

US00D946708S

(12) **United States Design Patent**
Stoler et al.

(10) **Patent No.:** **US D946,708 S**

(45) **Date of Patent:** **** Mar. 22, 2022**

(54) **FAUCET SPRAYHEAD**

(71) Applicant: **DELTA FAUCET COMPANY,**
Indianapolis, IN (US)

(72) Inventors: **Benjamin David Stoler,** Carmel, IN
(US); **Thad Eads,** Urbana, IN (US)

(73) Assignee: **DELTA FAUCET COMPANY,**
Indianapolis, IN (US)

(**) Term: **15 Years**

(21) Appl. No.: **29/723,367**

(22) Filed: **Feb. 6, 2020**

(51) **LOC (13) Cl.** **23-01**

(52) **U.S. Cl.**
USPC **D23/226**

(58) **Field of Classification Search**
USPC D23/213, 223, 226, 228, 229, 230, 238,
D23/239, 240, 241, 249
CPC B05B 1/16; B05B 1/1618; B05B 1/18;
B05B 1/185; E03C 1/0405; E03C 1/06;
E03C 1/063; E03C 1/066; E03C 1/084;
E03C 2001/0415

See application file for complete search history.

(56) **References Cited**

U.S. PATENT DOCUMENTS

8,413,686 B2 * 4/2013 Ko E03C 1/0404
137/801
D758,552 S * 6/2016 Rexach D23/255
9,707,572 B2 * 7/2017 Erickson B05B 1/1627
D805,611 S * 12/2017 Rexach D23/226
D844,109 S * 3/2019 Rexach D23/238
D866,707 S * 11/2019 Eads D23/213

D867,525 S * 11/2019 Eads D23/213
D870,234 S * 12/2019 Judge D23/213
D870,852 S * 12/2019 Eads D23/238
D873,380 S * 1/2020 Judge D23/238
D873,960 S * 1/2020 Fritz D23/238
2016/0136659 A1 * 5/2016 Erickson F16K 11/20
239/443

OTHER PUBLICATIONS

Kohler K-99260, Aug. 27, 2016 Amazon, site visited Mar. 24, 2021:
<https://www.amazon.com/dp/B01L3N3AEU/> (Year: 2016).*
Hoimpro H_KTOF_0019_03_BN, Oct. 11, 2019 Amazon, site
visited Mar. 24, 2021: <https://www.amazon.com/dp/B07Z1MHNC6/>
(Year: 2019).*

* cited by examiner

Primary Examiner — Jack Reickel

Assistant Examiner — Bobby W Jones, II

(74) *Attorney, Agent, or Firm* — Nirav D. Parikh; Edgar
A. Zarins

(57) **CLAIM**

The ornamental design for a faucet sprayhead, as shown and
described.

DESCRIPTION

FIG. 1 is a front perspective view of a faucet sprayhead
showing my new design;
FIG. 2 is a rear perspective view thereof;
FIG. 3 is another front perspective view thereof;
FIG. 4 is a left side view thereof;
FIG. 5 is another rear perspective view thereof;
FIG. 6 is a right side view thereof;
FIG. 7 is a top perspective view thereof; and,
FIG. 8 is a bottom perspective view thereof.

1 Claim, 4 Drawing Sheets

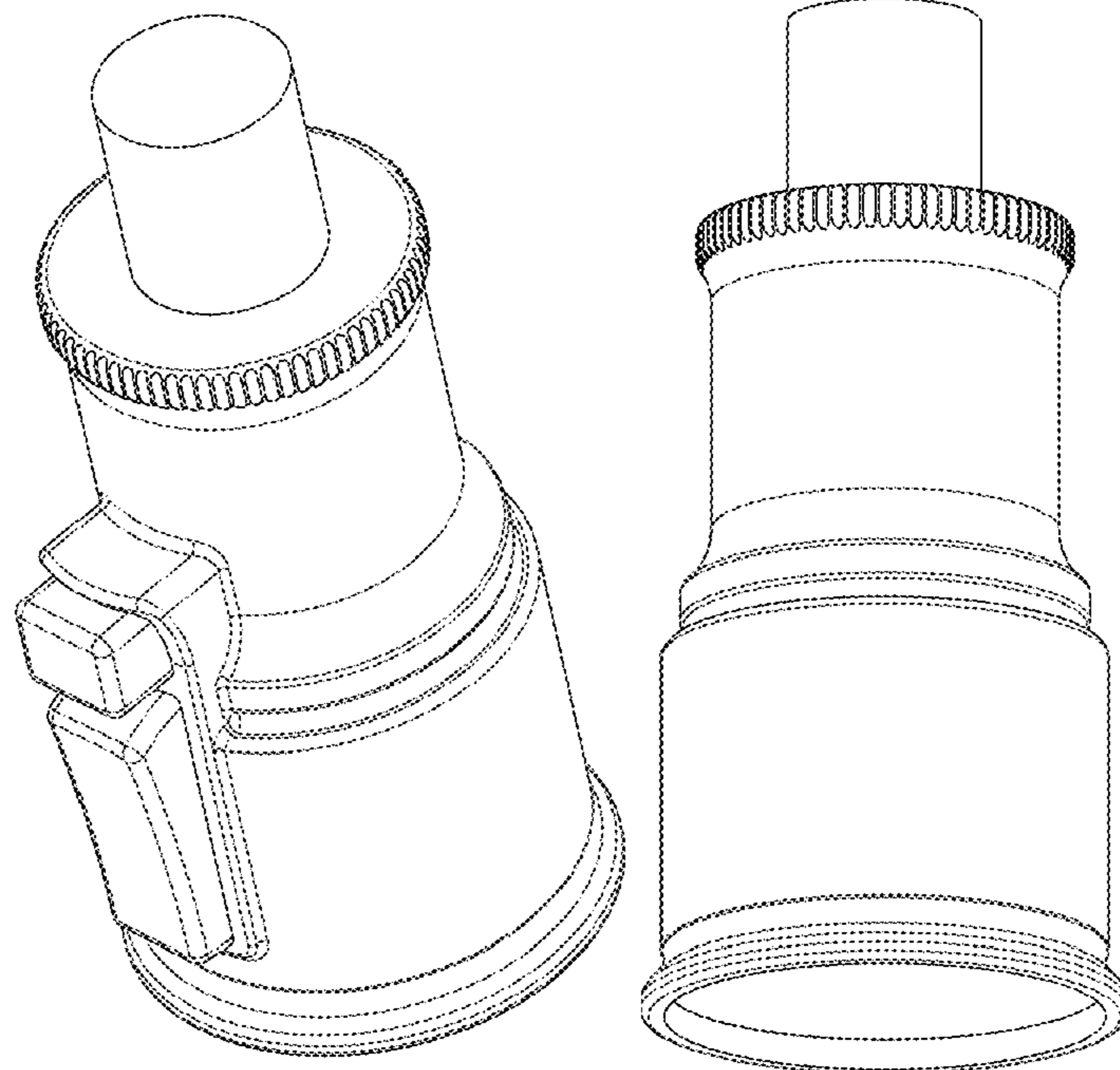

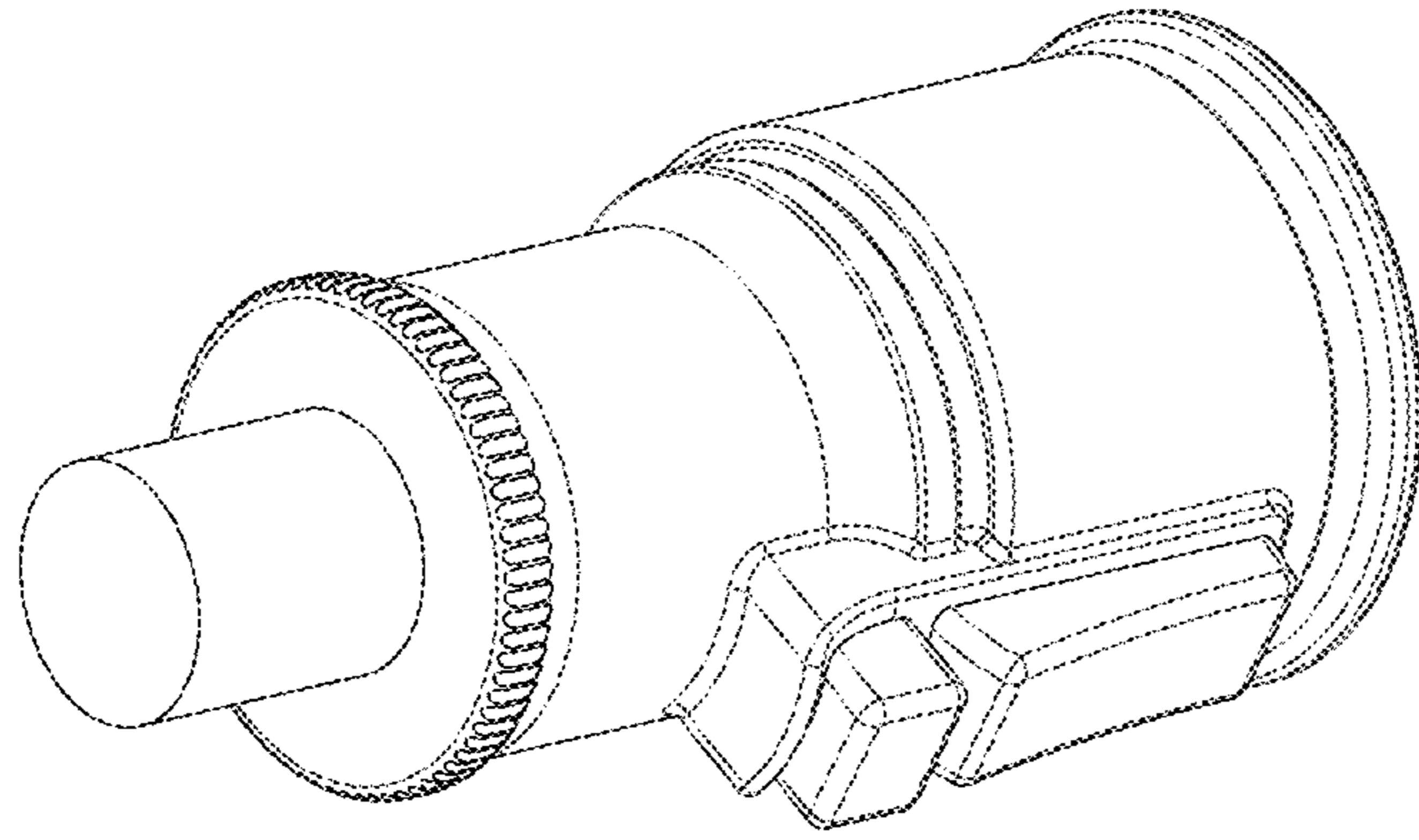

FIG - 2

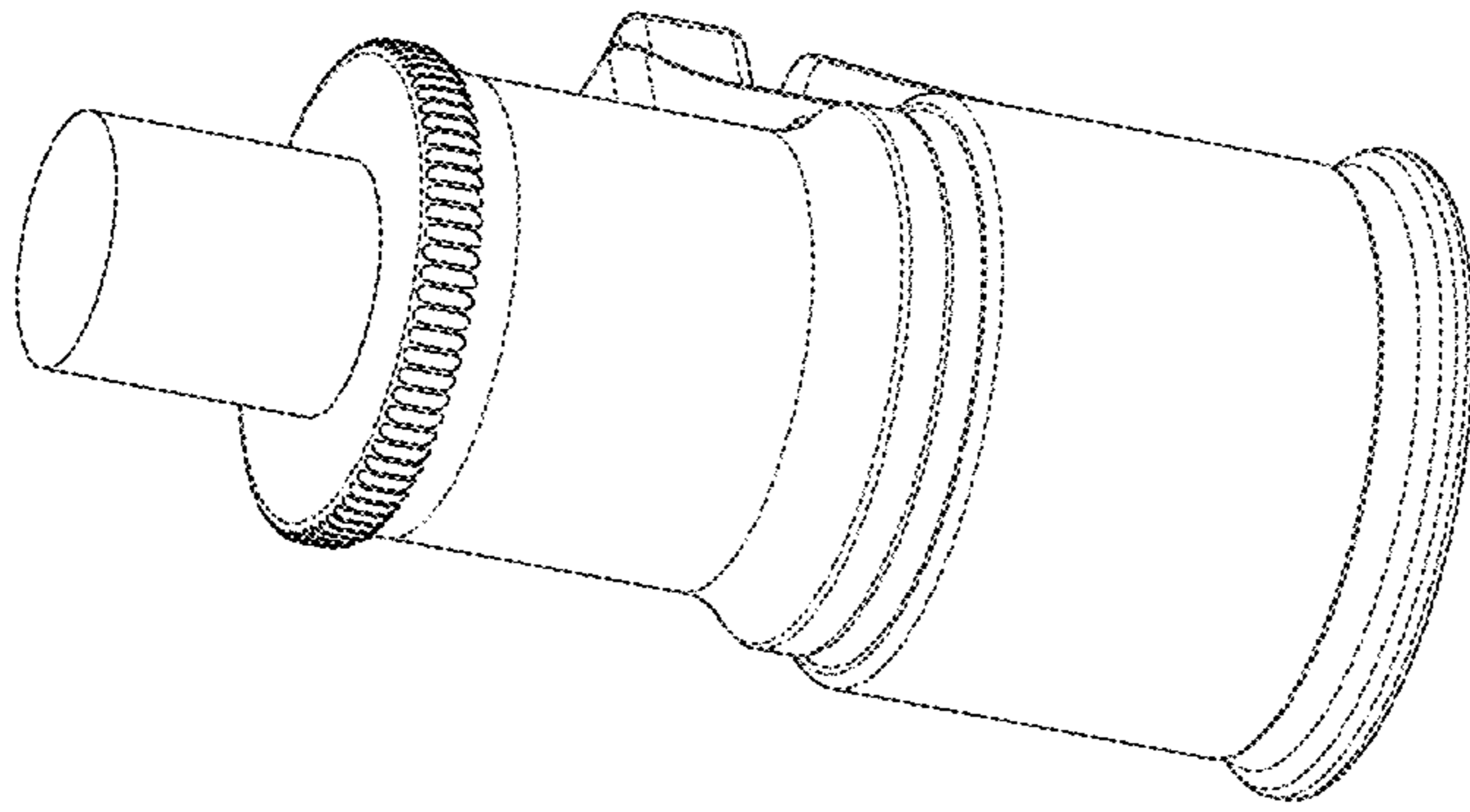

FIG - 1

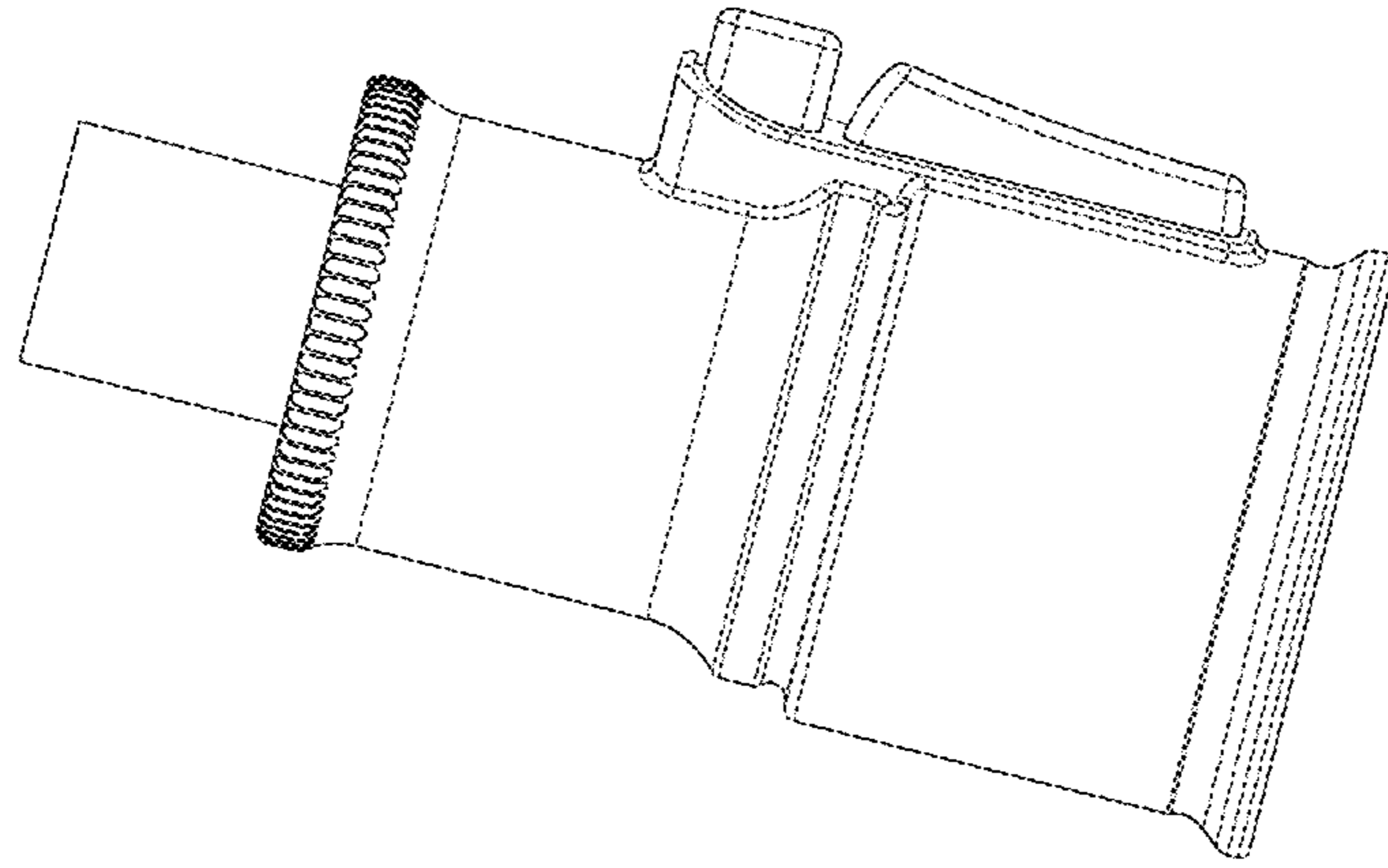

FIG - 4

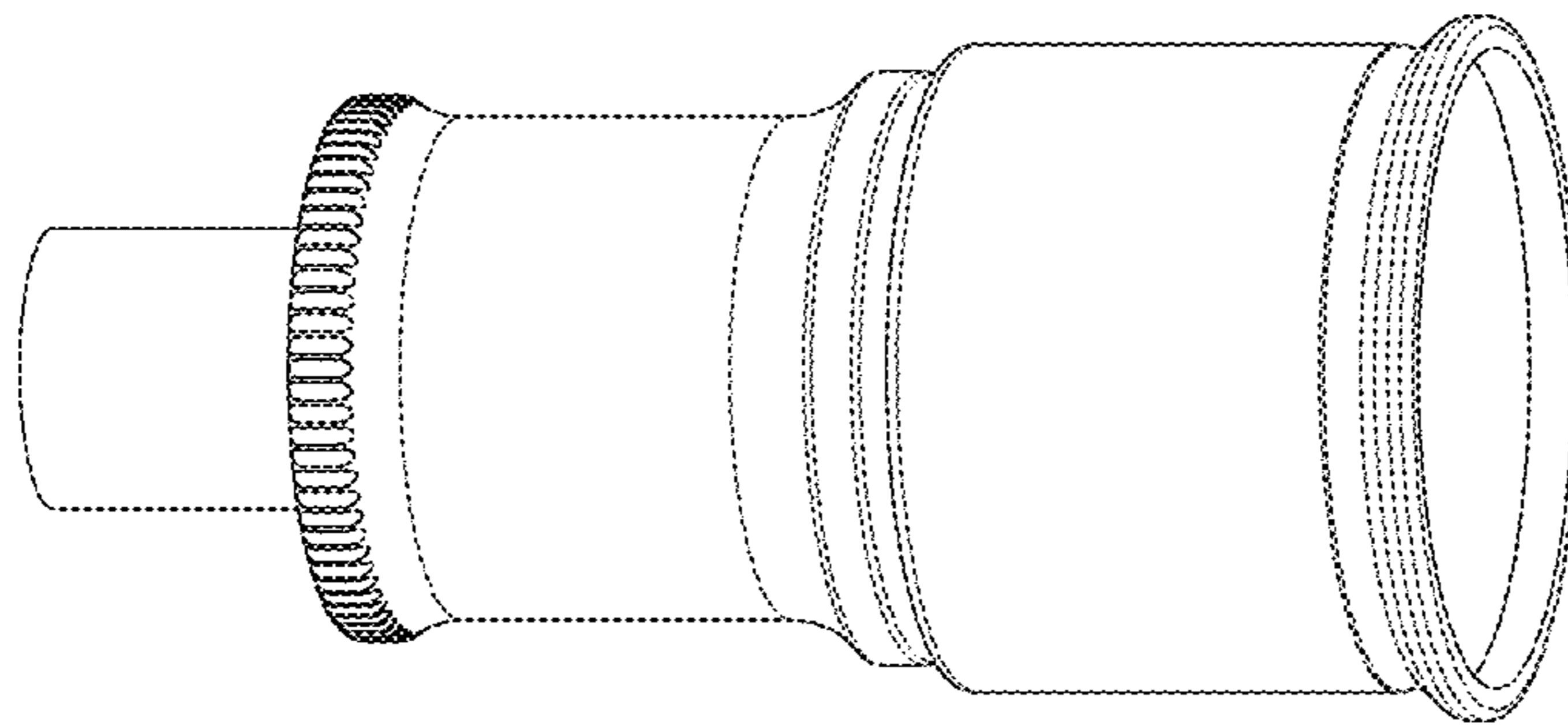

FIG - 3

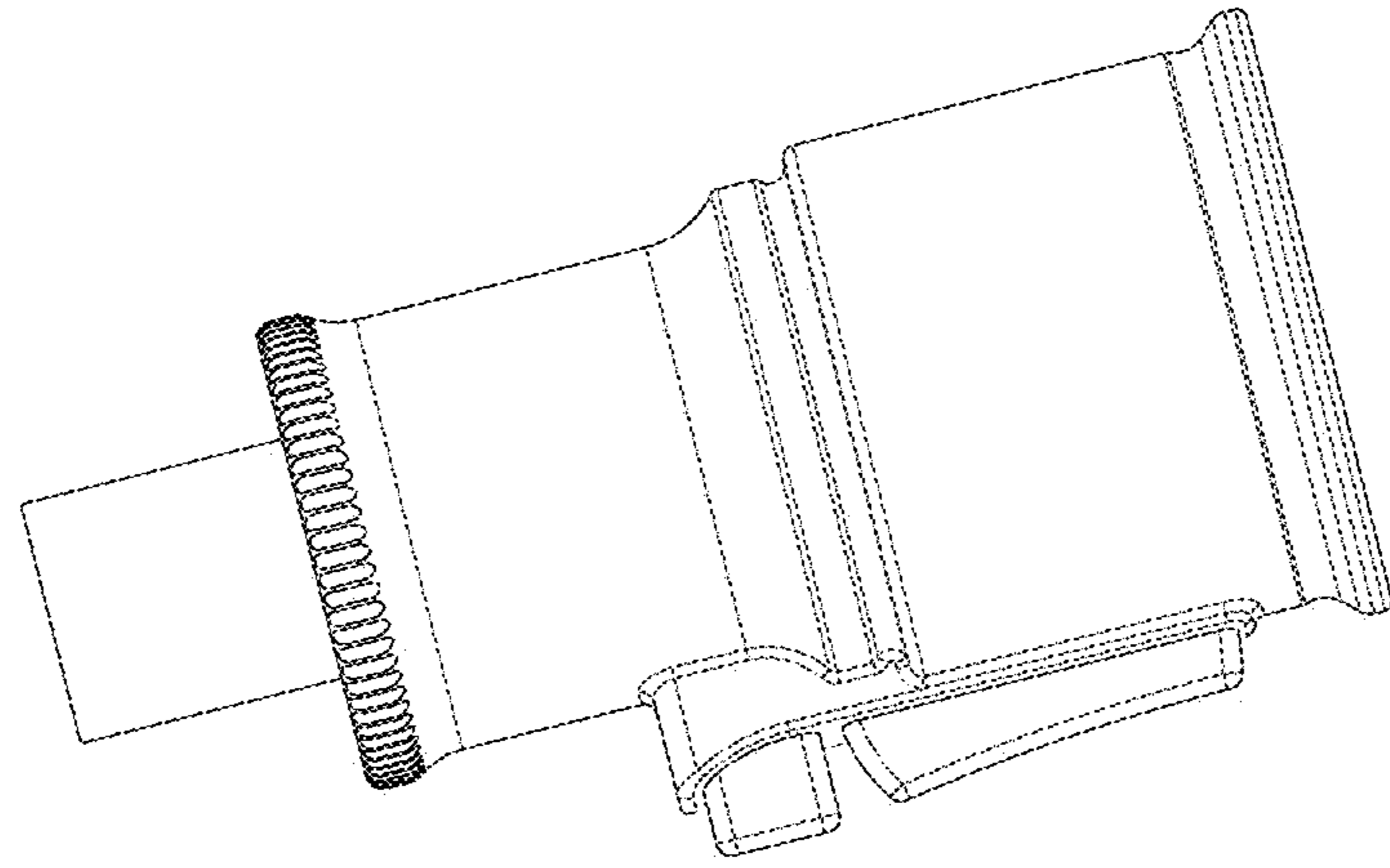

FIG - 6

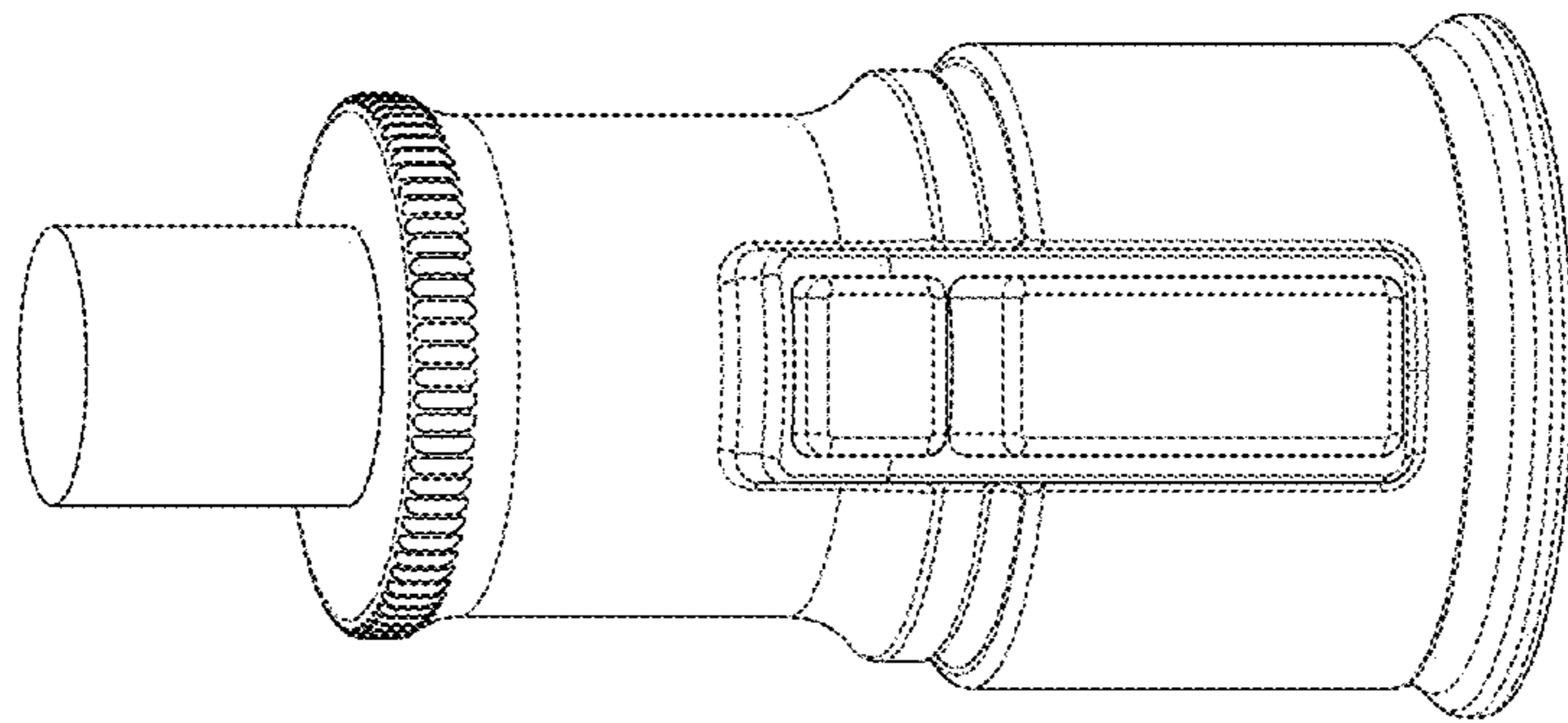

FIG - 5

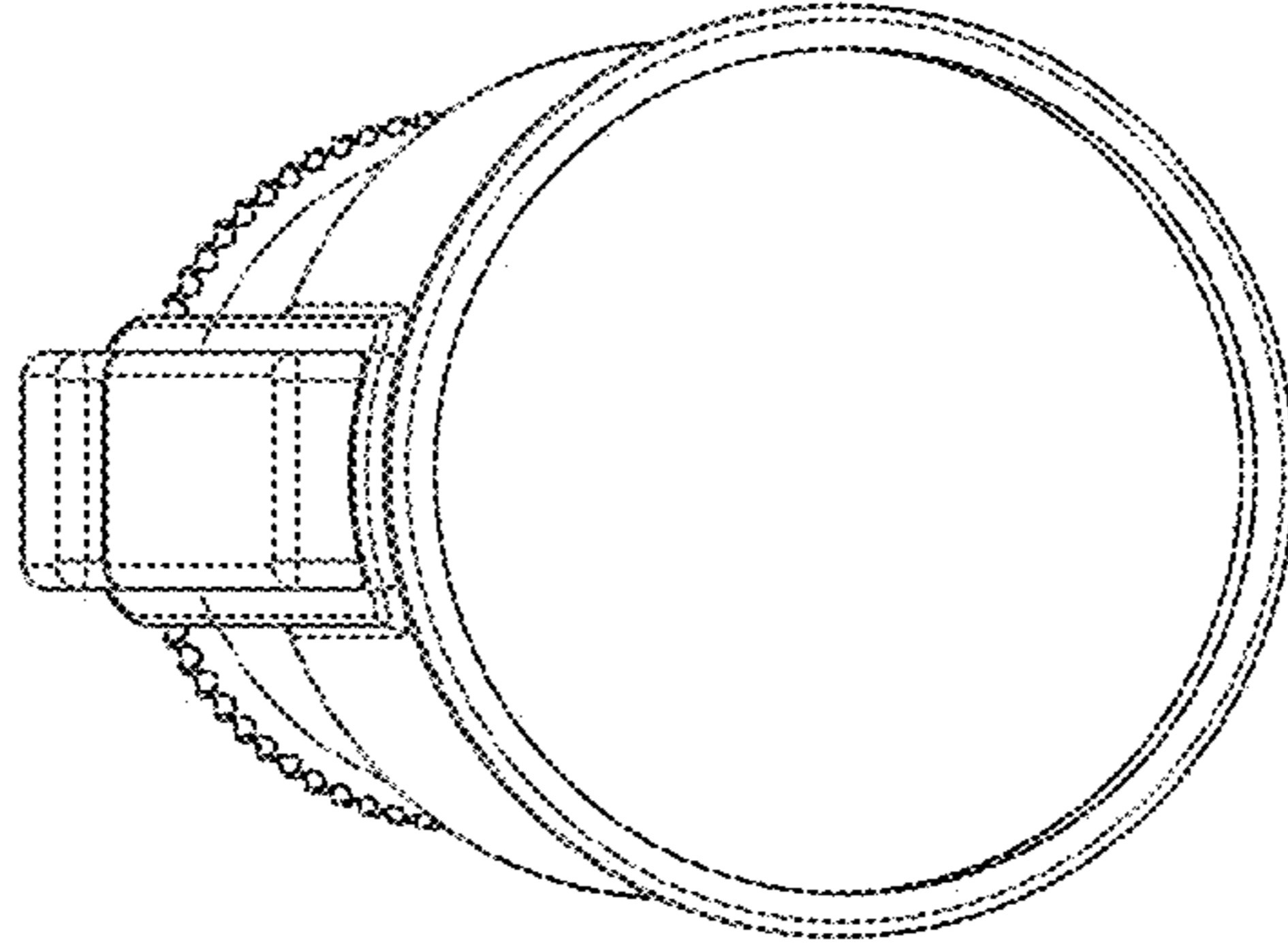

FIG - 8

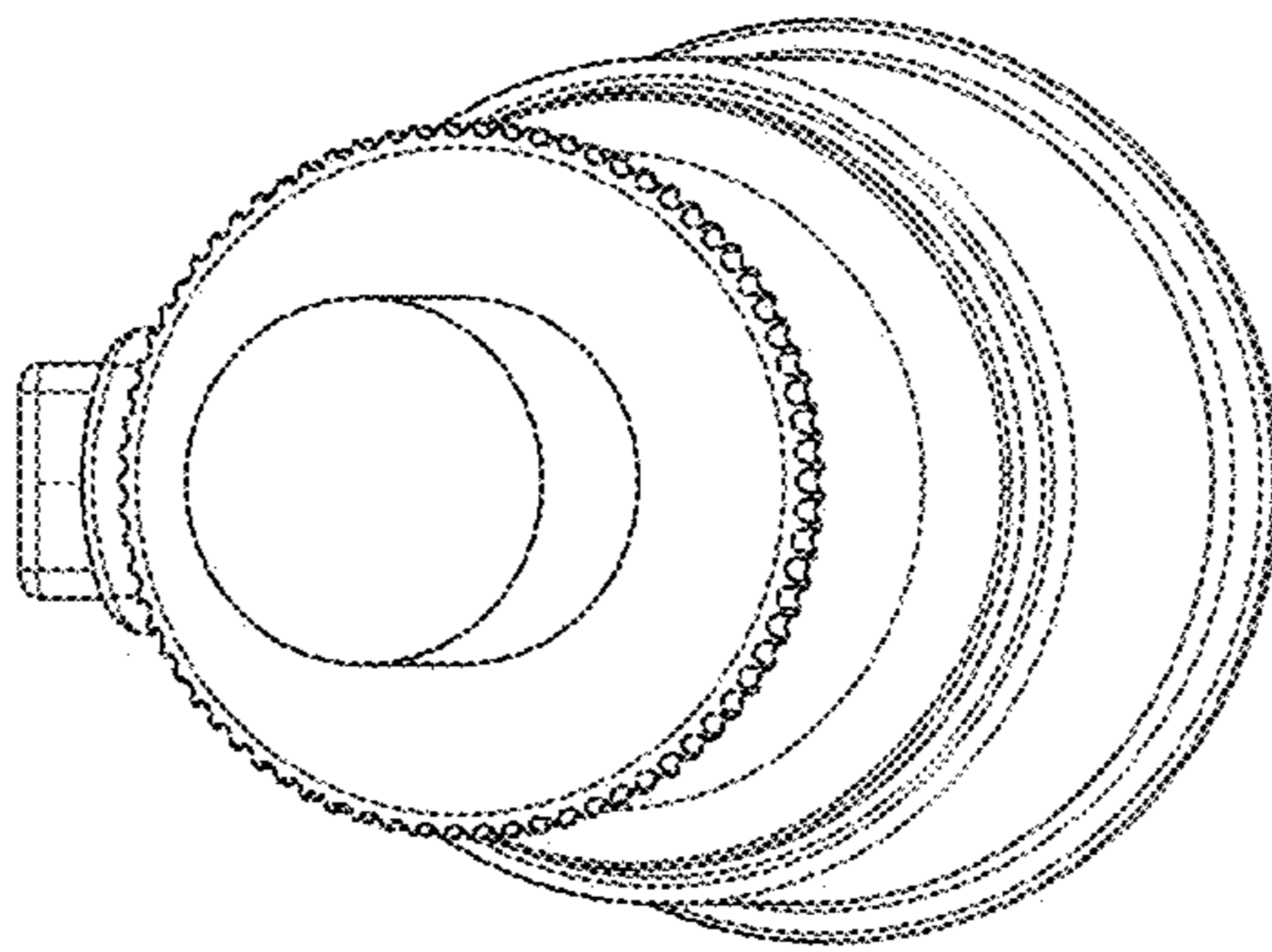

FIG - 7