



US00D946320S

(12) **United States Design Patent**
Wihlborg

(10) **Patent No.:** **US D946,320 S**

(45) **Date of Patent:** **** Mar. 22, 2022**

(54) **BOOKCASE**

(71) Applicant: **Inter IKEA Systems B.V.**, LN Delft
(NL)

(72) Inventor: **Ola Wihlborg**, Älmhult (SE)

(73) Assignee: **INTER IKEA SYSTEMS B.V.**, Delft
(NL)

(**) Term: **15 Years**

(21) Appl. No.: **29/733,787**

(22) Filed: **May 6, 2020**

(30) **Foreign Application Priority Data**

Nov. 8, 2019 (EM) 007203161-0001

(51) **LOC (13) Cl.** **06-04**

(52) **U.S. Cl.**
USPC **D6/662.1**

(58) **Field of Classification Search**
USPC D6/560, 642, 654.1, 657, 661, 662, 664,
D6/672, 673, 675, 675.1, 675.3, 699, 660;
D34/20; D30/101; D23/303
CPC B65D 5/545; B65D 5/26; B65D 5/0015;
B65D 5/0045; B65D 1/34; B65D 21/00;
B65D 81/3813; G09F 13/0413; A47F
5/103; A47F 5/105; A47F 7/146; A47F
2003/046; A47B 81/061
See application file for complete search history.

(56) **References Cited**

U.S. PATENT DOCUMENTS

D77,684 S * 2/1929 Gelfand D6/660
D176,466 S * 12/1955 La Barre D6/675.3

D258,185 S * 2/1981 Glass D6/675.3
D272,498 S * 2/1984 Kemp, III D6/662.1
D364,758 S * 12/1995 Newhouse D6/662.1
D447,364 S * 9/2001 Stone D6/675.3
D459,910 S * 7/2002 Winter D6/662.1
D485,454 S * 1/2004 De Blois D6/675.1
D525,455 S * 7/2006 O'Reilly D6/662.1
D554,889 S * 11/2007 Thompson D6/662.1
D595,974 S * 7/2009 Millilo D6/662.1
D648,151 S * 11/2011 Walker D6/662.1
D658,406 S * 5/2012 O'Brien D6/675.1
D712,692 S * 9/2014 McManic D6/702
D744,770 S * 12/2015 Middendorf D6/662.1
D836,956 S * 1/2019 Tsuchiyama D6/675.1
D885,807 S * 6/2020 Chiang D6/675.1

* cited by examiner

Primary Examiner — Kevin K Rudzinski

Assistant Examiner — Paul D Bohannon

(74) *Attorney, Agent, or Firm* — Tucker Ellis LLP

(57) **CLAIM**

The ornamental design for a bookcase, as shown and described.

DESCRIPTION

FIG. 1 is a perspective view of a bookcase showing my new design;
FIG. 2 is a front view thereof;
FIG. 3 is a rear view thereof;
FIG. 4 is a left side view thereof;
FIG. 5 is a right side view thereof;
FIG. 6 is a top view thereof; and,
FIG. 7 is a bottom view thereof.
The broken lines in the drawings illustrate portions of the bookcase that form no part of the claimed design.

1 Claim, 5 Drawing Sheets

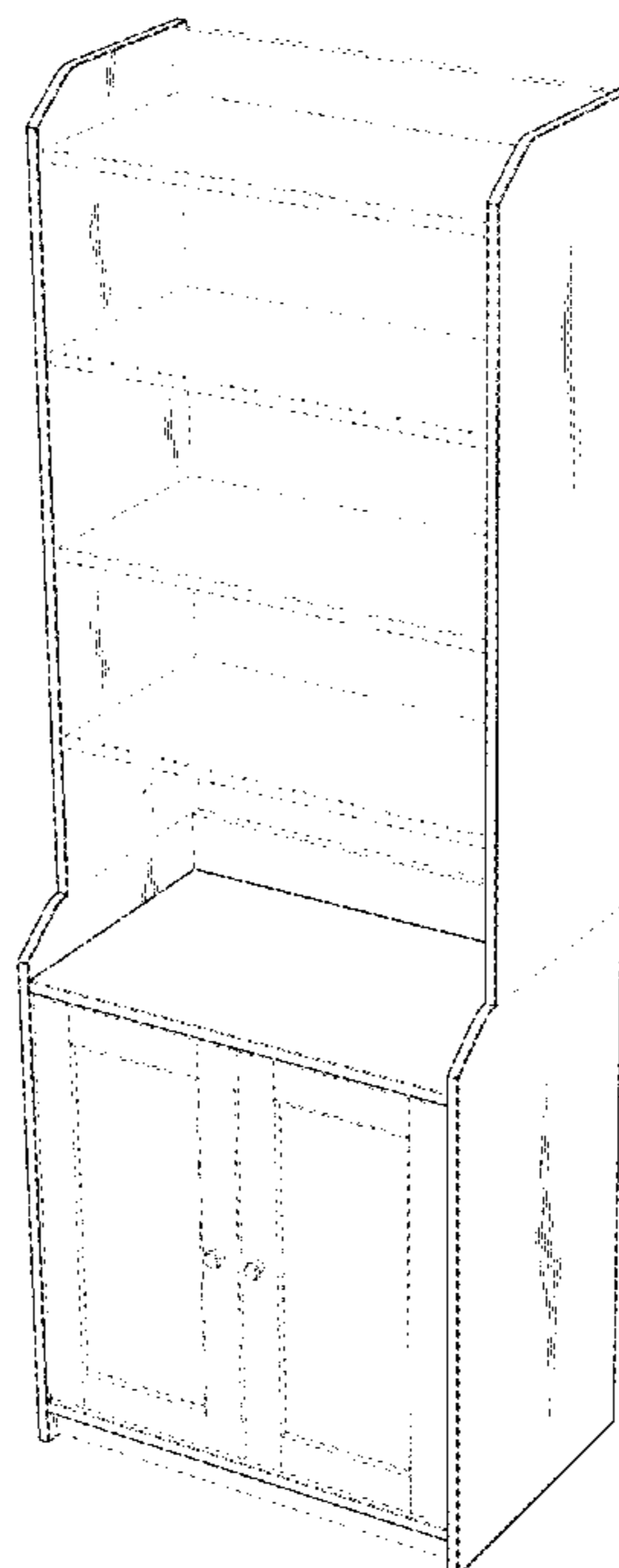

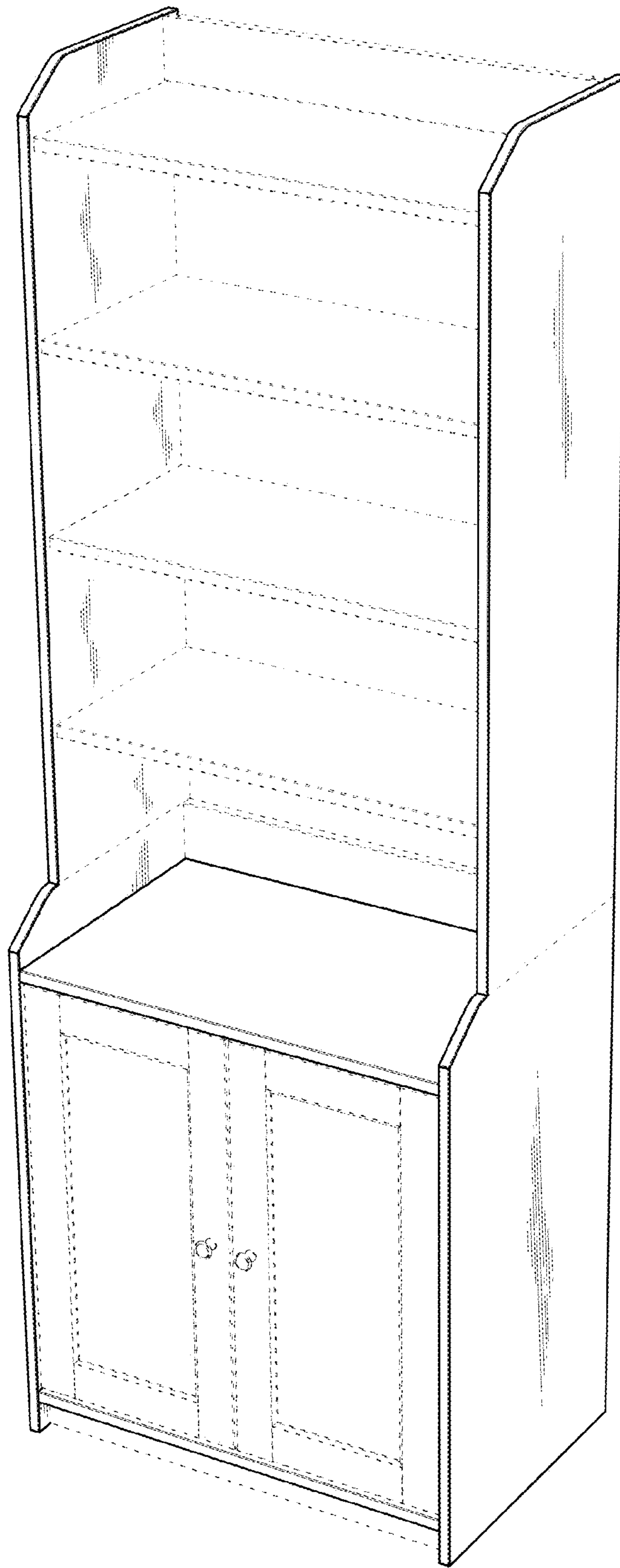

FIG. 1

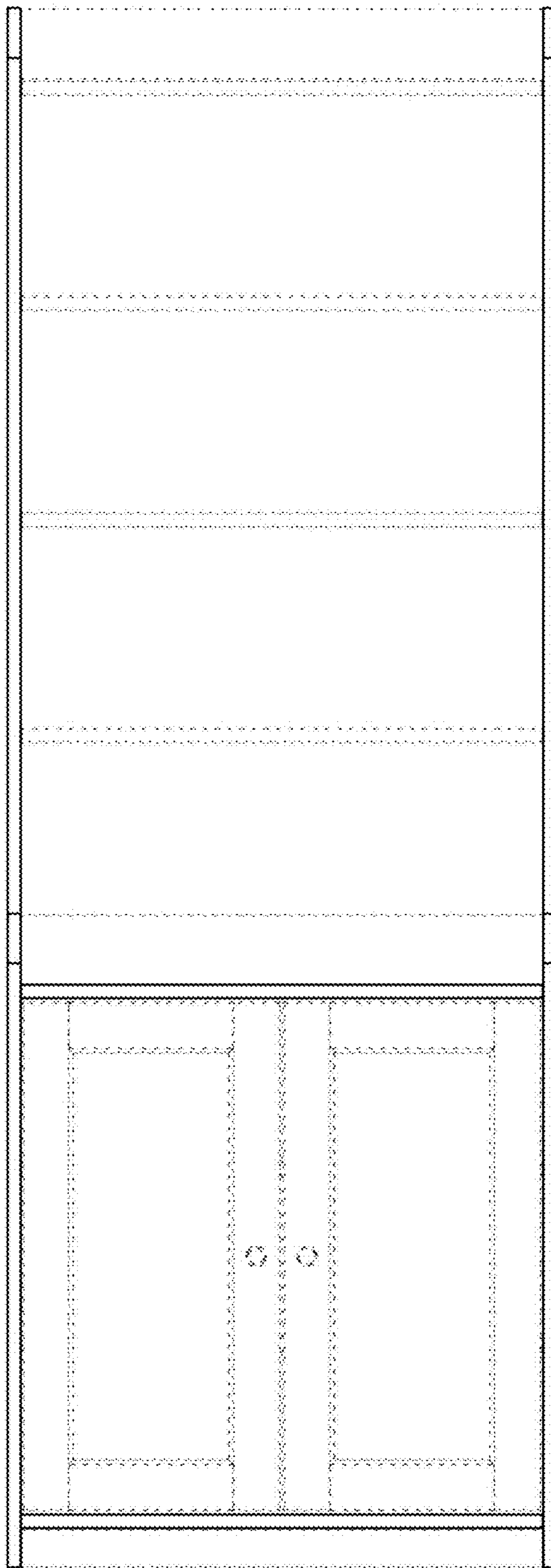

FIG. 2

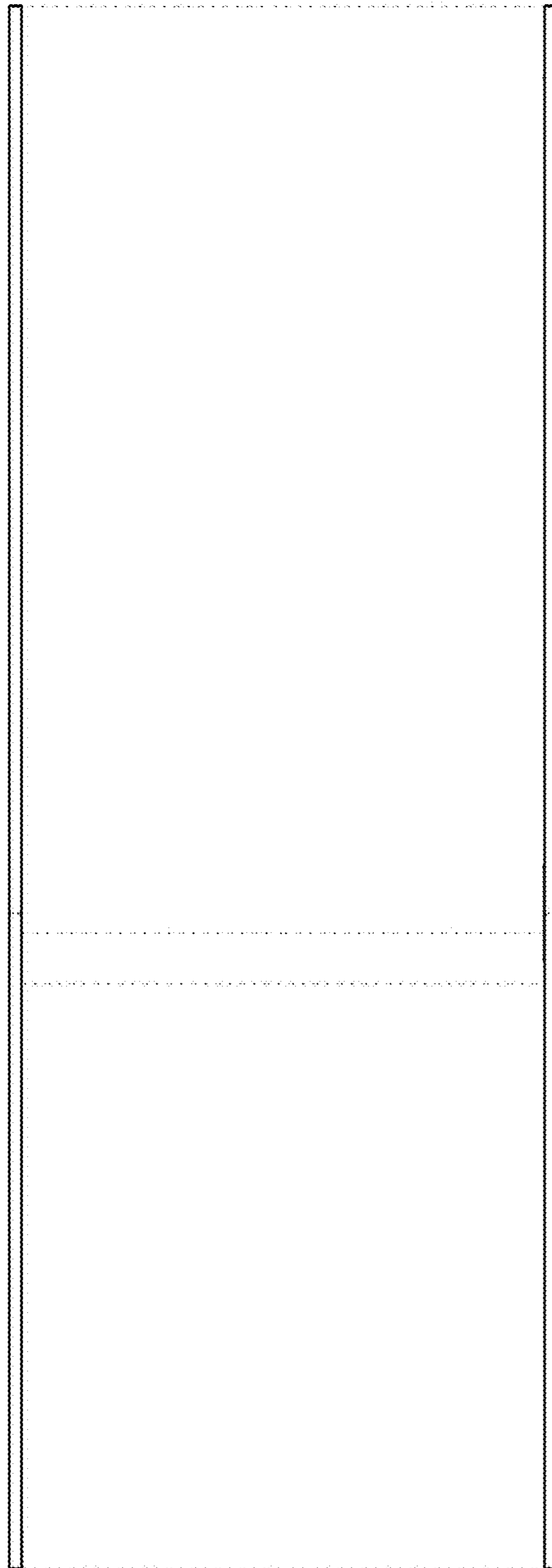

FIG. 3

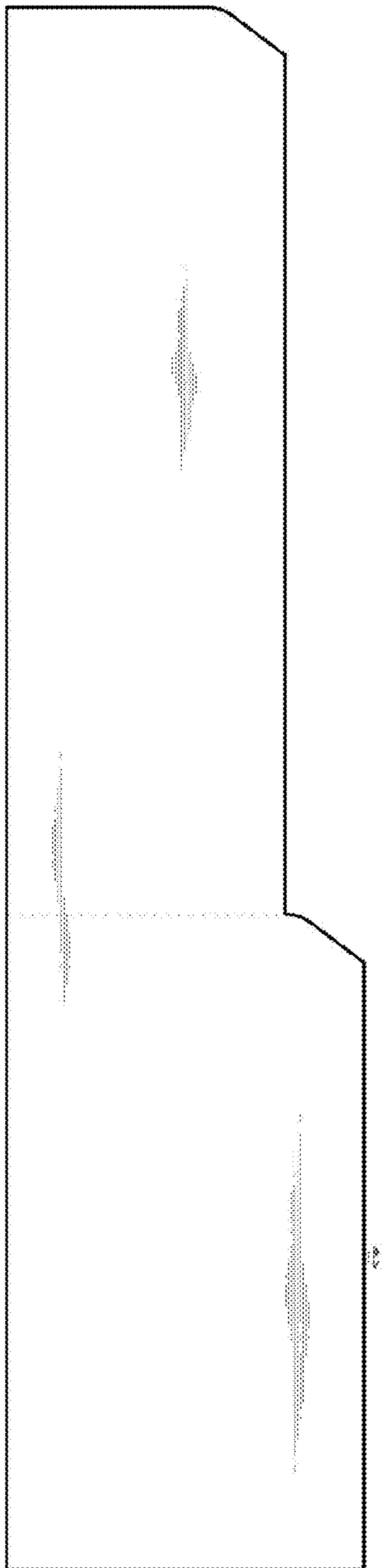

FIG. 4

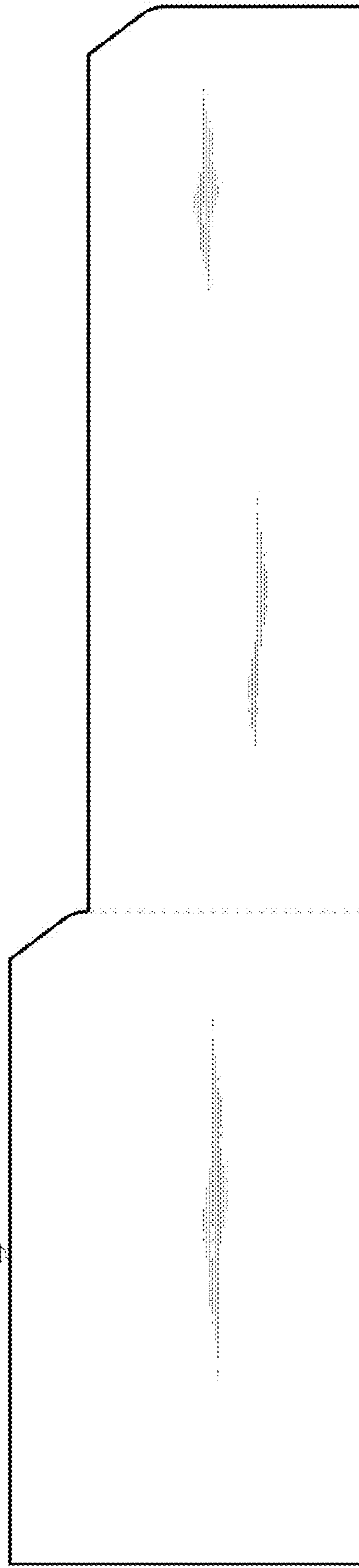

FIG. 5

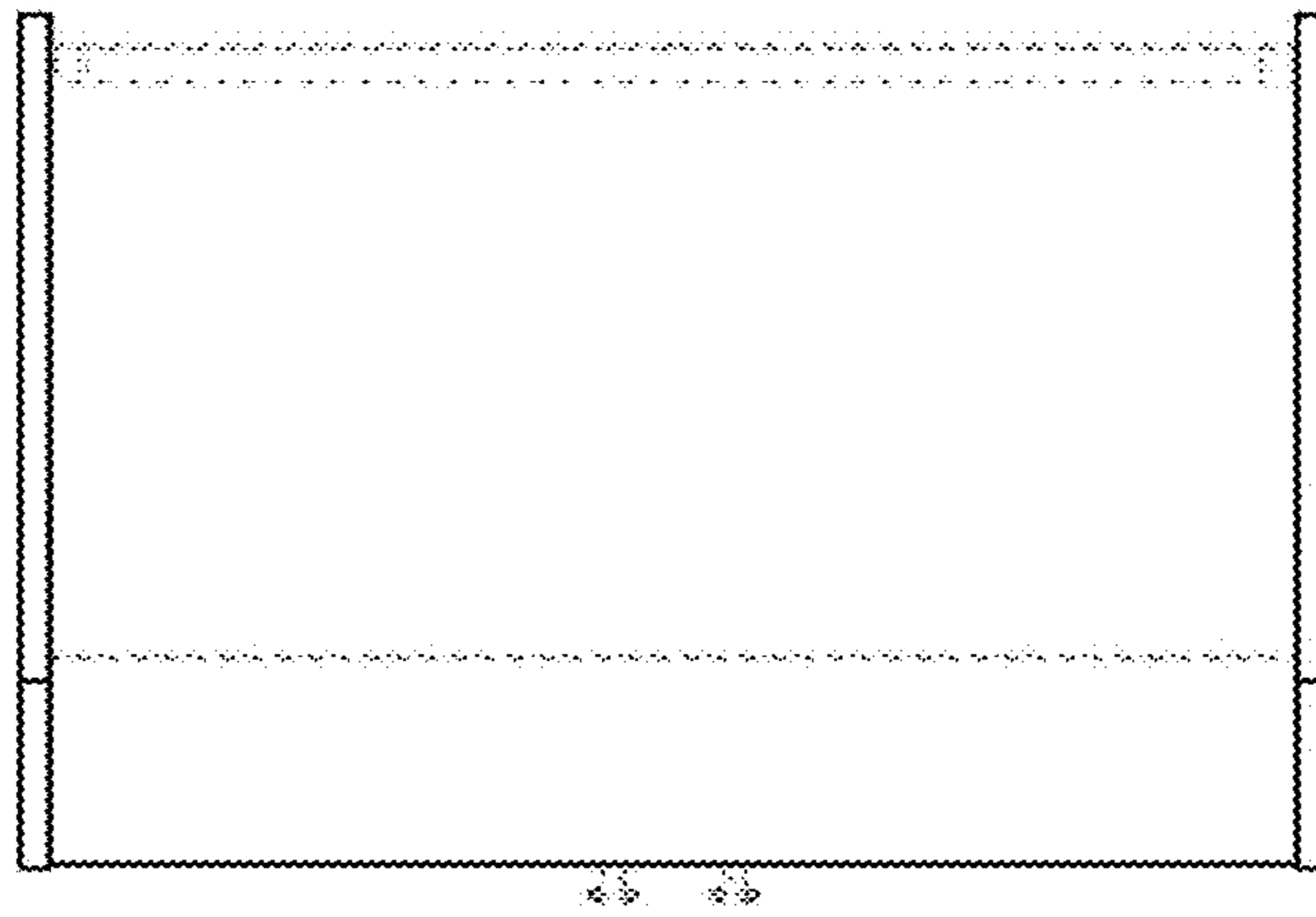

FIG. 6

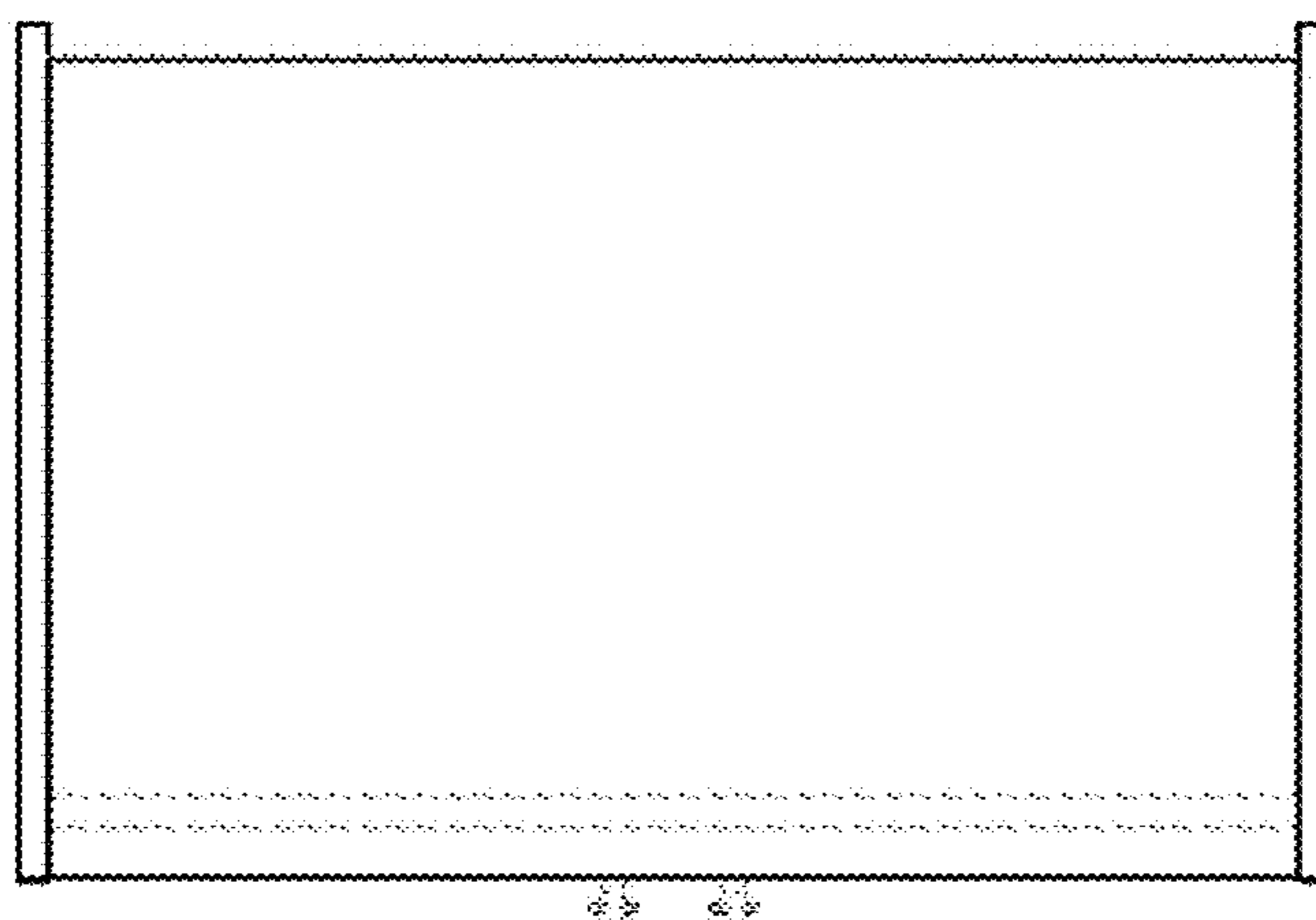

FIG. 7