



US00D942998S

(12) **United States Design Patent**  
**Zhang**

(10) **Patent No.:** **US D942,998 S**

(45) **Date of Patent:** **\*\* Feb. 8, 2022**

(54) **DISPLAY SCREEN OR PORTION OF A  
DEVICE WITH TRANSITIONAL  
GRAPHICAL USER INTERFACE**

(71) Applicant: **AUTEL INTELLIGENT  
TECHNOLOGY CORP., LTD.,**  
Guangdong (CN)

(72) Inventor: **Lijia Zhang**, Guangdong (CN)

(73) Assignee: **AUTEL INTELLIGENT  
TECHNOLOGY CORP., LTD.,**  
Shenzhen (CN)

(\*\*) Term: **15 Years**

(21) Appl. No.: **29/759,039**

(22) Filed: **Nov. 19, 2020**

(30) **Foreign Application Priority Data**

May 22, 2020 (CN) ..... 202030243265.0

(51) **LOC (13) Cl.** ..... **14-04**

(52) **U.S. Cl.**  
USPC ..... **D14/488**

(58) **Field of Classification Search**

USPC ..... D14/485-495  
CPC .... G06F 3/048; G06F 3/0481; G06F 3/04812;  
G06F 3/04815; G06F 3/04817; G06F  
3/0482; G06F 3/0483; G06F 3/0484;  
G06F 3/04842; G06F 3/04845; G06F  
3/04847; G06F 3/0485; G06F 3/04855;  
G06F 3/0486; G06F 3/0487; G06F  
3/0488; G06F 3/04883; G06F 3/04886

See application file for complete search history.

(56) **References Cited**

U.S. PATENT DOCUMENTS

9,212,918 B1 \* 12/2015 Newlin ..... G01C 21/26  
D858,555 S \* 9/2019 Krishna ..... D14/486

D874,491 S \* 2/2020 Kuo ..... D14/486  
D875,119 S \* 2/2020 Liu ..... D14/486  
10,579,226 B2 \* 3/2020 Leong ..... G06F 16/29  
D881,221 S \* 4/2020 Chen ..... D14/486  
D884,009 S \* 5/2020 Hong ..... D14/486  
10,755,373 B2 \* 8/2020 Smirin ..... G06Q 50/30  
D900,856 S \* 11/2020 Westerhold ..... D14/486  
D901,527 S \* 11/2020 Maier ..... D14/486  
D910,057 S \* 2/2021 Matsumoto ..... D14/486  
D910,697 S \* 2/2021 Lemay ..... D14/488  
D911,353 S \* 2/2021 Sanchez ..... D14/485  
D911,372 S \* 2/2021 Zhao ..... D14/486  
D911,382 S \* 2/2021 Devine ..... D14/488  
D912,694 S \* 3/2021 Clarke ..... D14/486  
D916,794 S \* 4/2021 Li ..... D14/486  
D920,367 S \* 5/2021 Luo ..... D14/486

(Continued)

Primary Examiner — Bao-Yen T Nguyen

(57) **CLAIM**

The ornamental design for a display screen or portion of a device with transitional graphical user interface, as shown and described.

**DESCRIPTION**

FIG. 1 is a front view of a first image of a display screen or portion of a device with transitional graphical user interface; FIG. 2 is a front view of a second image thereof; FIG. 3 is a front view of a third image thereof; FIG. 4 is a front view of a fourth image view thereof; FIG. 5 is a front view of a fifth image thereof; and, FIG. 6 is a front view of a sixth image thereof.

The broken line shown in FIGS. 1-6 is included for the purpose of showing a portion of a display screen and forms no part of the claimed design.

The appearance of the transitional image sequentially transitions between the images shown in FIGS. 1-6. The process or period in which one image transitions to another image forms no part of the claimed design.

**1 Claim, 6 Drawing Sheets**

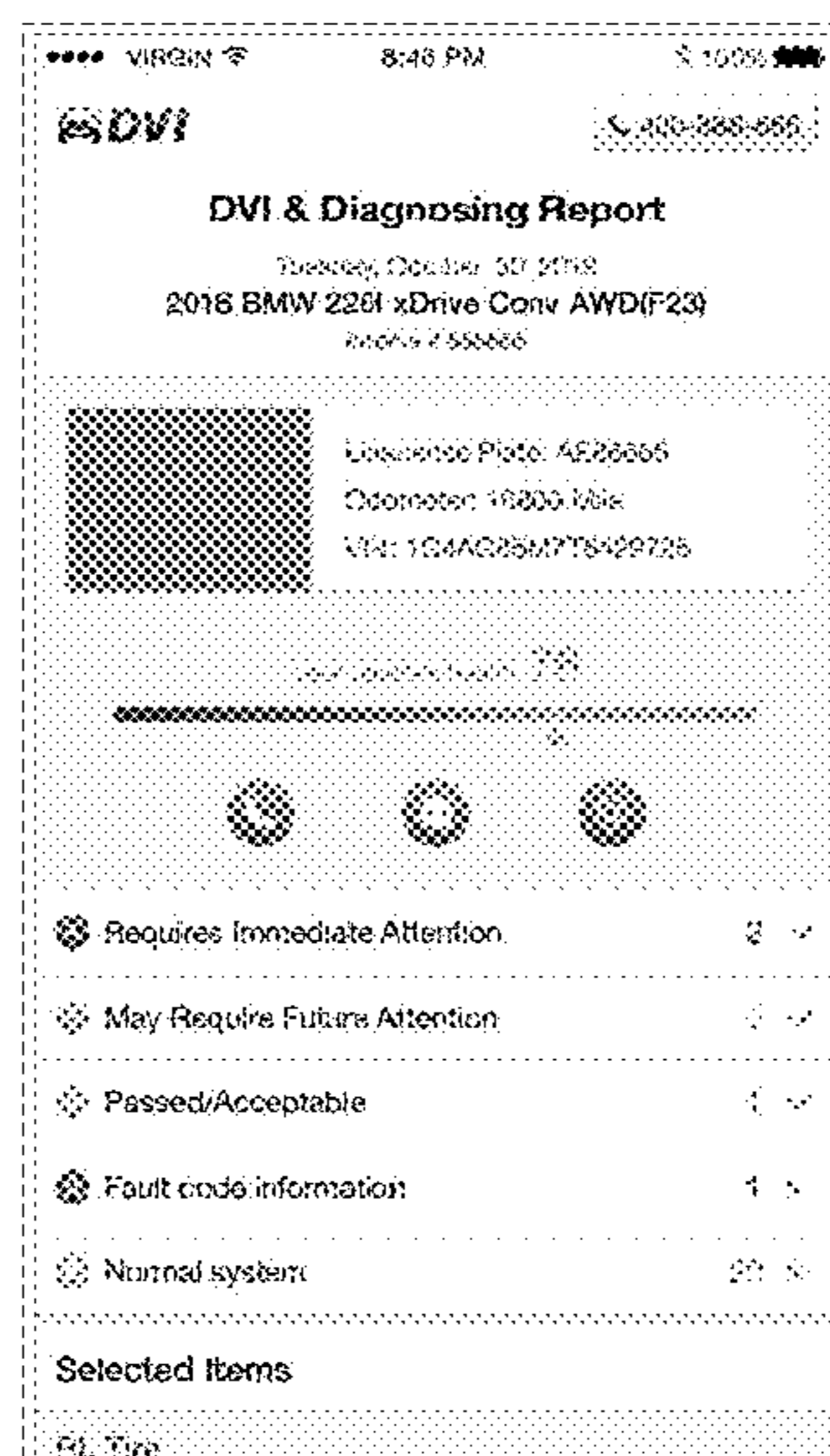

(56)

**References Cited**

U.S. PATENT DOCUMENTS

D925,564 S \* 7/2021 Zhao ..... D14/486  
2018/0188948 A1\* 7/2018 Ouyang ..... G06F 3/0233  
2018/0337918 A1\* 11/2018 Chang ..... G06F 3/04812  
2018/0367483 A1\* 12/2018 Rodriguez ..... H04L 65/60

\* cited by examiner

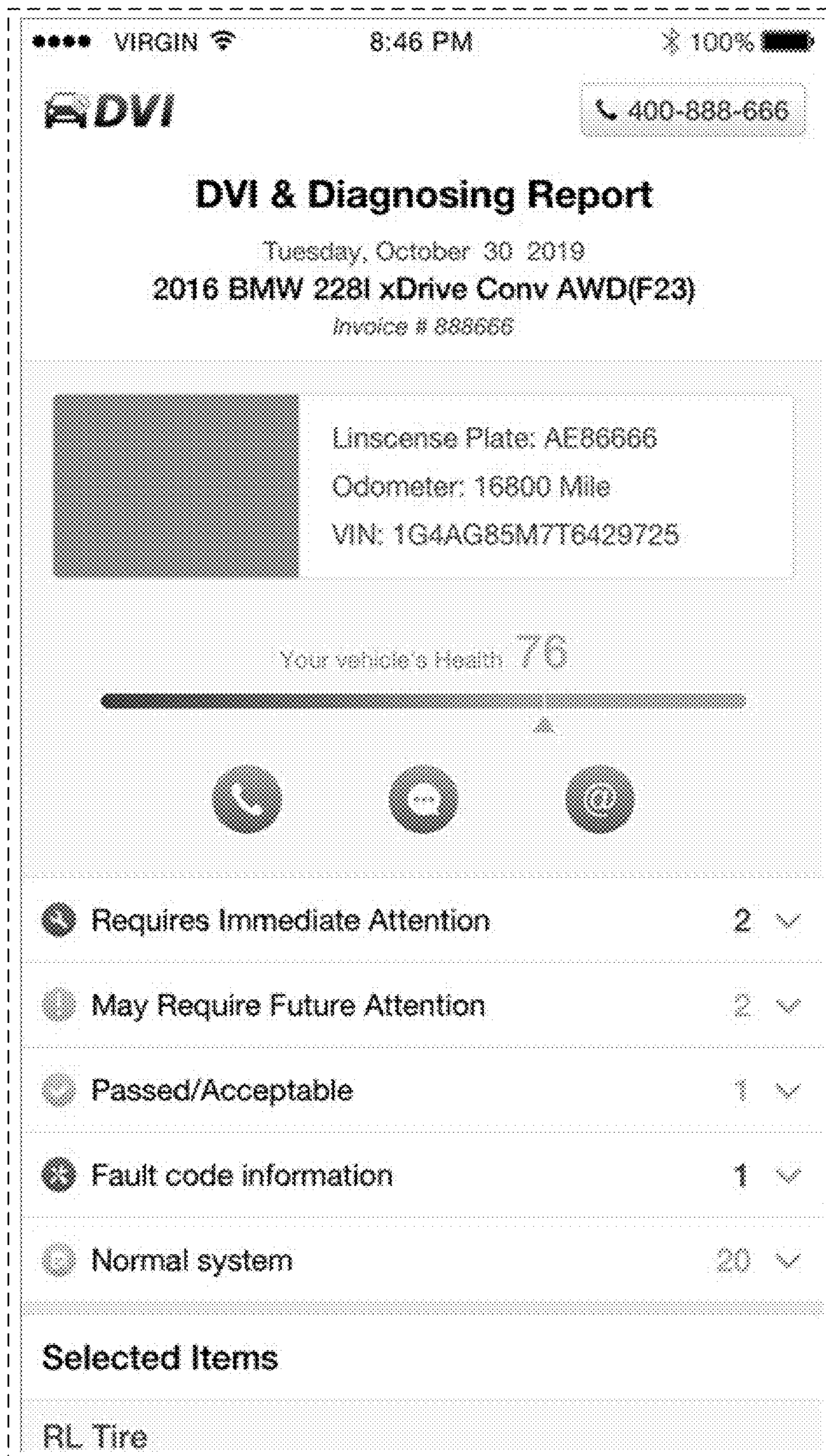

FIG.1



<b>RL Tire</b>		
Labar: \$100.00	Parts: \$200.00	SubTotal: \$300.00
<b>Coolant</b>		
Labar: \$100.00	Parts: \$200.00	SubTotal: \$300.00
<b>P0107</b>		
Labar: \$100.00	Parts: \$200.00	SubTotal: \$300.00
		Tax: \$35.00
		SubTotal: \$935.00

**Notes**

Enter a note...

I hereby authorize the above repair work to be done along with the necessary material and hereby grant you and/or your employees permission to operate the car or truck herein described on street,highways or elsewhere for the purpose to testing and/or inspection.An express mechanic's lien is hereby acknowledged on above car or truck to secure the amount of repairs thereto.

**Sign Here**

Authorize

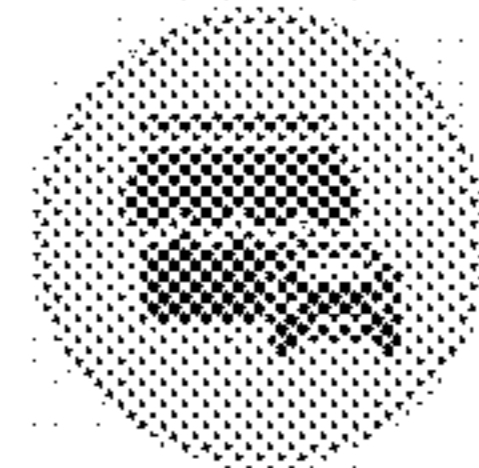
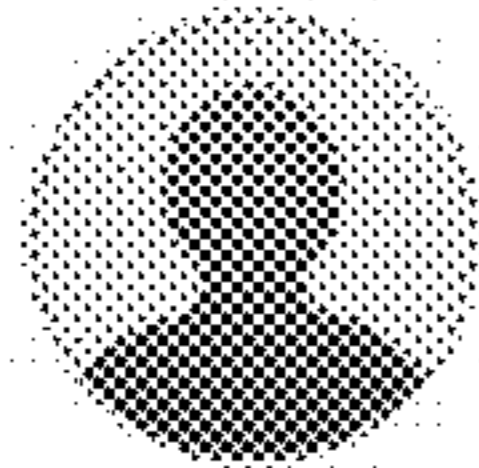

FIG.2



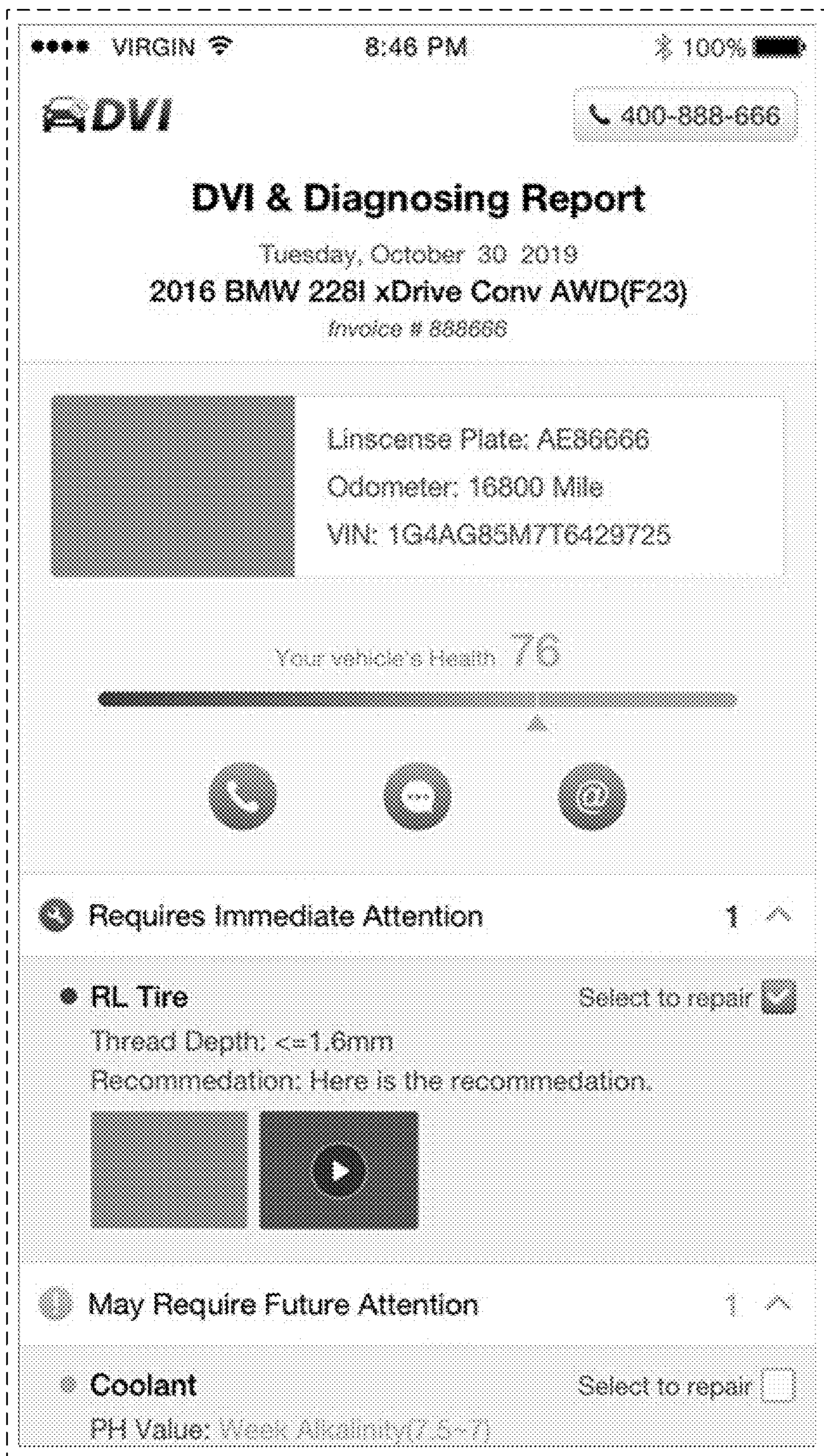

FIG.3



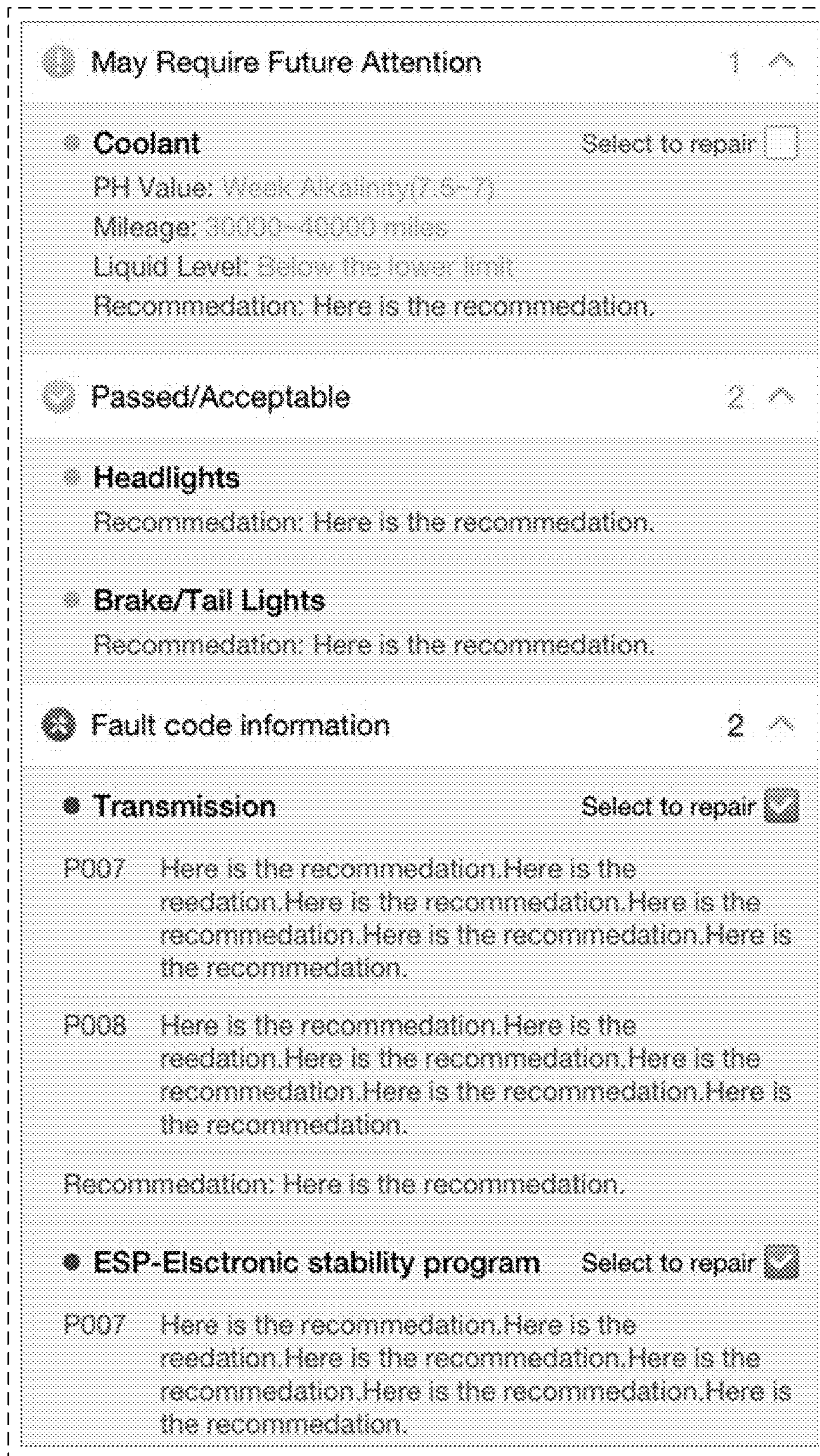

FIG.4



**ESP-Electronic stability program**    Select to repair

P007    Here is the recommendation. Here is the reedation. Here is the recommendation. Here is the recommendation. Here is the recommendation. Here is the recommendation.

P008    Here is the recommendation. Here is the reedation. Here is the recommendation. Here is the recommendation. Here is the recommendation. Here is the recommendation.

Recommendation: Here is the recommendation.

---

**Normal system** 2 ^

**Transmission**

**P0108**

---

**Selected Items**

RL Tire		
Labar: \$100.00	Parts: \$200.00	SubTotal: \$300.00
Coolant		
Labar: \$100.00	Parts: \$200.00	SubTotal: \$300.00
P0107		
Labar: \$100.00	Parts: \$200.00	SubTotal: \$300.00
		Tax: \$35.00
		SubTotal: \$935.00

---

**Notes**

Here is the recommendation. Here is the mediation. Here is the recommendation. Here is the recommendation.

FIG.5



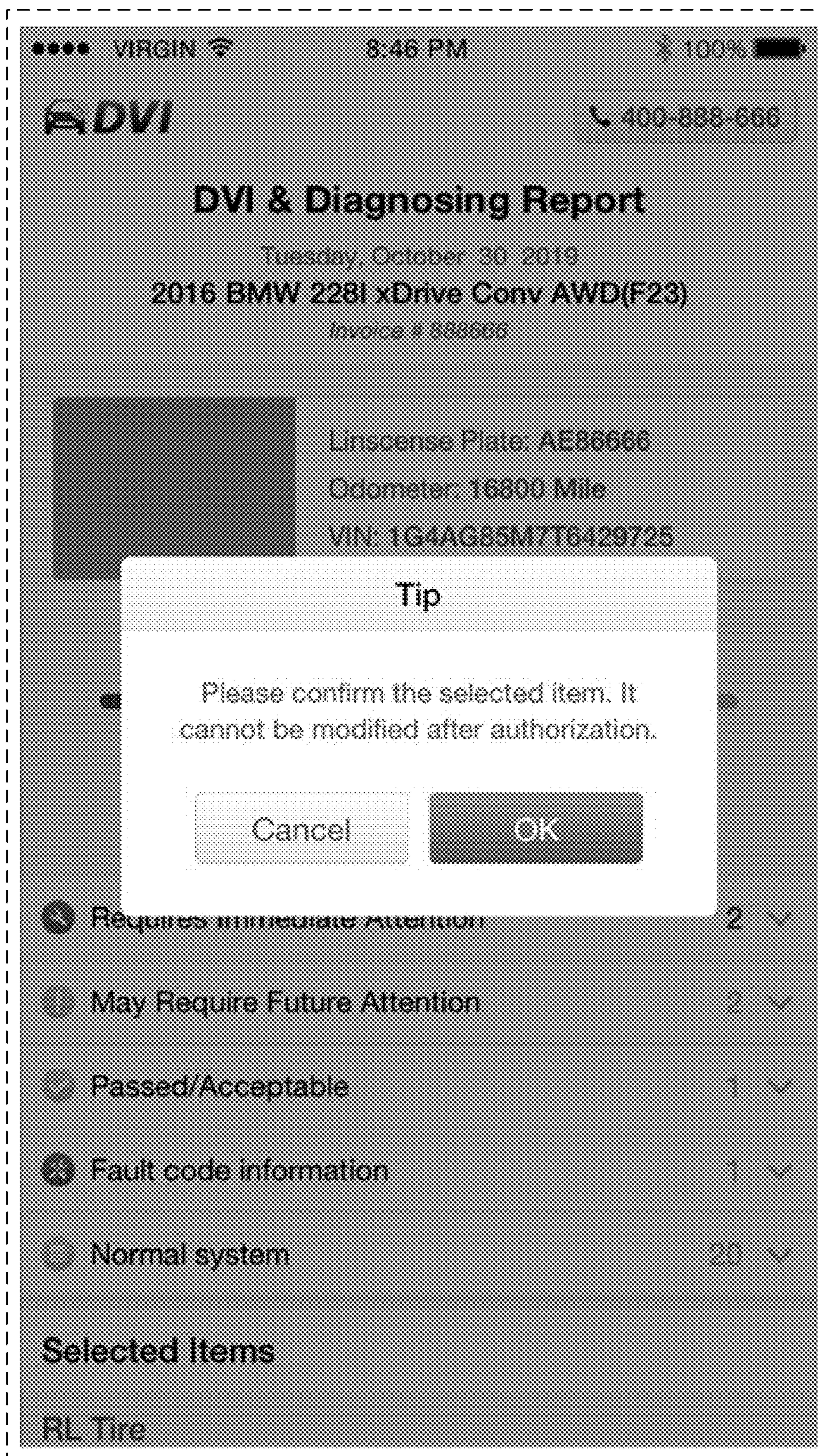

FIG.6