



US00D942978S

(12) **United States Design Patent**
Cruz

(10) **Patent No.:** **US D942,978 S**

(45) **Date of Patent:** **** Feb. 8, 2022**

(54) **EMV, NFC, MSR TABLET KIOSK ENCLOSURE**
(71) Applicant: **Spartadata LLC.**, Homestead, FL (US)
(72) Inventor: **Michael Cruz**, Homestead, FL (US)
(**) Term: **15 Years**

(21) Appl. No.: **29/716,708**
(22) Filed: **Dec. 11, 2019**
(51) **LOC (13) Cl.** **14-02**
(52) **U.S. Cl.**
USPC **D14/385**

(58) **Field of Classification Search**
USPC D18/4.4, 4.5, 4.6, 12, 12.1, 12.3;
D14/383, 384, 385, 386, 378, 420, 427,
D14/432-439, 447, 453; D13/107, 108,
D13/133, 146, 147, 152, 154, 156;
235/441, 451, 492, 380, 439, 375
CPC G06K 19/07749; G06K 19/0723; G06K
19/041; G06K 19/07758; G06K 19/0775;
G06K 19/07783; G06K 19/07794; G06K
19/06046; G06K 19/07722; G06K
19/07773; G06K 19/07779; G06K
19/07784; G06K 19/07786; G06K
19/0709

See application file for complete search history.

(56) **References Cited**

U.S. PATENT DOCUMENTS

D681,639 S * 5/2013 Cruz D14/385
D698,384 S * 1/2014 Cruz D18/4.4

D709,069 S * 7/2014 Cruz D14/385
D716,300 S * 10/2014 Cruz D14/385
D725,109 S * 3/2015 Azuma D14/385
D729,243 S * 5/2015 Toh D14/385
D729,244 S * 5/2015 Toh D14/385
D878,367 S * 3/2020 Rotsaert D14/385
D907,043 S * 1/2021 Turksu D14/434

* cited by examiner

Primary Examiner — Austin Murphy

(74) *Attorney, Agent, or Firm* — Albert Bordas, P.A.

(57) **CLAIM**

The ornamental design for an EMV, NFC, MSR tablet kiosk enclosure, as shown and described.

DESCRIPTION

FIG. 1 is a front isometric view of an EMV, NFC, MSR tablet kiosk enclosure;
FIG. 2 is a back isometric view thereof;
FIG. 3 is a front elevational view thereof;
FIG. 4 is a right-side elevational view thereof,
FIG. 5 left-side elevational view thereof;
FIG. 6 is a rear elevational view thereof;
FIG. 7 is a top plan view thereof; and,
FIG. 8 is a bottom plan view thereof.

The broken lines represent environmental structure and form no part of the claimed design.

1 Claim, 3 Drawing Sheets

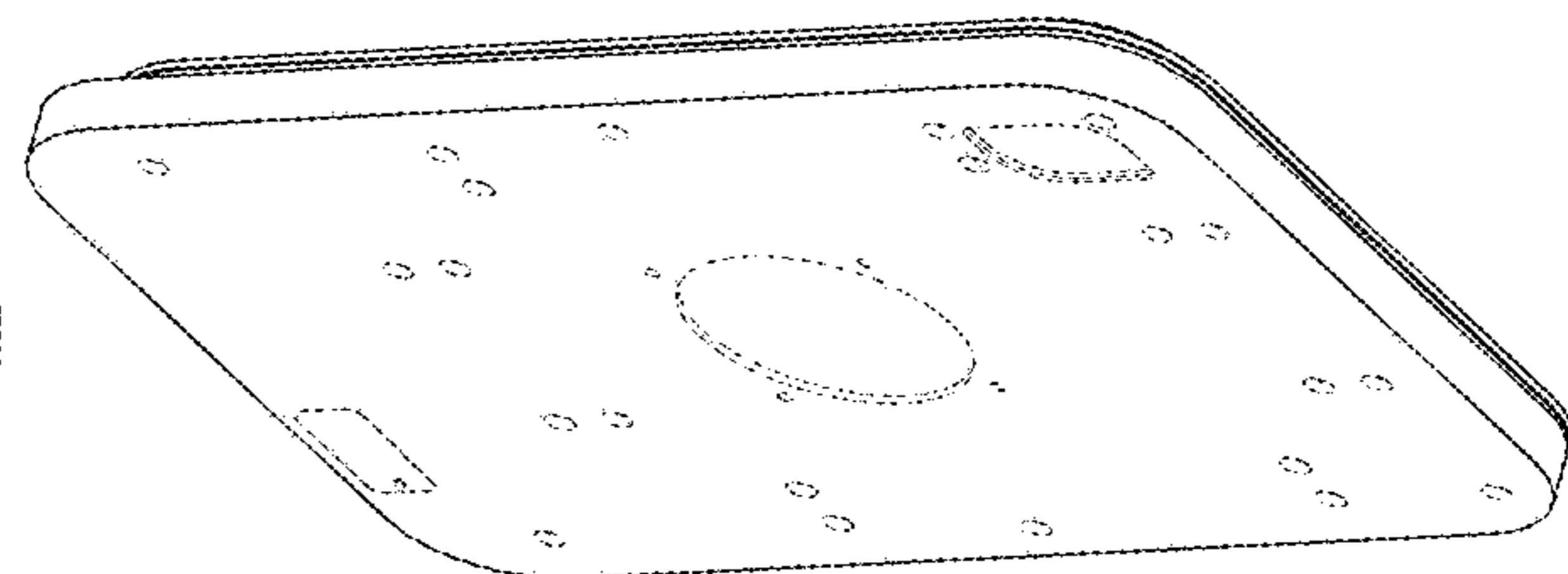
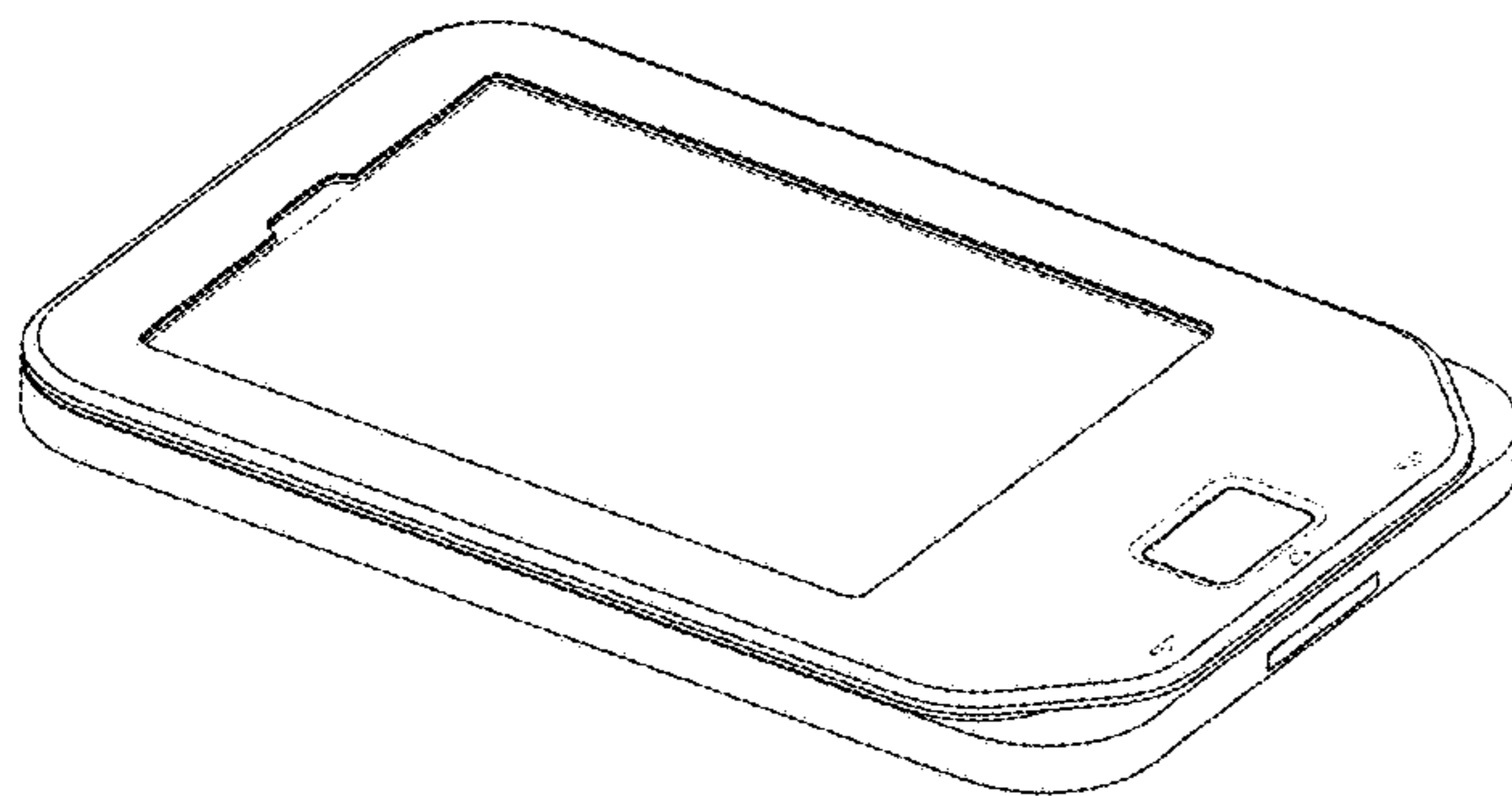

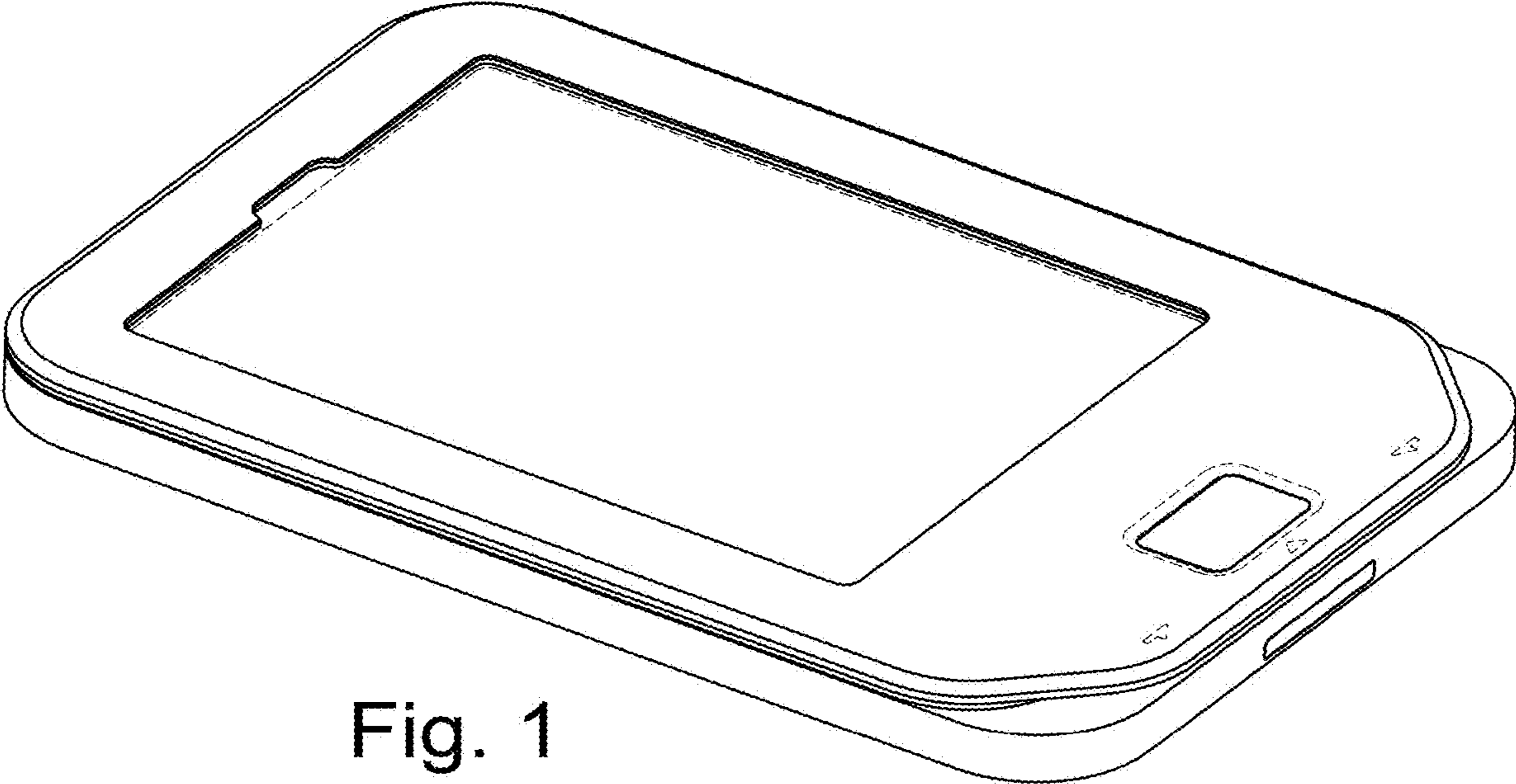

Fig. 1

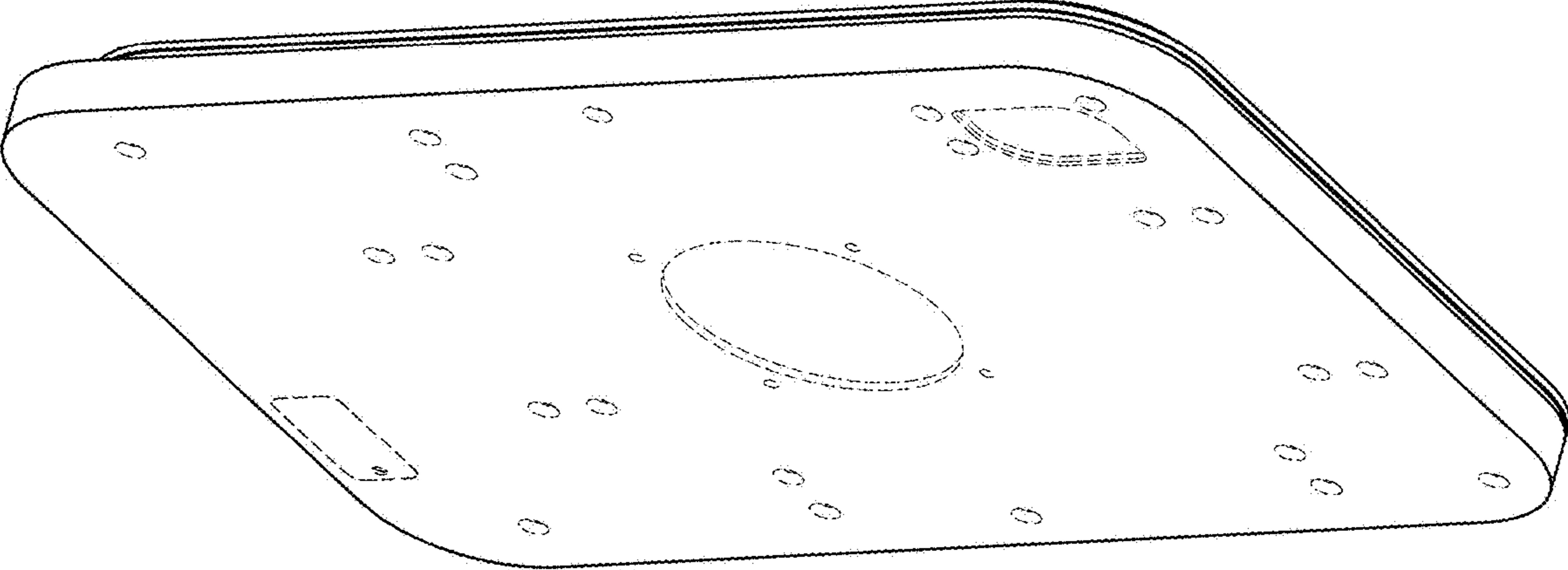

Fig. 2

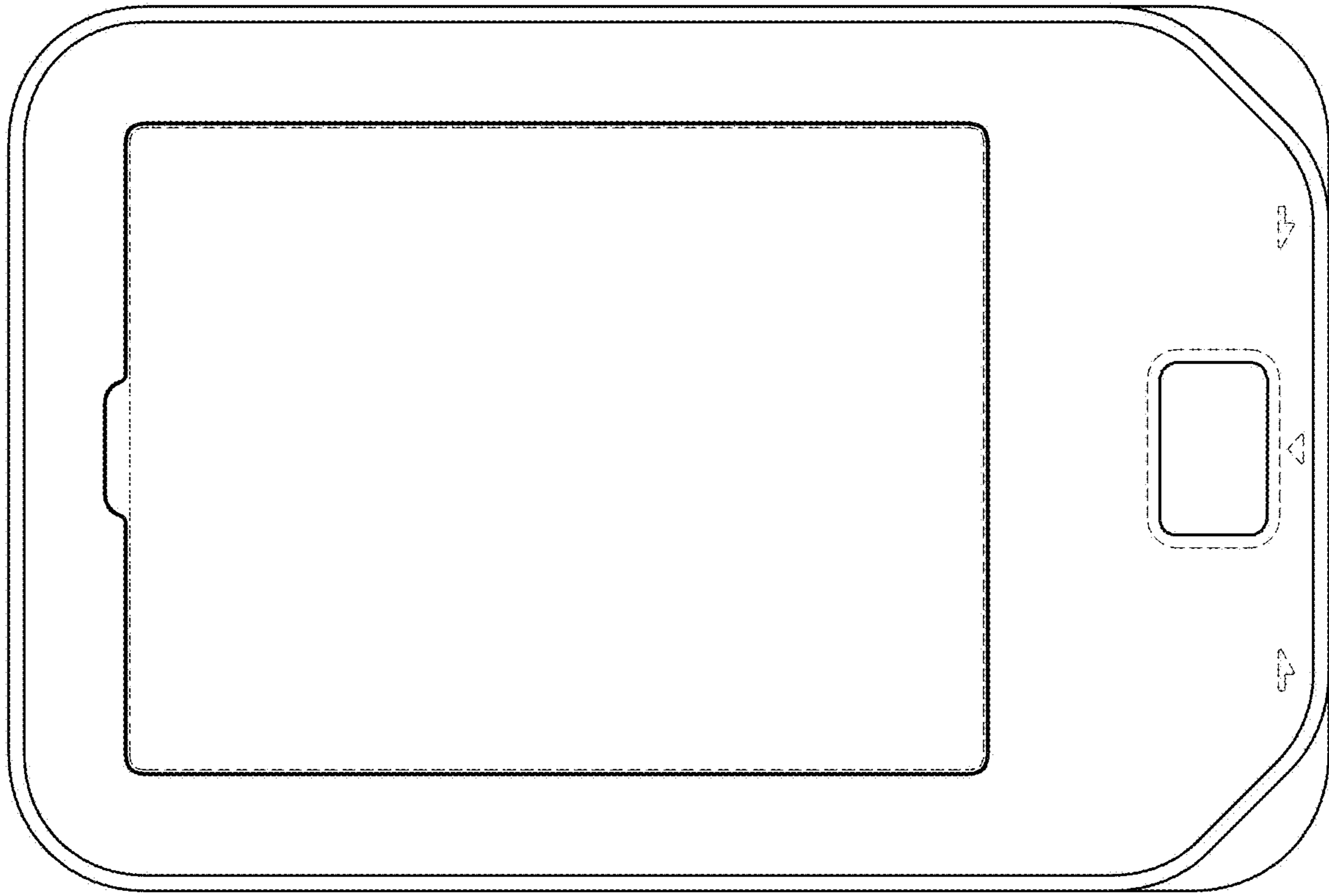

Fig. 3



Fig. 4

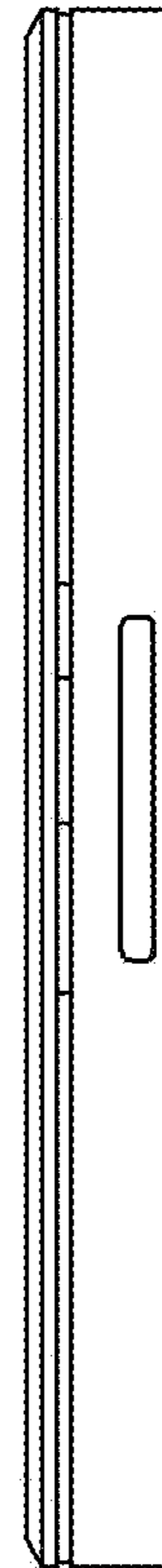

Fig. 5

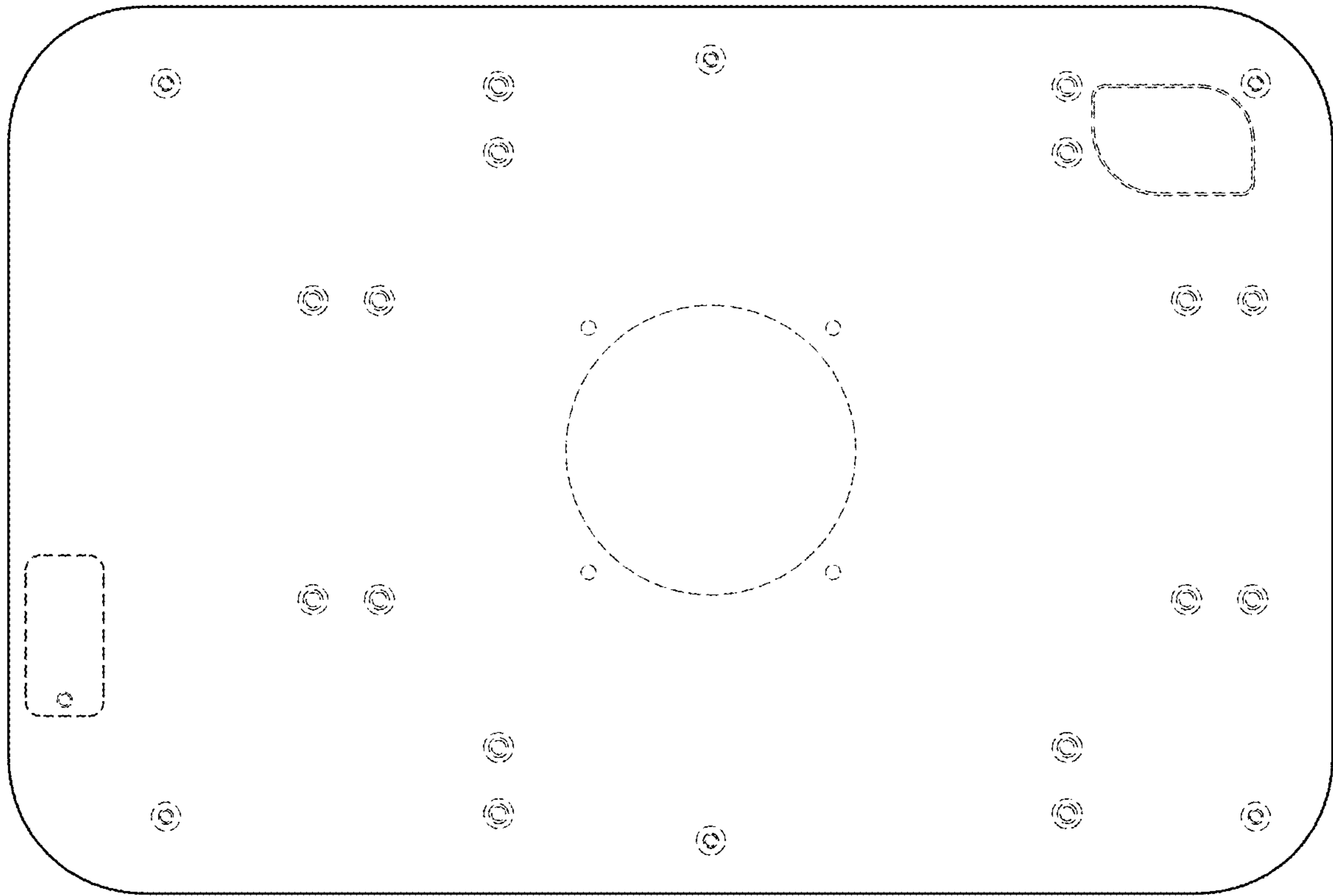

Fig. 6



Fig. 7

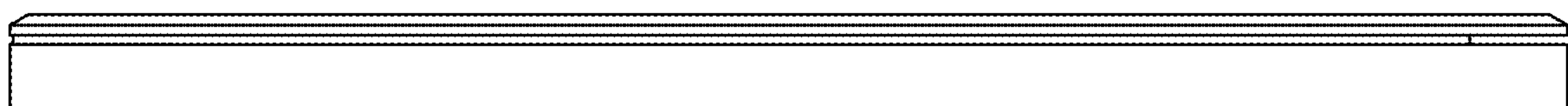

Fig. 8