



US00D941795S

(12) **United States Design Patent**
Keller

(10) **Patent No.:** **US D941,795 S**
(45) **Date of Patent:** **** Jan. 25, 2022**

(54) **PART OF DOOR PHONE**
(71) Applicant: **Bird Home Automation GmbH**, Berlin (DE)
(72) Inventor: **Sascha Keller**, Berlin (DE)
(**) Term: **15 Years**

D531,156 S * 10/2006 Ahn D14/138 C
D551,196 S * 9/2007 Hsiung D14/126
D578,993 S * 10/2008 Yamada D14/159
D579,913 S * 11/2008 Lamason D14/159
D597,062 S * 7/2009 Lando D14/159
D601,105 S * 9/2009 Morabito D14/129
D720,328 S * 12/2014 Shigeno D14/159
D740,782 S * 10/2015 Thomas D14/159
D823,277 S * 7/2018 Hagenauer D14/159

(21) Appl. No.: **35/509,240**

OTHER PUBLICATIONS

(22) Filed: **Aug. 9, 2019**

AVENT Video Baby Monitor by Philips, publication date Jun. 20, 2016, [online][site visited Mar. 5, 2021] URL: <https://www.youtube.com/watch?v=wtJmgZYj-dl> (Year: 2016).*
Teaser: Doorbird IP Video Indoor Station, publication date Jun. 26, 2019, [online][site visited Mar. 5, 2021] URL: <https://www.youtube.com/watch?v=RjThDDXF98w> (Year: 2019).*

(80) **Hague Agreement Data**

Int. Filing Date: **Aug. 9, 2019**
Int. Reg. No.: **DM/207539**
Int. Reg. Date: **Aug. 9, 2019**
Int. Reg. Pub. Date: **May 1, 2020**

* cited by examiner

(30) **Foreign Application Priority Data**

Primary Examiner — L. A. Grabenstetter
(74) *Attorney, Agent, or Firm* — Faegre Drinker Biddle & Reath LLP

Feb. 11, 2019 (EM) 006222014

(51) **LOC (13) Cl.** **14-03**

(52) **U.S. Cl.**
USPC **D14/159**

(57) **CLAIM**

(58) **Field of Classification Search**

USPC D14/126, 129, 138, 138 C, 138 AA,
D14/138 G, 154, 158, 203.1, 203.3,
D14/203.5, 203.7, 248, 341, 345, 496;
D21/329, 517
CPC . G06F 1/1626; H04M 1/0266; H04M 1/0202;
H04M 1/026

The ornamental design for a part of door phone, as shown and described.

See application file for complete search history.

DESCRIPTION

(56) **References Cited**

U.S. PATENT DOCUMENTS

D399,203 S * 10/1998 Renk, Jr. D14/159
D518,007 S * 3/2006 Peng D14/129
D529,017 S * 9/2006 Kim D14/138 G
D531,155 S * 10/2006 Ahn D14/138 C

- 1. Part of door phone
- 1.1 : Left Perspective
- 1.2 : Front
- 1.3 : Back
- 1.4 : Second Left Perspective
- 1.5 : Right
- 1.6 : Top

The broken lines, and regions surrounded on all sides by broken lines, depict portions of the part of door phone that form no part of the claimed design.

1 Claim, 6 Drawing Sheets

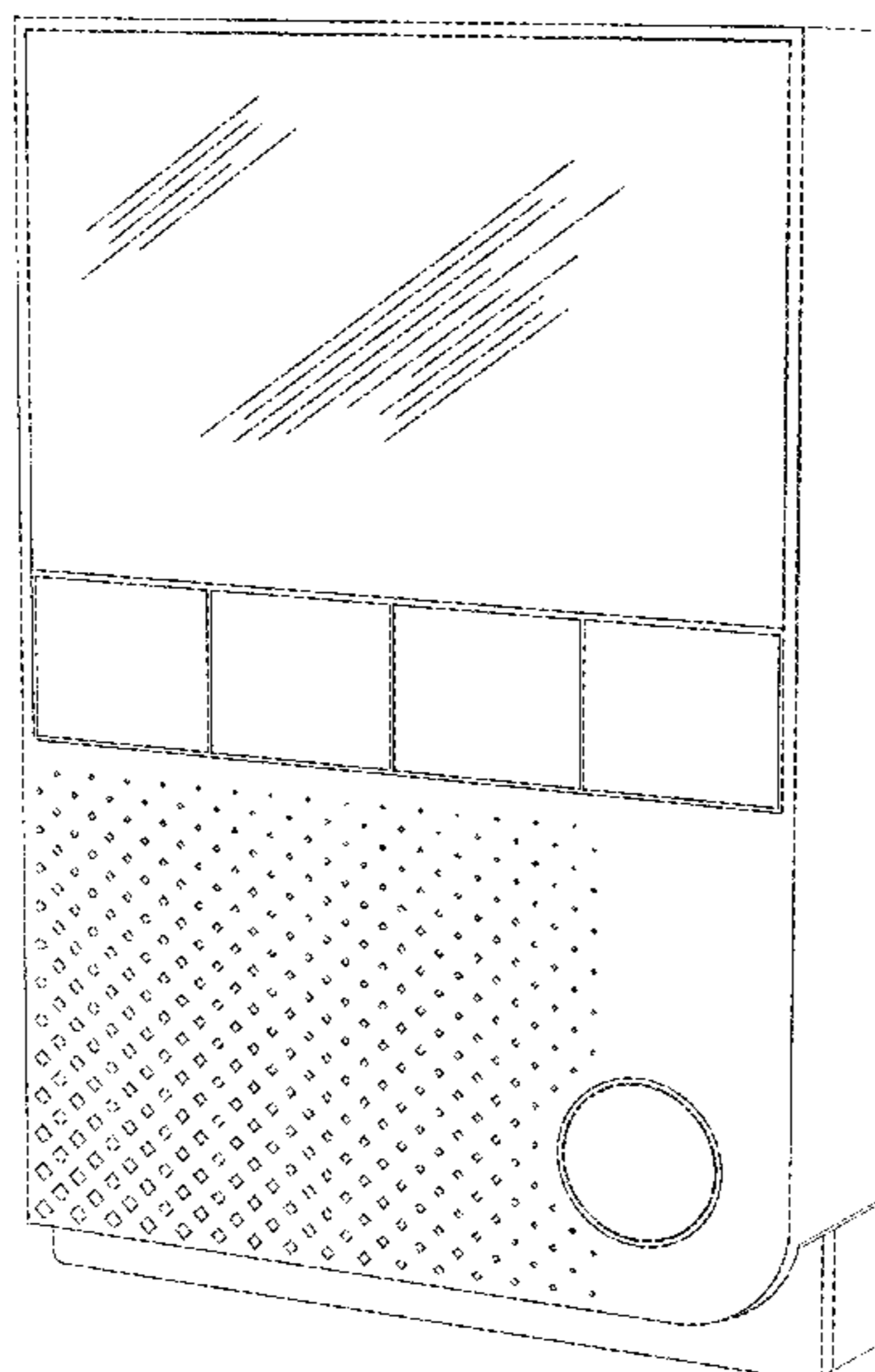

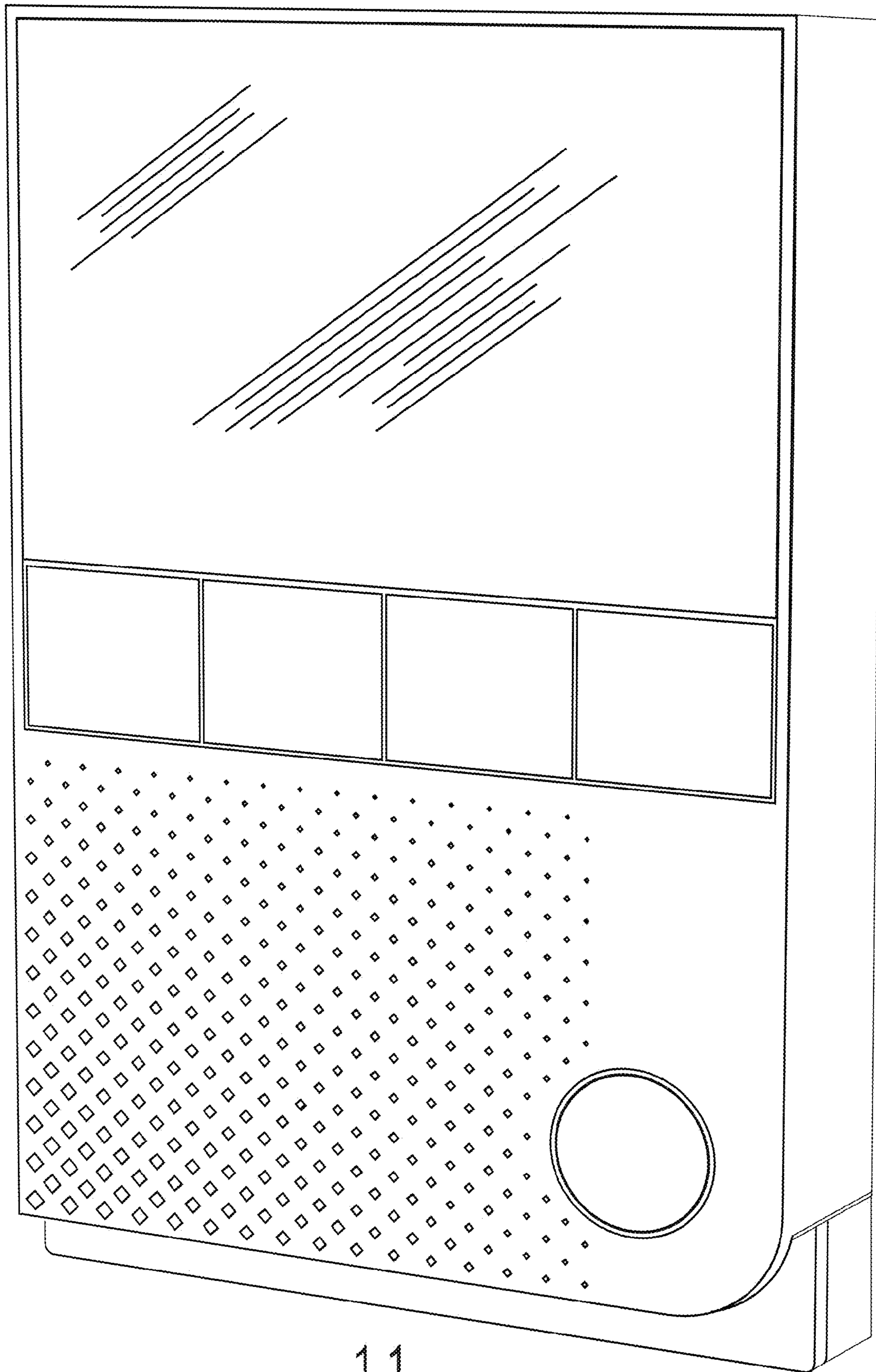

1.1

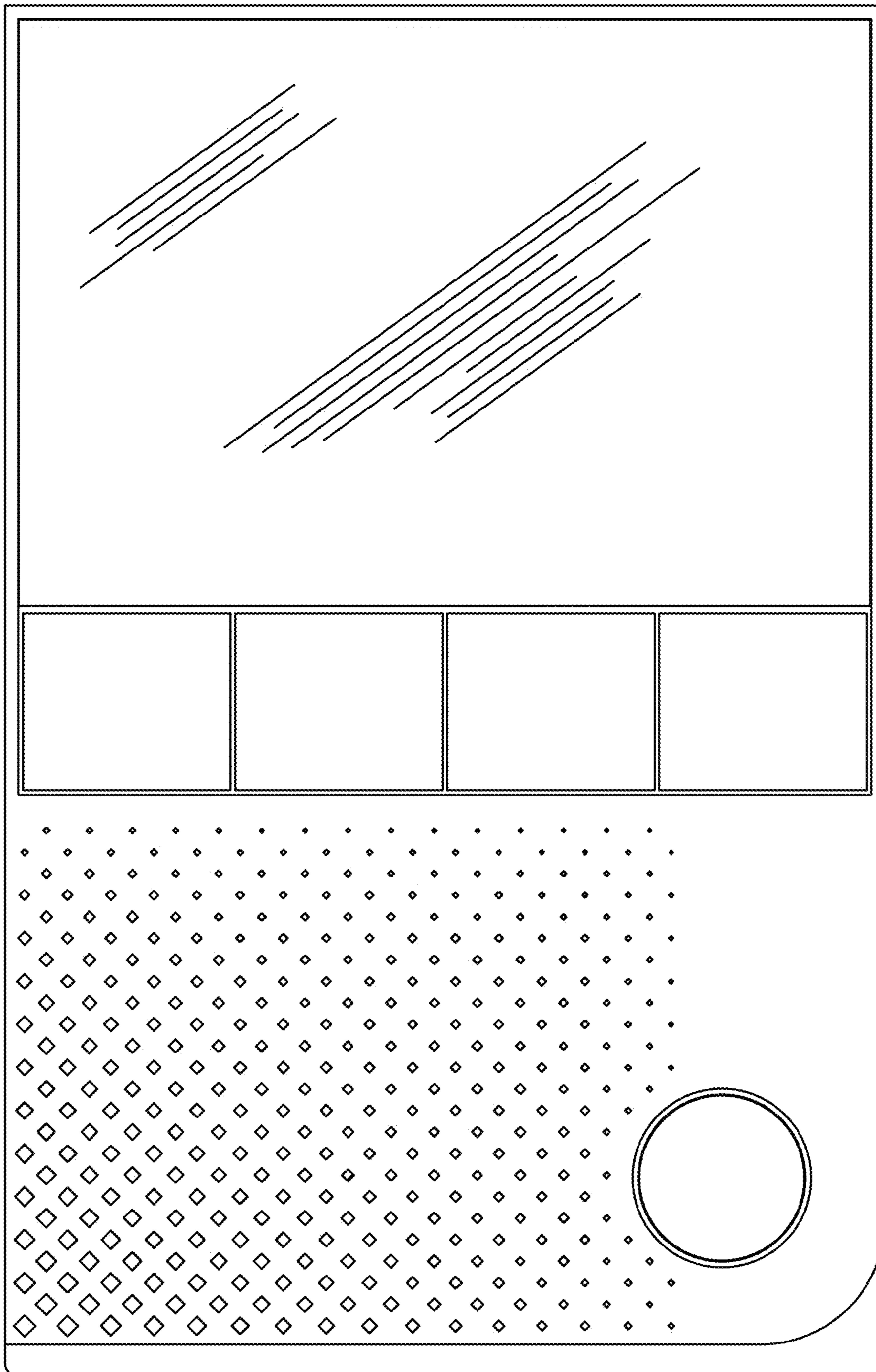

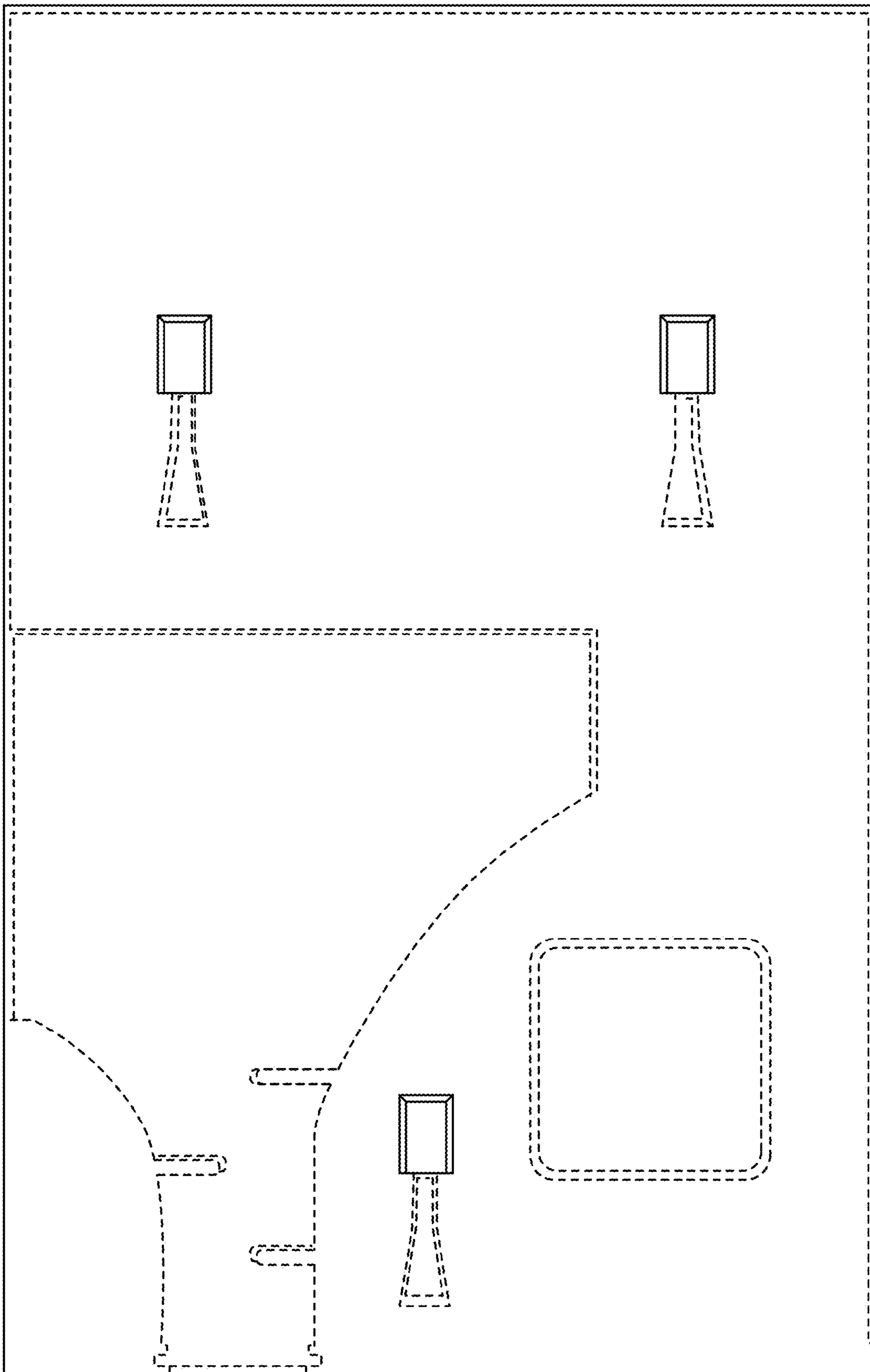

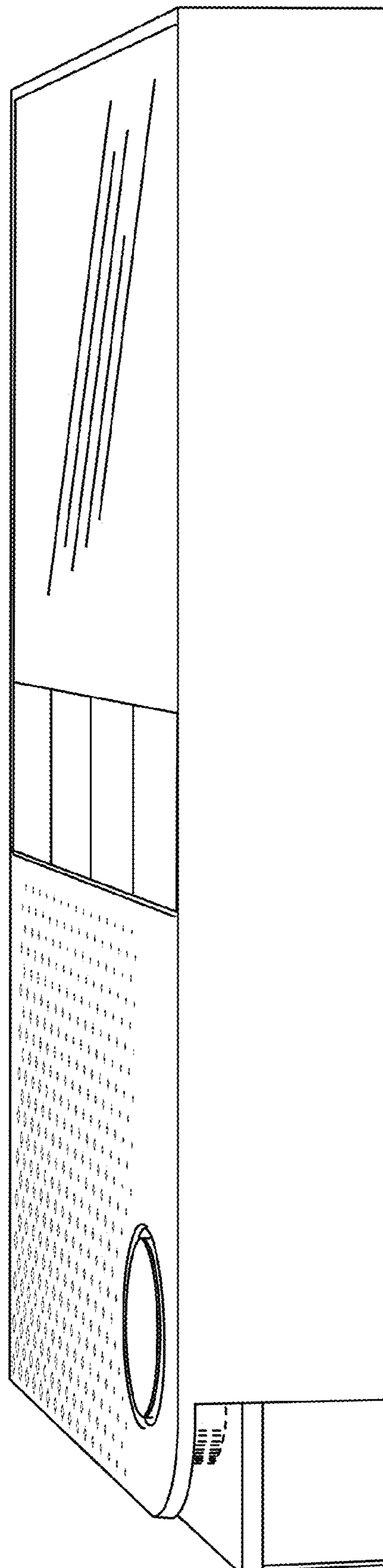

1.4

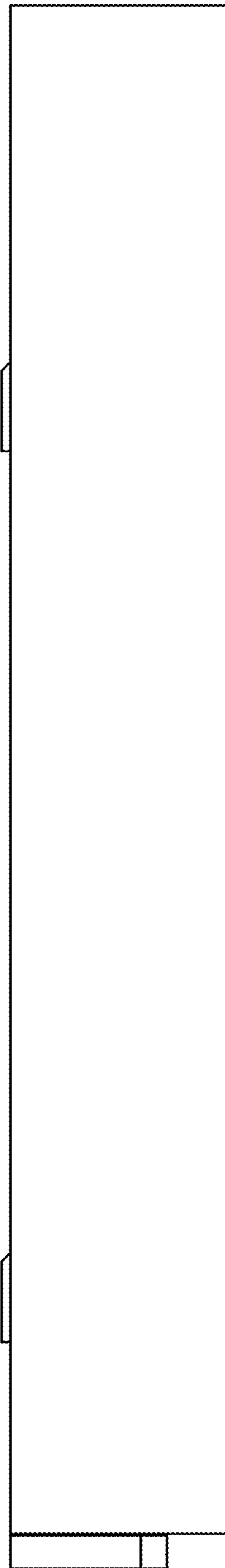

1.5

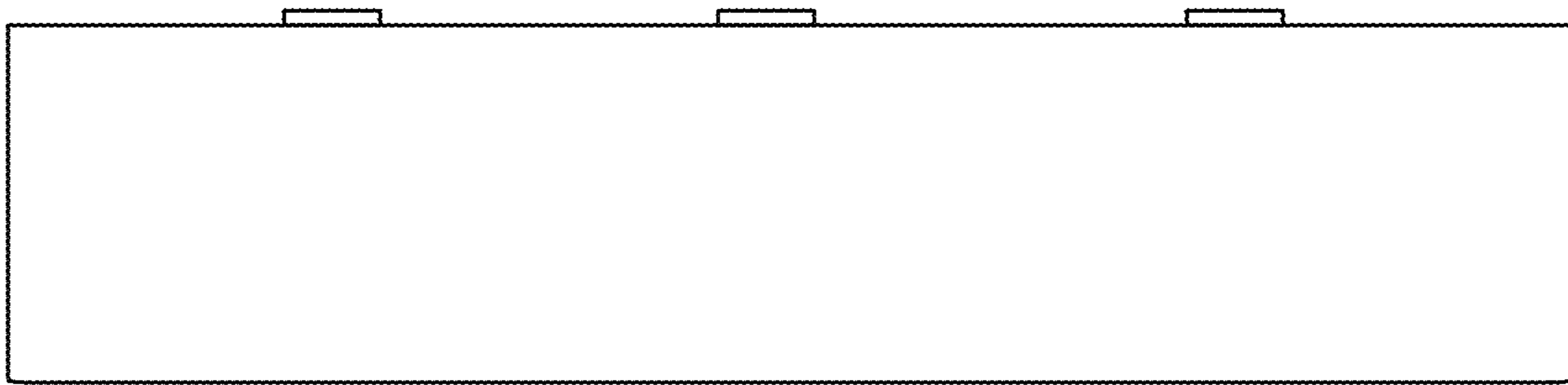

1.6