



US00D939272S

(12) **United States Design Patent** (10) **Patent No.:** **US D939,272 S**
Benoit et al. (45) **Date of Patent:** **** Dec. 28, 2021**

(54) **FOOD PROCESSING ATTACHMENT**

2013/145; B02C 2013/18; B02C 2013/1807; B02C 2013/1857; B02C 2013/1864; B30B 9/00; B30B 9/16; B30B 9/18; B30B 9/20; B30B (Continued)

(71) Applicant: **WHIRLPOOL CORPORATION**,
Benton Harbor, MI (US)

(72) Inventors: **Kaitlyn M. Benoit**, St. Joseph, MI (US); **Michael P. Conti**, St. Joseph, MI (US); **John Dykhouse**, Benton Harbor, MI (US); **Timothy J. Hicks**, Berrien Springs, MI (US); **Mitchell L. Robertson**, Elkhart, IN (US)

(56) **References Cited**

U.S. PATENT DOCUMENTS

62,184 A 2/1867 Coe
100,280 A 3/1870 Gerhard
RE9,774 E 6/1881 Whittemore
(Continued)

(73) Assignee: **Whirlpool Corporation**, Benton Harbor, MI (US)

FOREIGN PATENT DOCUMENTS

CN 2536142 Y 2/2003
DE 971304 C 1/1959
EP 2777447 A1 9/2014

(**) Term: **15 Years**

Primary Examiner — Ricky Pham

(21) Appl. No.: **29/732,296**

(74) *Attorney, Agent, or Firm* — Price Heneveld LLP

(22) Filed: **Apr. 23, 2020**

Related U.S. Application Data

(63) Continuation of application No. 14/983,735, filed on Dec. 30, 2015, now Pat. No. 10,820,735.

(51) **LOC (13) Cl.** **31-00**

(52) **U.S. Cl.**
USPC **D7/401.2; D7/381; D7/384**

(58) **Field of Classification Search**
USPC D7/372, 376–386, 401.2, 412, 665–666, D7/669, 678–679, 693–694
CPC A01F 2015/07; A01F 2015/077; A01F 2015/0775; A23N 1/00; A23N 1/02; A47J 19/00; A47J 19/005; A47J 19/02; A47J 19/025; A47J 19/04; A47J 19/06; A47J 42/32; A47J 42/34; A47J 42/36; A47J 43/044; A47J 43/25; A47J 43/255; B01F 7/26; B01F 7/28; B01F 11/0082; B01F 13/04; B02C 13/00; B02C 13/02; B02C 13/10; B02C 18/06; B02C 18/26; B02C 18/2291; B02C 18/30; B02C 18/301; B02C 18/302; B02C 18/304; B02C 18/305; B02C 25/00; B02C 2002/00; B02C 2013/00; B02C 2013/14; B02C

(57) **CLAIM**

The ornamental design for a food processing attachment, as shown and described.

DESCRIPTION

FIG. 1 is a front-right perspective view of a food processing attachment according to the design;
FIG. 2 is a back-right perspective view thereof;
FIG. 3 is a front-right perspective view thereof showing the food processing attachment mounted with an environmental food processing device; and,
FIG. 4 is a back-right perspective view thereof showing the food processing attachment mounted with the environmental food processing device.
The portions of the article shown in even broken line form no part of the claimed design.
Dash-dot-dash broken lines are environmental only and form no part of the claimed design.

1 Claim, 3 Drawing Sheets

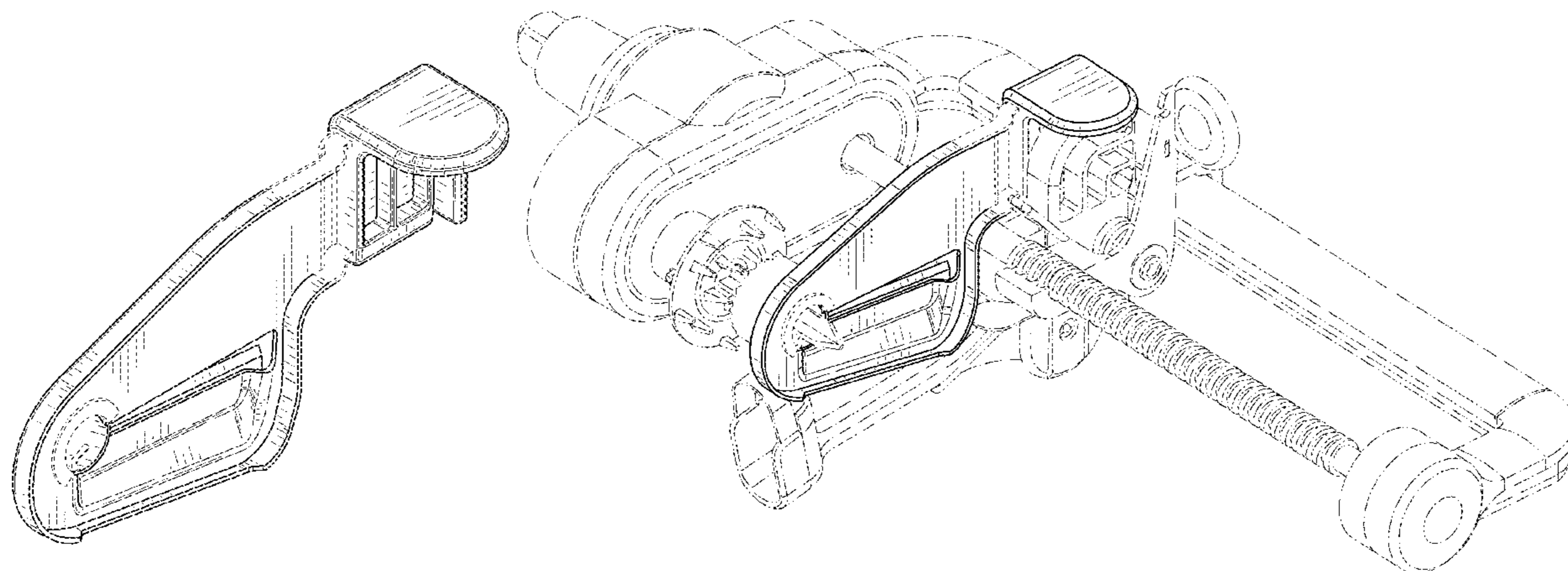

(58) **Field of Classification Search**
 CPC .. 9/26; B30B 9/205; B30B 9/207; B26D 3/11
 See application file for complete search history.

(56) **References Cited**

U.S. PATENT DOCUMENTS

243,035	A	6/1881	Geer	
256,214	A	4/1882	Heizmann	
256,800	A	4/1882	Holton	
273,418	A	3/1883	Whittemore	
310,196	A *	1/1885	Goodell	A47J 17/16 99/598
1,006,621	A	10/1911	Arnold	
1,008,555	A *	11/1911	Mower	A47J 17/16 99/598
1,256,751	A *	2/1918	Wenzel	A47J 17/16 99/598
2,056,843	A *	10/1936	Erro	A47J 17/04 99/595
2,069,654	A	2/1937	Jeppsson et al.	
2,130,980	A	9/1938	Chattin et al.	
2,156,645	A	5/1939	Waller	
2,410,683	A	11/1946	Rios Y Marquez	
2,461,249	A	2/1949	Anderson	
2,464,993	A	3/1949	Ross	
2,508,868	A	5/1950	Ross	
2,693,210	A	11/1954	Gustafson	
2,931,404	A	4/1960	Gildo	
3,211,202	A	10/1965	Mason	
3,357,469	A	12/1967	Pease et al.	
3,374,818	A	3/1968	Knoedler	
RE26,684	E	10/1969	Mason	
3,881,406	A	5/1975	Perez	
3,952,621	A	4/1976	Chambos	

4,137,839	A	2/1979	Couture et al.	
4,287,820	A	9/1981	Urban	
4,581,990	A	4/1986	Matsumoto	
4,619,192	A	10/1986	Cyzyk et al.	
4,628,808	A	12/1986	Simon	
4,704,959	A	11/1987	Scallen	
4,741,265	A	5/1988	Cushman	
4,753,159	A	6/1988	Eaton	
4,765,234	A	8/1988	Cailliot	
5,138,940	A	8/1992	Geissler et al.	
5,558,011	A	9/1996	Heim	
5,690,022	A	11/1997	Chai	
RE36,155	E	3/1999	Scallen	
5,878,643	A *	3/1999	Hwang	B26D 3/11 83/781
5,950,528	A	9/1999	Wang	
5,957,045	A	9/1999	He et al.	
6,053,098	A	4/2000	Yamamoto	
6,082,253	A	7/2000	Ridler	
6,125,744	A	10/2000	Martin	
6,269,740	B2	8/2001	Kojs	
6,327,971	B1	12/2001	Ridler	
6,408,520	B1	6/2002	Ridler	
6,412,177	B1	7/2002	Ridler	
6,523,464	B1	2/2003	Widelo	
6,854,383	B2 *	2/2005	Wang	A47J 17/16 99/542
D669,324	S *	10/2012	Bodum	D7/693
D773,894	S	12/2016	Benoit et al.	
D874,219	S *	2/2020	McConnell	D7/401.2
D901,242	S *	11/2020	McConnell	D7/401.2
D901,970	S *	11/2020	Benoit	D7/401.2
D909,130	S *	2/2021	McConnell	D7/401.2
D911,097	S *	2/2021	Chen	D7/384
D919,365	S *	5/2021	Benoit	D7/412
2016/0255982	A1	9/2016	Benoit	

* cited by examiner

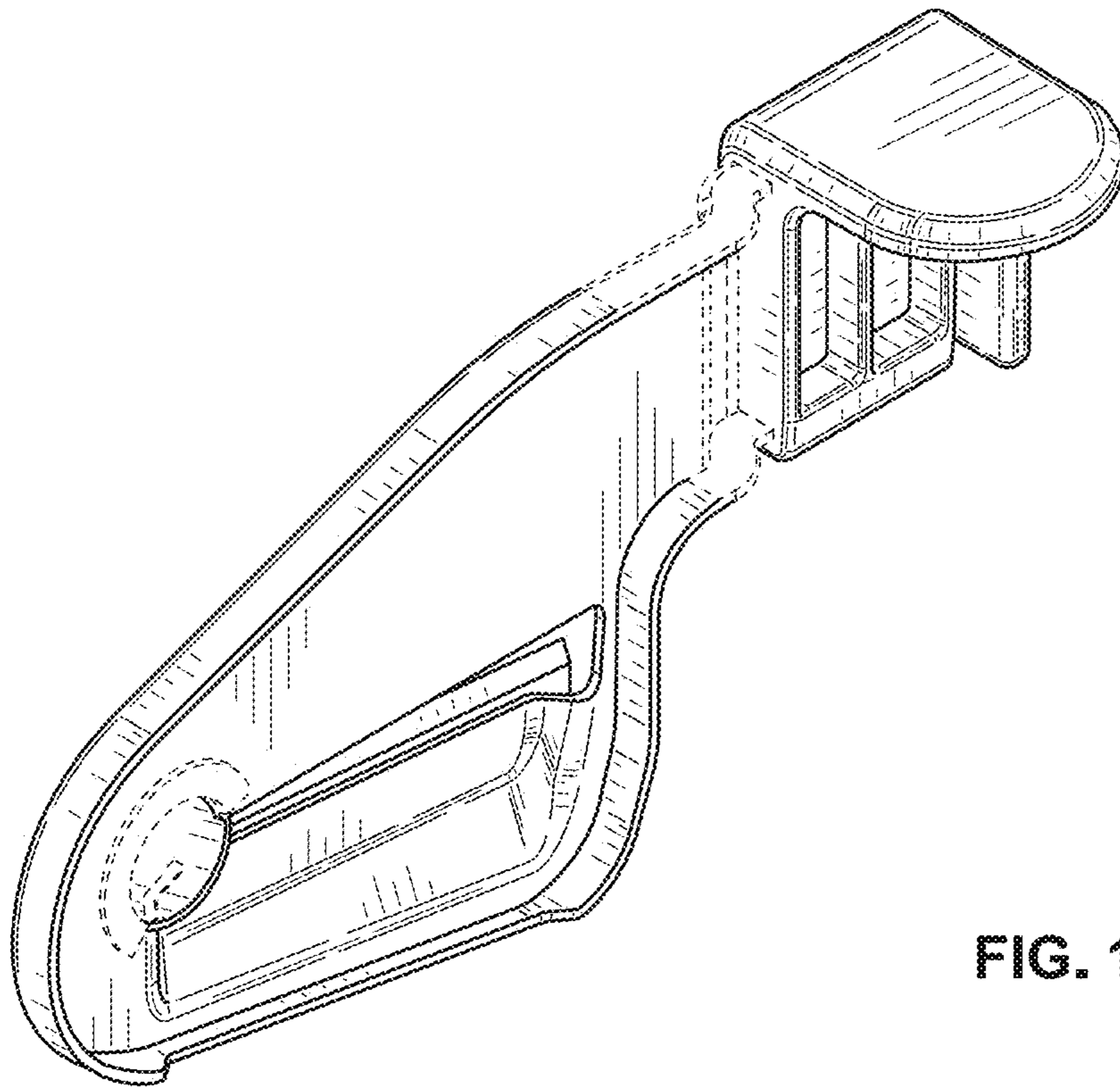

FIG. 1

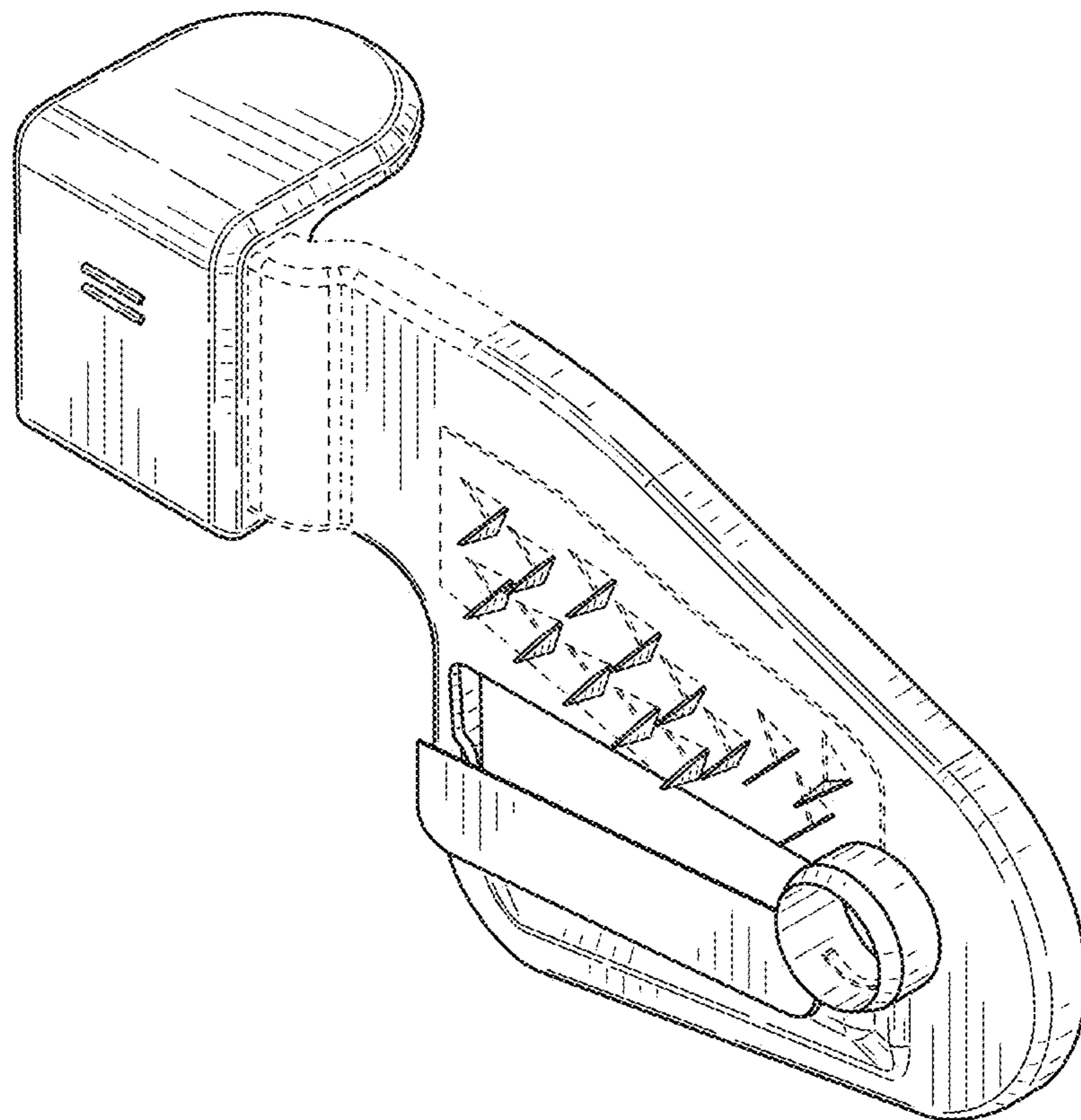

FIG. 2

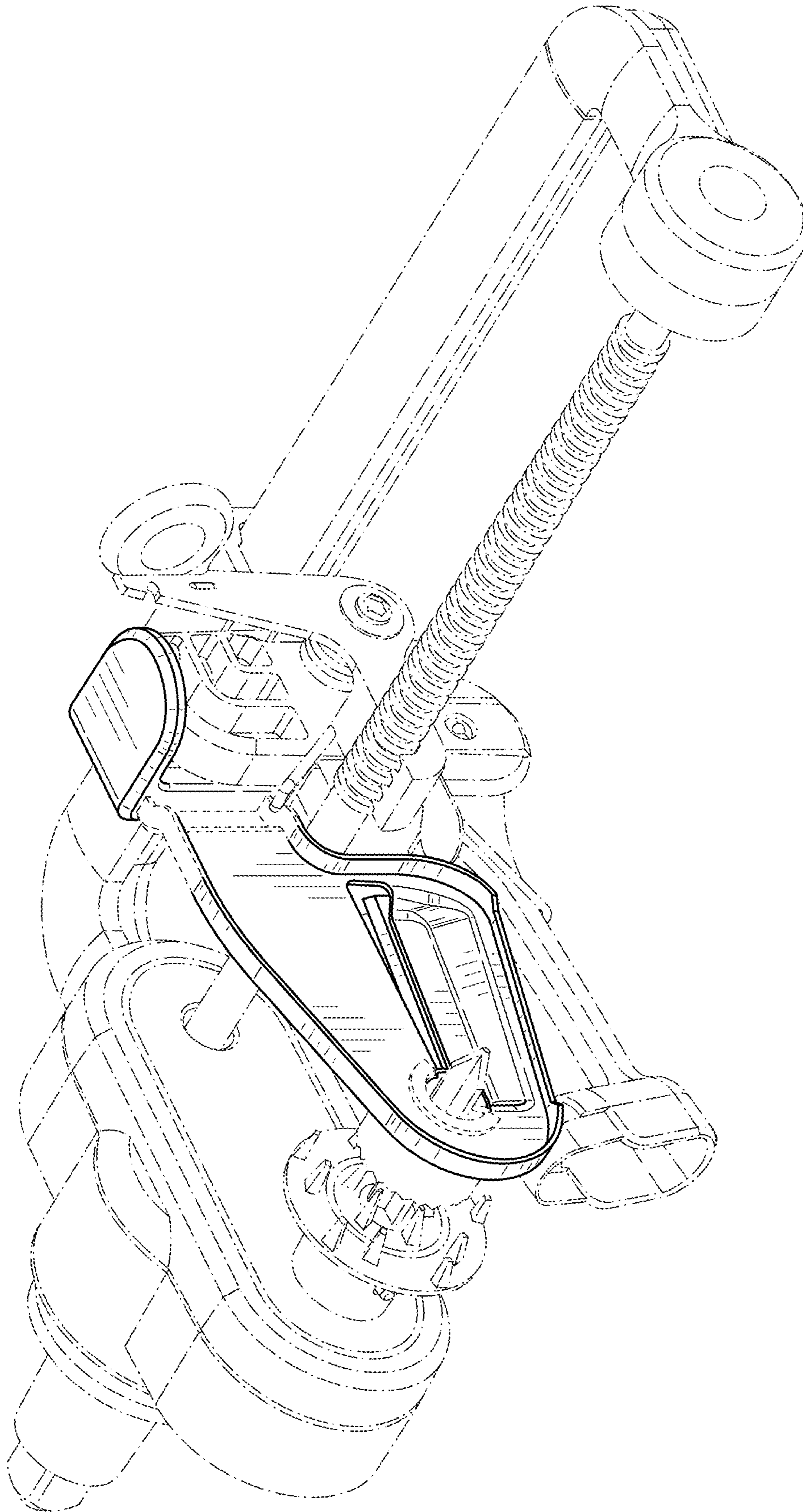

FIG. 3

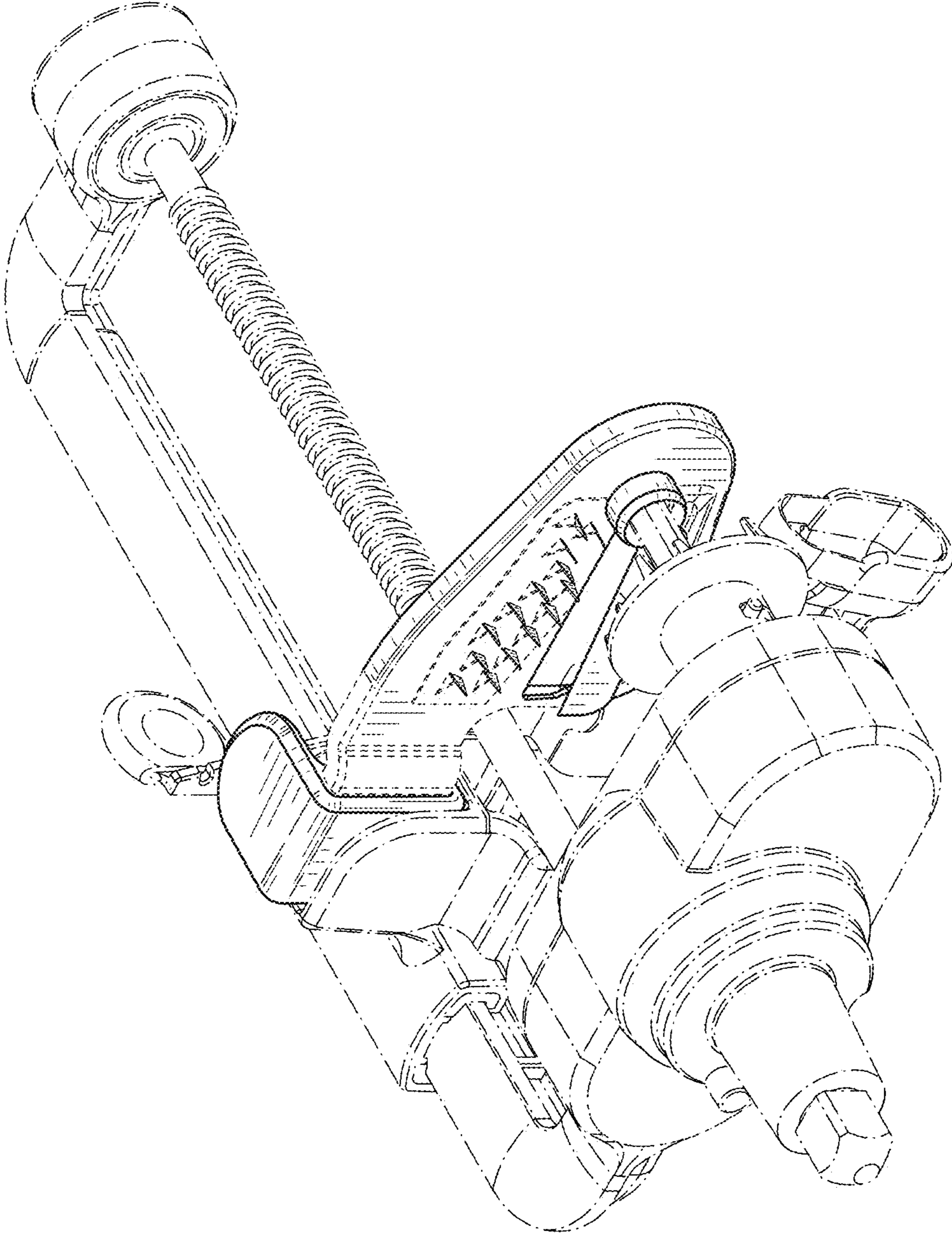

FIG. 4