



US00D938984S

(12) **United States Design Patent**
Grubbs et al.

(10) **Patent No.:** **US D938,984 S**
(45) **Date of Patent:** **** Dec. 21, 2021**

- (54) **DISPLAY SCREEN OR PORTION THEREOF WITH GRAPHICAL USER INTERFACE SET**
- (71) Applicant: **GEN-PROBE INCORPORATED**, San Diego, CA (US)
- (72) Inventors: **Steven G. Grubbs**, San Diego, CA (US); **Trung Pham**, Chula Vista, CA (US); **Jerry W. Jeffers, II**, San Diego, CA (US)
- (73) Assignee: **GEN-PROBE INCORPORATED**, San Diego, CA (US)
- (**) Term: **15 Years**
- (21) Appl. No.: **29/650,426**
- (22) Filed: **Jun. 6, 2018**

Related U.S. Application Data

- (63) Continuation of application No. 29/610,185, filed on Jul. 10, 2017, now Pat. No. Des. 824,410.
- (51) **LOC (13) Cl.** **14-04**
- (52) **U.S. Cl.**
USPC **D14/487**
- (58) **Field of Classification Search**
USPC D14/485–495
CPC G06F 3/048; G06F 3/0481; G06F 3/04812; G06F 3/04815; G06F 3/04817; G06F 3/0482; G06F 3/0483; G06F 3/0484; G06F 3/044; G06F 3/0417
See application file for complete search history.

References Cited

U.S. PATENT DOCUMENTS

| | | | | |
|--------------|---------|----------------|-------|---------|
| D649,557 S * | 11/2011 | Duchene | | D14/488 |
| D681,660 S * | 5/2013 | Matas | | D14/488 |
| D708,632 S * | 7/2014 | Baumann | | D14/488 |
| D720,767 S | 1/2015 | Miller et al. | | |
| 9,329,762 B1 | 5/2016 | Schultz et al. | | |

- D761,289 S 7/2016 Chen et al.
 - D761,290 S 7/2016 Chen et al.
 - 9,613,469 B2 4/2017 Fish et al.
 - D785,650 S 5/2017 Kagan et al.
 - D787,531 S 5/2017 Wada
- (Continued)

OTHER PUBLICATIONS

USPTO, Notice of Allowance, U.S. Appl. No. 29/610,185, filed Apr. 25, 2018.

Primary Examiner — Bao-Yen T Nguyen

(74) *Attorney, Agent, or Firm* — Sterne, Kessler, Goldstein & Fox P.L.L.C.; Charles B. Cappellari

(57) **CLAIM**

The ornamental design for a display screen or portion thereof with graphical user interface set, as shown and described.

DESCRIPTION

The file of this patent contains at least one drawing/photograph executed in color. Copies of this patent with color drawing(s)/photograph(s) will be provided by the Office upon request and payment of the necessary fee.

FIG. 1 is a front view of a display screen or portion thereof with graphical user interface set showing the claimed design; and,

FIG. 2 is another embodiment thereof.

The broken lines in the figures forming the outer rectangles show a display screen or portion thereof, and form no part of the claimed design. The other broken lines in the figures show portions of the graphical user interface set that form no part of the claimed design.

The graphical user interfaces of FIGS. 1 and 2 are arranged relatively on the drawing sheet for convenience of illustration, and the relative positioning forms no part of the claimed design.

1 Claim, 2 Drawing Sheets
(1 of 2 Drawing Sheet(s) Filed in Color)

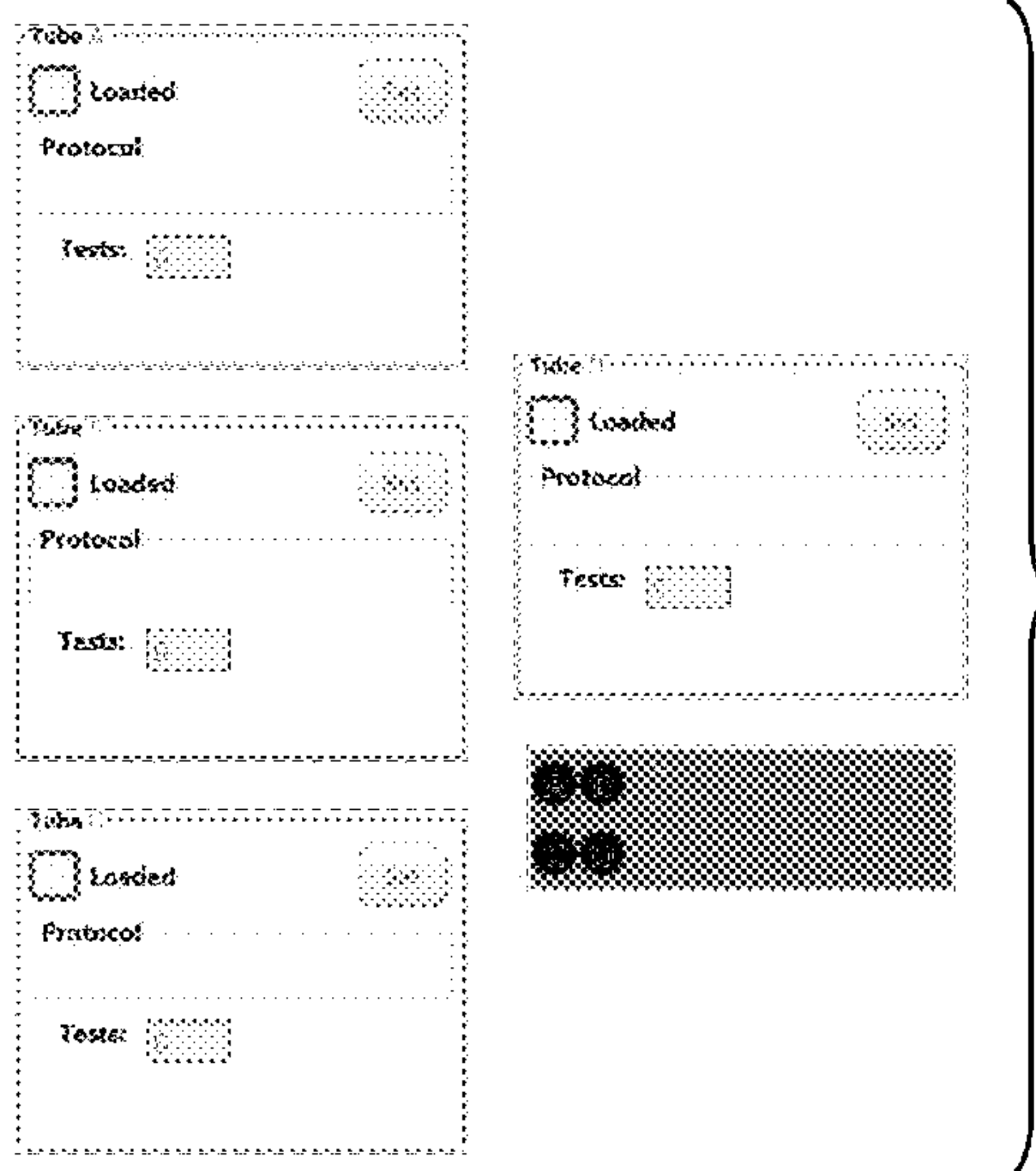

(56)

References Cited

U.S. PATENT DOCUMENTS

| | | | |
|-----------------|---------|------------------|---------|
| D788,128 S | 5/2017 | Wada | |
| D799,505 S | 10/2017 | Park et al. | |
| D800,755 S * | 10/2017 | De Cock | D14/486 |
| D807,379 S | 1/2018 | Pahwa et al. | |
| D808,979 S | 1/2018 | Hazam et al. | |
| D808,981 S | 1/2018 | Hazam et al. | |
| D809,528 S | 2/2018 | Hazam et al. | |
| D810,096 S | 2/2018 | Groszmann et al. | |
| D810,097 S | 2/2018 | Groszmann et al. | |
| D813,248 S | 3/2018 | Burton et al. | |
| D817,986 S * | 5/2018 | Iketsuki | D14/486 |
| D819,666 S * | 6/2018 | Porter | D14/486 |
| D822,696 S * | 7/2018 | Iketsuki | D14/486 |
| D824,408 S * | 7/2018 | Harvey | D14/486 |
| D824,410 S | 7/2018 | Grubbs et al. | |
| D836,120 S * | 12/2018 | Dudey | D14/486 |
| D841,682 S * | 2/2019 | Coffman | D14/487 |
| D841,683 S * | 2/2019 | Coffman | D14/487 |
| D842,329 S * | 3/2019 | Coffman | D14/487 |
| D848,472 S * | 5/2019 | Coffman | D14/487 |
| D849,034 S * | 5/2019 | Mokwunye | D14/486 |
| D849,045 S * | 5/2019 | Coffman | D14/487 |
| D849,780 S * | 5/2019 | Coffman | D14/487 |
| D854,573 S * | 7/2019 | Coffman | D14/487 |
| D854,574 S * | 7/2019 | Coffman | D14/487 |
| D854,575 S * | 7/2019 | Coffman | D14/487 |
| D854,576 S * | 7/2019 | Coffman | D14/487 |
| D862,507 S * | 10/2019 | Coffman | D14/487 |
| D862,508 S * | 10/2019 | Coffman | D14/487 |
| D863,330 S * | 10/2019 | Miller | D14/486 |
| D866,587 S * | 11/2019 | Iida | D14/486 |
| D867,387 S * | 11/2019 | Hehl | D14/486 |
| D870,760 S * | 12/2019 | Li | D14/486 |
| D871,438 S * | 12/2019 | Nakahara | D14/487 |
| D871,440 S * | 12/2019 | Coffman | D14/487 |
| D872,762 S * | 1/2020 | Coffman | D14/487 |
| D873,293 S * | 1/2020 | Coffman | D14/487 |
| D874,508 S * | 2/2020 | Coffman | D14/487 |
| D874,509 S * | 2/2020 | Coffman | D14/487 |
| D875,110 S * | 2/2020 | Spors | D14/485 |
| D875,127 S * | 2/2020 | Wong | D14/487 |
| D876,462 S * | 2/2020 | Li | D14/486 |
| D876,468 S * | 2/2020 | Tolentino | D14/486 |
| D877,183 S * | 3/2020 | Gaiser | D14/487 |
| D877,184 S * | 3/2020 | Coffman | D14/487 |
| 2007/0214415 A1 | 9/2007 | Williams | |
| 2014/0136407 A1 | 5/2014 | Hazam et al. | |

* cited by examiner

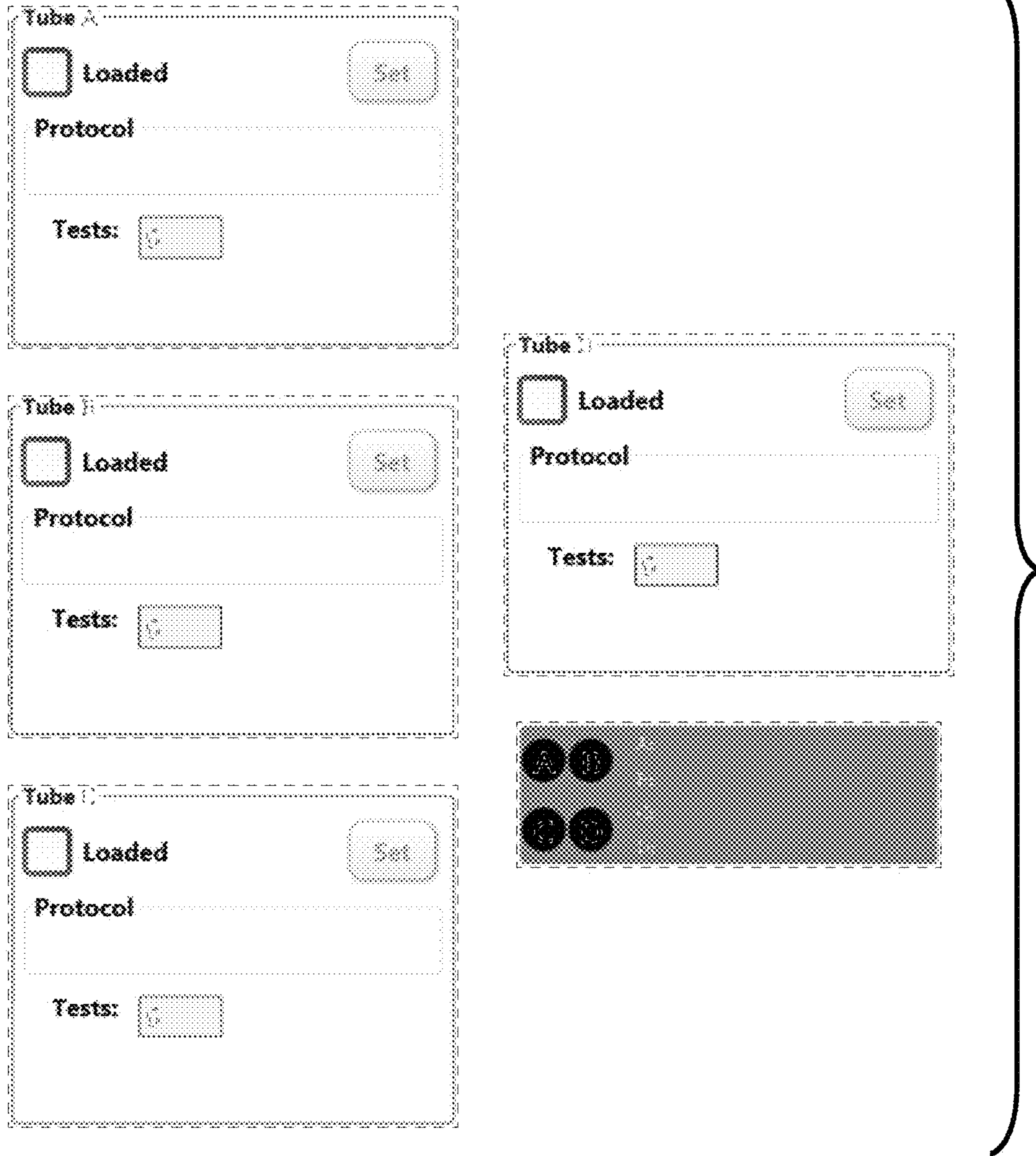

FIG. 1

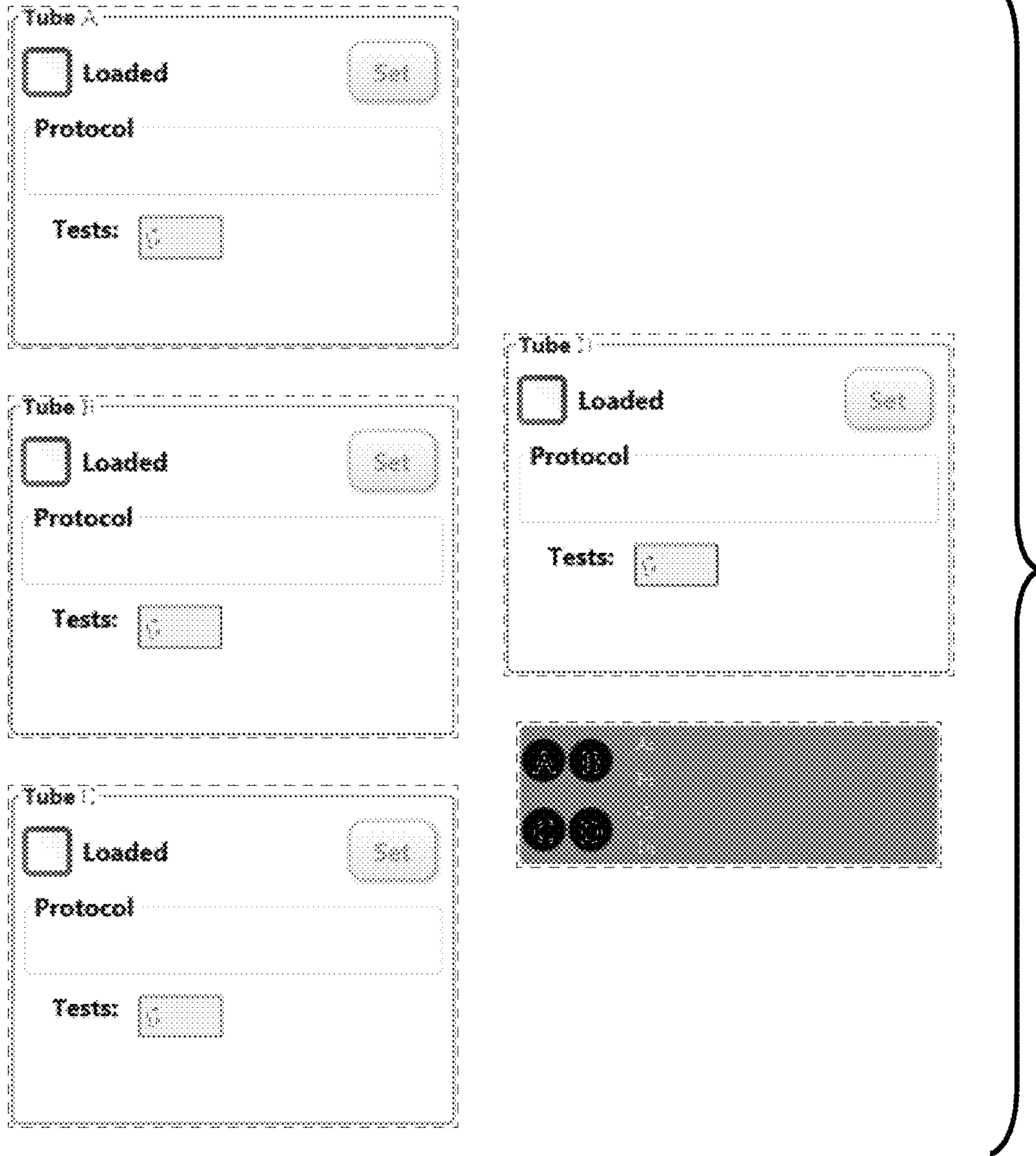

FIG. 2