



US00D938922S

(12) **United States Design Patent** (10) **Patent No.:** **US D938,922 S**
Banuls Tobaruela (45) **Date of Patent:** **** Dec. 21, 2021**

- (54) **CABLE DROP COMPONENT**
- (71) Applicant: **Basor Electric, Inc.**, Millstadt, IL (US)
- (72) Inventor: **Javier Banuls Tobaruela**, Gandia (ES)
- (73) Assignee: **Basor Electric, Inc.**, Millstadt, IL (US)
- (**) Term: **15 Years**
- (21) Appl. No.: **29/700,201**
- (22) Filed: **Jul. 31, 2019**
- (51) **LOC (13) Cl.** **13-03**
- (52) **U.S. Cl.**
USPC **D13/155**
- (58) **Field of Classification Search**
USPC D13/123, 133, 139.1, 139.2, 139.4, 152,
D13/154, 155, 156, 158, 184; D8/354
See application file for complete search history.

(56) **References Cited**

U.S. PATENT DOCUMENTS

- D320,782 S * 10/1991 Henneberger D13/155
- 5,161,580 A * 11/1992 Klug H02G 3/0418
138/157
- D348,651 S * 7/1994 Henneberger D13/155
- D354,734 S * 1/1995 Messelhi D13/156
- 5,469,893 A * 11/1995 Caveney H02G 3/0608
138/157
- 6,037,543 A * 3/2000 Nicoli H02G 3/0608
138/157
- D445,765 S * 7/2001 Wojcik D13/155
- D463,377 S * 9/2002 Canty D13/155
- D474,750 S * 5/2003 Dyer D13/155

- D479,707 S * 9/2003 Caswell D13/155
- 6,625,373 B1 * 9/2003 Wentworth G02B 6/4459
385/134
- 2002/0126977 A1 * 9/2002 Kampf G02B 6/4459
385/134

* cited by examiner

Primary Examiner — Jennifer O King

(74) *Attorney, Agent, or Firm* — Thedford I. Hitaffer;
Hitaffer & Hitaffer, PLLC

(57) **CLAIM**

The ornamental design for a cable drop component, as shown and described.

DESCRIPTION

FIG. 1 is a front perspective view of a cable drop component;
 FIG. 2 is a front elevational view thereof;
 FIG. 3 is a rear elevational view thereof;
 FIG. 4 is a top plan view thereof;
 FIG. 5 is a bottom plan view thereof;
 FIG. 6 is a right side view thereof; and,
 FIG. 7 is a left side view thereof
 FIG. 8 is a front perspective view of a second embodiment of a cable drop component;
 FIG. 10 is a rear elevational view thereof;
 FIG. 11 is a top plan view thereof;
 FIG. 12 is a bottom plan view thereof;
 FIG. 13 is a right side view thereof; and,
 FIG. 14 is a left side view thereof.
 The features shown in broken line throughout FIGS. 8-14 form no part of the claimed design.

1 Claim, 12 Drawing Sheets

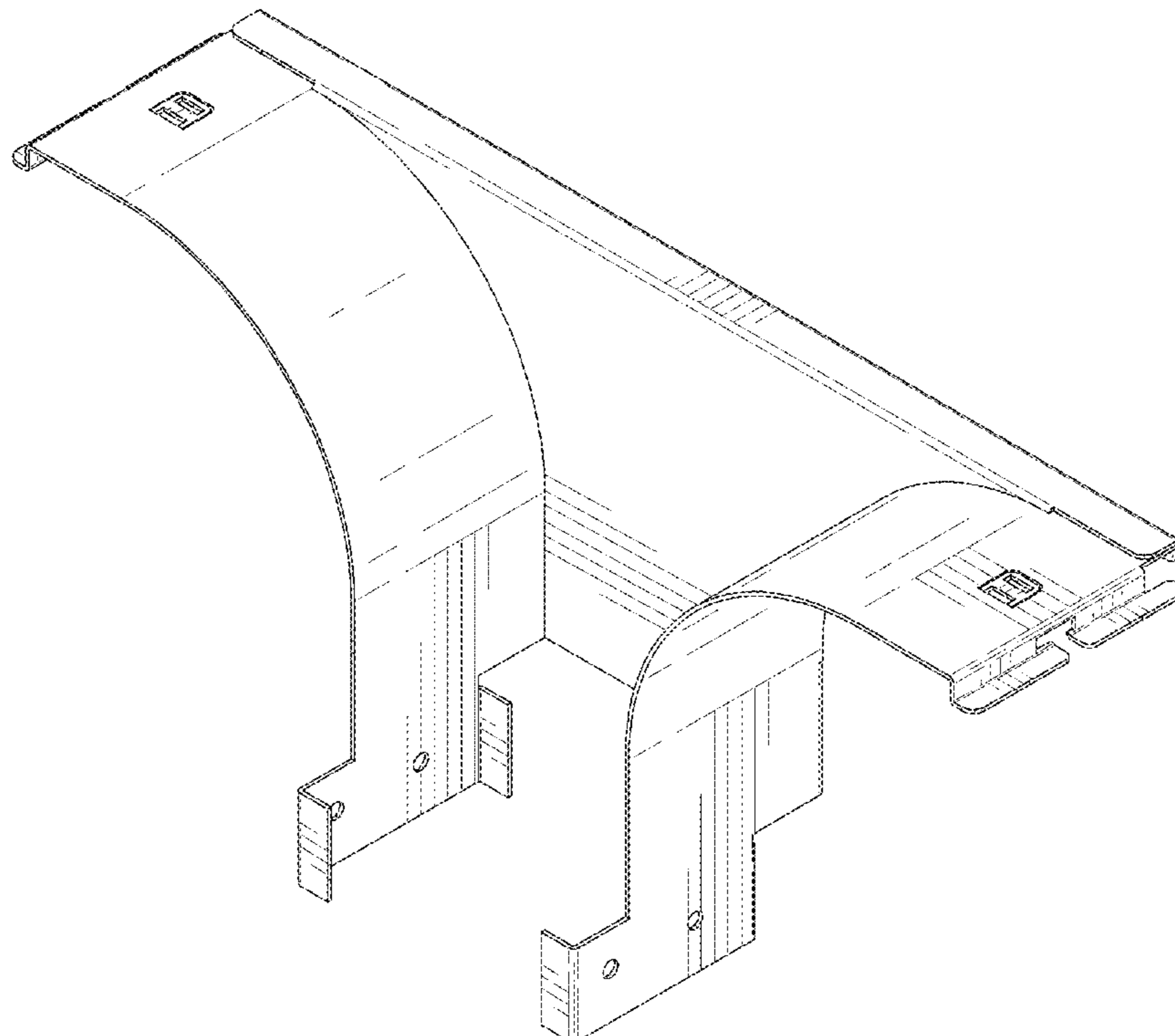

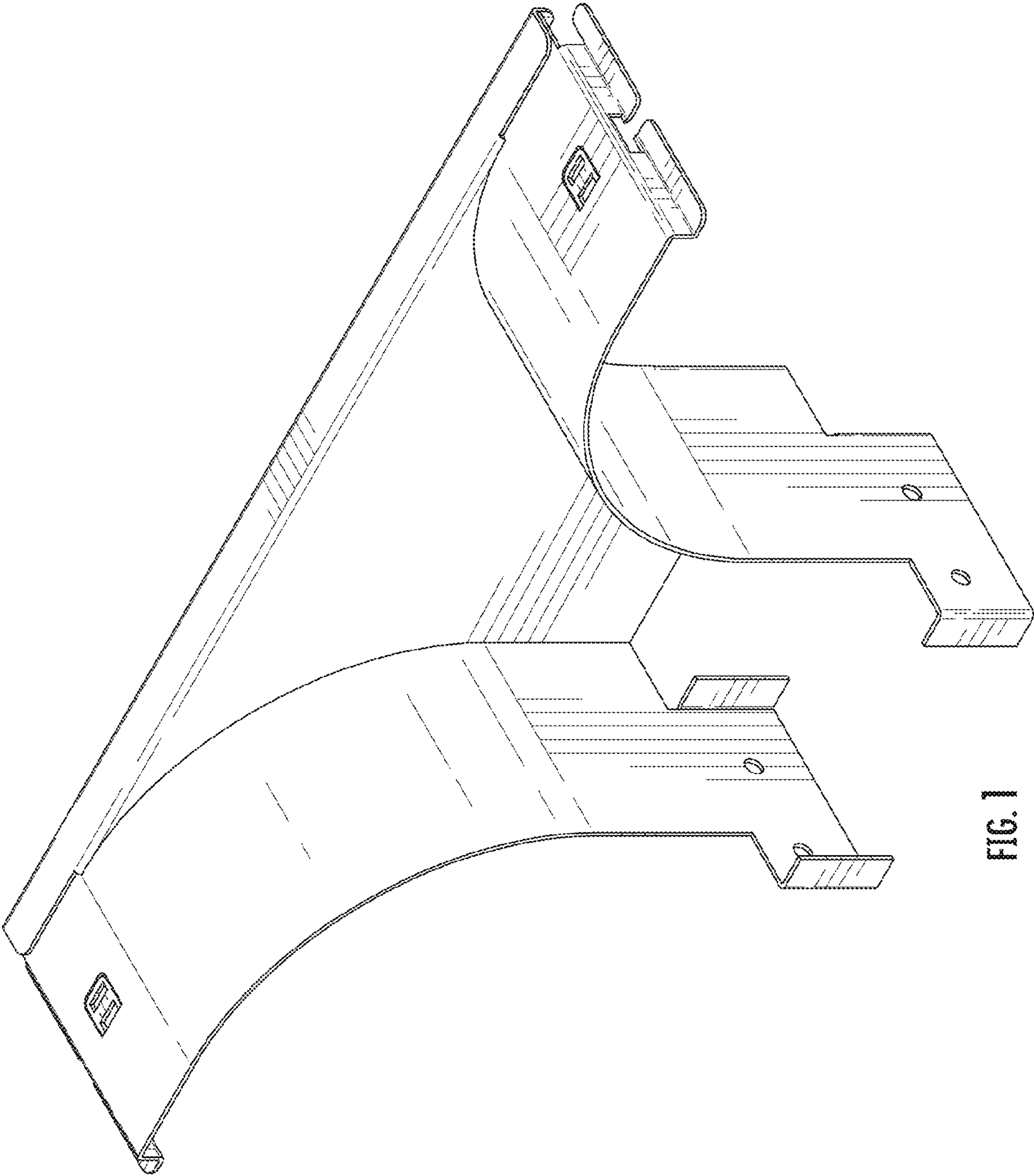

FIG. 1

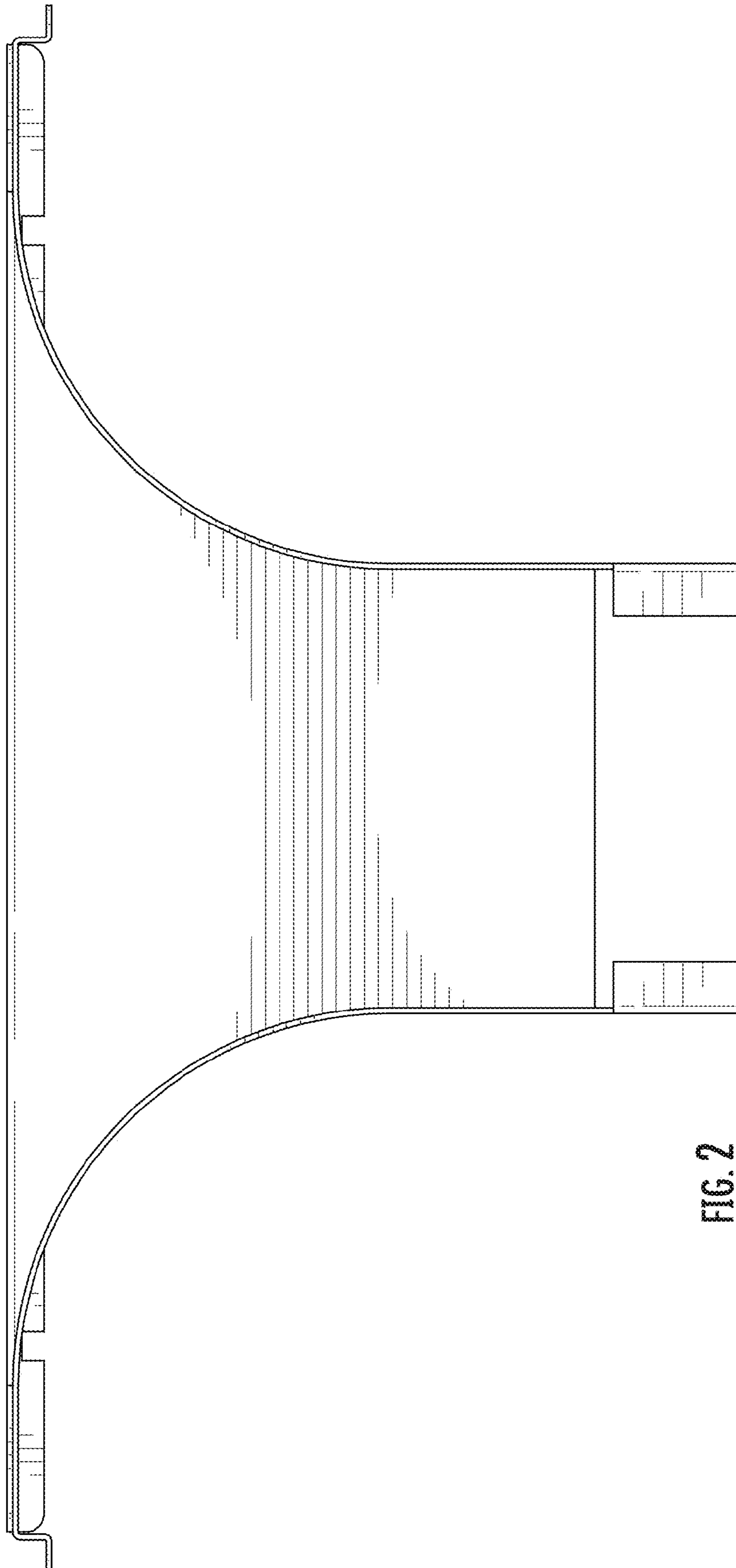

FIG. 2

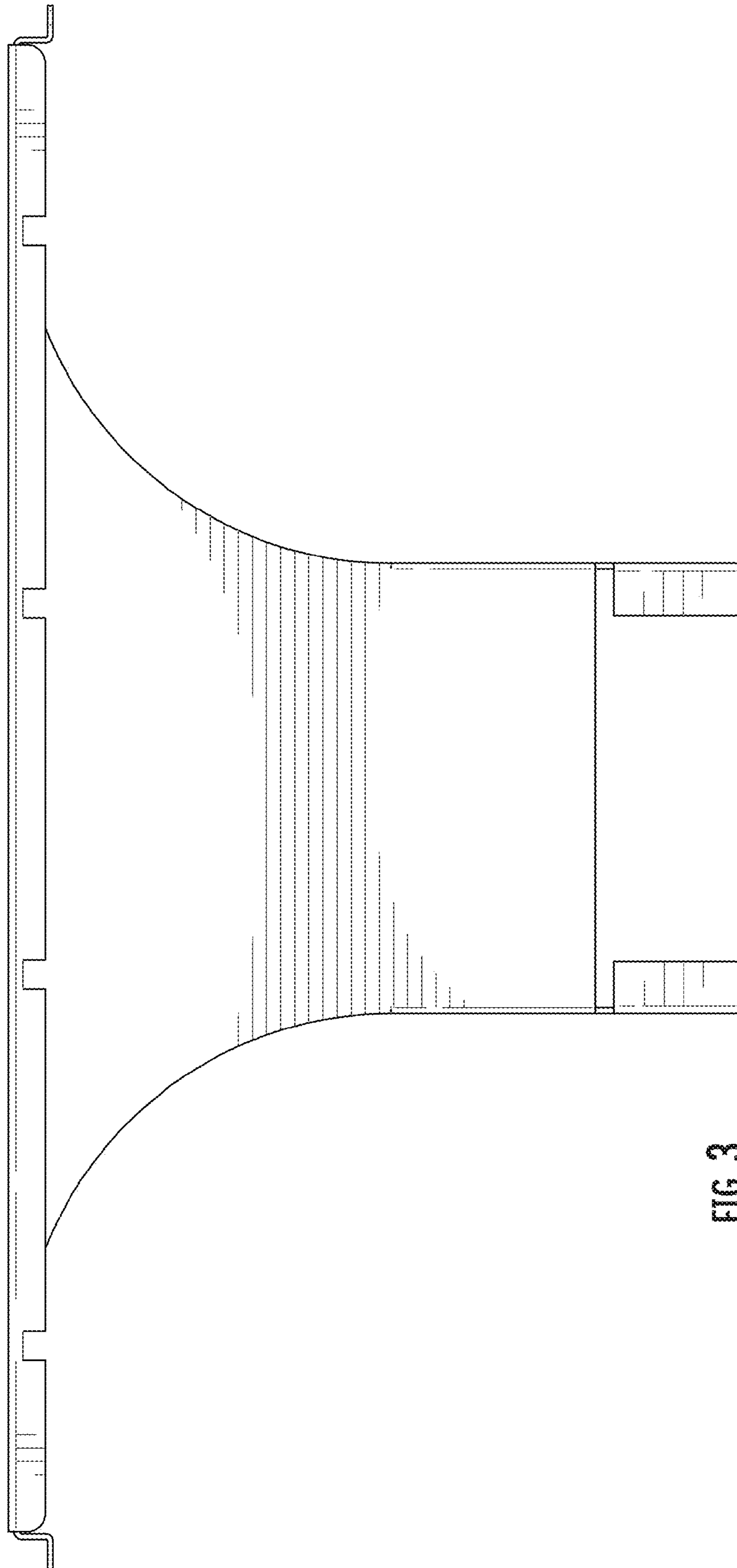

FIG. 3

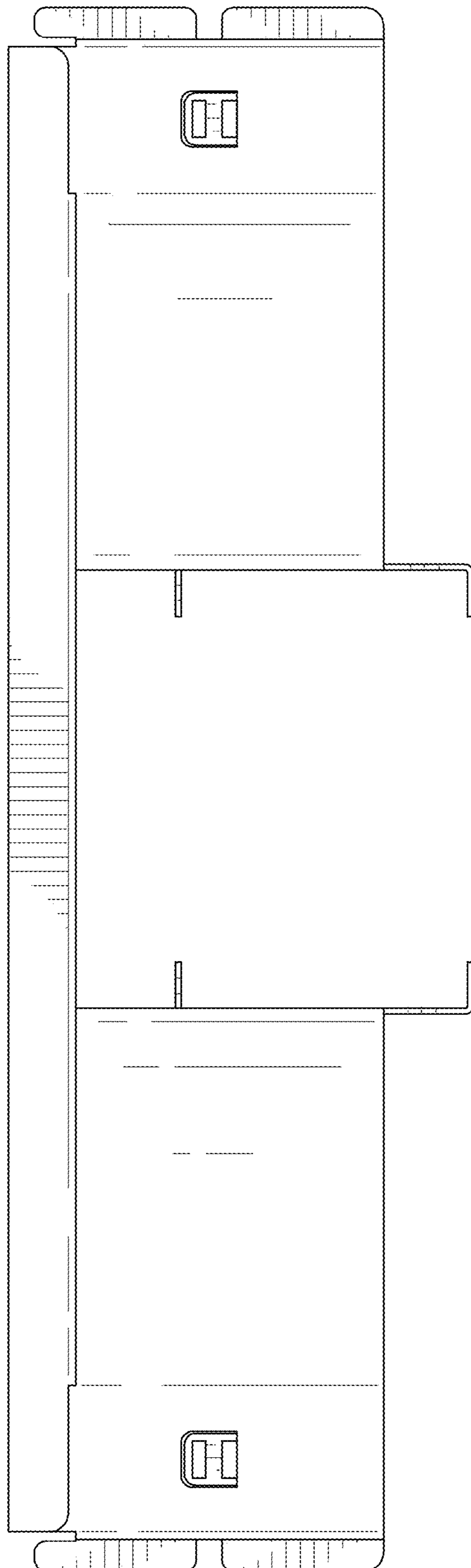

FIG. 4

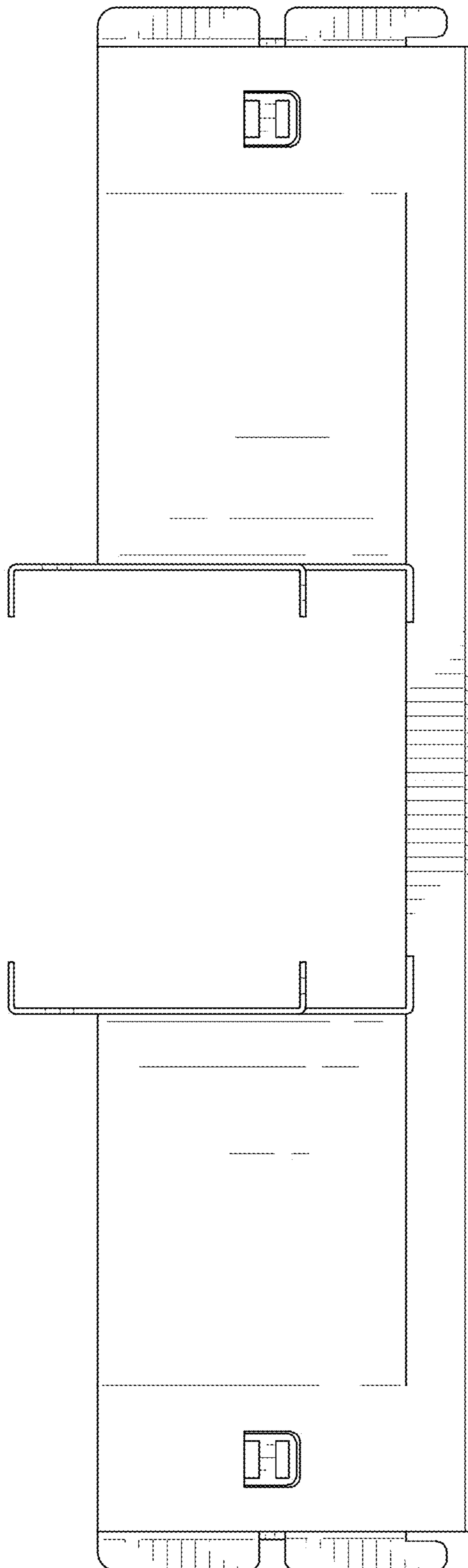

FIG. 5

FIG. 6

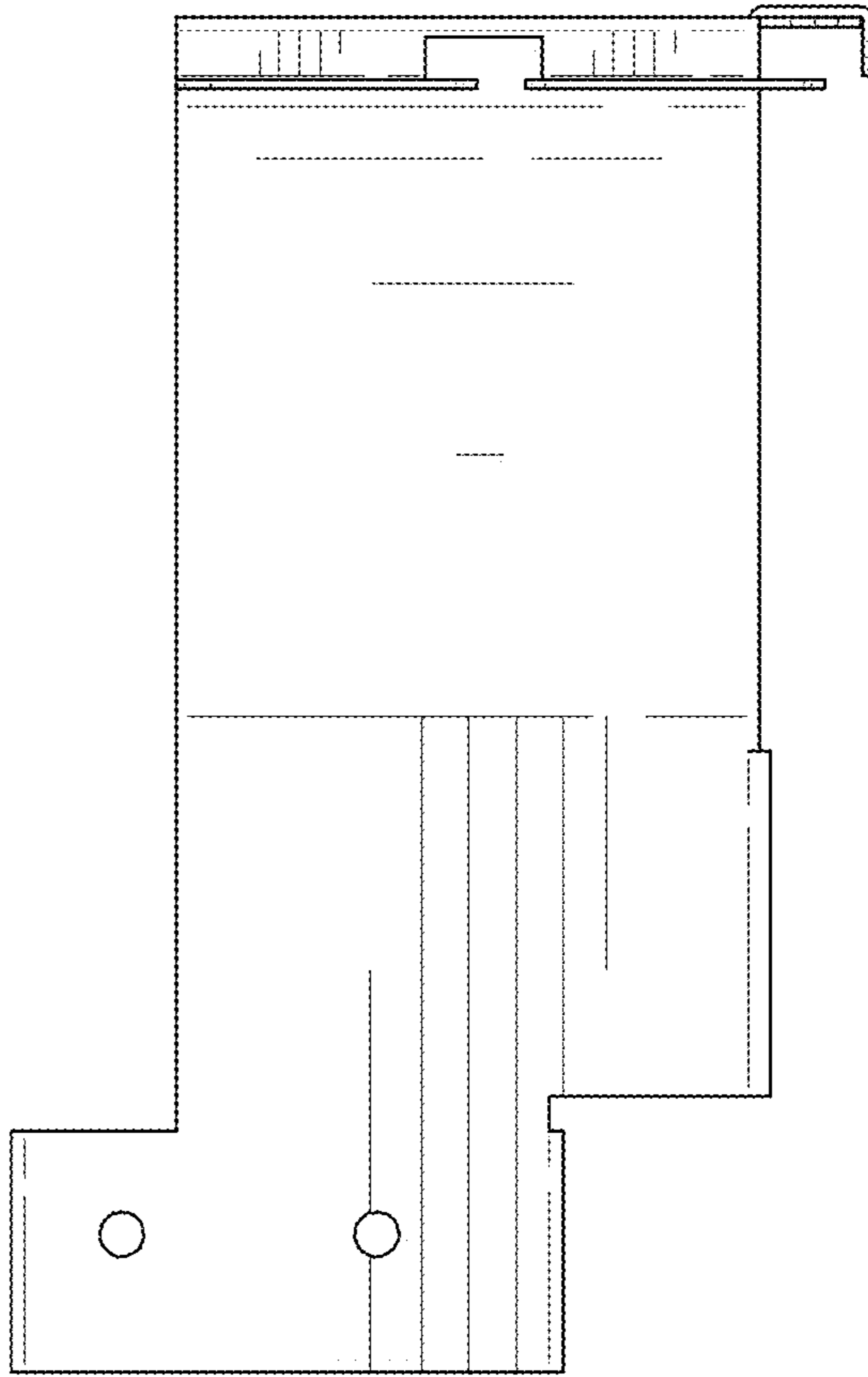
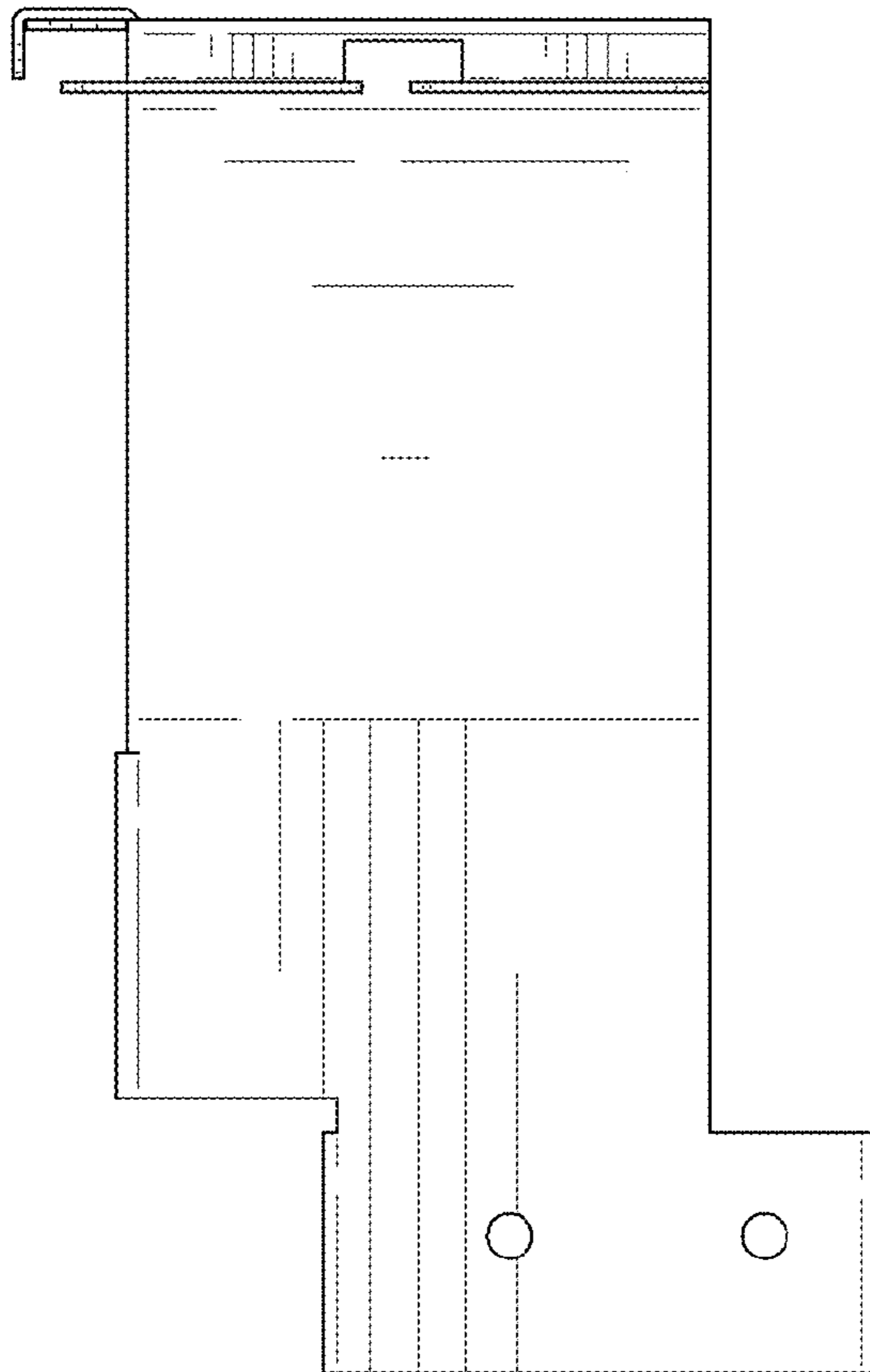

FIG. 7



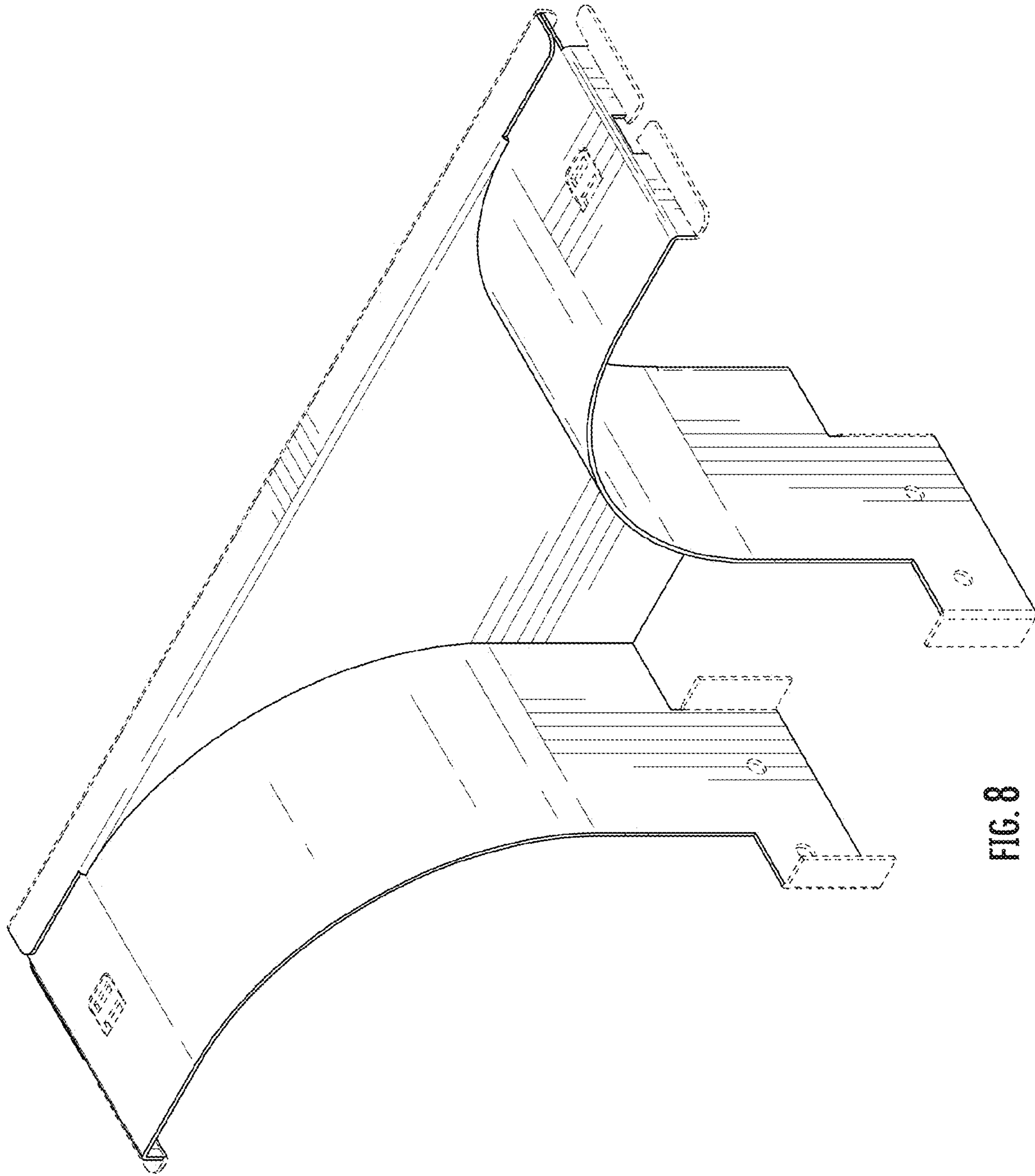

FIG. 8

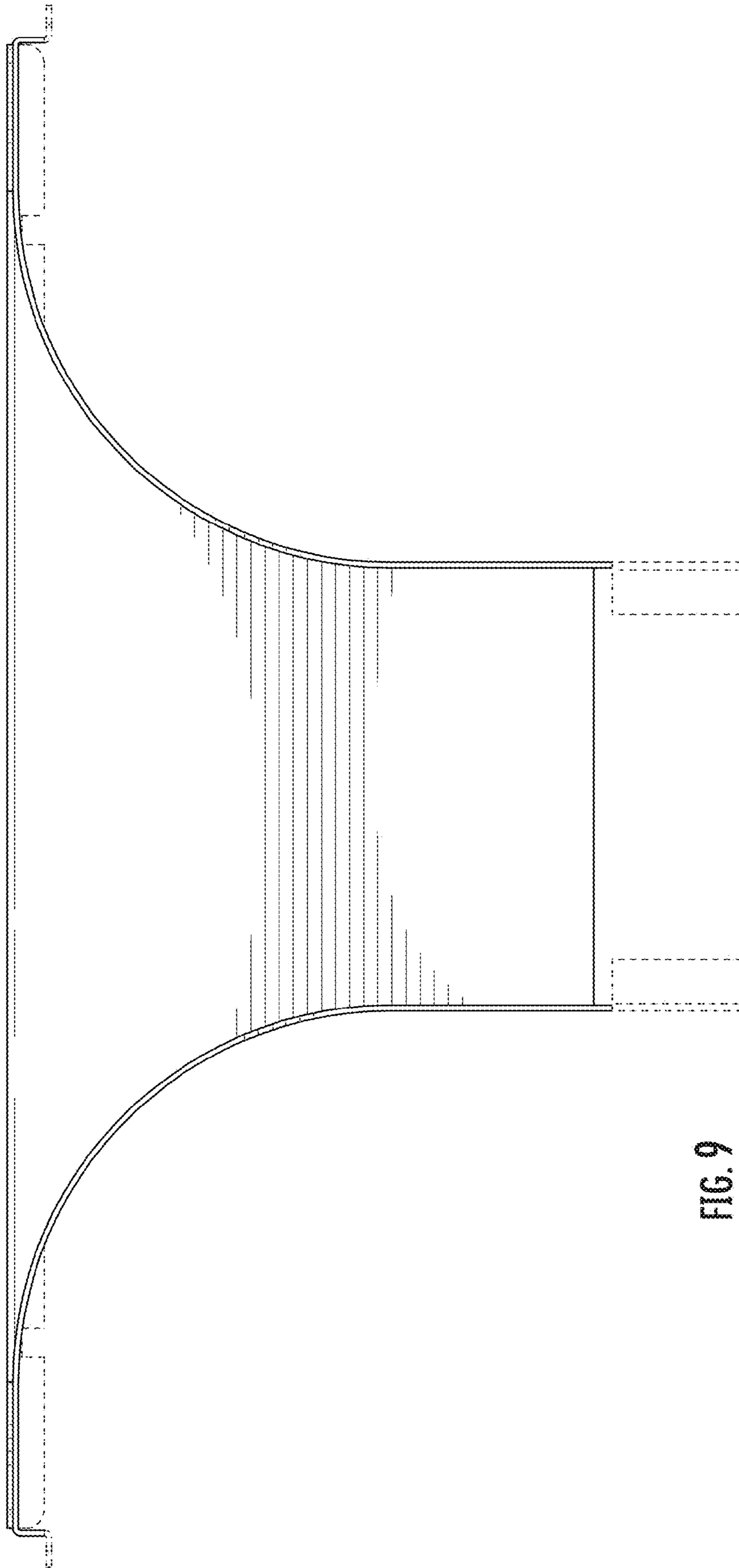

FIG. 9

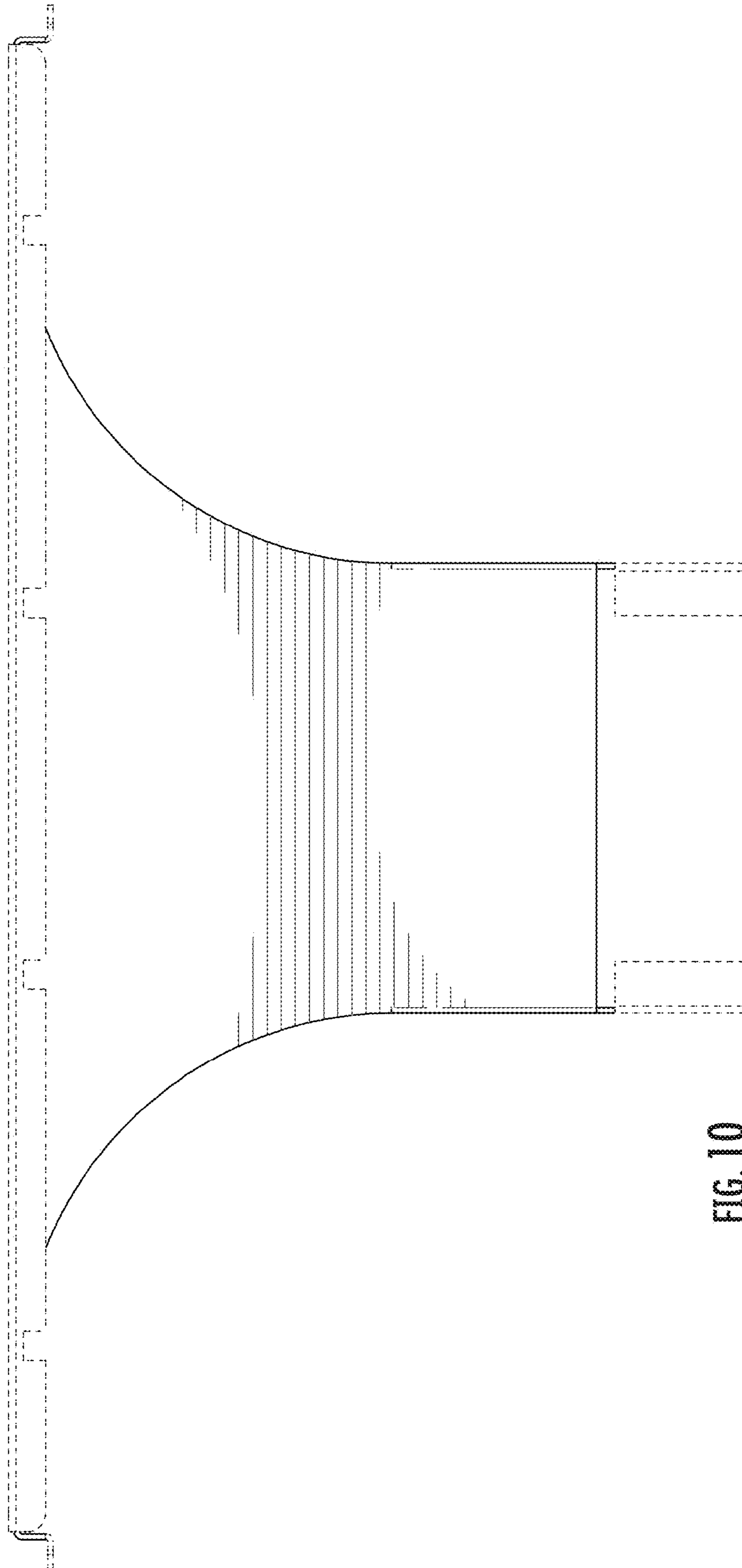

FIG. 10

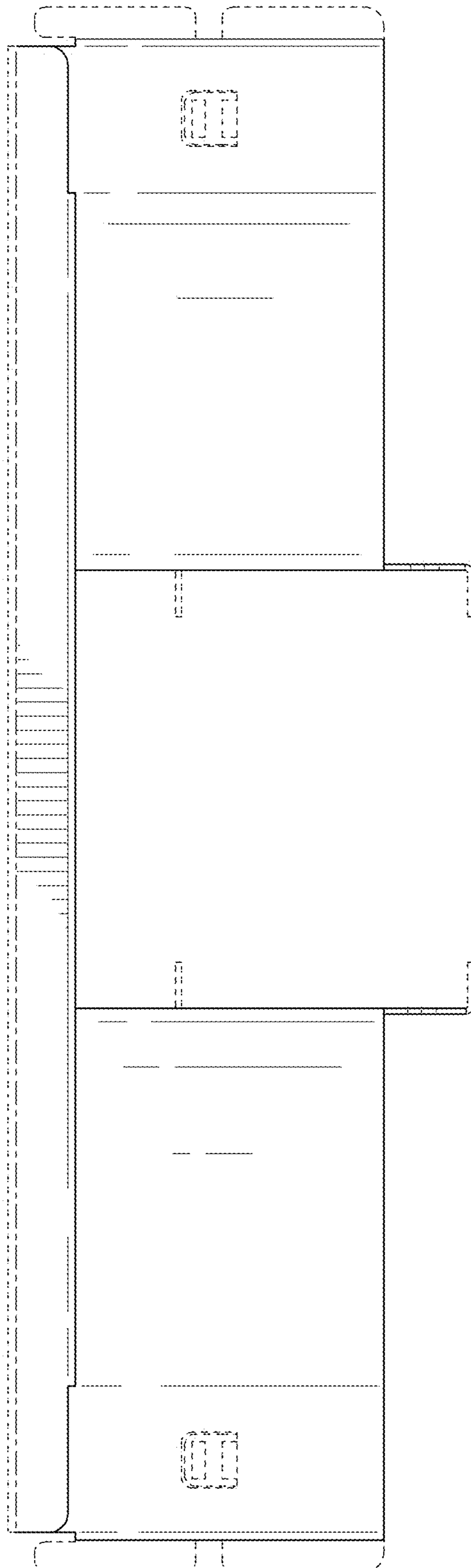

FIG. 11

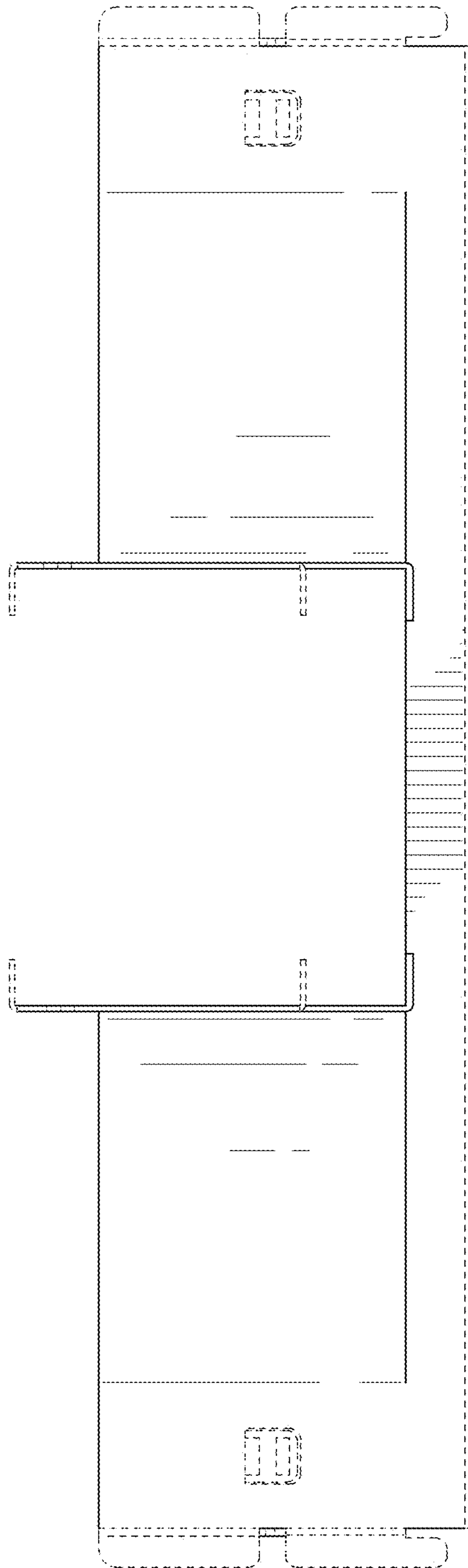

FIG. 12

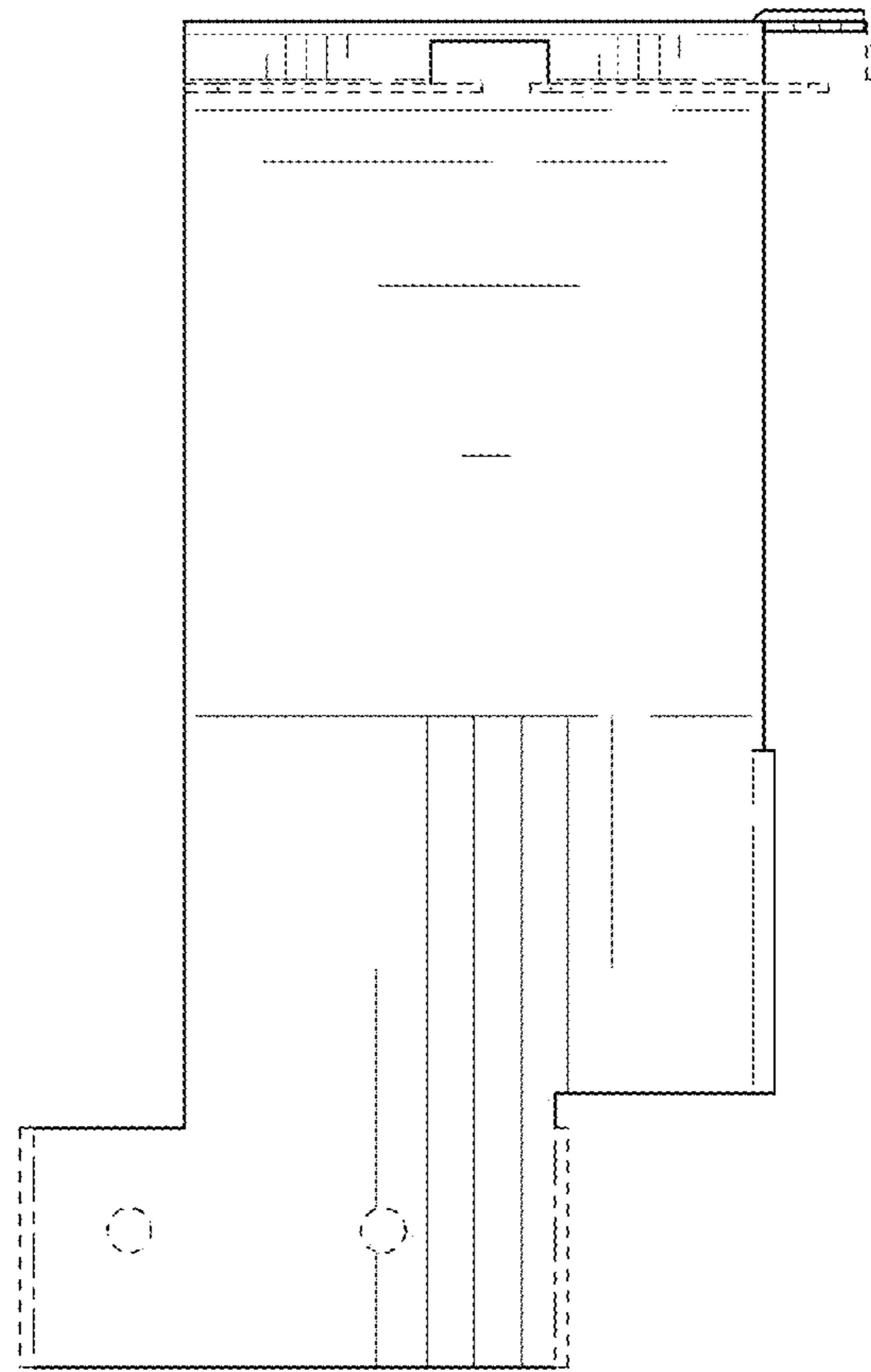

FIG. 13

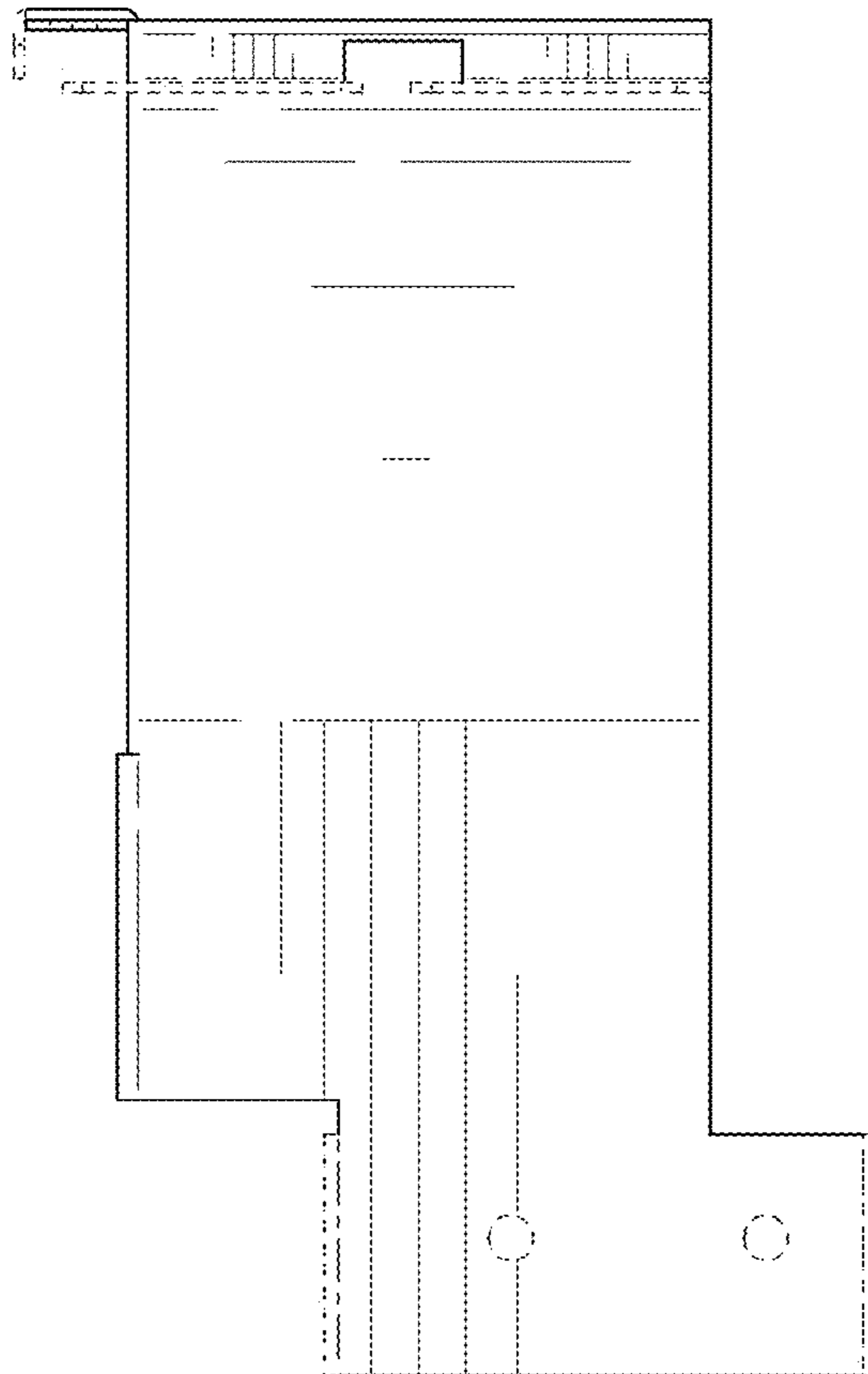

FIG. 14