



US00D938247S

(12) **United States Design Patent**
Suzuki et al.

(10) **Patent No.:** **US D938,247 S**

(45) **Date of Patent:** **** Dec. 14, 2021**

(54) **PORTABLE ELECTRIC SANDER**

(71) Applicant: **MAKITA CORPORATION**, Anjo (JP)

(72) Inventors: **Wataru Suzuki**, Anjo (JP); **Fumihide Sugita**, Anjo (JP)

(73) Assignee: **MAKITA CORPORATION**, Anjo (JP)

(**) Term: **15 Years**

(21) Appl. No.: **29/686,102**

(22) Filed: **Apr. 2, 2019**

(30) **Foreign Application Priority Data**

Oct. 3, 2018 (JP) 2018-021753

(51) **LOC (13) Cl.** **08-03**

(52) **U.S. Cl.**
USPC **D8/62**

(58) **Field of Classification Search**

USPC D8/69, 68, 67, 66, 64, 61, 70; 83/698.41,
83/747, 166.3, 374, 373, 375, 376, 391,
83/377, 390, 388, 389; 125/13.01;
144/218; D21/532

CPC B24B 23/028; B24B 47/12; B24B 7/186;
B25F 5/001; B25F 5/02

See application file for complete search history.

(56) **References Cited**

U.S. PATENT DOCUMENTS

D457,925 S * 5/2002 Grafton D21/532
D482,582 S * 11/2003 Chunn D8/8
7,625,264 B1 * 12/2009 Gordon B24B 7/184
451/294
D748,963 S * 2/2016 Roeck D8/62
9,387,566 B2 * 7/2016 Roeck B24B 23/02
9,981,360 B2 * 5/2018 Roeck B24B 7/184

10,035,236 B2 * 7/2018 Roeck B24B 27/0084
D830,798 S * 10/2018 Tinius D8/8
D929,199 S * 8/2021 Li D8/62

(Continued)

FOREIGN PATENT DOCUMENTS

EP 1793966 B1 2/2012
EP 1719581 B1 3/2013

Primary Examiner — Austin Murphy

(74) *Attorney, Agent, or Firm* — Global IP Counselors, LLP

(57) **CLAIM**

The ornamental design for a portable electric sander, as shown and described.

DESCRIPTION

FIG. 1 is a front perspective view of a portable electric sander in accordance with our new design;
FIG. 2 is a rear perspective view of the portable electric sander in accordance with our new design;
FIG. 3 is a front elevational view of the portable electric sander in accordance with our new design;
FIG. 4 is a rear elevational view of the portable electric sander in accordance with our new design;
FIG. 5 is a top plan view of the portable electric sander in accordance with our new design;
FIG. 6 is a bottom plan view of the portable electric sander in accordance with our new design;
FIG. 7 is a right side elevational view of the portable electric sander in accordance with our new design;
FIG. 8 is a left side elevational view of the portable electric sander, in accordance with our new design; and,
FIG. 9 is a front perspective view of the portable electric sander in accordance with our new design showing when an extension pole is in an extended state and a rechargeable battery is attached to the portable electric sander.
The broken line showing of environment structures in the drawings forms no part of the claimed design.

1 Claim, 8 Drawing Sheets

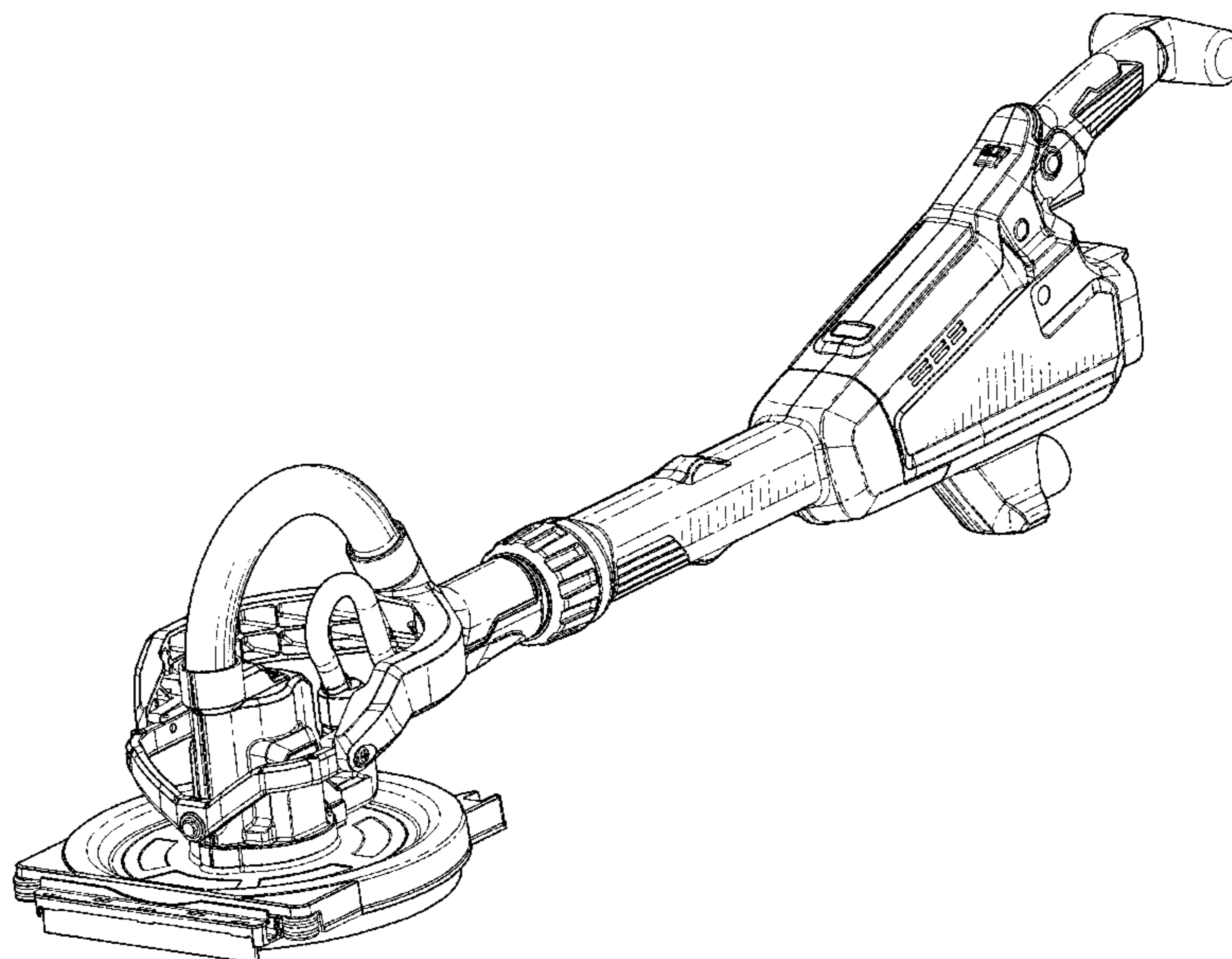

(56)

References Cited

U.S. PATENT DOCUMENTS

2006/0073778 A1* 4/2006 Phillips B24B 47/12
451/354
2016/0213216 A1* 7/2016 Laessig B24B 7/184
2019/0232456 A1* 8/2019 Sugita B24B 23/005

* cited by examiner

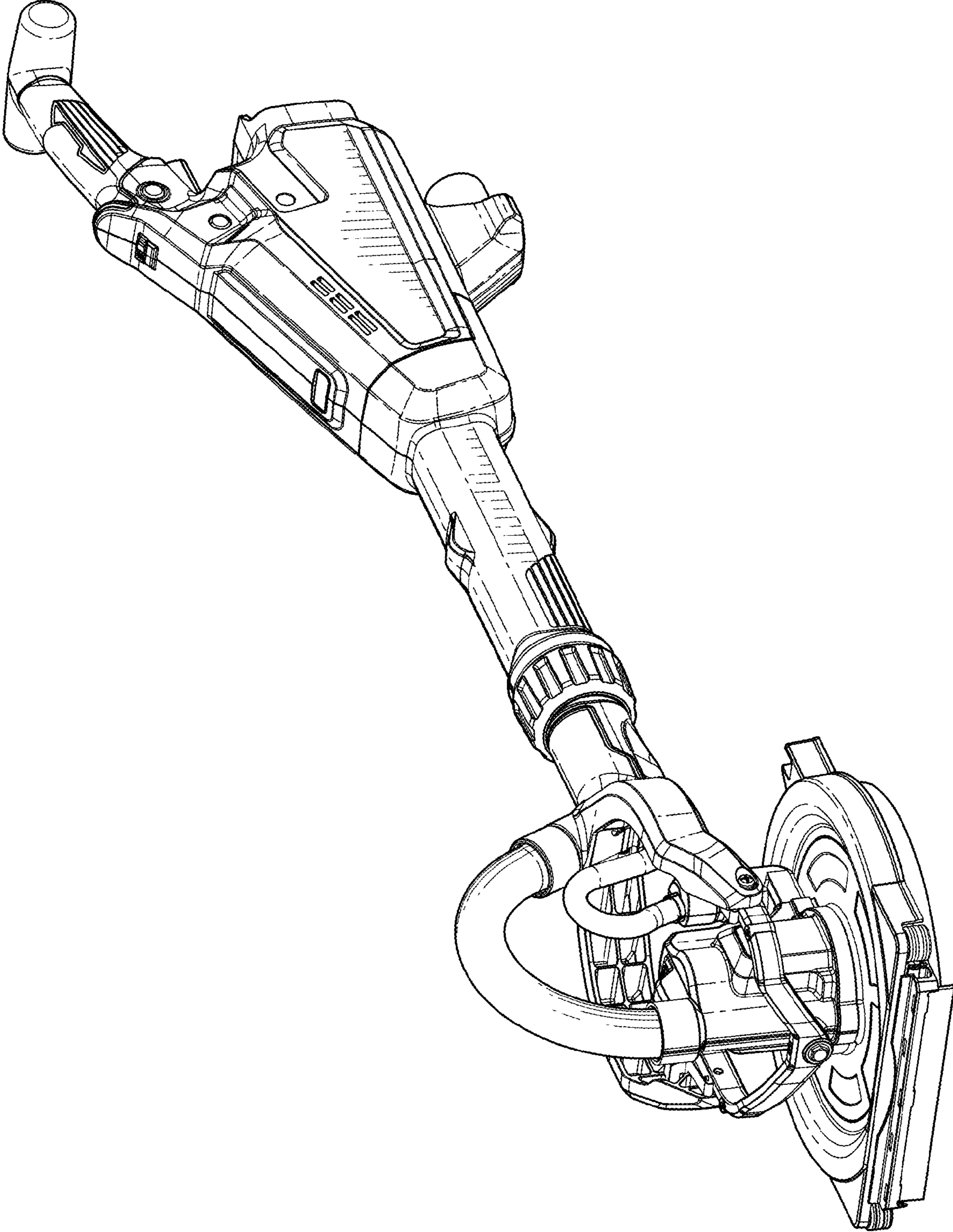

FIG. 1

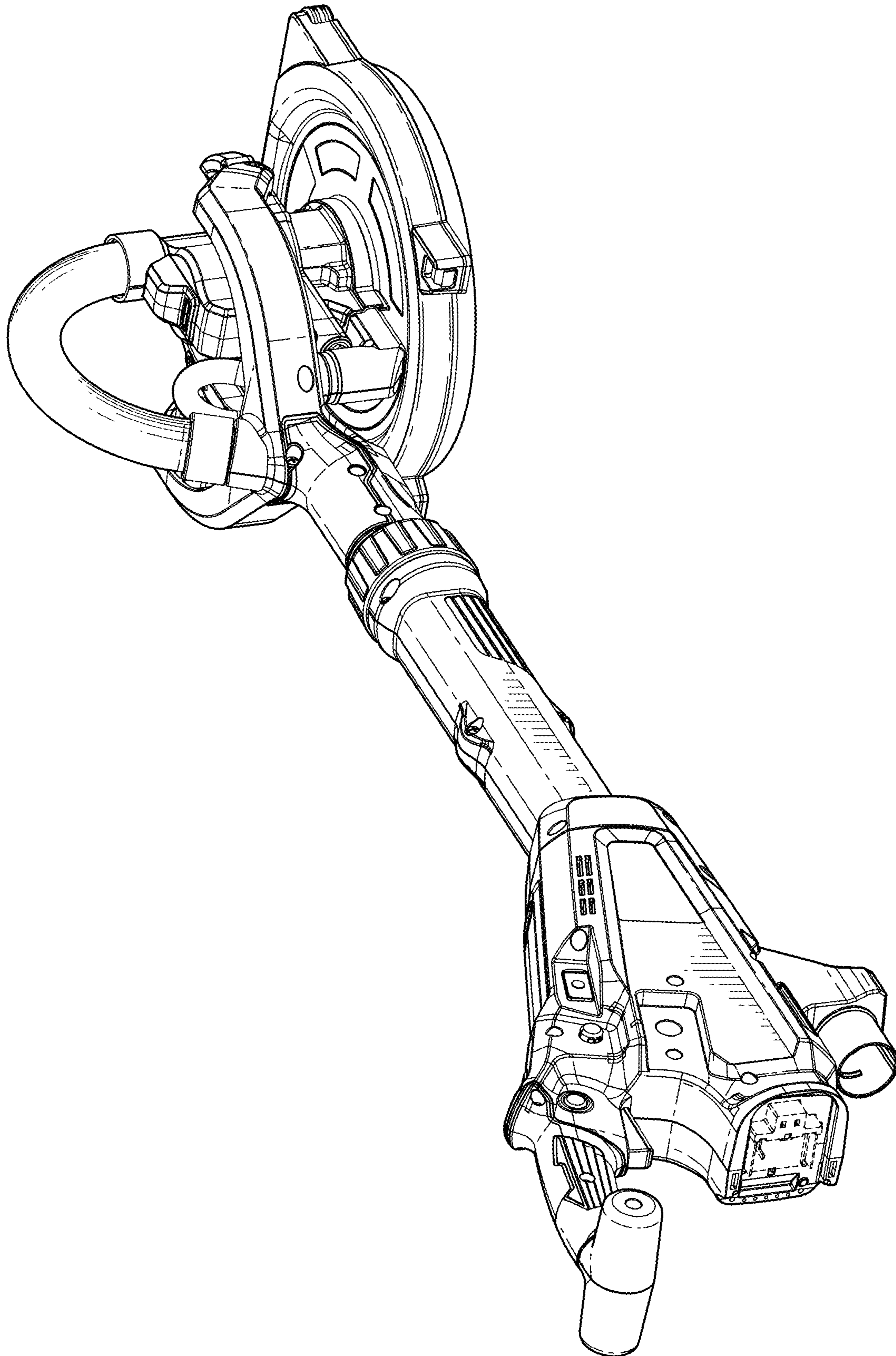

FIG. 2

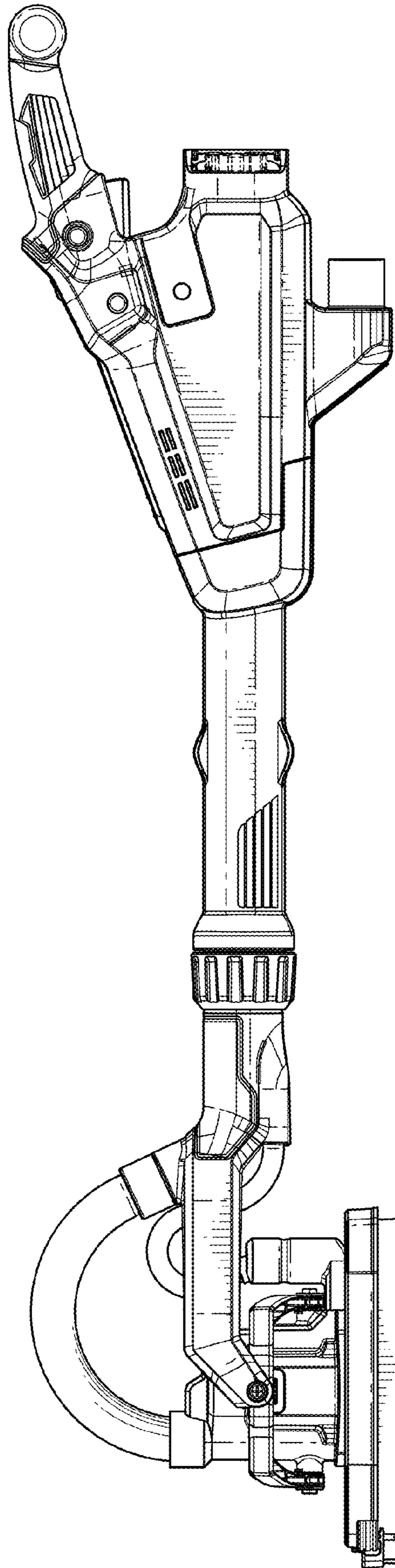

FIG. 3

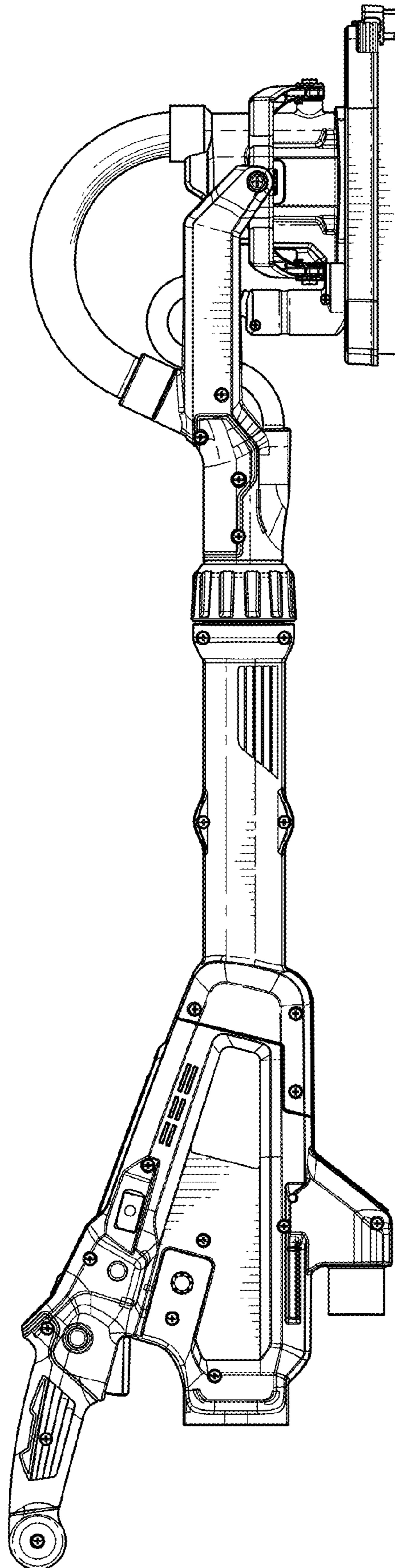

FIG. 4

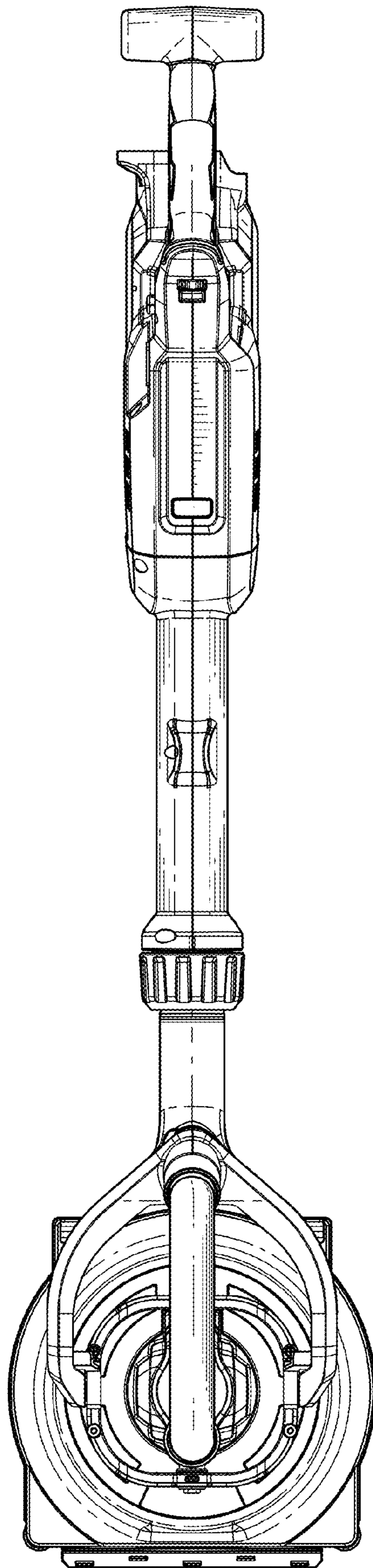

FIG. 5

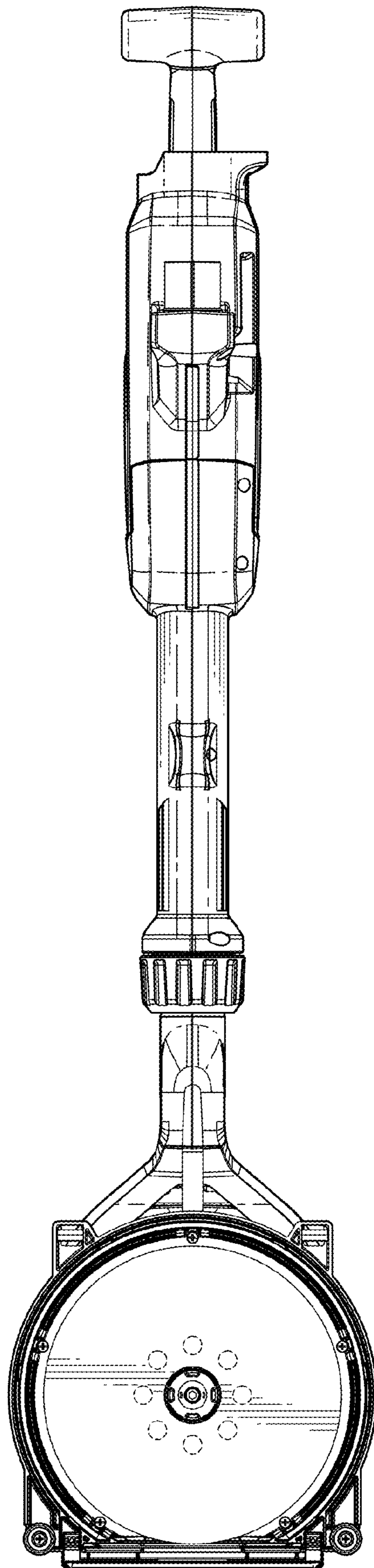

FIG. 6

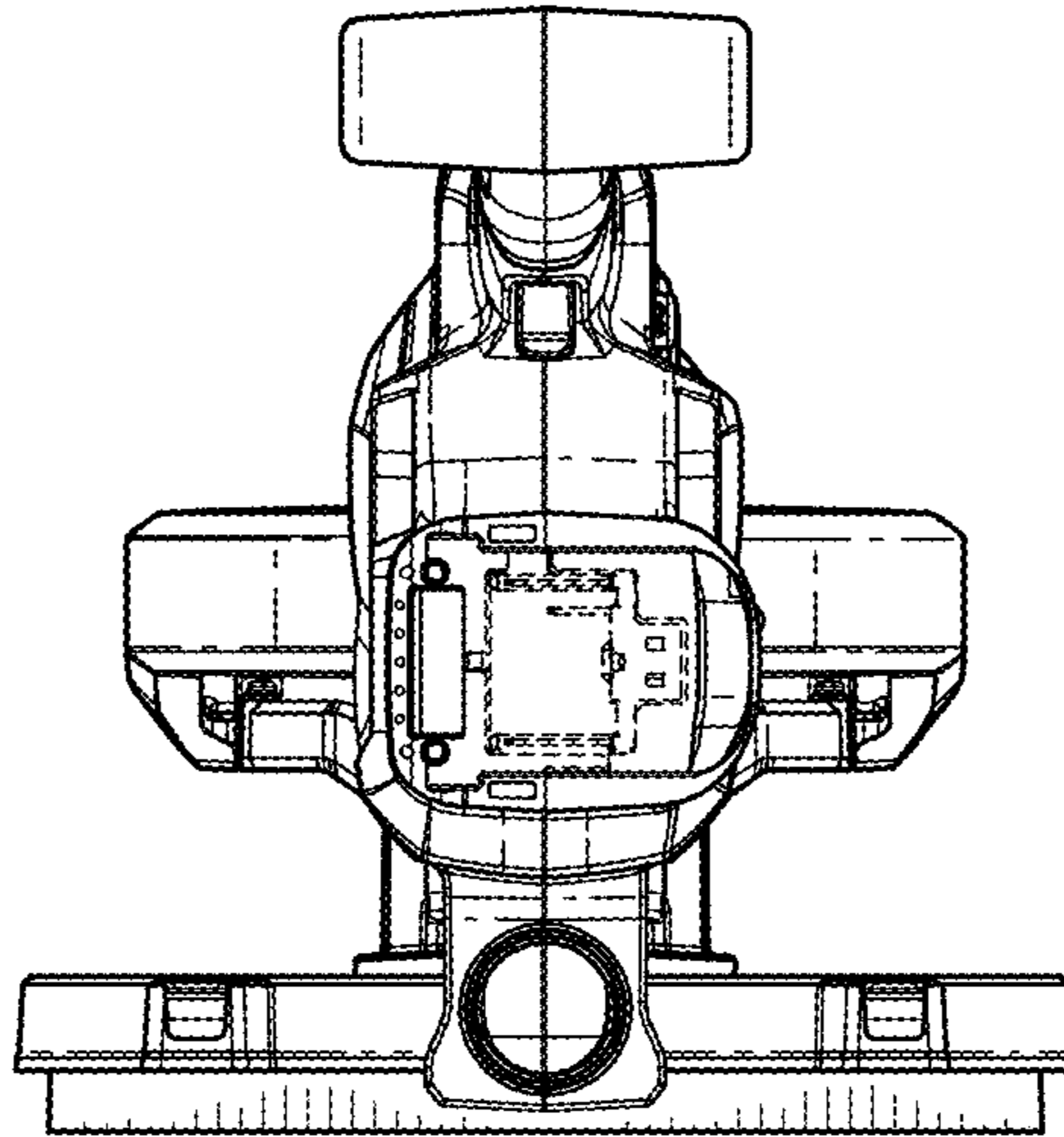

FIG. 7

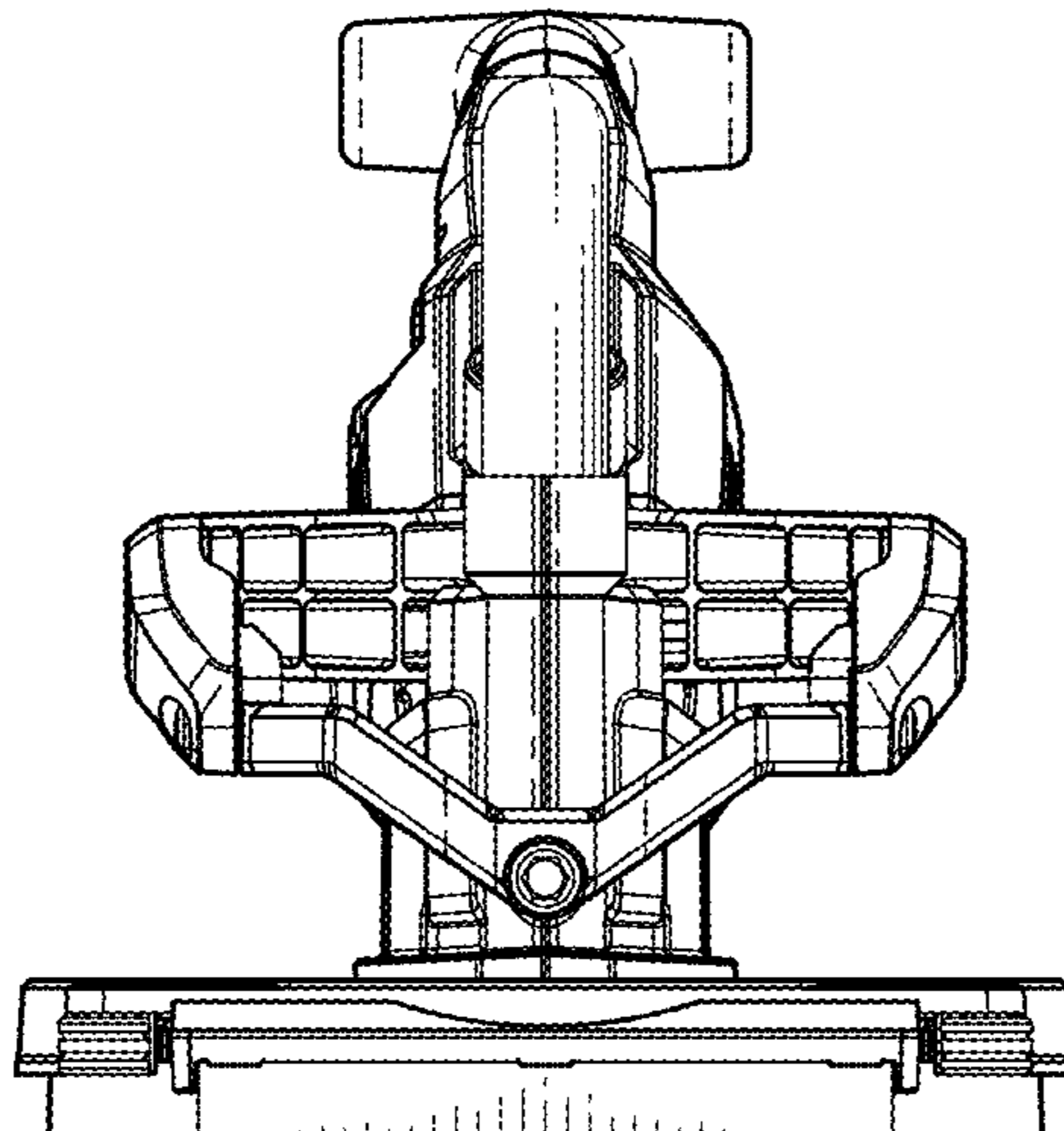

FIG. 8

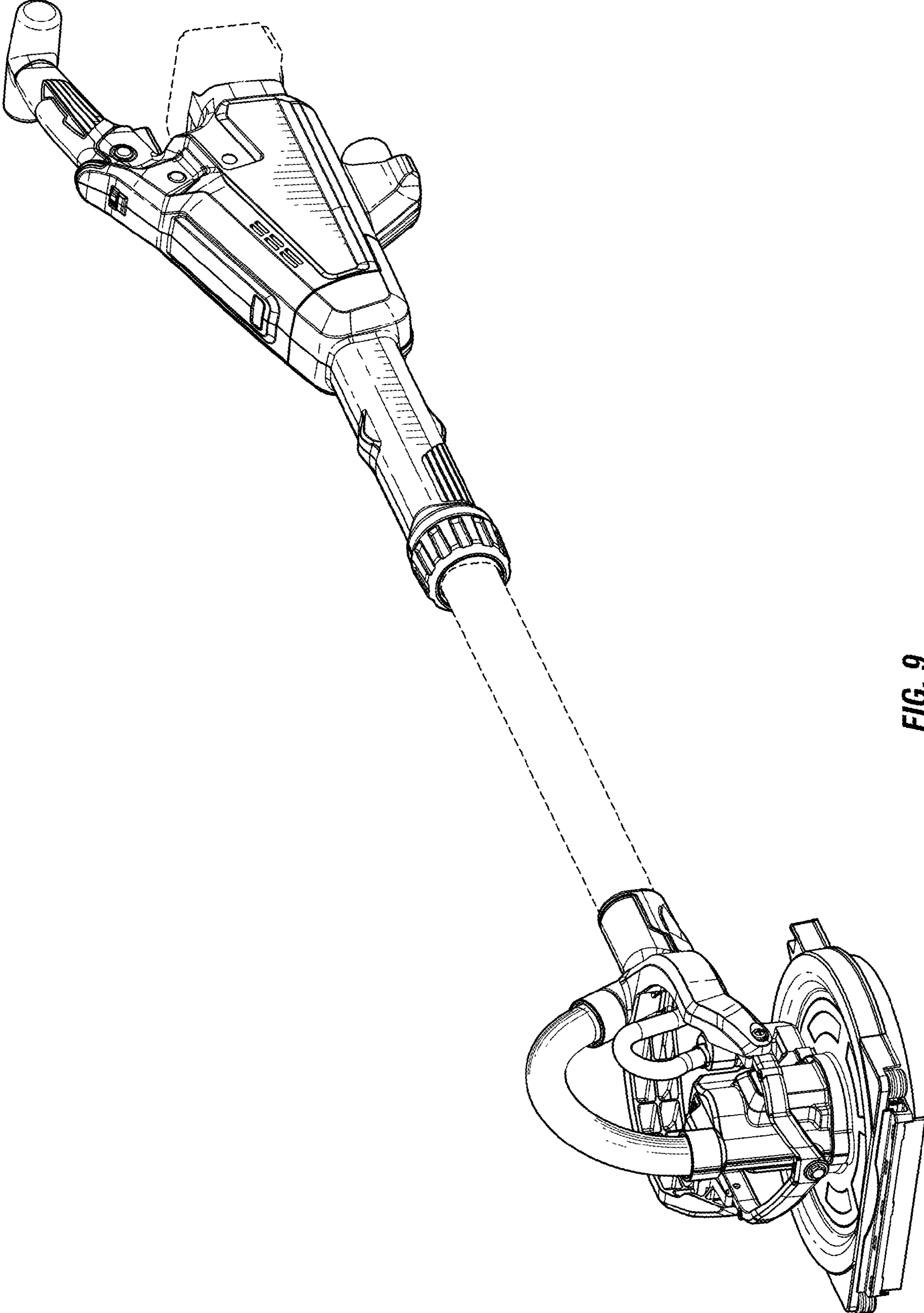

FIG. 9