



US00D937979S

(12) **United States Design Patent** (10) **Patent No.:** **US D937,979 S**  
**Stoler** (45) **Date of Patent:** **\*\* Dec. 7, 2021**

(54) **FAUCET BODY** D922,530 S \* 6/2021 Lazarini ..... D23/238  
D922,531 S \* 6/2021 Staler ..... D23/238  
(71) Applicant: **DELTA FAUCET COMPANY,** D923,148 S \* 6/2021 Lazarini ..... D23/238  
Indianapolis, IN (US)

(72) Inventor: **Benjamin Stoler,** Carmel, IN (US)

(73) Assignee: **DELTA FAUCET COMPANY,**  
Indianapolis, IN (US)

(\*\*) Term: **15 Years**

(21) Appl. No.: **29/721,592**

(22) Filed: **Jan. 22, 2020**

(51) **LOC (13) Cl.** ..... **23-01**

(52) **U.S. Cl.**  
USPC ..... **D23/238**

(58) **Field of Classification Search**  
USPC ..... D23/238–243, 249, 255, 257  
CPC .... E03C 1/0401; E03C 1/0402; E03C 1/0404;  
E03C 1/0405; E03C 1/0412

See application file for complete search history.

(56) **References Cited**

U.S. PATENT DOCUMENTS

D76,827 S *	11/1928	Smith	.....	D23/252
D163,236 S *	5/1951	Young	.....	D23/249
D429,521 S *	8/2000	Doughty	.....	D23/250
D452,101 S *	12/2001	Yeh	.....	D6/550
D478,754 S *	8/2003	Moore	.....	D6/524
D494,396 S *	8/2004	Veltz	.....	D6/524
D516,354 S *	3/2006	Sedwick	.....	D6/550
D868,939 S *	12/2019	Bahler	.....	D23/238
D875,217 S *	2/2020	Bahler	.....	D23/238
D875,218 S *	2/2020	Chen	.....	D23/255
D921,842 S *	6/2021	Fritz	.....	D23/238

OTHER PUBLICATIONS

Moen Brantford Motionsense Wave Touchless One-Handle Pulldown Kitchen Faucet, announced Dec. 1, 2018[online], [site visited Jul. 28, 2021], Available from internet, URL:< <https://www.amazon.com/Moen-Brantford-Motionsense-One-Handle-7185EWC/dp/B07MHJX584>> (Year: 2018).\*

\* cited by examiner

*Primary Examiner* — Barbara Fox

*Assistant Examiner* — Jamaal Rasheed

(74) *Attorney, Agent, or Firm* — Nirav D. Parikh; Edgar A. Zarins

(57) **CLAIM**

The ornamental design for a faucet body, as shown and described.

**DESCRIPTION**

FIG. 1 is a front perspective view of a faucet body showing my new design;

FIG. 2 is a rear perspective view thereof;

FIG. 3 is a front elevational view thereof;

FIG. 4 is a left side view thereof;

FIG. 5 is a rear view thereof;

FIG. 6 is a right side view thereof; and,

FIG. 7 is a top plan view thereof.

The broken line showing of the faucet body is for the purposes of depicting portions of the article and forms no part of the claimed design.

**1 Claim, 4 Drawing Sheets**

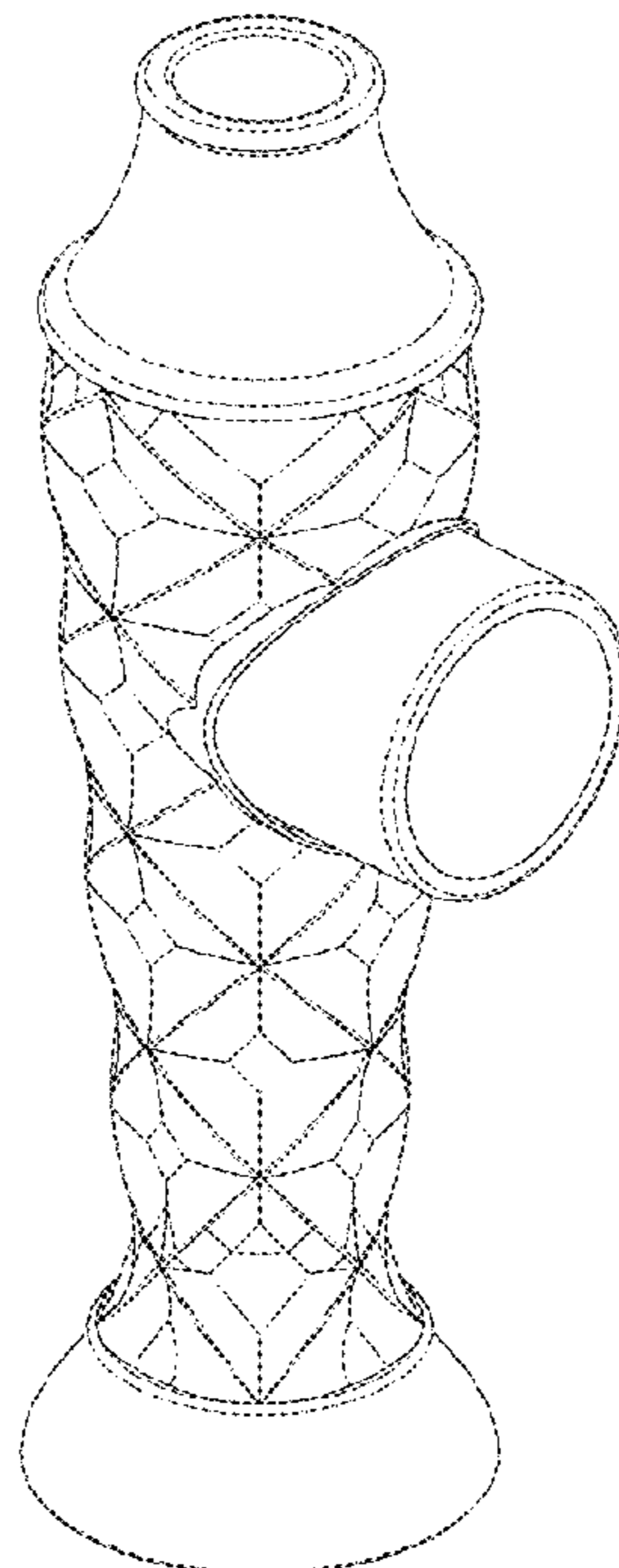

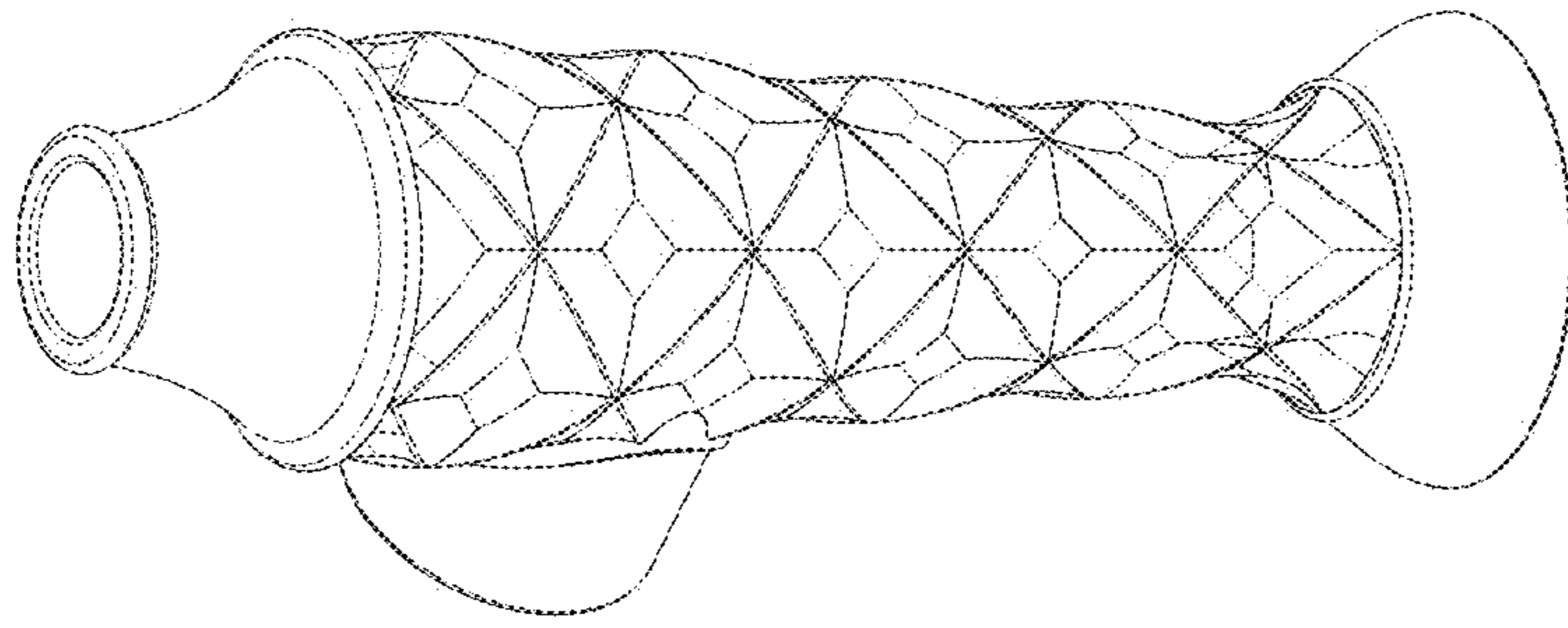

FIG - 2

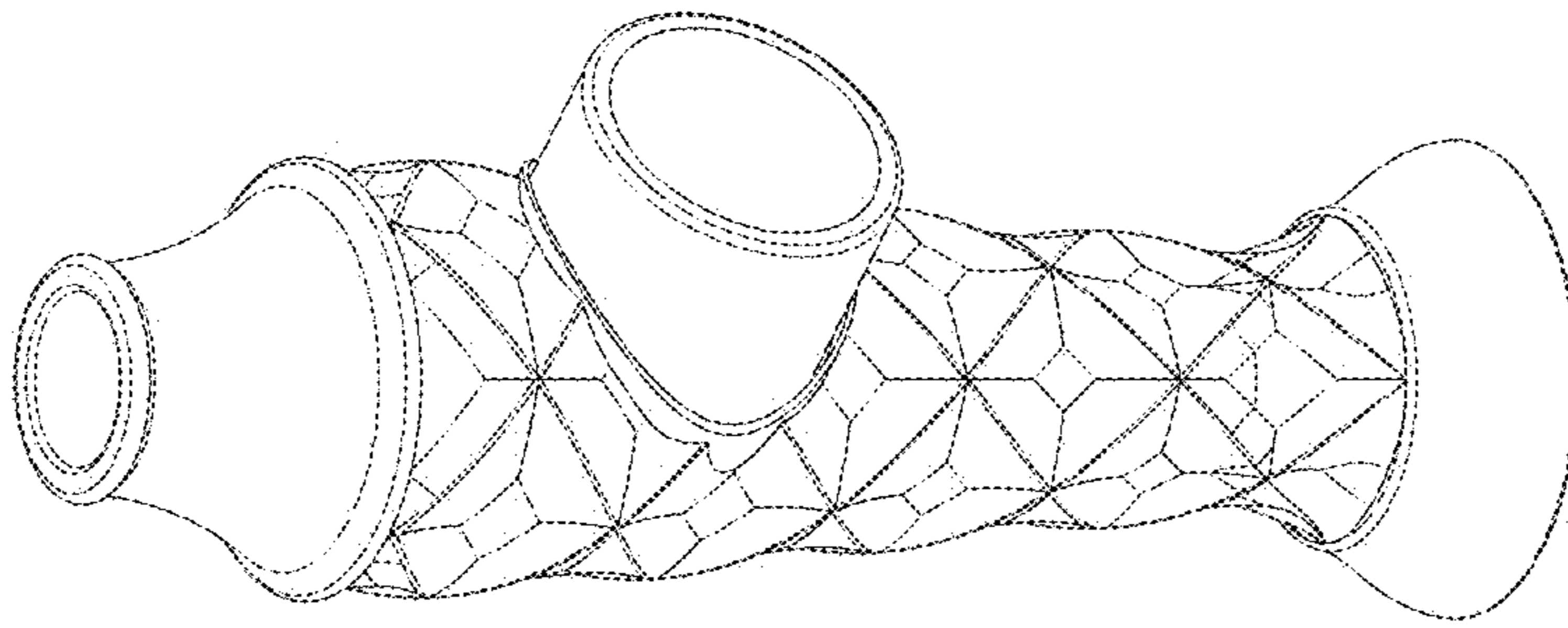

FIG - 1

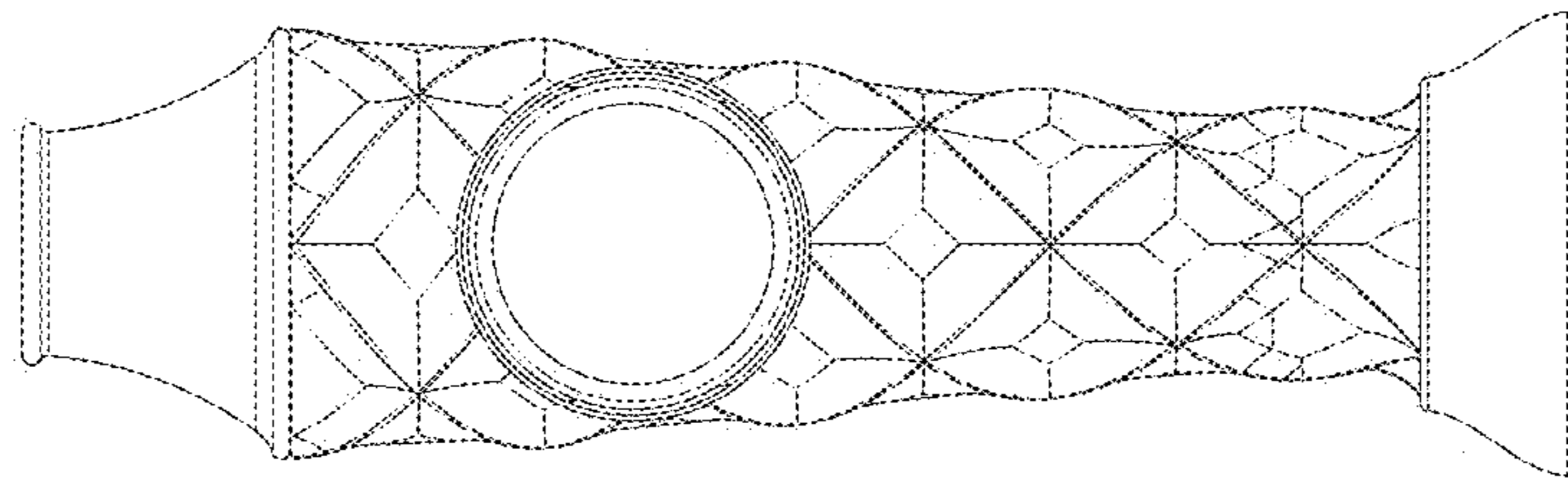

FIG - 4

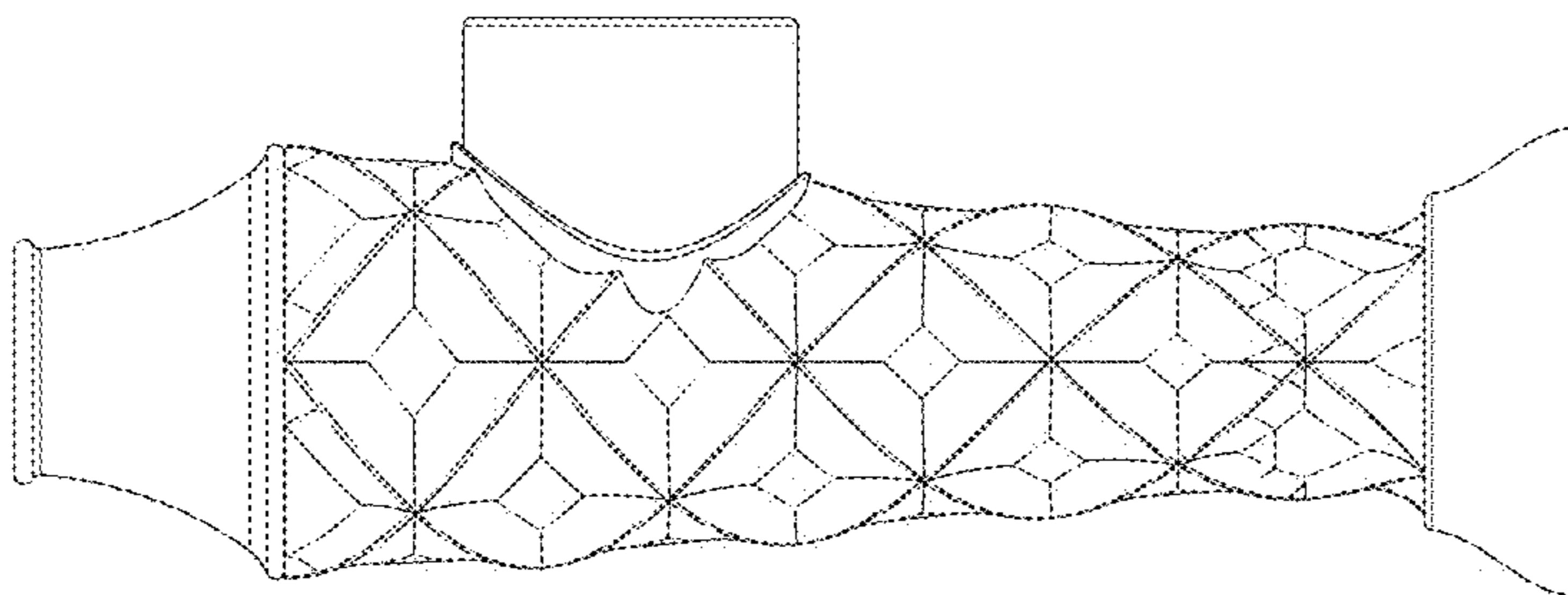

FIG - 3

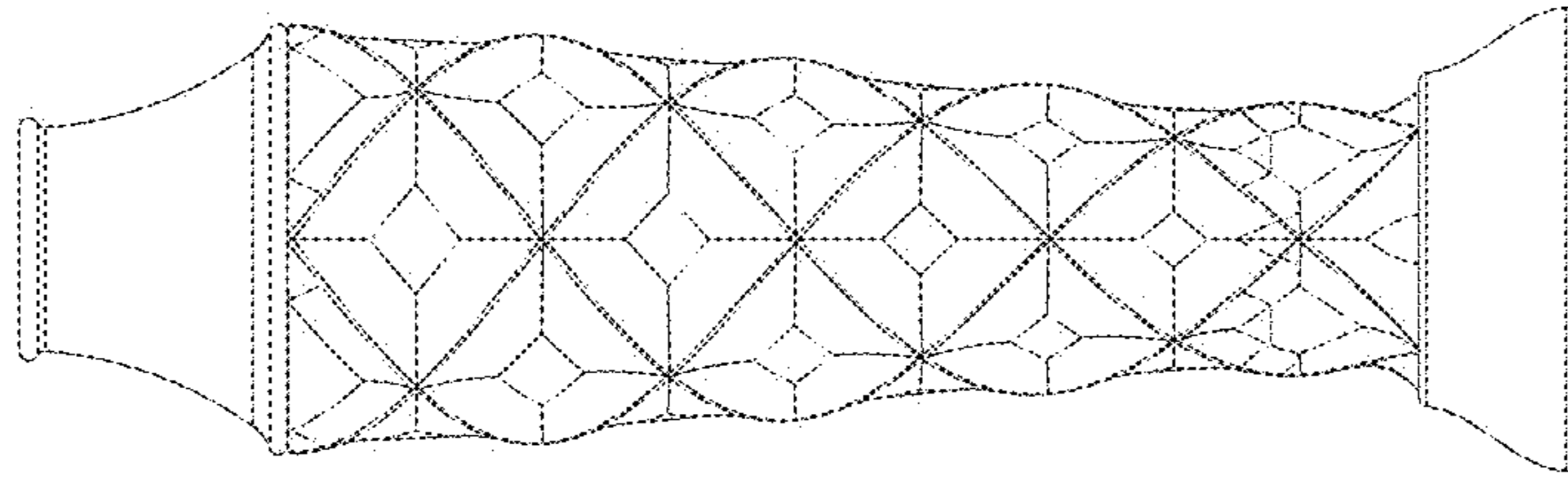

FIG - 6

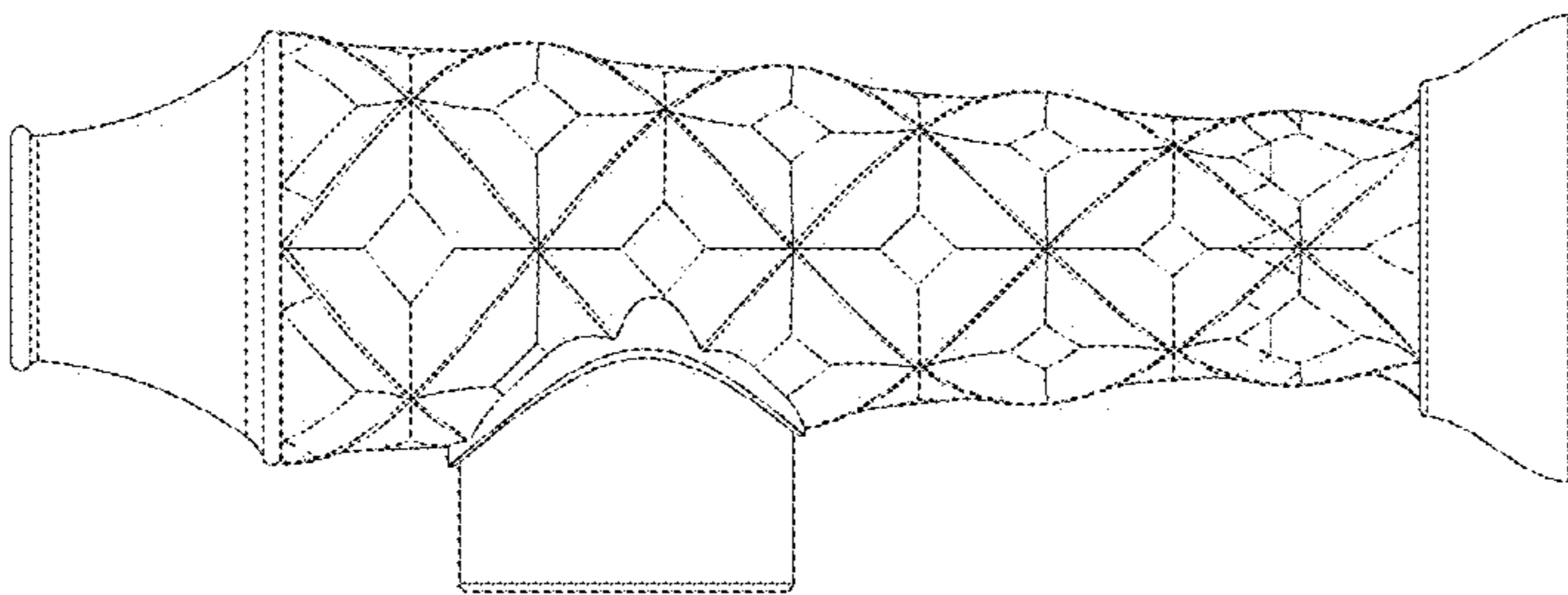

FIG - 5

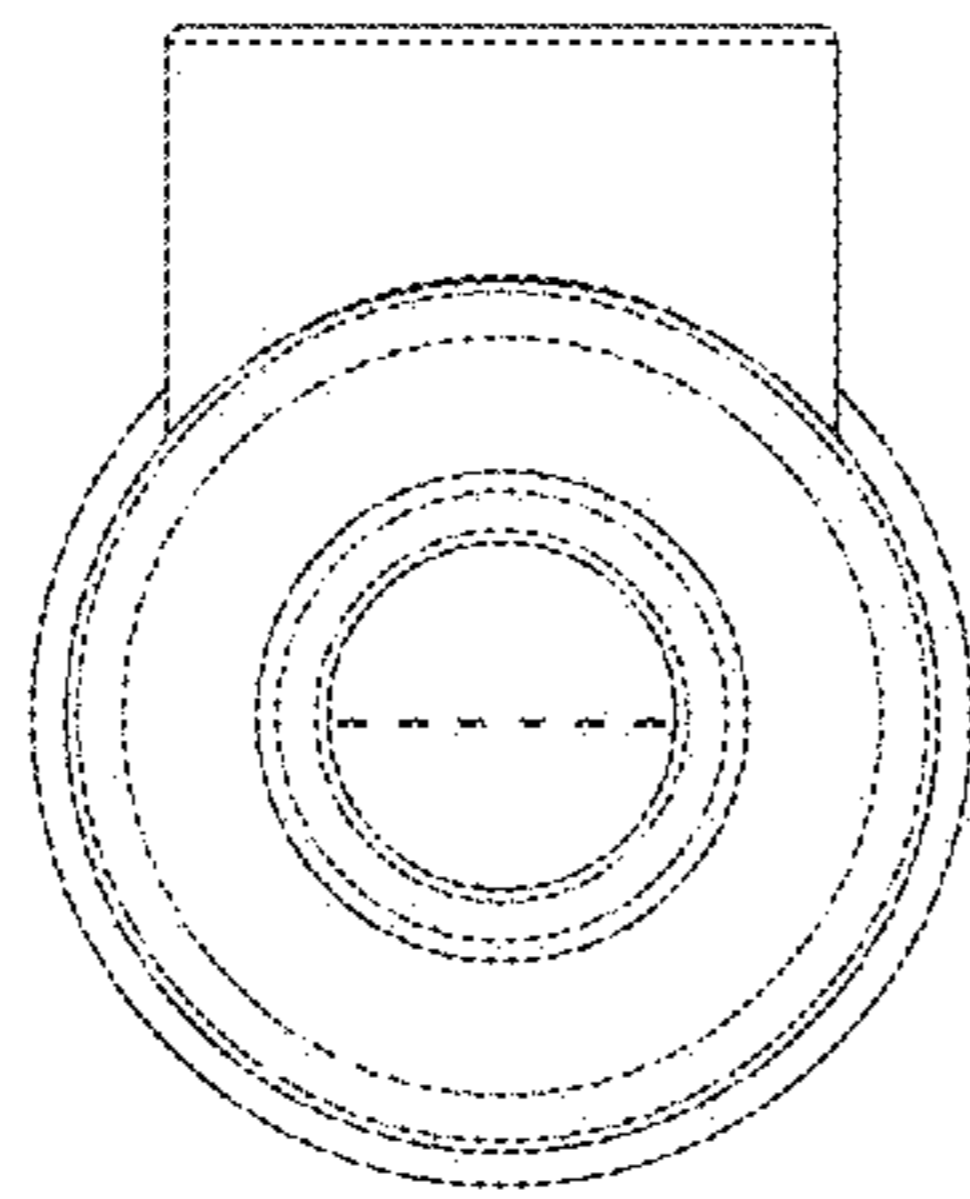

FIG - 7