



US00D936868S

(12) **United States Design Patent** (10) **Patent No.:** **US D936,868 S**
Wraith et al. (45) **Date of Patent:** **** Nov. 23, 2021**

(54) **VEHICLE CENTER HIGH MOUNT BRAKE LIGHT**

D825,797 S * 8/2018 Suwa D26/28
D869,019 S * 12/2019 Benoit D26/28
D882,139 S * 4/2020 Benoit D26/60
D897,568 S * 9/2020 Tomasson D26/28

(71) Applicant: **Ford Global Technologies, LLC,**
Dearborn, MI (US)

OTHER PUBLICATIONS

(72) Inventors: **Paul Wraith**, West Bloomfield, MI (US); **Martin B. Coons**, Detroit, MI (US); **Anthony Meyer**, Royal Oak, MI (US); **Joseph F. Denatale, Jr.**, Royal Oak, MI (US)

Unknown, My observations from seeing see the actual 4-door Bronco raw, unpainted sheet metal shell, Feb. 15, 2020 <https://www.bronco6g.com/forum/threads/my-observations-from-seeing-see-the-actual-4-door-bronco-raw-unpainted-sheet-metal-shell.1048/>.

(73) Assignee: **Ford Global Technologies, LLC,**
Dearborn, MI (US)

Unknown, Here's the 2021 Bronco's Tail Light Shape Illuminated, Feb. 19, 2020 <https://www.bronco6g.com/forum/threads/heres-the-2021-broncos-tail-light-shape-illuminated.1071/>.

(**) Term: **15 Years**

Unknown, 2021 Bronco Interior Spied Undisguised!!, Feb. 25, 2020 <https://www.bronco6g.com/forum/threads/2021-bronco-interior-spied-undisguised.1096/>.

(21) Appl. No.: **29/726,371**

* cited by examiner

(22) Filed: **Mar. 3, 2020**

Primary Examiner — Angela J Lee

(51) **LOC (13) Cl.** **26-06**

(52) **U.S. Cl.**
USPC **D26/28**

(57) **CLAIM**

(58) **Field of Classification Search**
USPC D26/28, 29, 30, 31, 32, 33, 34, 35, 36, D26/44

The ornamental design for a vehicle center high mount brake light, as shown and described.

CPC F21S 48/00; F21S 48/10; F21S 48/115; F21S 48/225; F21S 48/1233; F21S 48/1266; F21S 48/1388; F21S 48/2268; F21V 21/04; F21W 2103/35; F21W 3/40; F21W 2102/17; F21W 2102/30; F21W 2103/00; F21W 2103/55; F21W 2104/00; F21W 2107/17; F21W 2107/13

DESCRIPTION

See application file for complete search history.

FIG. 1 is a front elevational view of a vehicle center high mount brake light, showing our new design; FIG. 2 is a rear elevational view thereof; FIG. 3 is a left side elevational view thereof; FIG. 4 is a right side elevational view thereof; FIG. 5 is a top plan view thereof; FIG. 6 is a bottom plan view thereof; FIG. 7 is a top, front and right side perspective view thereof; and, FIG. 8 is a bottom, front and right side perspective view thereof.

(56) **References Cited**

U.S. PATENT DOCUMENTS

D710,043 S * 7/2014 Liao D26/28
D745,728 S * 12/2015 Ruthling D26/28
D763,483 S * 8/2016 Luke D26/28
D776,842 S * 1/2017 Liao D26/28
D787,098 S * 5/2017 Landcastle D26/28
D825,794 S * 8/2018 Zheng D26/28

The broken lines and the lightened surface shading illustrate portions of the vehicle center high mount brake light that form no part of the claimed design.

1 Claim, 8 Drawing Sheets

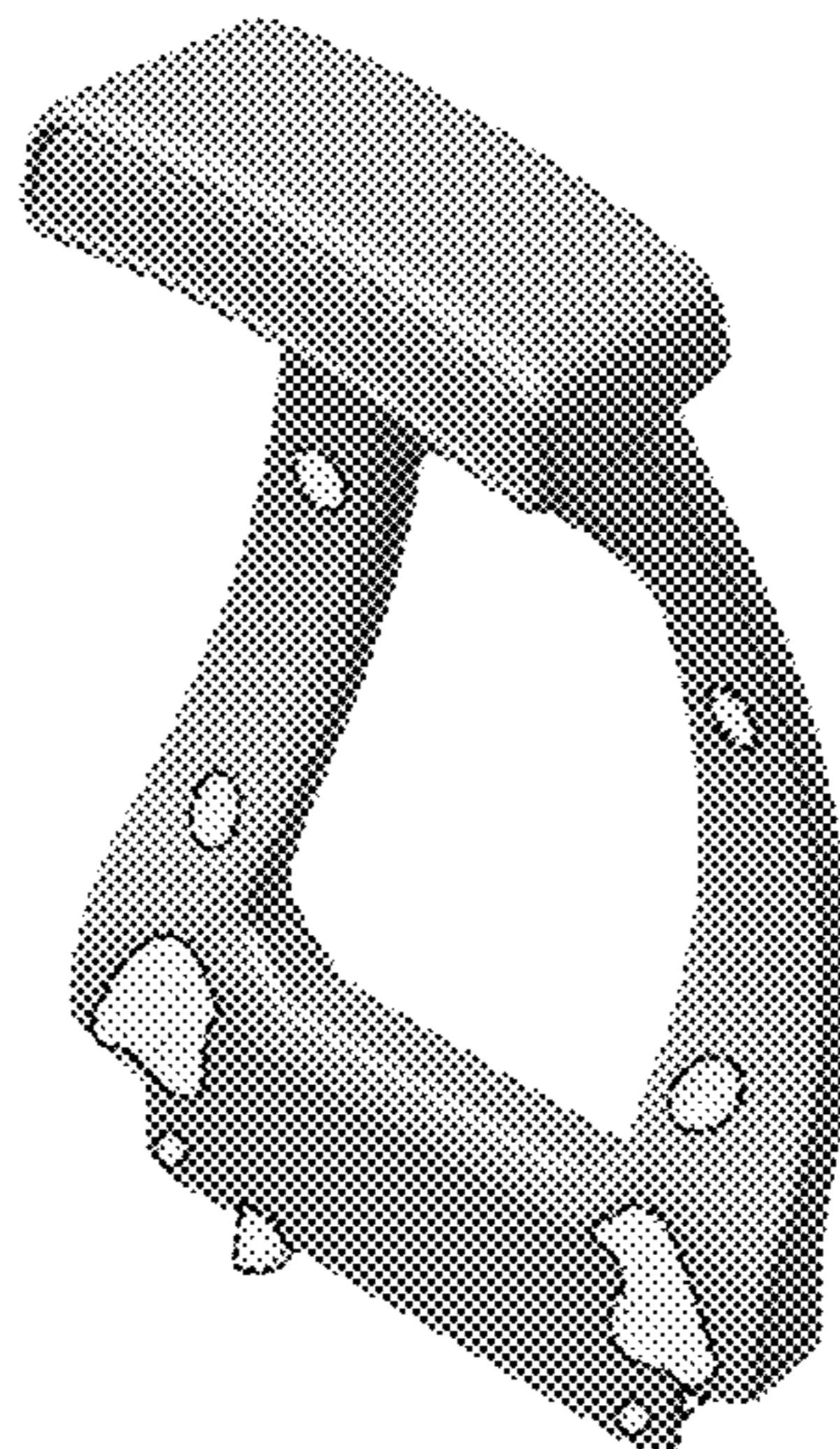

Fig. 1

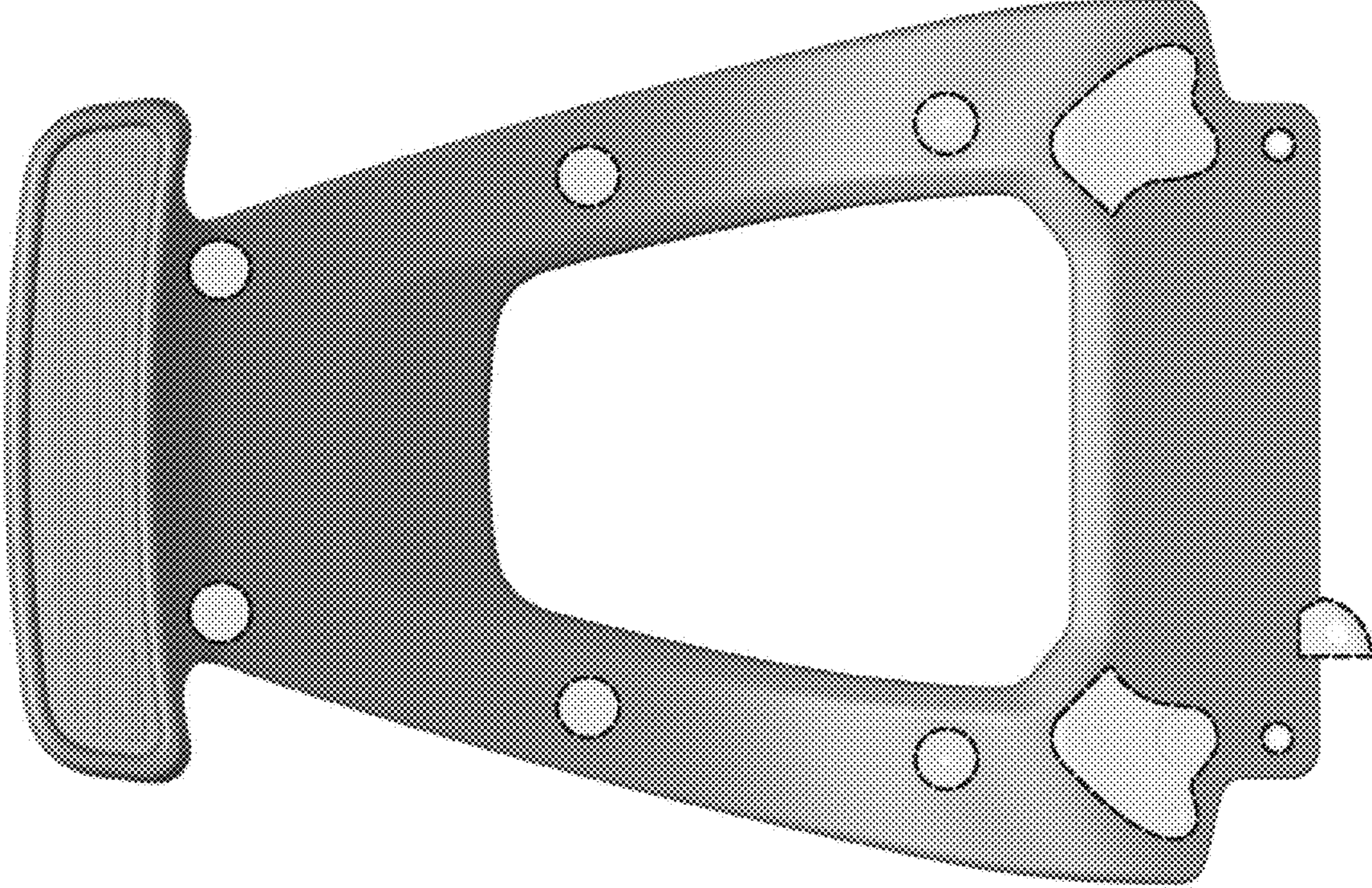
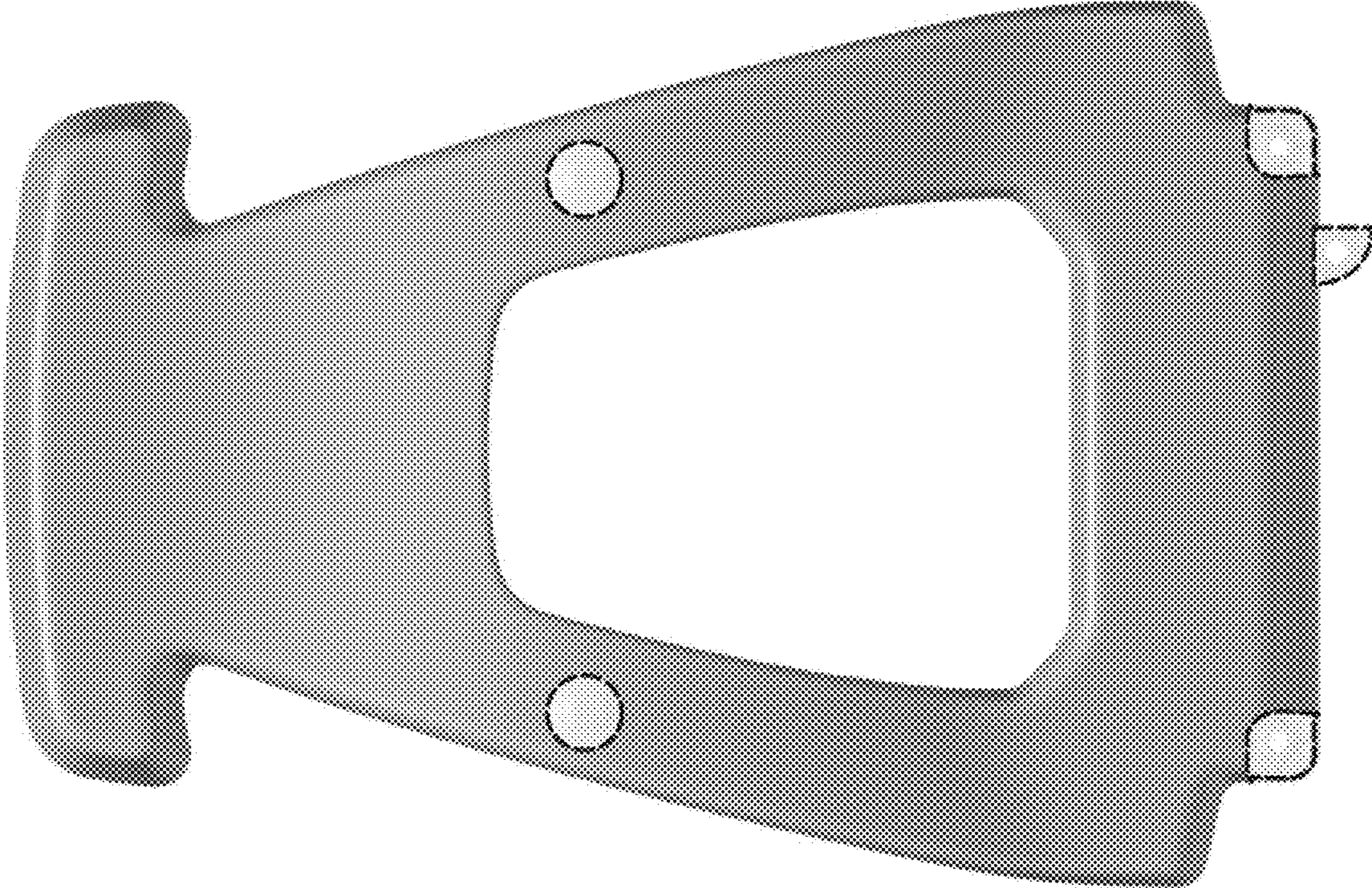

Fig. 2



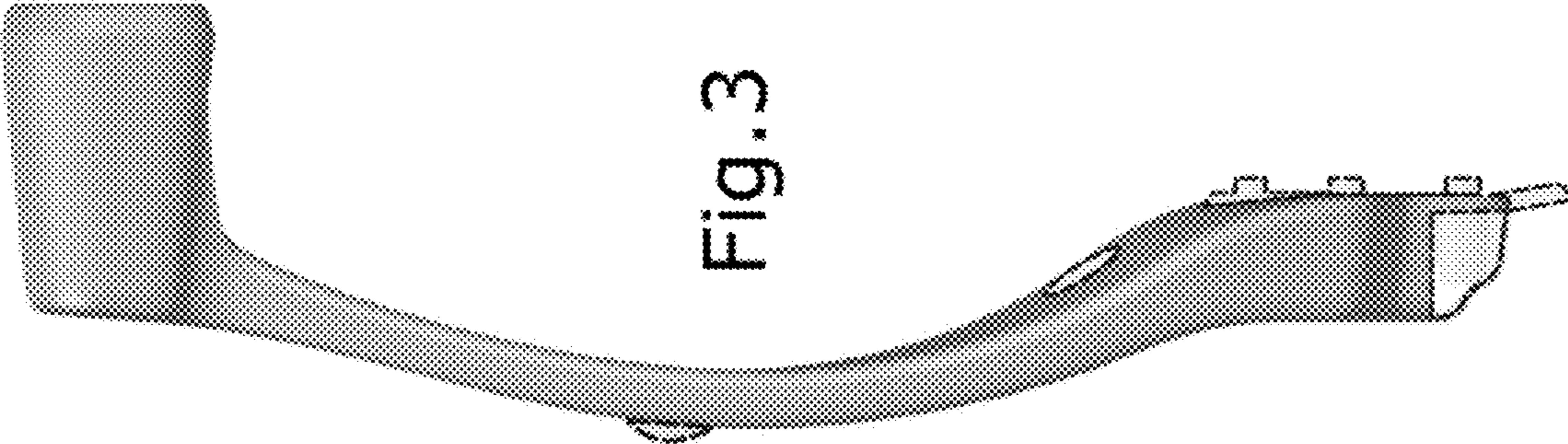

Fig. 3

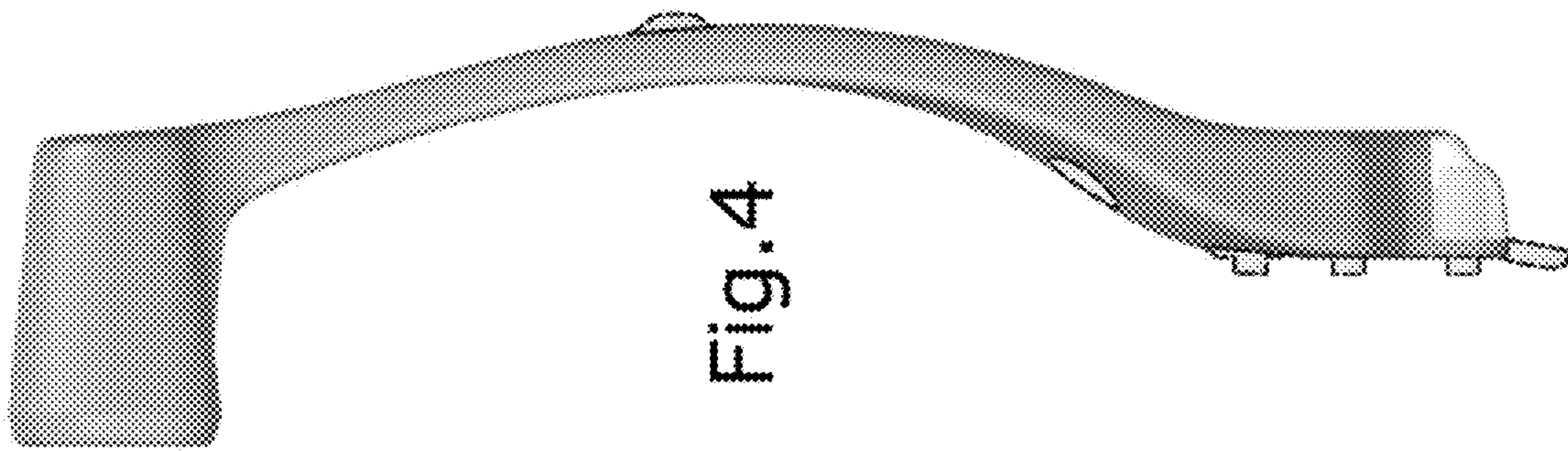

Fig.4

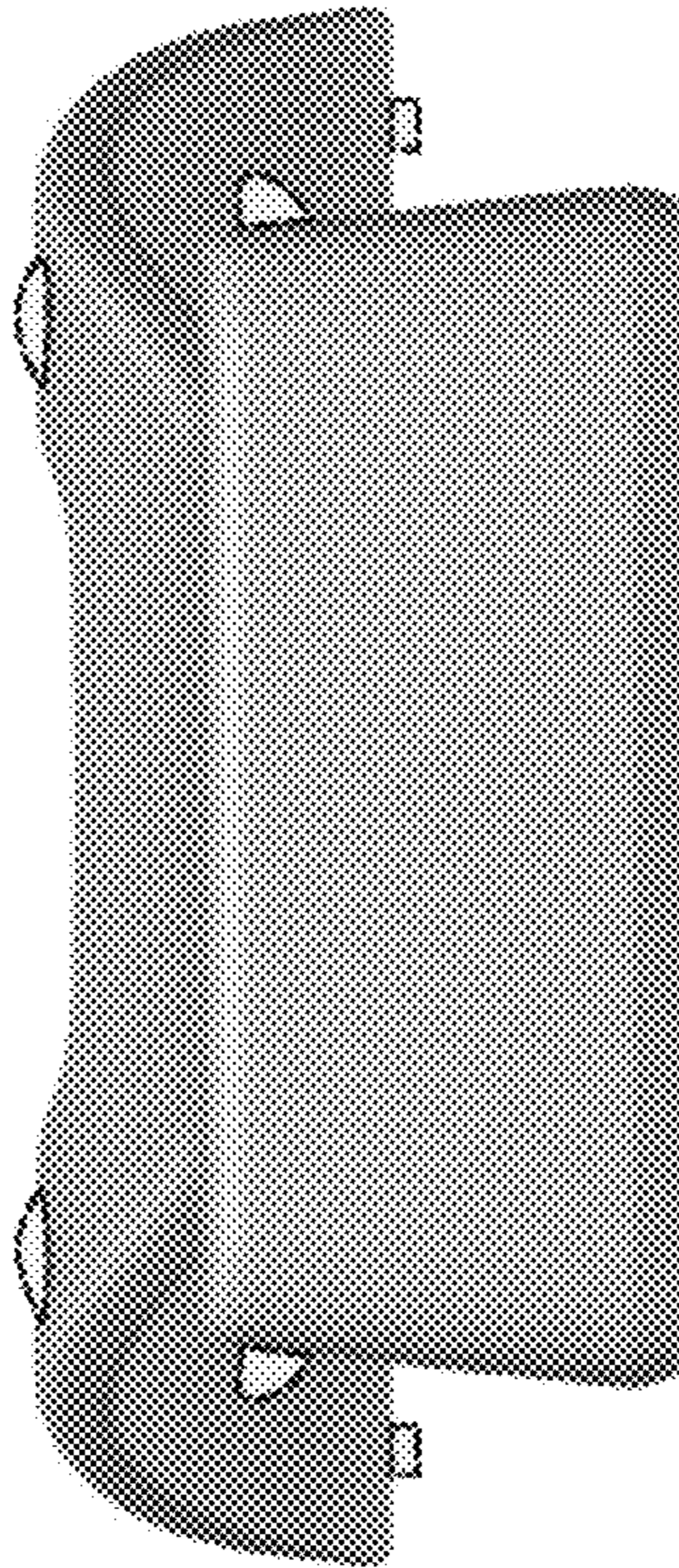

Fig. 5

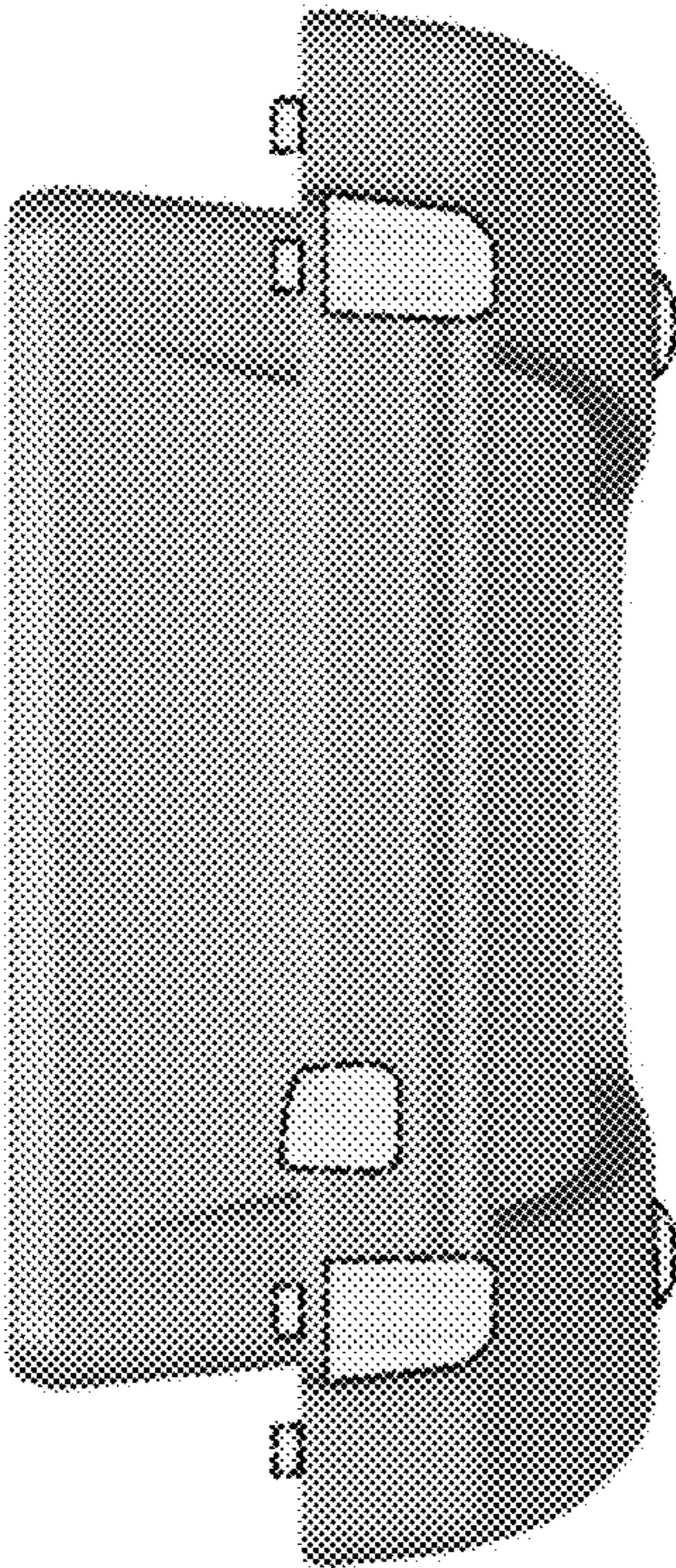

Fig. 6

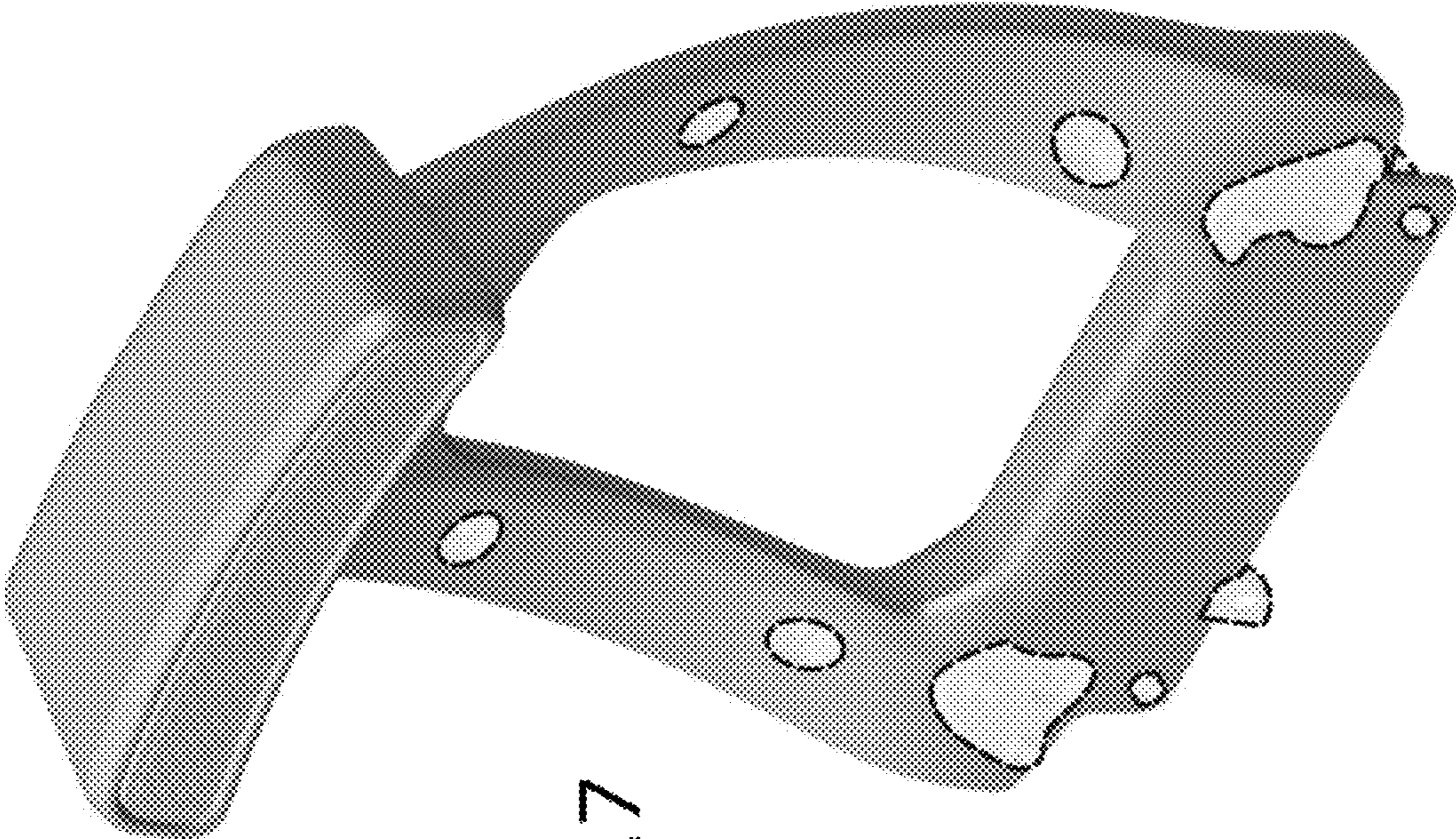

Fig. 7

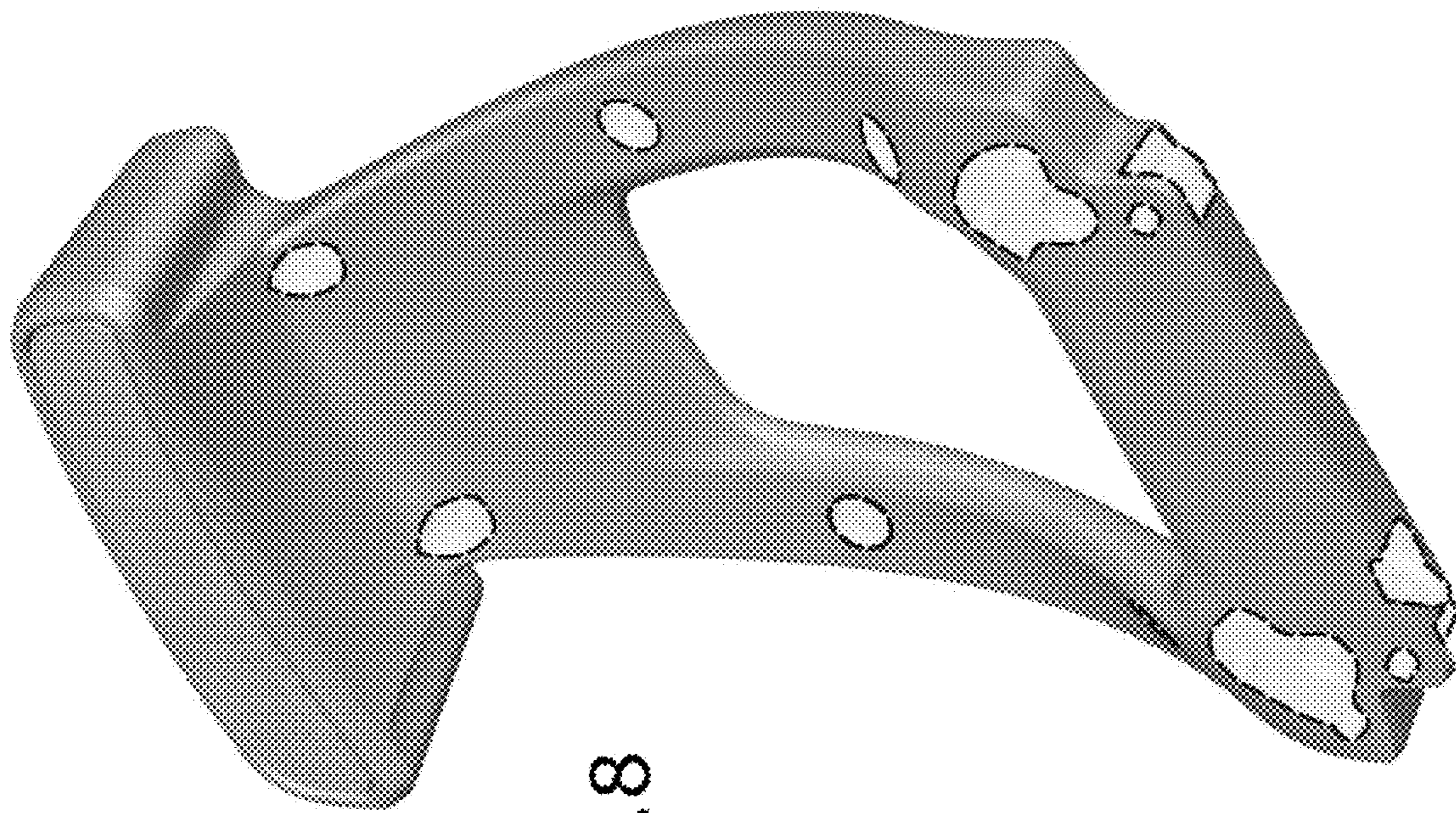

Fig. 8