



US00D935845S

(12) **United States Design Patent** (10) **Patent No.:** **US D935,845 S**  
**Chen** (45) **Date of Patent:** **\*\* Nov. 16, 2021**

(54) **SQUARE BOTTOM DOUBLE WALL TUMBLER**

(71) Applicant: **Pengcheng Chen**, Shenzhen (CN)

(72) Inventor: **Pengcheng Chen**, Shenzhen (CN)

(\*\*) Term: **15 Years**

(21) Appl. No.: **29/710,721**

(22) Filed: **Oct. 25, 2019**

(51) **LOC (13) Cl.** ..... **07-01**

(52) **U.S. Cl.**

USPC ..... **D7/510; D7/511**

(58) **Field of Classification Search**

USPC ..... D7/507, 509, 510, 511, 523, 532, 533,  
D7/536, 392.1, 396.2, 387, 608; D9/435,  
D9/449, 450, 436

CPC ..... A47G 19/22; A47G 19/2288; A47G  
19/2205; A47G 19/2272; A45F 3/20

See application file for complete search history.

(56) **References Cited**

**U.S. PATENT DOCUMENTS**

D399,392 S \* 10/1998 Husted ..... D7/511  
D557,074 S \* 12/2007 Bardolet ..... D7/509  
D667,151 S \* 9/2012 Arslanian ..... D26/9  
D770,231 S \* 11/2016 Hume ..... D7/532  
D805,352 S \* 12/2017 Thuma ..... D7/523  
D817,718 S \* 5/2018 Furneaux ..... D7/532  
D838,140 S \* 1/2019 Furneaux ..... D7/510  
D886,528 S \* 6/2020 Omdahl, II ..... D7/511  
D898,506 S \* 10/2020 Perman ..... D7/392.1  
D909,816 S \* 2/2021 Omdahl, II ..... D7/523

D915,143 S \* 4/2021 Wang ..... D7/510  
2008/0179274 A1 \* 7/2008 Cheng ..... A45F 3/16  
215/329  
2017/0121074 A1 \* 5/2017 Seiders ..... A47G 19/2272  
2020/0339314 A1 \* 10/2020 Meyers ..... A47G 19/2266

**OTHER PUBLICATIONS**

<https://www.youtube.com/watch?v=CkWXWnp-xaw> (Year: 2019).\*

\* cited by examiner

*Primary Examiner* — Jae Liang

(74) *Attorney, Agent, or Firm* — Scott H. Kaliko, Esq.;  
Kaliko & Associates, LLC

(57) **CLAIM**

The ornamental design for a square bottom double wall tumbler, as shown and described.

**DESCRIPTION**

FIG. 1 is a front perspective view of a square bottom double wall tumbler showing my new design;  
FIG. 2 is a bottom perspective view thereof;  
FIG. 3 is an exploded view thereof;  
FIG. 4 is a top view of thereof;  
FIG. 5 is a bottom view thereof;  
FIG. 6 is a side view thereof;  
FIG. 7 is a side view thereof;  
FIG. 8 is a front view thereof; and,  
FIG. 9 is a back view thereof.

The broken lines in the drawings depict the bracket portion of the exploded view only and form no part of the claimed design.

**1 Claim, 8 Drawing Sheets**

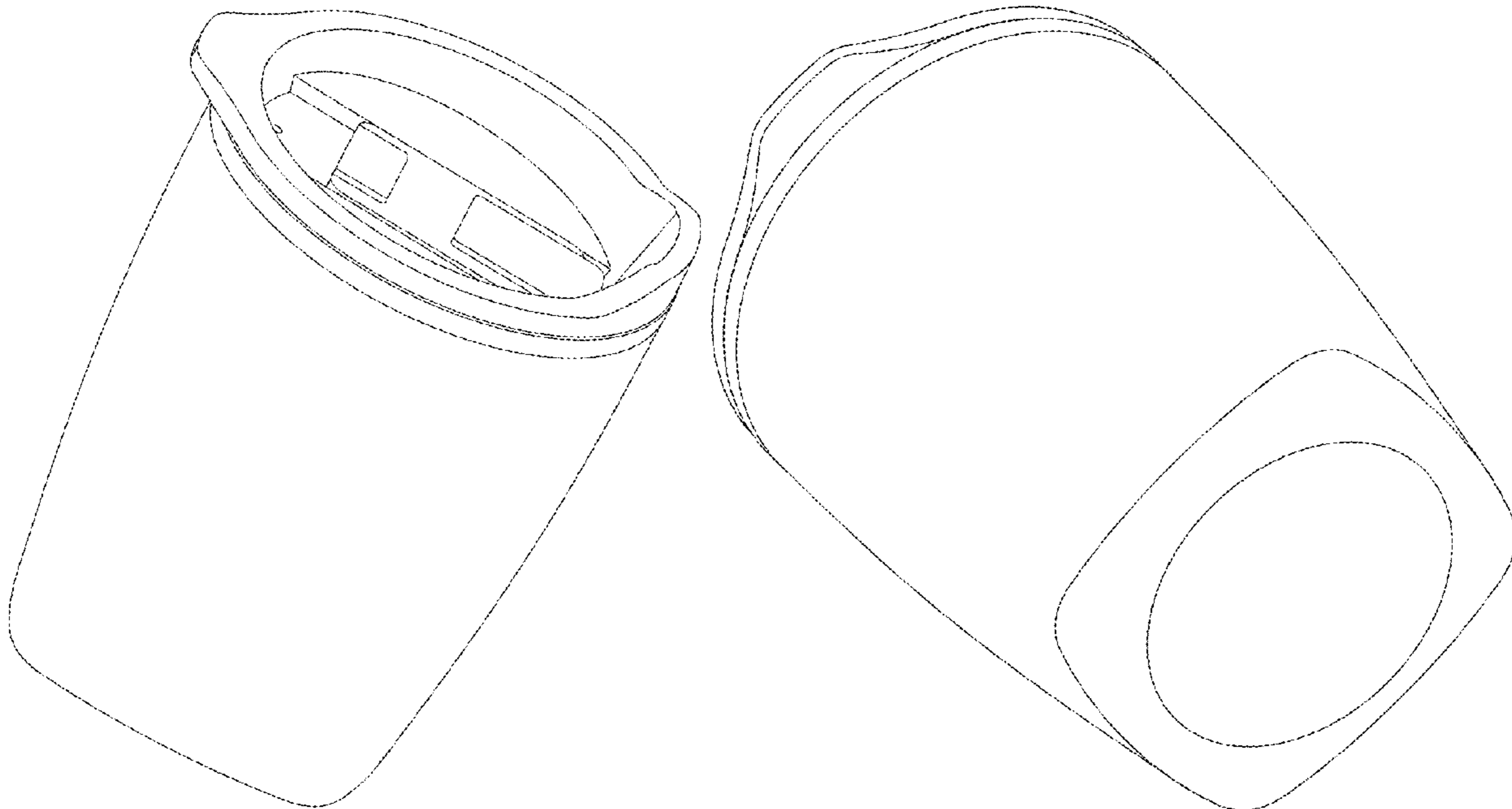

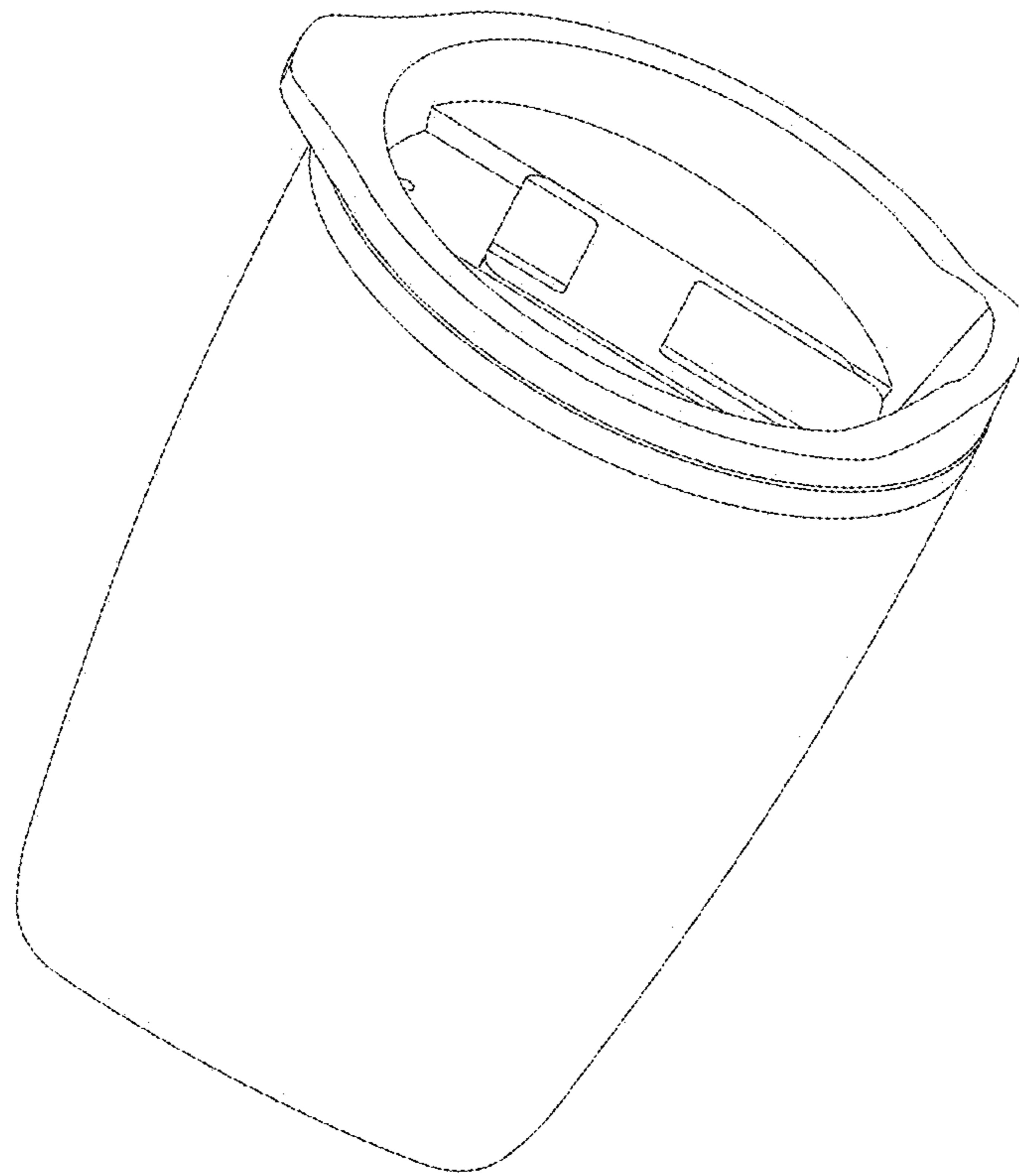

FIG 1

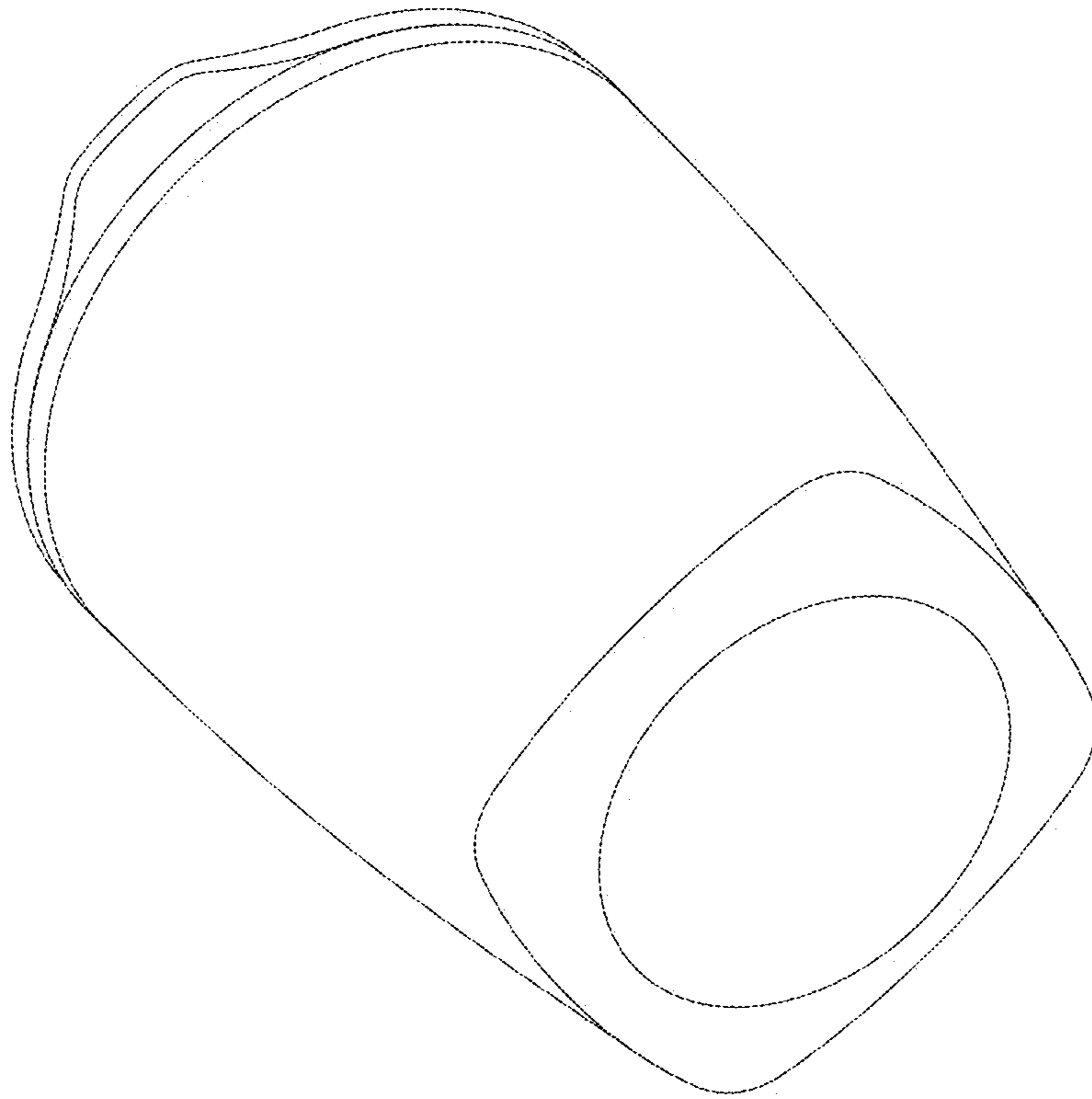

FIG 2

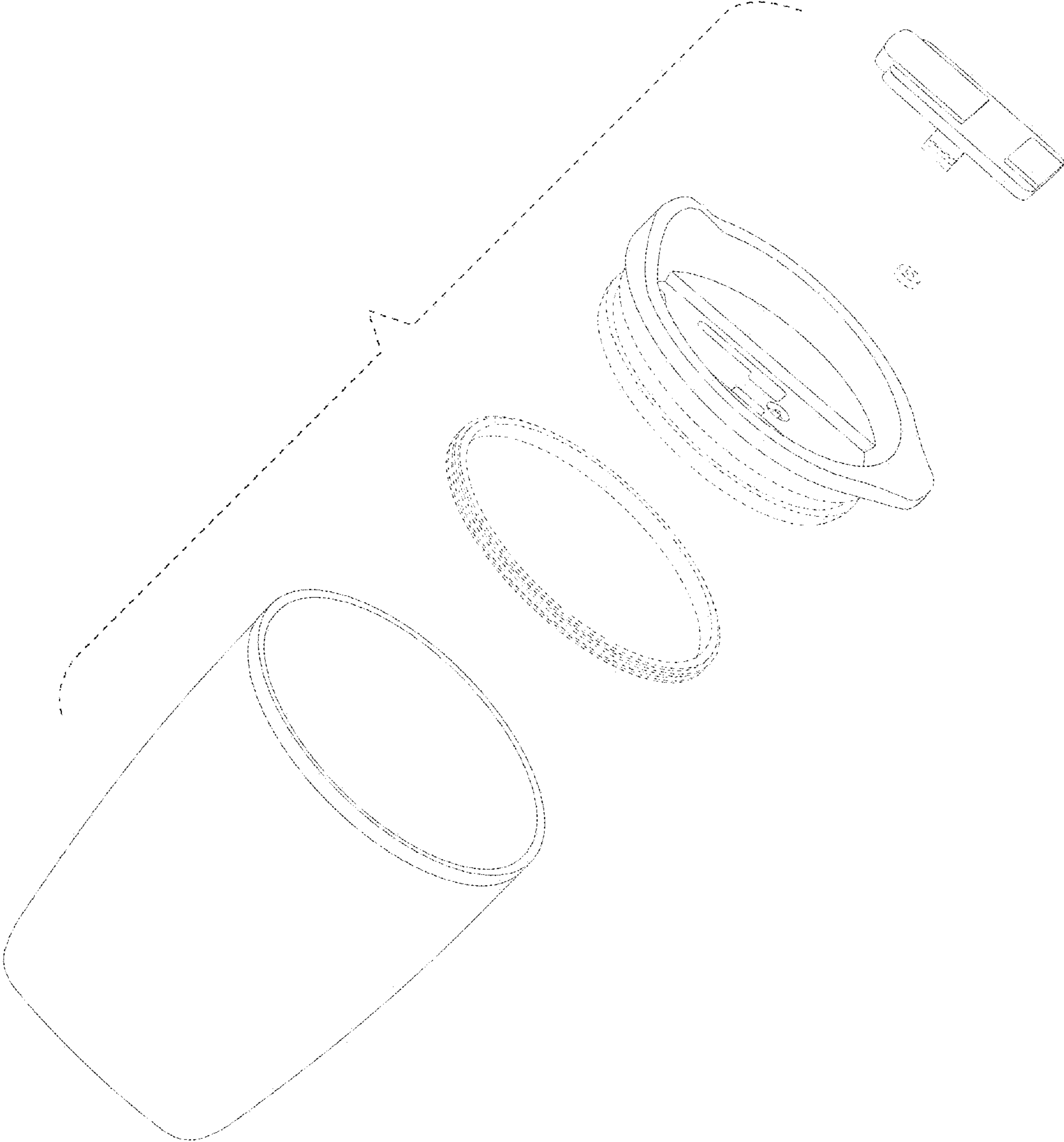

FIG 3

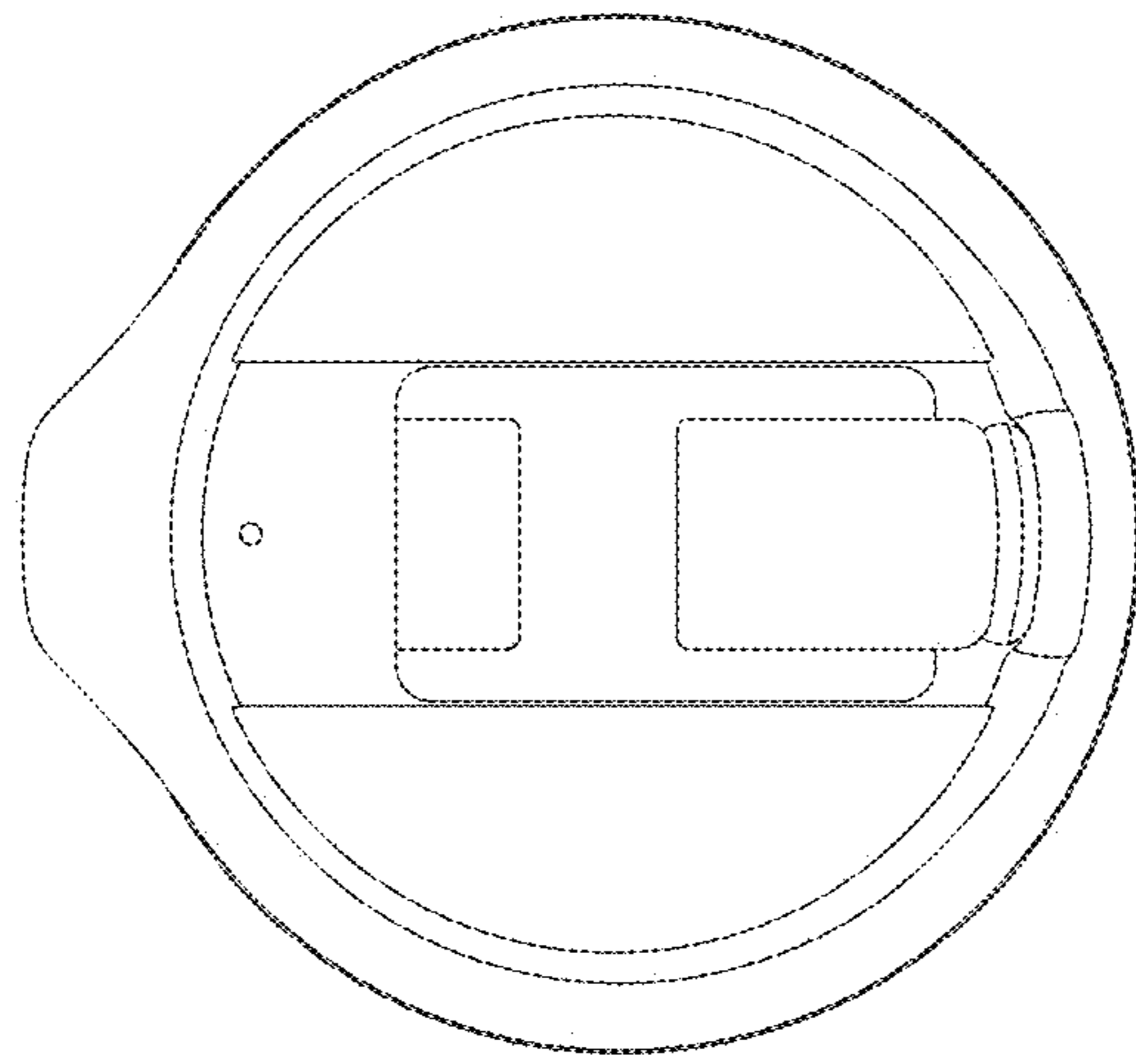

FIG 4

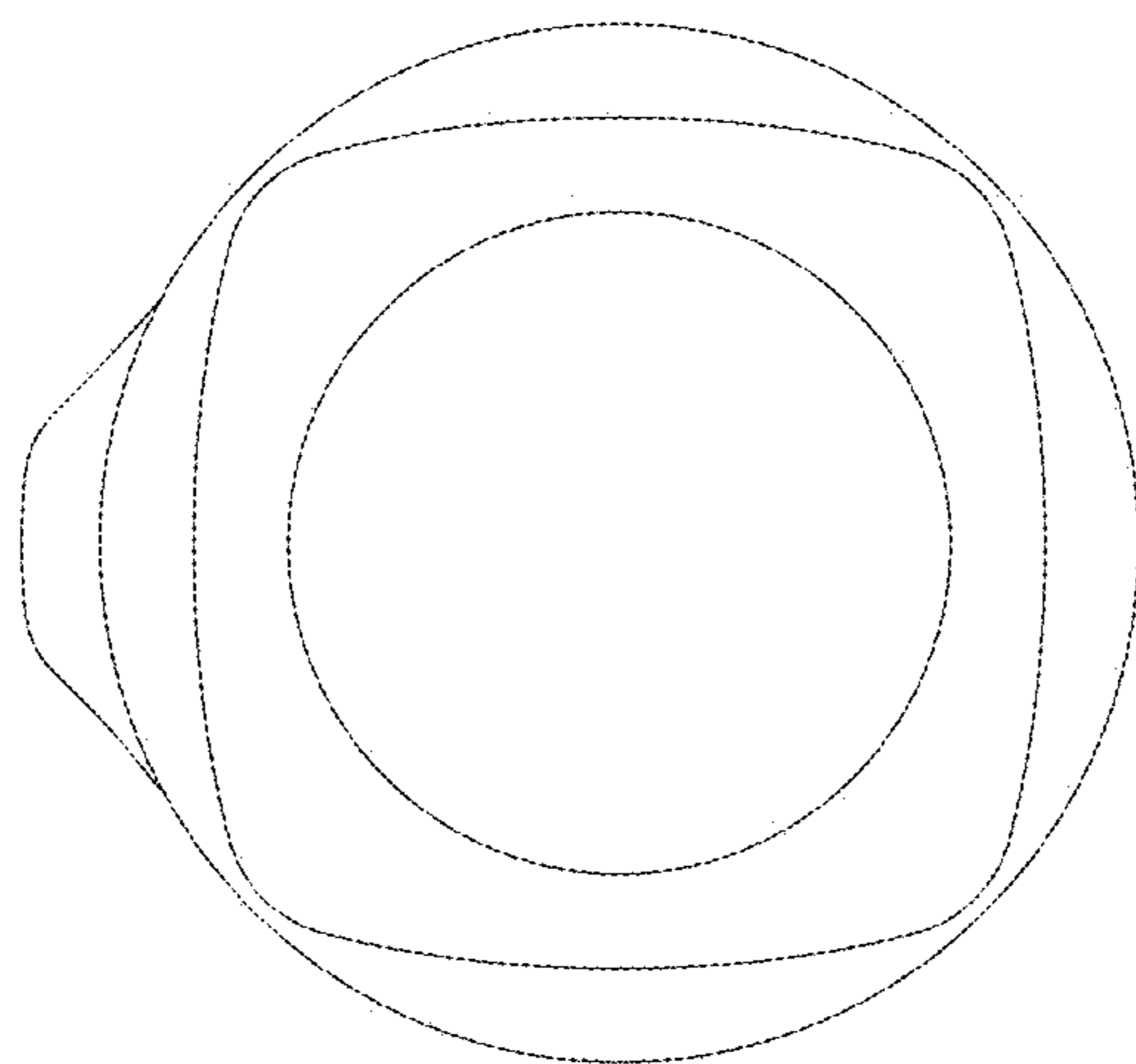

FIG 5

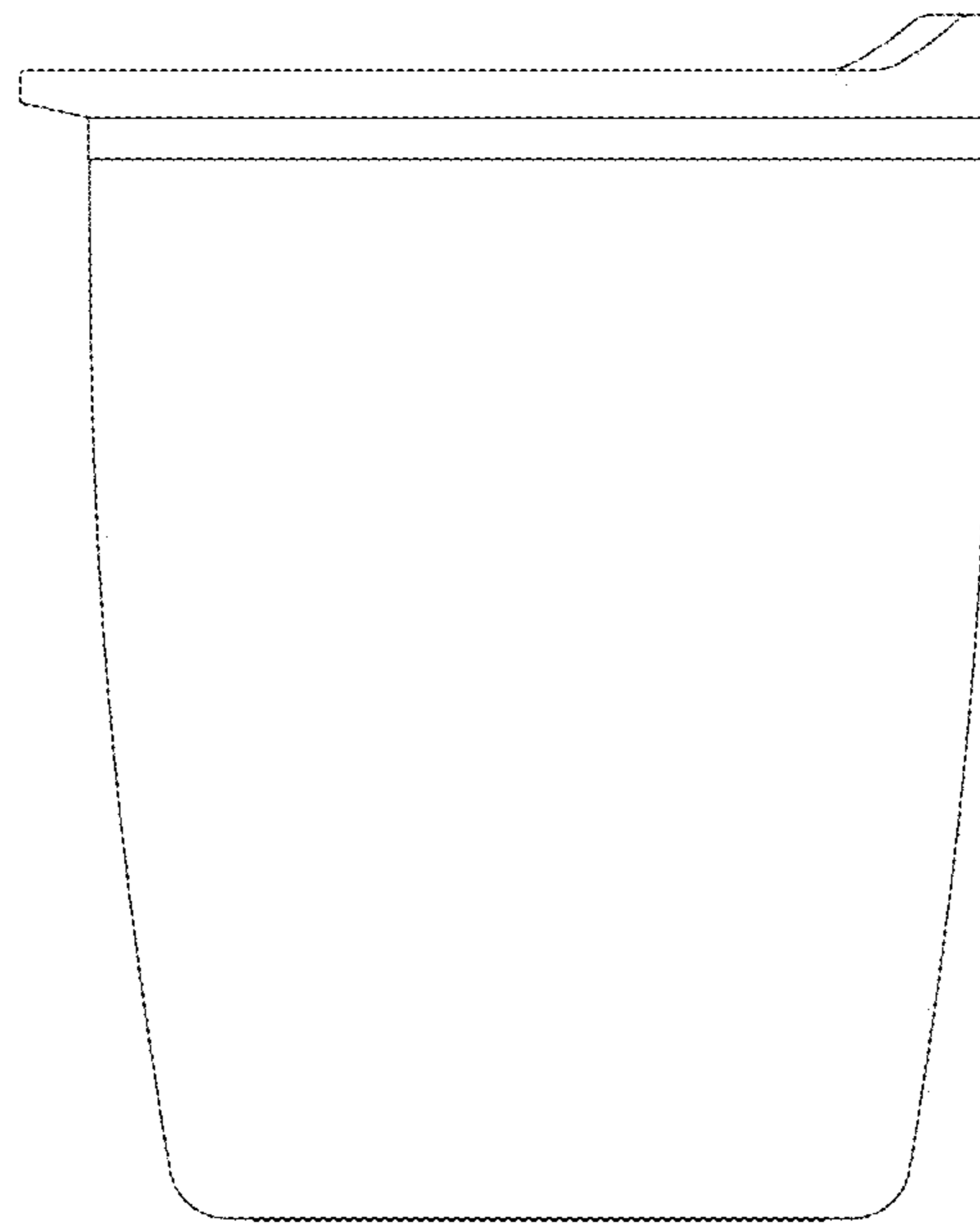

FIG 6

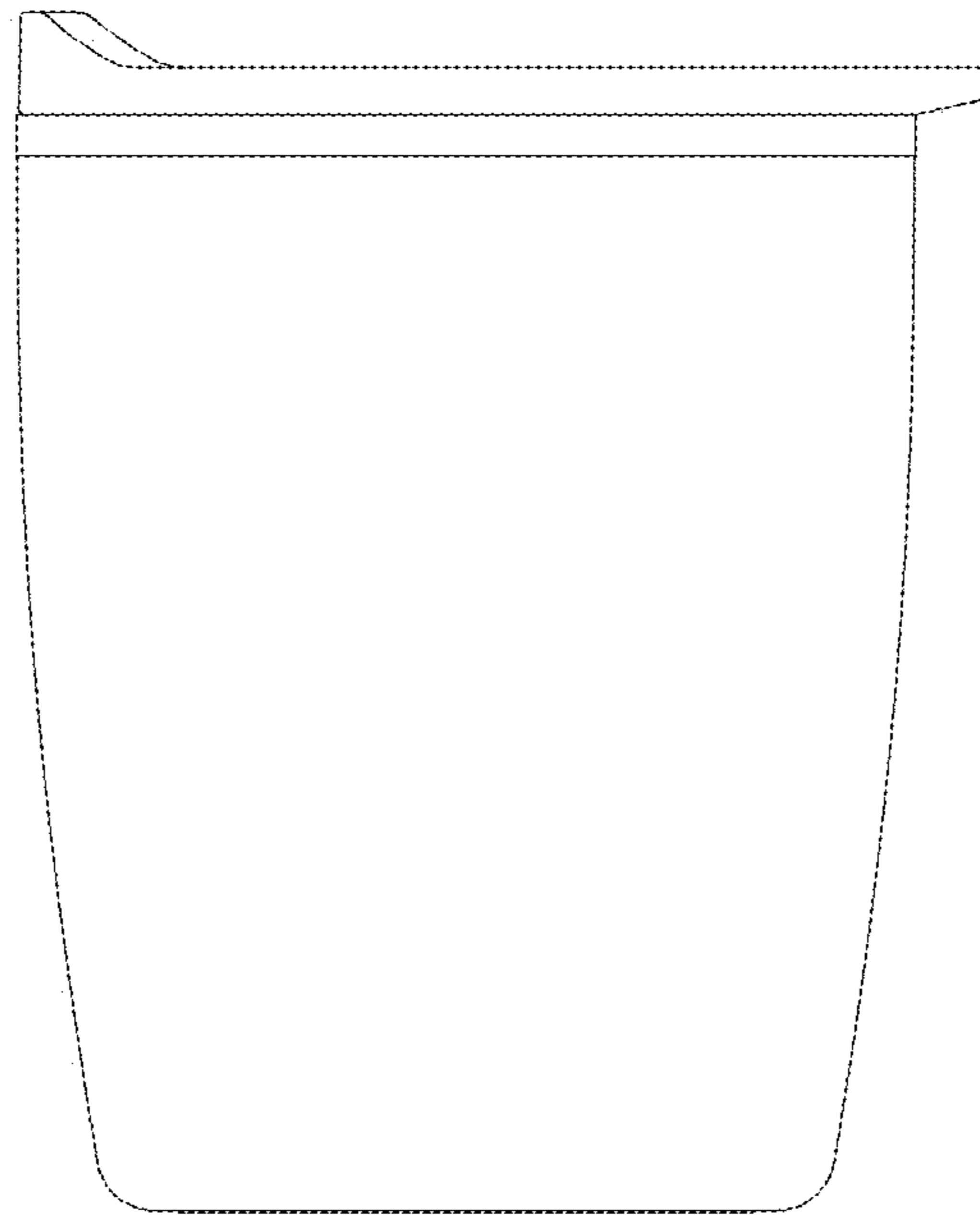

FIG 7

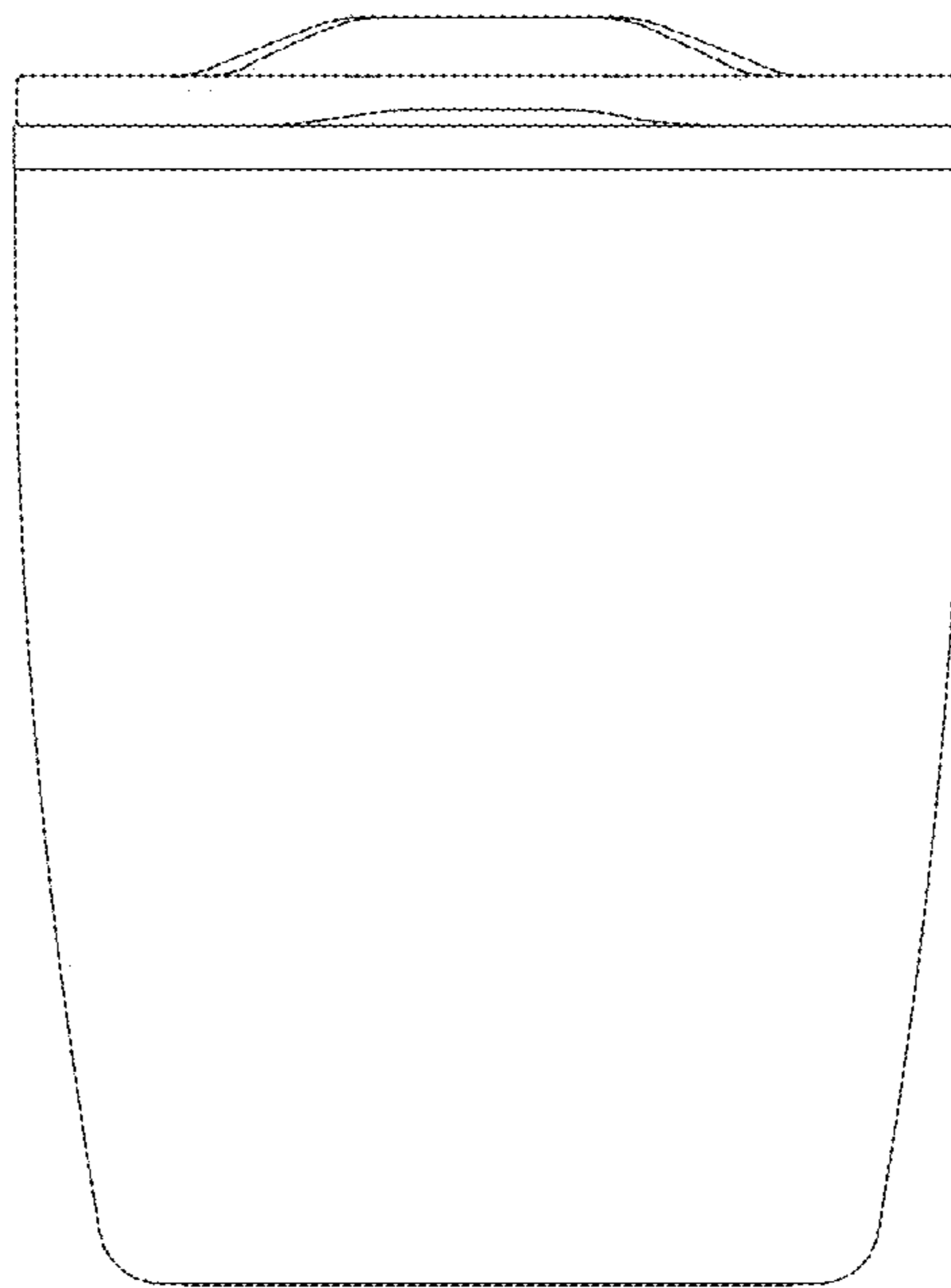

FIG 8



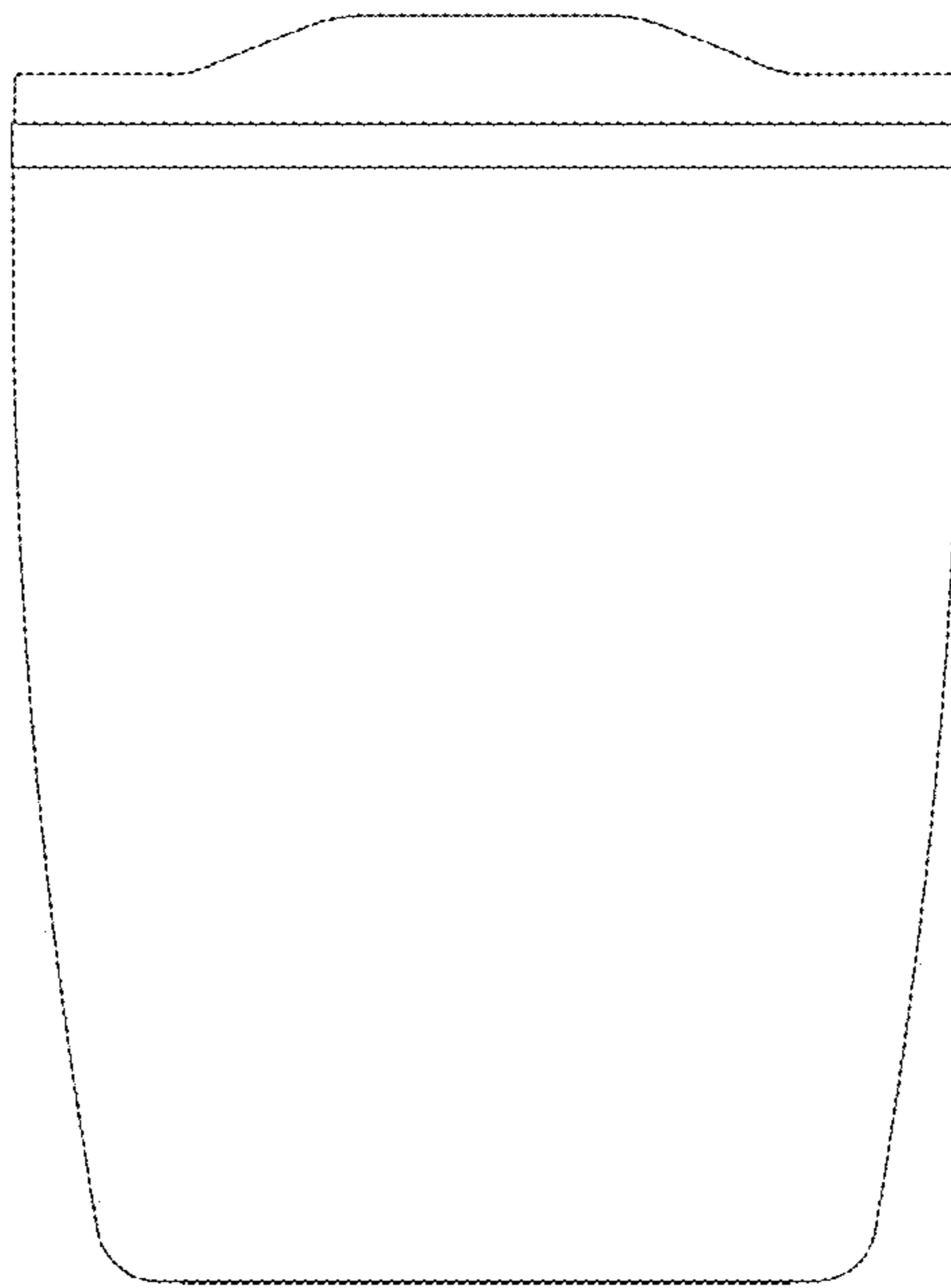

FIG 9