



US00D935803S

(12) **United States Design Patent** (10) **Patent No.:** **US D935,803 S**
Wang (45) **Date of Patent:** **** Nov. 16, 2021**

(54) **CURTAIN SET**
(71) Applicant: **Gangqiang Wang**, Zhejiang (CN)
(72) Inventor: **Gangqiang Wang**, Zhejiang (CN)
(73) Assignee: **NINGBO OCEAN TEXTILES CO., LTD**, Ningbo (CN)
(**) Term: **15 Years**
(21) Appl. No.: **29/676,149**
(22) Filed: **Jan. 9, 2019**
(51) **LOC (13) Cl.** **06-10**
(52) **U.S. Cl.**
USPC **D6/575**
(58) **Field of Classification Search**
USPC D6/575, 578-580
CPC A47H 2023/003; A47H 2023/025; A47H 2201/01; A47H 23/00; A47H 23/01; A47H 23/05; A47H 23/10; A47K 3/38
See application file for complete search history.

(56) **References Cited**
U.S. PATENT DOCUMENTS
2,594,624 A * 4/1952 Dubinsky A47H 23/02 160/123
4,070,735 A * 1/1978 Canaday A47K 3/38 160/349.2
5,240,758 A * 8/1993 Honigberg A47H 23/06 160/330
6,163,899 A * 12/2000 Leonard A47H 23/06 160/330
6,317,904 B1 * 11/2001 Samelson A47K 3/38 4/558
D876,121 S * 2/2020 Sun D6/575
D903,373 S * 12/2020 Lv D6/580
D925,393 S * 7/2021 Zijl D11/165
2003/0012924 A1 * 1/2003 Samelson A47K 3/38 428/137

2004/0031576 A1 * 2/2004 Zahner A47H 7/02 160/330
2009/0119830 A1 * 5/2009 Goskowski A47K 3/38 4/610
2010/0243181 A1 * 9/2010 O'Connor A47K 3/38 160/236

(Continued)

Primary Examiner — Kevin K Rudzinski
Assistant Examiner — Clare Ann Gannon
(74) *Attorney, Agent, or Firm* — Justin Lampel

(57) **CLAIM**

The ornamental design for the curtain set, as shown and described.

DESCRIPTION

FIG. 1 is a perspective view of the curtain set showing my new design, showing the first component with the back lining removed;
FIG. 2 is a top plan view thereof;
FIG. 3 is a rear elevational view thereof;
FIG. 4 is a bottom plan view thereof;
FIG. 5 is a right side view thereof;
FIG. 6 is a front elevational view thereof; and
FIG. 7 is a left side view thereof;
FIG. 8 is a perspective view thereof, showing the backing lining of my new design with the first component removed;
FIG. 9 is a top plan view thereof;
FIG. 10 is a rear elevational view thereof;
FIG. 11 is a bottom plan view thereof;
FIG. 12 is a right side view thereof;
FIG. 13 is a front elevational view thereof; and
FIG. 14 is a left side view thereof;
FIG. 15 is a perspective view thereof, showing the combination of back lining and first component; and,
FIG. 16 is a perspective view thereof; showing the back lining partially removed.
The broken lines illustrate portions of the curtain set that form no part of the claimed design.

1 Claim, 16 Drawing Sheets

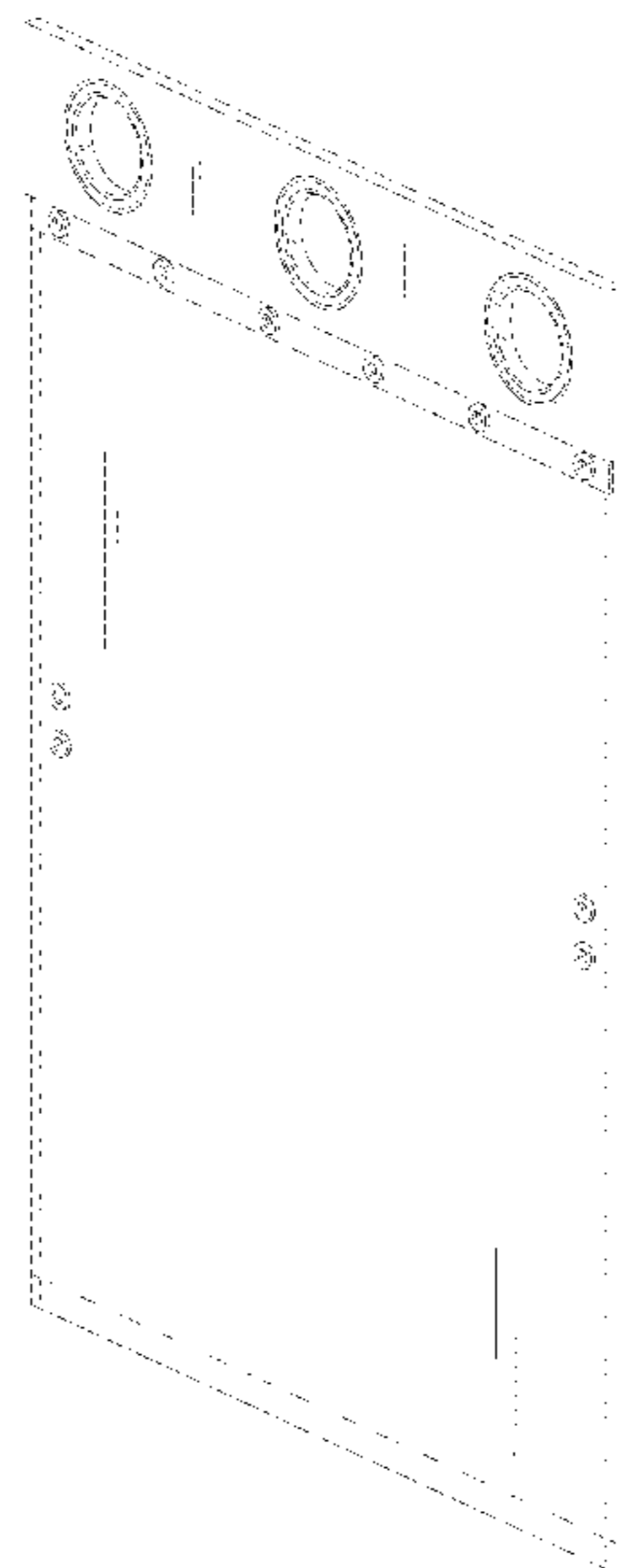

(56)

References Cited

U.S. PATENT DOCUMENTS

2013/0283519 A1* 10/2013 Holden A47H 23/00
4/558
2014/0298581 A1* 10/2014 Chenoweth A47K 3/38
4/608
2016/0106251 A1* 4/2016 Ramey A47K 3/38
4/608
2017/0086616 A1* 3/2017 Hickey A47H 23/00

* cited by examiner

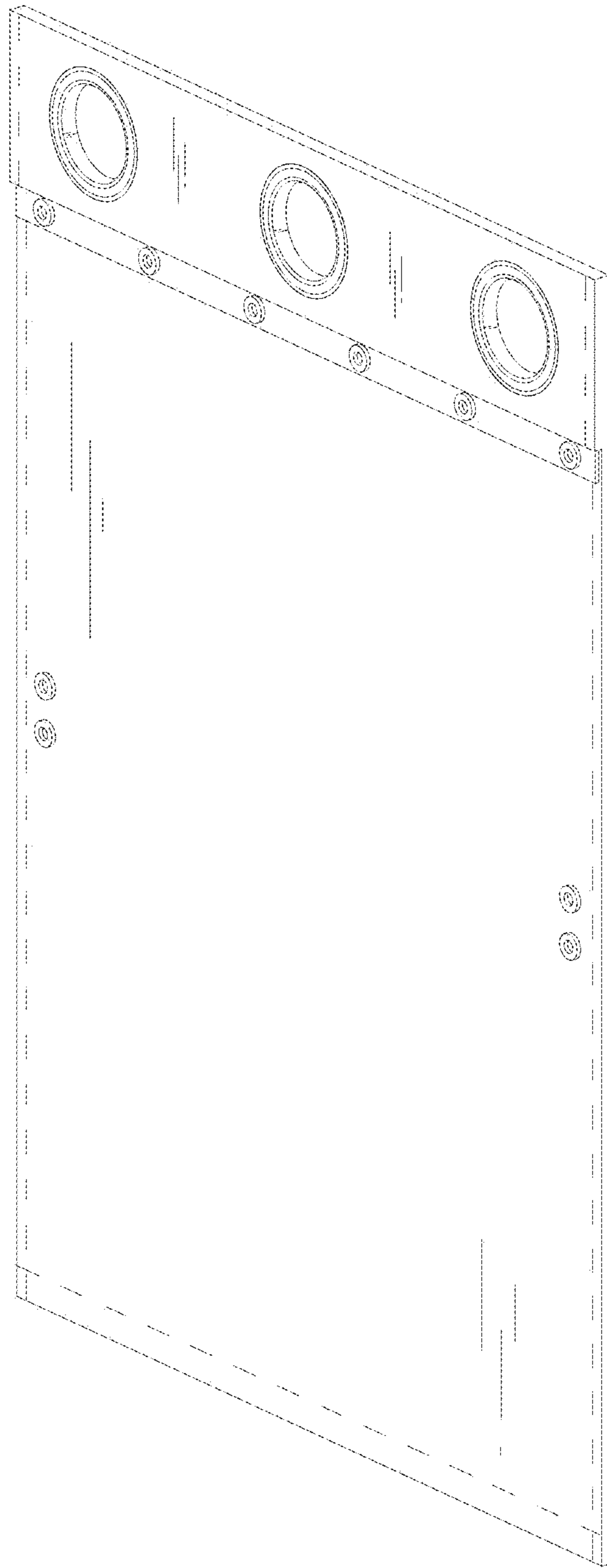

FIG.1



FIG. 2

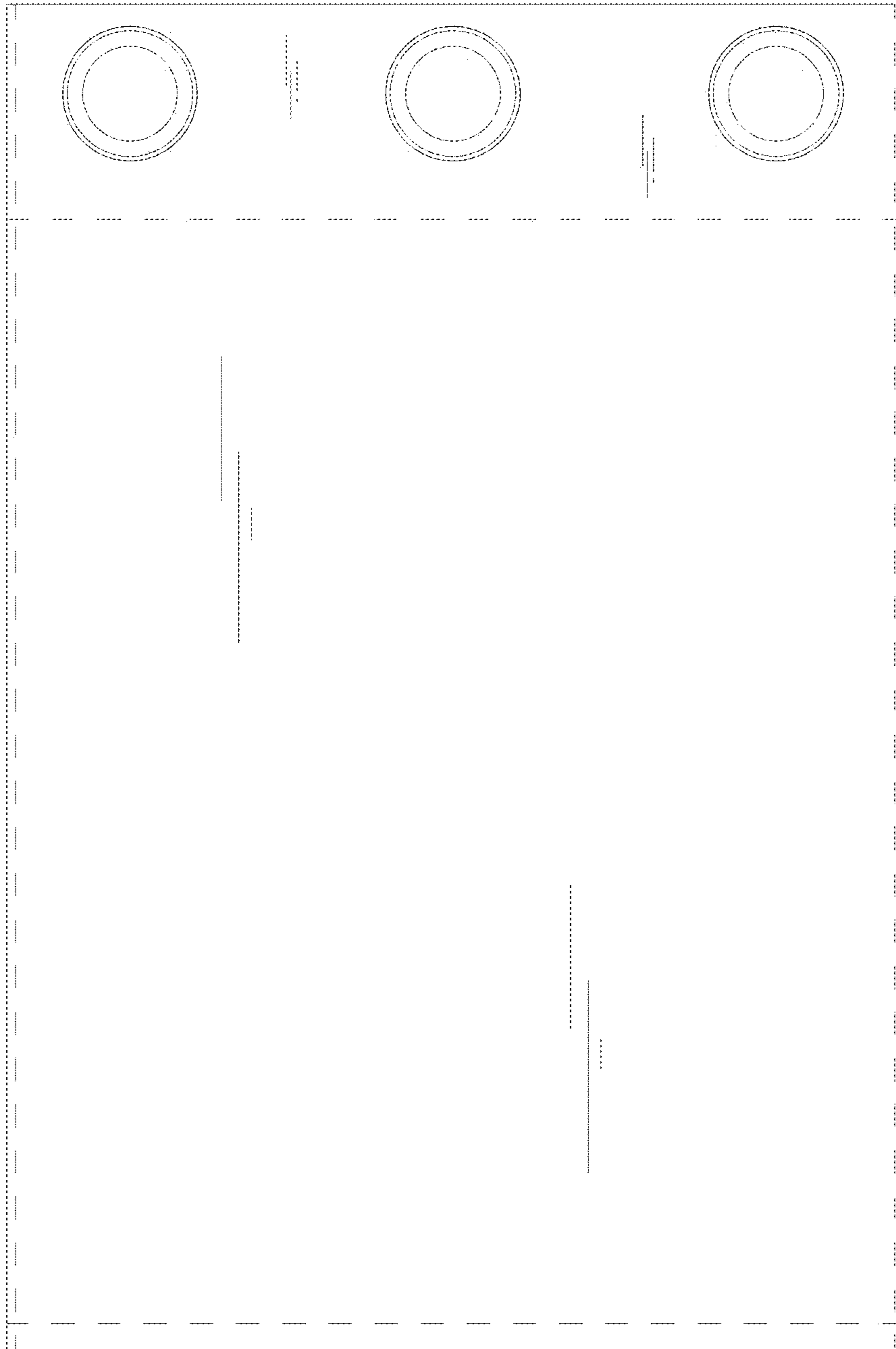

FIG. 3

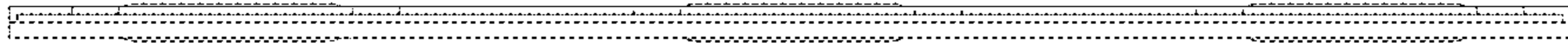

FIG. 4

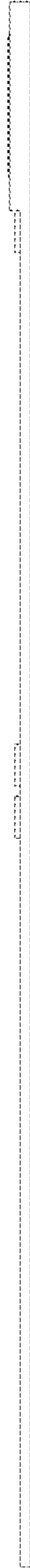

FIG.5

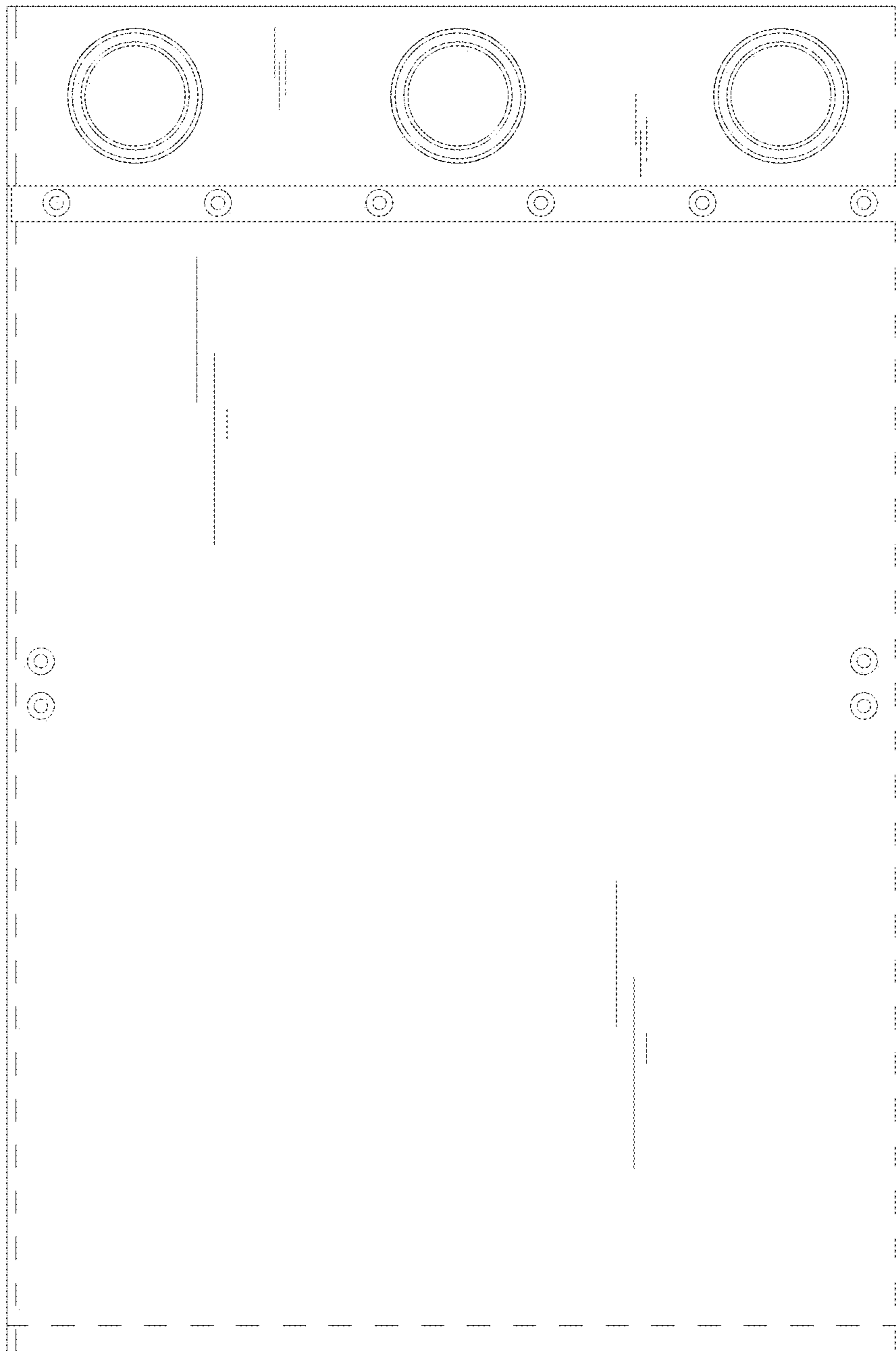

FIG. 6

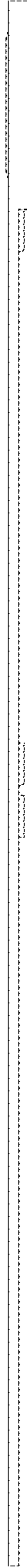

FIG.7

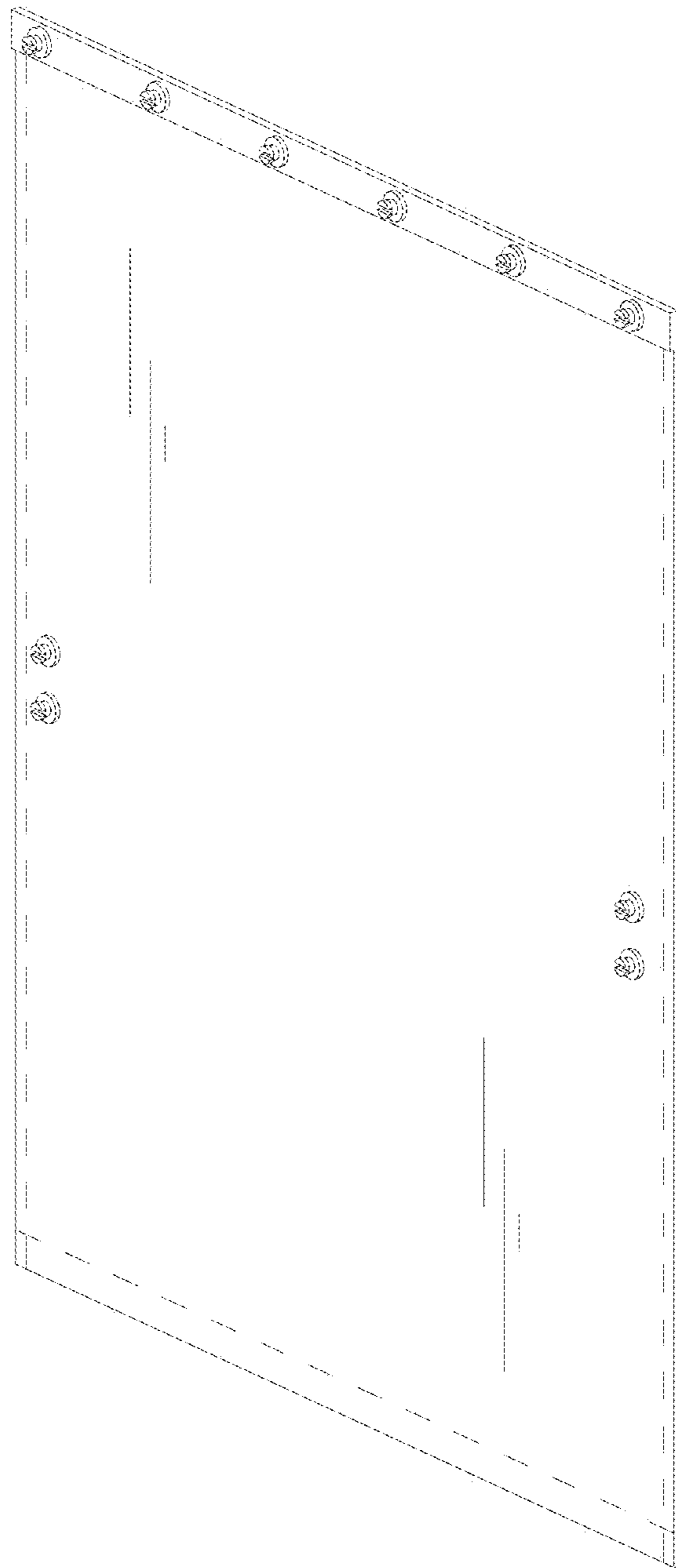

FIG.8

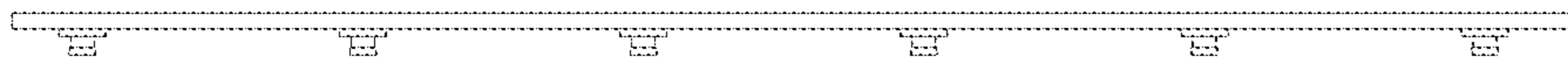

FIG.9

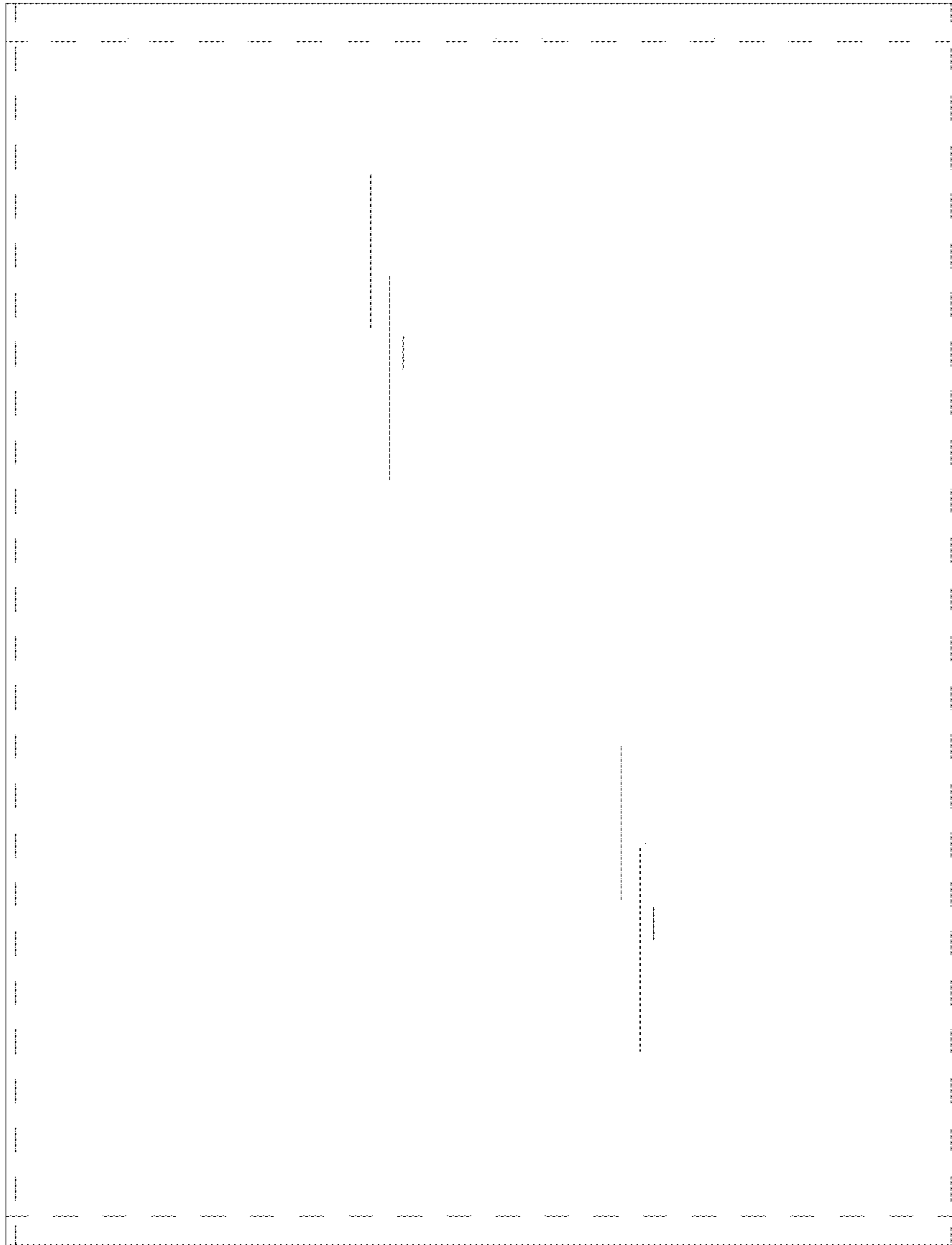

FIG.10

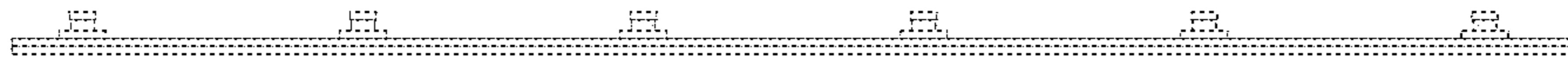

FIG.11



FIG.12

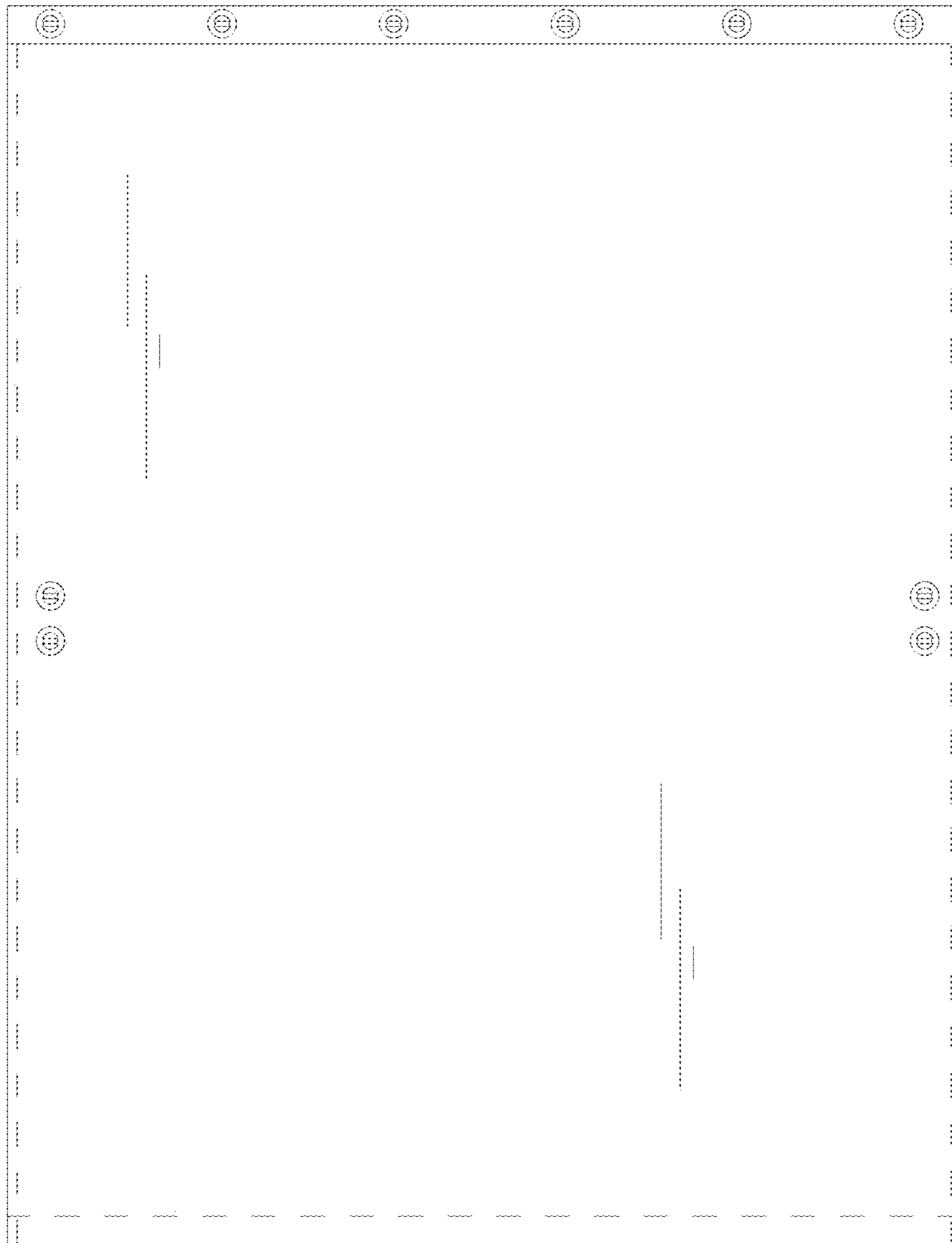

FIG.13

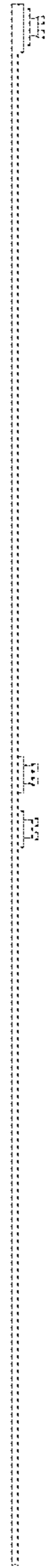

FIG.14

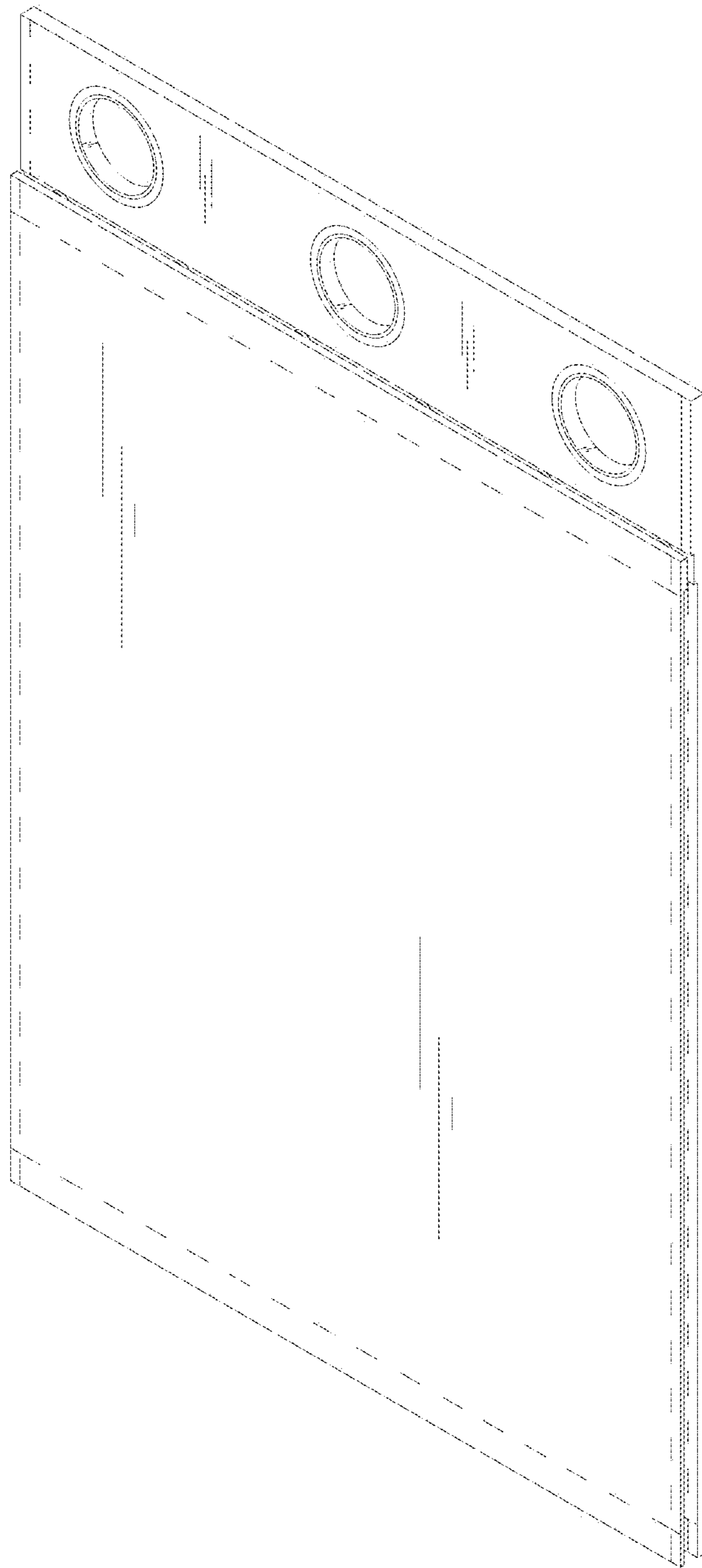

FIG.15

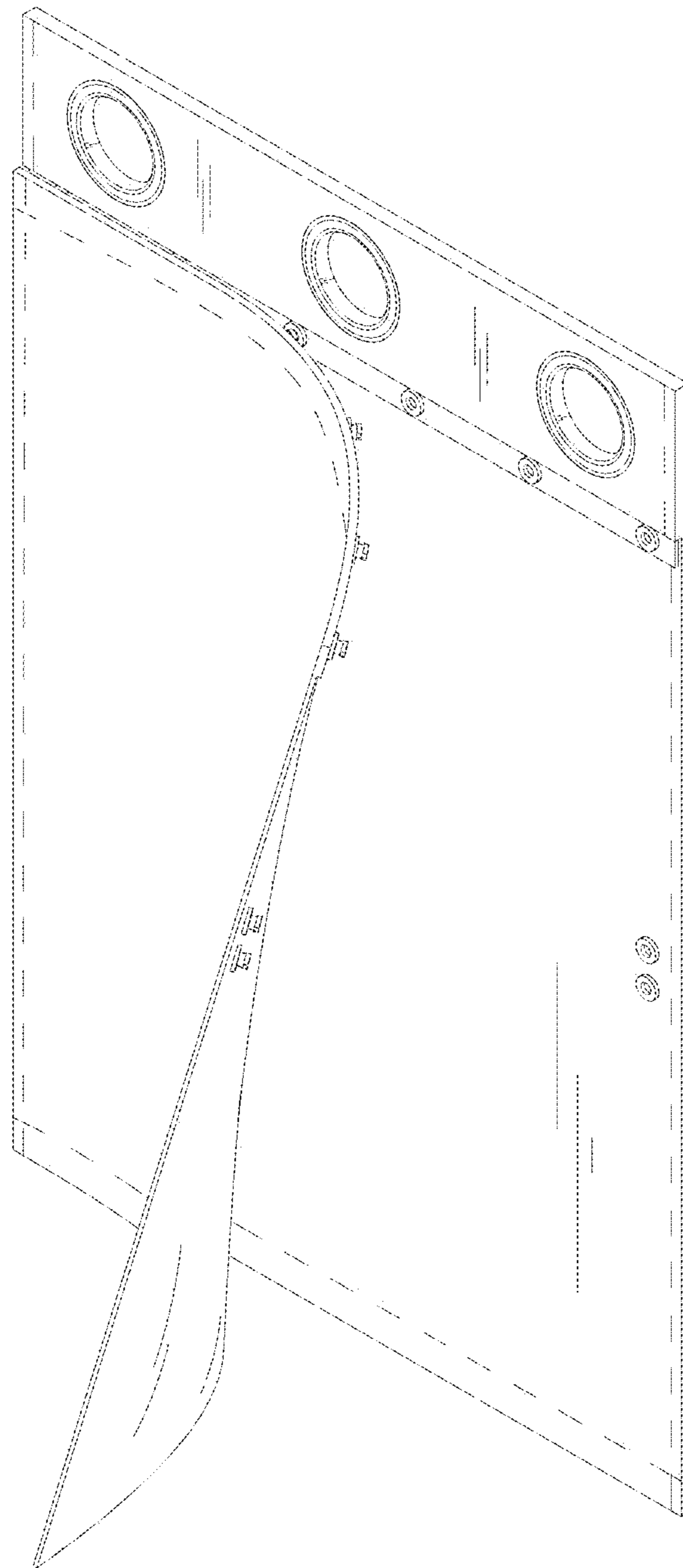

FIG.16