



US00D935601S

(12) **United States Design Patent** (10) **Patent No.:** **US D935,601 S**
Eves et al. (45) **Date of Patent:** **** Nov. 9, 2021**

(54) **PATIENT INTERFACE**

(71) Applicant: **ResMed Pty Ltd**, Bella Vista (AU)

(72) Inventors: **Matthew Eves**, Sydney (AU); **Lemmy Nga**, Sydney (AU); **Gerard Michael Rummery**, Woodford (AU); **Rupert Christian Scheiner**, Sydney (AU); **Errol Savio Alex D'Souza**, Sydney (AU)

(73) Assignee: **ResMed Pty Ltd**, Bella Vista (AU)

(**) Term: **15 Years**

(21) Appl. No.: **29/750,718**

(22) Filed: **Sep. 16, 2020**

Related U.S. Application Data

(60) Continuation of application No. 29/738,219, filed on Jun. 16, 2020, which is a division of application No. (Continued)

(51) **LOC (13) Cl.** **29-02**

(52) **U.S. Cl.**
USPC **D24/110.4**

(58) **Field of Classification Search**
USPC D24/110-110.6, 127, 129; D29/110 (Continued)

(56) **References Cited**

U.S. PATENT DOCUMENTS

5,647,356 A 7/1997 Barnett et al.
5,647,357 A 7/1997 Barnett et al.
(Continued)

OTHER PUBLICATIONS

U.S. Appl. No. 29/663,680, filed Sep. 18, 2018 of Matthew Eves et al. for "Patient Interface and/or Components Thereof," (parent application).

(Continued)

Primary Examiner — Sheryl Lane

Assistant Examiner — Aula Soroush

(74) *Attorney, Agent, or Firm* — Nixon & Vanderhye P.C.

(57) **CLAIM**

The ornamental design for a patient interface, as shown and described.

DESCRIPTION

FIG. 1 is a front perspective view of a patient interface showing a first embodiment of our new design, in which a shroud and a frame of a cushion module are shown in an exploded configuration;

FIG. 2 is a perspective front view thereof, in which the shroud and the frame of the cushion module are shown in an assembled configuration;

FIG. 3 is a front elevation view thereof;

FIG. 4 is a rear elevation view thereof;

FIG. 5 is a top plan view thereof;

FIG. 6 is a bottom plan view thereof;

FIG. 7 is a left side elevation view thereof;

FIG. 8 is a right side elevation view thereof;

FIG. 9 is rear perspective view thereof;

FIG. 10 is a front perspective view of a patient interface showing a second embodiment of our new design, in which a shroud and a frame of a cushion module are shown in an exploded configuration;

FIG. 11 is a perspective front view thereof, in which the shroud and the frame of the cushion module are shown in an assembled configuration;

FIG. 12 is a front elevation view thereof;

FIG. 13 is a rear elevation view thereof;

FIG. 14 is a top plan view thereof;

FIG. 15 is a bottom plan view thereof;

FIG. 16 is a left side elevation view thereof;

FIG. 17 is a right side elevation view thereof; and,

FIG. 18 is rear perspective view thereof.

The broken lines in the drawings depict portions of the patent interface that form no part of the claimed design. The dotted lines in the drawings depict the bounds of the claim and form no part of the claimed design.

1 Claim, 18 Drawing Sheets

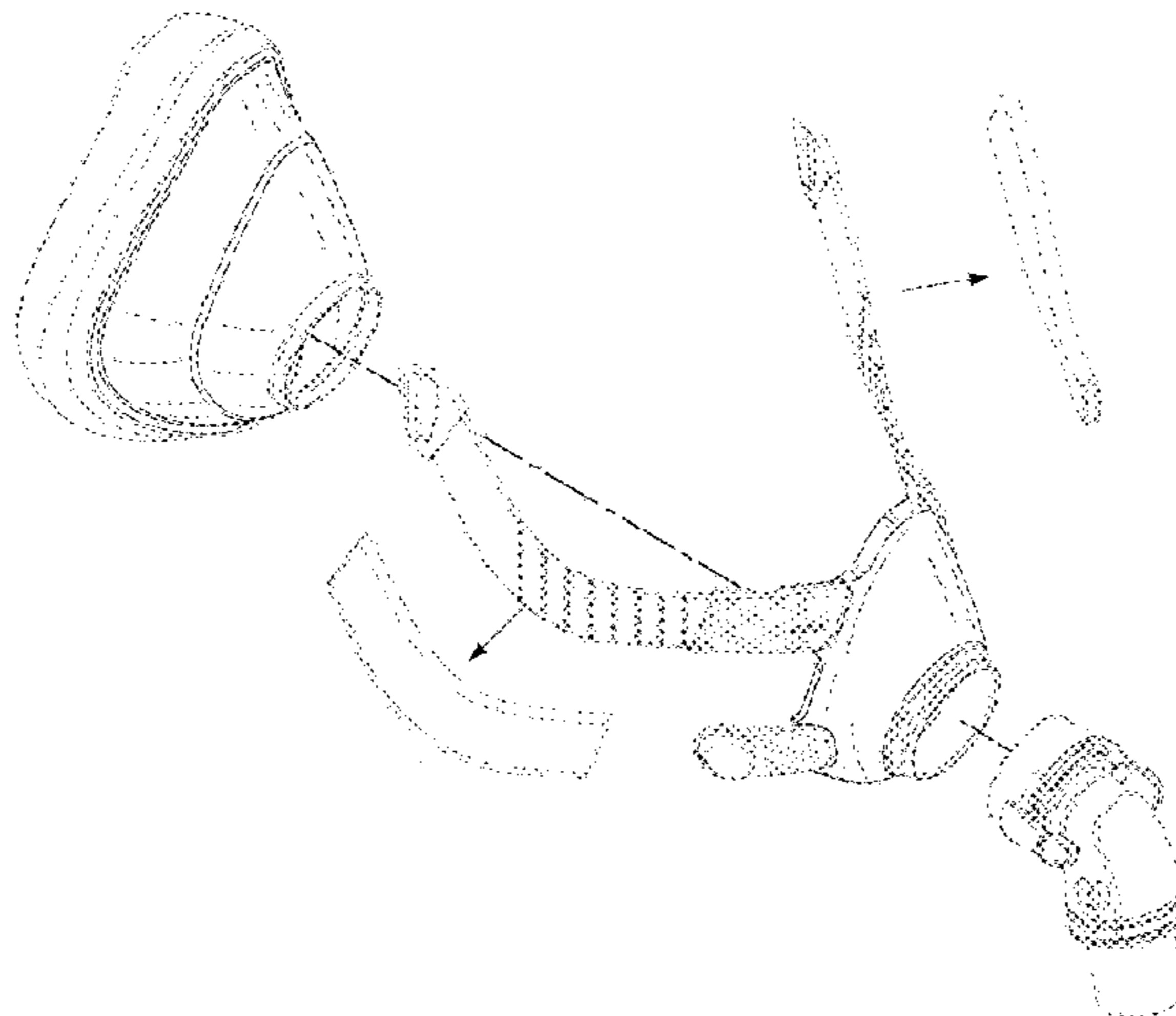

Related U.S. Application Data

29/663,680, filed on Sep. 18, 2018, now Pat. No. Des. 891,610, which is a division of application No. 29/581,900, filed on Oct. 24, 2016, now Pat. No. Des. 895,105.

(58) **Field of Classification Search**

CPC A61M 16/0616; A61M 16/0633; A61M 16/06; A61M 16/0666; A61M 16/0683; A61M 16/0605; A61M 16/0622; A61M 16/0644; A61M 16/0875; A61M 16/0816; A61M 16/08; B63C 11/205; B63C 11/16; B63C 11/186; B63C 11/12

See application file for complete search history.

(56) **References Cited**

U.S. PATENT DOCUMENTS

5,662,101	A	9/1997	Ogden et al.
5,884,624	A	3/1999	Barnett et al.
6,651,663	B2	11/2003	Barnett et al.
6,729,333	B2	5/2004	Barnett et al.
D493,885	S	8/2004	Raje
6,959,710	B2	11/2005	Barnett et al.
7,210,481	B1	5/2007	Lovell et al.
7,703,457	B2	4/2010	Barnett et al.
D619,701	S	7/2010	Edwards
D635,247	S	3/2011	Scheiner et al.
D665,494	S	8/2012	Stallard
D679,799	S	4/2013	D'Souza et al.
D693,460	S	11/2013	Rothermel
D693,462	S	11/2013	Rothermel
D694,875	S	12/2013	D'Souza
D695,887	S	12/2013	Ozolins
D700,697	S	3/2014	Ho
D703,807	S	4/2014	Chu
D707,349	S	6/2014	D'Souza
D717,942	S	11/2014	Neff
9,119,931	B2	9/2015	D'Souza et al.
D751,188	S	3/2016	Skipper
RE45,985	E	4/2016	McAuley
D754,328	S	4/2016	Bowsher
D760,379	S	6/2016	Smith et al.
D767,755	S	9/2016	D'Souza
D769,440	S	10/2016	Amarasinghe
9,757,533	B2	9/2017	Ng et al.

D809,131	S	1/2018	Law
D843,560	S	3/2019	D'Souza
D884,152	S *	5/2020	Law D24/110.4
D891,610	S *	7/2020	Eves D24/110.4
D895,105	S *	9/2020	Eves D24/110.4
D901,674	S *	11/2020	D'Souza D24/110.4
D906,514	S *	12/2020	Law D24/110.4
10,864,342	B2 *	12/2020	Henry A61M 16/06
2005/0172969	A1	8/2005	Ging
2006/0042629	A1	3/2006	Geist
2007/0277828	A1	12/2007	Ho
2008/0047561	A1	2/2008	Fu
2008/0066757	A1	3/2008	Stallard
2008/0257354	A1	10/2008	Davidson
2008/0314390	A1	12/2008	Kwok
2010/0051034	A1	3/2010	Howard
2011/0146684	A1	6/2011	Wells
2012/0204879	A1	8/2012	Cariola
2012/0204881	A1	8/2012	Davidson
2012/0222680	A1	9/2012	Eves
2013/0324788	A1	12/2013	Holley
2013/0327336	A1	12/2013	Burnham
2014/0026888	A1	1/2014	Matula, Jr.
2014/0083429	A1	3/2014	Rothermel
2014/0150800	A1	6/2014	Zeijlstra
2014/0216462	A1	8/2014	Law
2014/0261427	A1	9/2014	Foote
2014/0261435	A1	9/2014	Rothermel
2014/0290663	A1	10/2014	Rothermel
2014/0311496	A1	10/2014	Rothermel
2015/0000671	A1	1/2015	Frerichs
2016/0082214	A1	3/2016	Barlow et al.
2016/0325067	A1	11/2016	Harwood
2017/0368288	A1	12/2017	Stephens
2017/0368289	A1	12/2017	Baiko
2018/0021536	A1	1/2018	Ng

OTHER PUBLICATIONS

U.S. Appl. No. 29/581,900, filed Oct. 24, 2016 of Matthew Eves et al. for "Patient Interface and/or Components Thereof," (parent application).
 U.S. Appl. No. 29/739,219, filed Jun. 16, 2020 of Matthew Eves et al. for "Patient Interface and/or Components Thereof," (parent application).
 U.S. Appl. No. 62/969,747, filed Feb. 4, 2020 of Tumul Gupta et al, entitled "Plenum Chamber Insert for Patient Interface," 301 pages.

* cited by examiner

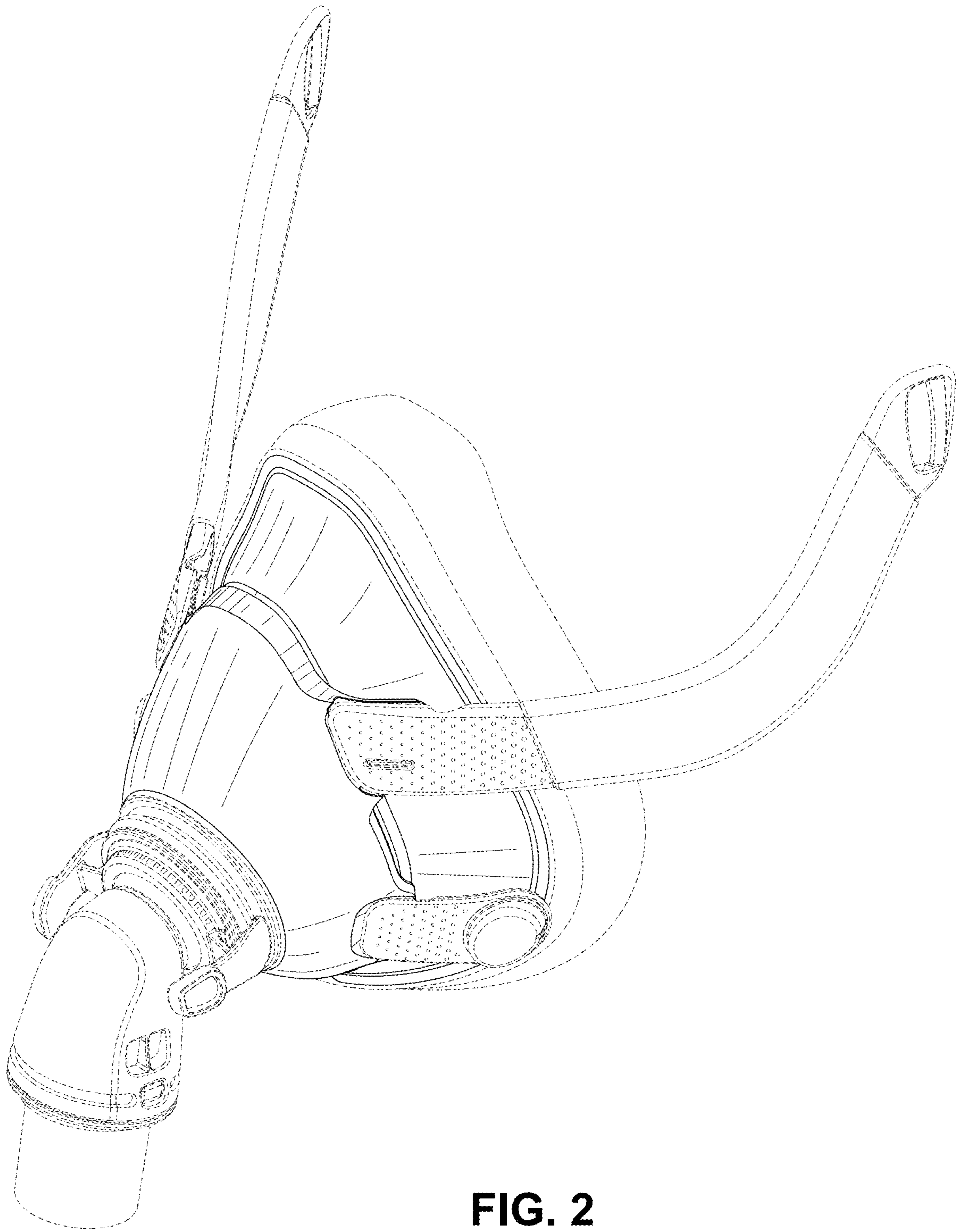

FIG. 2

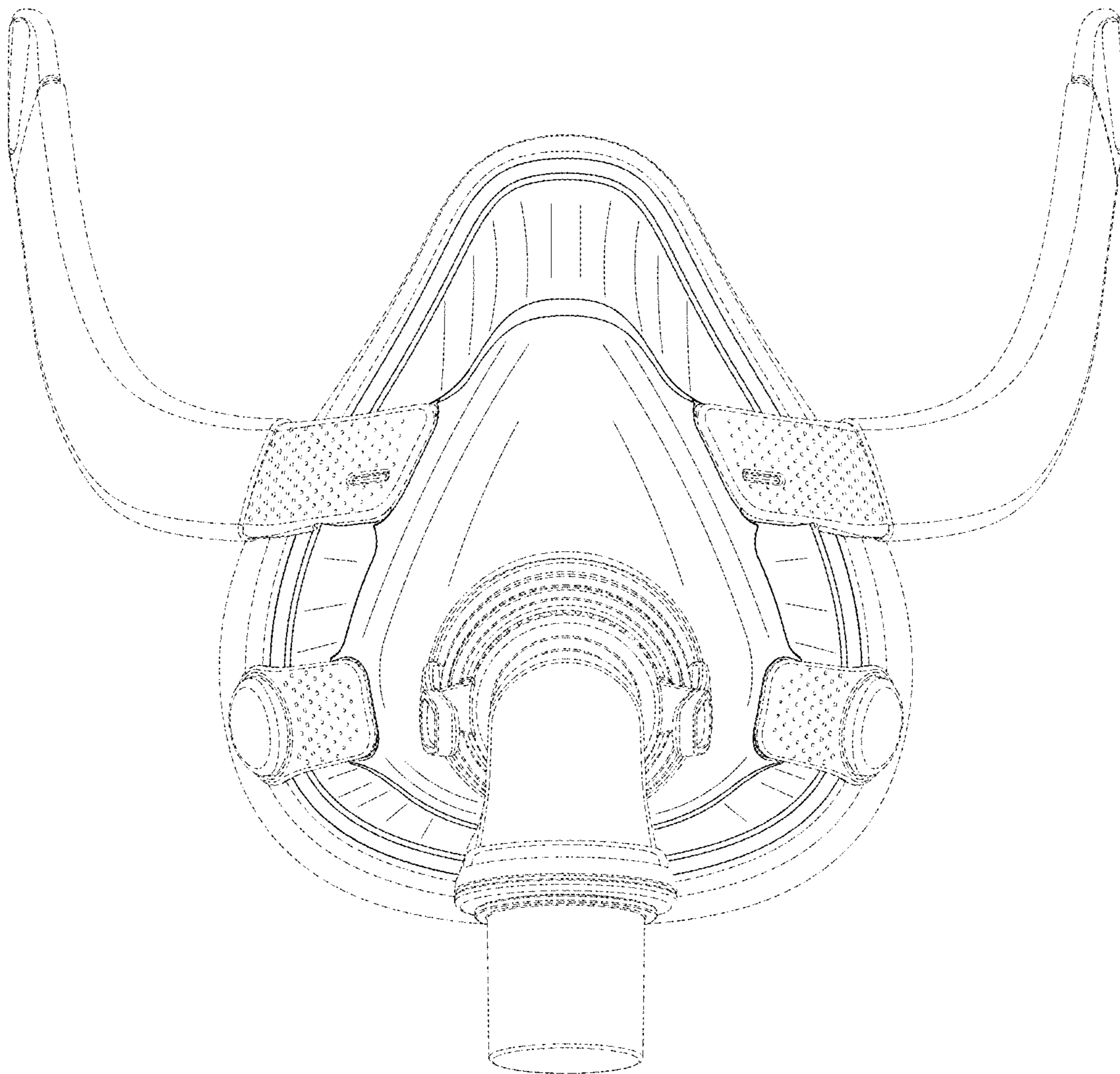

FIG. 3

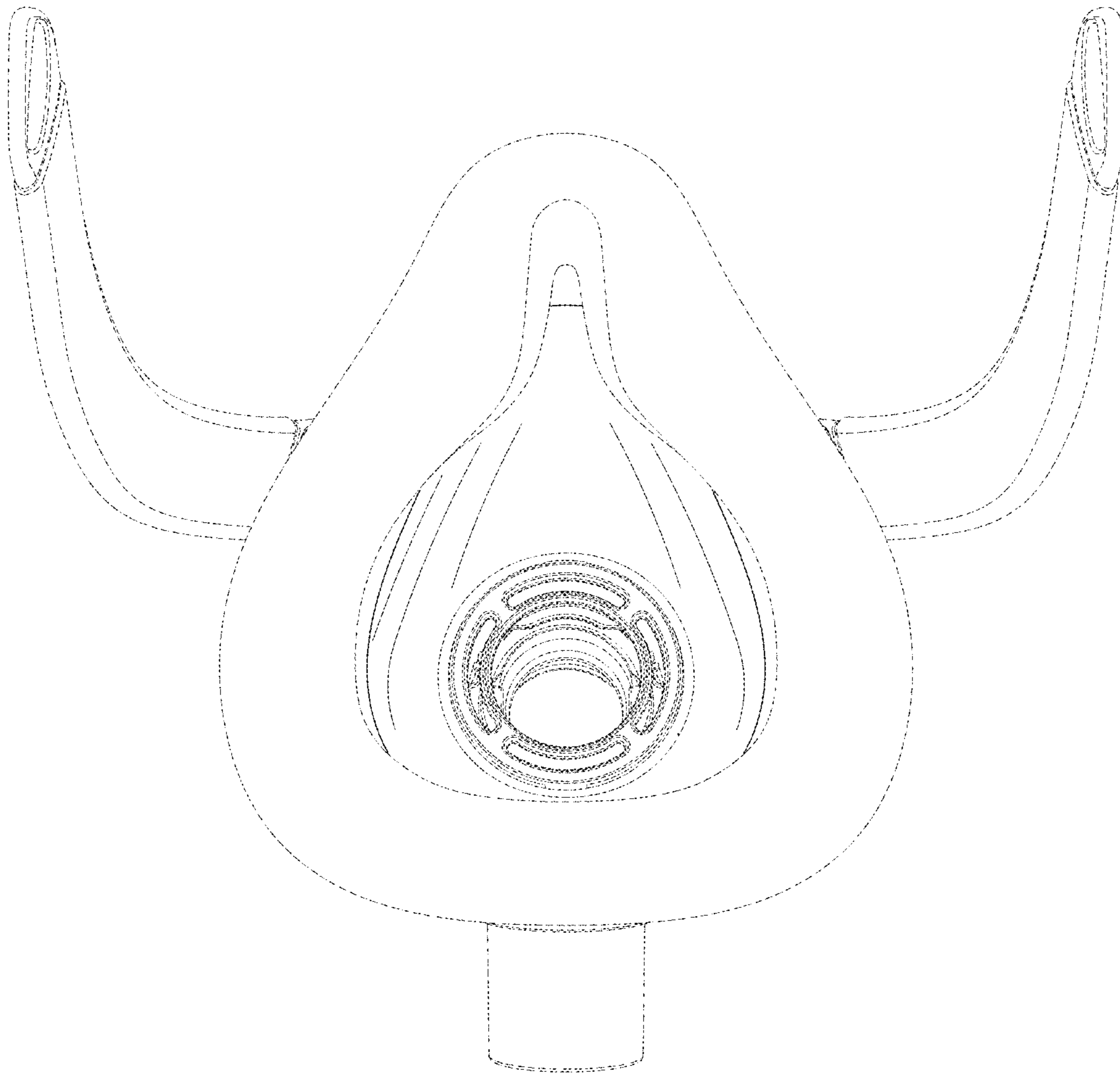

FIG. 4

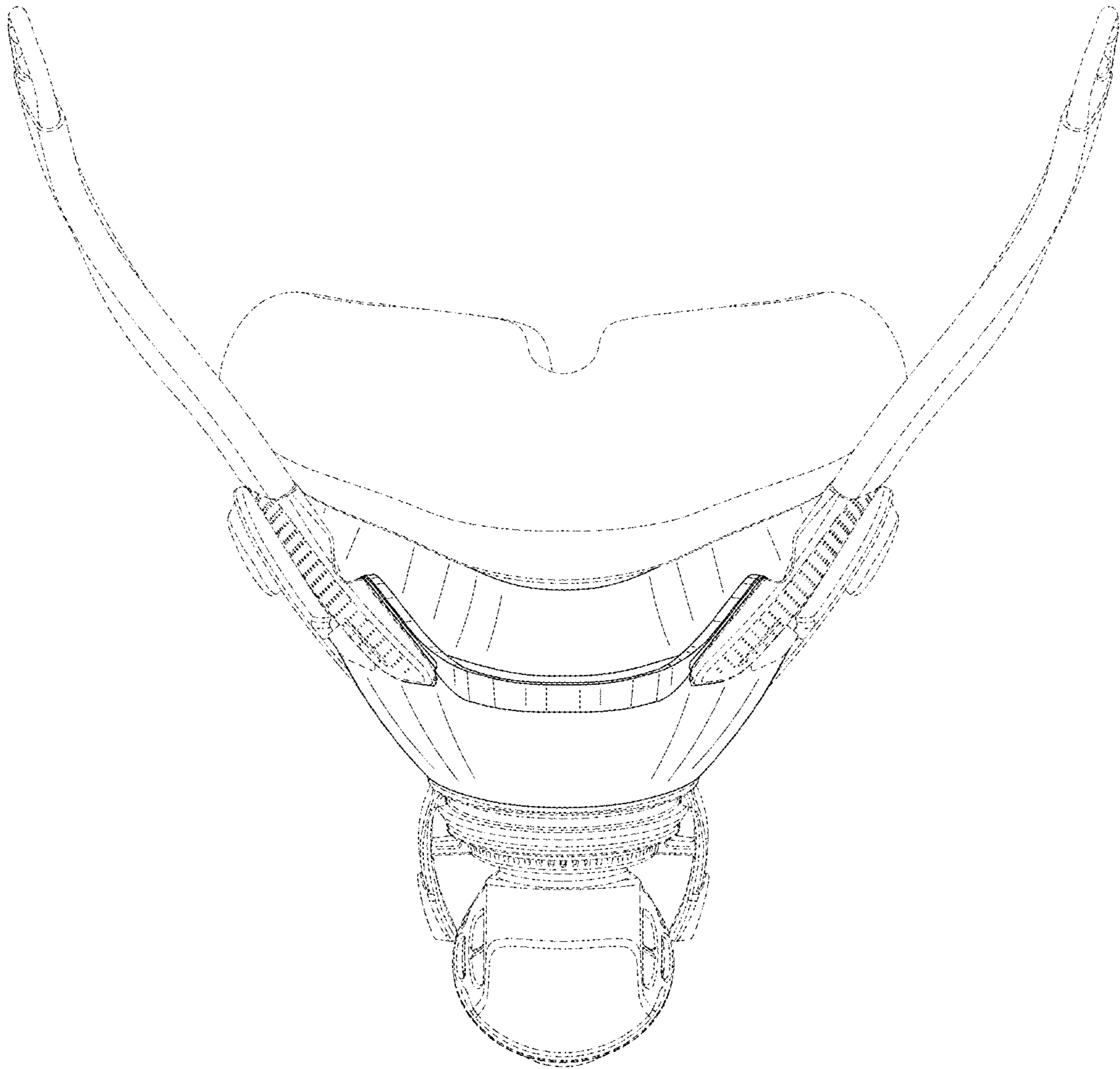

FIG. 5

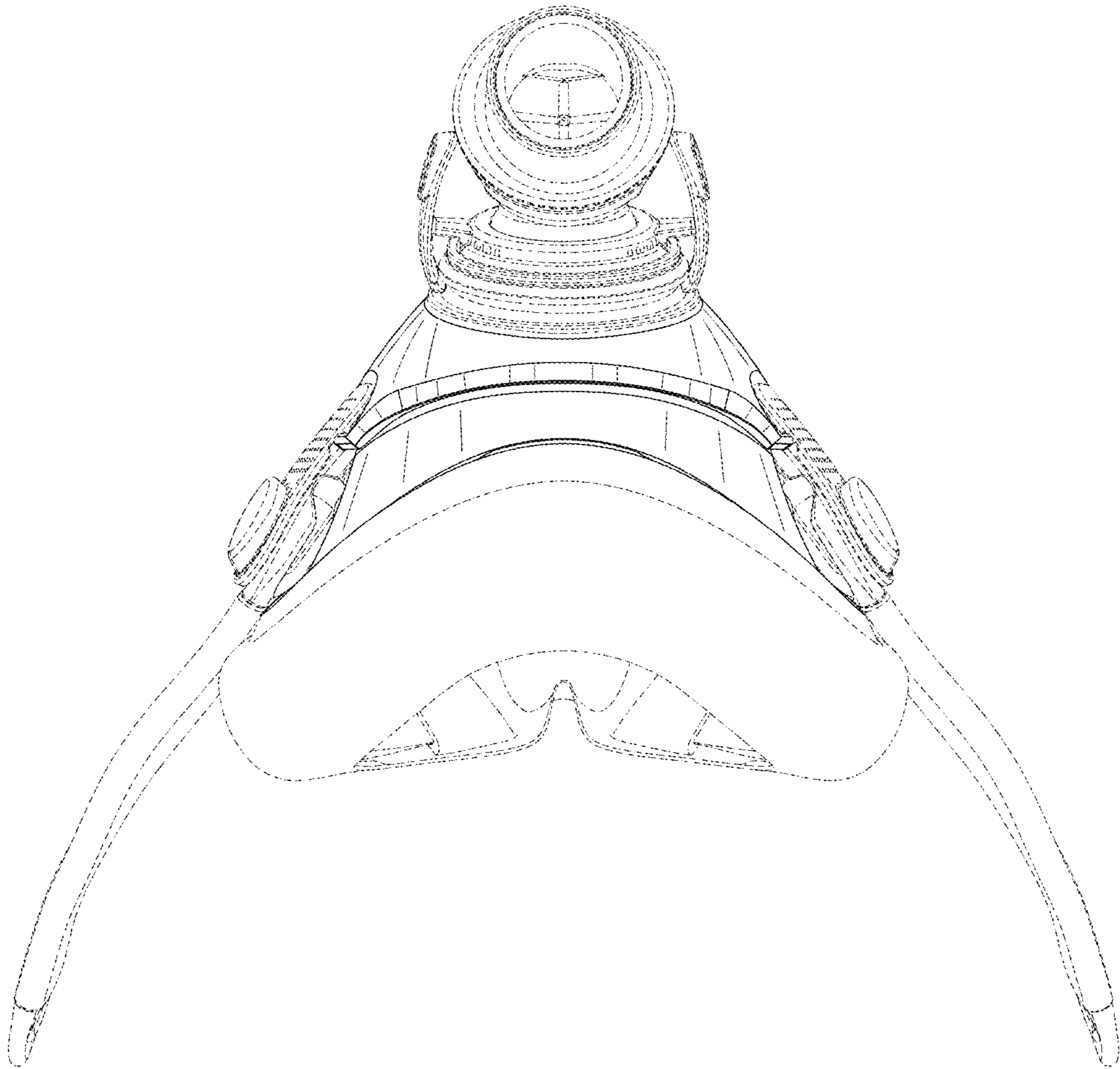

FIG. 6

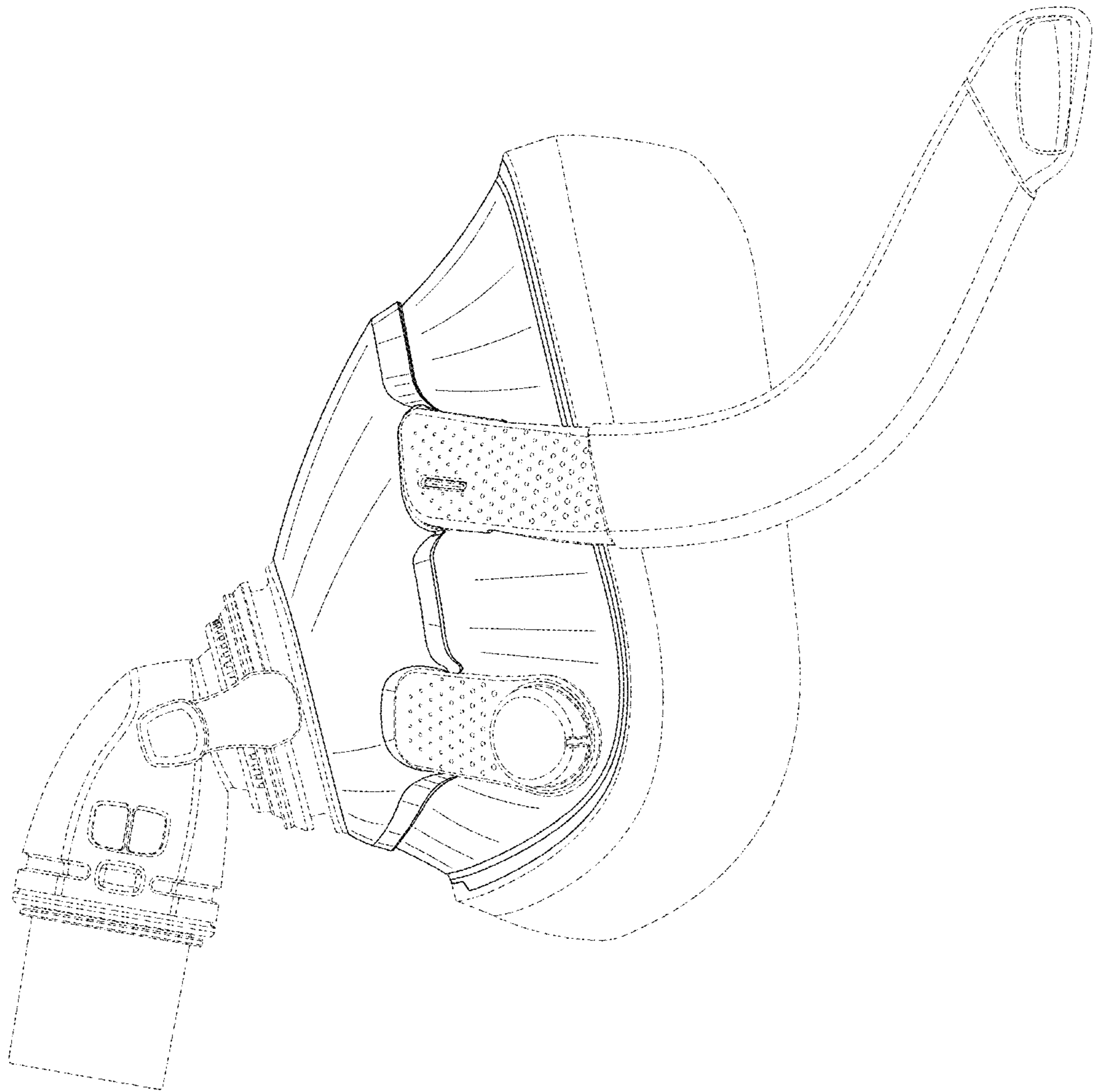

FIG. 7

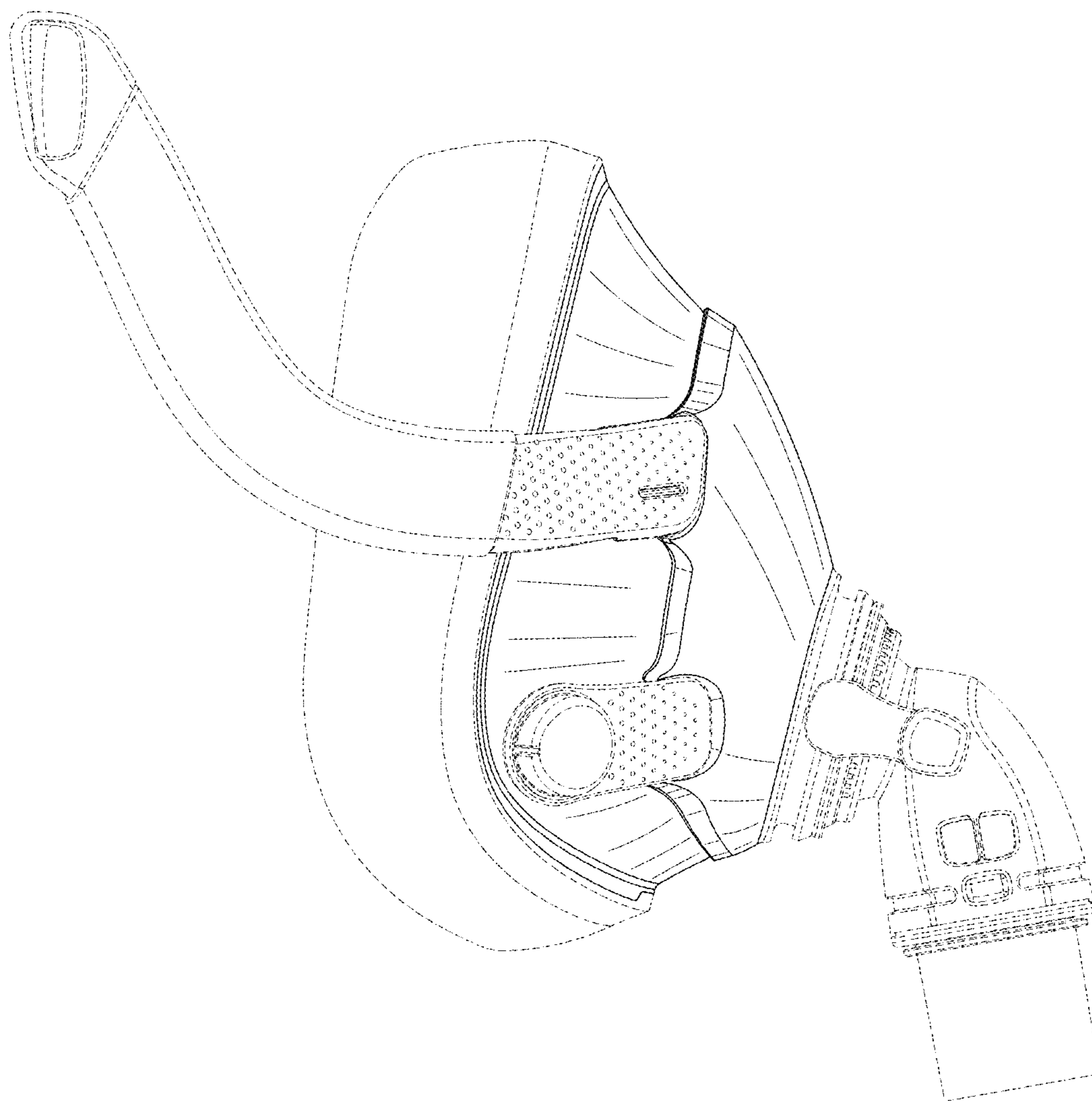

FIG. 8

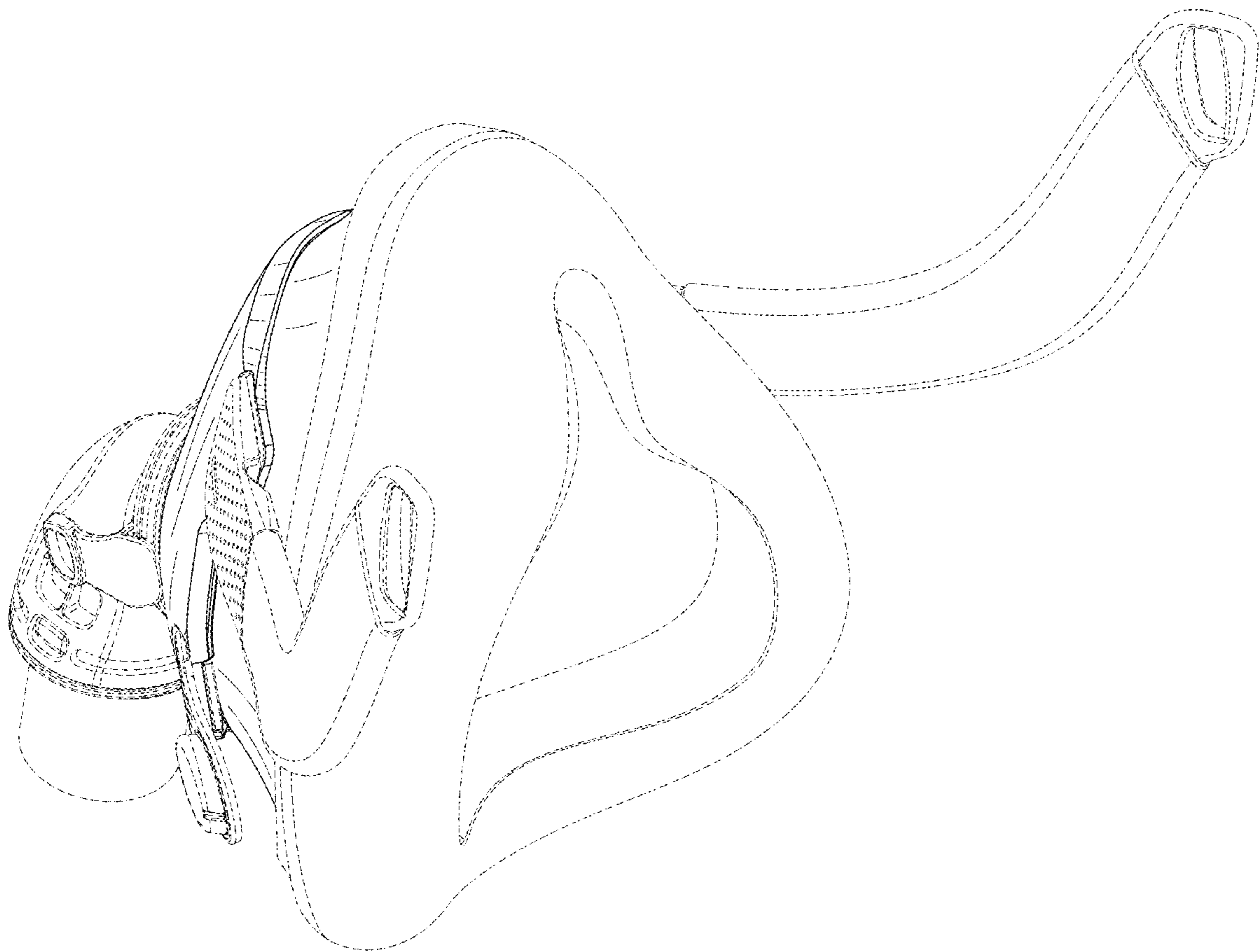

FIG. 9

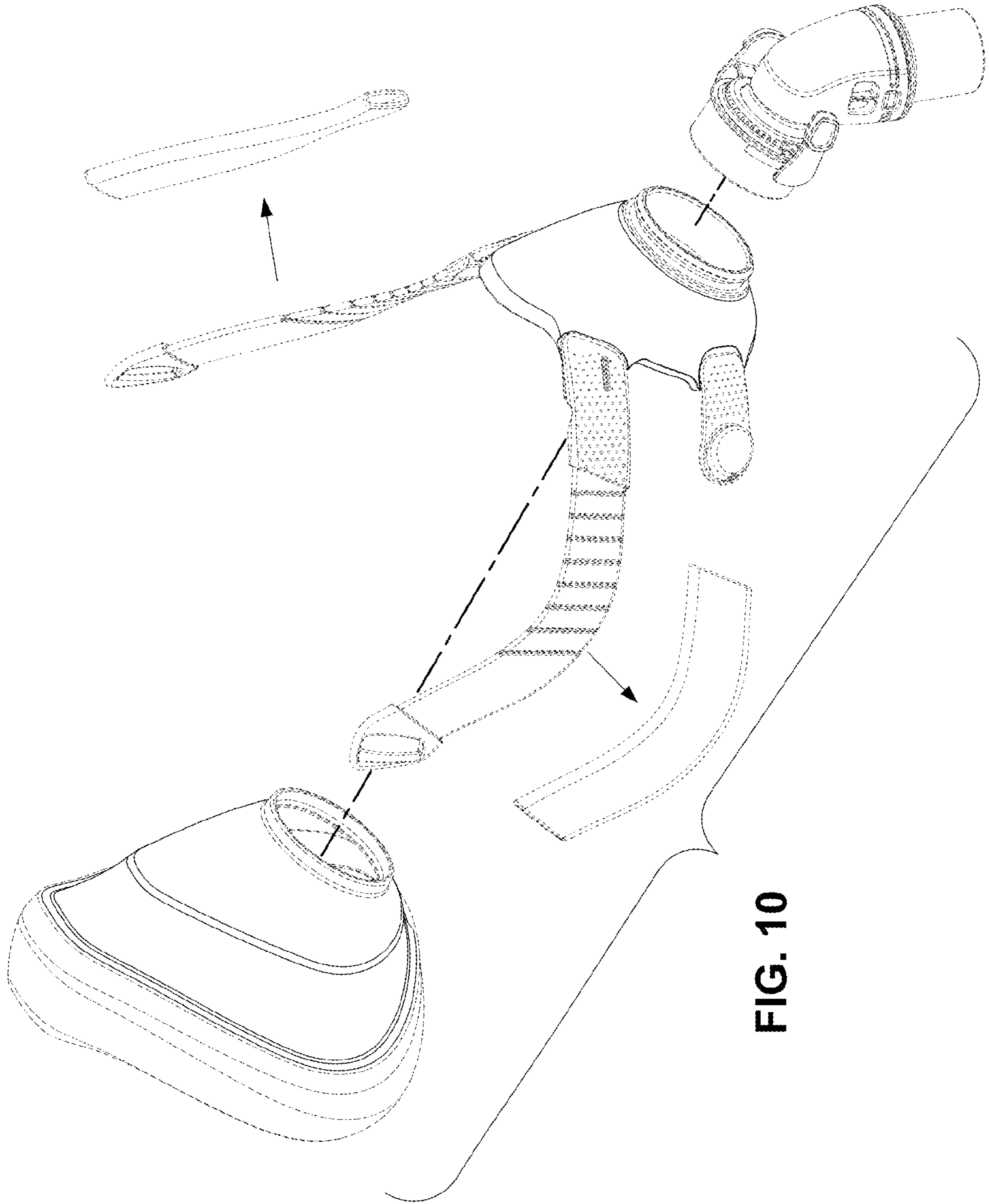

FIG. 10

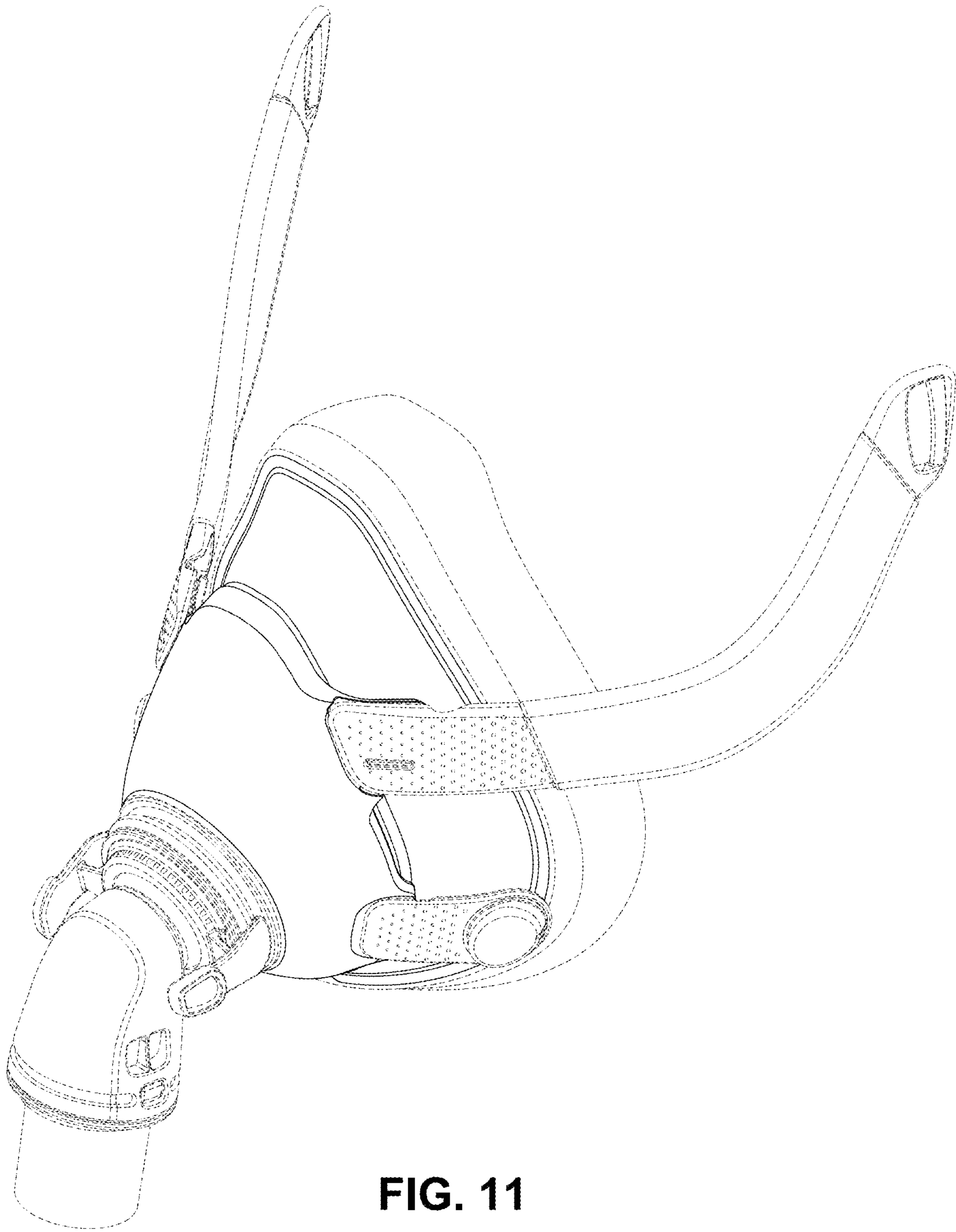

FIG. 11

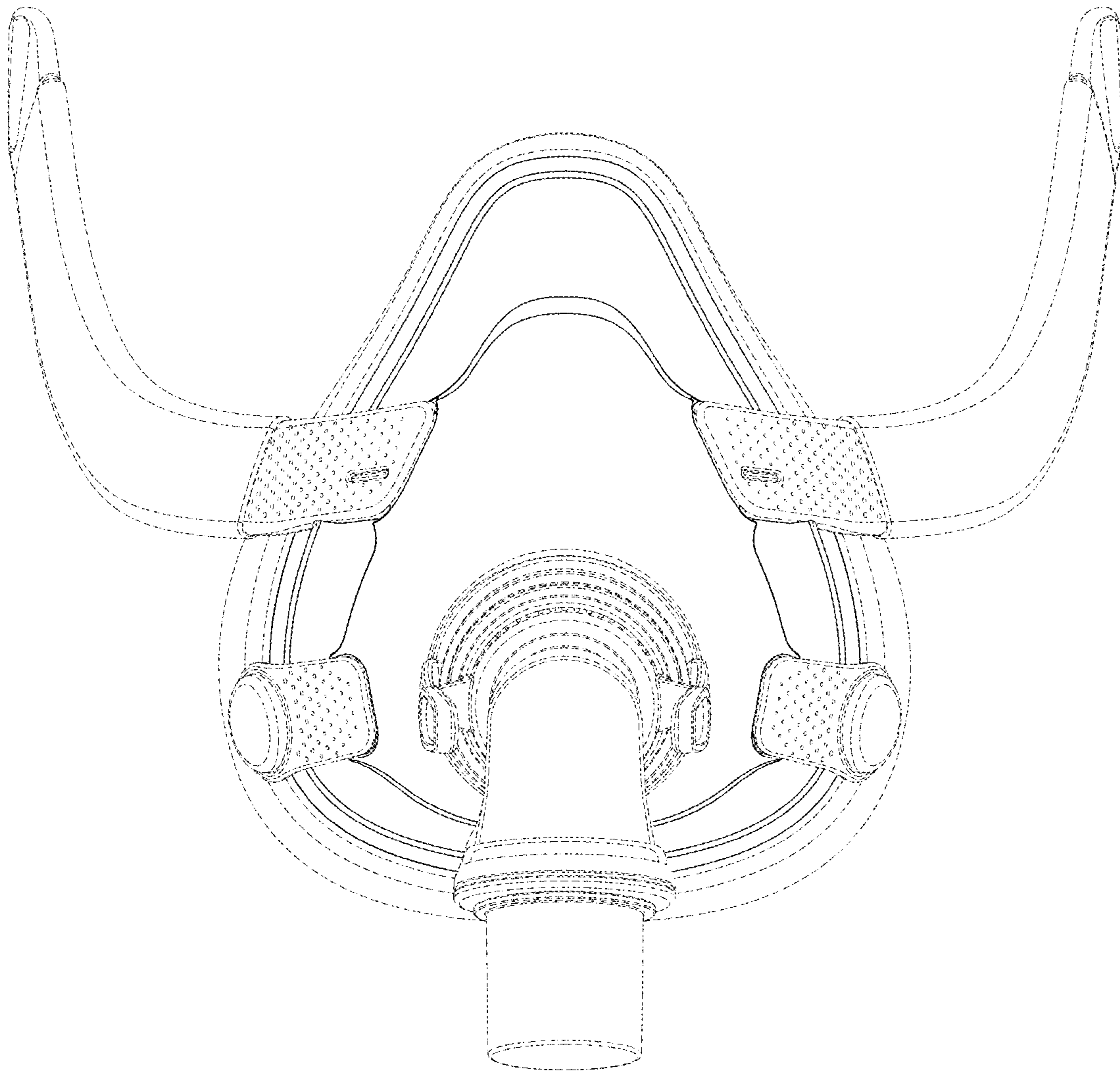

FIG. 12

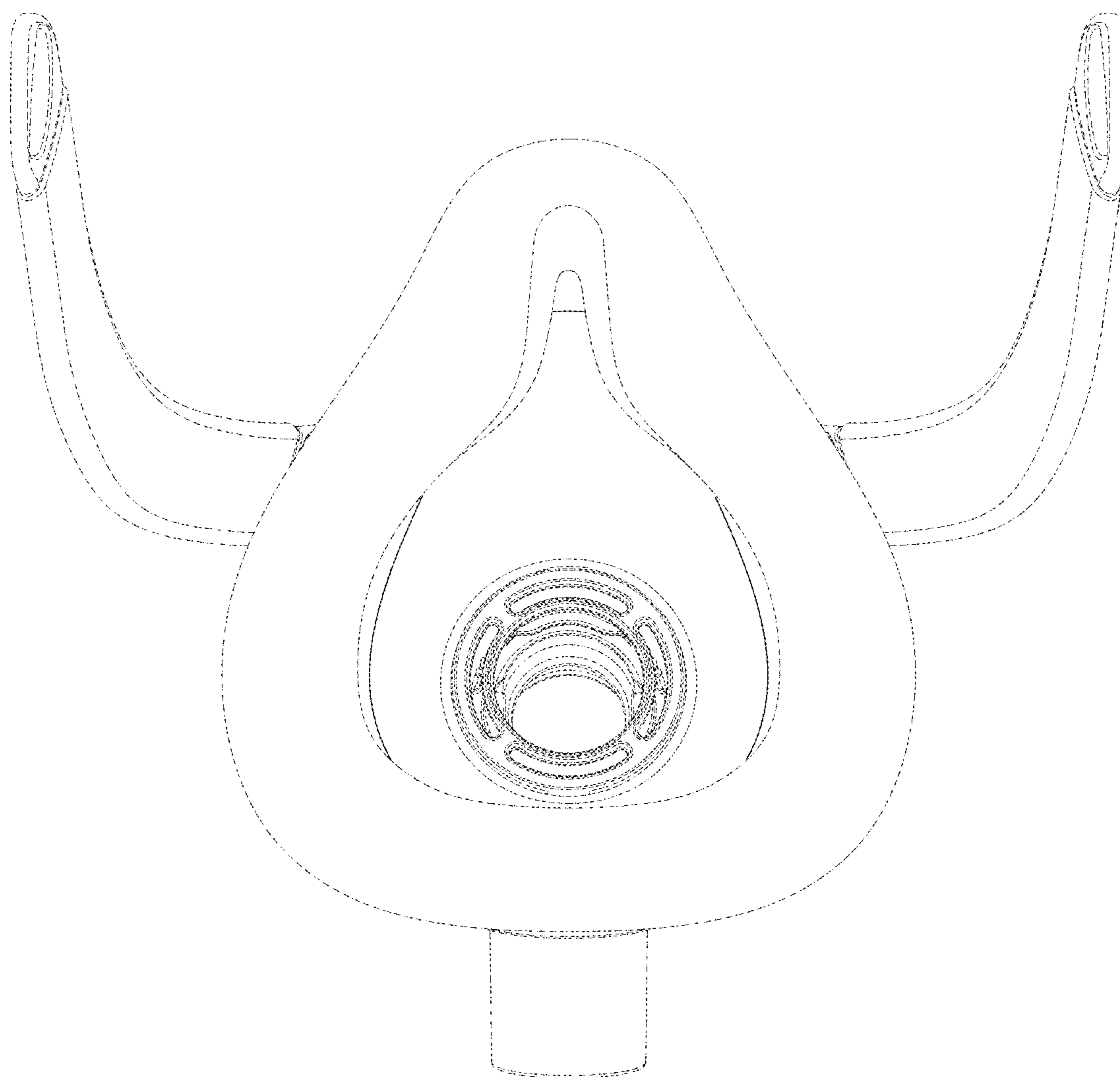

FIG. 13

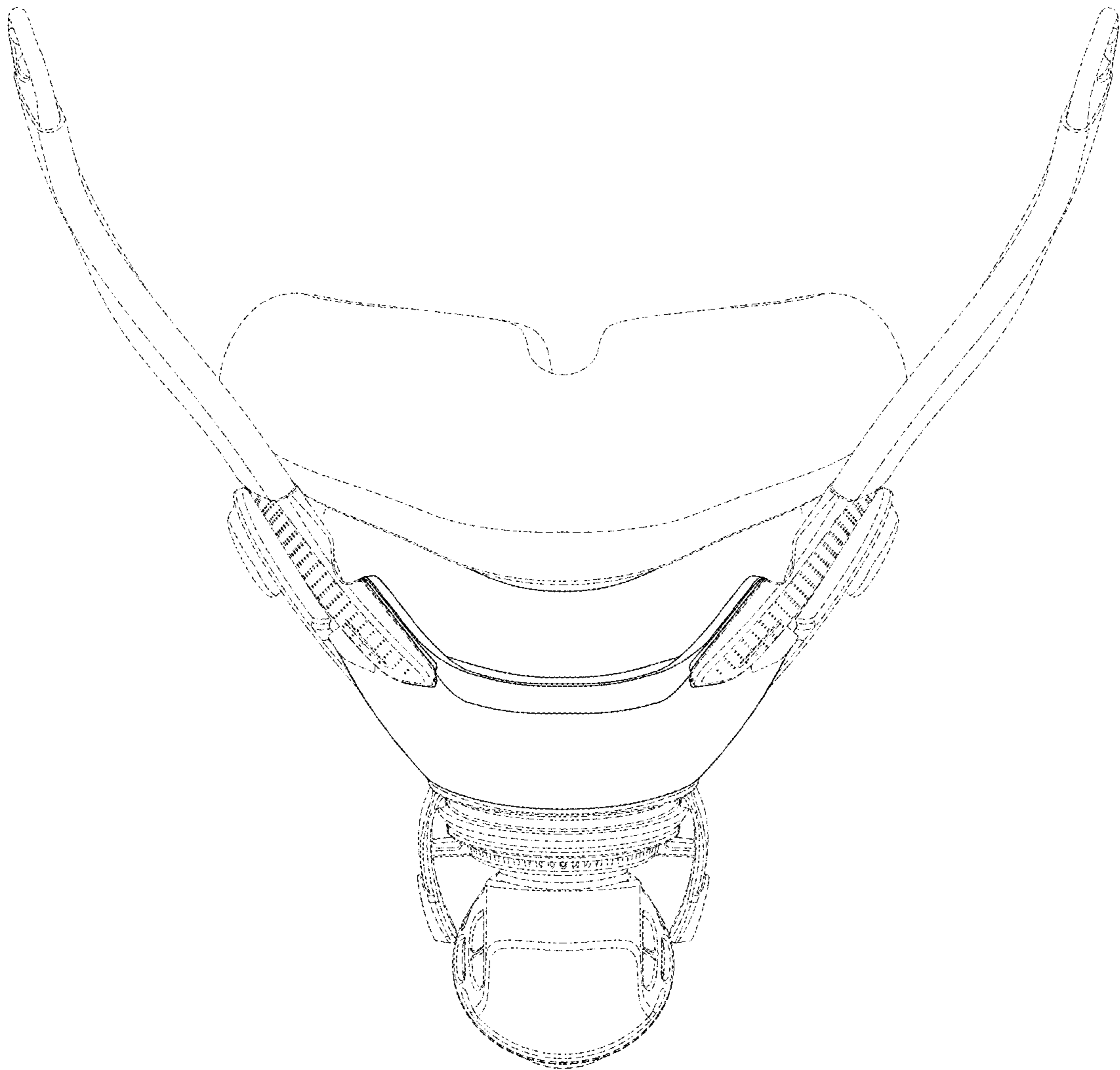

FIG. 14

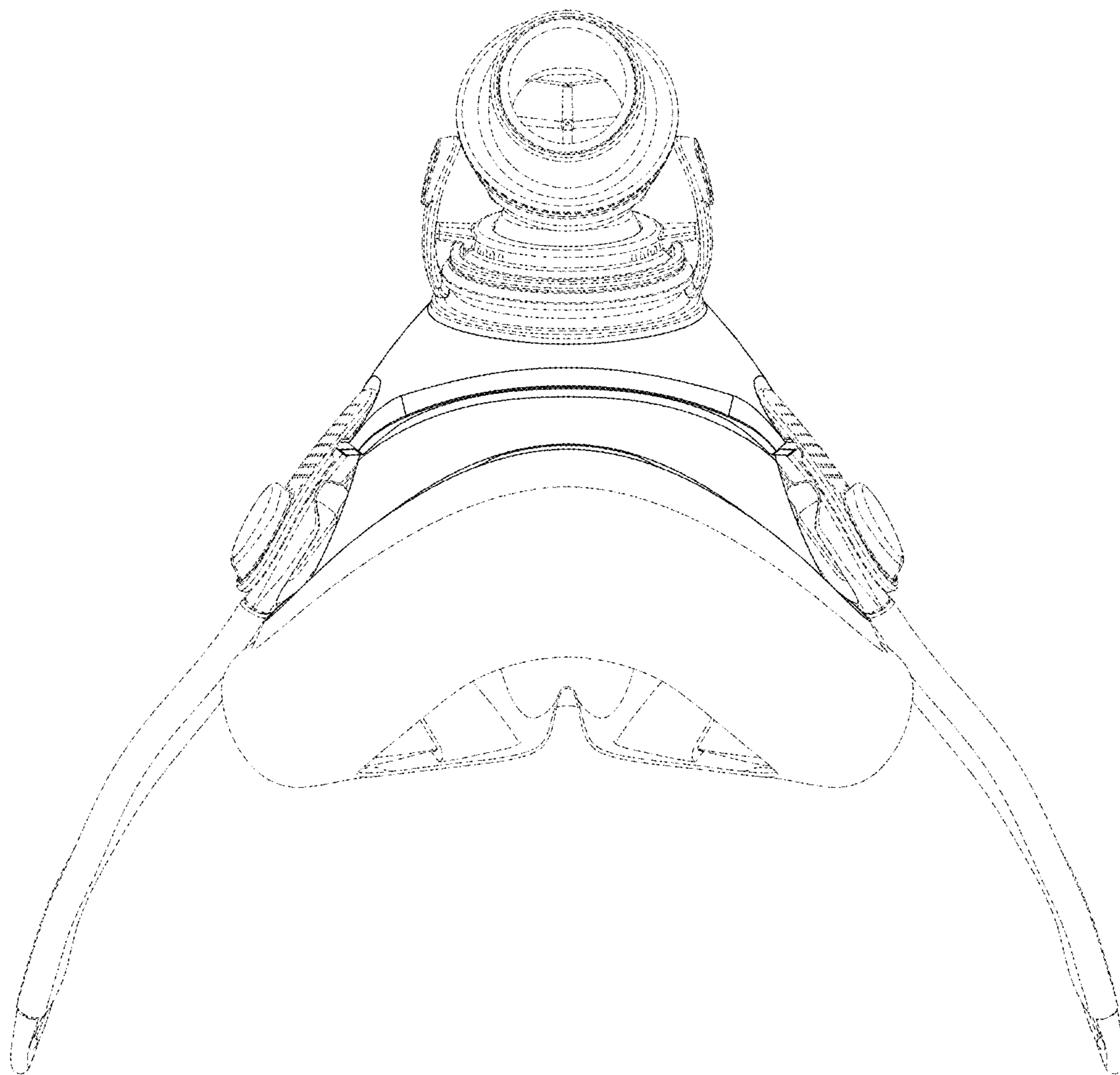

FIG. 15

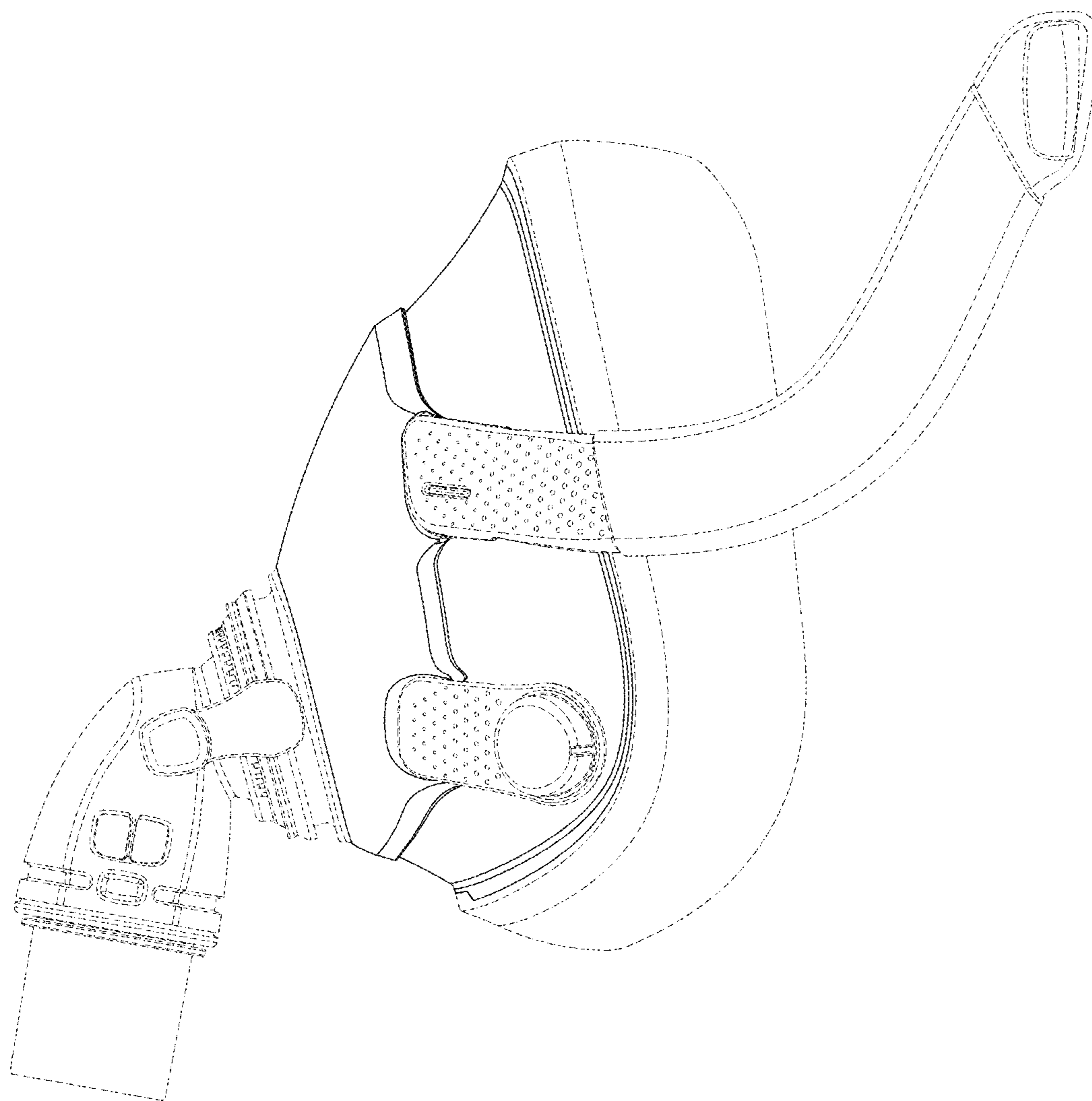

FIG. 16

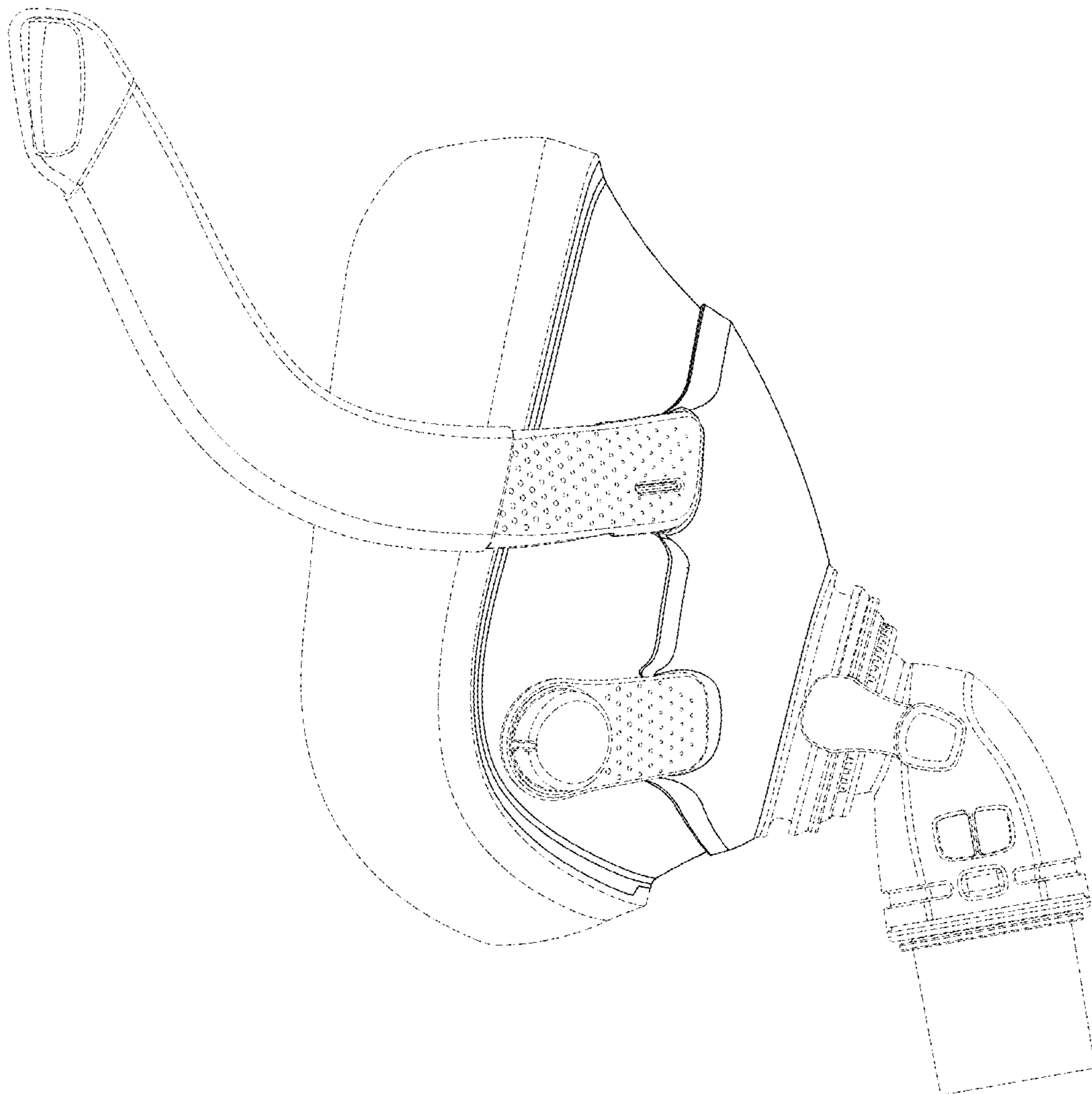

FIG. 17

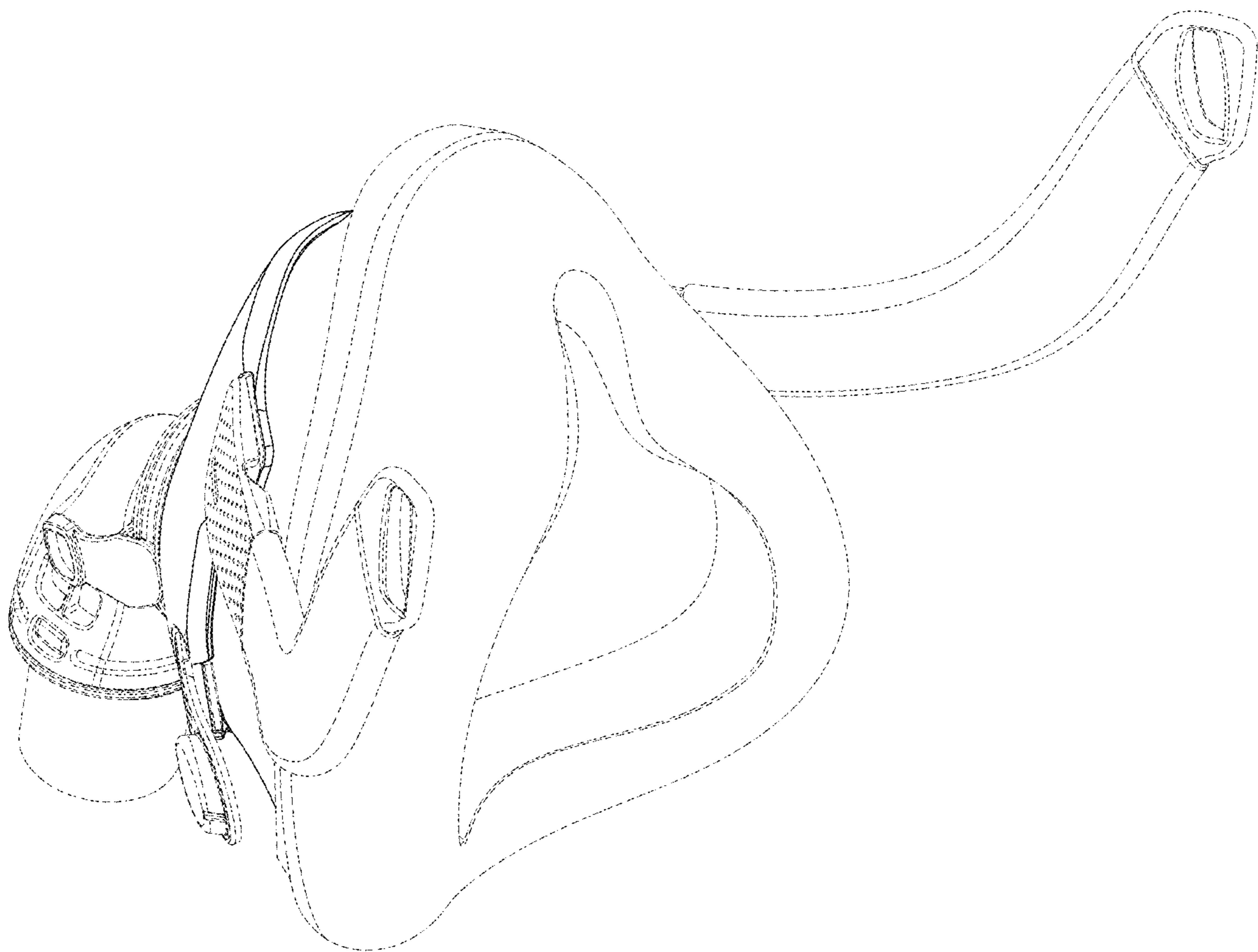

FIG. 18