



US00D935365S

(12) **United States Design Patent** (10) **Patent No.:** **US D935,365 S**
Kaoud et al. (45) **Date of Patent:** **** Nov. 9, 2021**

(54) **VEHICLE MIRROR**

(71) Applicant: **Ford Global Technologies, LLC**,
Dearborn, MI (US)

(72) Inventors: **Ehab N. Kaoud**, Livonia, MI (US);
William K. Moore, West Bloomfield,
MI (US); **Marc Cammeyer**, Berkley,
MI (US); **Rick Howard**, Brighton, MI
(US)

(73) Assignee: **Ford Global Technologies, LLC**,
Dearborn, MI (US)

(**) Term: **15 Years**

(21) Appl. No.: **29/723,954**

(22) Filed: **Feb. 12, 2020**

(51) **LOC (13) Cl.** **12-16**

(52) **U.S. Cl.**
USPC **D12/187**

(58) **Field of Classification Search**
USPC D12/187, 188, 189, 195, 179, 192
CPC B60R 1/003; B60R 1/078; B60R 1/074;
B60R 1/075; B60R 1/081; B60R 1/082;
B60R 1/06; B60R 1/076; B60R 1/08
See application file for complete search history.

(56) **References Cited**

U.S. PATENT DOCUMENTS

D489,657 S *	5/2004	Metros	D12/187
D489,658 S *	5/2004	Metros	D12/187
D496,311 S *	9/2004	Simmons	D12/187
D508,447 S *	8/2005	Morrow	D12/187
D577,320 S *	9/2008	Choi	D12/187
D577,639 S *	9/2008	Choi	D12/187
D603,774 S *	11/2009	Chen	D12/187
D636,309 S *	4/2011	Matei	D12/187
D636,310 S *	4/2011	Matei	D12/187
D690,637 S *	10/2013	O'Donnell	D12/187
D709,810 S	7/2014	Platto	

D709,811 S	7/2014	Platto	
D716,206 S *	10/2014	Thole D12/187
D718,197 S *	11/2014	Chen D12/187
D731,379 S *	6/2015	Behmer D12/187
D804,379 S *	12/2017	McMahan D12/187
D809,442 S *	2/2018	Zipfel D12/187
D865,598 S *	11/2019	Grand D12/187
D906,203 S *	12/2020	Chen D12/187
D913,880 S *	3/2021	Hilliard D12/187
D913,881 S *	3/2021	Hilliard D12/187

OTHER PUBLICATIONS

Andrew Wendler, The 2021 Ford F-150, Spied Testing, Looks Pretty Evolutionary, May 8, 2019 <https://www.caranddriver.com/news/a27409108/2021-ford-f-150-pickup-spied/>.

* cited by examiner

Primary Examiner — Susan E Krakower
Assistant Examiner — Jerry Shiuan-Hua Hsu

(57) **CLAIM**

The ornamental design for a vehicle mirror, as shown and described.

DESCRIPTION

FIG. 1 is a front elevational view of a vehicle mirror, showing our new design;
FIG. 2 is a rear elevational view thereof;
FIG. 3 is a left side elevational view thereof;
FIG. 4 is a right side elevational view thereof;
FIG. 5 is a top plan view thereof;
FIG. 6 is a bottom plan view thereof;
FIG. 7 is a top, front and left side perspective view thereof;
and,
FIG. 8 is a bottom, front and left side perspective view thereof.
The broken lines and the lightened surface shading illustrate portions of the vehicle mirror that form no part of the claimed design.

1 Claim, 8 Drawing Sheets

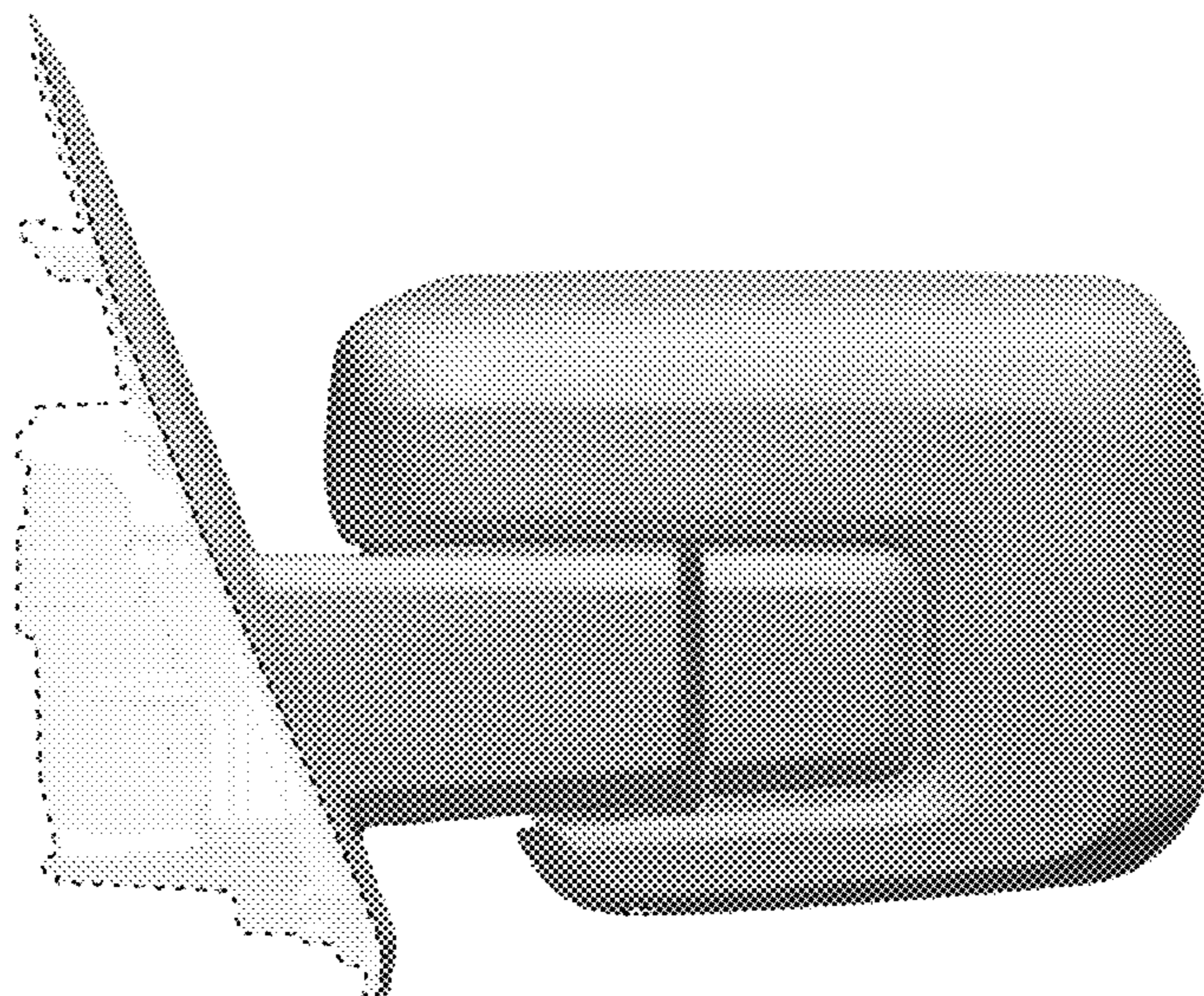

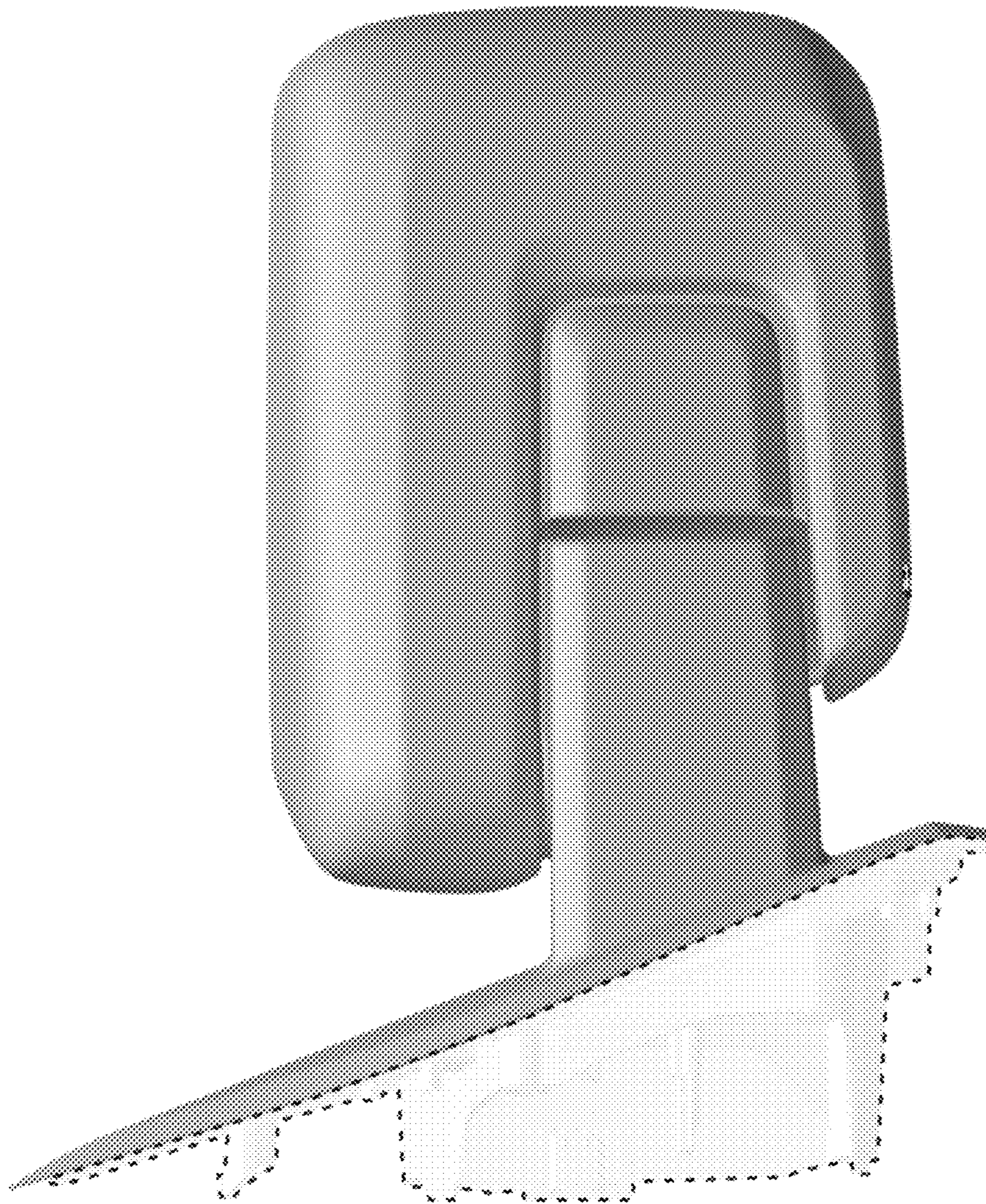

Fig. 1

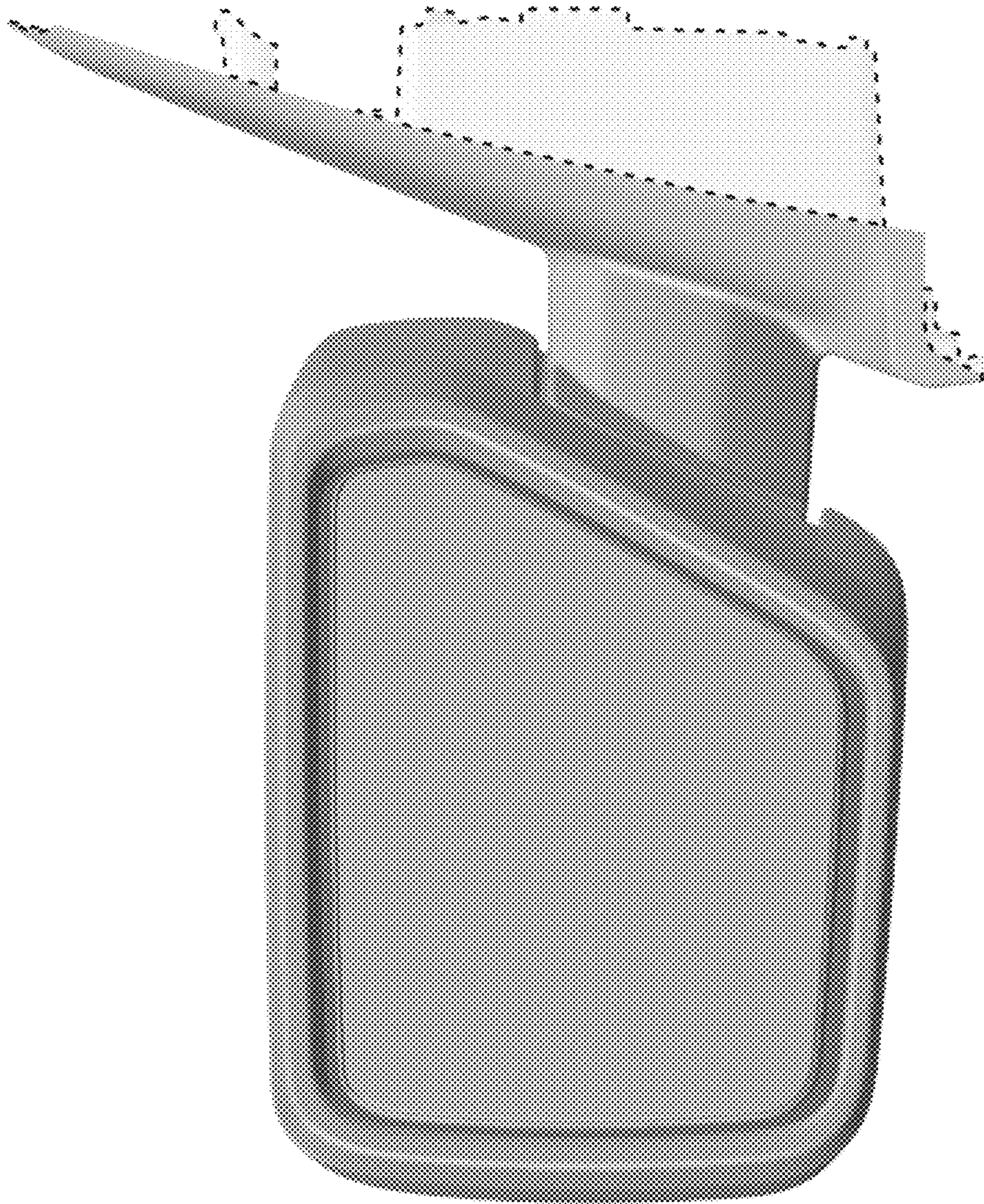

Fig. 2

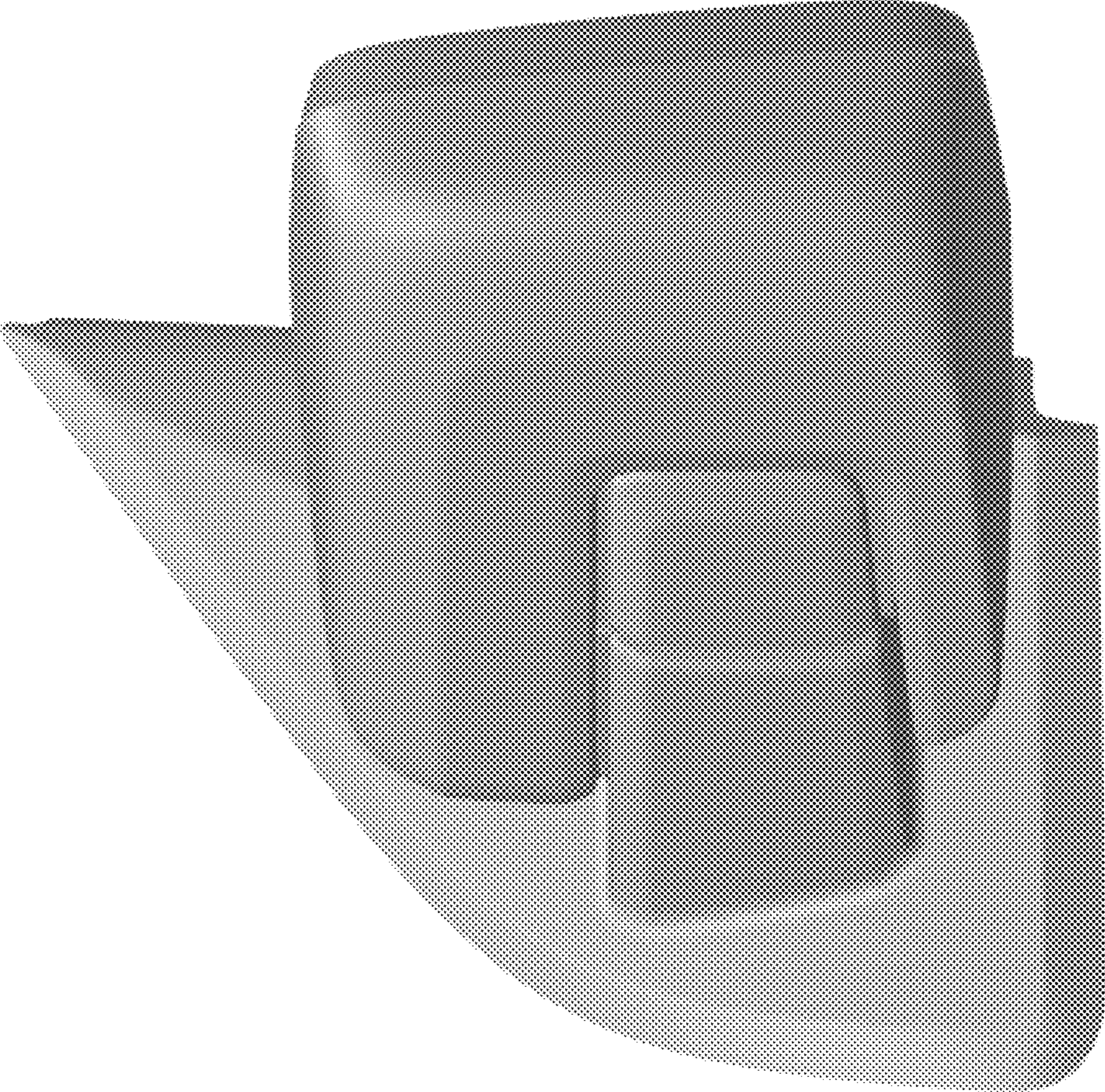

Fig. 3

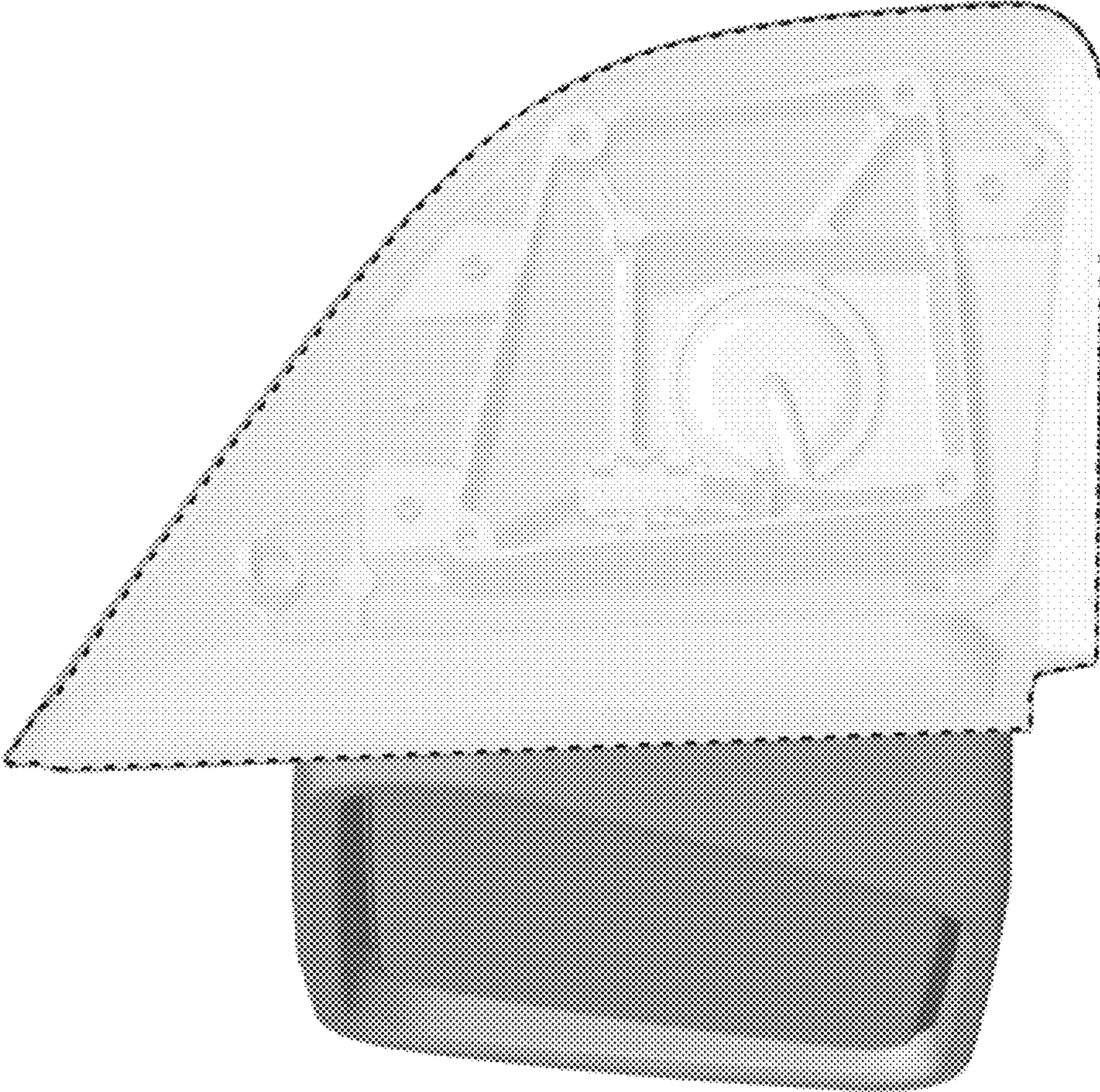

Fig.4

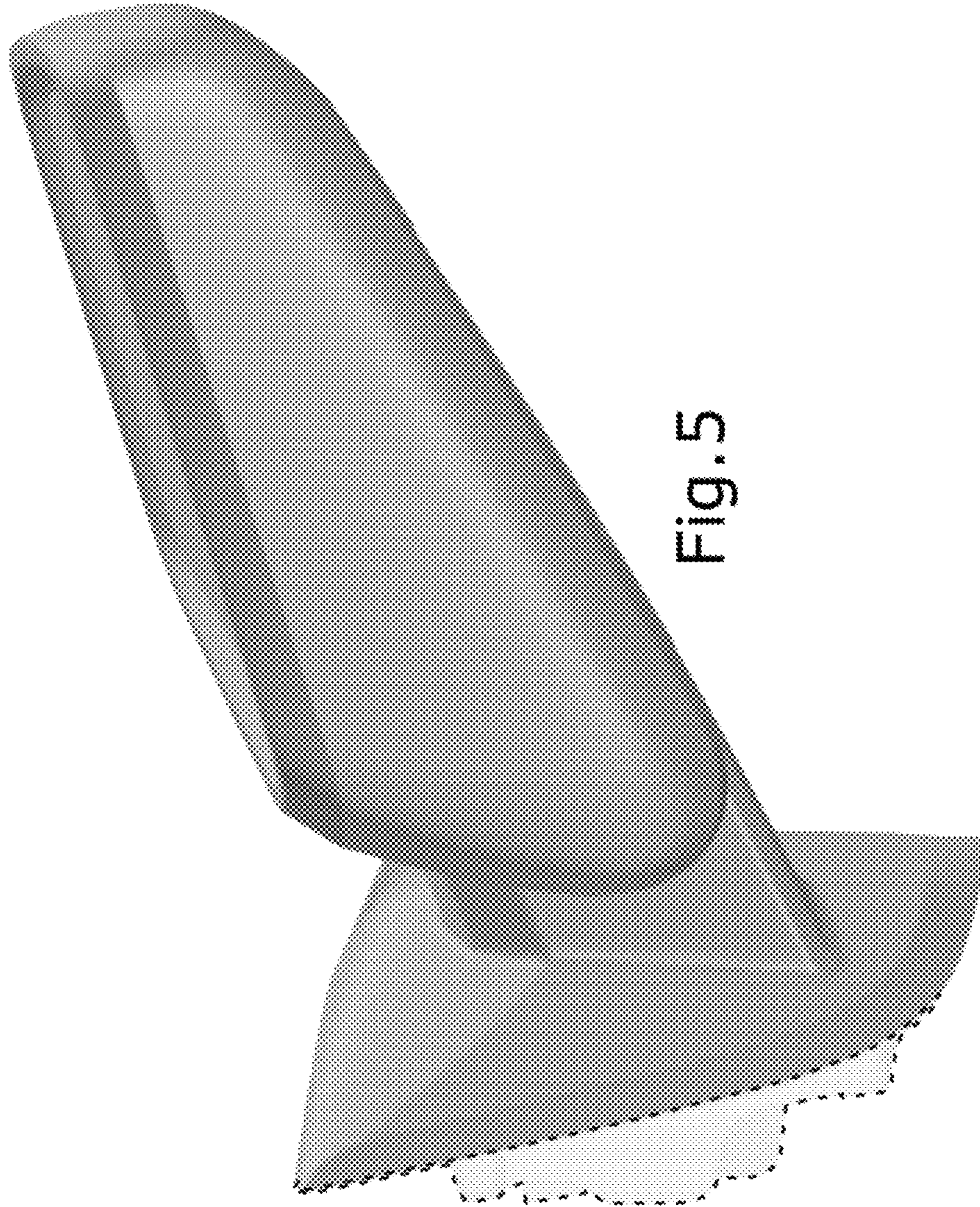

Fig. 5

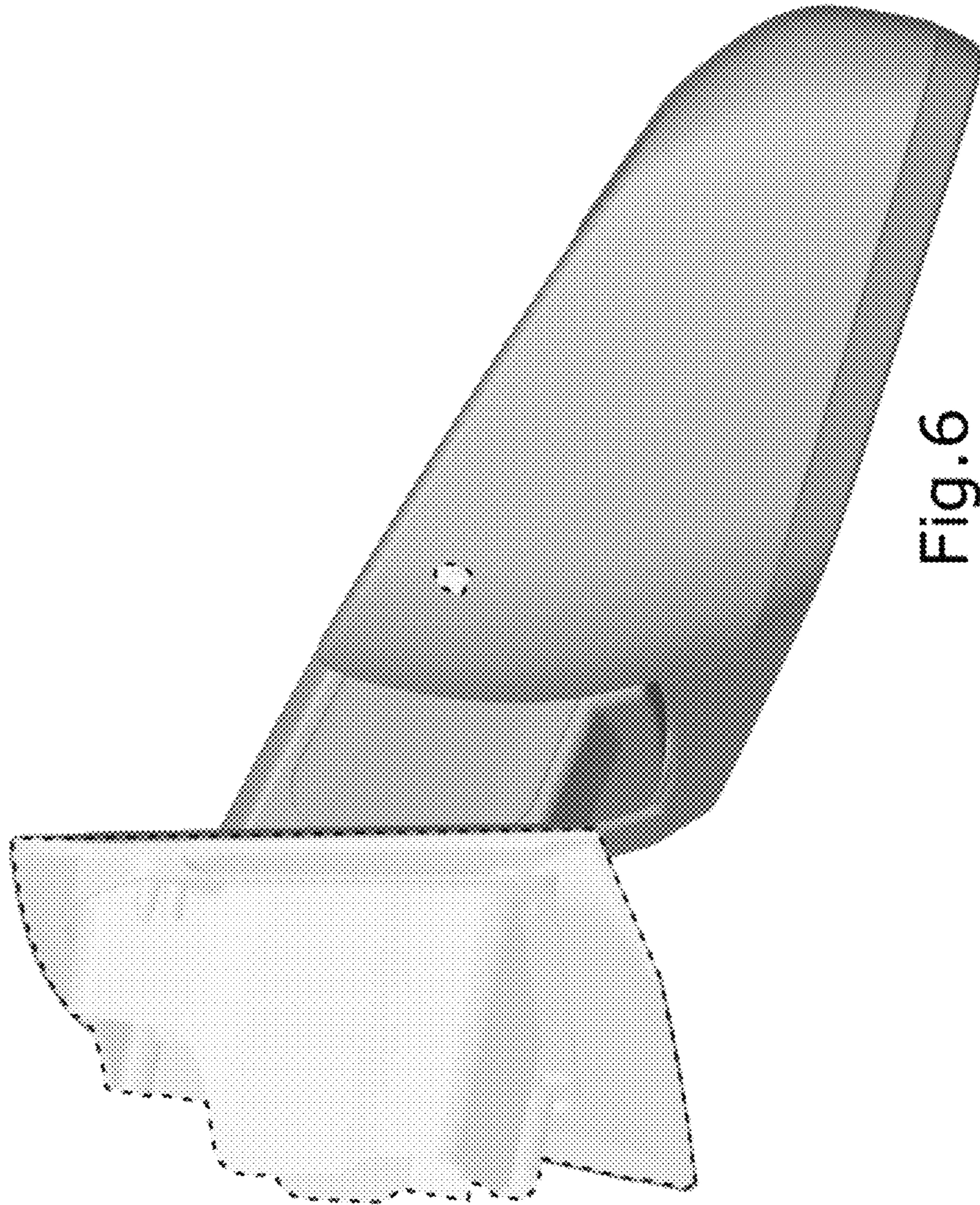

Fig. 6

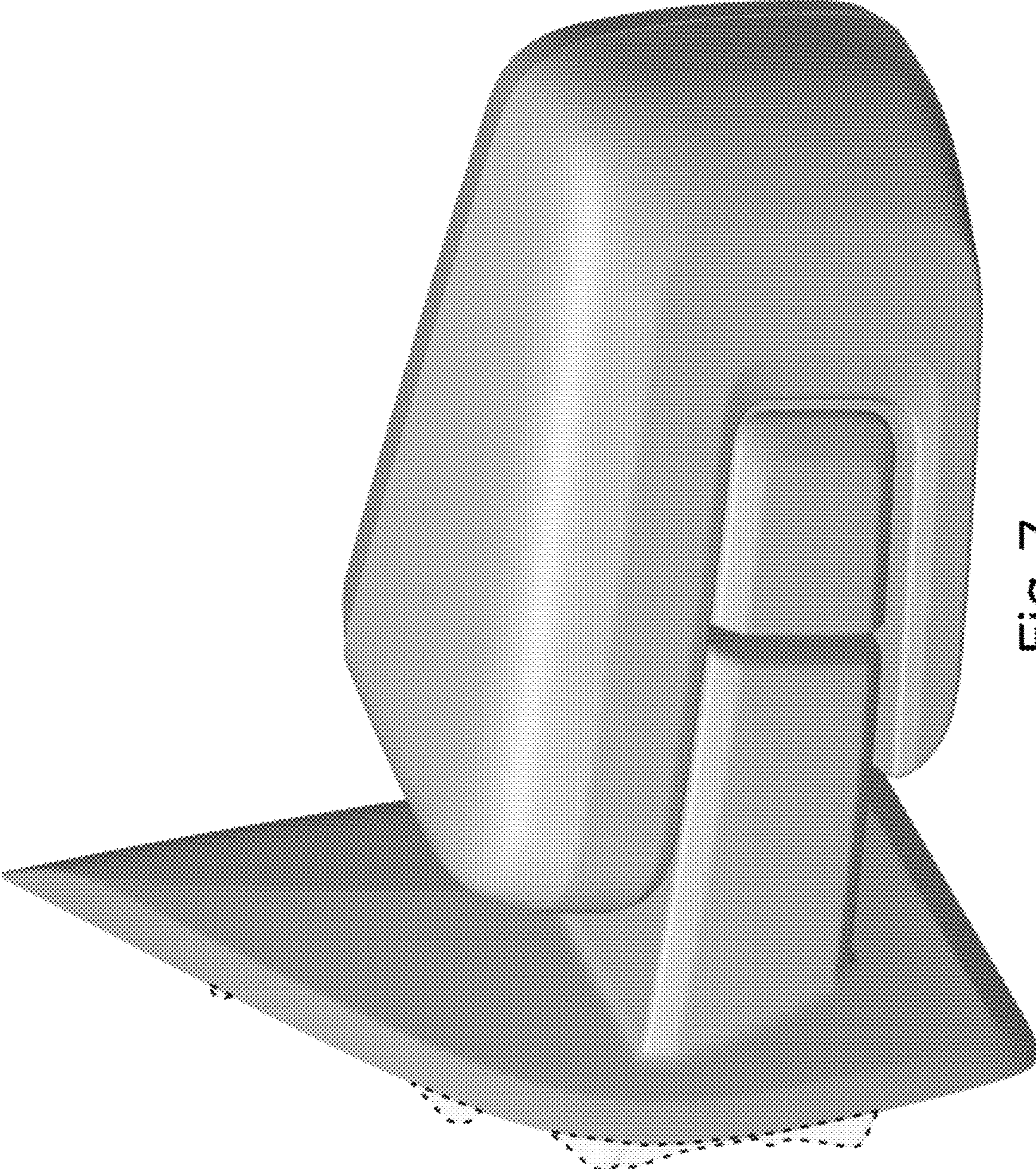

Fig.7

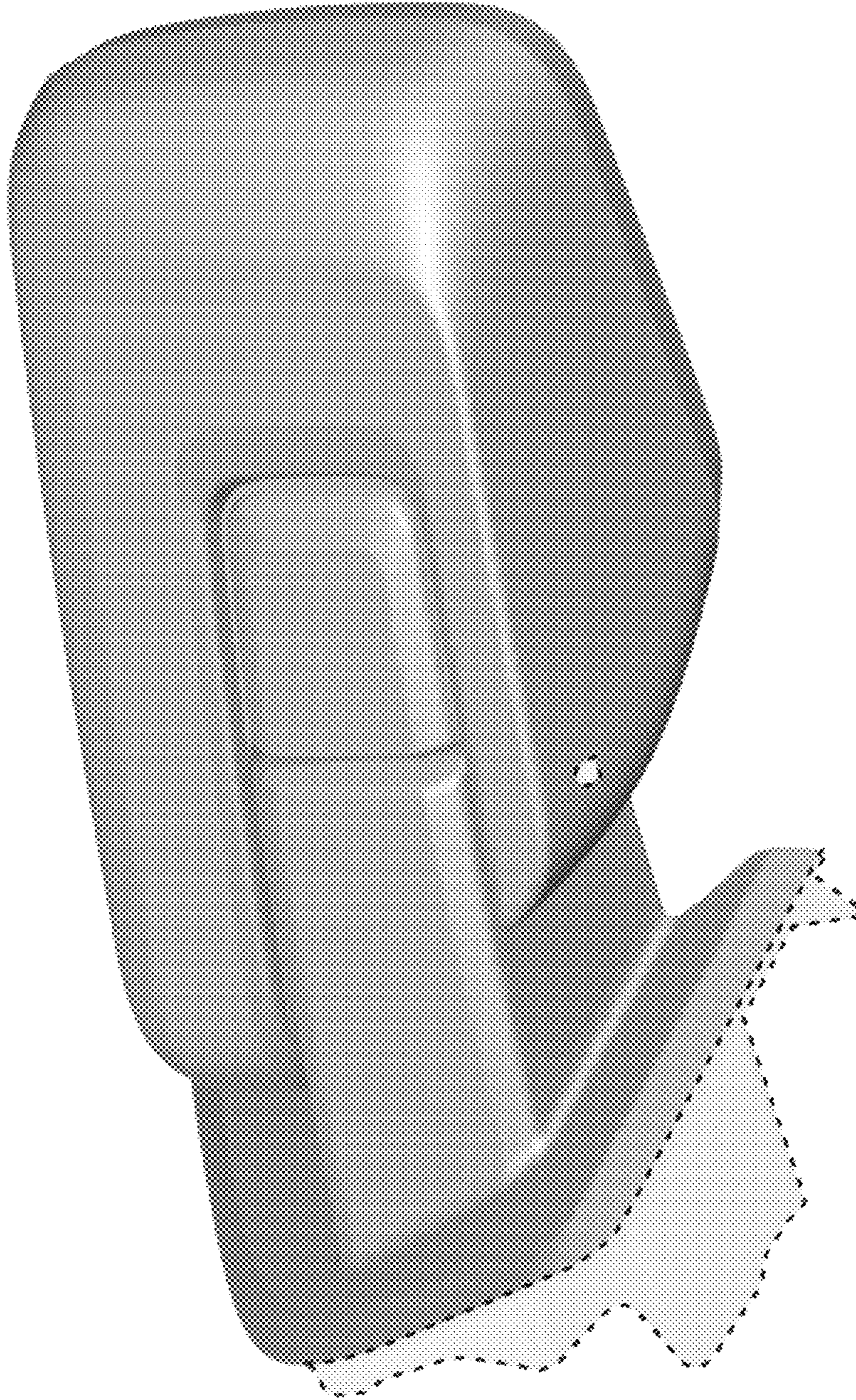

Fig. 8