



US00D934467S

(12) **United States Design Patent**  
**Hu**

(10) **Patent No.:** **US D934,467 S**

(45) **Date of Patent:** **\*\* Oct. 26, 2021**

(54) **HEADLIGHT**

(71) Applicant: **Chun Hu**, Guangzhou (CN)

(72) Inventor: **Chun Hu**, Guangzhou (CN)

(\*\*) Term: **15 Years**

(21) Appl. No.: **29/735,415**

(22) Filed: **May 21, 2020**

(51) **LOC (13) Cl.** ..... **26-06**

(52) **U.S. Cl.**  
USPC ..... **D26/28**

(58) **Field of Classification Search**

USPC ..... D26/28-36, 139

CPC ..... F21S 48/00; F21S 48/10; F21S 48/115;

F21S 48/225; F21S 48/1233; F21S

48/1266; F21S 48/1388; F21S 48/2268;

F21V 21/04; F21V 29/004; B60Q 9/13;

B60Q 9/135; B60Q 9/1375

See application file for complete search history.

(56) **References Cited**

**U.S. PATENT DOCUMENTS**

D495,814 S \* 9/2004 James ..... D26/28

D600,838 S \* 9/2009 Kuboshima ..... D26/28

D607,128 S \* 12/2009 Wu ..... D26/28

D712,577 S \* 9/2014 Merovitz ..... D26/28

D712,578 S \* 9/2014 Merovitz ..... D26/28

D728,138 S \* 4/2015 Christ ..... D26/28

D737,482 S \* 8/2015 Kuge ..... D26/28

D747,516 S \* 1/2016 Yang ..... D26/28

\* cited by examiner

*Primary Examiner* — Marcus A Jackson

(57) **CLAIM**

The ornamental design for headlight, as shown and described.

**DESCRIPTION**

FIG. 1 is a top view of the headlight design;

FIG. 2 is a bottom view thereof;

FIG. 3 is a front view thereof;

FIG. 4 is a back view thereof;

FIG. 5 is a right-side view thereof;

FIG. 6 is a left-side vertical view thereof;

FIG. 7 is a top-side vertical view thereof; and,

FIG. 8 is a bottom-side view thereof.

The headlight design is a 9-inch round LED headlight suitable for 2019 JEEP wrangler JL. In FIG. 3, the two circles of transparent materials are day-time running light, turning light and position lamp. The protruding part on the central axis is auxiliary signal light. The central part consists of two optical lenses, which function as high beam light and low beam light.

**1 Claim, 8 Drawing Sheets**

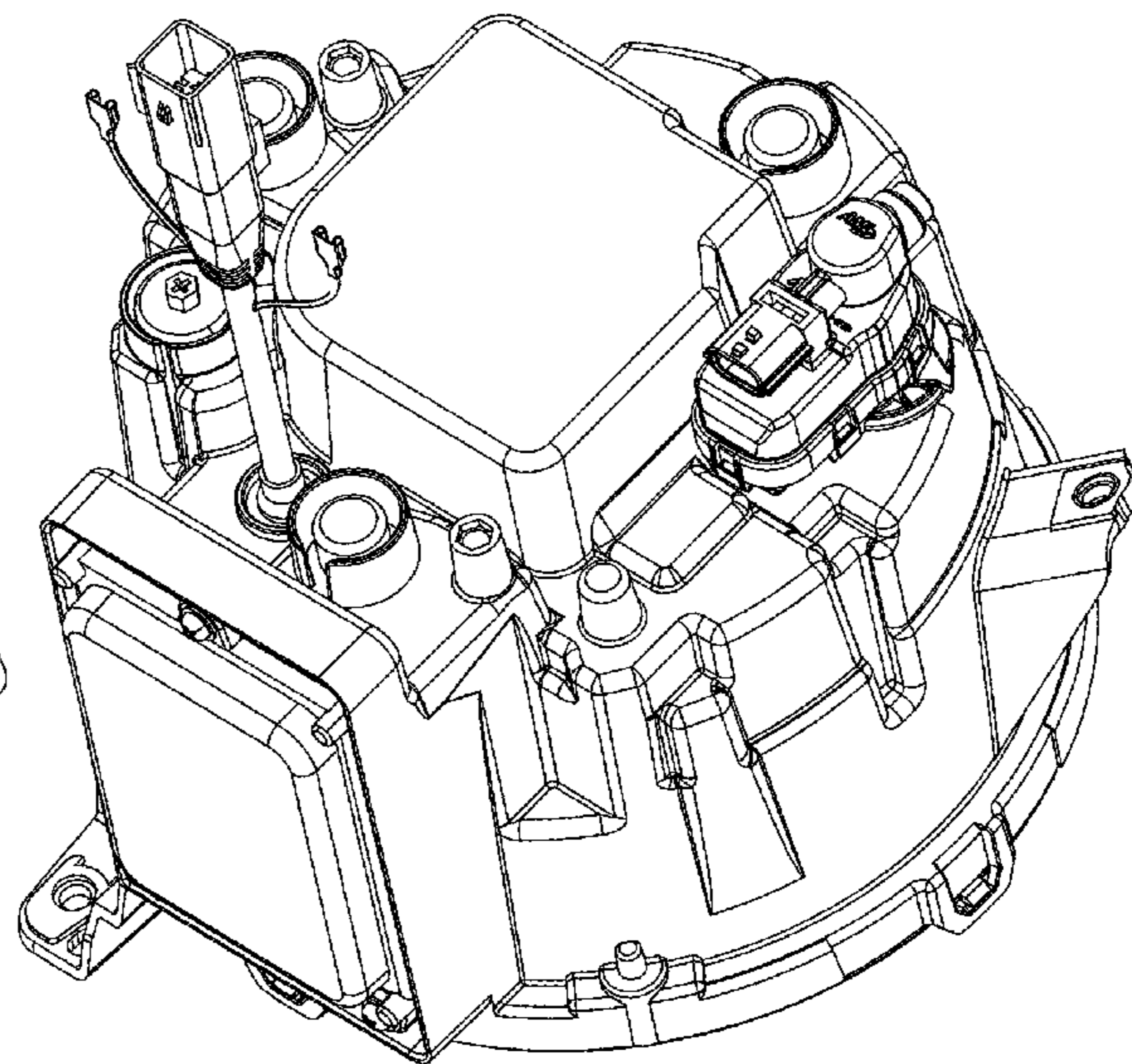
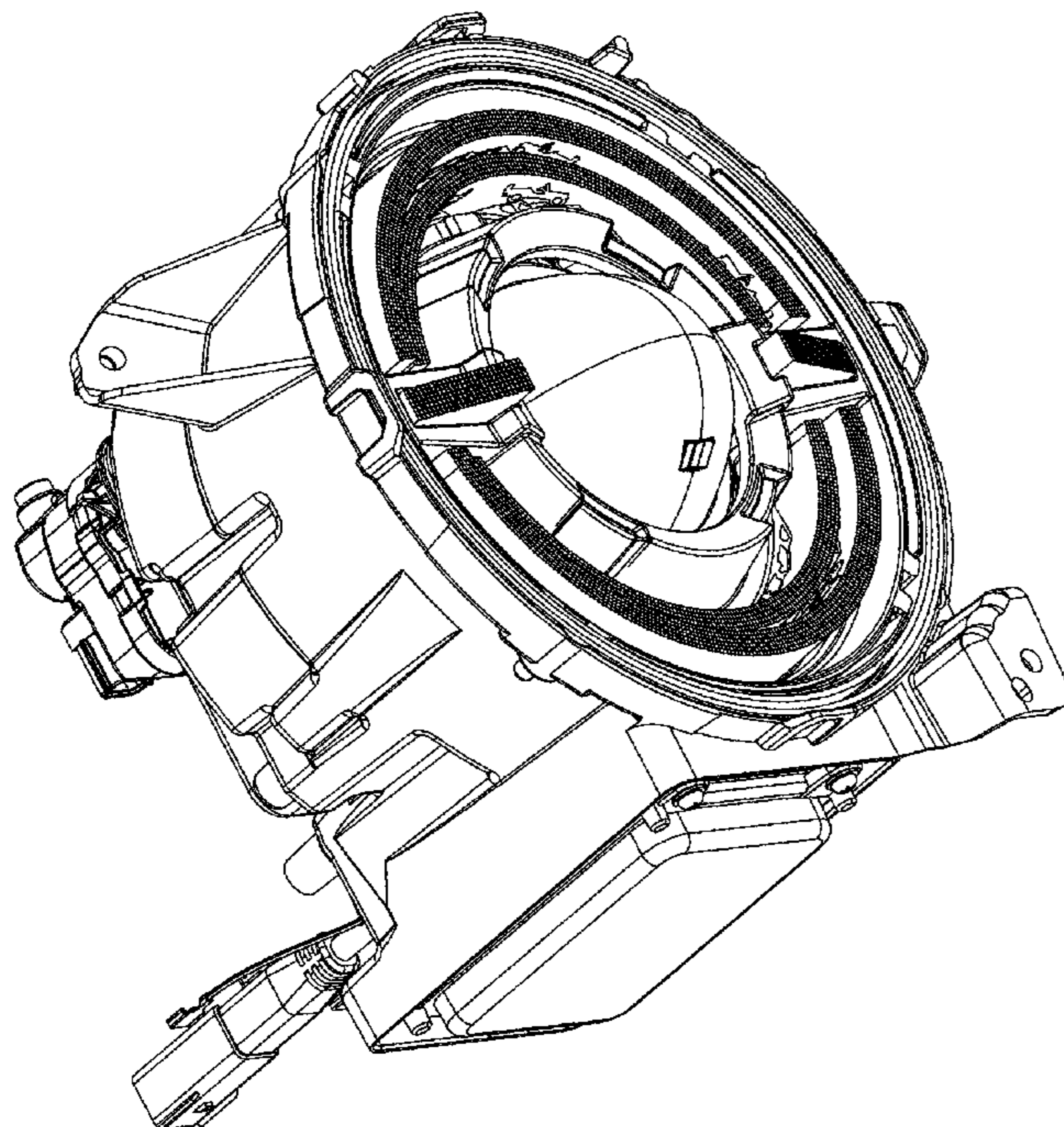

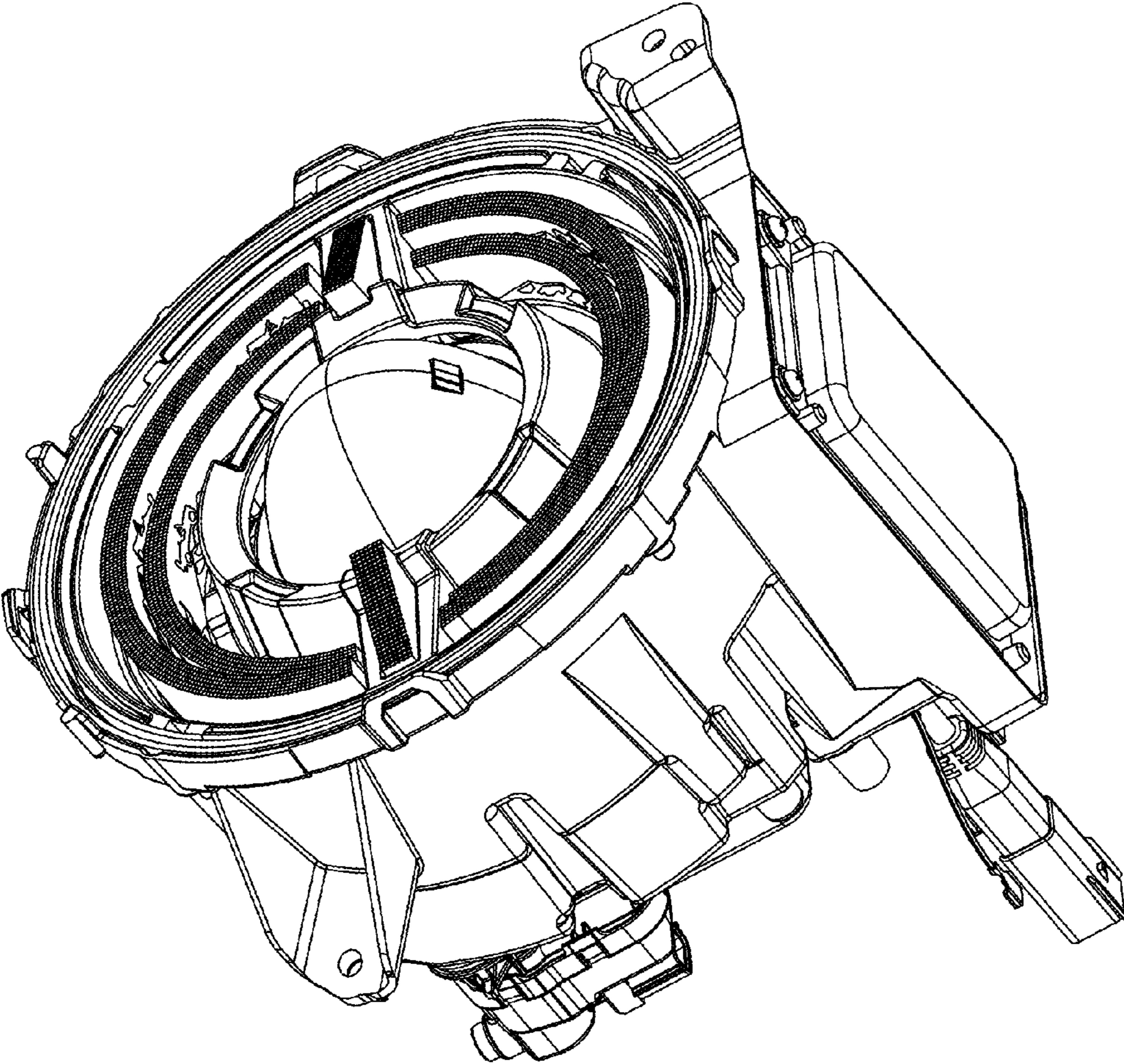

FIG. 1

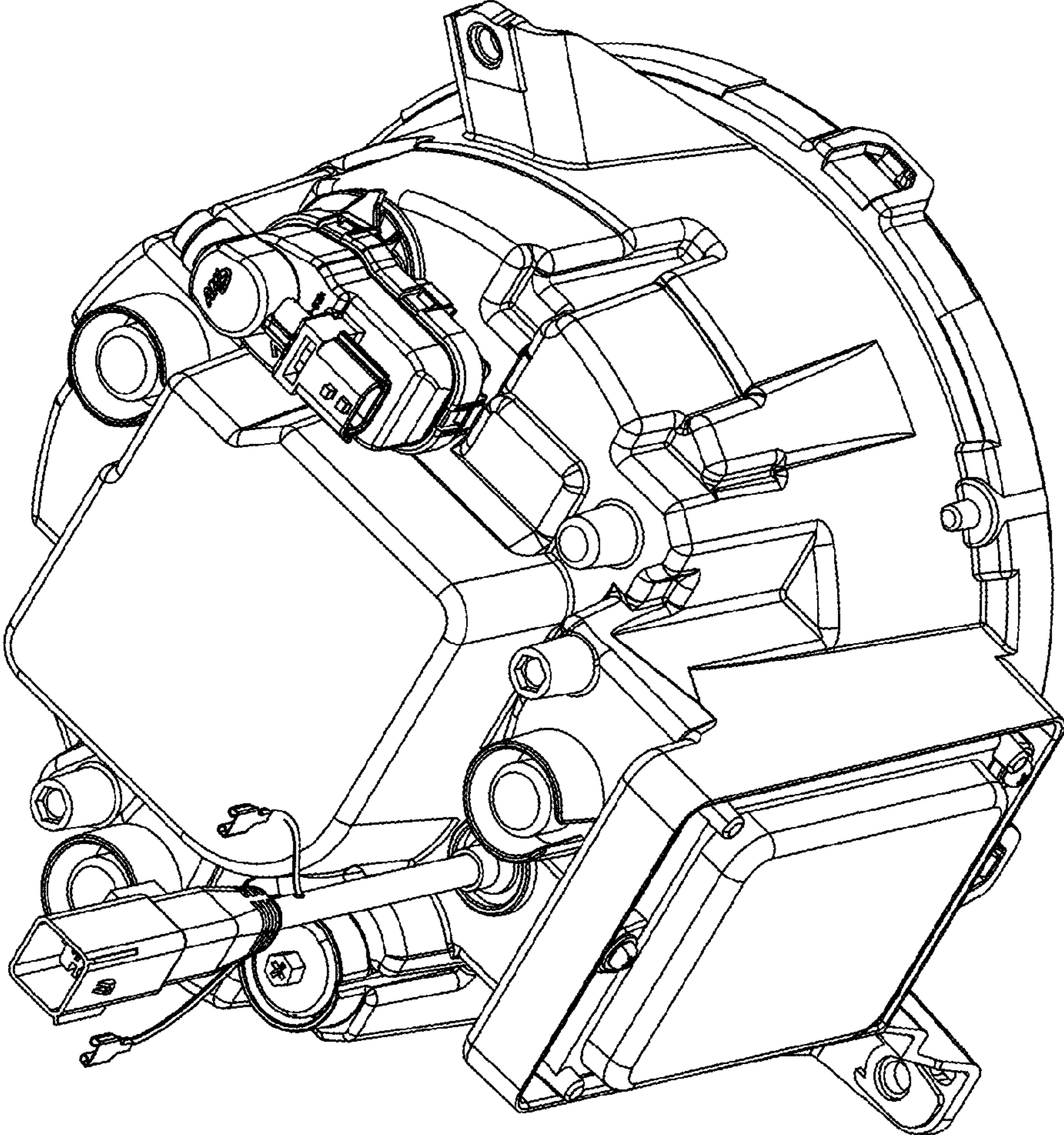
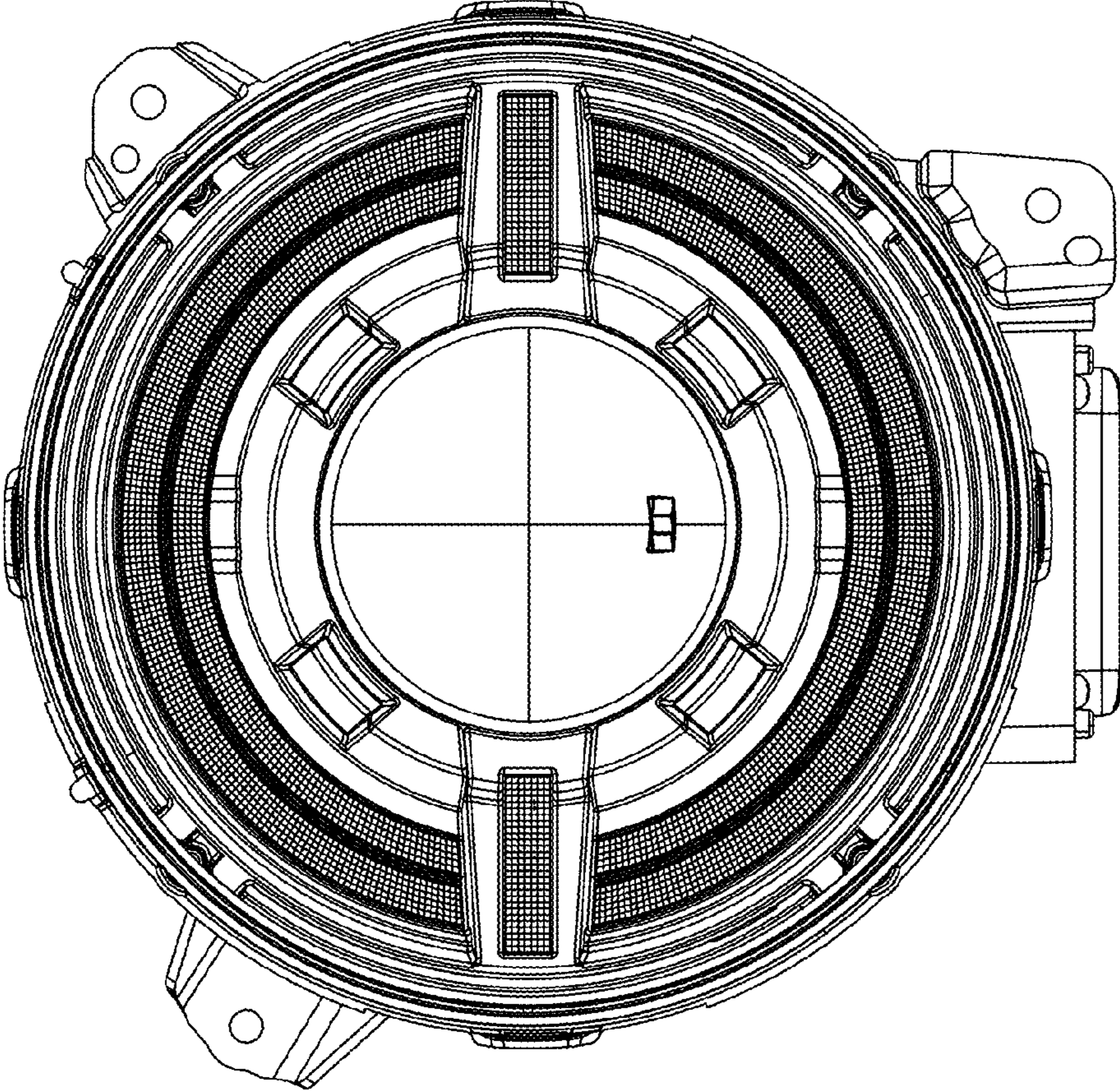

FIG. 2



F I G . 3

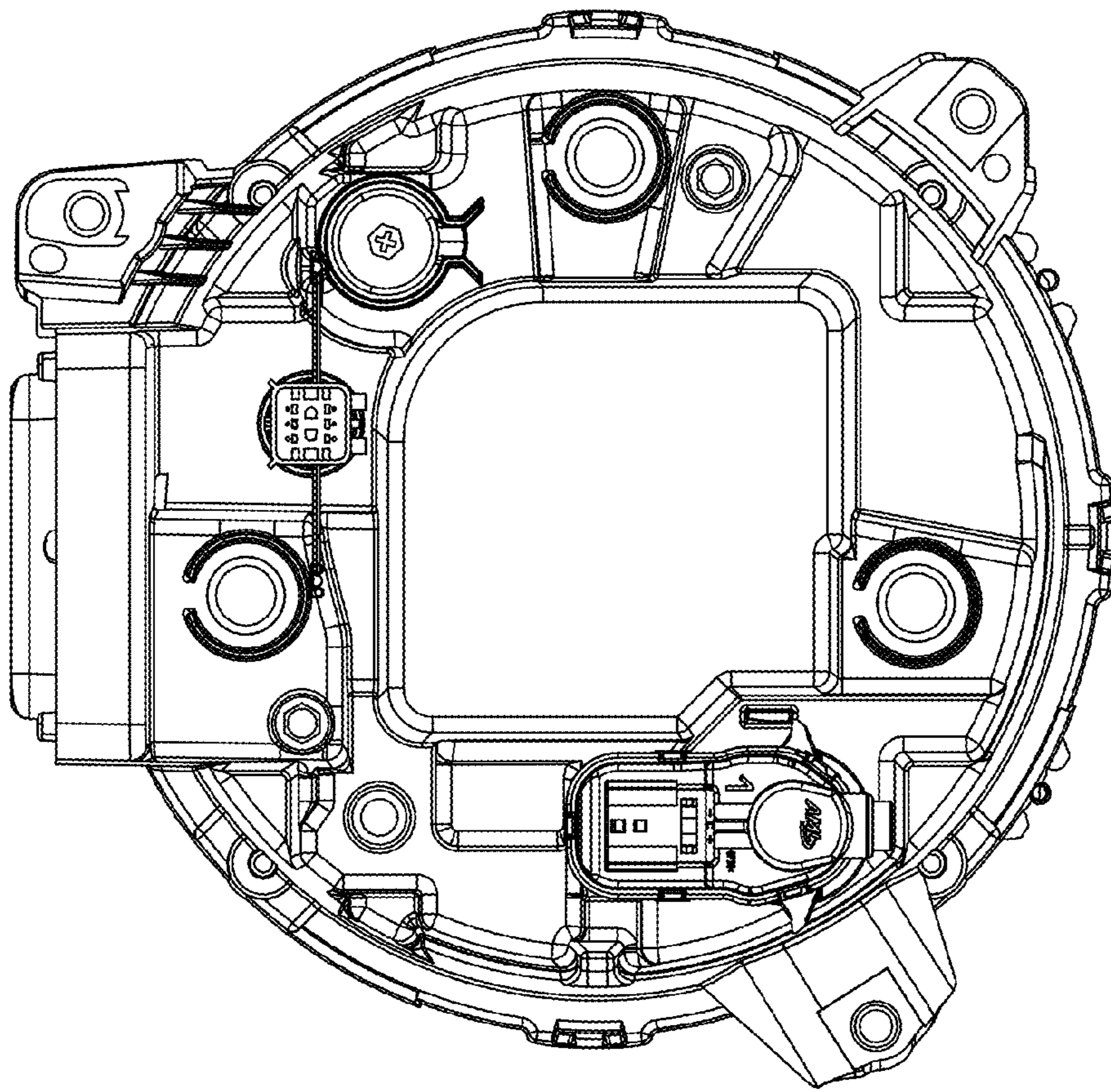

FIG. 4

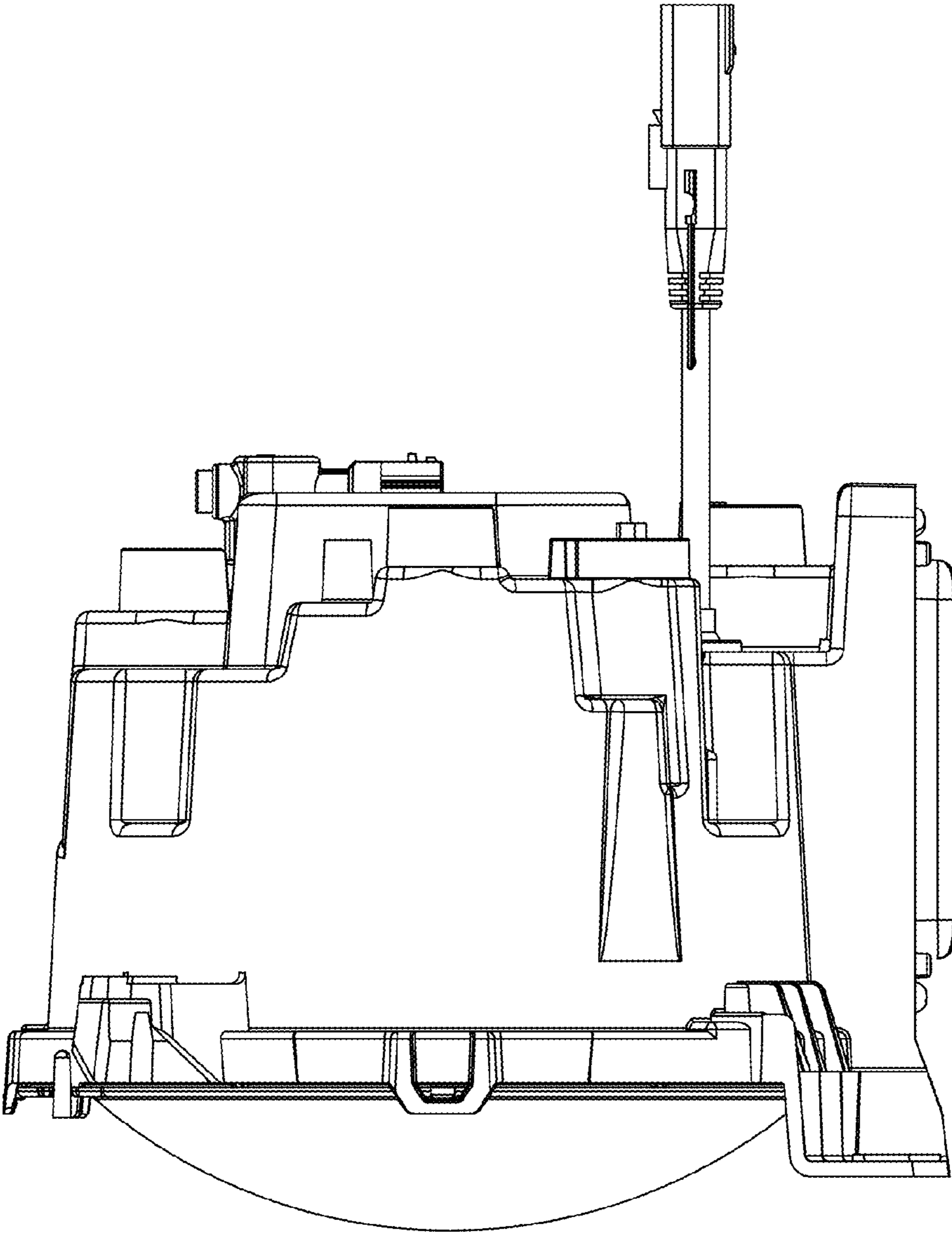

FIG. 5

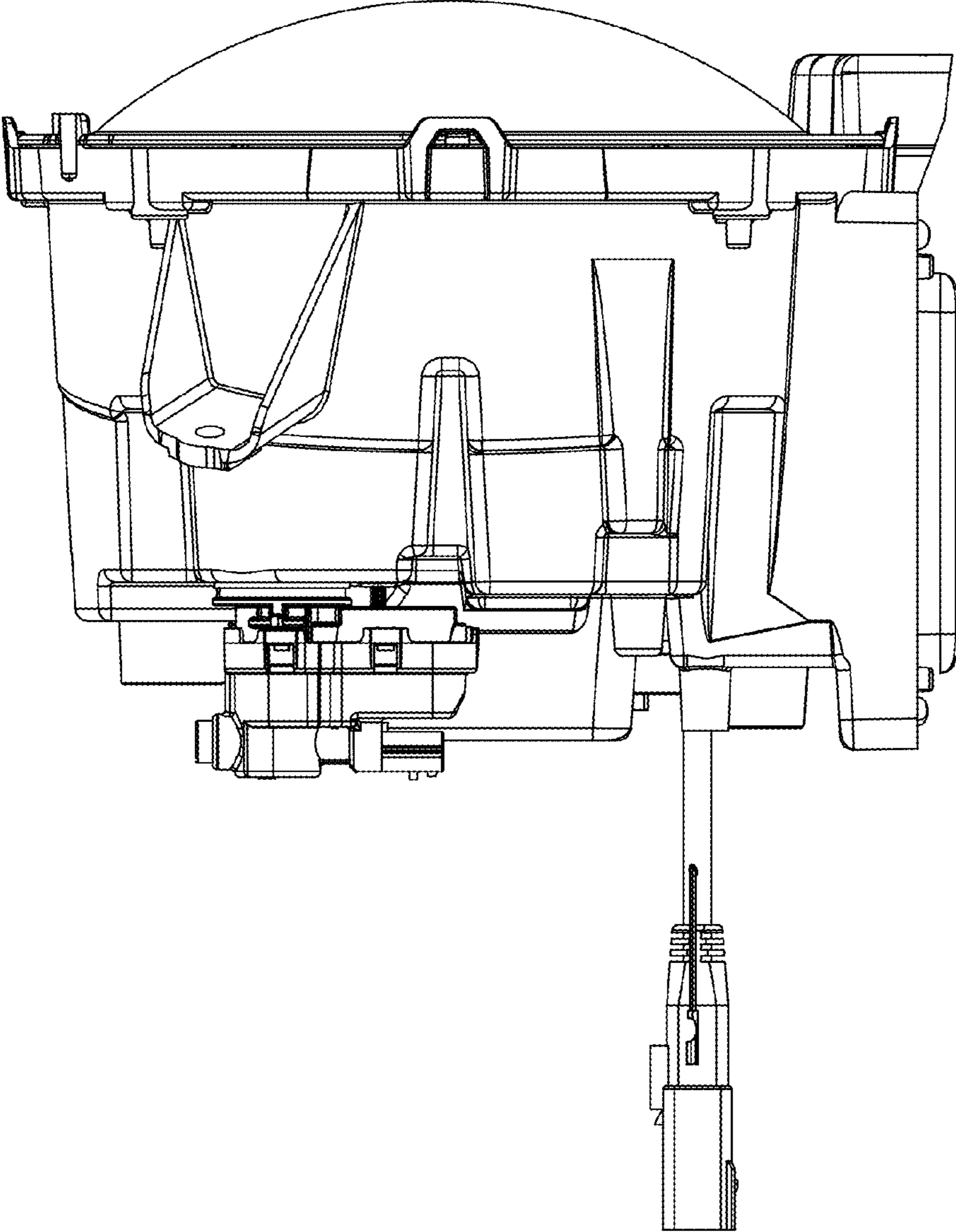

FIG. 6

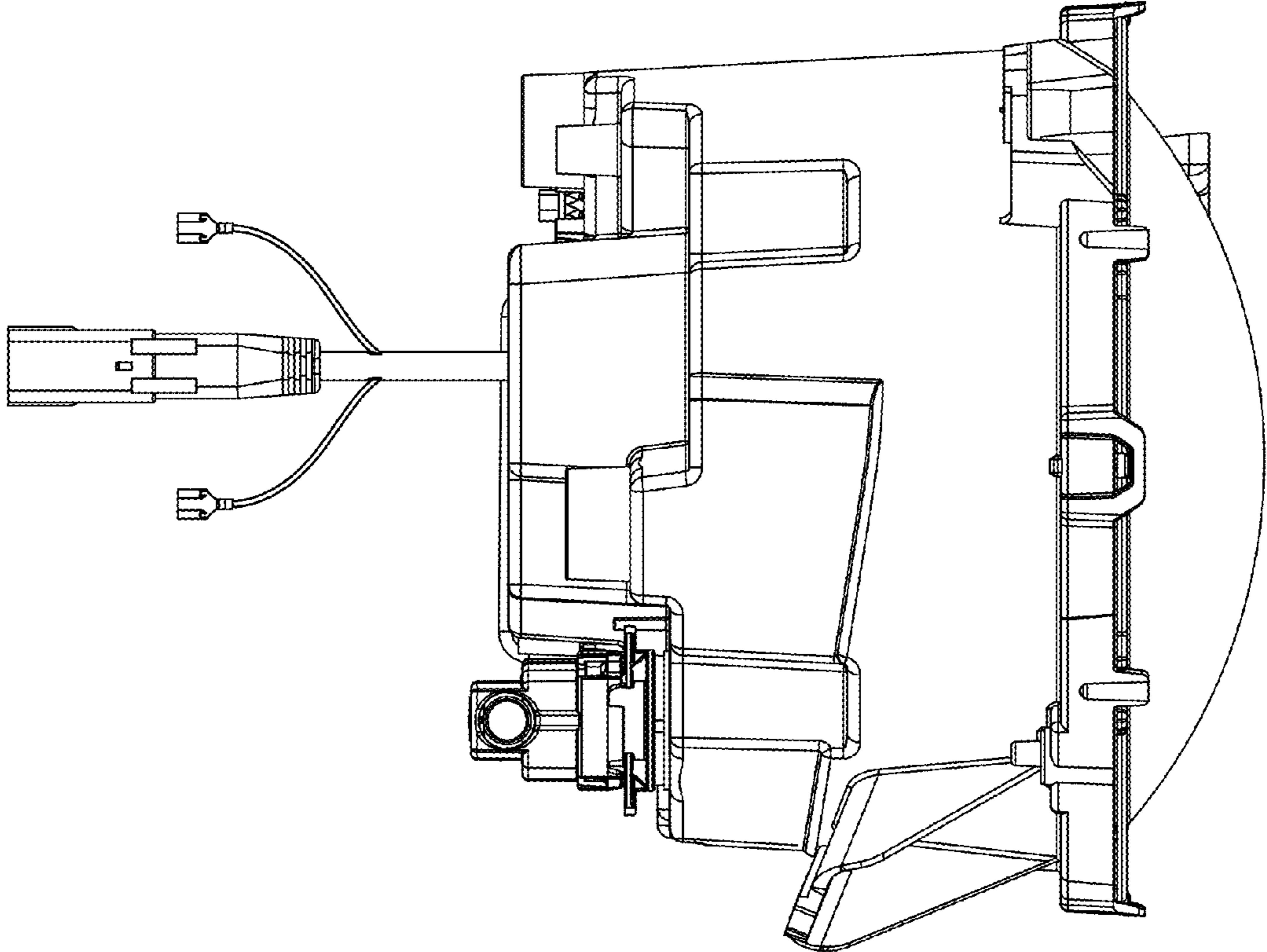

FIG. 7



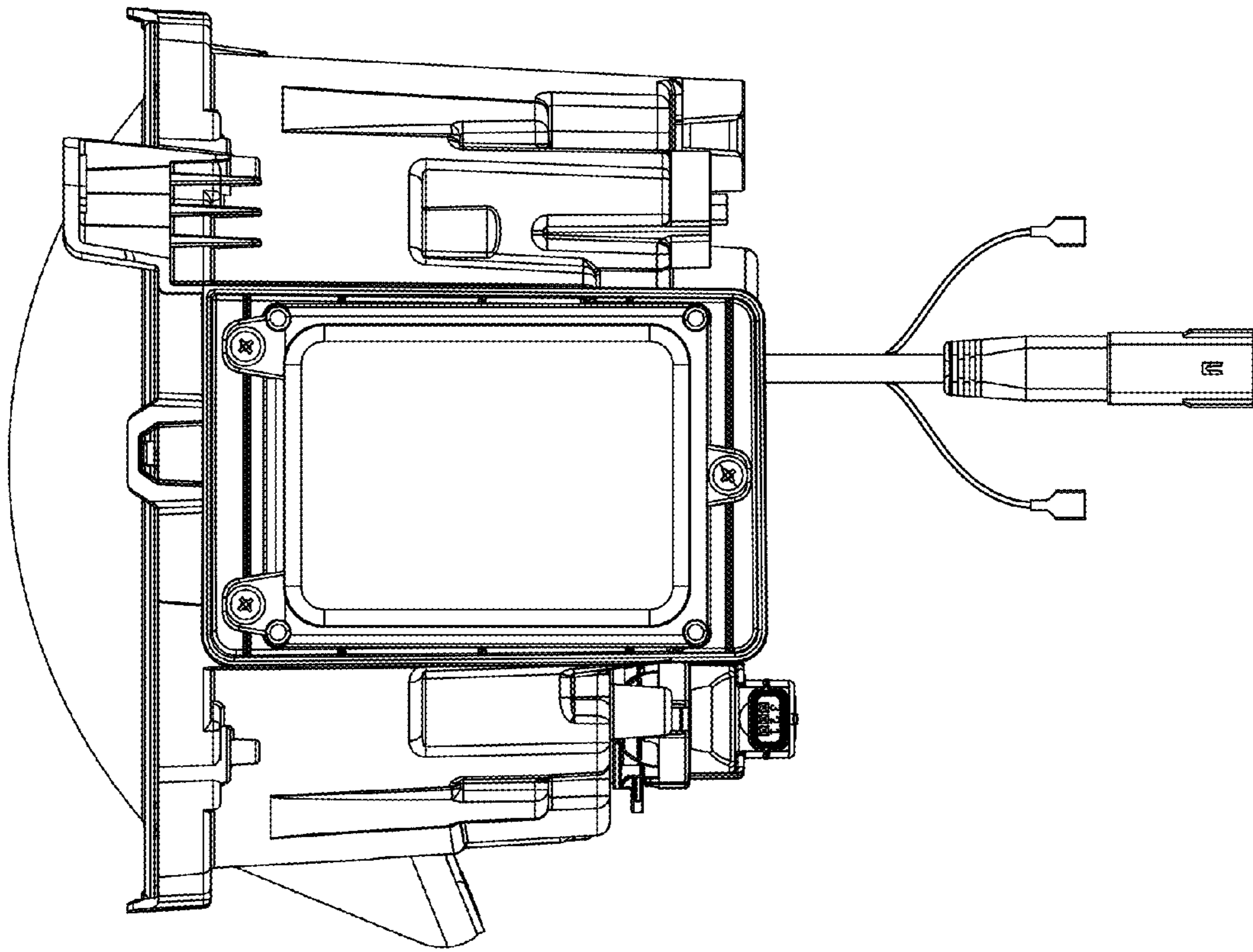

FIG. 8