



US00D934393S

(12) **United States Design Patent** (10) **Patent No.:** **US D934,393 S**  
**Lazarini** (45) **Date of Patent:** **\*\* Oct. 26, 2021**

(54) **SPOUT**

FOREIGN PATENT DOCUMENTS

(71) Applicant: **DELTA FAUCET COMPANY**,  
Indianapolis, IN (US)

WO WO-D075420-001 \* 2/2011

(72) Inventor: **Alejandra Lazarini**, Carmel, IN (US)

OTHER PUBLICATIONS

(73) Assignee: **DELTA FAUCET COMPANY**,  
Indianapolis, IN (US)

Architonic, Lineare Bath spout by Grohe, launched 2017, [online], [visited Apr. 23, 2021]. Internet, <URL: https://www.architonic.com/en/product/grohe-lineare-bath-spout/1504891> (Year: 2017).\*  
Architonic, Hansgrohe Novus Bath spout by Hansgrohe, launched 2017, [online], [visited Apr. 23, 2021]. Internet, <URL: https://www.architonic.com/en/product/hansgrohe-hansgrohe-novus-bath-spout/1519922> (Year: 2017).\*

(\*\*) Term: **15 Years**

(21) Appl. No.: **29/720,651**

\* cited by examiner

(22) Filed: **Jan. 15, 2020**

(51) **LOC (13) Cl.** ..... **23-01**

*Primary Examiner* — Sheryl Lane

(52) **U.S. Cl.**

*Assistant Examiner* — Samantha N Wood

USPC ..... **D23/255**

(74) *Attorney, Agent, or Firm* — Nirav D. Parikh; Edgar A. Zarins

(58) **Field of Classification Search**

USPC ..... D23/257, 249, 254, 259, 255, 233, 234,  
D23/235, 236, 237, 238, 239, 240, 241,  
D23/242, 243, 244, 245, 246, 247, 248,  
D23/250, 251, 252, 253, 256

CPC ..... E03C 1/01; E03C 1/0409; E03C 1/025;  
E03C 1/0408; Y10T 137/5339; Y10T  
137/6014; Y10T 137/6021

See application file for complete search history.

(57) **CLAIM**

The ornamental design for a spout, as shown and described.

**DESCRIPTION**

(56) **References Cited**

U.S. PATENT DOCUMENTS

D271,706 S \* 12/1983 Fabian ..... D23/255  
D530,793 S \* 10/2006 Sutopo ..... D23/255  
D601,229 S \* 9/2009 Schoenherr ..... D23/255  
D617,425 S \* 6/2010 Lammel ..... D23/255  
D659,804 S \* 5/2012 Flowers ..... D23/255  
D719,643 S \* 12/2014 Sedwick ..... D23/249  
D767,733 S \* 9/2016 Hong ..... D23/255  
D800,274 S \* 10/2017 Andrew ..... D23/255  
D865,133 S \* 10/2019 Hoogendoorn ..... D23/255

FIG. 1 is a front perspective view of a spout showing my new design;

FIG. 2 is a rear perspective view thereof;

FIG. 3 is a front elevational view thereof;

FIG. 4 is a left side elevational view thereof;

FIG. 5 is a rear elevational view thereof;

FIG. 6 is a right side elevational view thereof;

FIG. 7 is a top plan view thereof; and,

FIG. 8 is a bottom plan view thereof.

**1 Claim, 4 Drawing Sheets**

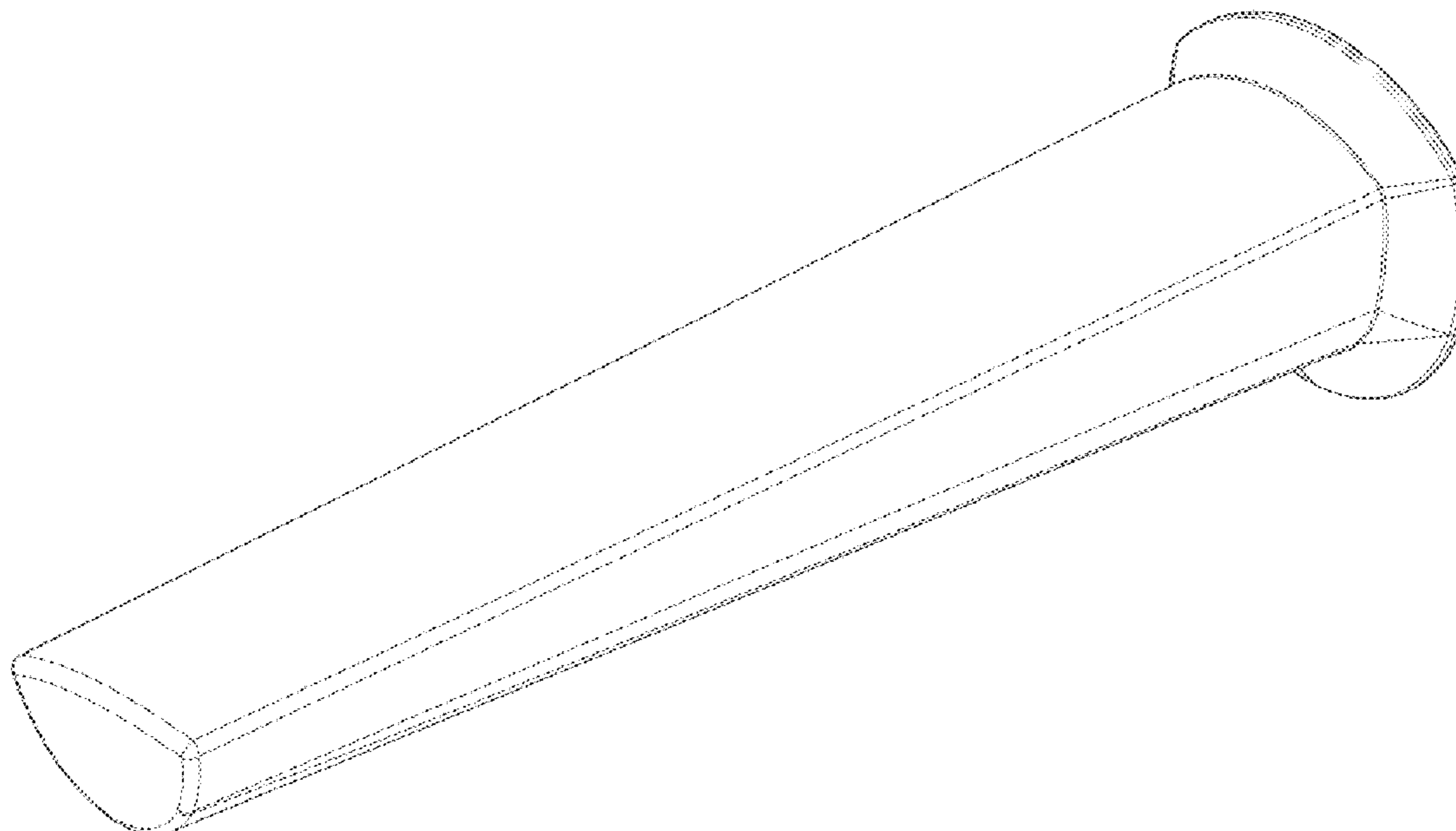

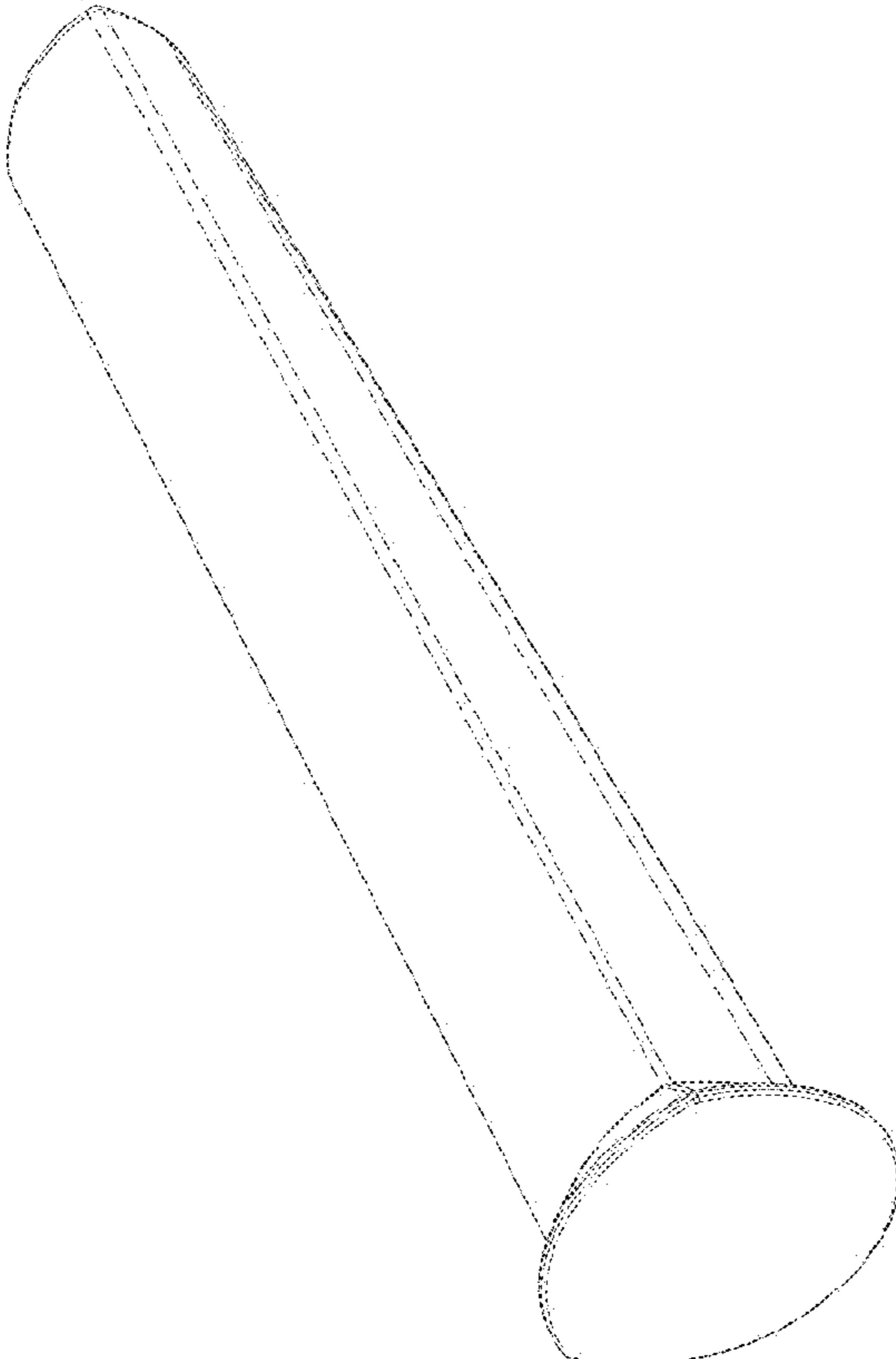

FIG. 2

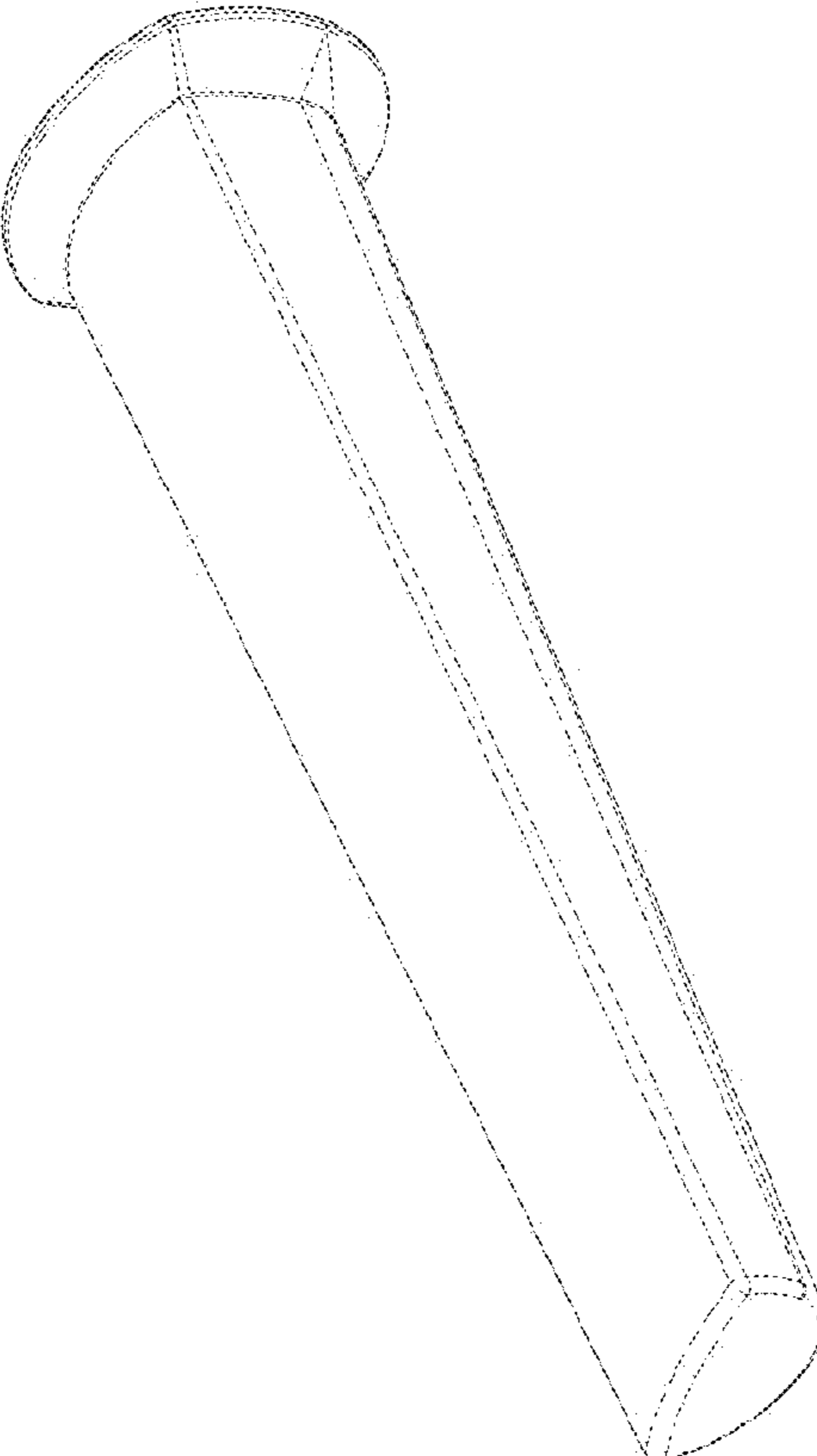

FIG. 1

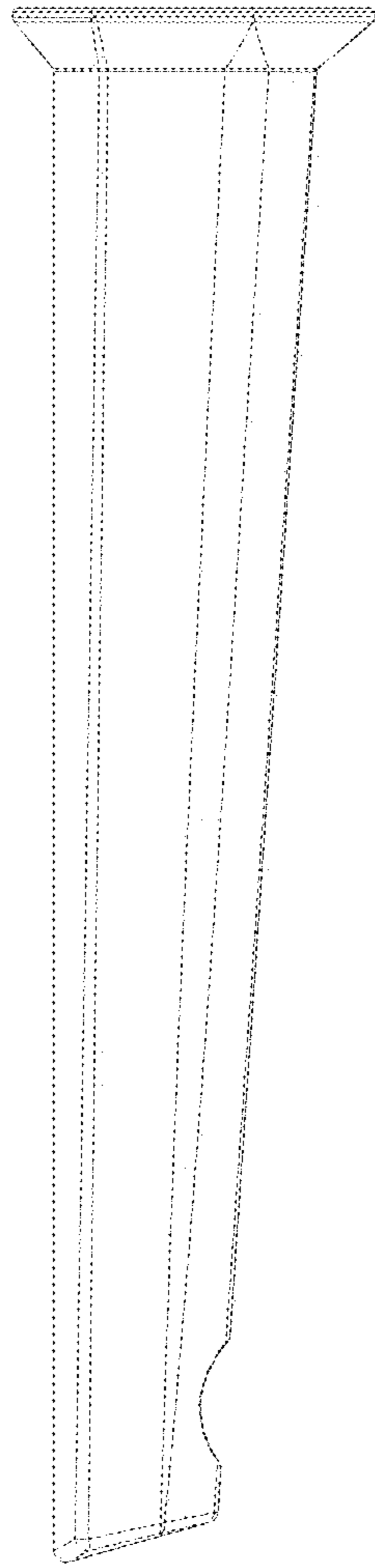

FIG - 4

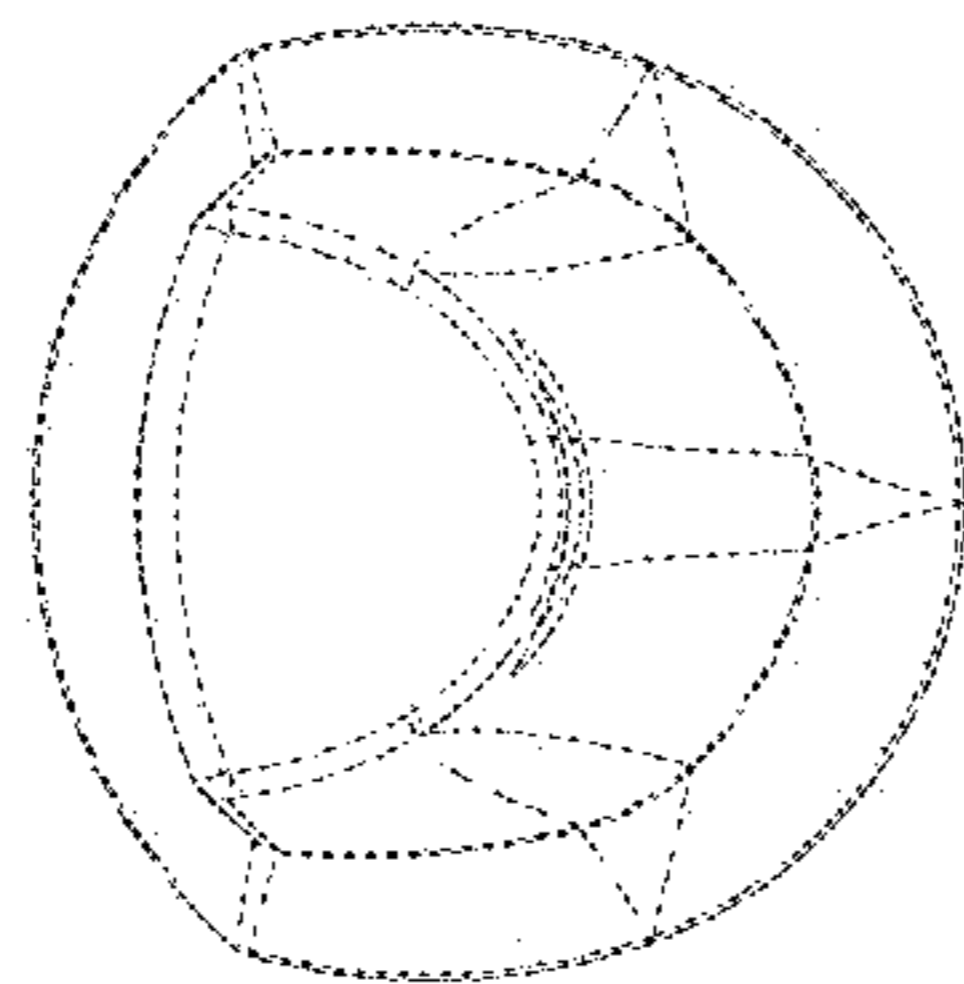

FIG - 3

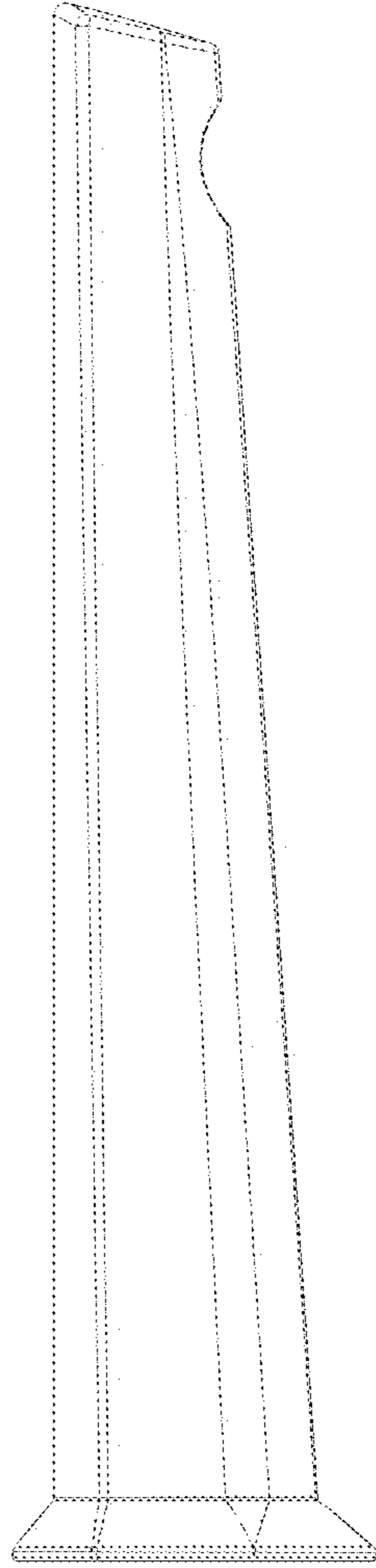

FIG - 6

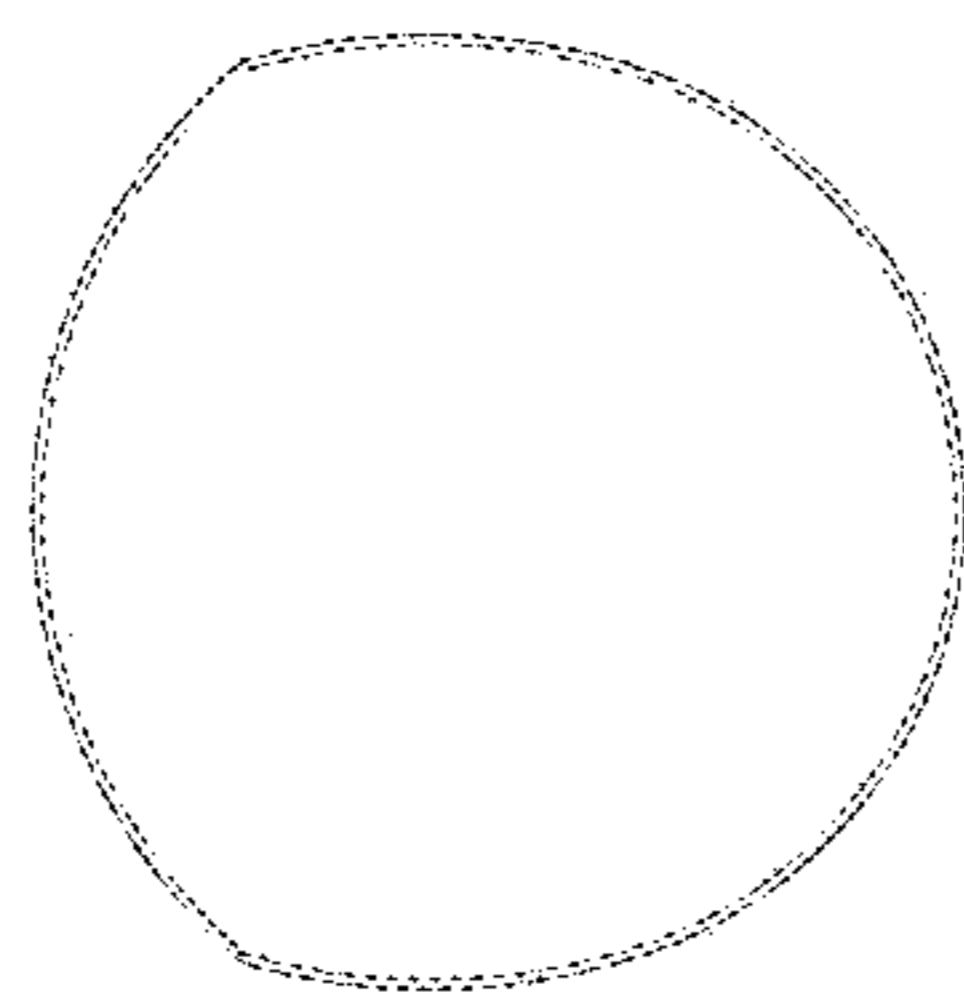

FIG - 5

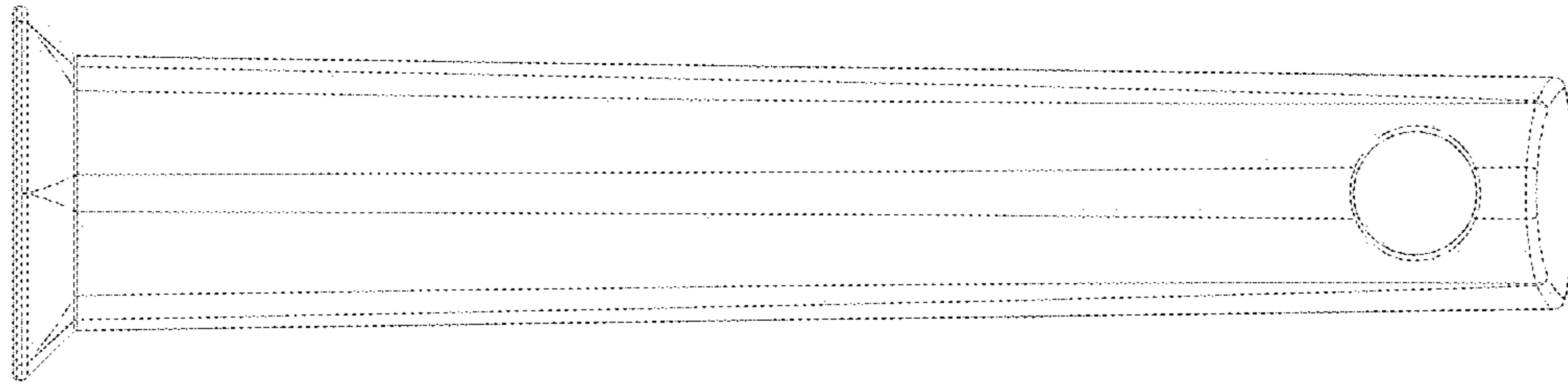

FIG - 8

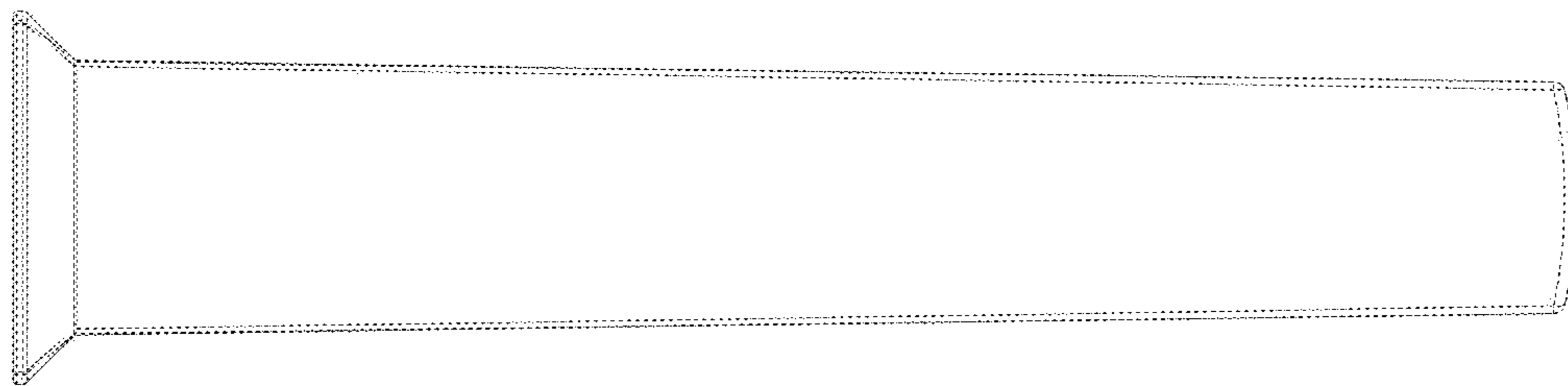

FIG - 7