



US00D933720S

(12) **United States Design Patent** (10) **Patent No.:** **US D933,720 S**
Masuda et al. (45) **Date of Patent:** **** Oct. 19, 2021**

(54) **BACKHOE**

Primary Examiner — Richard E Chilcot

(71) Applicant: **KUBOTA CORPORATION**, Osaka (JP)

(74) *Attorney, Agent, or Firm* — The Webb Law Firm

(72) Inventors: **Ryo Masuda**, Sakai (JP); **Yoichi Nishigori**, Sakai (JP); **Hideki Omori**, Sakai (JP); **Tsuyoshi Nishimura**, Sakai (JP)

(57) **CLAIM**

The ornamental design for a backhoe, as shown and described.

(73) Assignee: **Kubota Corporation**, Osaka (JP)

DESCRIPTION

(**) Term: **15 Years**

The patent or application file contains at least one drawing executed in color. Copies of this patent or patent application publication with color drawing(s) will be provided by the Office upon request and payment of the necessary fee.

(21) Appl. No.: **35/509,257**

1.1 is a front elevation view of a backhoe, showing our new design;

(22) Filed: **Mar. 27, 2020**

1.2 is a rear elevation view thereof;

(80) **Hague Agreement Data**

Int. Filing Date: **Mar. 27, 2020**

Int. Reg. No.: **DM/207524**

Int. Reg. Date: **Mar. 27, 2020**

Int. Reg. Pub. Date: **May 1, 2020**

1.3 is a left side elevation view thereof;

1.4 is a right side elevation view thereof;

1.5 is a top view thereof;

1.6 is an enlarged top view of a portion thereof showing an inside of the cabin, with the top of the cabin removed for convenience;

(30) **Foreign Application Priority Data**

Sep. 30, 2019 (JP) 2019-021992

Sep. 30, 2019 (JP) 2019-021993

Sep. 30, 2019 (JP) 2019-021995

1.7 is an enlarged upper rear perspective view of a portion thereof showing the inside of the cabin, with the top of the cabin removed for convenience;

1.8 is an enlarged upper front perspective view thereof showing the inside of the cabin, with the top of the cabin removed for convenience;

(51) **LOC (13) Cl.** **15-04**

(52) **U.S. Cl.**
USPC **D15/28**

1.9 is a further enlarged top view of a portion thereof showing the inside of the cabin, with the top of the cabin removed for convenience;

(58) **Field of Classification Search**
USPC D15/10, 22–28, 30, 31, 33; 180/89.1, 180/89.12, 89.13, 900, 9.1, 9.2, 9.62;
(Continued)

1.10 is an another front elevation view thereof;

1.11 is an another rear elevation view thereof;

1.12 is an another left side elevation view thereof;

1.13 is another right side elevation view thereof;

1.14 is another top view thereof;

(56) **References Cited**

U.S. PATENT DOCUMENTS

4,600,236 A * 7/1986 Weiss B62D 33/0617
296/190.03

D420,685 S * 2/2000 Muranen D15/30
(Continued)

1.15 is another enlarged top view of a portion thereof showing an inside of the cabin, with the top of the cabin removed for convenience;

1.16 is another enlarged upper rear perspective view of a portion thereof showing the inside of the cabin, with the top of the cabin removed for convenience;

(Continued)

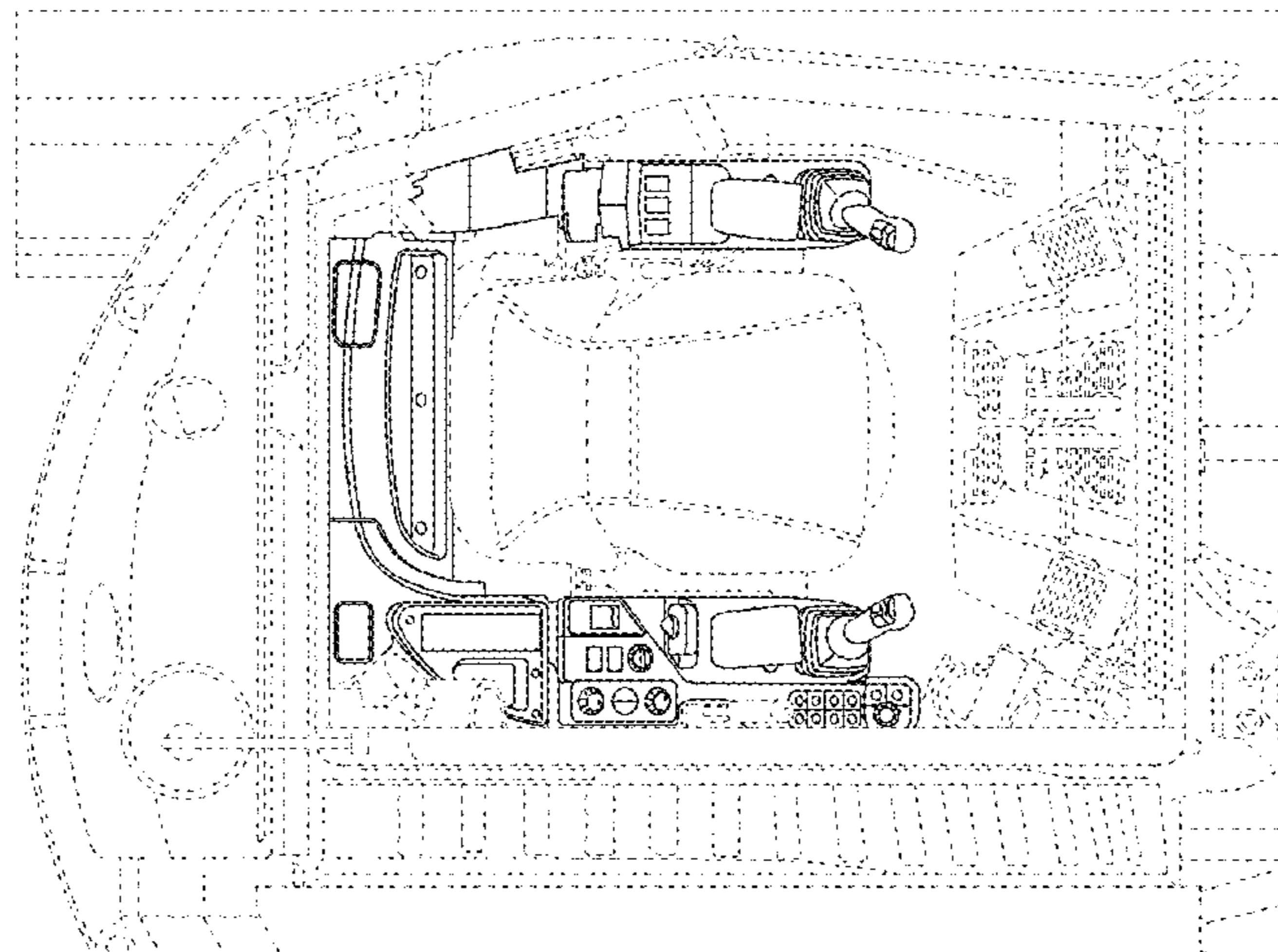

1.17 is another enlarged upper front perspective view thereof showing the inside of the cabin, with the top of the cabin removed for convenience; and

1.18 is another further enlarged top view of a portion thereof showing the inside of the cabin, with the top of the cabin removed for convenience.

A bottom view is omitted because it is plain and unornamental and forms no part of the subject matter of the claimed design.

The portions of the backhoe shown in broken lines in Reproductions 1.1-1.9 form no part of the claimed design. The portions of the backhoe colored gold (yellow and orange) in Reproductions 1.10-1.18 form no part of the claimed design.

**1 Claim, 18 Drawing Sheets
(9 of 18 Drawing Sheet(s) Filed in Color)**

- (52) **U.S. Cl.**
CPC *E02F 9/18* (2013.01)
- (58) **Field of Classification Search**
USPC 414/694, 699, 722-724, 660, 685, 698,
414/719, 743
CPC . E02F 9/163; E02F 9/0886; E02F 9/18; E02F
3/32; E02F 3/76; E02F 3/40; F01N
13/001; F01N 2590/08
See application file for complete search history.

(56) **References Cited**

U.S. PATENT DOCUMENTS

- 6,039,141 A * 3/2000 Denny B60N 2/797
180/329
- D463,459 S * 9/2002 Tamaru D15/28

- D513,415 S * 1/2006 Klein D15/30
- D516,096 S * 2/2006 Bergman D15/28
- D516,097 S * 2/2006 Bergman D15/28
- D519,132 S * 4/2006 Laux D15/28
- D524,509 S * 7/2006 Cantrill D12/192
- D525,409 S * 7/2006 Cantrill D12/192
- D532,427 S * 11/2006 Kim D15/28
- D539,311 S * 3/2007 Honda D15/28
- D546,841 S * 7/2007 McCarren, Jr. D15/28
- D549,739 S * 8/2007 Stephens D15/28
- D555,676 S * 11/2007 Haubrich D15/28
- D614,205 S 4/2010 Kuwae et al.
- D656,966 S * 4/2012 Iwata D15/28
- D664,998 S * 8/2012 Warr D15/28
- D678,355 S * 3/2013 Warr D15/28
- D685,007 S * 6/2013 Tanaka D15/28
- D689,529 S * 9/2013 Hagura D15/28
- D730,948 S * 6/2015 Higuchi D15/28
- D741,236 S * 10/2015 Schnering D12/195
- D760,813 S * 7/2016 Roemer D15/28
- D767,643 S * 9/2016 Sohngen D15/28
- D783,686 S * 4/2017 Jilbert D15/28
- D786,313 S * 5/2017 Okuyama D15/28
- D803,273 S * 11/2017 Sewell D15/28
- D847,869 S * 5/2019 Sachtleben D15/28
- D847,870 S * 5/2019 Sachtleben D15/28
- D856,379 S * 8/2019 Ninomiya D15/28
- D856,380 S * 8/2019 Ninomiya D15/28
- D856,381 S * 8/2019 Ninomiya D15/28
- D857,755 S * 8/2019 Ninomiya D15/28
- D887,456 S * 6/2020 Adachi D15/28
- D887,457 S * 6/2020 Adachi D15/28
- D887,458 S * 6/2020 Adachi D15/28
- D918,275 S * 5/2021 Masuda E02F 9/18
D15/28
- D920,388 S * 5/2021 Wagner D15/28
- 2014/0034403 A1 * 2/2014 Tokuda E02F 9/0866
180/89.12

* cited by examiner

1.1

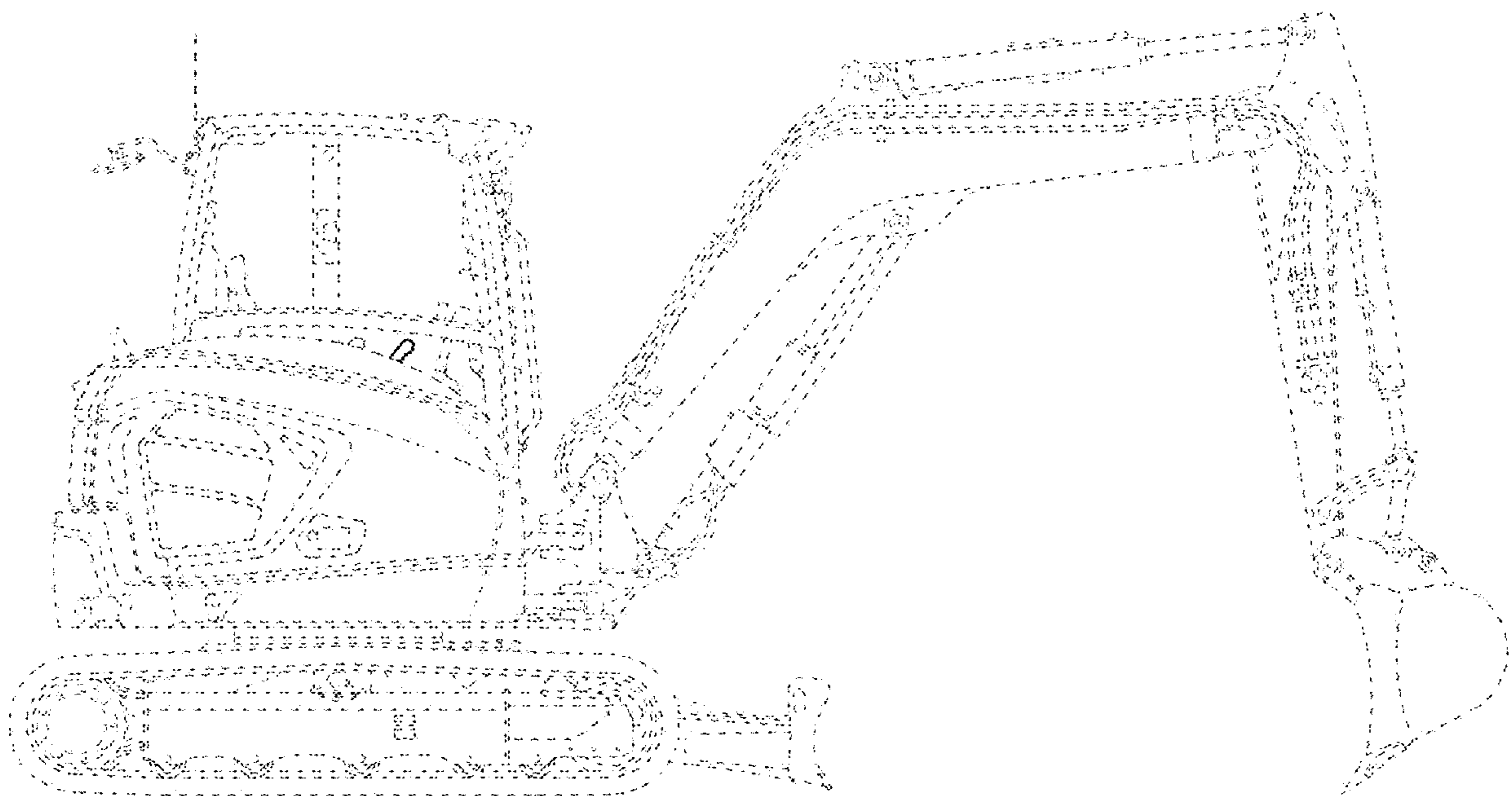

1.2

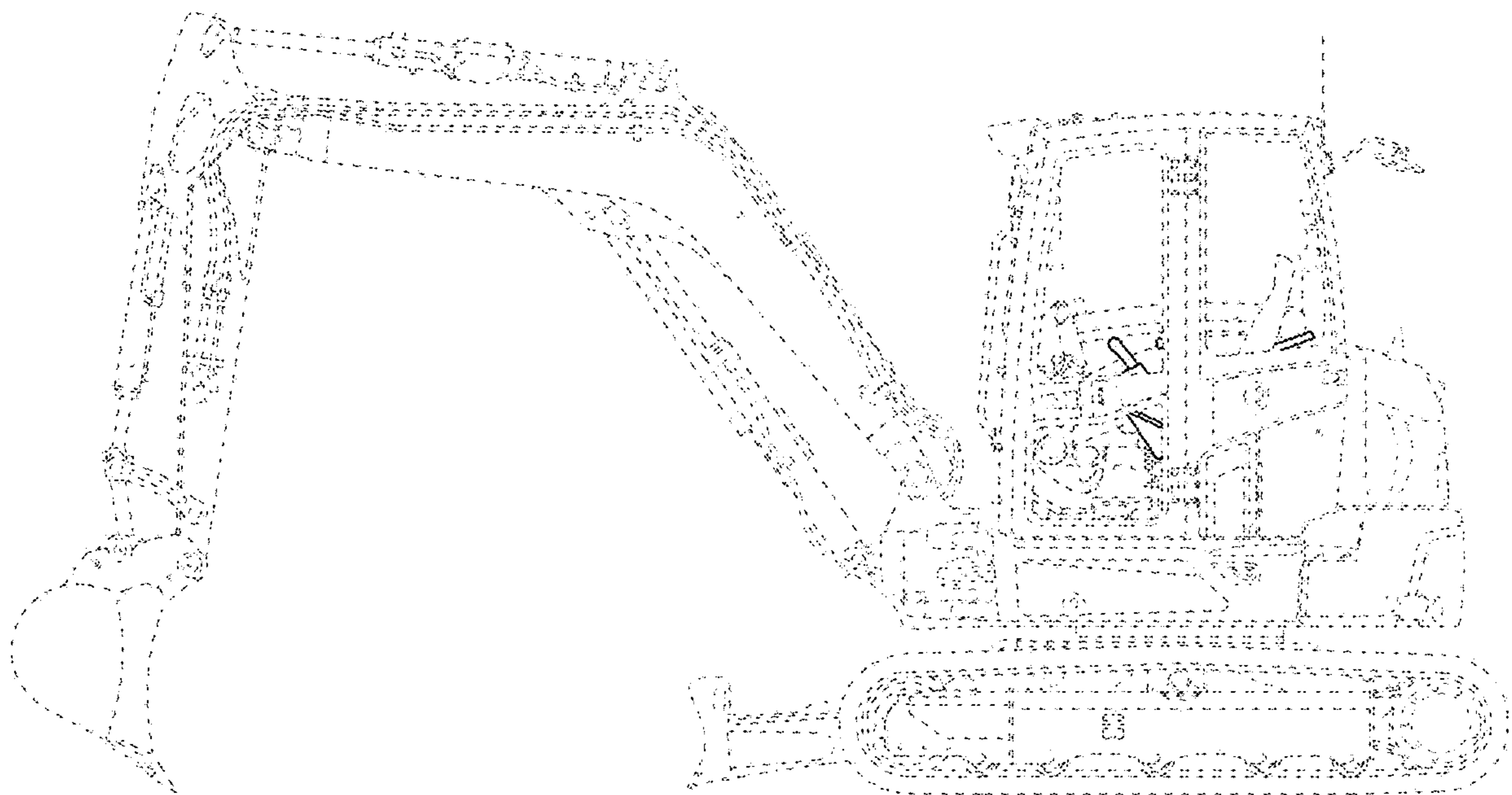

1.3

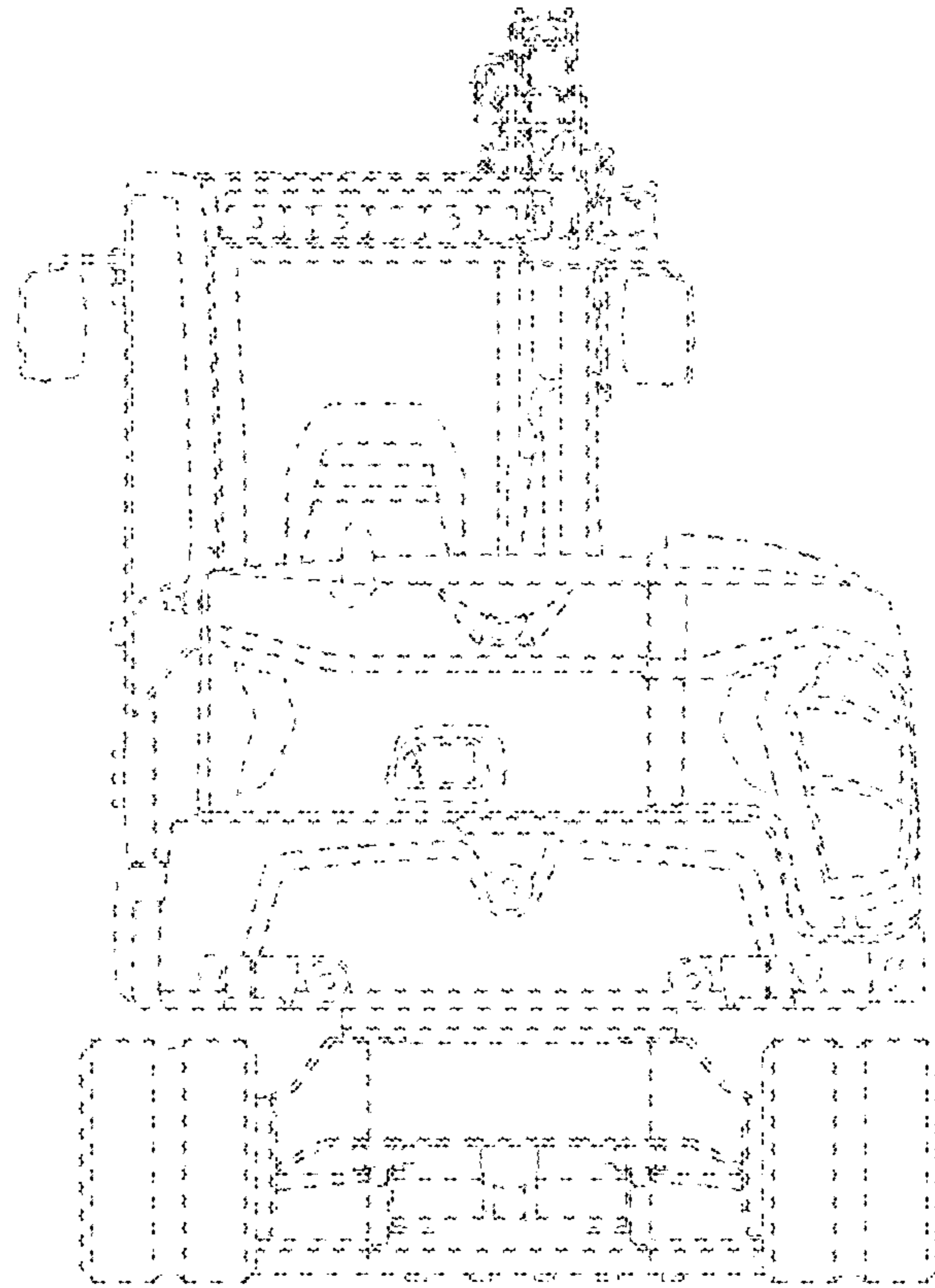

1.4

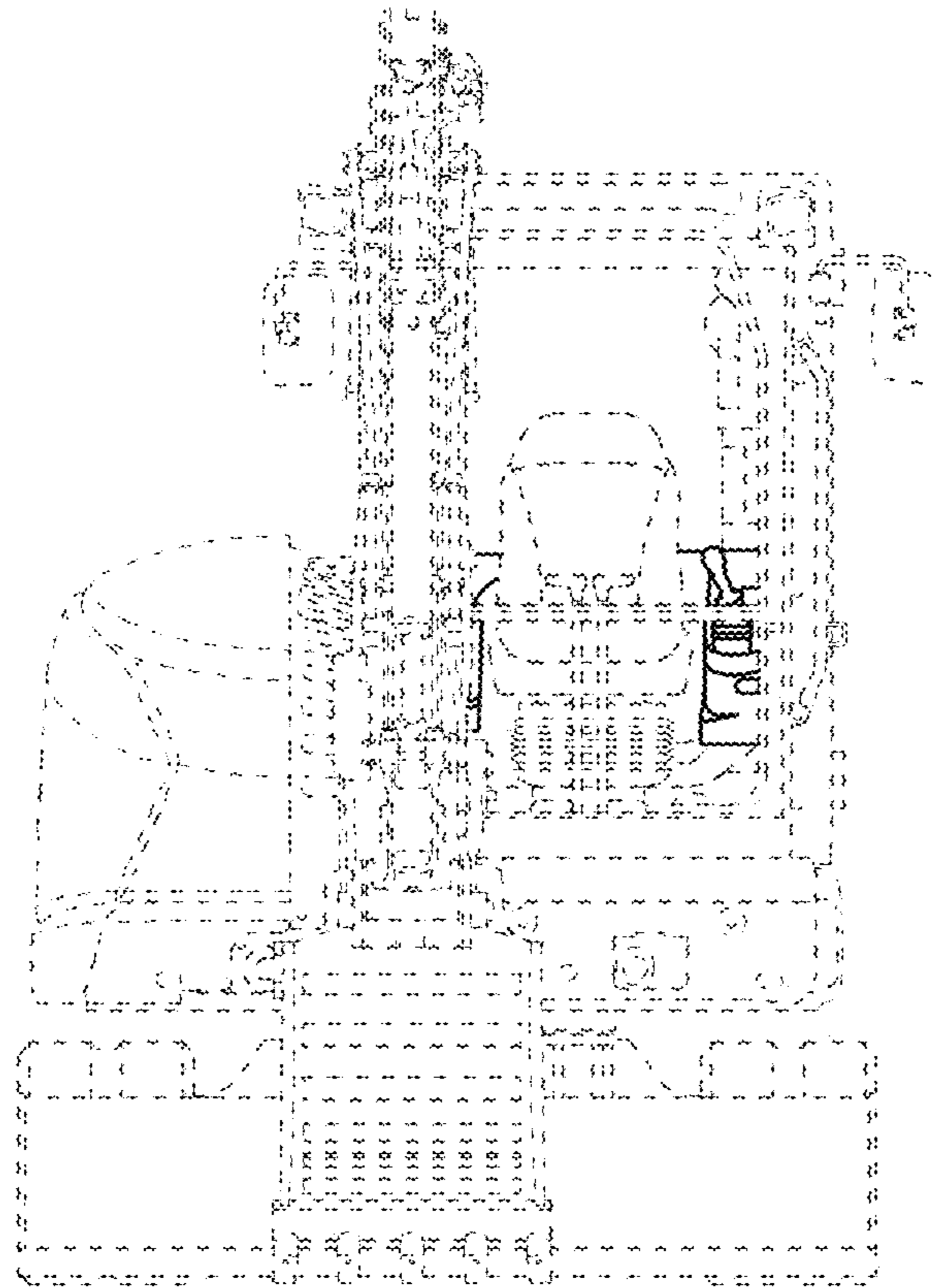

1.5

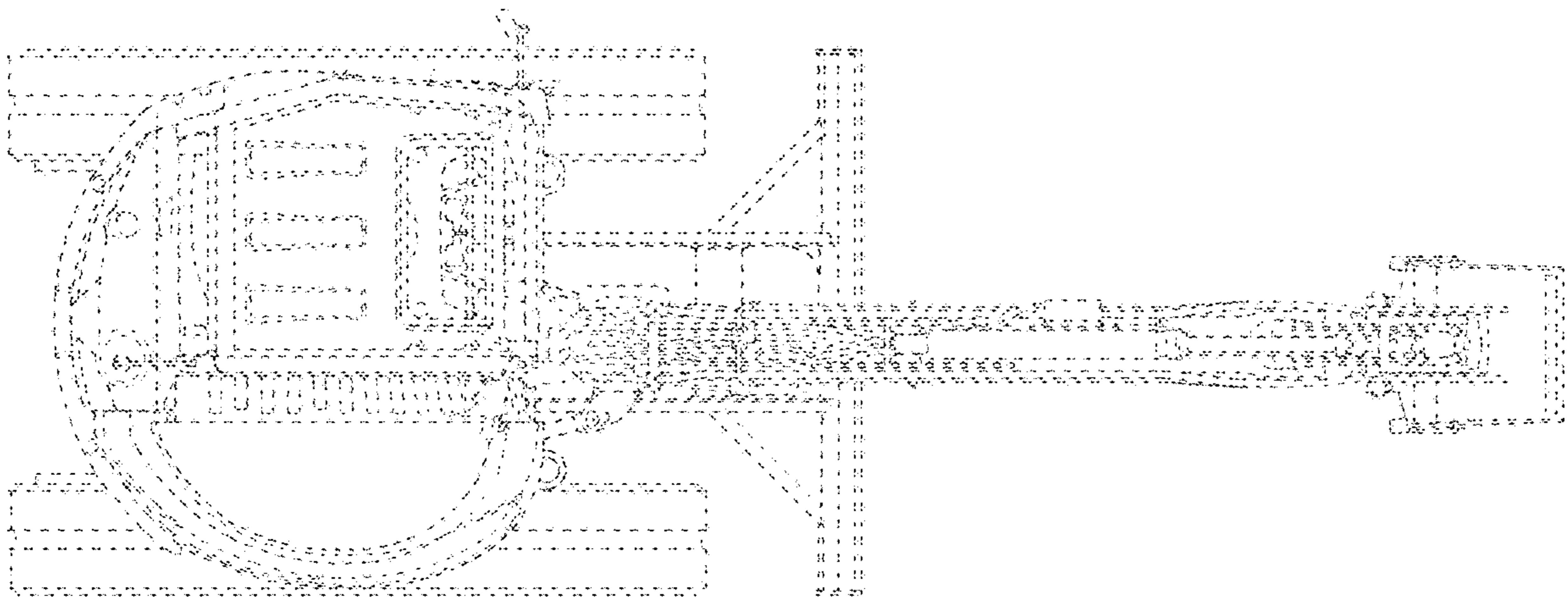

1.6

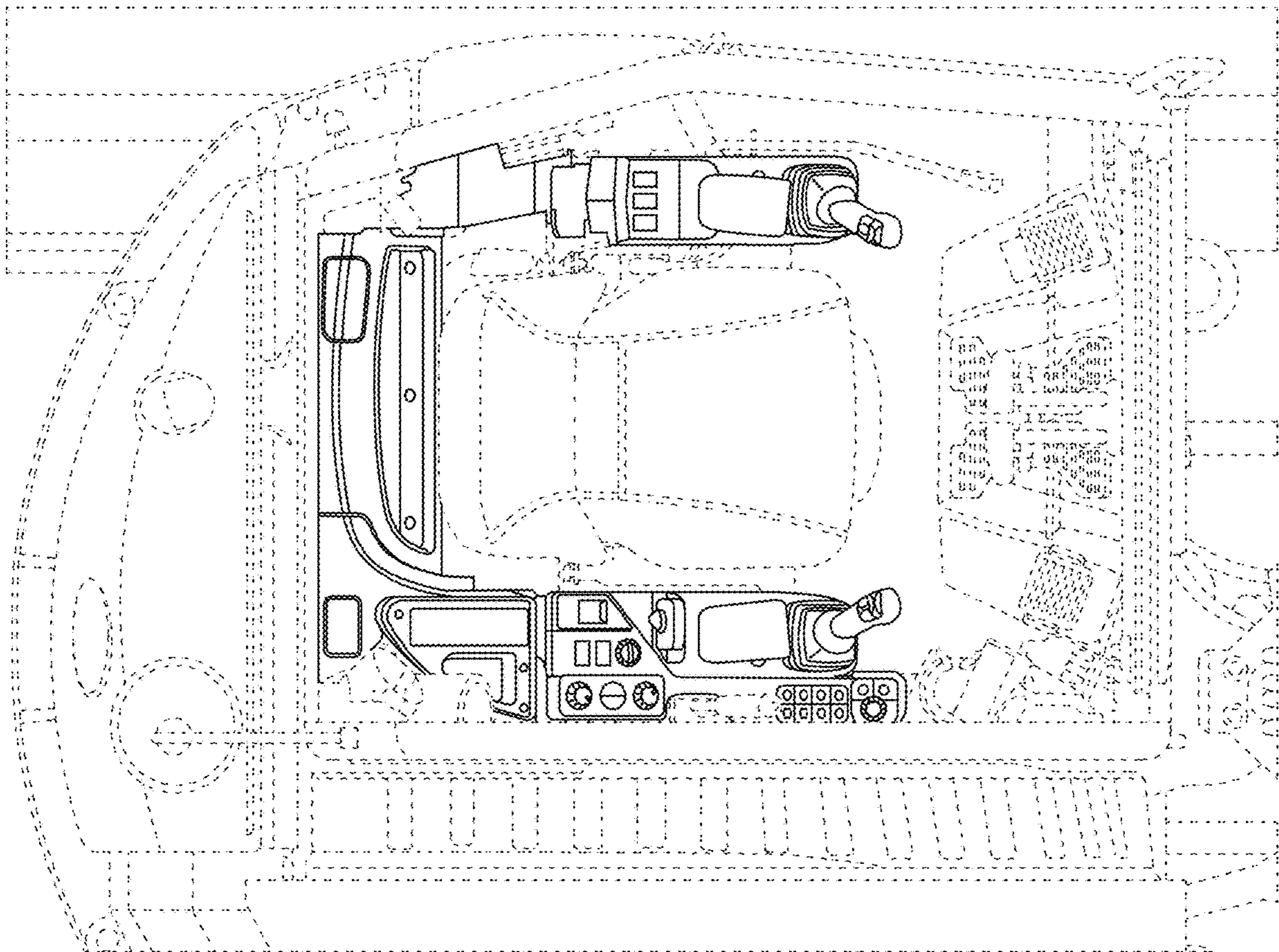

1.7

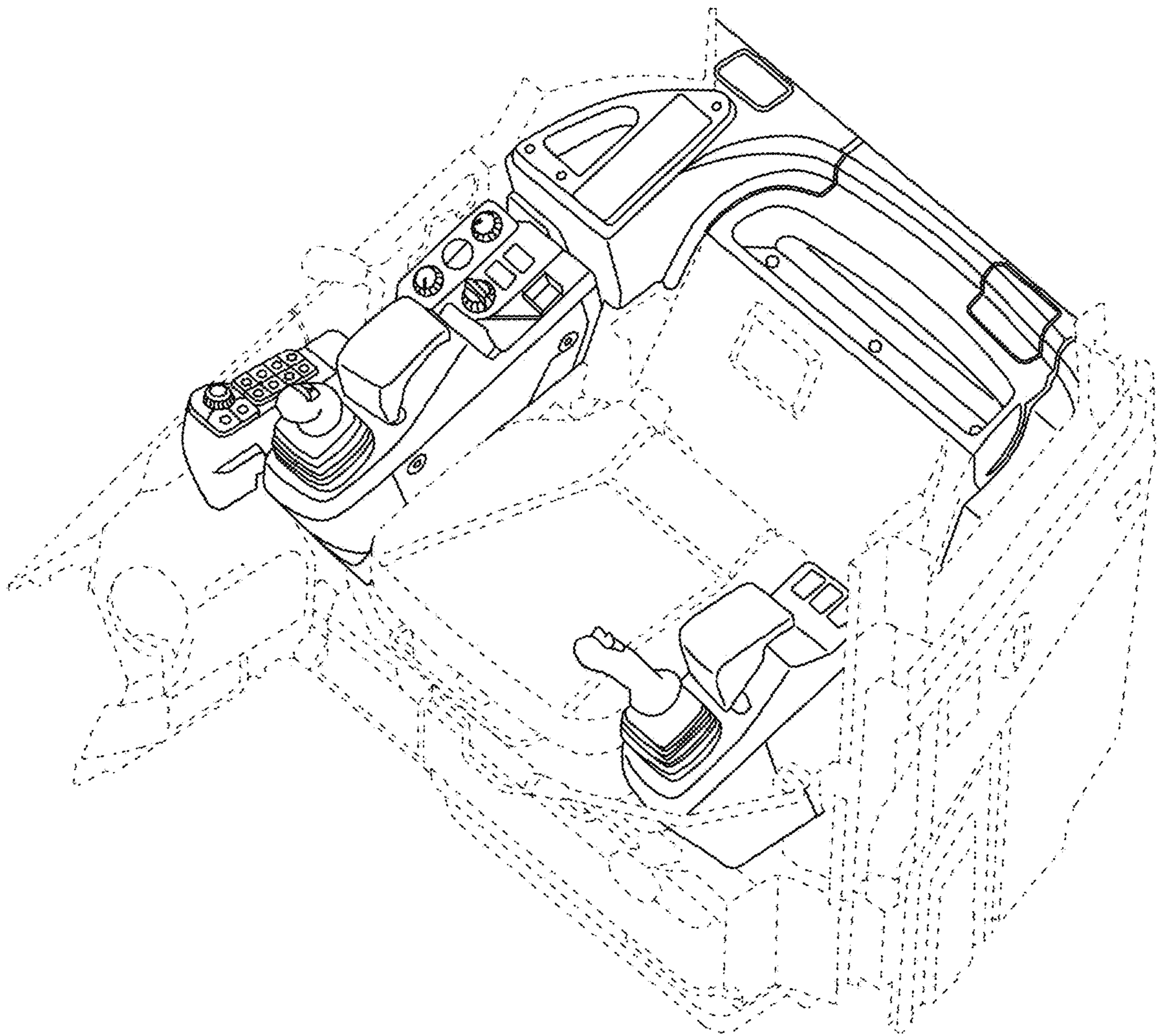

1.8

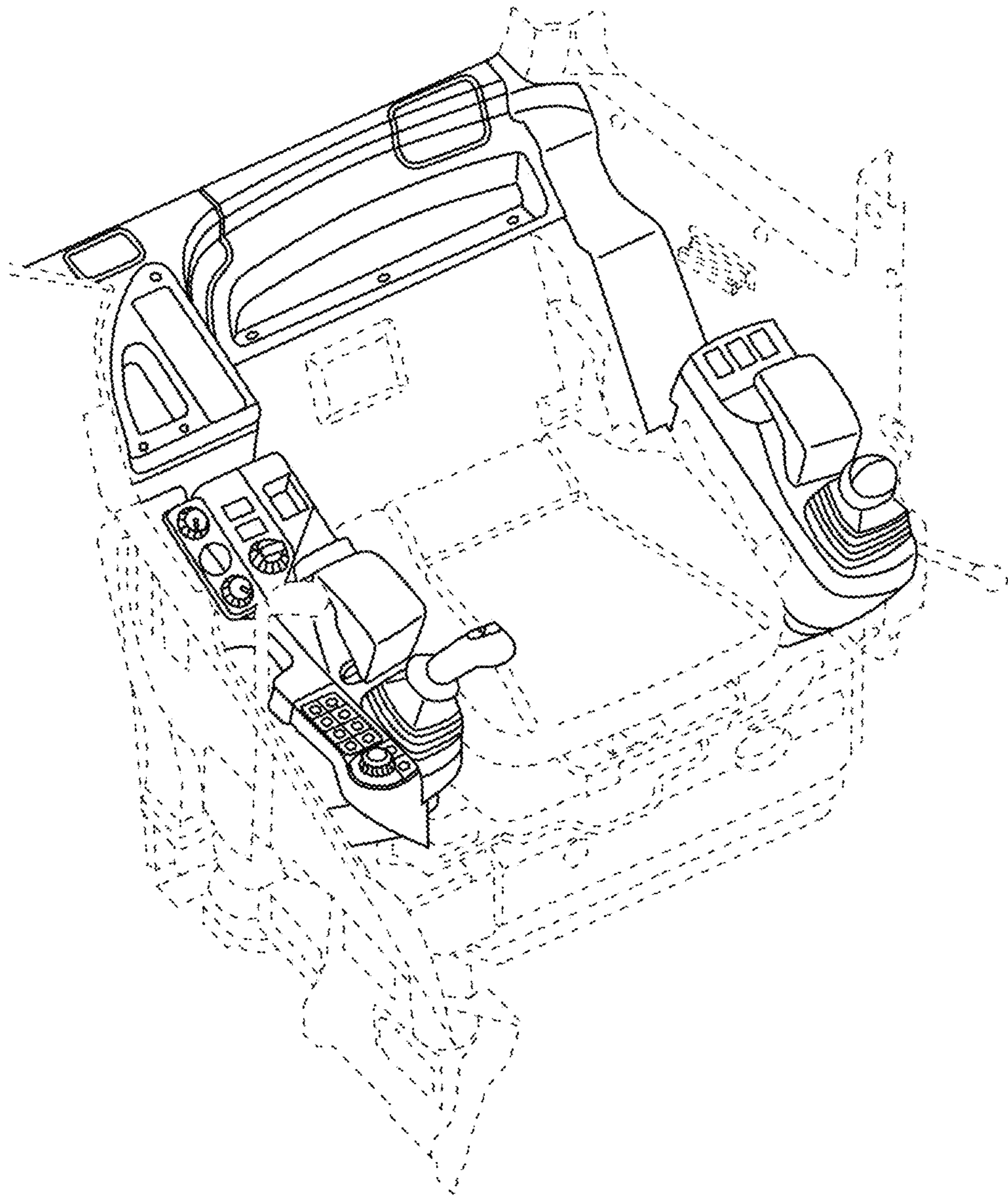

1.9

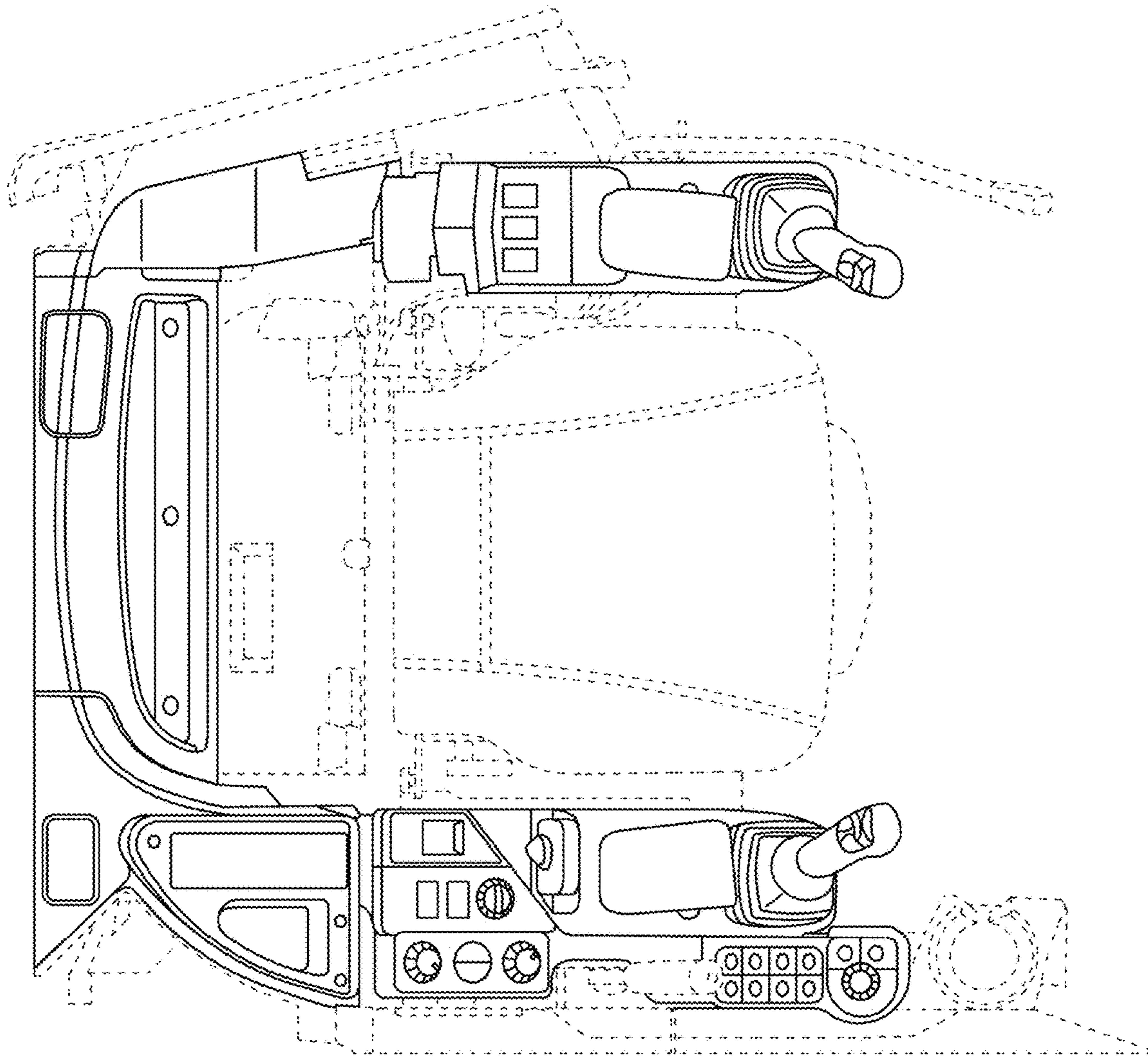

1.10

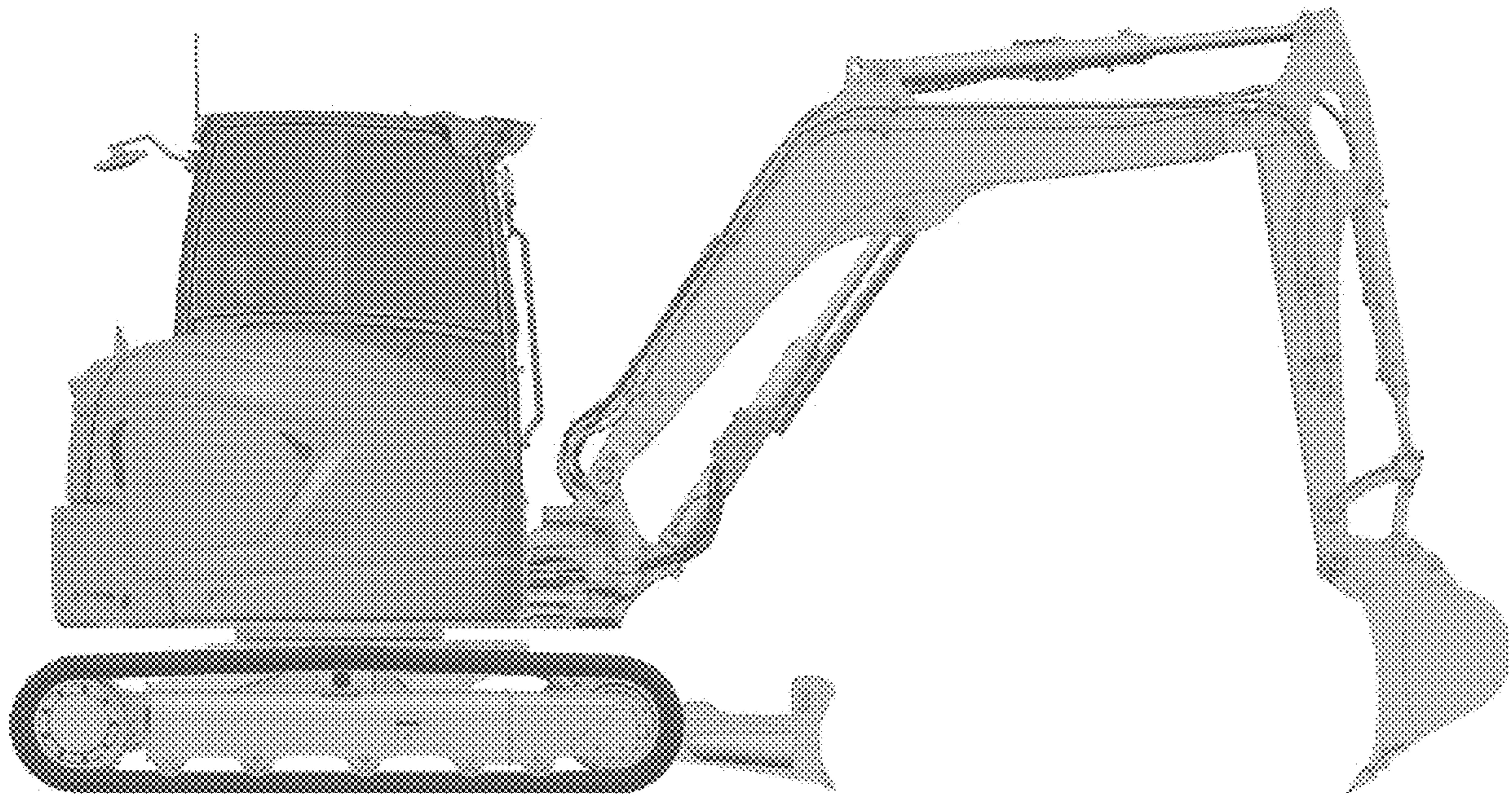

1.11

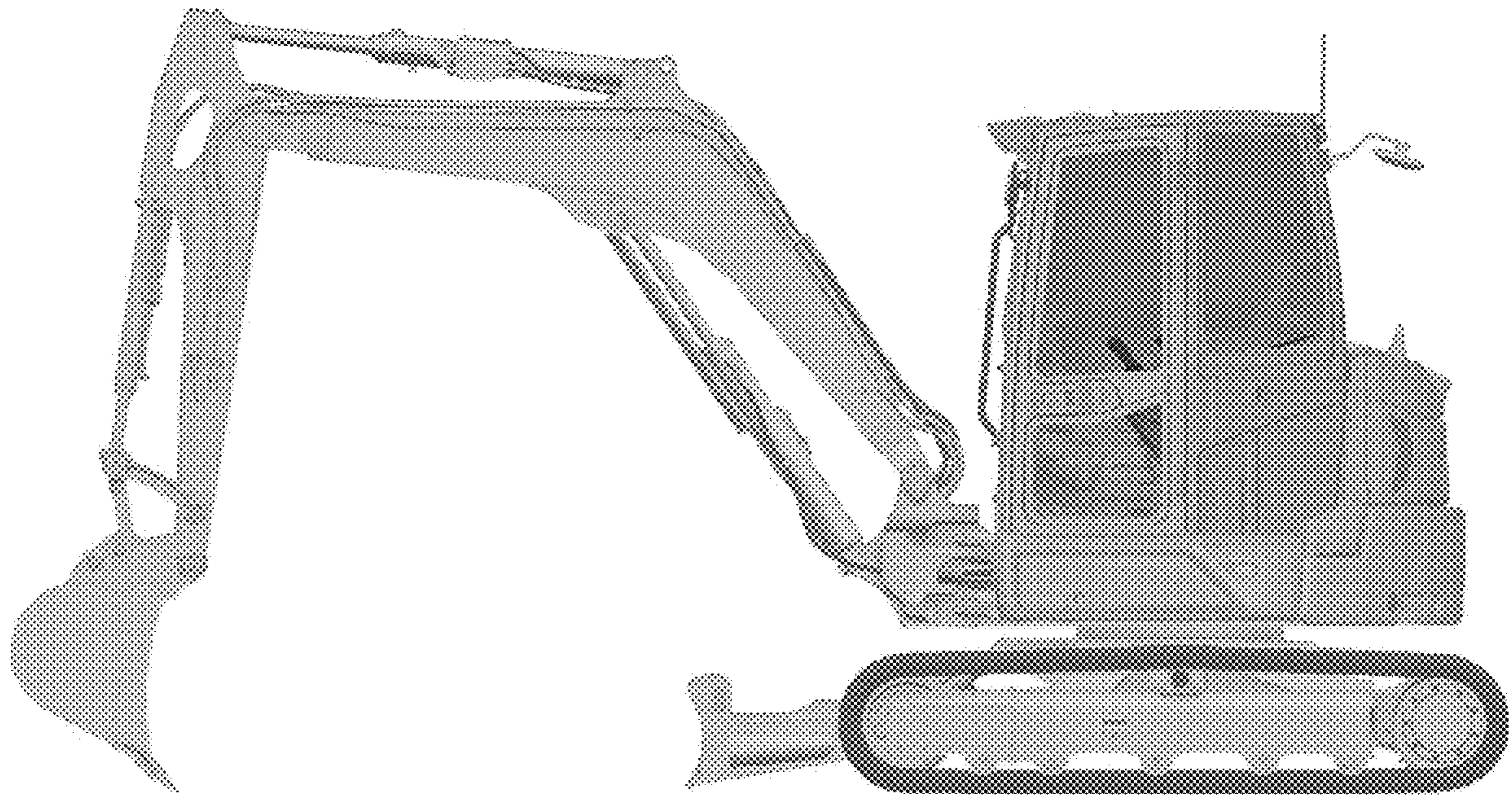

1.12

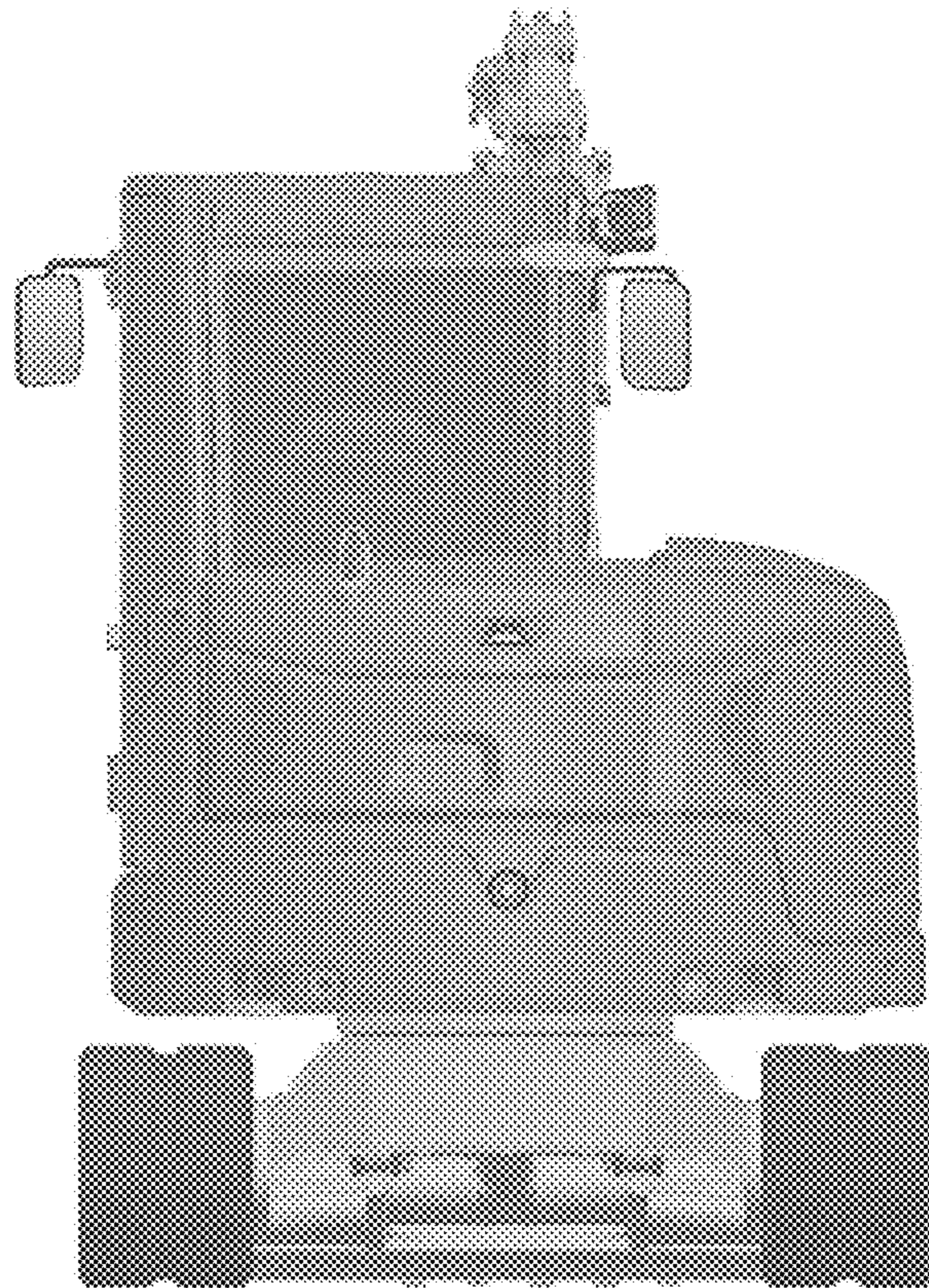

1.13

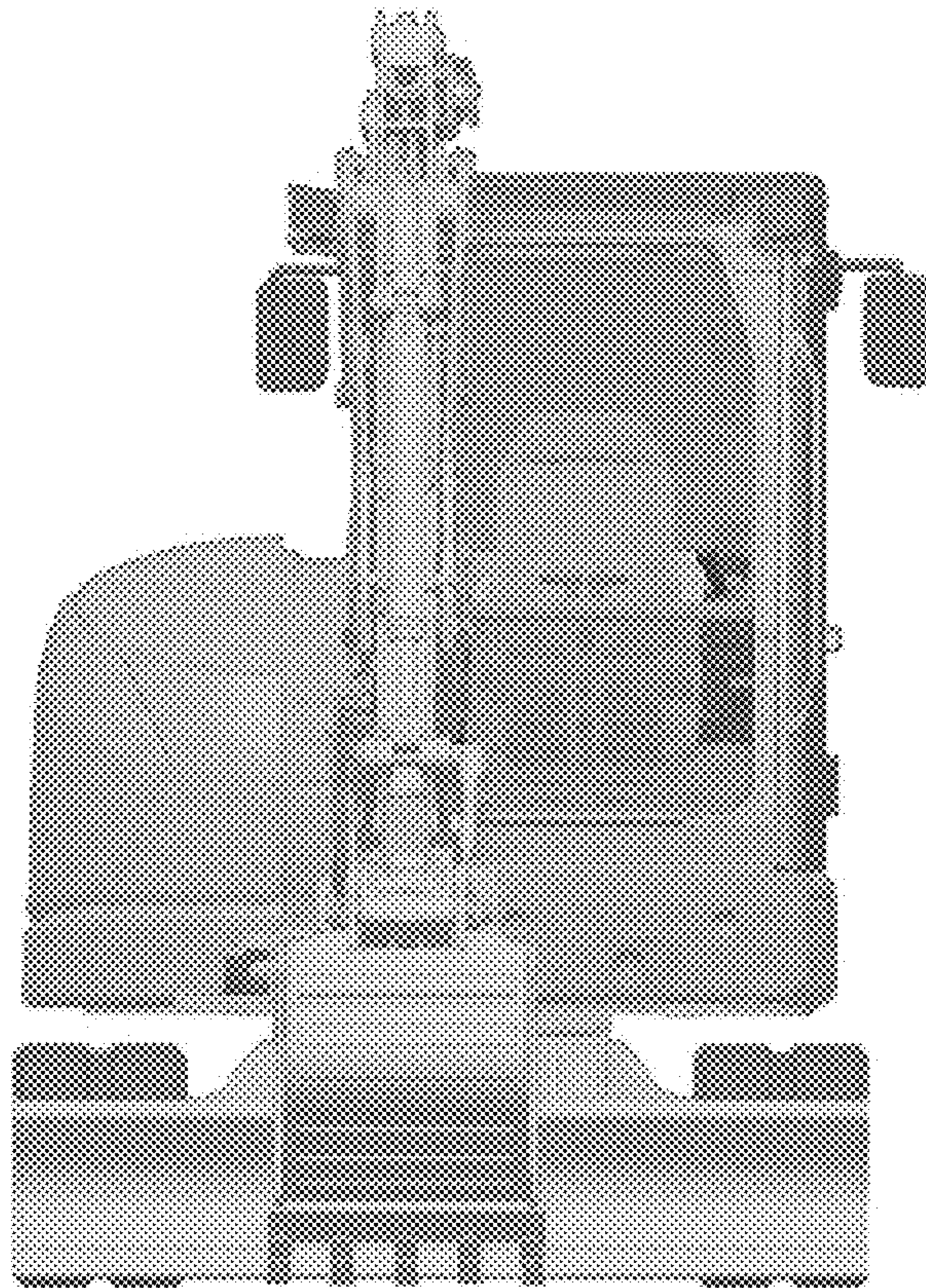

1.14

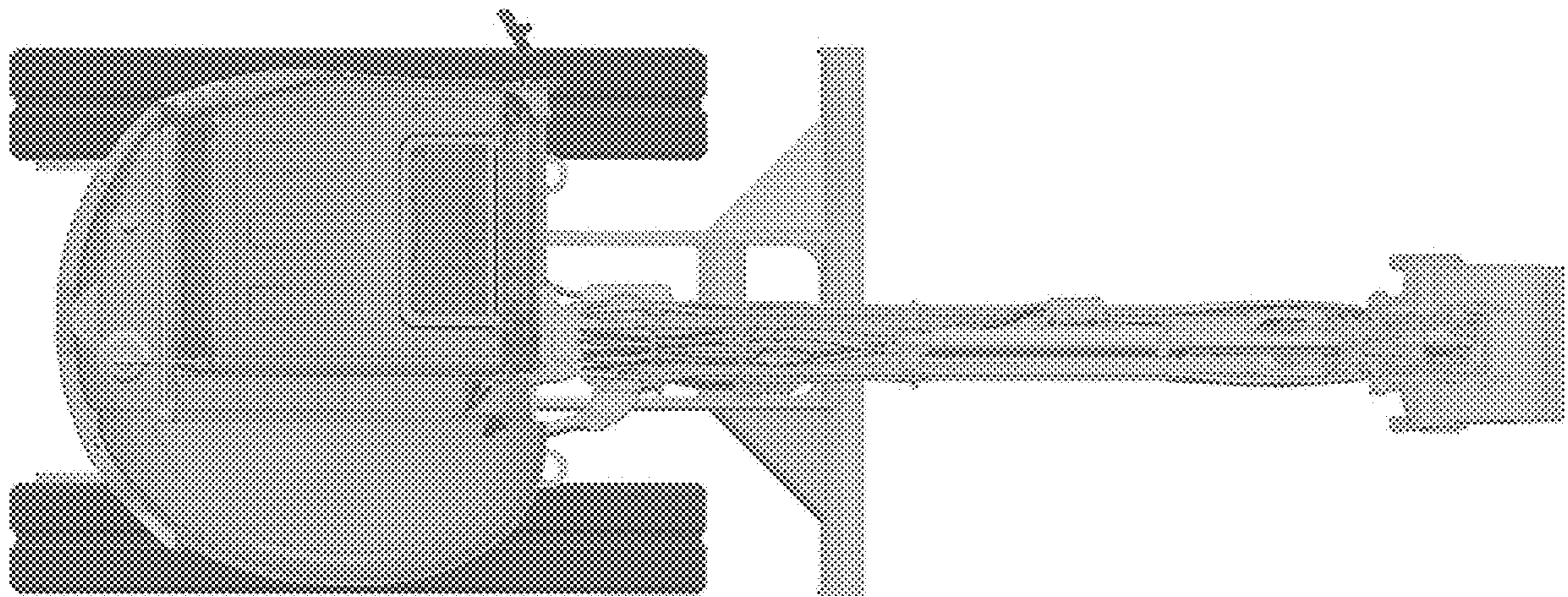

1.15

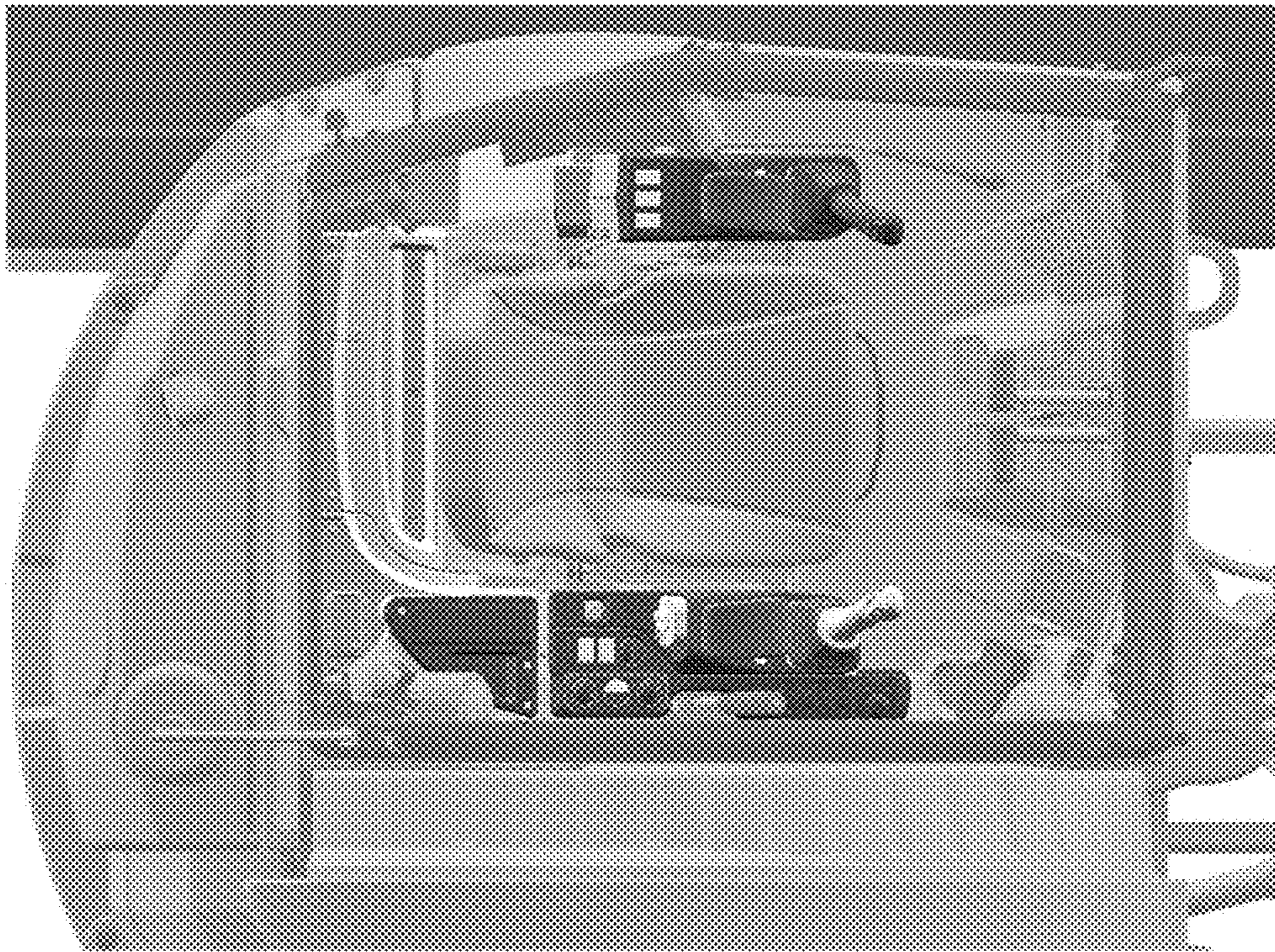

1.16

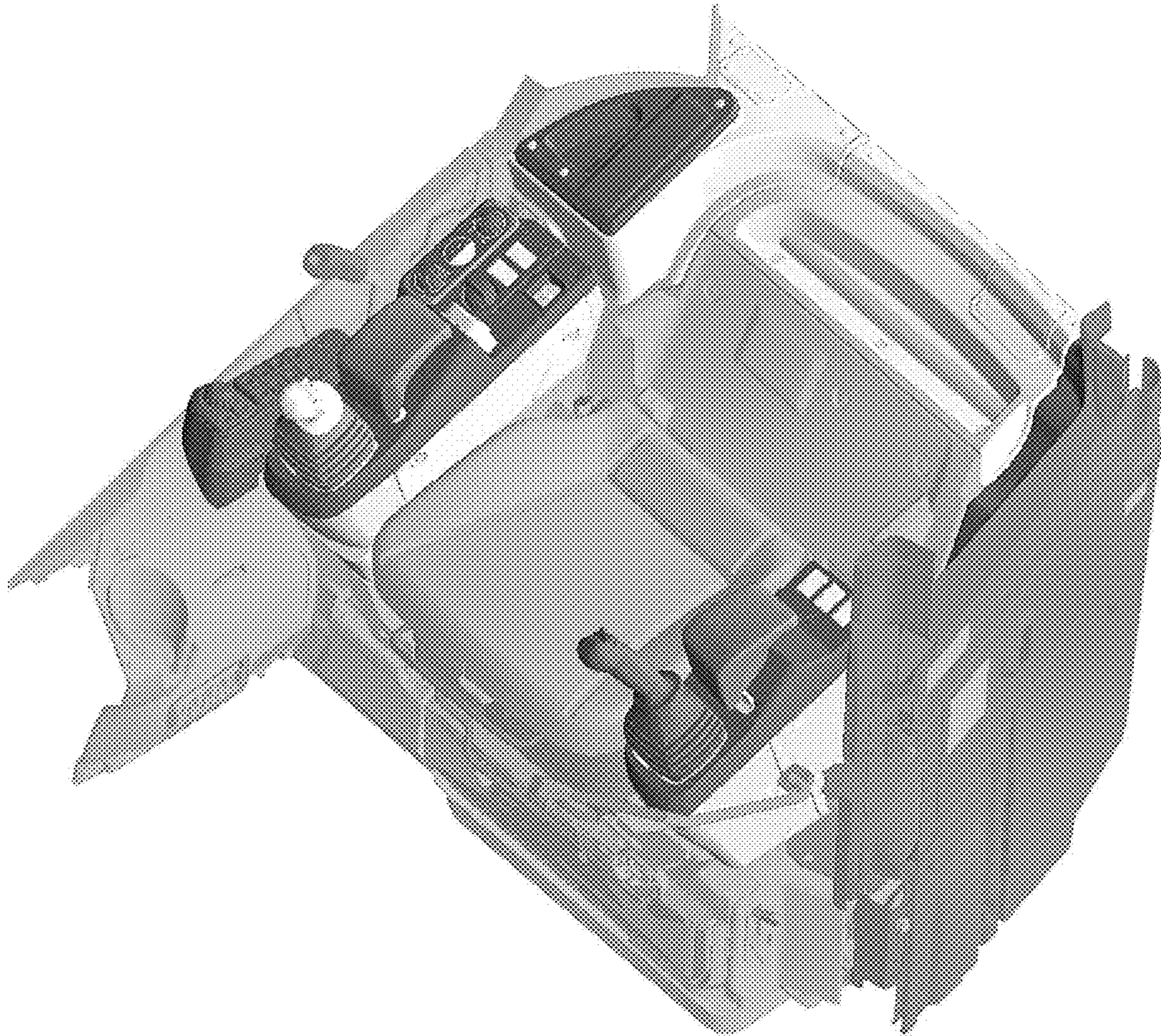

1.17

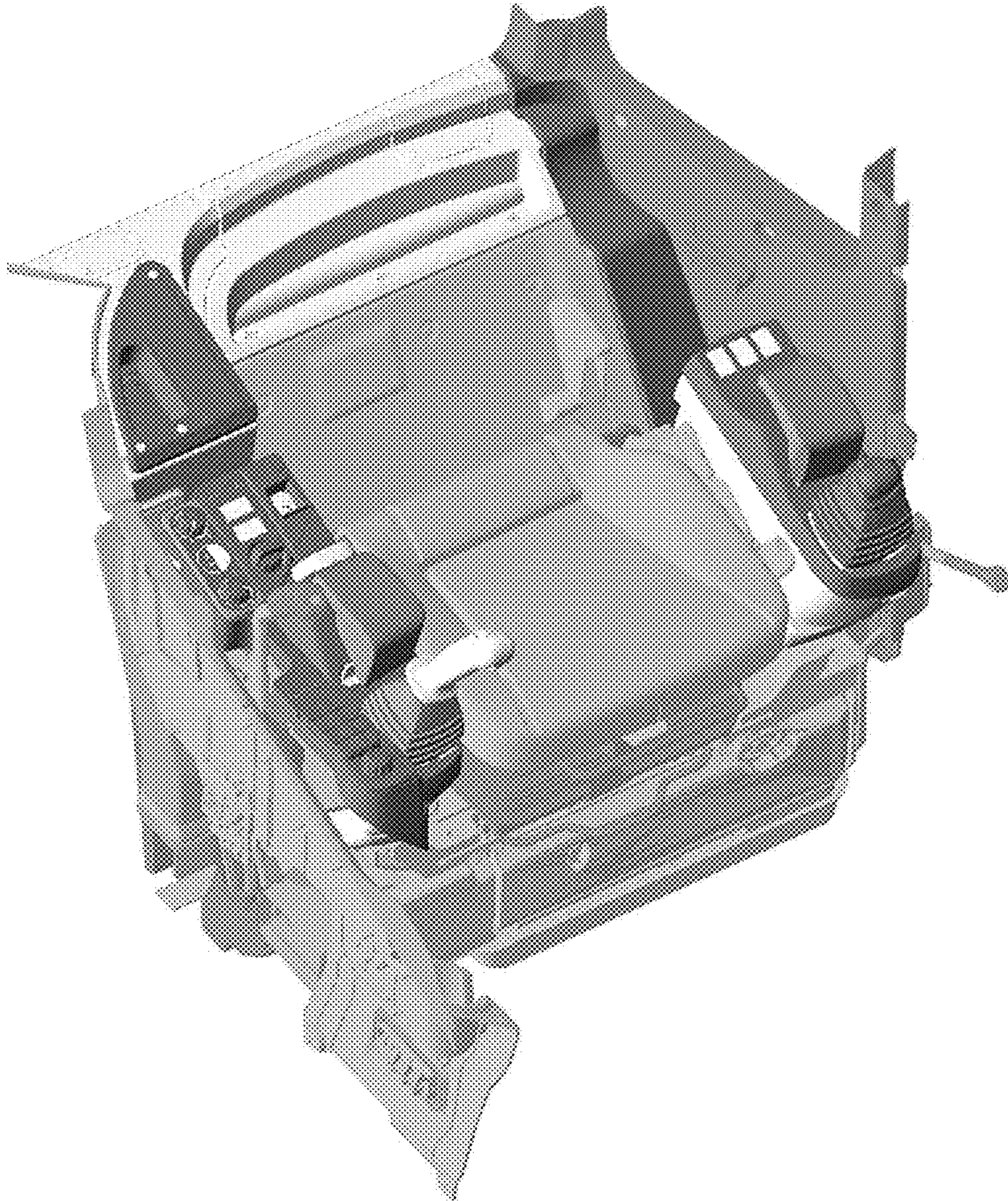

1.18

