



US00D931917S

(12) **United States Design Patent**  
**Lin**

(10) **Patent No.:** **US D931,917 S**

(45) **Date of Patent:** **\*\* Sep. 28, 2021**

- (54) **DRILL**
- (71) Applicant: **Danfeng Lin**, Jiangsu (CN)
- (72) Inventor: **Danfeng Lin**, Jiangsu (CN)
- (73) Assignee: **Danyang Linrui Tools Co., Ltd.**,  
Jiangsu (CN)
- (\*\*) Term: **15 Years**
- (21) Appl. No.: **29/731,851**
- (22) Filed: **Apr. 18, 2020**
- (51) **LOC (13) Cl.** ..... **15-09**
- (52) **U.S. Cl.**  
USPC ..... **D15/139**
- (58) **Field of Classification Search**  
USPC .... D8/20, 70, 85, 86, 98, 99; D15/122, 127,  
D15/131-133, 139  
CPC ..... B23B 2251/18; B23B 2251/241; B23B  
2251/404; Y10T 408/04; Y10T 408/78;  
Y10T 408/89; Y10T 408/909; Y10T  
408/9095; Y10T 408/9097  
See application file for complete search history.

3,997,279	A	*	12/1976	Porter	.....	B27G 15/00	408/211
D372,485	S	*	8/1996	Stone	.....	D15/139	
D376,809	S	*	12/1996	Stone	.....	D15/139	
D394,663	S	*	5/1998	Stone	.....	D15/139	
D455,446	S	*	4/2002	Collins	.....	D15/139	
D507,585	S	*	7/2005	Held	.....	D15/139	
D604,751	S	*	11/2009	Dost	.....	D15/139	
D608,801	S	*	1/2010	Evatt	.....	D15/139	
D627,805	S	*	11/2010	Dost	.....	D15/139	
D863,384	S	*	10/2019	Weber	.....	D15/139	
D890,826	S	*	7/2020	Howell	.....	D15/139	
D917,589	S	*	4/2021	Lin	.....	D15/139	

\* cited by examiner

*Primary Examiner* — Michael C Stout  
*Assistant Examiner* — Fritzgerald L Butac

(57) **CLAIM**

The ornamental design for a drill, as shown and described.

**DESCRIPTION**

FIG. 1 is a perspective view of a drill showing my new design;  
FIG. 2 is a front elevation view thereof;  
FIG. 3 is a rear elevation view thereof;  
FIG. 4 is a left side elevation view thereof;  
FIG. 5 is a right side elevation view thereof;  
FIG. 6 is a top plan view thereof; and,  
FIG. 7 is a bottom plan view thereof.

**1 Claim, 7 Drawing Sheets**

(56) **References Cited**

**U.S. PATENT DOCUMENTS**

3,748,052	A	*	7/1973	Jensen	.....	B23B 51/00	408/188
D240,263	S	*	6/1976	Southall	.....	D15/139	

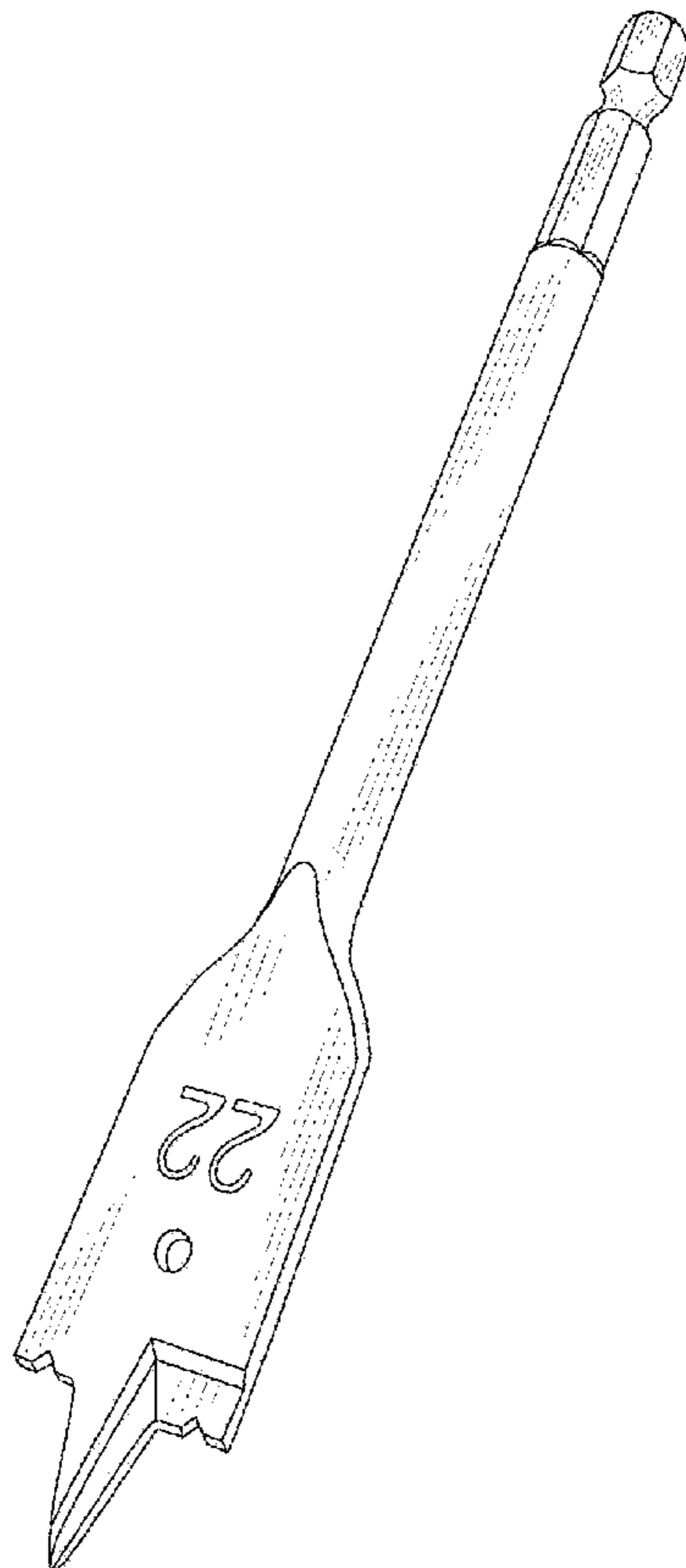

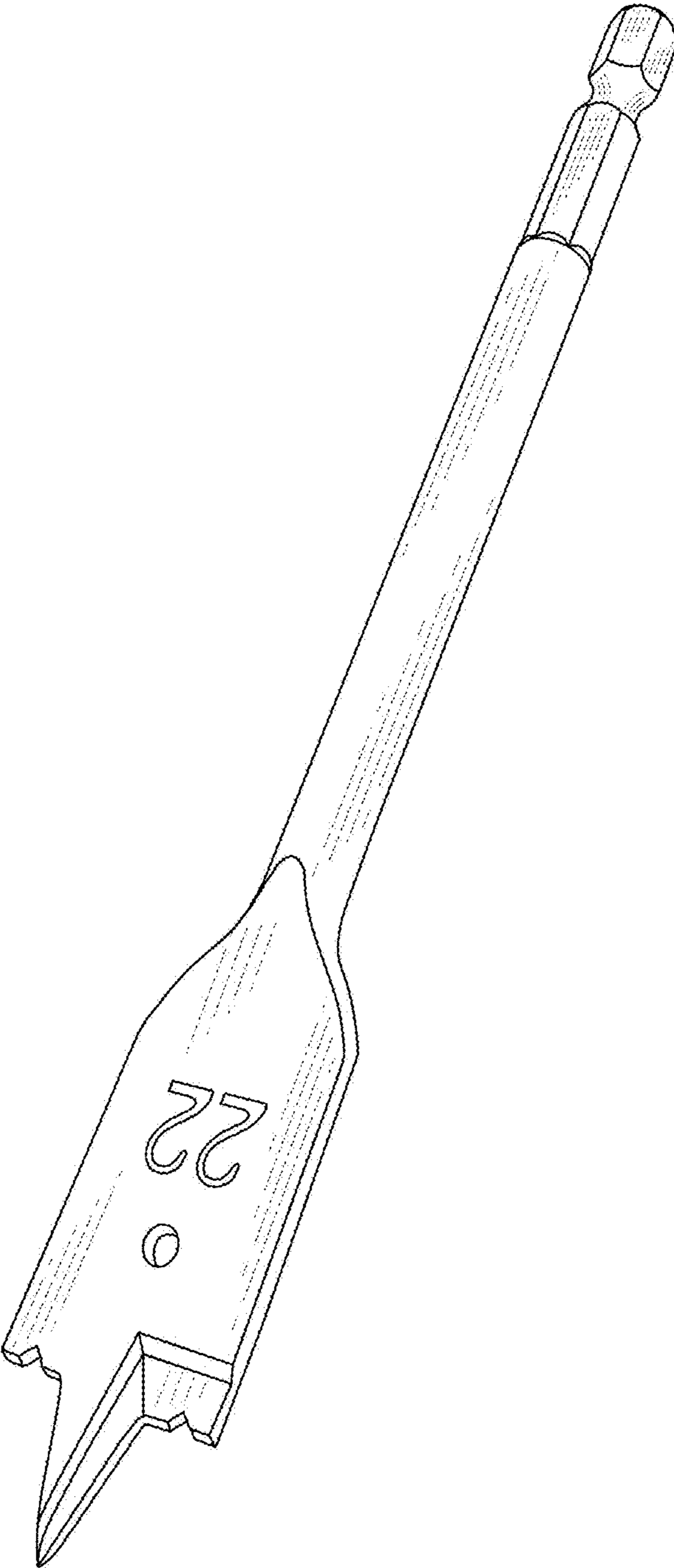

FIG.1

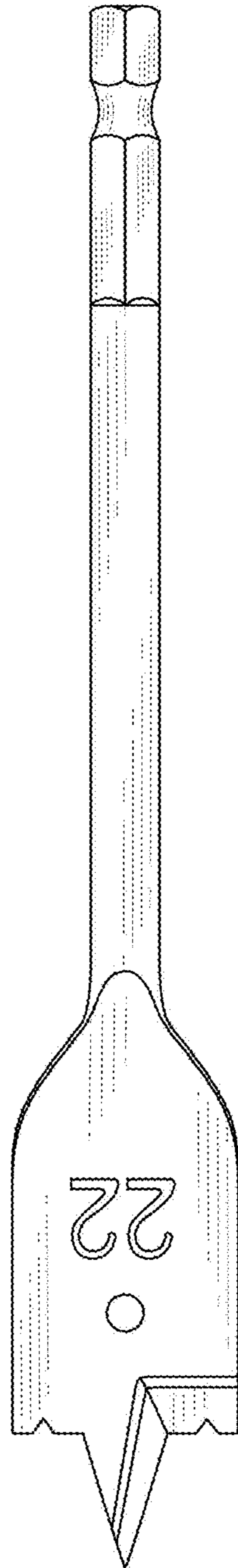

FIG.2

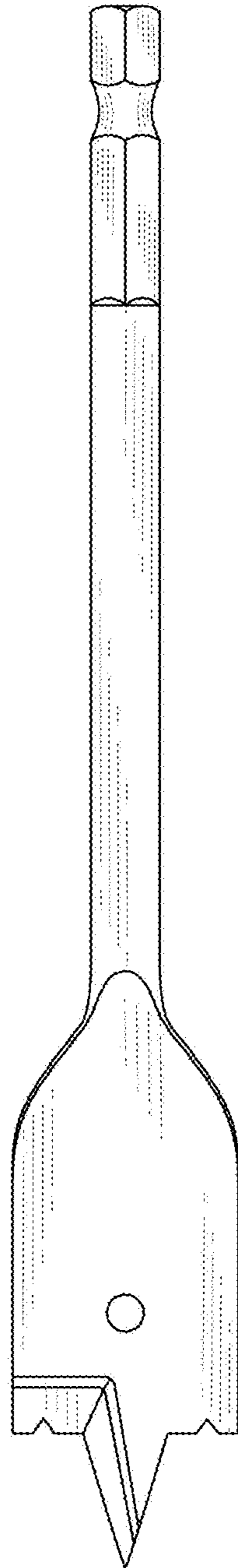

FIG.3

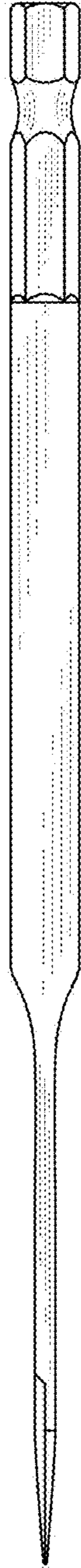

FIG.4

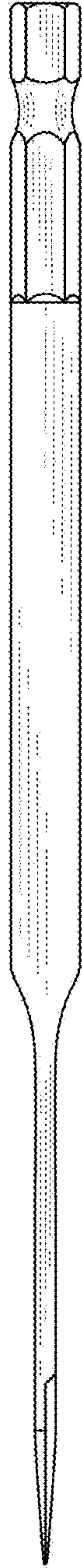

FIG.5

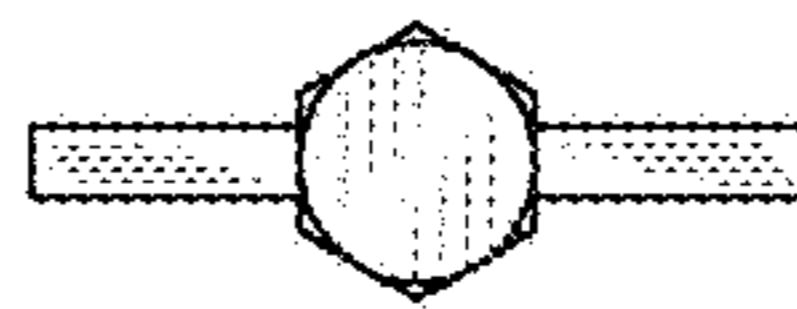

FIG.6

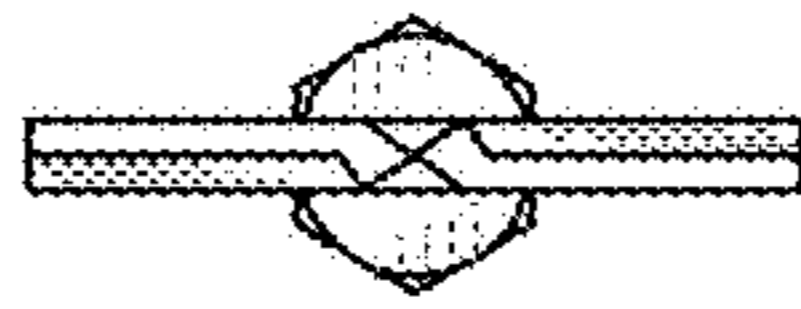

FIG. 7