



US00D931904S

(12) **United States Design Patent**  
**Wang et al.**

(10) **Patent No.:** **US D931,904 S**  
(45) **Date of Patent:** **\*\* Sep. 28, 2021**

- (54) **LEAF SHATTERING MACHINE**
- (71) Applicant: **INTRADIN (HUZHOU) PRECISION TECHNOLOGY CO., LTD.**, Huzhou (CN)
- (72) Inventors: **Junliang Wang**, Huzhou (CN); **Xin Zhang**, Huzhou (CN)
- (73) Assignee: **INTRADIN (HUZHOU) PRECISION TECHNOLOGY CO., LTD.**, Huzhou (CN)

5,018,672 A *	5/1991	Peck	.....	A01G 3/002
				241/101.78
D323,512 S *	1/1992	D'Aleo	.....	D15/10
D328,603 S *	8/1992	Piltz	.....	D15/10
5,199,653 A *	4/1993	Durrant	.....	B02C 18/2291
				241/101.78
D345,983 S *	4/1994	Bold	.....	D15/10
5,390,865 A *	2/1995	Vandermolen	.....	B02C 13/04
				241/101.76
D356,801 S *	3/1995	Bold	.....	D15/10
D357,259 S *	4/1995	Bold	.....	D15/10
5,402,950 A *	4/1995	Blair	.....	B02C 19/22
				241/101.76
D358,399 S *	5/1995	Tiedeman	.....	D15/10
D757,829 S *	5/2016	Dallimore	.....	D15/123
D781,925 S *	3/2017	Kanchibhotla	.....	D15/10

(\*\*) Term: **15 Years**

(21) Appl. No.: **29/737,727**

(22) Filed: **Jun. 11, 2020**

(51) **LOC (13) Cl.** ..... **15-03**

(52) **U.S. Cl.**  
USPC ..... **D15/10**

(58) **Field of Classification Search**  
USPC ..... D15/10-33; 241/188  
CPC ..... A01G 3/002; A01G 3/00; A01G 2003/005  
See application file for complete search history.

(56) **References Cited**

**U.S. PATENT DOCUMENTS**

3,412,770 A *	11/1968	Johnson	.....	A01G 3/00
				241/243
3,716,198 A *	2/1973	Lautzenheiser	.....	A01G 3/002
				241/188.1
D233,364 S *	10/1974	Chambers, Sr.	.....	D15/10
3,861,603 A *	1/1975	Lautzenheiser	.....	A01G 3/002
				241/100
4,283,018 A *	8/1981	Richard	.....	A01D 42/005
				241/101.1

\* cited by examiner

*Primary Examiner* — Mark A Goodwin

(57) **CLAIM**

The ornamental design for a leaf shattering machine, as shown and described.

**DESCRIPTION**

FIG. 1 is a perspective view of a leaf shattering machine showing my new design;  
FIG. 2 is another perspective view thereof;  
FIG. 3 is a front elevation view thereof;  
FIG. 4 is a back elevation view thereof;  
FIG. 5 is a left side view thereof;  
FIG. 6 is a right side view thereof;  
FIG. 7 is a top plan view thereof; and,  
FIG. 8 is a bottom plan view thereof.

The broken lines in the drawings illustrate portions of the leaf shattering machine and form no part of the claimed design.

**1 Claim, 8 Drawing Sheets**

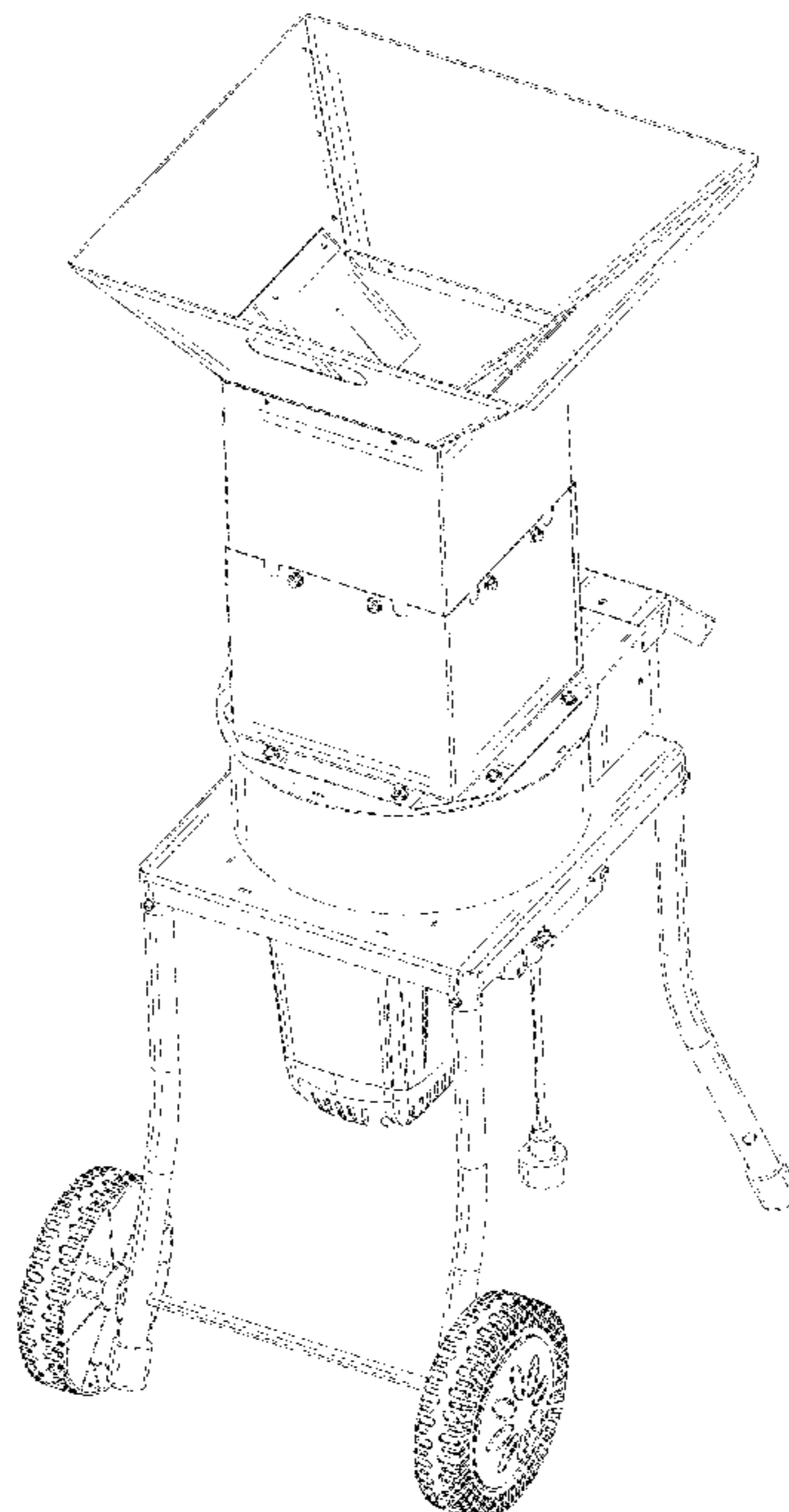

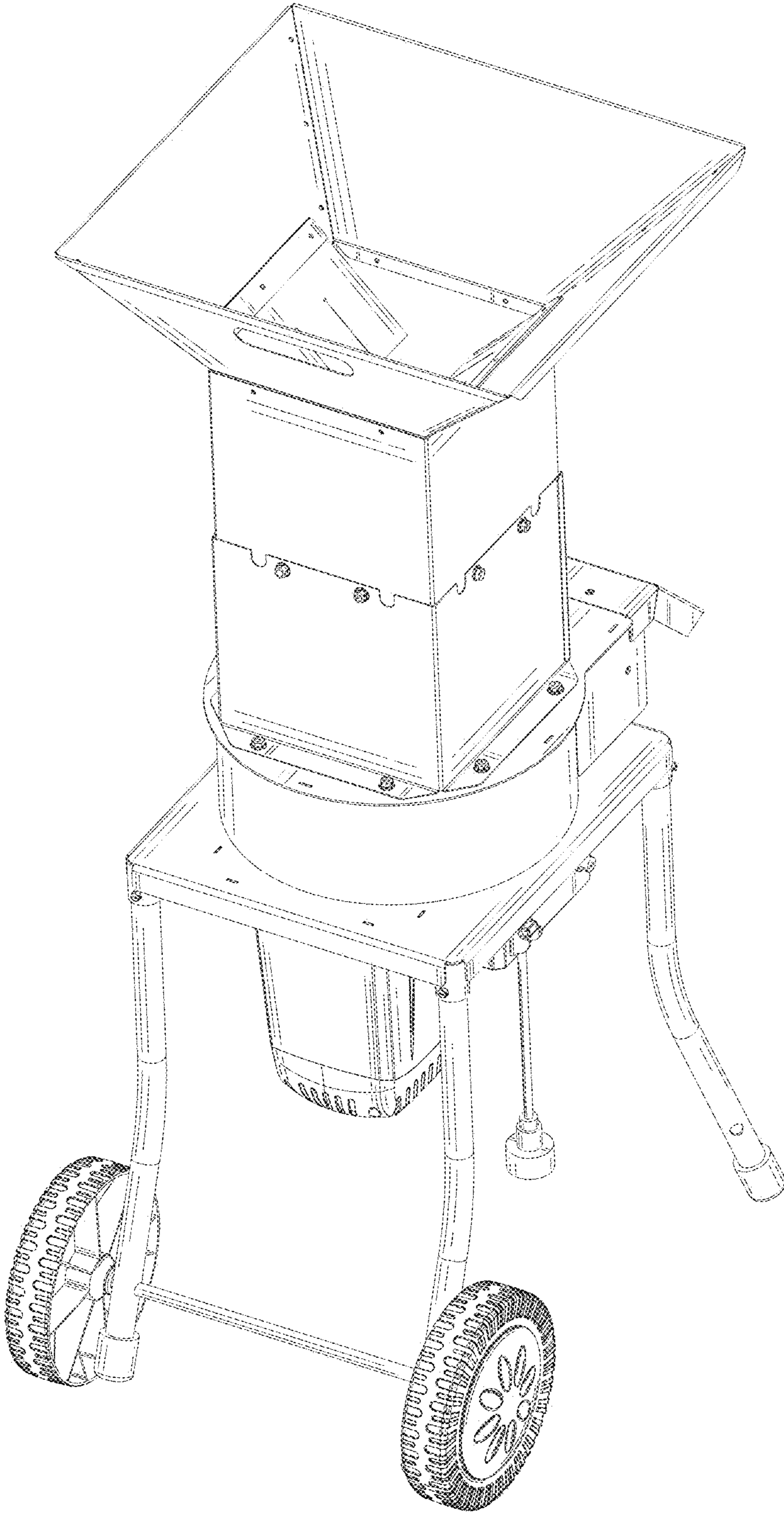

FIG. 1

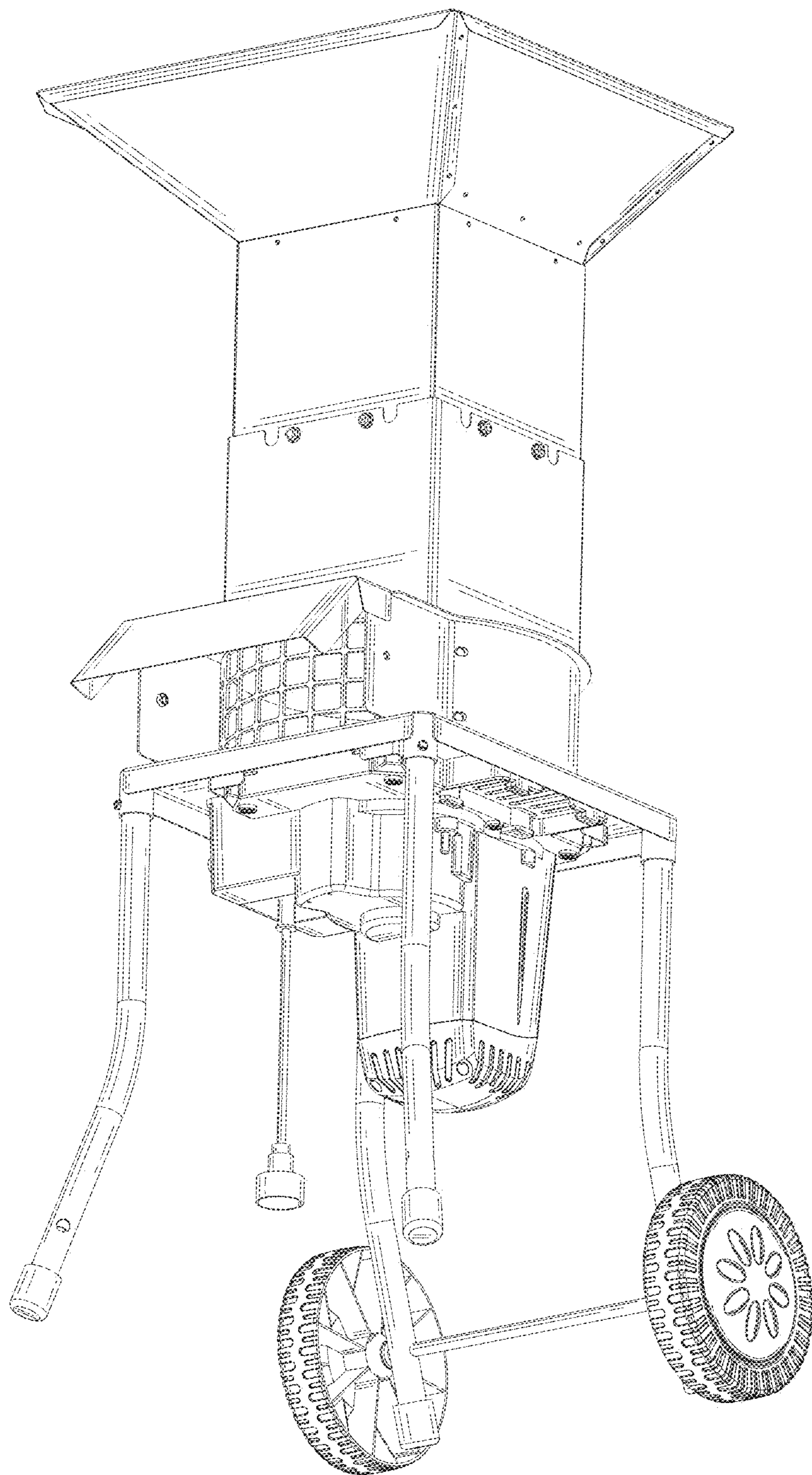

FIG. 2



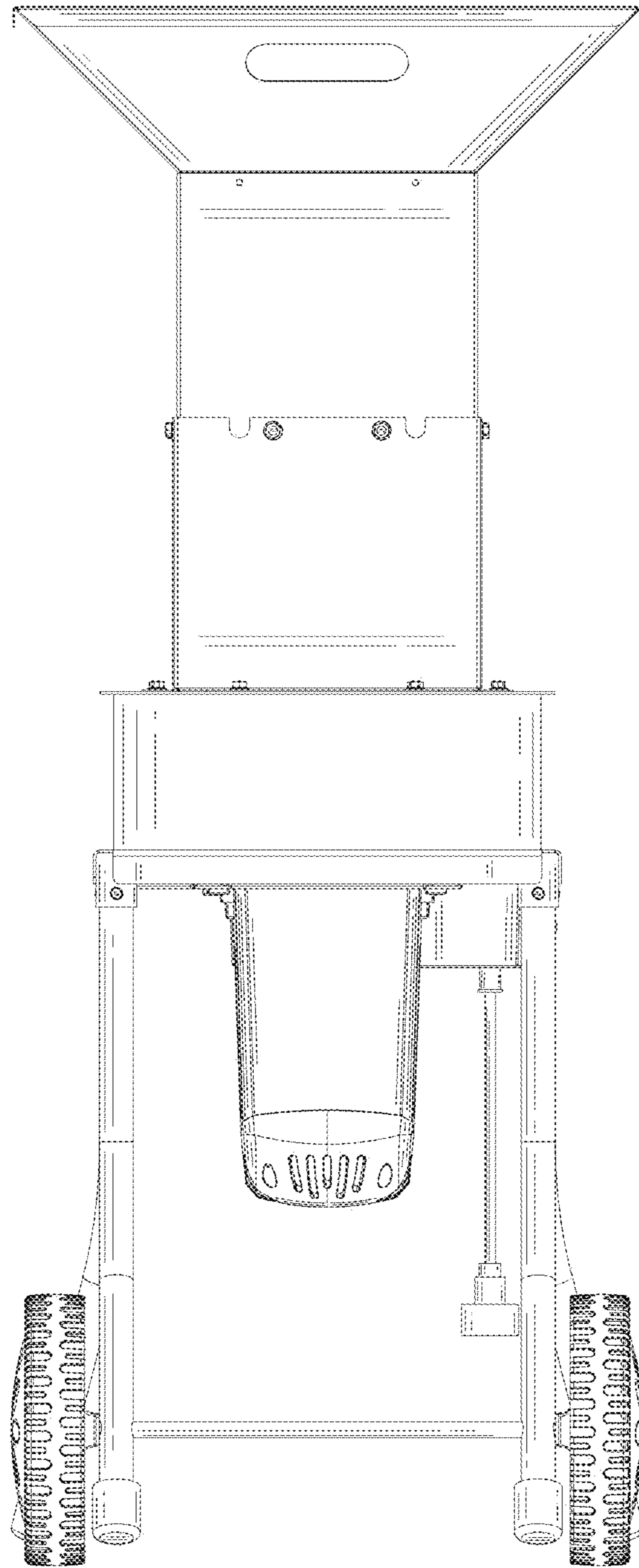

FIG. 3

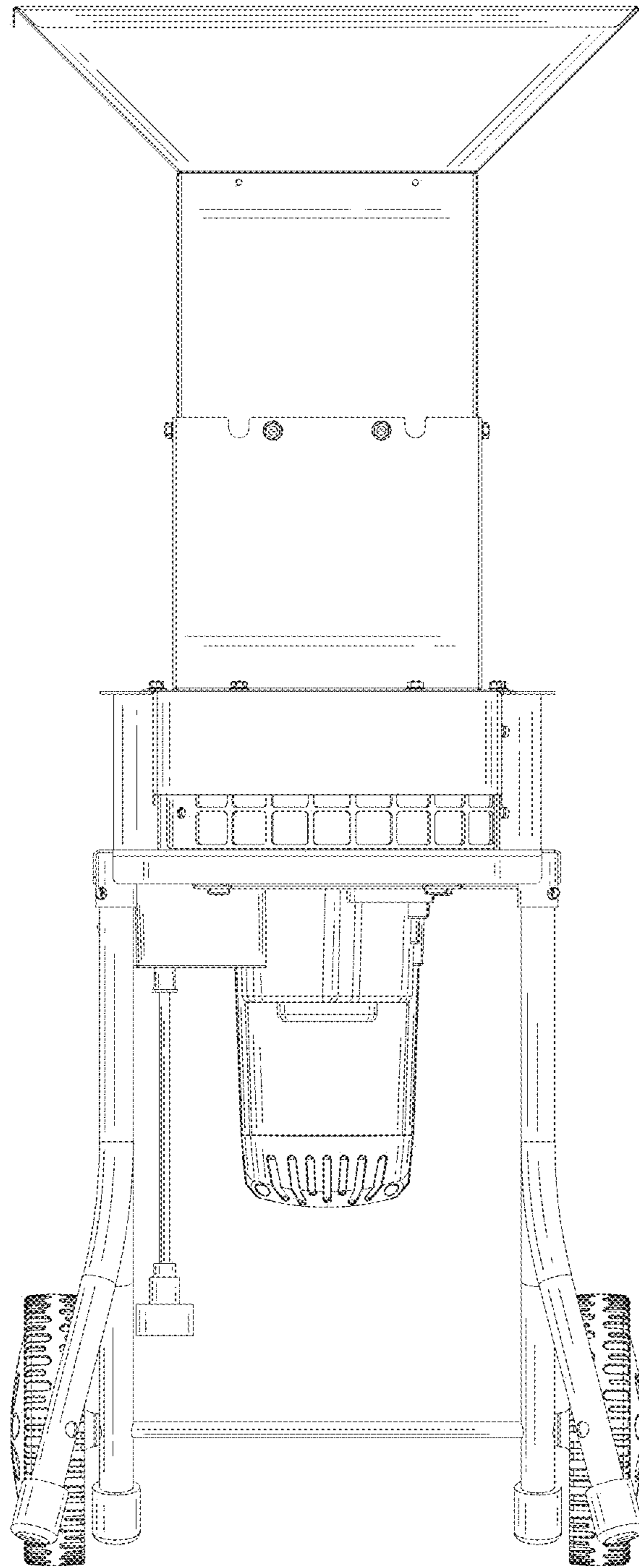

FIG. 4

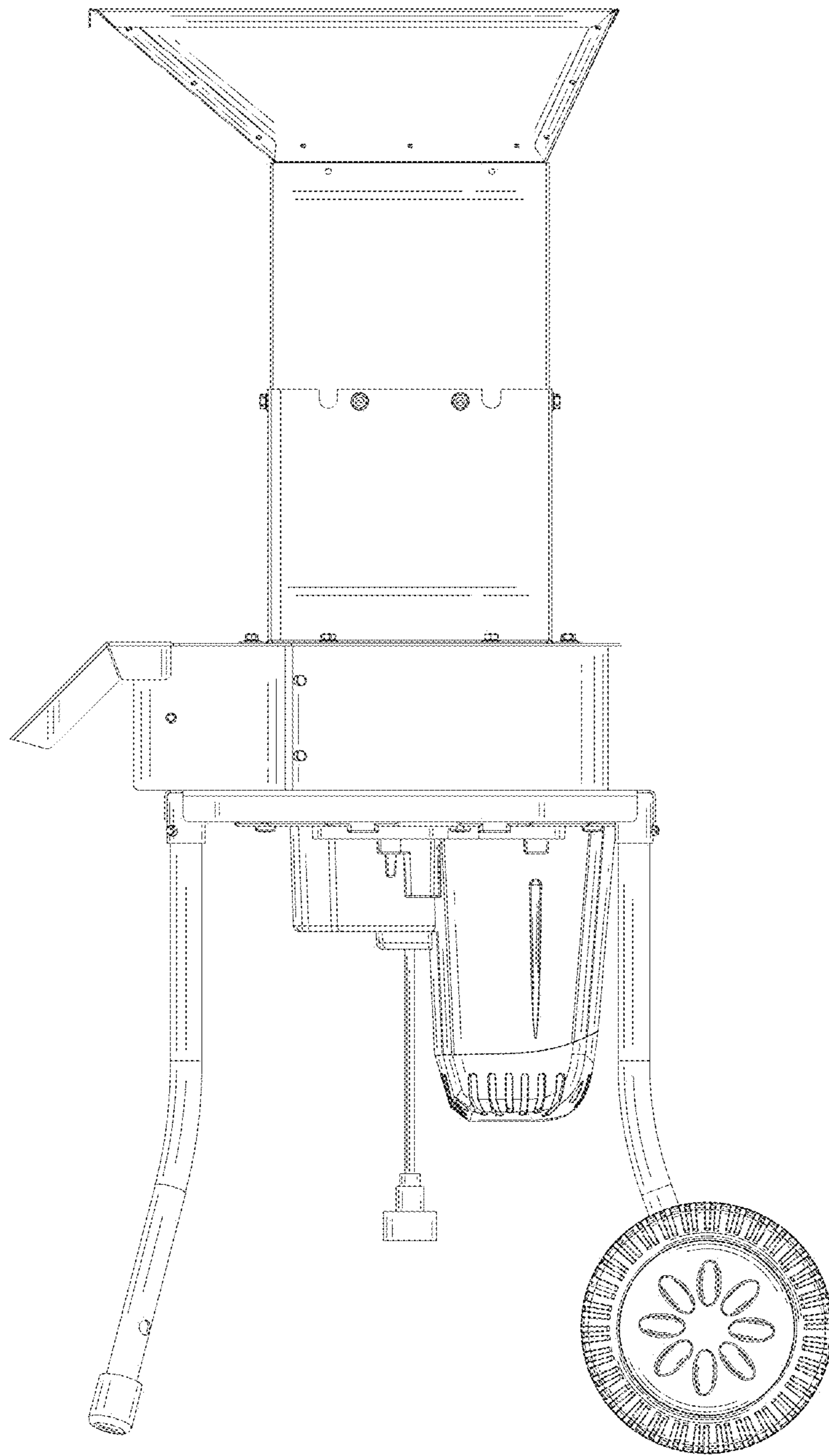

FIG. 5

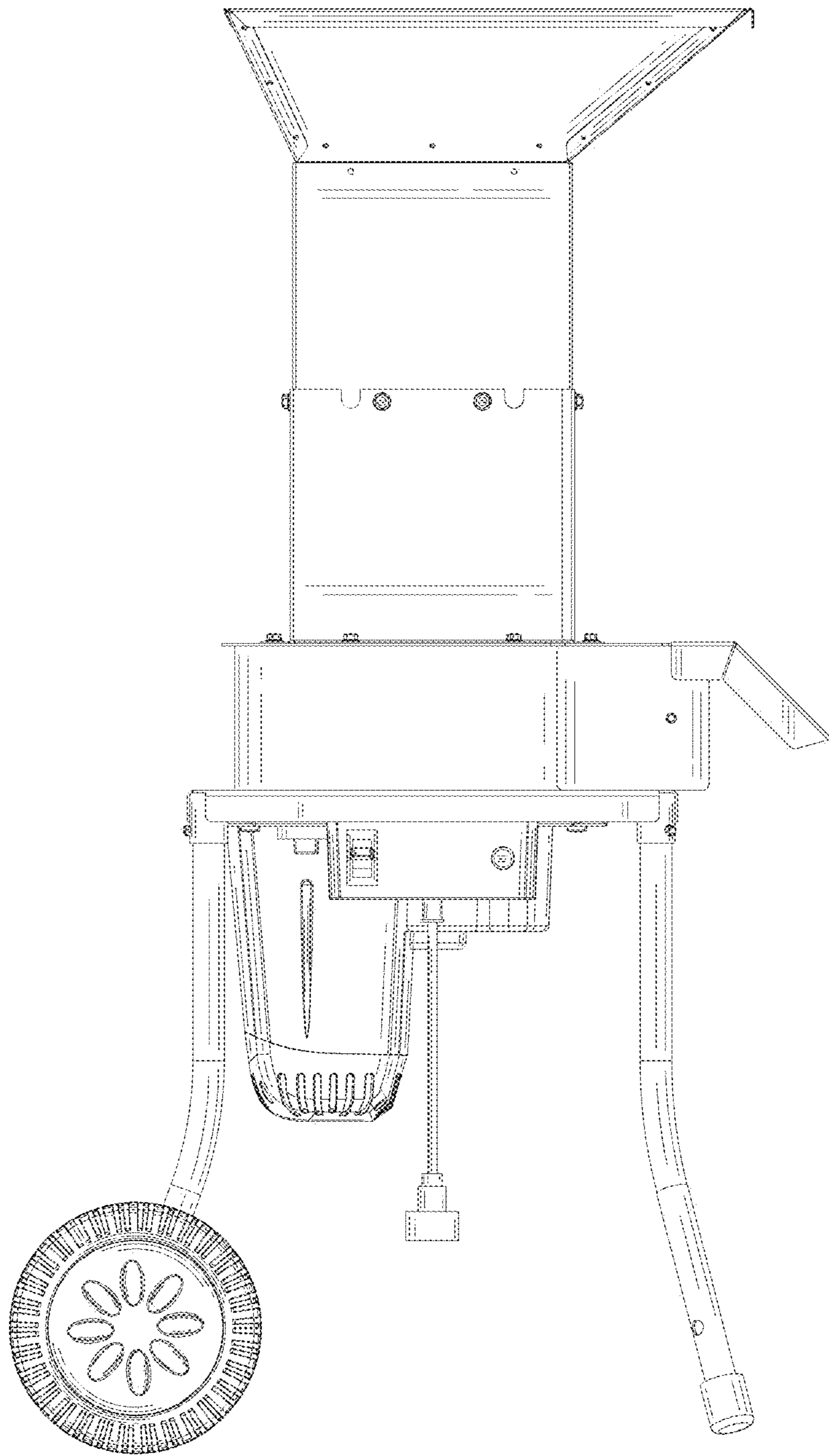

FIG. 6

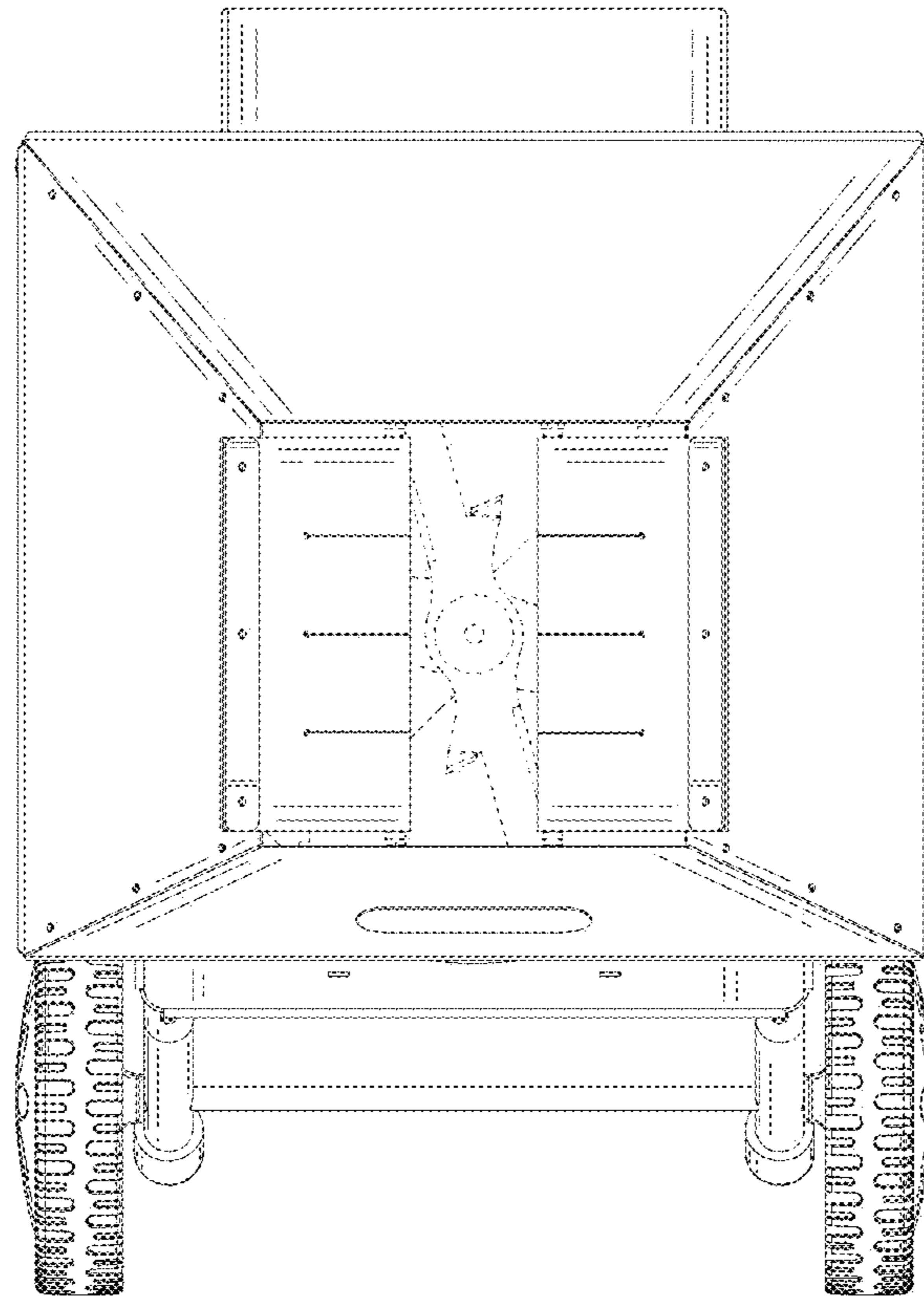

FIG. 7



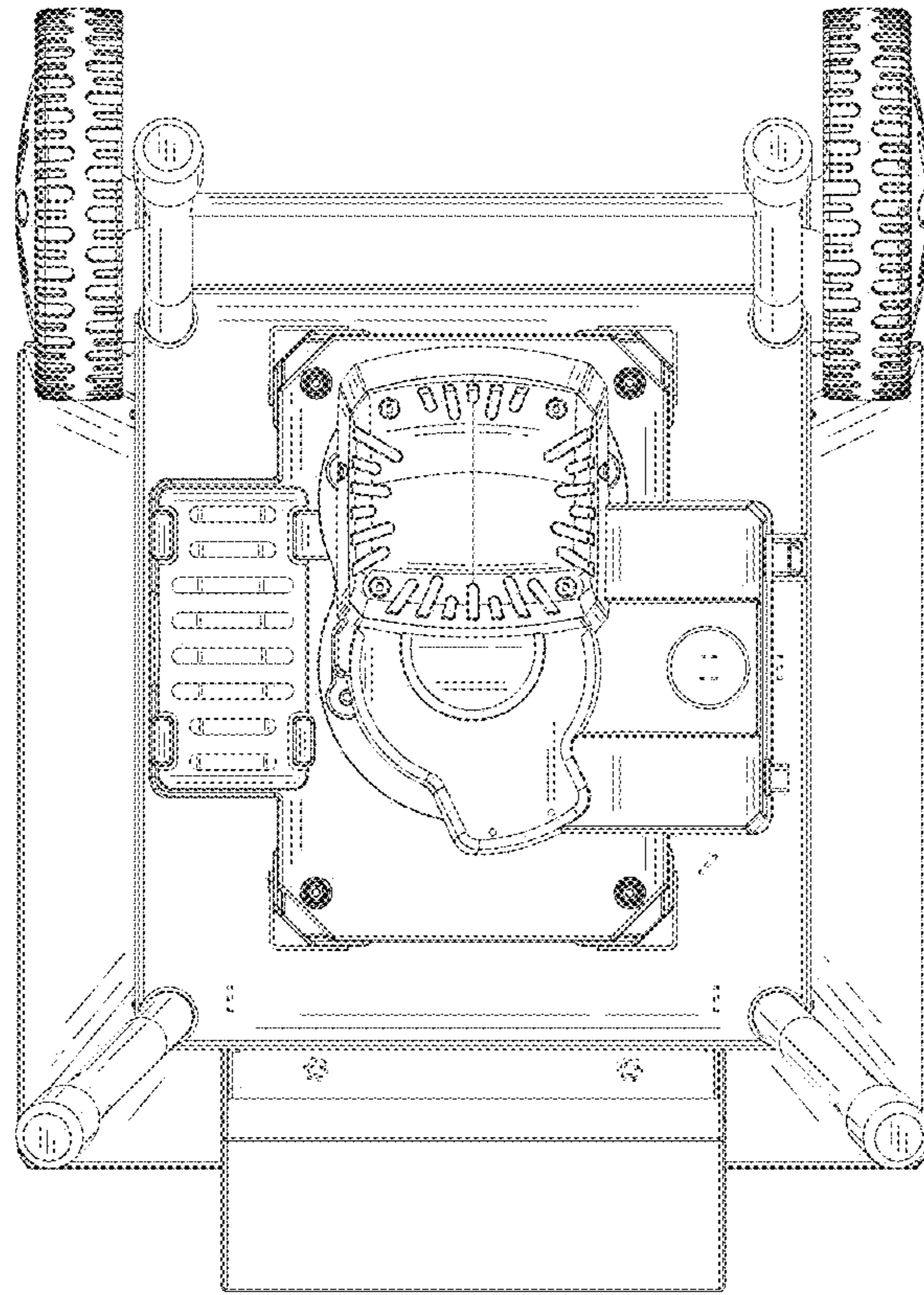

FIG. 8