



US00D931643S

(12) **United States Design Patent** (10) **Patent No.:** **US D931,643 S**  
**Li** (45) **Date of Patent:** **\*\* Sep. 28, 2021**

(54) **SHELF**  
(71) Applicant: **39F USA INC**, Rancho Cucamonga, CA (US)  
(72) Inventor: **Yuehai Li**, Rancho Cucamonga, CA (US)

D892,521 S \* 8/2020 Lai ..... D6/675.3  
D893,924 S \* 8/2020 Lai ..... D6/675.1  
D898,485 S \* 10/2020 Pedersen ..... D6/675  
D903,385 S \* 12/2020 Young ..... D6/675.1  
D907,413 S \* 1/2021 Bogdan ..... D6/675.1  
D909,102 S \* 2/2021 Davis ..... D6/675.1  
D914,866 S \* 3/2021 Gao ..... D23/410  
2005/0103734 A1 \* 5/2005 Saltzberg ..... A47B 96/1441  
211/187

(\*\*) Term: **15 Years**

(21) Appl. No.: **29/727,037**

(22) Filed: **Mar. 8, 2020**

(51) **LOC (13) Cl.** ..... **06-01**

(52) **U.S. Cl.**  
USPC ..... **D6/375**

(58) **Field of Classification Search**  
USPC ..... D6/375, 675, 675.1, 675.3; D23/410  
CPC ..... A47B 47/024; A47B 57/06; A47B 57/50;  
A47B 96/00; A47B 96/1441  
See application file for complete search history.

(56) **References Cited**

**U.S. PATENT DOCUMENTS**

5,685,238 A \* 11/1997 Chambers ..... A47B 47/024  
108/158.12  
7,028,620 B1 \* 4/2006 Lyndon ..... A47B 87/0207  
108/153.1  
D665,198 S \* 8/2012 Levy ..... D6/675.1  
D825,233 S \* 8/2018 Yamamoto ..... D6/675.1  
D838,523 S \* 1/2019 Yamamoto ..... D6/675.1  
D867,039 S \* 11/2019 Ying ..... D6/675.1  
D878,116 S \* 3/2020 Davis ..... D6/675.1  
D882,993 S \* 5/2020 Li ..... D6/675.1  
D891,831 S \* 8/2020 Davis ..... D6/675.1

**OTHER PUBLICATIONS**

“Gray Faux Slate Geometric Bookcase” Oct. 29, 2017, wayfair.com, site visited Apr. 7, 2021 <<https://www.wayfair.com/furniture/pdp/foundstone-faux-slate-geometric-bookcase-w001083566.html>> (Year: 2017).\*

\* cited by examiner

*Primary Examiner* — Kevin K Rudzinski  
*Assistant Examiner* — Paul D Bohannon  
(74) *Attorney, Agent, or Firm* — Feng Qian

(57) **CLAIM**

The ornamental design for a shelf, as shown and described.

**DESCRIPTION**

FIG. 1 is a front perspective view of a shelf showing my new design;  
FIG. 2 is a front elevation view thereof;  
FIG. 3 is a rear elevation view thereof;  
FIG. 4 is a left-side elevation view thereof;  
FIG. 5 is a right-side elevation view thereof;  
FIG. 6 is a top plan view thereof; and,  
FIG. 7 is a bottom plan view thereof.

**1 Claim, 7 Drawing Sheets**

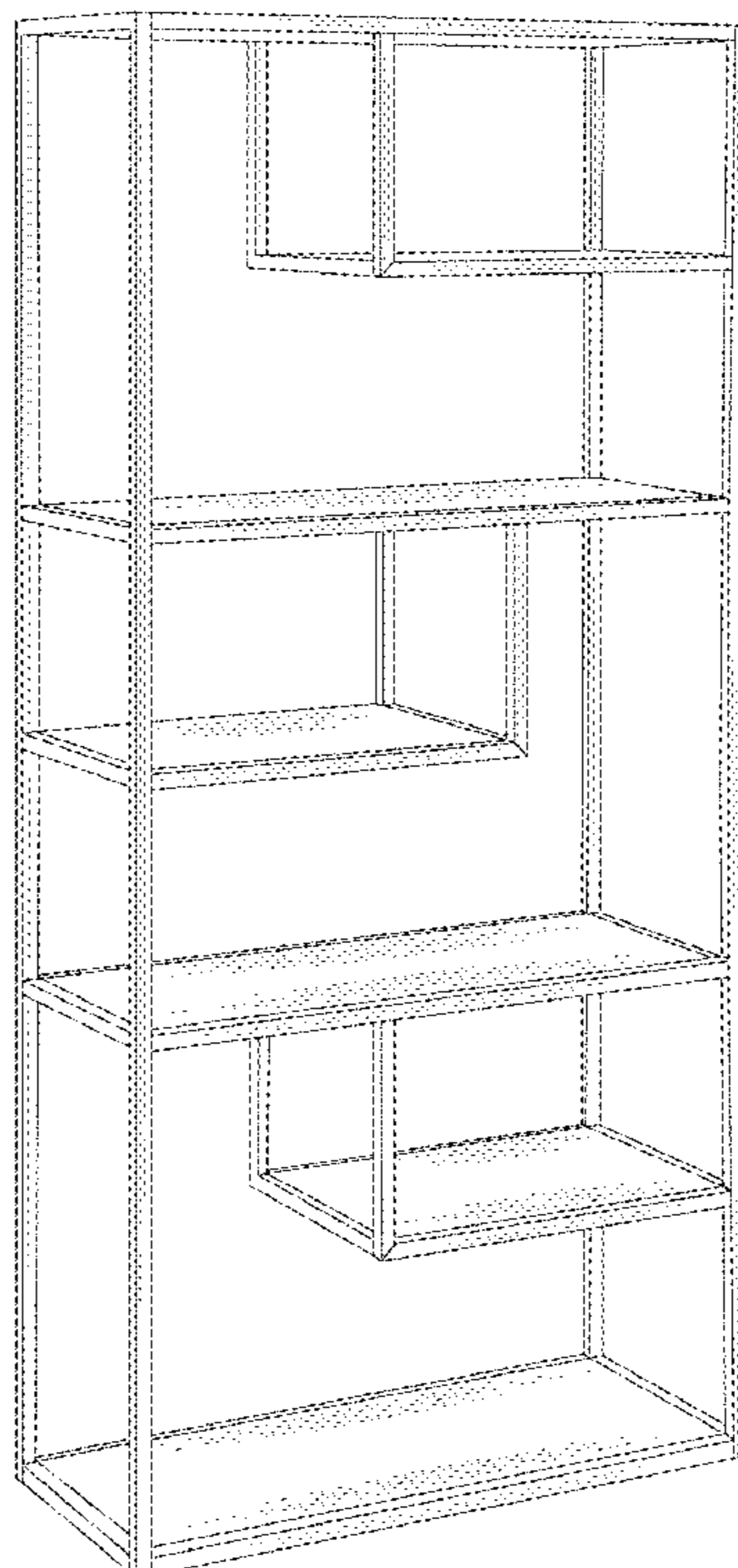

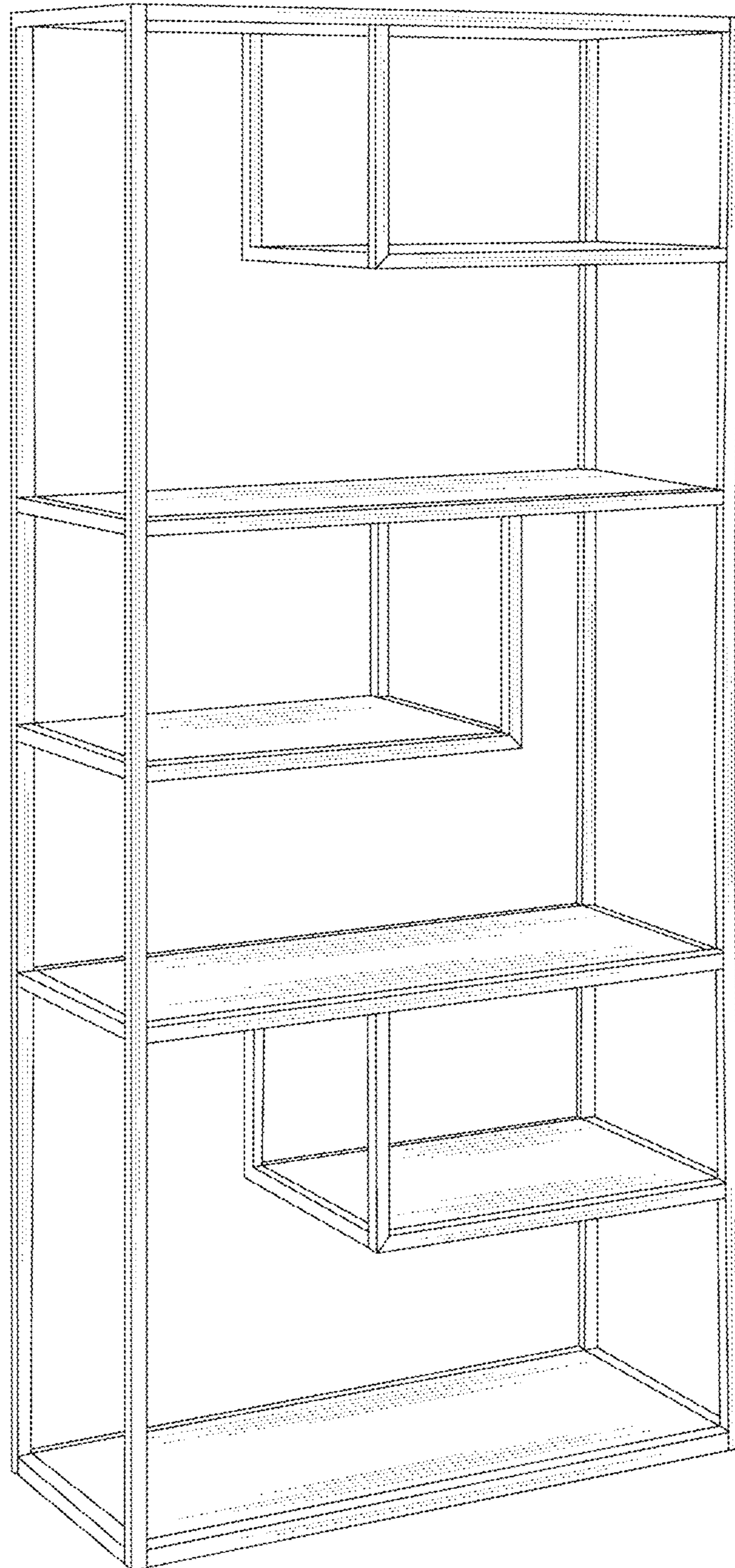

Fig.1

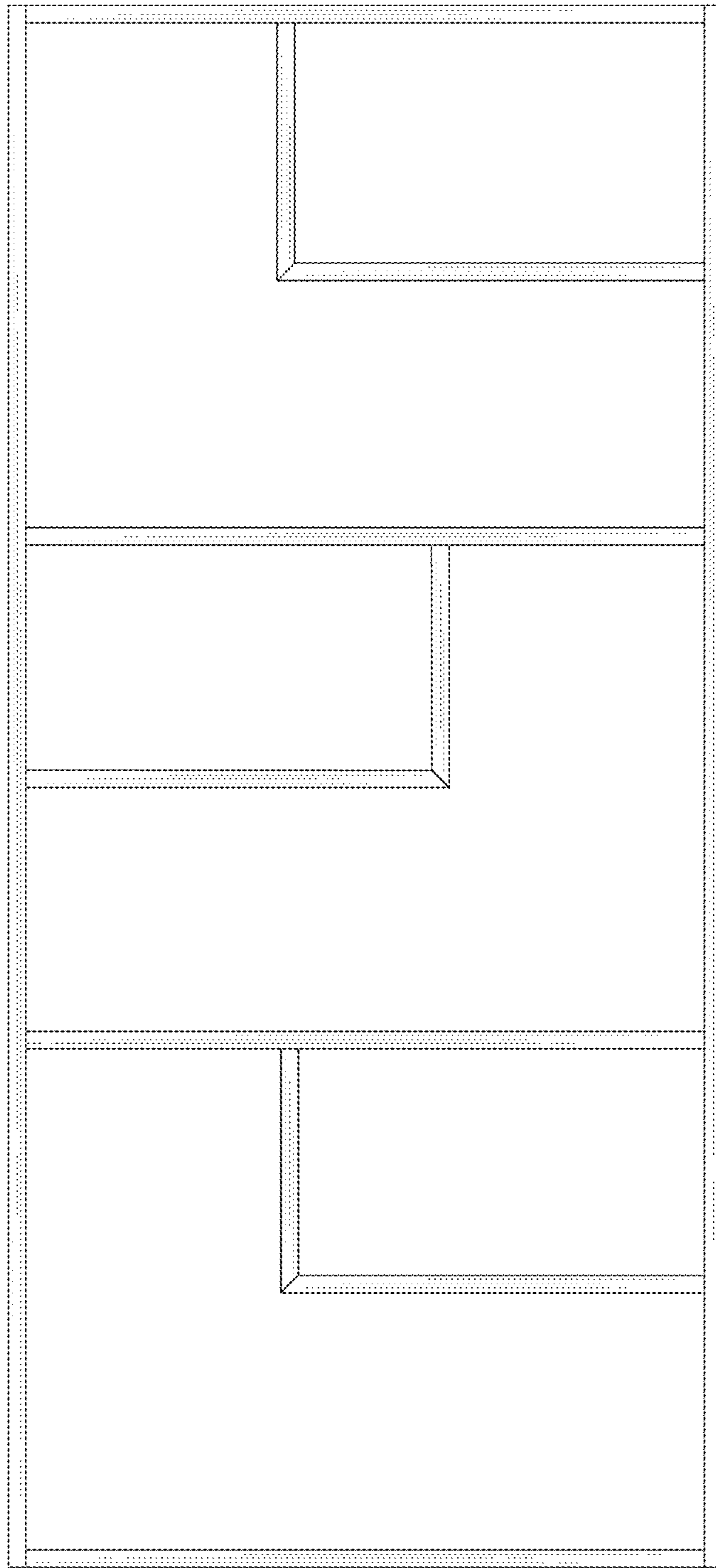

Fig.2

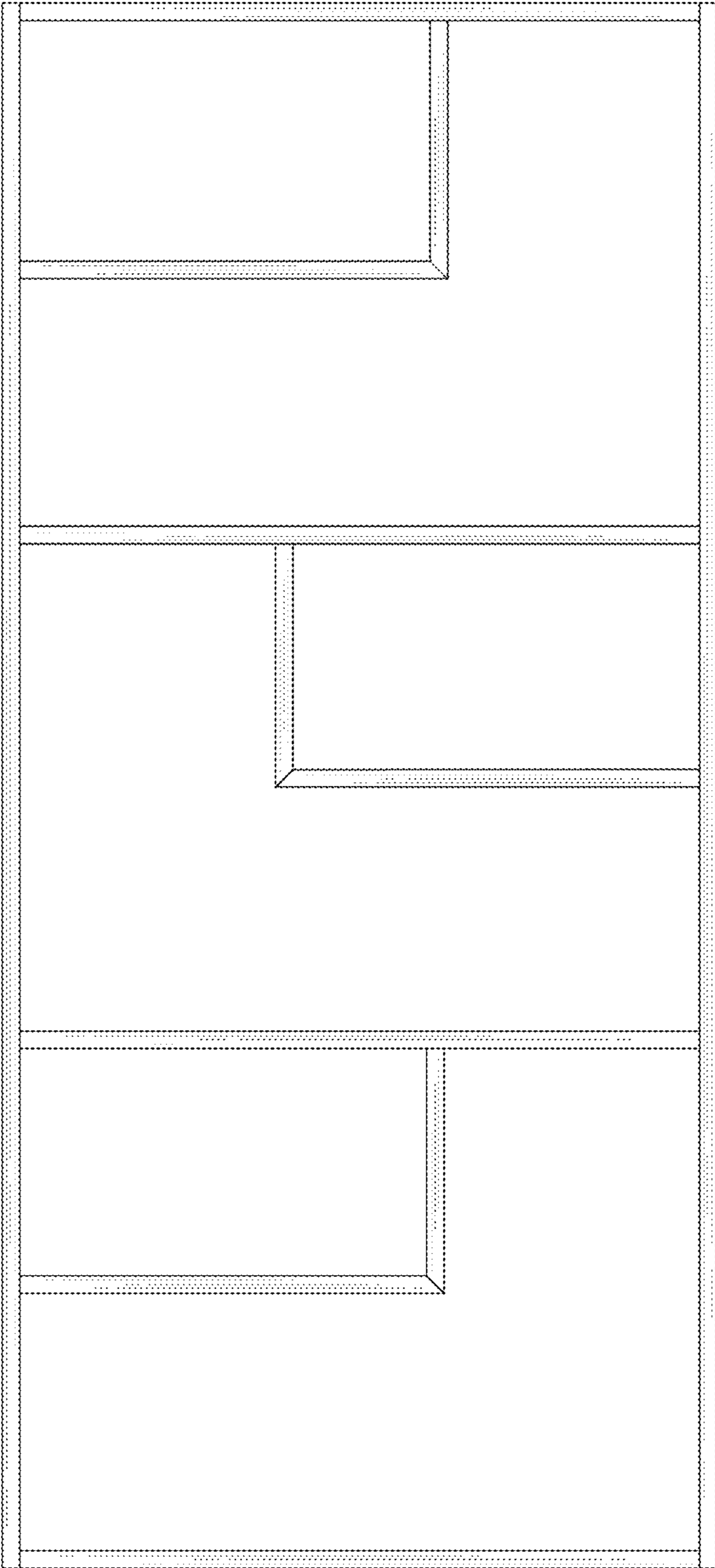

Fig.3

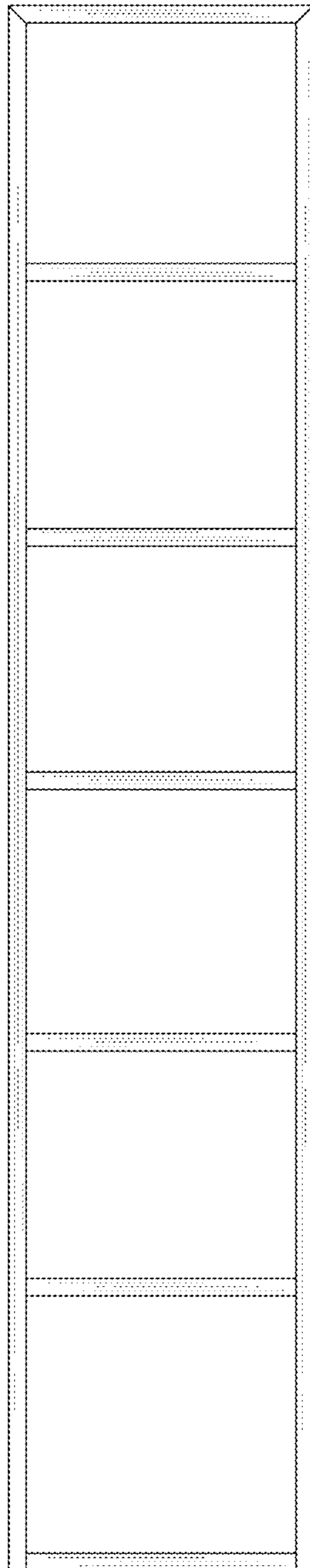

Fig.4

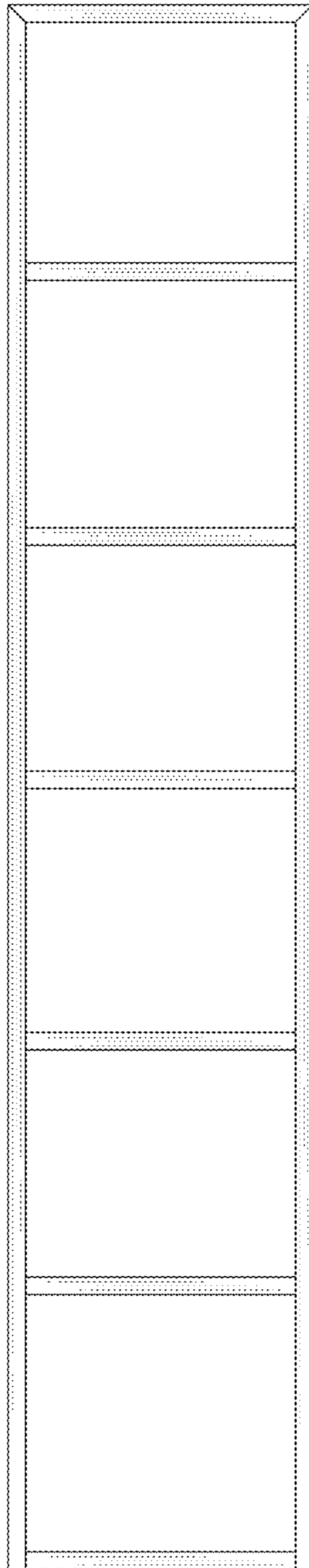

Fig.5



Fig.6

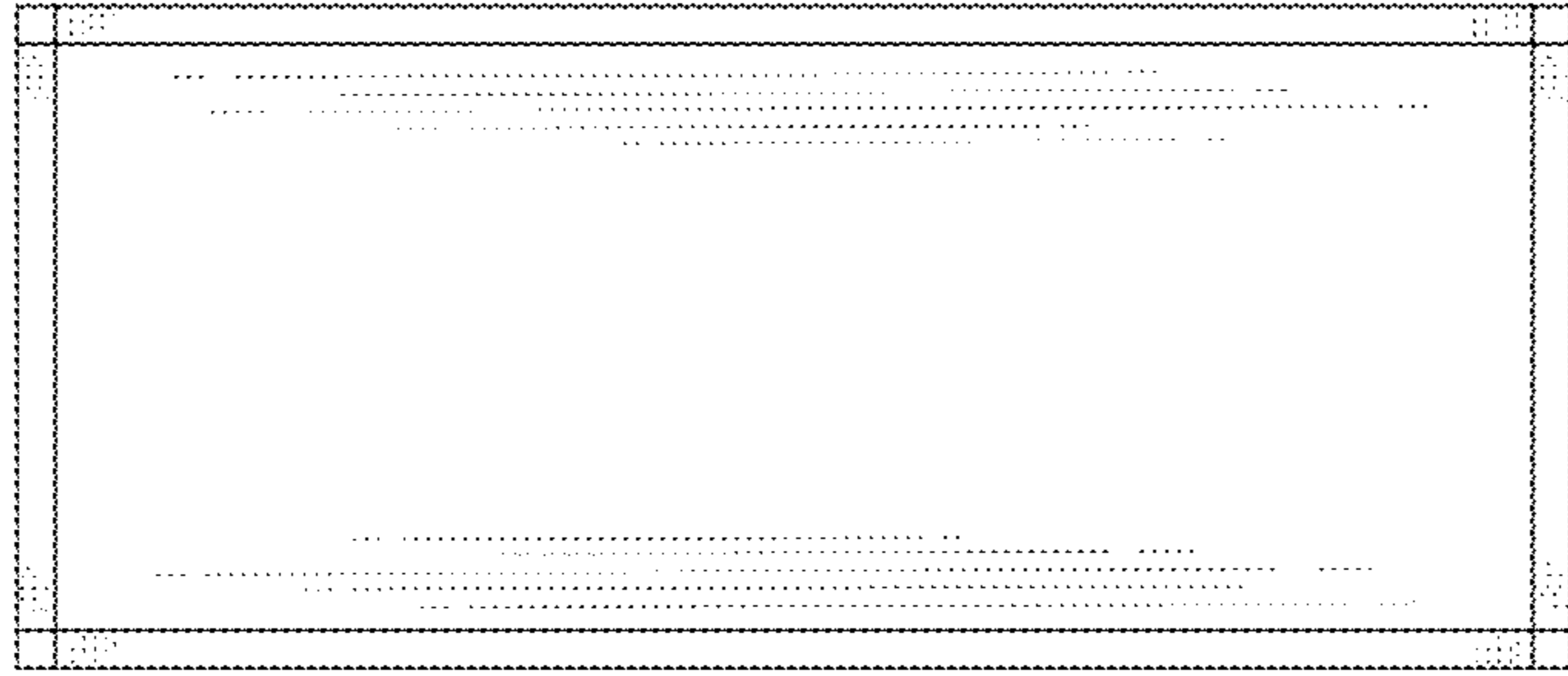

Fig.7