



US00D931083S

(12) **United States Design Patent**  
**Kibayashi et al.**

(10) **Patent No.:** **US D931,083 S**

(45) **Date of Patent:** **\*\* Sep. 21, 2021**

- (54) **CABLE WINDING MACHINE**
- (71) Applicant: **Mitsubishi Electric Corporation**,  
Tokyo (JP)
- (72) Inventors: **Yusuke Kibayashi**, Tokyo (JP);  
**Noboru Kawaguchi**, Tokyo (JP); **Junji Takaki**, Tokyo (JP); **Katsumi Yamasaki**, Tokyo (JP)
- (73) Assignee: **Mitsubishi Electric Corporation**,  
Tokyo (JP)

3,000,588 A \* 9/1961 Brady ..... B65H 49/32  
242/388.8  
4,155,518 A \* 5/1979 Small ..... B60P 3/035  
242/388.7  
4,208,021 A \* 6/1980 Wall ..... A01K 3/00  
242/129  
D288,773 S \* 3/1987 Ward ..... D8/359  
4,903,911 A \* 2/1990 Sepka ..... B65H 75/40  
15/315  
D341,770 S \* 11/1993 Spear ..... D8/359  
5,622,333 A \* 4/1997 Jacques ..... B65H 75/241  
242/118.5

(Continued)

(\*\*) Term: **15 Years**

FOREIGN PATENT DOCUMENTS

(21) Appl. No.: **29/732,561**

EP 449076 A1 \* 10/1991

(22) Filed: **Apr. 24, 2020**

*Primary Examiner* — Patricia A Palasik

(30) **Foreign Application Priority Data**

(74) *Attorney, Agent, or Firm* — Studebaker & Brackett PC

Nov. 1, 2019 (JP) ..... 2019-024465

(51) **LOC (13) Cl.** ..... **08-05**

(52) **U.S. Cl.**  
USPC ..... **D8/354**; D8/358; D15/138

(58) **Field of Classification Search**  
USPC ..... D8/358, 359; D13/137.4; D14/433;  
D15/138, 199

CPC ..... B65H 49/32; B65H 54/72; B65H 54/553;  
B65H 61/00; H02G 11/02; H02G 11/00  
See application file for complete search history.

(56) **References Cited**

U.S. PATENT DOCUMENTS

1,350,946 A \* 8/1920 Stockdale ..... B65H 49/30  
242/407.1  
1,969,924 A \* 8/1934 Carter ..... B65H 75/24  
242/470  
2,370,868 A \* 3/1945 Luebke ..... B65H 75/24  
242/407.1  
2,983,465 A \* 5/1961 Skubal ..... B65H 75/24  
242/575.5

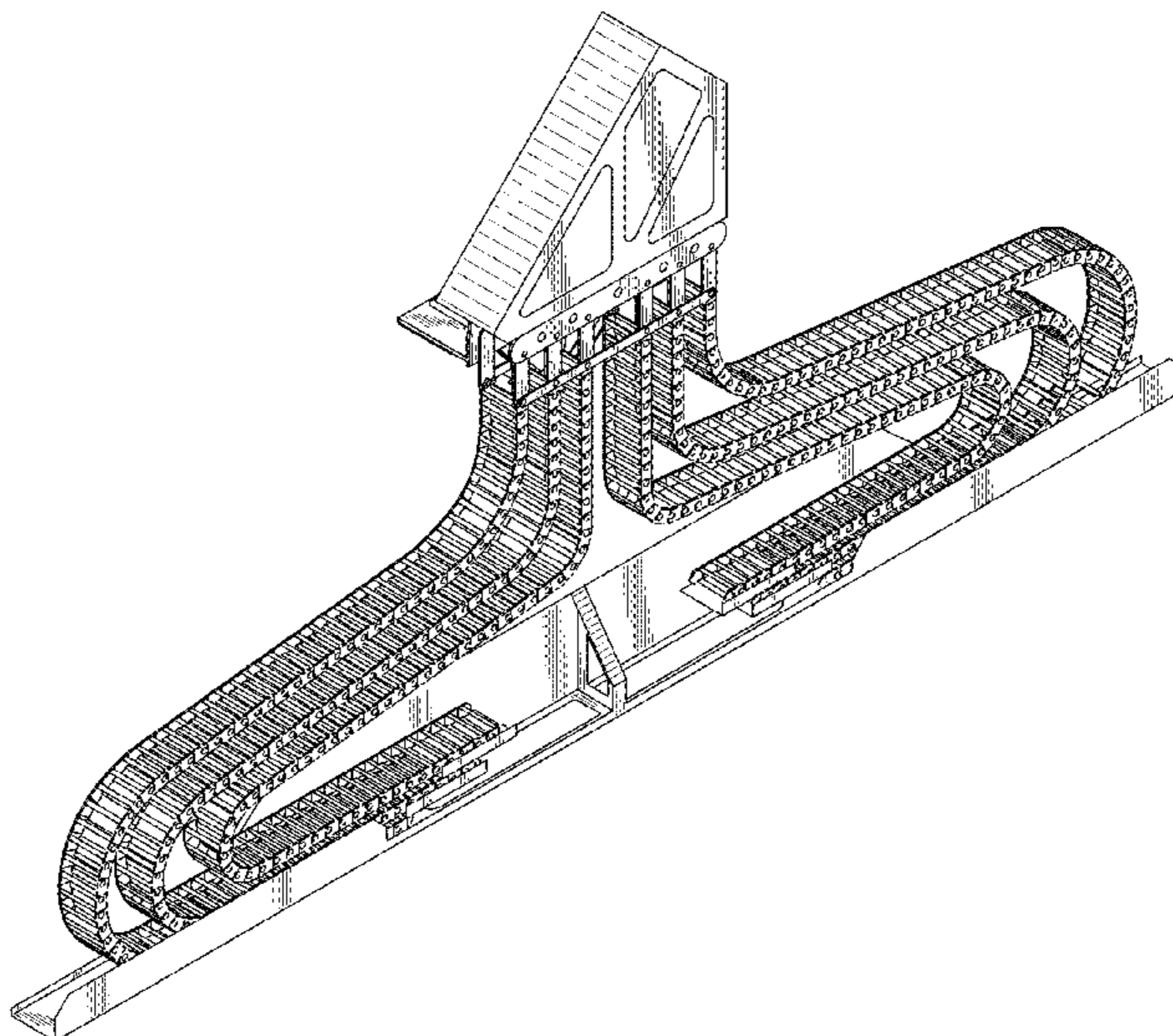
(57) **CLAIM**

The ornamental design for a cable winding machine, as shown and described.

**DESCRIPTION**

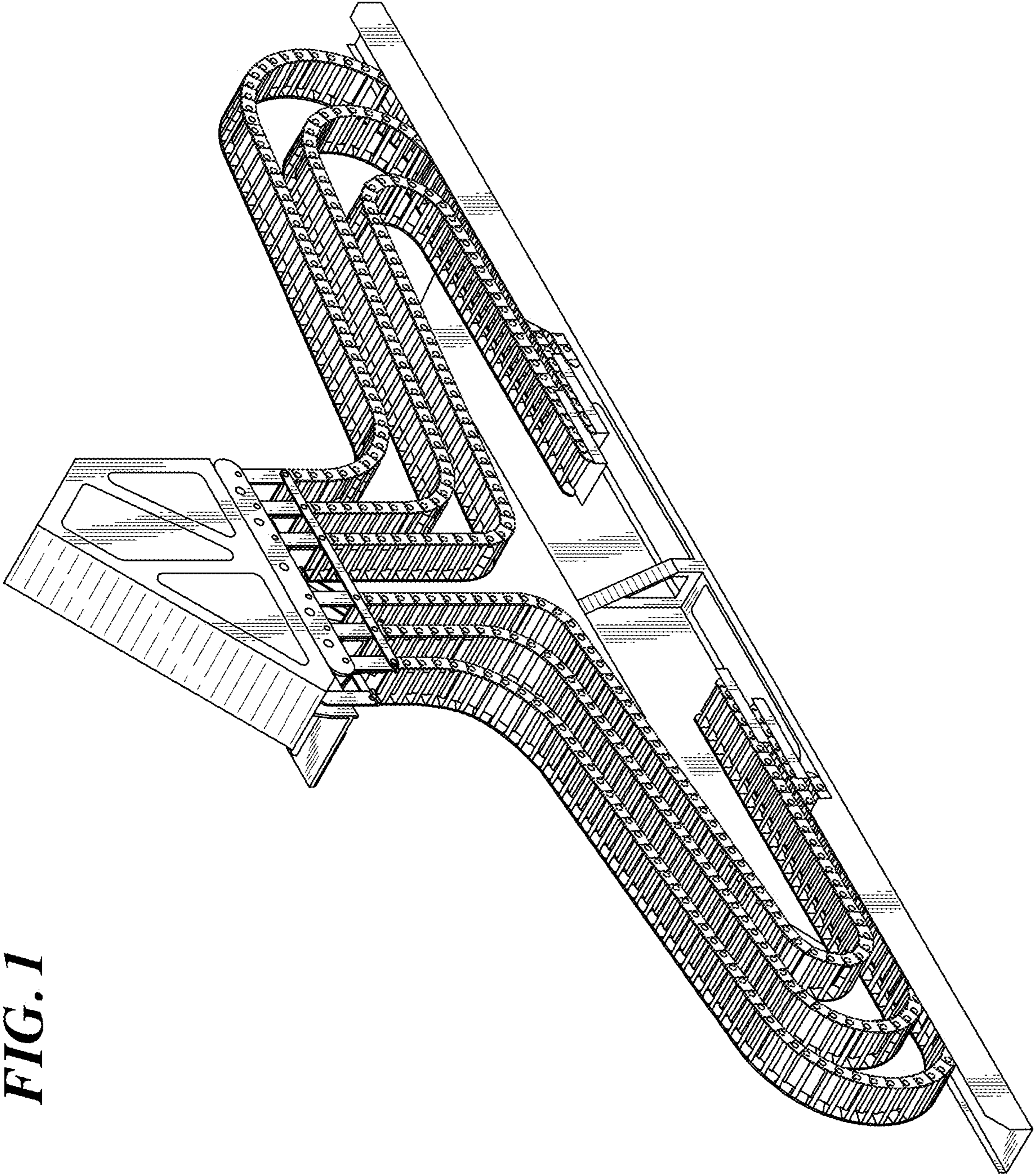
FIG. 1 is a front, top, and left side perspective view of a cable winding machine, showing our new design;  
FIG. 2 is a rear, bottom, and right side perspective view thereof;  
FIG. 3 is a front view thereof;  
FIG. 4 is a rear view thereof;  
FIG. 5 is a top view thereof;  
FIG. 6 is a bottom view thereof;  
FIG. 7 is a right side view thereof;  
FIG. 8 is a left side view thereof;  
FIG. 9 is a front view 1 showing the changed state thereof; and,  
FIG. 10 is a front view 2 showing the changed state thereof.

**1 Claim, 10 Drawing Sheets**



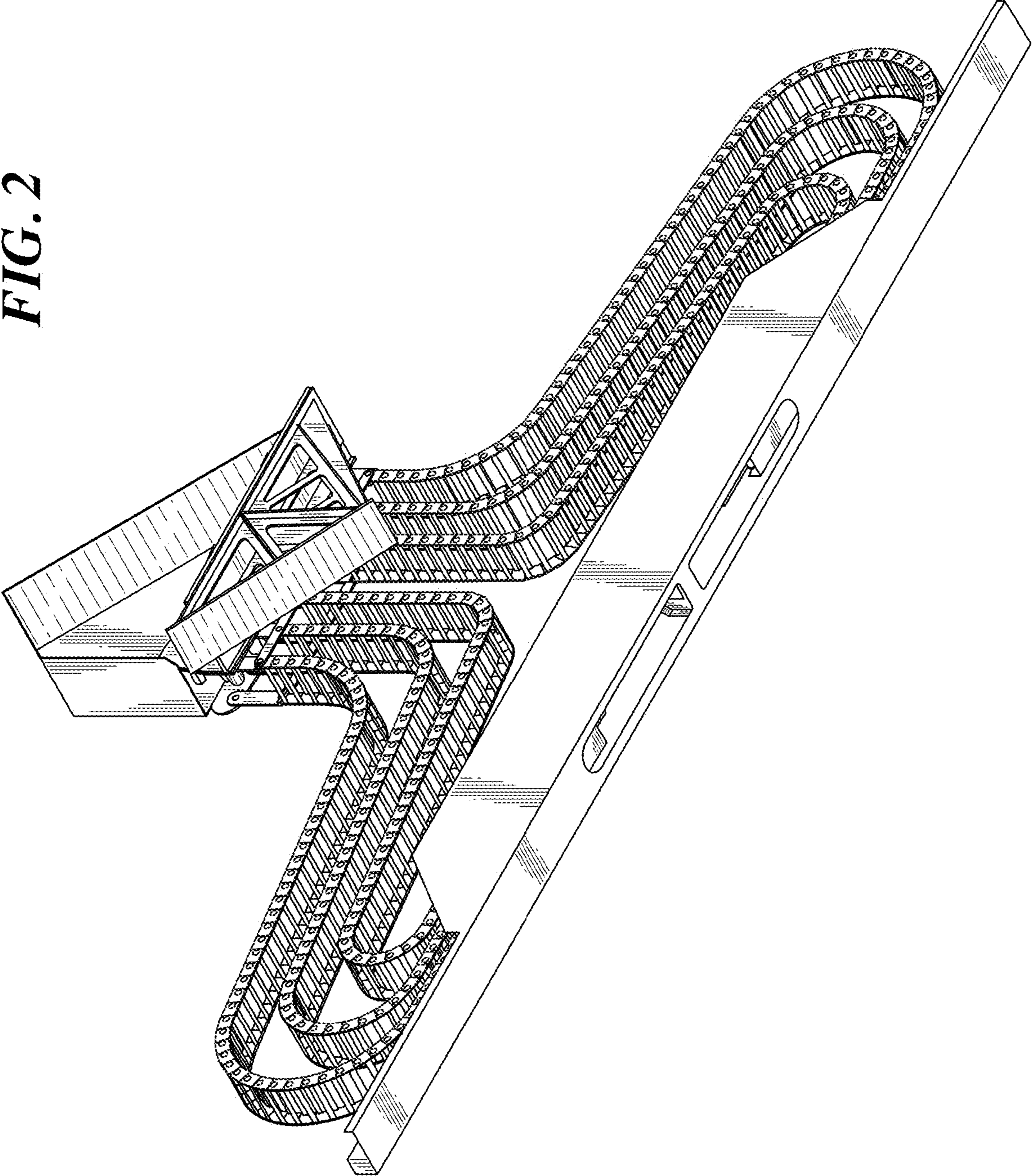






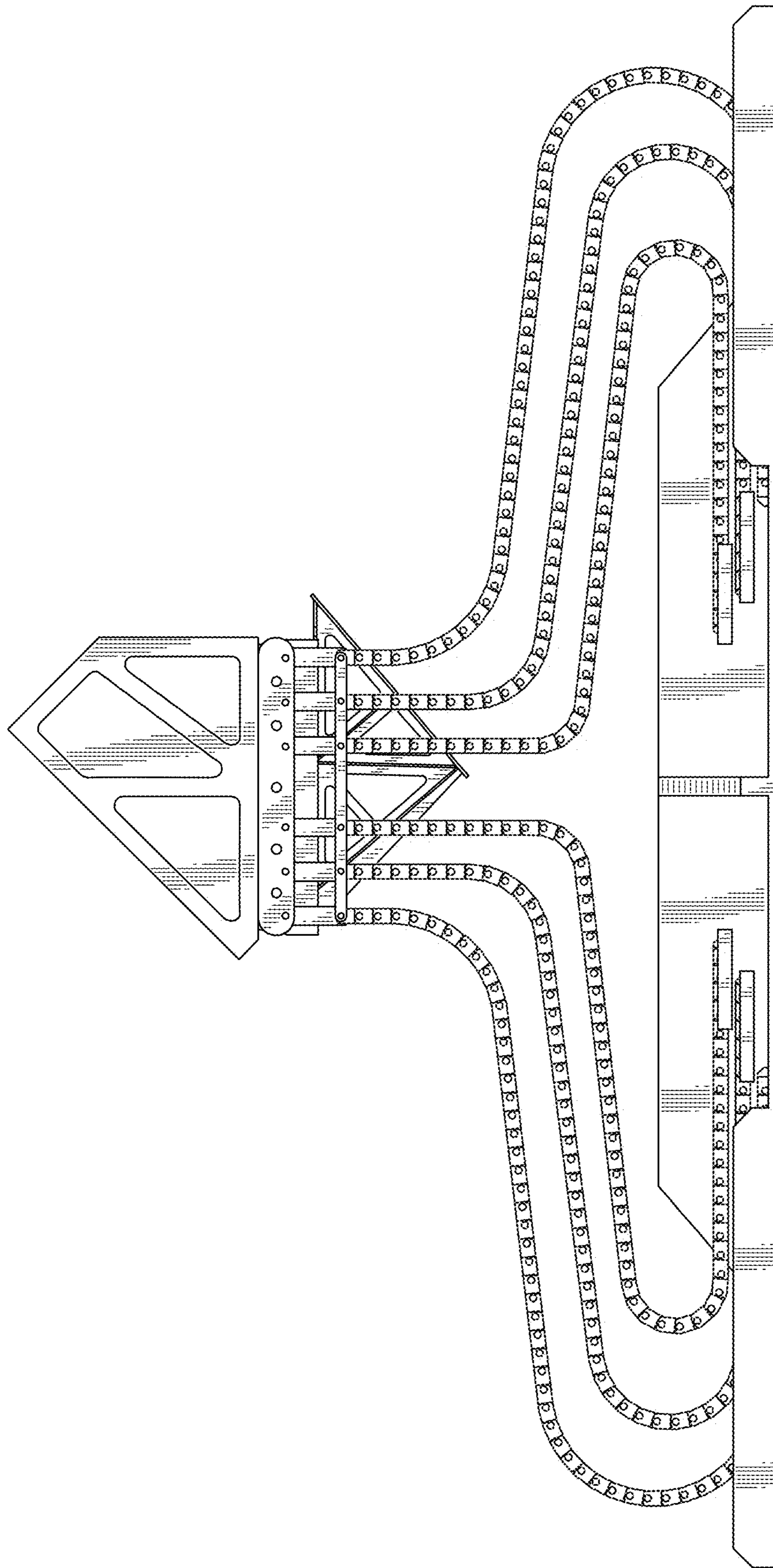
**FIG. 1**

FIG. 2

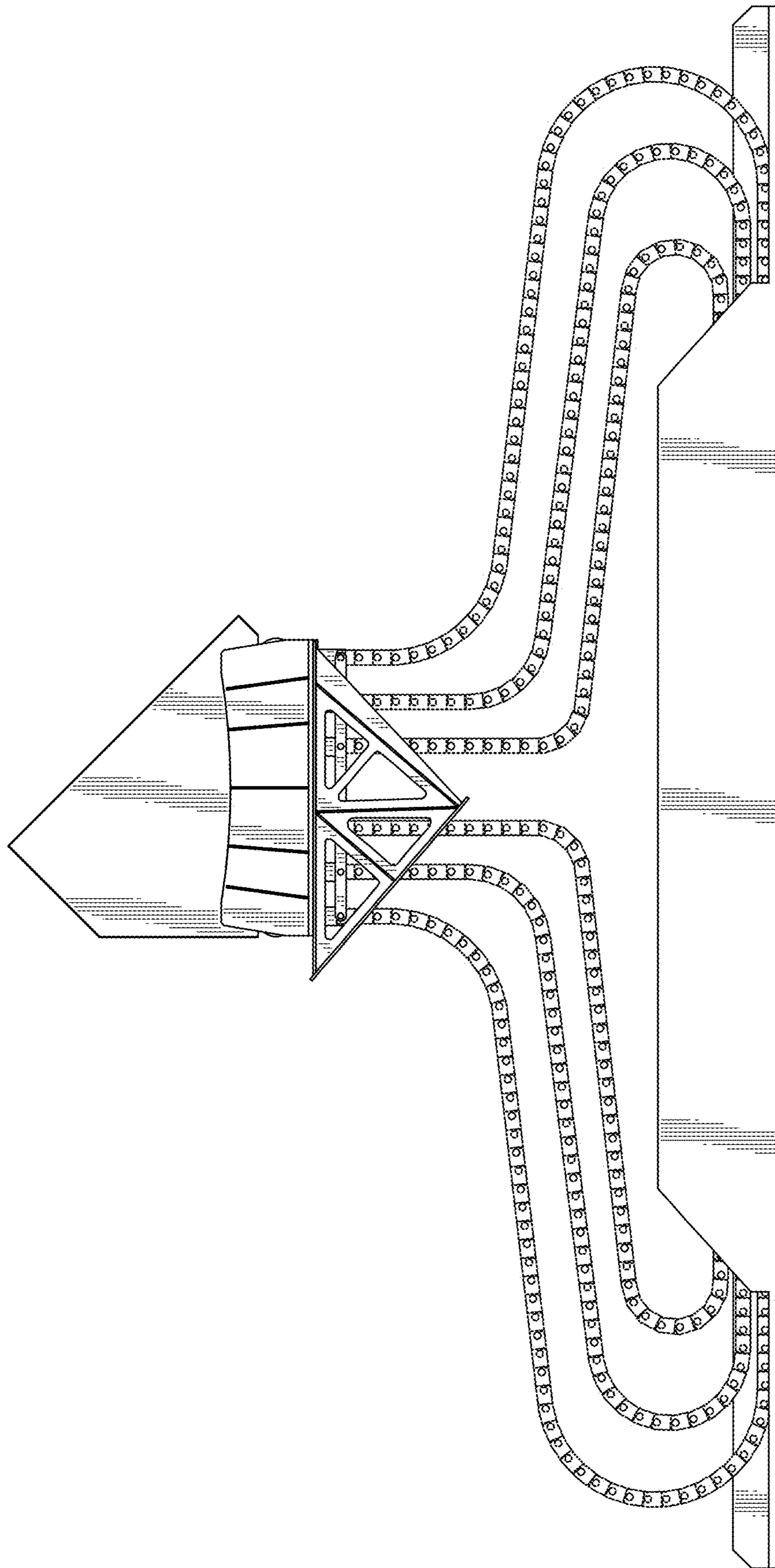




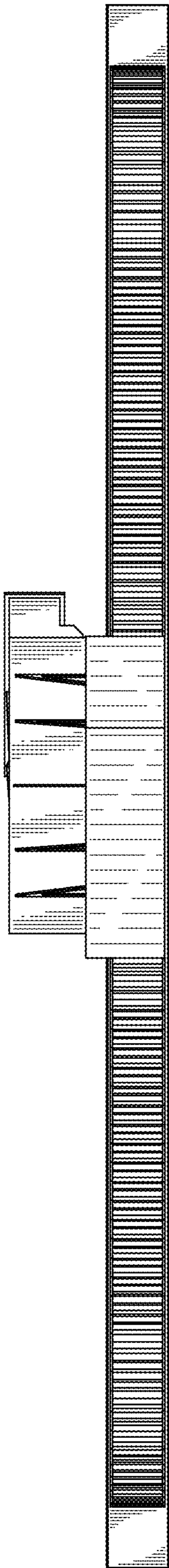
**FIG. 3**



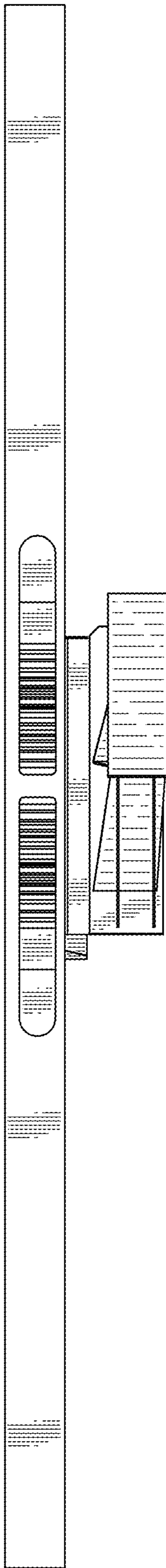
**FIG. 4**



*FIG. 5*

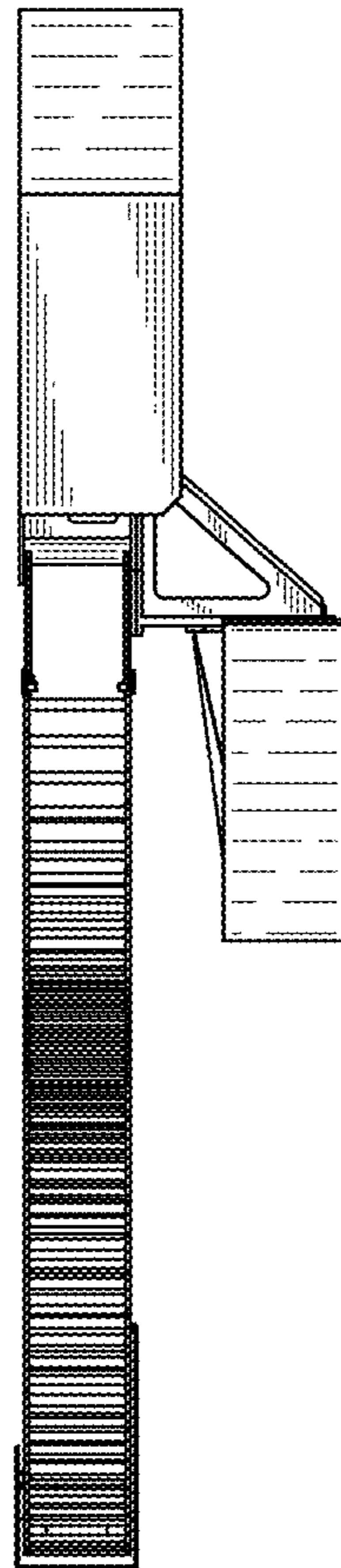


*FIG. 6*

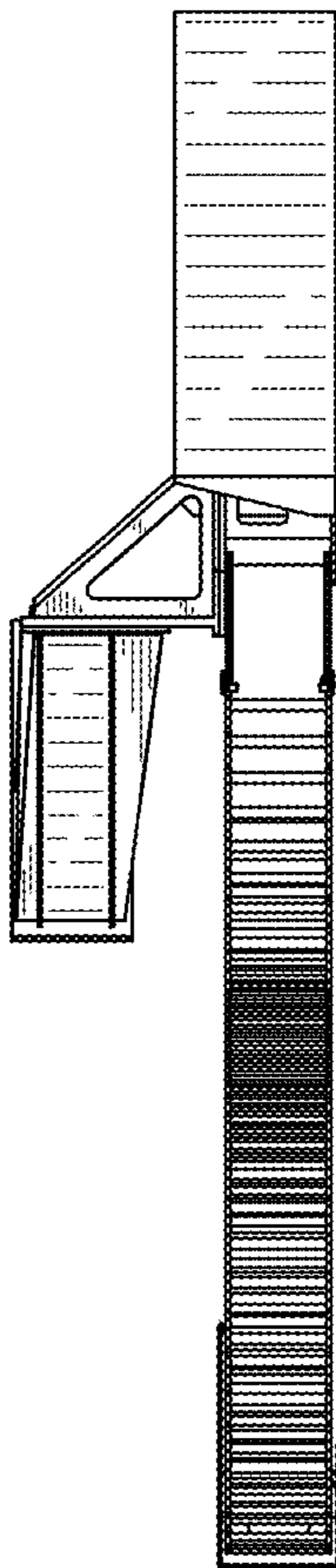




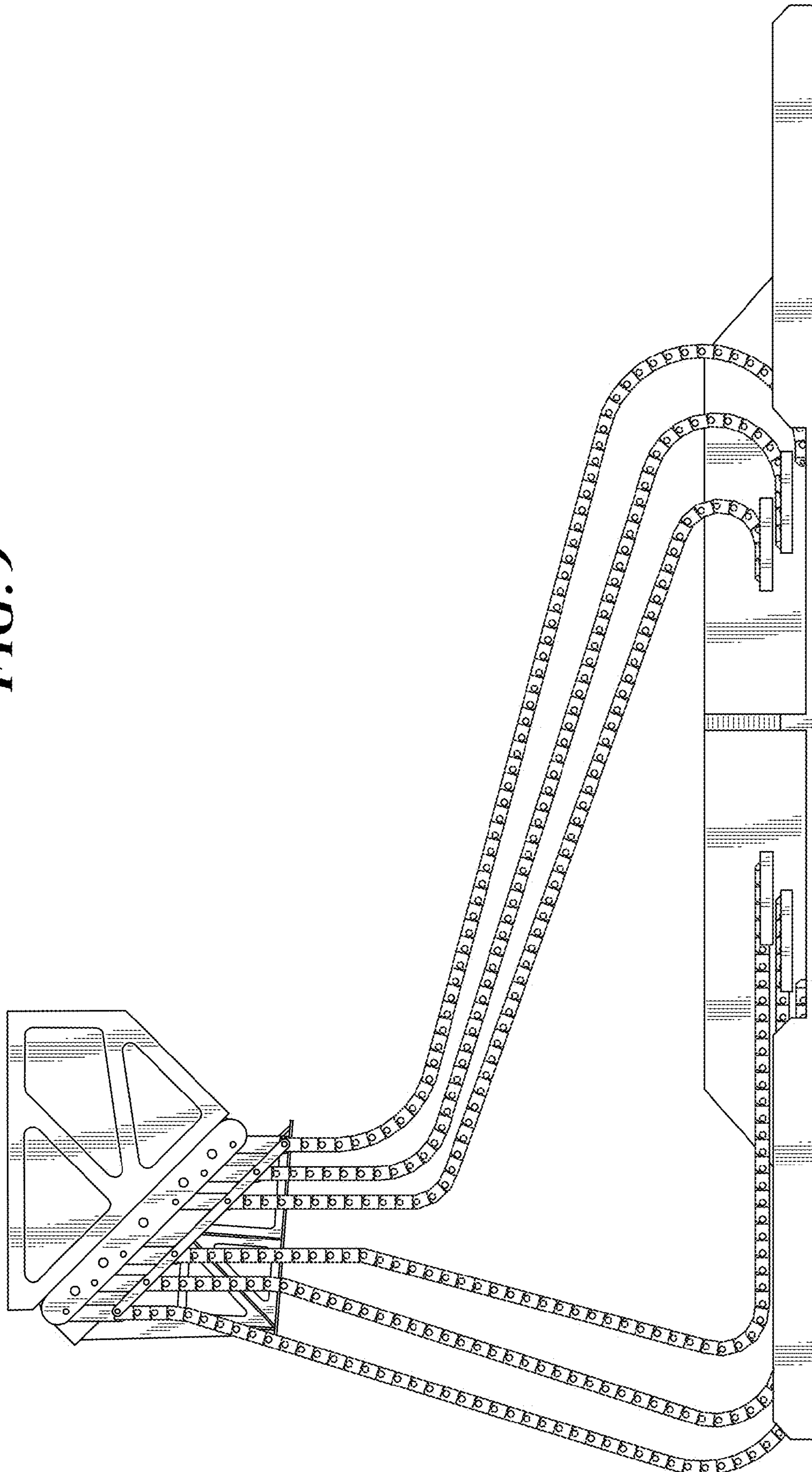
***FIG. 7***



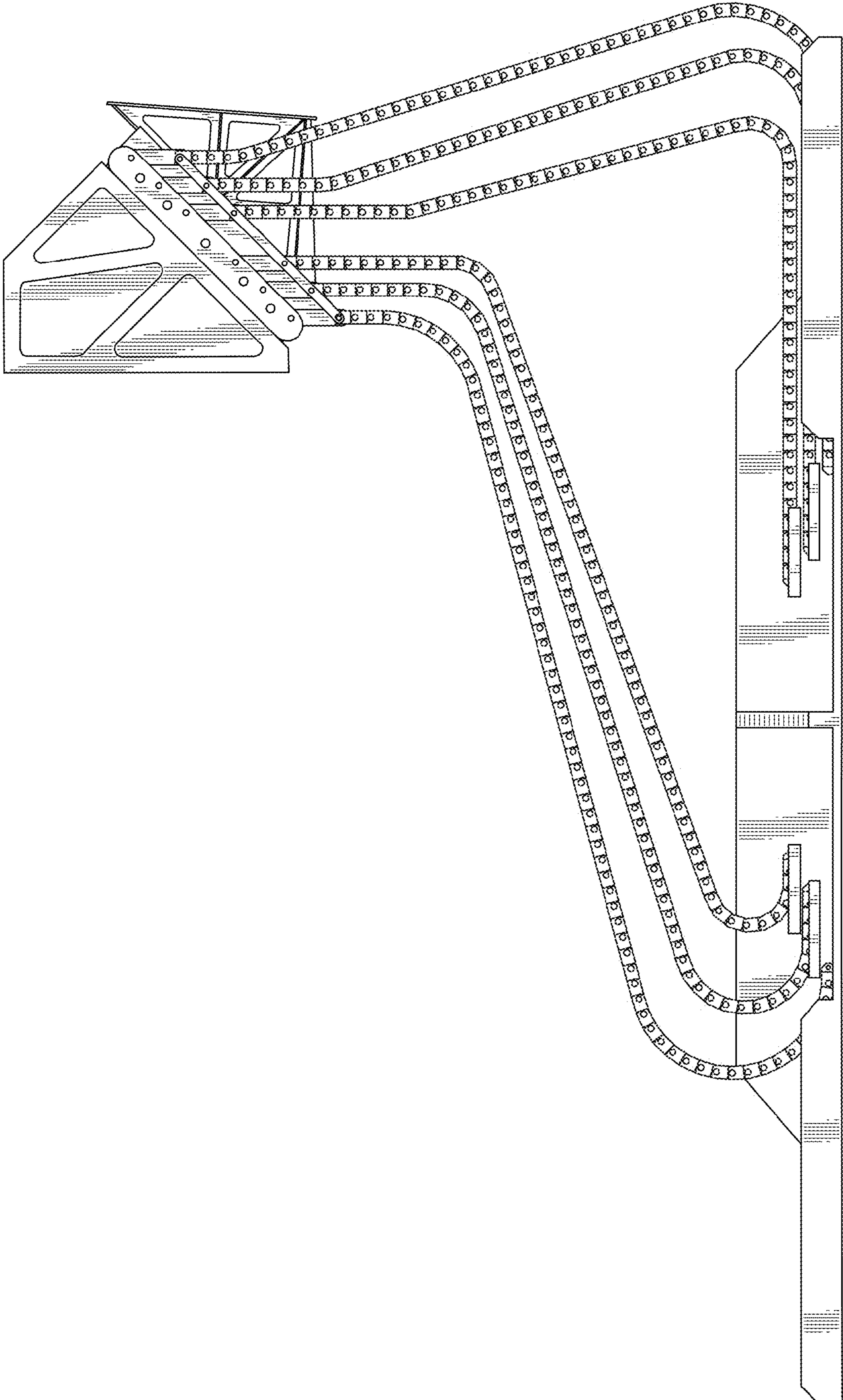
*FIG. 8*



**FIG. 9**







**FIG. 10**