



US00D929880S

(12) **United States Design Patent** (10) **Patent No.:** **US D929,880 S**
Lan (45) **Date of Patent:** **** Sep. 7, 2021**

(54) **LASER PROBE HEAD**
(71) Applicant: **Jinhe Lan**, Guangdong (CN)
(72) Inventor: **Jinhe Lan**, Guangdong (CN)
(**) Term: **15 Years**

D830,208 S * 10/2018 Makino D10/78
10,260,735 B2 * 4/2019 Chien H02J 7/00
D849,578 S * 5/2019 Huang D10/80
2005/0018178 A1 * 1/2005 Schloss G01K 17/003
356/216
2012/0134386 A1 * 5/2012 Bender G01K 17/003
374/32

(21) Appl. No.: **29/711,825**

FOREIGN PATENT DOCUMENTS

CN 201930590990.2 * 10/2019

(22) Filed: **Nov. 3, 2019**

(51) **LOC (13) Cl.** **10-05**

(52) **U.S. Cl.**
USPC **D10/78**

(58) **Field of Classification Search**
USPC D10/49, 75, 76, 78, 80, 96, 97, 104.1
CPC G01K 17/003; G01K 17/16; G01K 17/18;
G01J 1/0233; G01J 1/04
See application file for complete search history.

OTHER PUBLICATIONS

RF Camera Detector Wireless | aliexpress.com; no posting date [online], © 2010-2021 AliExpress.com [retrieved Jun. 14, 2021] from Internet: <<https://www.aliexpress.com/item/32887725189.html>> (Year: 2021).*
Wireless RF Signal Detector | amazon.com; date first available Apr. 2019 [online], © 1996-2021, Amazon.com, Inc. [retrieved Jun. 14, 2021] from Internet: <https://www.amazon.com/Detector-Wireless-Scanner-Anti-Theft-Vibration/dp/B07QF821YQ/ref=psdc_12909791_t5_B08K459FR2> (Year: 2019).*

(56) **References Cited**

U.S. PATENT DOCUMENTS

3,908,457 A * 9/1975 Drong G01K 11/02
374/32
4,804,917 A * 2/1989 Miller G01R 1/203
324/126
D316,052 S * 4/1991 Bubash D10/75
D407,031 S * 3/1999 Bourgeois D10/78
D410,529 S * 6/1999 Taylor D23/245
D516,929 S * 3/2006 Vipond D10/104.1
D531,066 S * 10/2006 Watabe D10/46
7,897,277 B2 * 3/2011 Meyer F21L 2/00
429/100
D644,738 S * 9/2011 Regan D24/187
D656,426 S * 3/2012 Marcoz D10/79
D686,927 S * 7/2013 Matuschek D10/74
D694,264 S * 11/2013 Reinhardt D14/496
D718,868 S * 12/2014 Schroderus D24/167
D744,360 S * 12/2015 Makino D10/78
D749,004 S * 2/2016 Sirius-El D10/97
D749,971 S * 2/2016 Sirius-El D10/97
D778,189 S * 2/2017 Worden D10/104.1
D829,119 S * 9/2018 Osawa D10/96

* cited by examiner

Primary Examiner — Katherine Glennon

(57) **CLAIM**

The ornamental design for a laser probe head, as shown.

DESCRIPTION

FIG. 1 is a front elevational view of a laser probe head showing my new design;
FIG. 2 is a rear elevational view thereof;
FIG. 3 is a left side view thereof;
FIG. 4 is a right side view thereof;
FIG. 5 is a top plan view thereof;
FIG. 6 is a bottom plan view thereof;
FIG. 7 is a perspective view thereof; and,
FIG. 8 is another perspective view thereof.

1 Claim, 7 Drawing Sheets

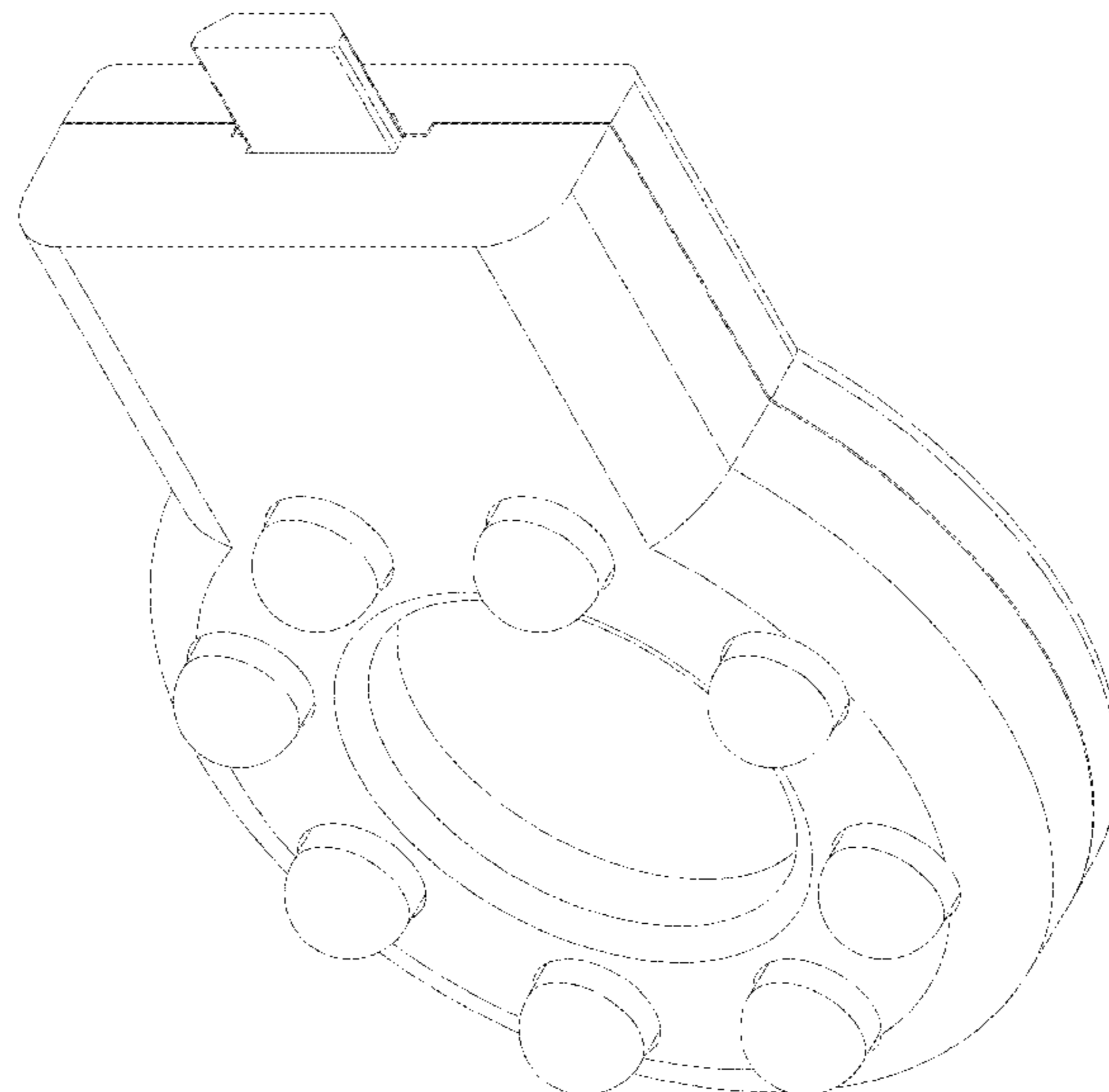

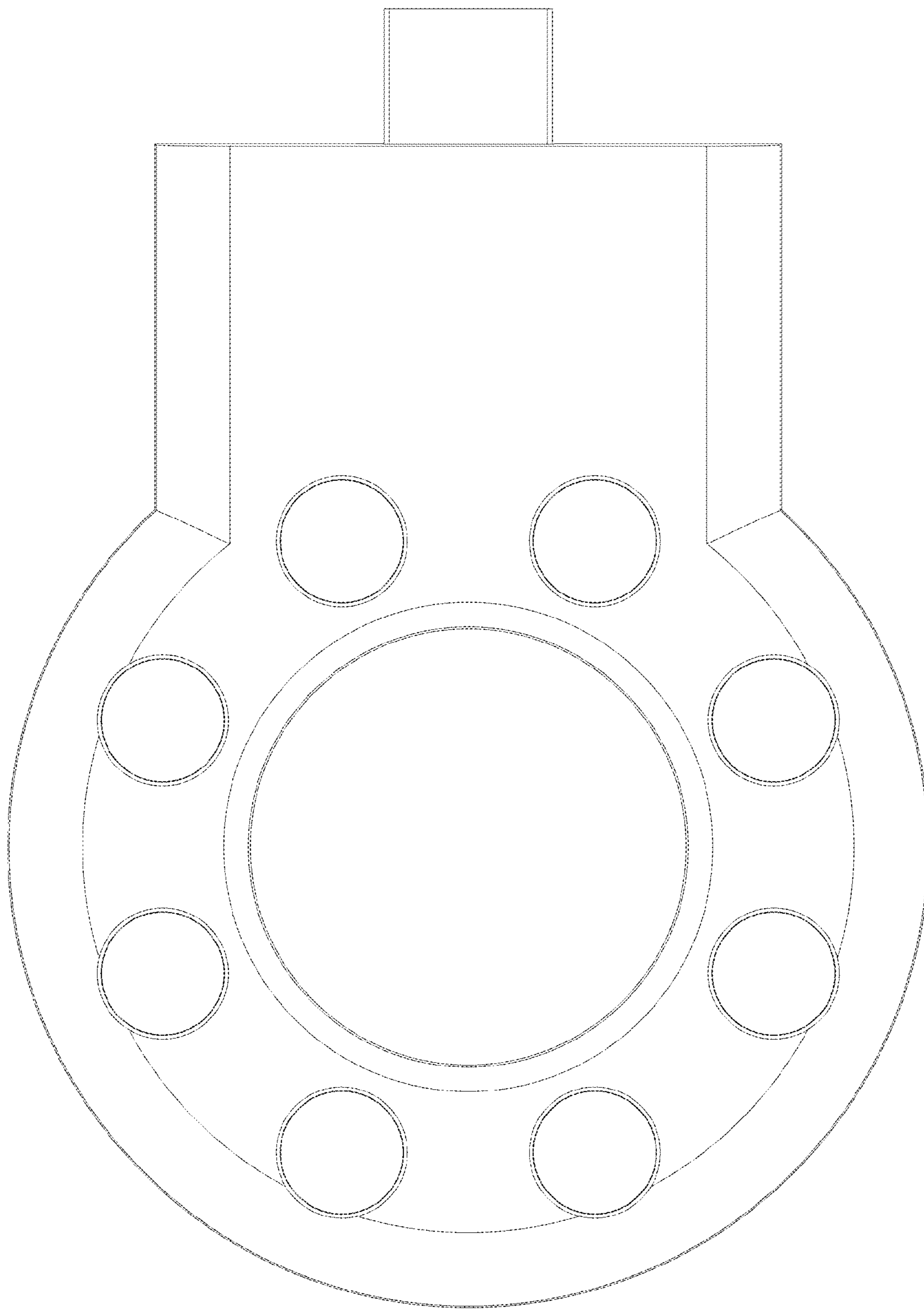

Fig. 1

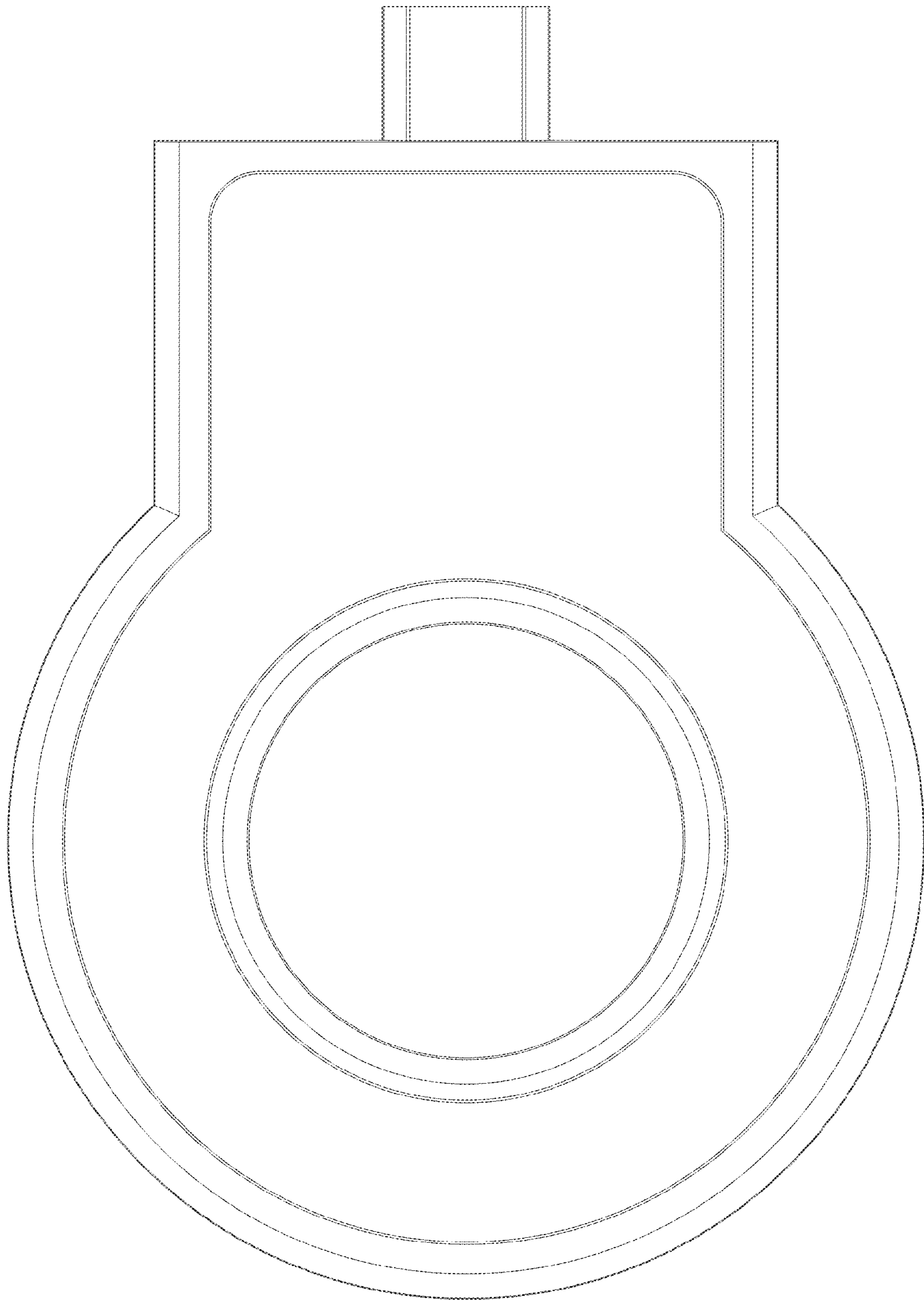

Fig. 2

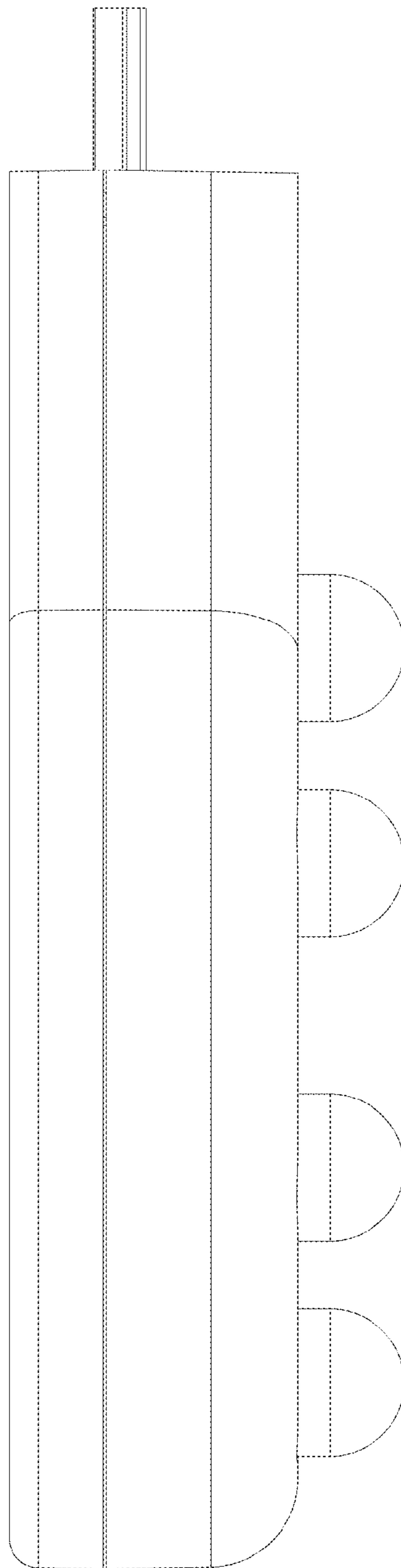

Fig. 3

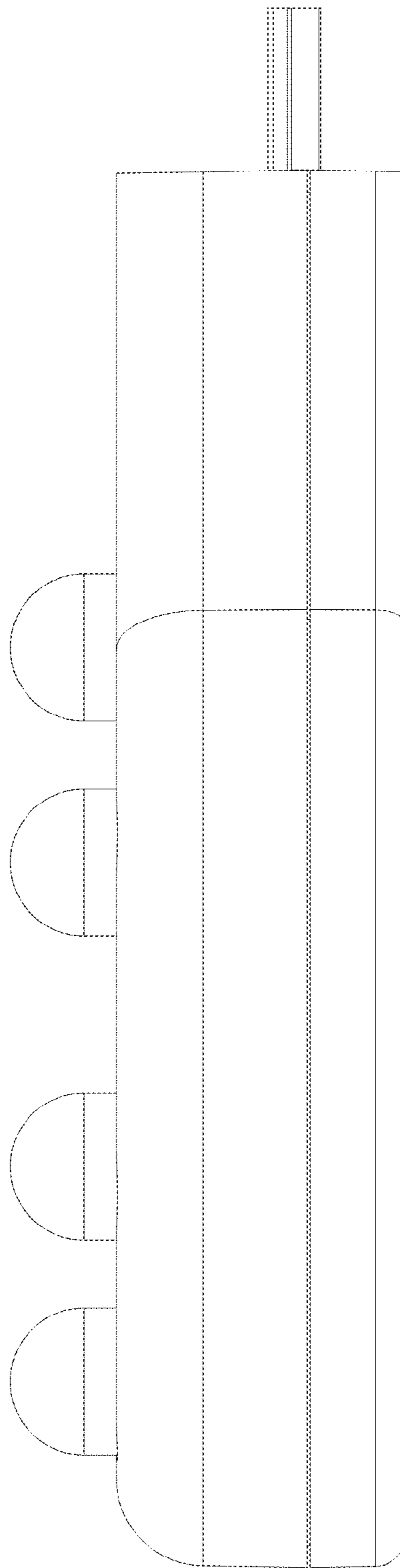

Fig. 4

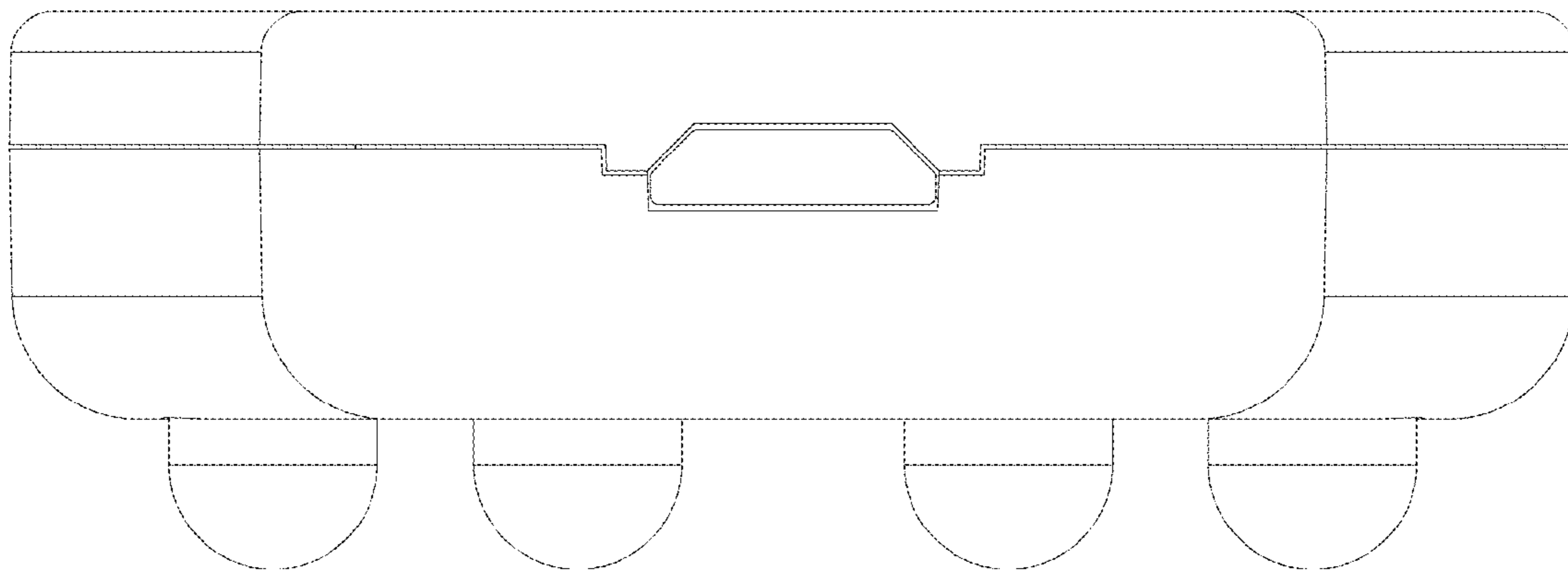

Fig. 5

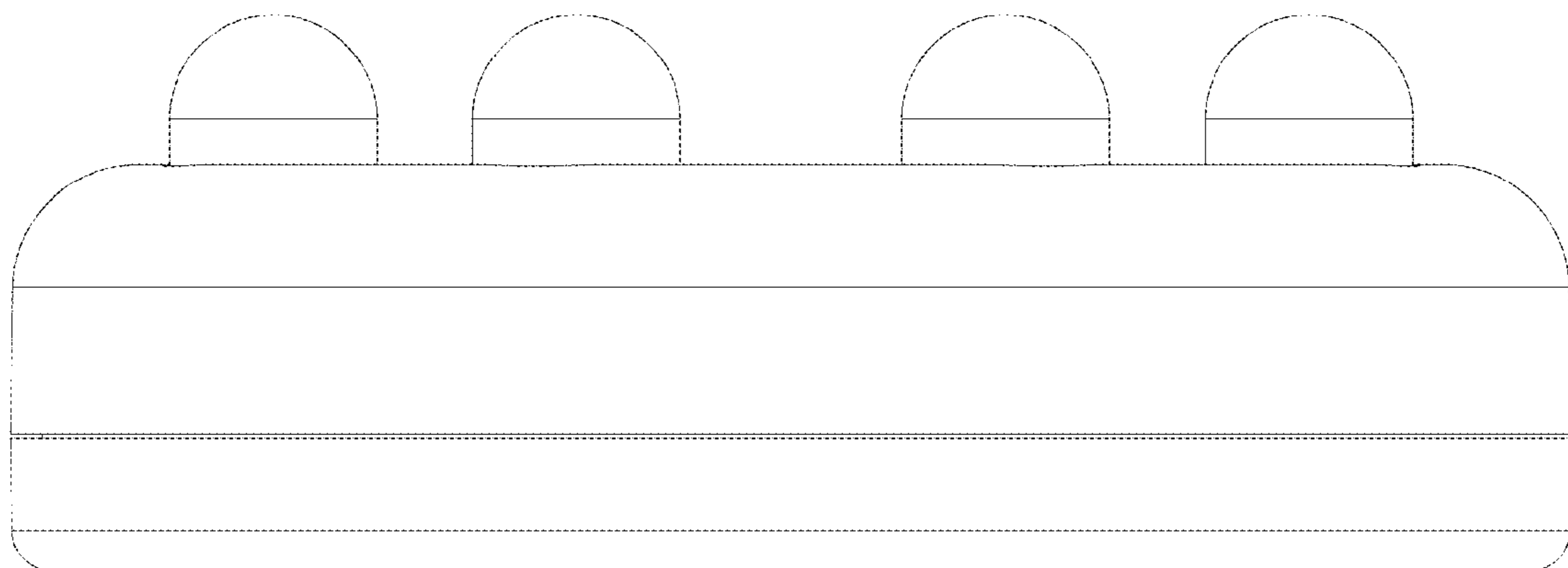

Fig. 6

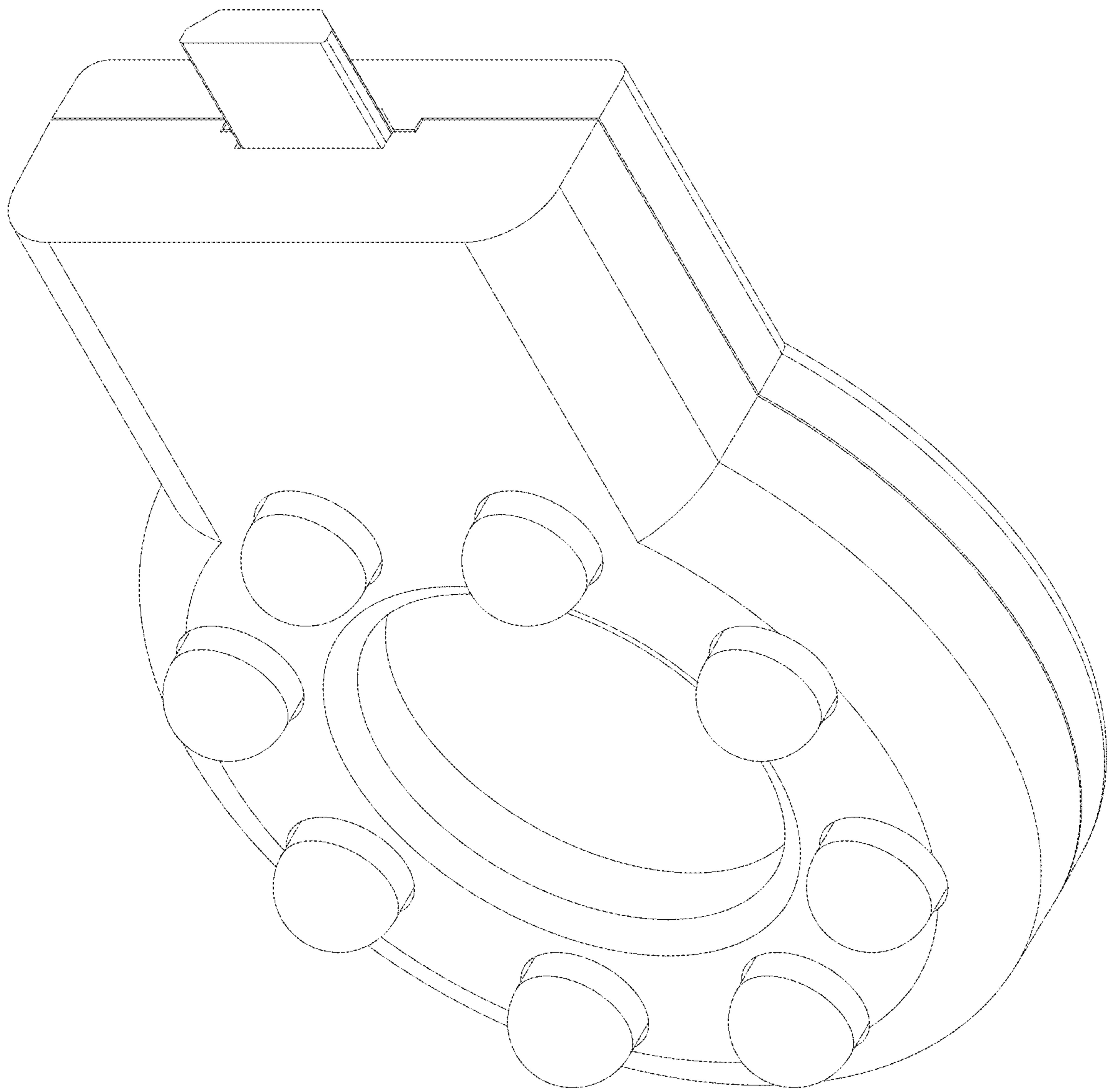

Fig. 7

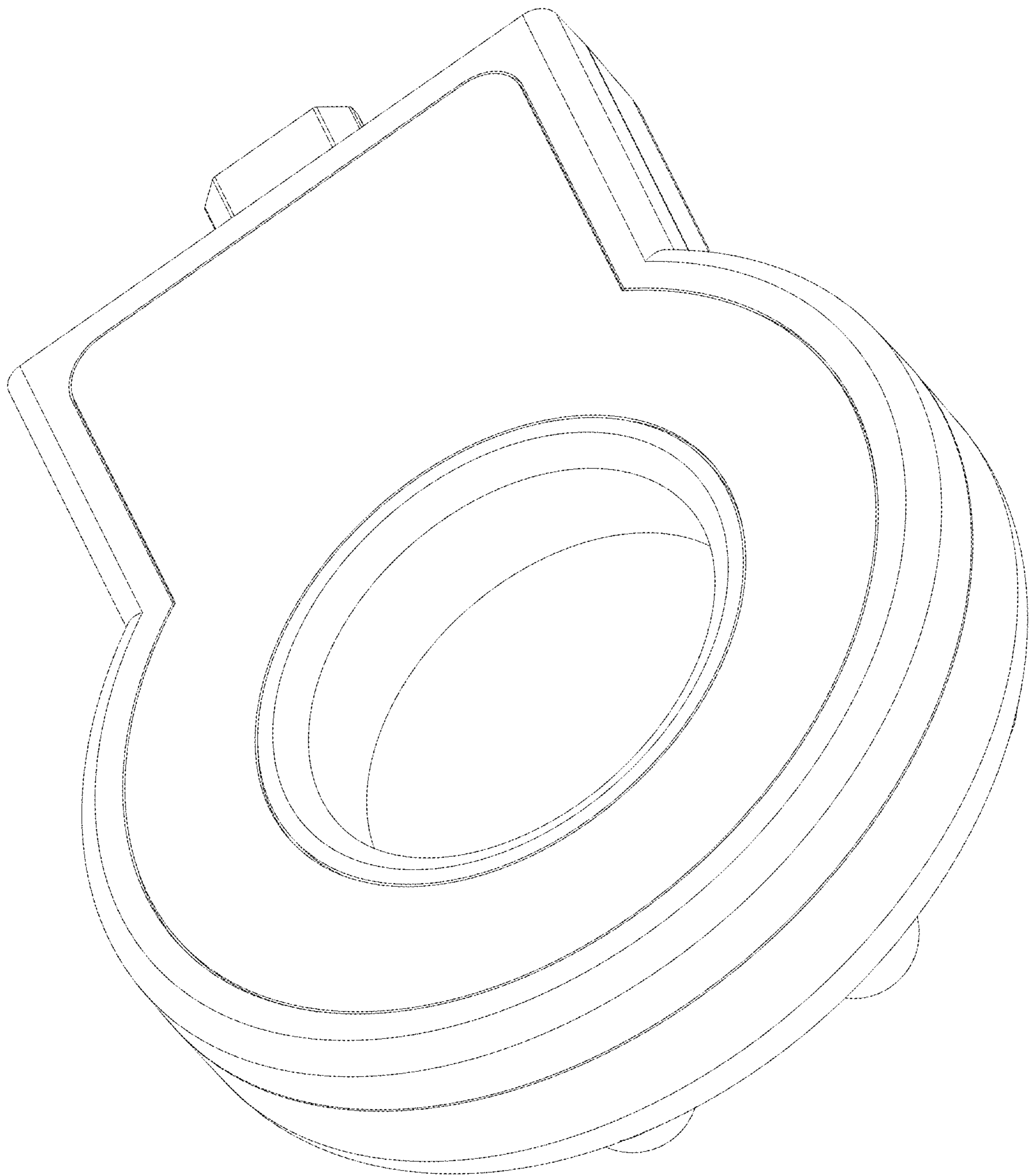

Fig. 8