



US00D929429S

(12) **United States Design Patent** (10) **Patent No.:** **US D929,429 S**
Patel (45) **Date of Patent:** **** Aug. 31, 2021**

(54) **DISPLAY SCREEN OR PORTION THEREOF WITH AN ANIMATED GRAPHICAL USER INTERFACE**

H04M 1/04; H04M 1/05; H04M 1/667; H04M 1/6058; Y02B 60/1217
See application file for complete search history.

(71) Applicant: **PAYRANGE INC.**, Portland, OR (US)

(56) **References Cited**

(72) Inventor: **Paresh K. Patel**, Portland, OR (US)

U.S. PATENT DOCUMENTS

(73) Assignee: **PAYRANGE INC.**, Portland, OR (US)

D295,637 S * 5/1988 Wells-Papanek D14/493
5,479,602 A * 12/1995 Baecker G06F 3/04817
715/838
D625,326 S * 10/2010 Allen D14/488

(**) Term: **15 Years**

(Continued)

(21) Appl. No.: **29/670,599**

Primary Examiner — Katherine A Holbrow

(22) Filed: **Nov. 16, 2018**

(74) *Attorney, Agent, or Firm* — Morgan, Lewis & Bockius LLP

Related U.S. Application Data

(57) **CLAIM**

(63) Continuation of application No. 29/524,727, filed on Apr. 22, 2015, now Pat. No. Des. 836,118, which is a continuation-in-part of application No. 14/611,065, filed on Jan. 30, 2015, now Pat. No. 10,019,724.

The ornamental design for a display screen or portion thereof with an animated graphical user interface, as shown and described.

(51) **LOC (13) Cl.** **14-04**

DESCRIPTION

(52) **U.S. Cl.**

USPC **D14/486**; D14/488

This application is related to U.S. Design patent application Ser. No. 29/524,725, filed Apr. 22, 2015; U.S. Design patent application Ser. No. 29/524,726, filed Apr. 22, 2015; U.S. Design patent application Ser. No. 29/524,728, filed Apr. 22, 2015; and U.S. Design patent application Ser. No. 29/524,730, filed Apr. 22, 2015, each of which is hereby incorporated by reference in its entirety.

(58) **Field of Classification Search**

USPC ... D14/138 R, 144, 341, 344, 358, 388, 218, D14/485-495; D10/30-39, 70, 98; D11/3, 4, 26, 93-94, 78.1, 79, 86; D24/167, 169, 186-187, 164
CPC A41D 1/002; A41D 19/0034; G06F 1/04; G06F 1/08; G06F 1/10; G06F 1/14; G06F 1/1626; G06F 1/1628; G06F 1/163; G06F 1/1635; G06F 1/3203; G06Q 20/10; G06Q 20/12; G06Q 20/108; G06Q 20/145; H04B 1/3833; H04B 1/385; H04B 1/3888; H04M 1/02; H04M 1/03;

FIG. 1 is a front view of the first image of a display screen or portion thereof with an animated graphical user interface; FIG. 2 is a front view of the second image; FIG. 3 is a front view of the third image; FIG. 4 is a front view of the fourth image; and, FIG. 5 is a front view of the fifth image.

The broken lines illustrate the display screen, portions of the animated graphical user interface, and portions of an electronic device. None of the broken lines form part of the claimed design.

The appearance of the image transitions sequentially between the images shown in FIGS. 1-5. The process or

(Continued)

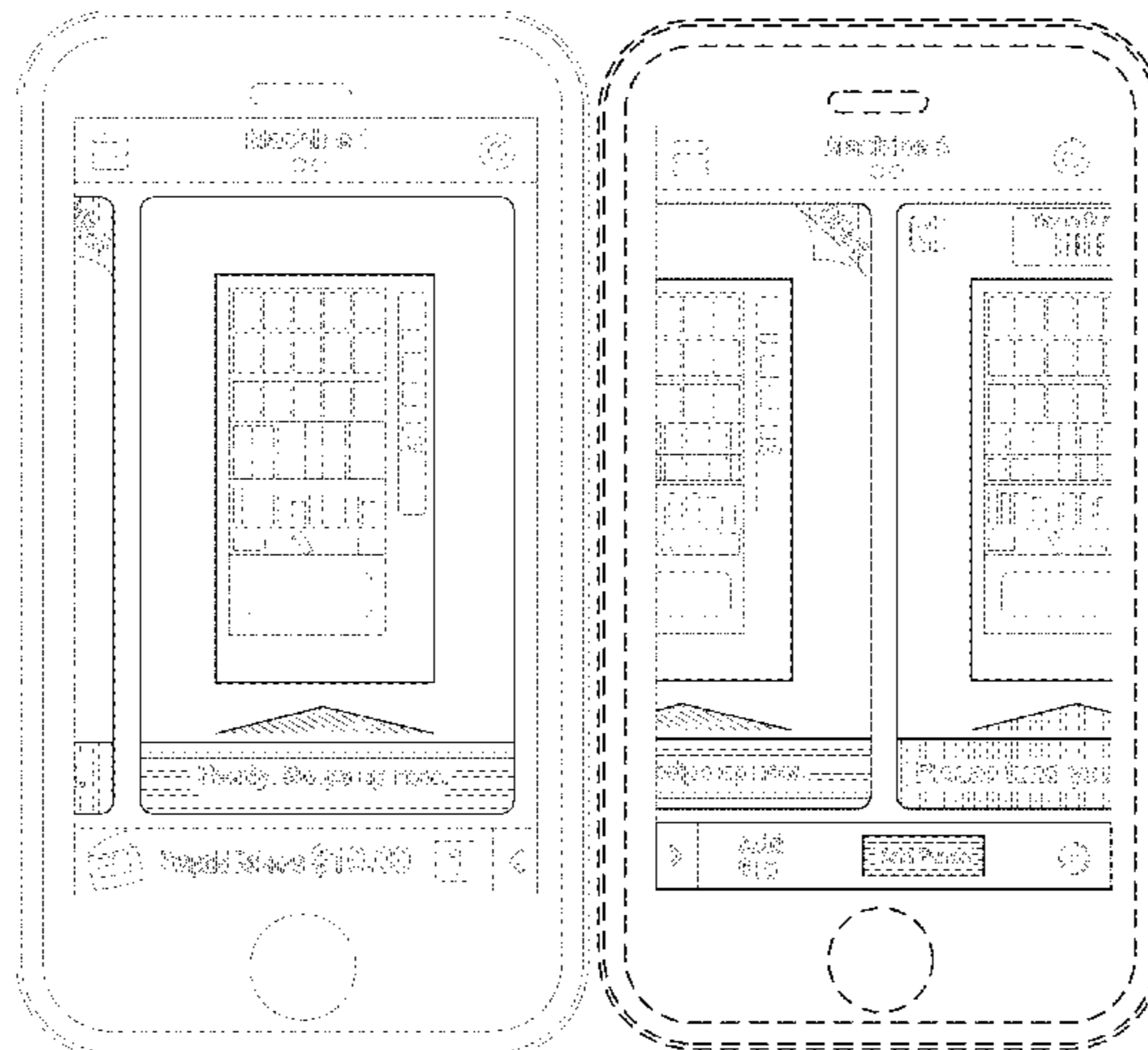

period in which an image transitions to another image forms
no part of the claimed design.

1 Claim, 3 Drawing Sheets

(56)

References Cited

U.S. PATENT DOCUMENTS

D649,154	S	*	11/2011	Vance	D14/486
D706,810	S	*	6/2014	Jones	D14/488
D730,403	S	*	5/2015	Farmer	D14/493
D735,219	S	*	7/2015	Young-Ri	G06F 3/04817
						D14/486
D746,866	S	*	1/2016	Memoria	D14/492
D754,744	S	*	4/2016	Tijssen	D14/493
9,395,888	B2	*	7/2016	Shiplacoff	G06F 3/0486
D763,888	S	*	8/2016	Patel	D14/486
D763,905	S	*	8/2016	Patel	D14/488
D764,532	S	*	8/2016	Patel	D14/488
D765,101	S	*	8/2016	Park	D14/485
9,483,763	B2	*	11/2016	Van Os	G06Q 20/3224
D773,508	S	*	12/2016	Patel	D14/486
D795,287	S	*	8/2017	Sun	D14/488
D806,741	S	*	1/2018	Majernik	D14/488
D808,425	S	*	1/2018	Park	D14/492
D808,998	S	*	1/2018	Wu	D14/486
D809,540	S	*	2/2018	Vedrody	D14/486
D816,701	S	*	5/2018	Ball	D14/486
2014/0067542	A1	*	3/2014	Everingham	G06Q 30/0623
						705/14.64

* cited by examiner

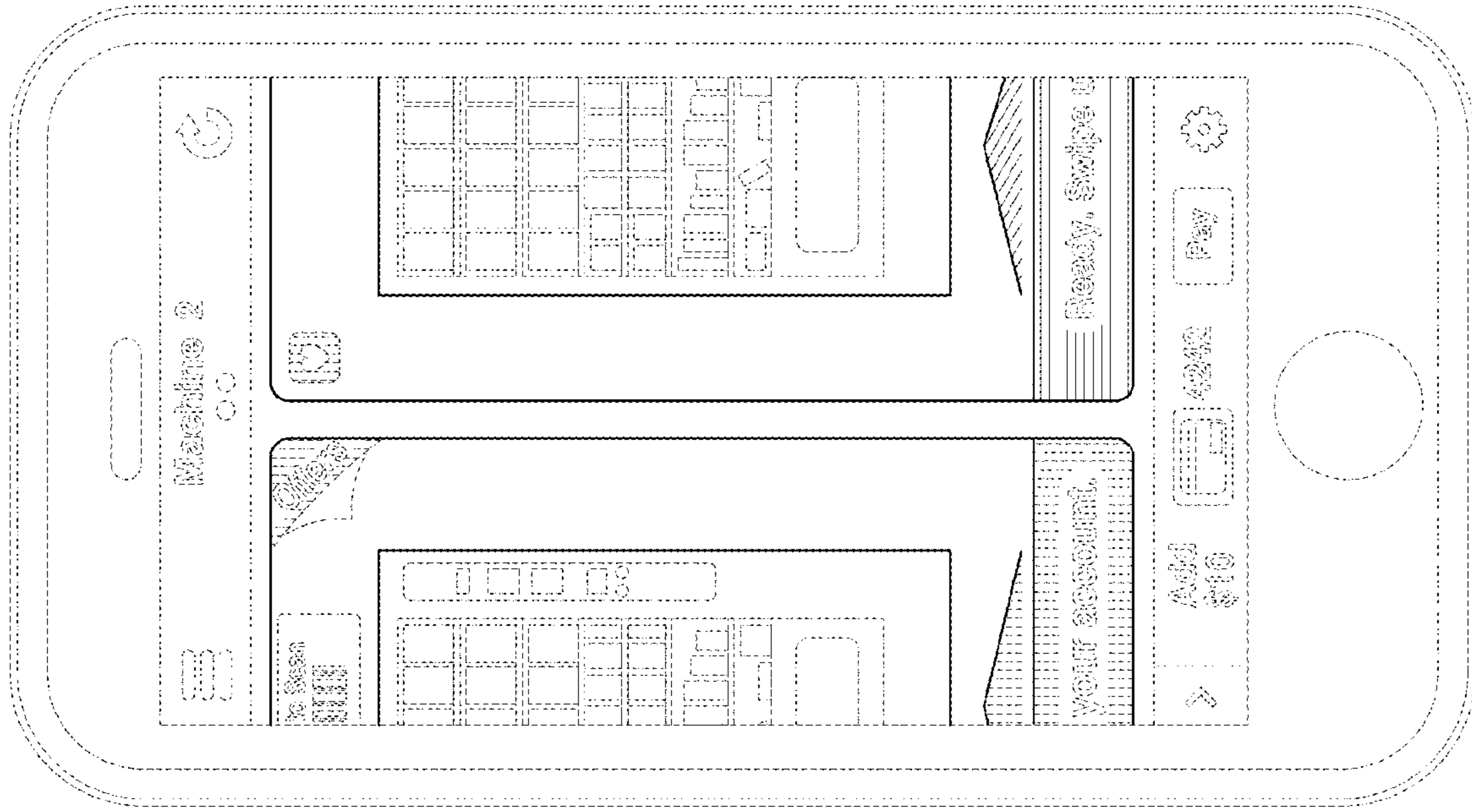

FIG. 1

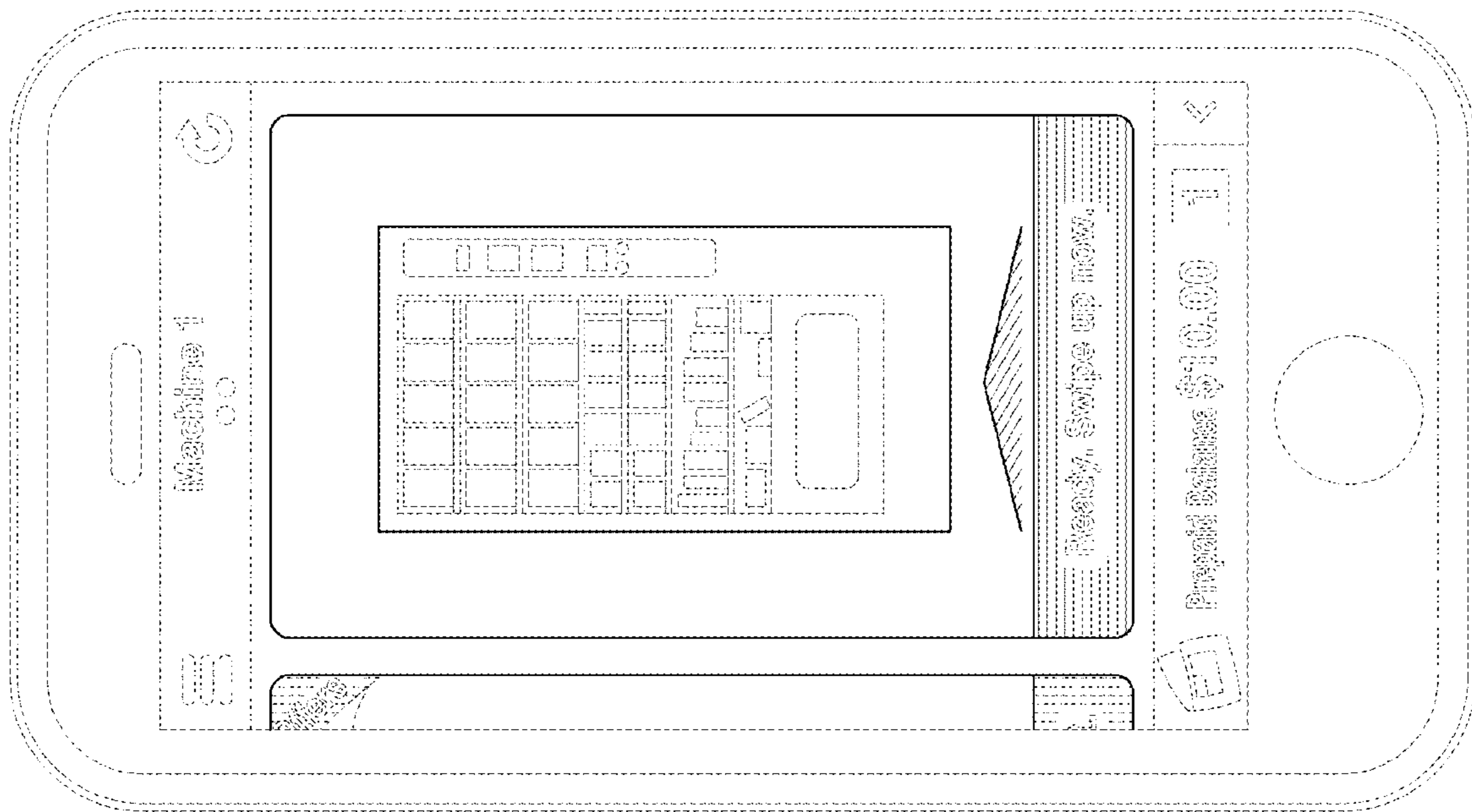

FIG. 2

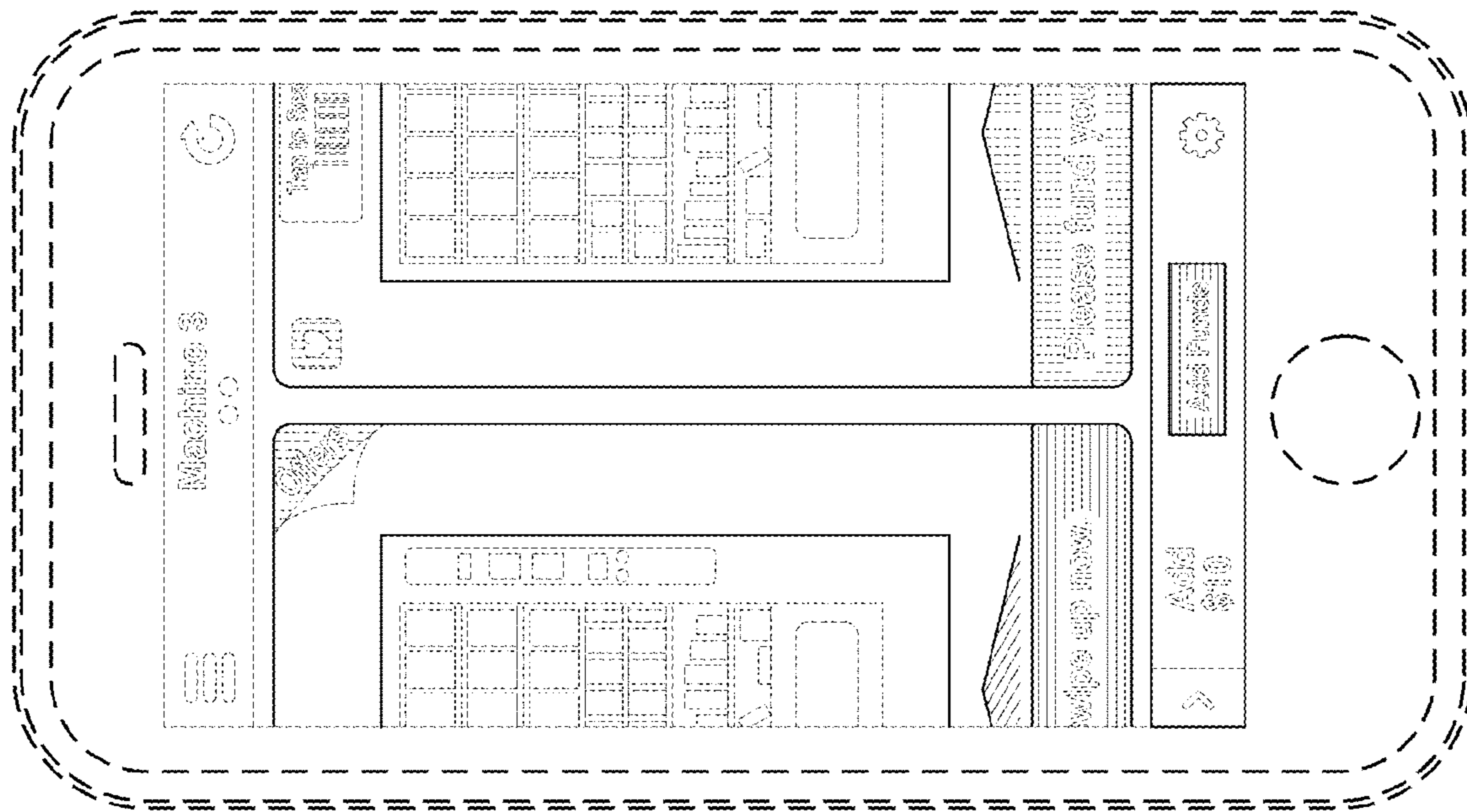

FIG. 4

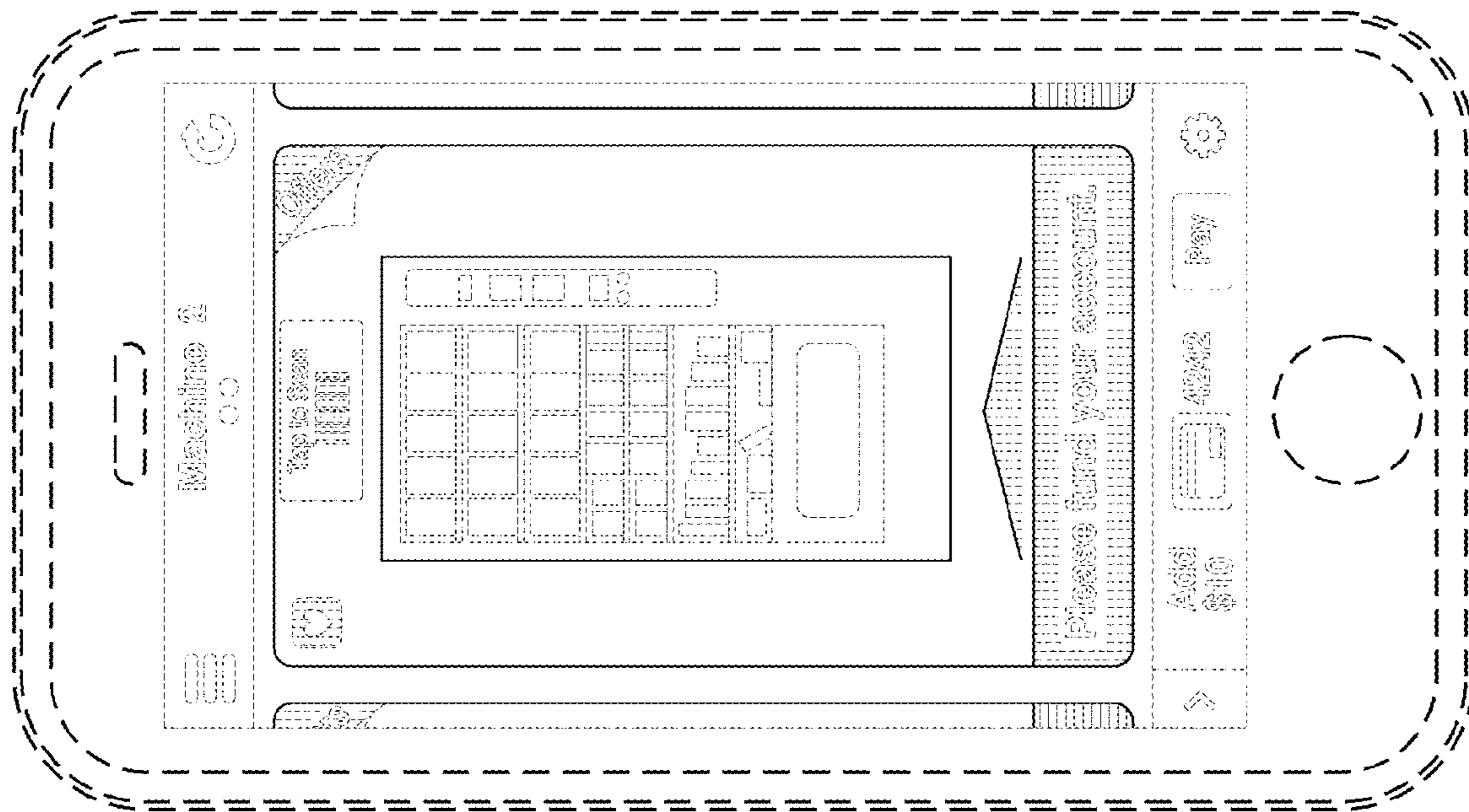

FIG. 3

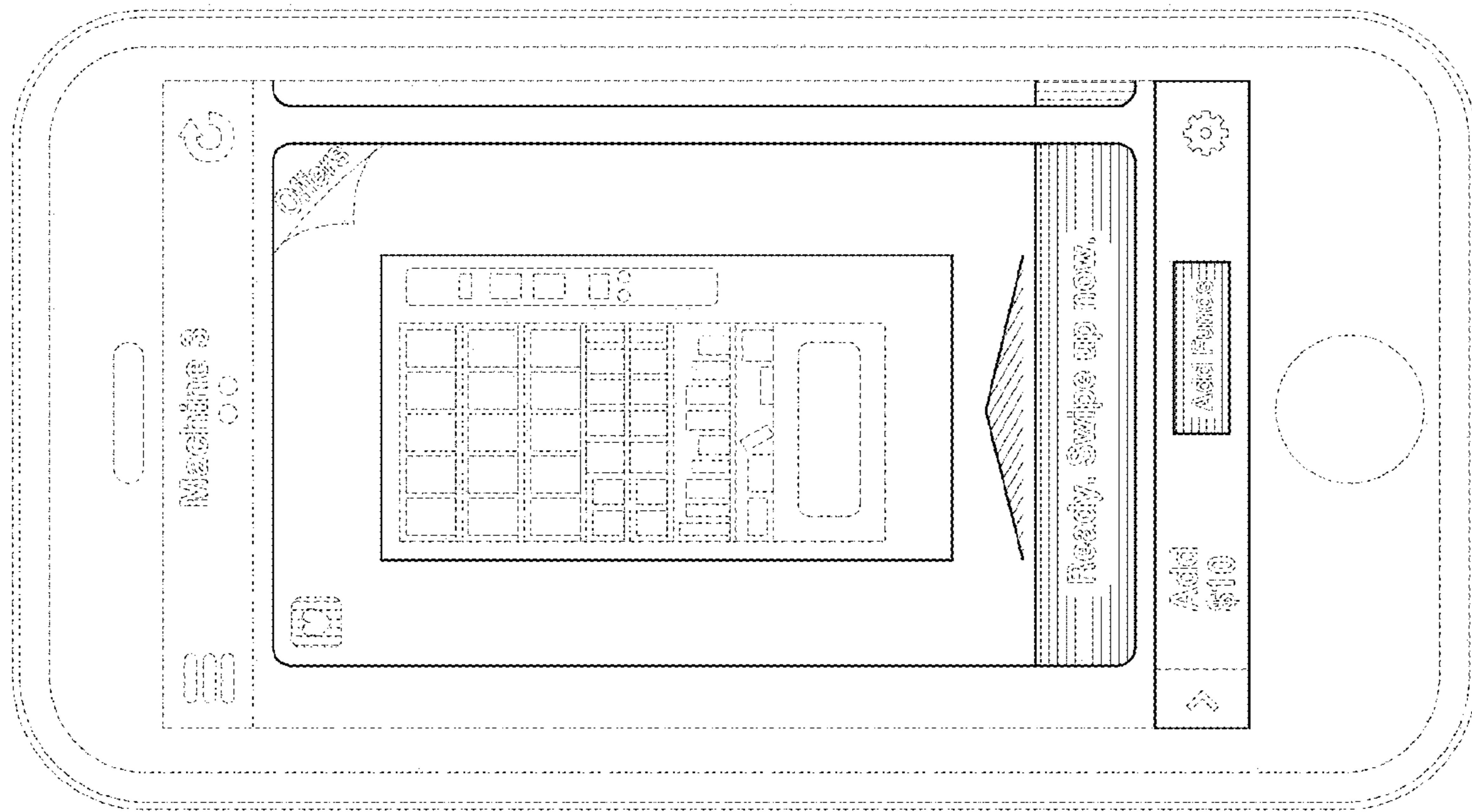

FIG. 5