



US00D927573S

(12) **United States Design Patent**
Kim et al.

(10) **Patent No.:** **US D927,573 S**

(45) **Date of Patent:** **** Aug. 10, 2021**

(54) CUTTING INSERT	5,145,295 A *	9/1992	Satran	B23C 5/2213 407/113
(71) Applicant: Korloy Inc. , Seoul (KR)	5,207,538 A *	5/1993	Satran	B23C 5/2213 407/113
(72) Inventors: Young Heum Kim , Cheongju-si (KR); Hyo San Kim , Cheongju-si (KR); Min Seok Oh , Cheongju-si (KR); Nam Seon Lee , Cheongju-si (KR); Ki Chan Nam , Cheongju-si (KR)	D342,269 S *	12/1993	Arai	D15/139
	D344,276 S *	2/1994	Markusson	D15/139
	D345,984 S *	4/1994	Ishikawa	D15/139
	D345,985 S *	4/1994	Ishikawa	D15/139
	D355,661 S *	2/1995	Hessman	D15/139
	D357,692 S *	4/1995	Ishikawa	D15/139
	D376,158 S *	12/1996	Hessman	D15/139
	D381,026 S *	7/1997	Hessman	D15/139
(**) Term: 15 Years	D409,633 S *	5/1999	Bernadic	D15/139
(21) Appl. No.: 35/509,191	D422,608 S *	4/2000	Malaker	D15/139
(22) Filed: Jan. 20, 2020	D425,086 S *	5/2000	Bernadic	D15/139
	D488,175 S *	4/2004	Kasperik	D15/139
(80) Hague Agreement Data	7,168,512 B2 *	1/2007	Schuffenhauer	B23C 5/207 175/426
Int. Filing Date: Jan. 20, 2020	D585,467 S *	1/2009	Takanashi	D15/139
Int. Reg. No.: DM/207209	D589,542 S *	3/2009	Takanashi	D15/139
Int. Reg. Date: Jan. 20, 2020	D805,566 S *	12/2017	Oh	D15/139
Int. Reg. Pub. Date: Apr. 24, 2020	D816,133 S *	4/2018	Mura	D15/139
	D816,134 S *	4/2018	Mura	D15/139
	D826,664 S *	8/2018	Matsubara	D8/20
	D828,414 S *	9/2018	Takahashi	D15/139

(Continued)

(30) **Foreign Application Priority Data**

Sep. 18, 2019 (KR) 30-2019-0044789

(51) **LOC (13) Cl.** **15-09**

(52) **U.S. Cl.**
USPC **D15/139**
CPC **B23C 5/207** (2013.01)

(58) **Field of Classification Search**
USPC D15/124-144; D8/20, 70, 90, 98;
407/59, 114; 409/139-140
CPC B23C 2200/0494; B23C 2200/086; B23C
2200/128; B23C 2200/362; B23C 5/15;
B23C 5/06; B23C 5/207; B23C 2200/367;
B23C 2200/0422; B23B 27/007; B23B
27/143; B23B 2200/321; B23B 2200/087
See application file for complete search history.

(56) **References Cited**

U.S. PATENT DOCUMENTS

D304,949 S * 12/1989 Niebauer D15/139
D305,239 S * 12/1989 Niebauer D15/139

Primary Examiner — Richard E Chilcot

(74) *Attorney, Agent, or Firm* — Rabin & Berdo, P.C.

(57) **CLAIM**

The ornamental design for a cutting insert, as shown and described.

DESCRIPTION

- 1. Cutting insert
- 1.1 : Perspective
- 1.2 : Front
- 1.3 : Back
- 1.4 : Top
- 1.5 : Bottom
- 1.6 : Left
- 1.7 : Right

1 Claim, 7 Drawing Sheets

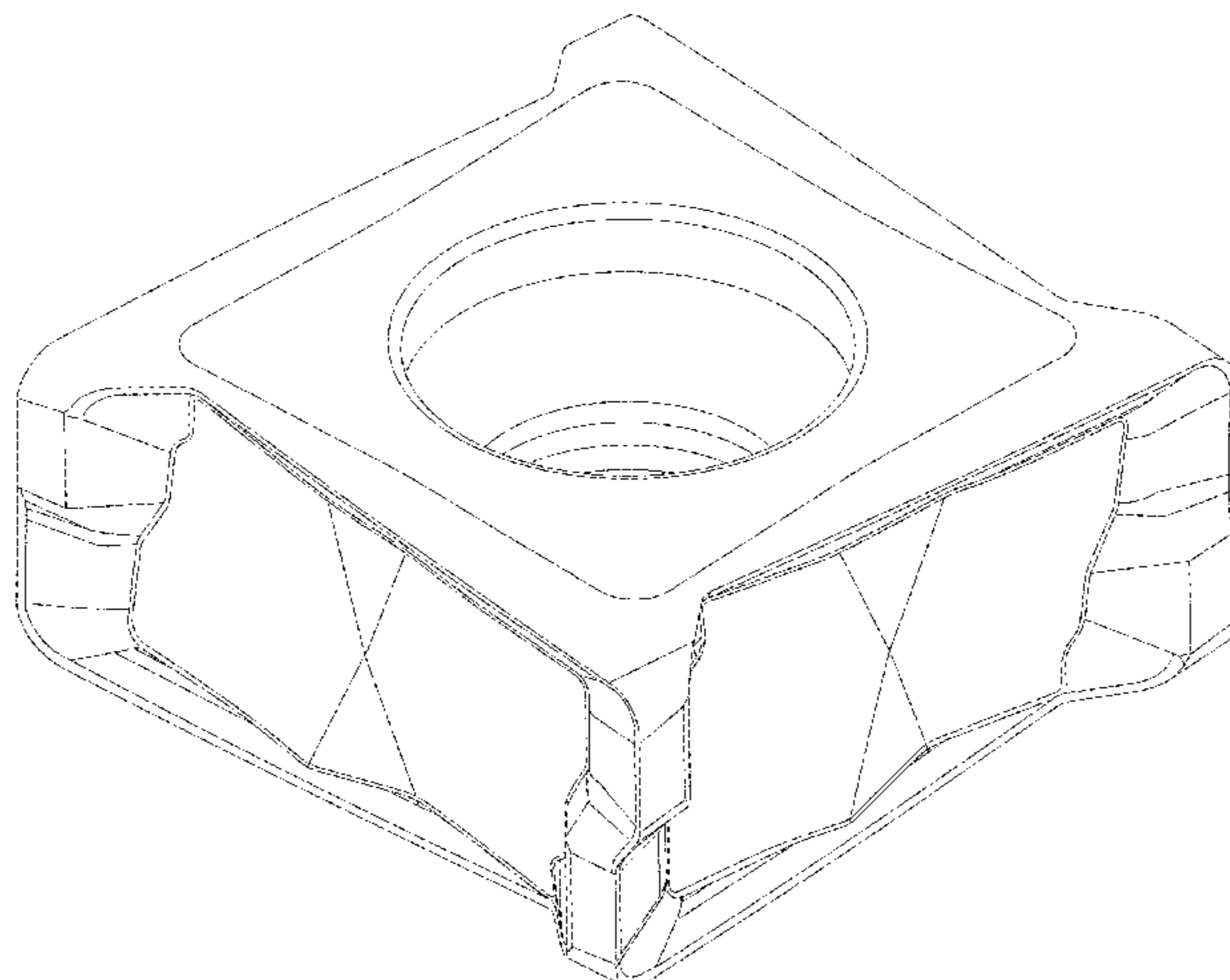

(56)

References Cited

U.S. PATENT DOCUMENTS

D853,456 S *	7/2019	Aizawa	D15/138
D872,784 S *	1/2020	Inagaki	D15/139
D879,168 S *	3/2020	Zhao	D15/139
2015/0202697 A1 *	7/2015	Shiota	B23C 5/109 407/42
2015/0246398 A1 *	9/2015	Kawasaki	B23B 27/141 408/231

* cited by examiner

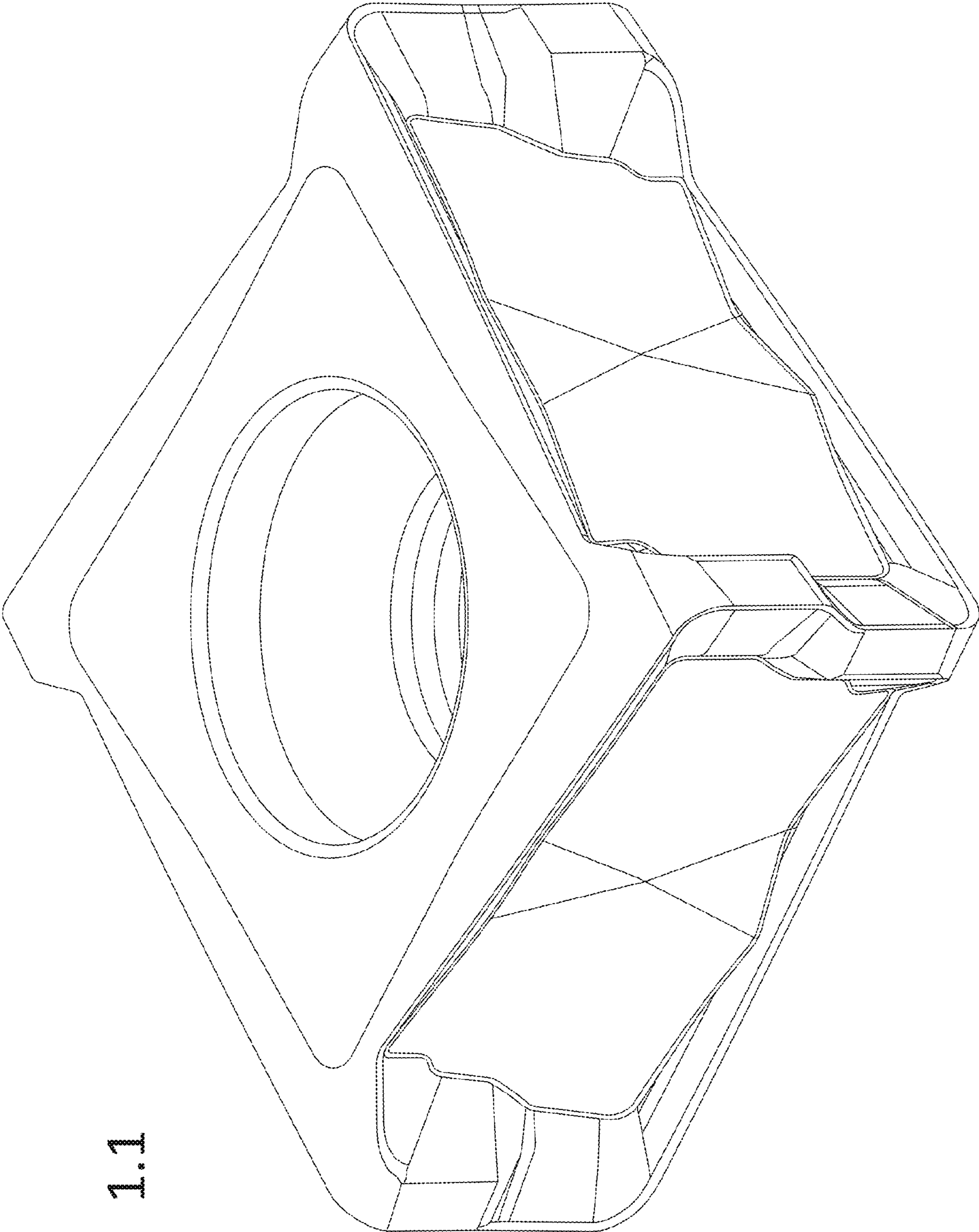

1.1

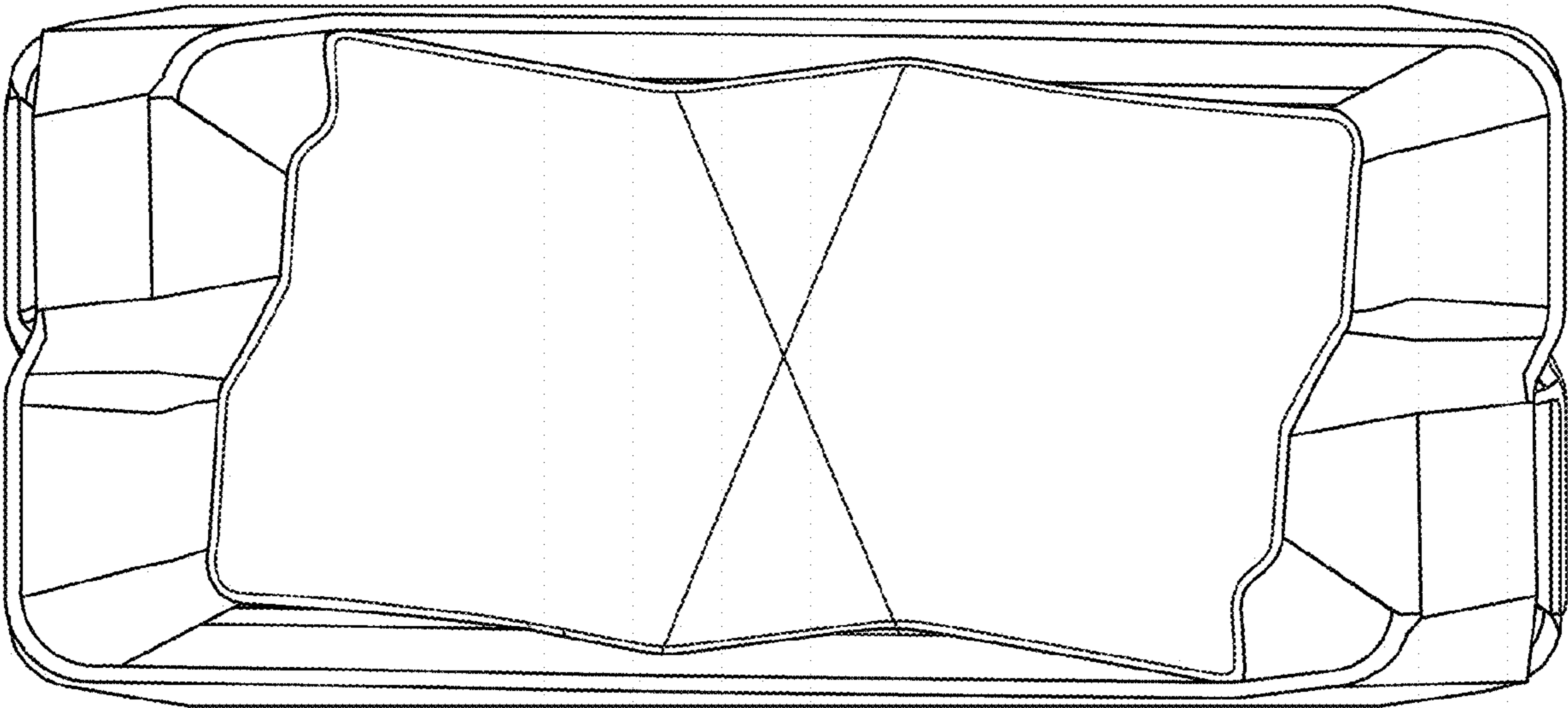

1.2

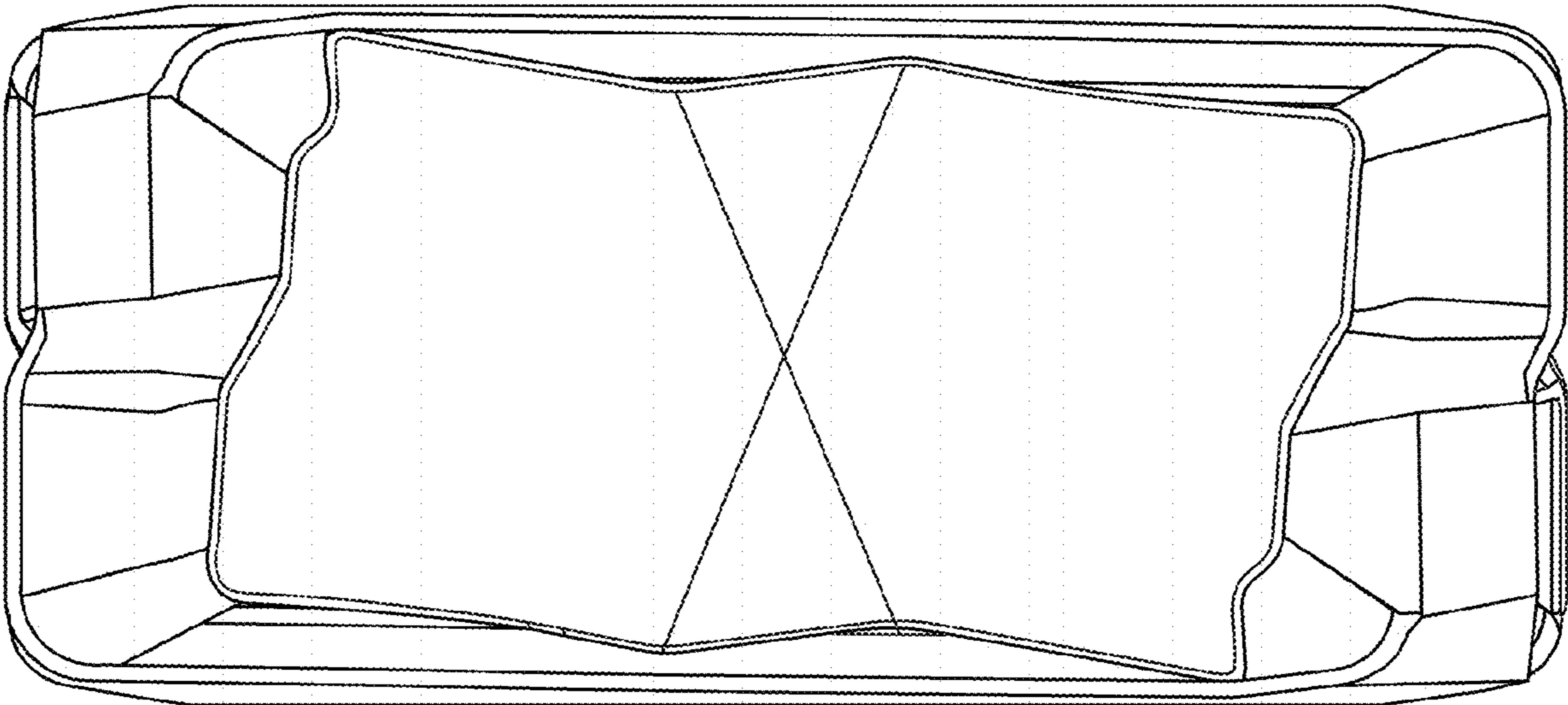

1.3

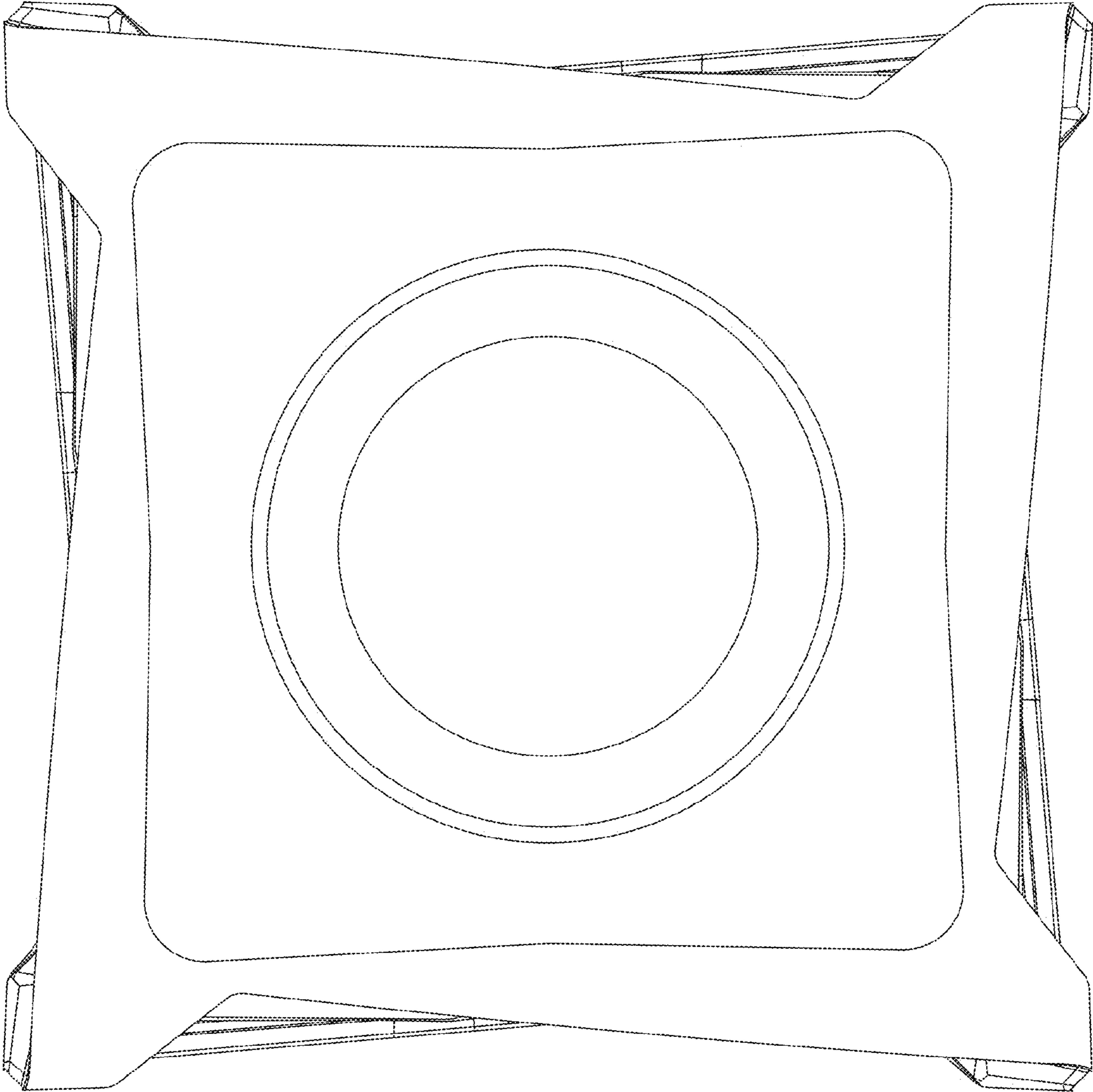

1.4

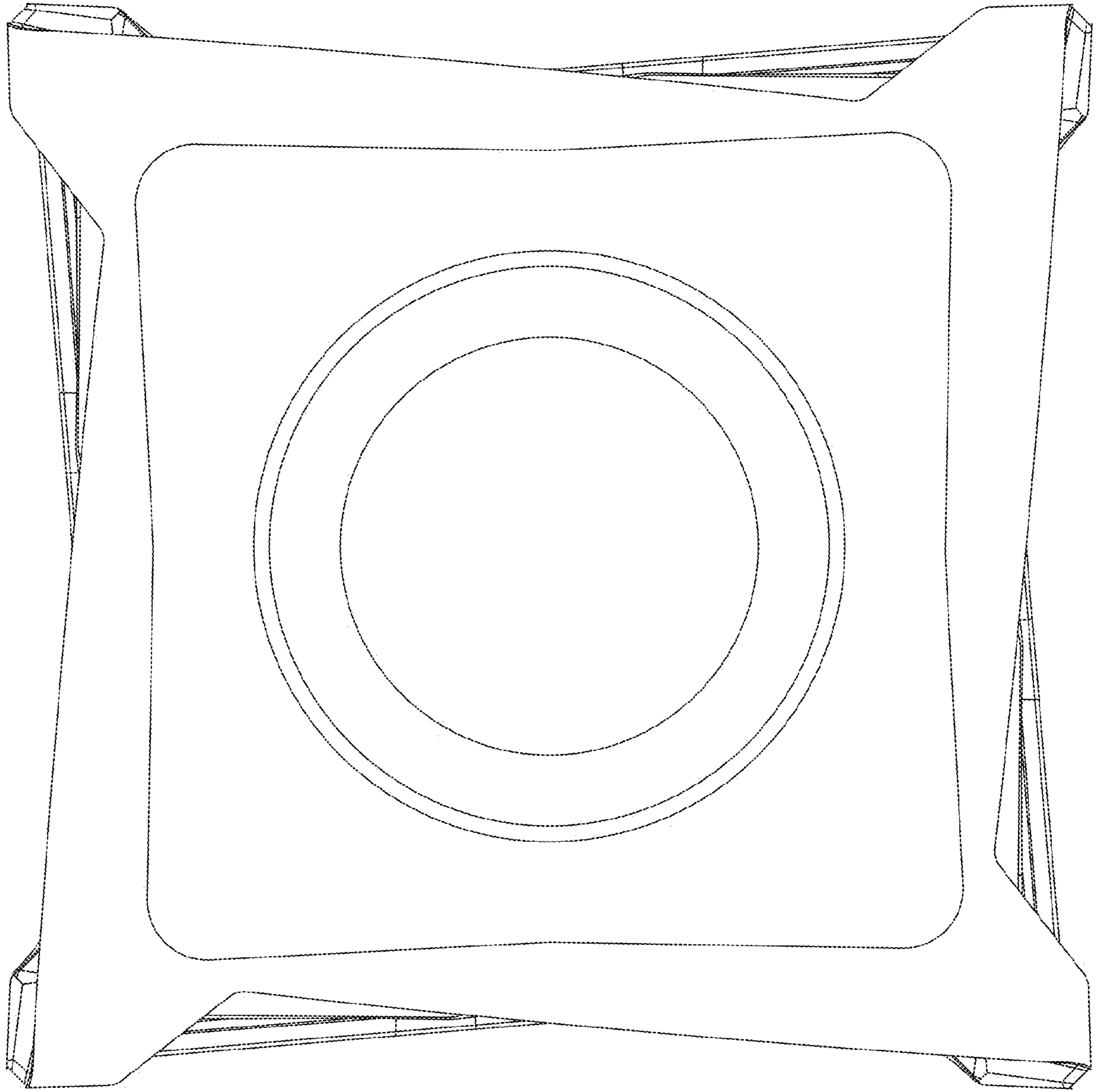

1.5

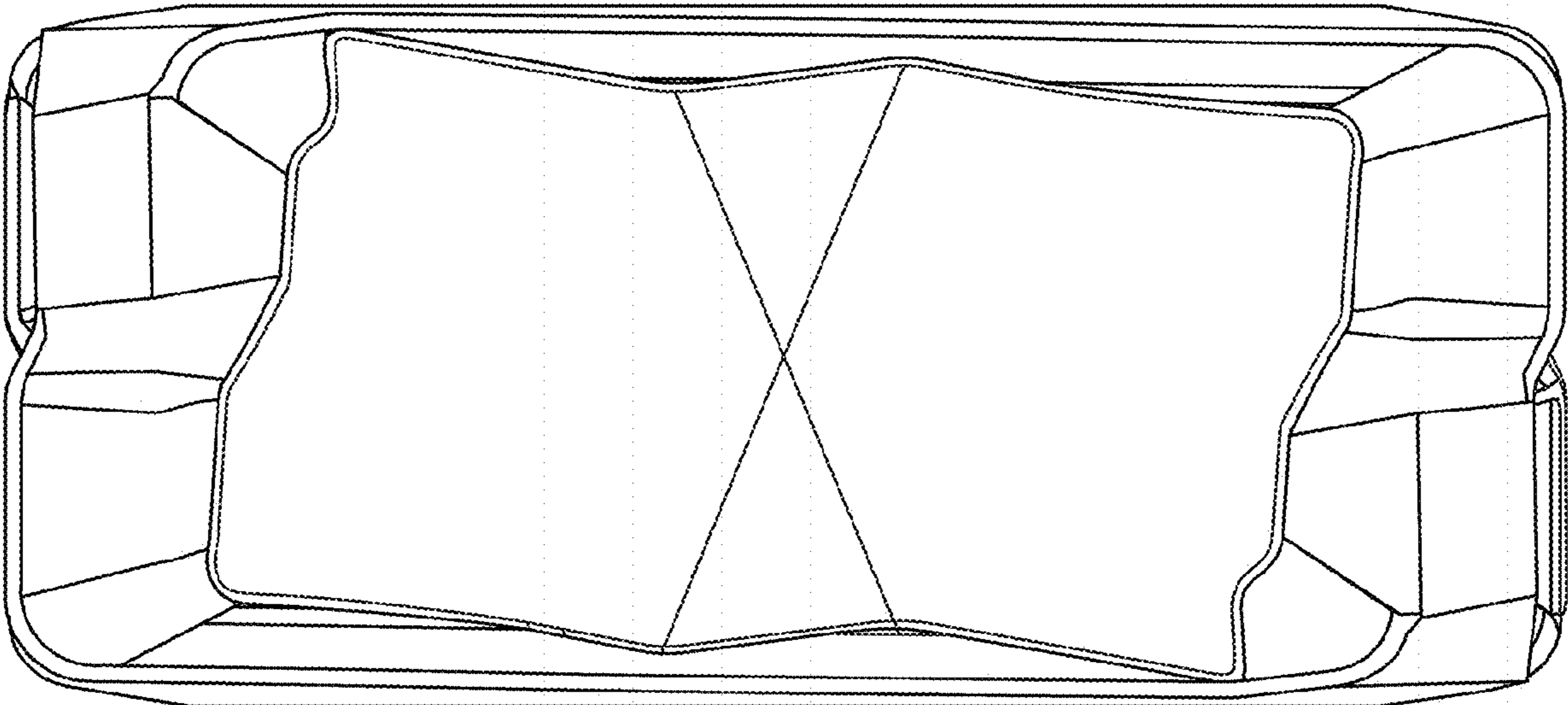

1.6

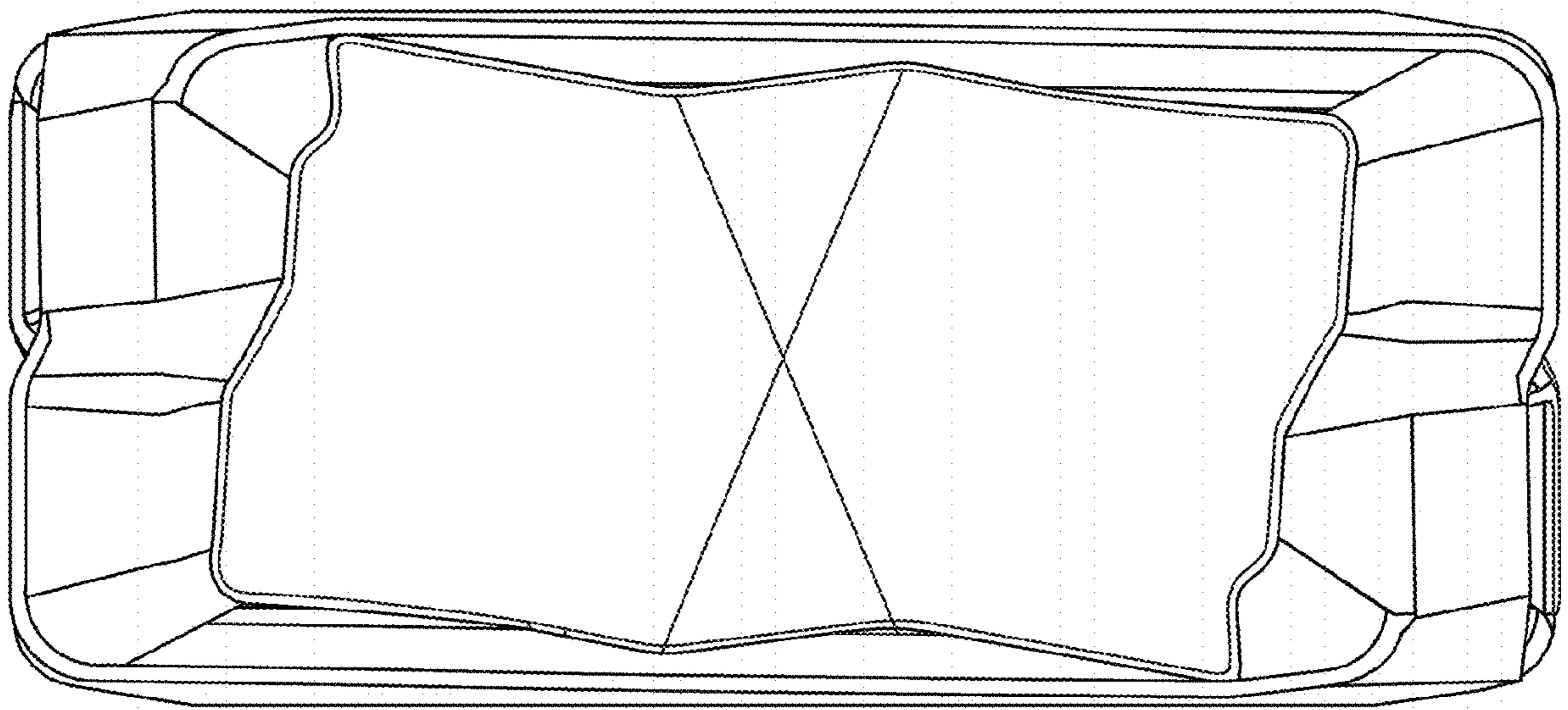

1.7