



US00D924293S

(12) **United States Design Patent**  
**Nakamura**

(10) **Patent No.:** **US D924,293 S**  
(45) **Date of Patent:** **\*\* Jul. 6, 2021**

(54) **AUTONOMOUS MOBILE ROBOT**  
(71) Applicant: **Soichiro Nakamura**, Tokyo (JP)  
(72) Inventor: **Soichiro Nakamura**, Tokyo (JP)  
(\*\*) Term: **15 Years**

D829,252 S \* 9/2018 Wang ..... D15/199  
D829,793 S \* 10/2018 Wang ..... D15/199  
D840,453 S \* 2/2019 Yoo ..... D21/451  
D841,067 S \* 2/2019 Camporesi ..... D15/199  
D851,148 S \* 6/2019 Wang ..... D12/332  
D856,389 S \* 8/2019 Gayne ..... D7/594

(Continued)

(21) Appl. No.: **29/731,768**  
(22) Filed: **Apr. 17, 2020**

**FOREIGN PATENT DOCUMENTS**

JP 2005242409 A \* 9/2005  
WO WO-2017198208 A1 \* 11/2017 ..... A47L 11/4061  
WO WO-2017198214 A1 \* 11/2017 ..... A47L 11/40

(30) **Foreign Application Priority Data**

Oct. 18, 2019 (JP) ..... 2019-023252

*Primary Examiner* — Patricia A Palasik

(74) *Attorney, Agent, or Firm* — Fitch, Even, Tabin & Flannery LLP

(51) **LOC (13) Cl.** ..... **15-09**

(52) **U.S. Cl.**  
USPC ..... **D15/199**

(57) **CLAIM**

I claim the ornamental design for an autonomous mobile robot, as shown and described.

(58) **Field of Classification Search**  
USPC ..... D15/199; D21/578–583, 621, 622;  
D32/21; D34/34

CPC ..... B25J 5/007; B25J 11/00; B25J 11/008;  
B62D 57/024; G06N 3/008; Y10S 901/01

See application file for complete search history.

**DESCRIPTION**

FIG. 1 is a front perspective view of an autonomous mobile robot, showing my new design;  
FIG. 2 is a rear perspective view thereof;  
FIG. 3 is a front elevational view thereof;  
FIG. 4 is a rear elevational view thereof;  
FIG. 5 is a top plan view thereof;  
FIG. 6 is a bottom plan view thereof;  
FIG. 7 is a right side elevational view thereof;  
FIG. 8 is a left side elevational view thereof;  
FIG. 9 is an enlarged front elevational view of the 9-9 portion of FIG. 3;  
FIG. 10 is a cross-sectional view taken along line 10-10 of FIG. 9 in which internal mechanisms are omitted; and,  
FIG. 11 is a cross-sectional view taken along line 11-11 of FIG. 9 in which internal mechanisms are omitted.  
The dashed broken lines show portions of the autonomous mobile robot that form no part of the claimed design.

(56) **References Cited**

**U.S. PATENT DOCUMENTS**

D90,840 S \* 10/1933 Ferris ..... D21/451  
D173,771 S \* 12/1954 Thieblot ..... D12/332  
D174,817 S \* 5/1955 Kenyon, II ..... D21/389  
D183,564 S \* 9/1958 Erstad ..... D7/594  
D185,870 S \* 8/1959 Apostolescu ..... D21/452  
4,149,932 A \* 4/1979 Jacobs ..... G21C 17/01  
376/249  
D438,914 S \* 3/2001 O'Rourke ..... D21/452  
D509,261 S \* 9/2005 Tebbe ..... D21/452  
D624,971 S \* 10/2010 Cohen ..... D21/452  
D635,603 S \* 4/2011 Paz Rodriguez ..... D15/199  
D722,631 S \* 2/2015 Stone ..... D15/199  
D810,167 S \* 2/2018 Yang ..... D15/199  
D813,284 S \* 3/2018 Wei ..... D15/199  
D813,285 S \* 3/2018 Wei ..... D15/199  
D829,250 S \* 9/2018 Zilbershtein ..... D15/199

**1 Claim, 11 Drawing Sheets**

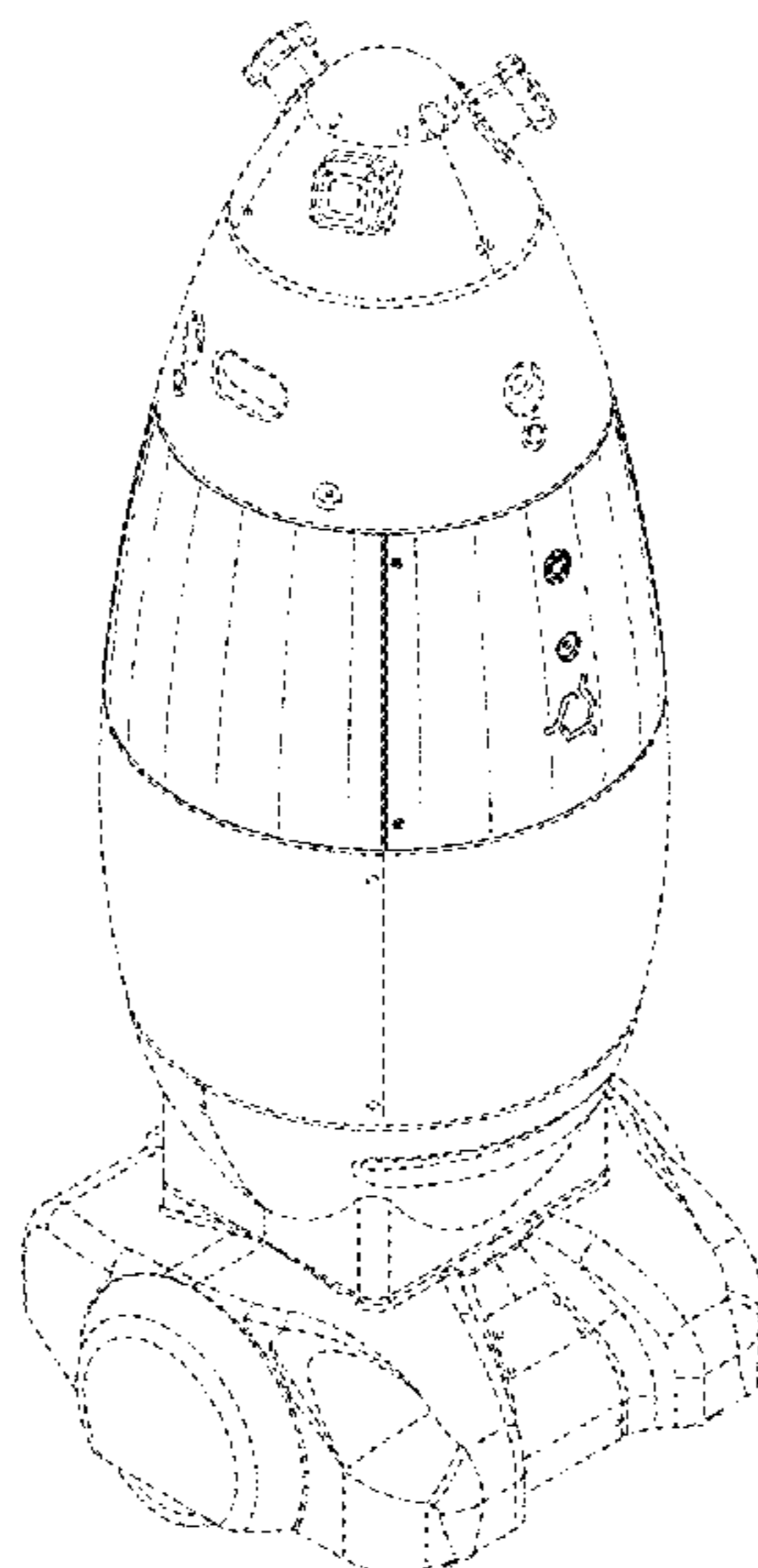

(56)

**References Cited**

U.S. PATENT DOCUMENTS

D857,074	S	*	8/2019	Kim	.....	D21/389
D862,550	S	*	10/2019	Shu	.....	D21/452
D865,021	S	*	10/2019	Hu	.....	D21/452
2017/0136631	A1	*	5/2017	Li	.....	G06N 20/00
2017/0326724	A1	*	11/2017	Wei	.....	G06F 3/0412
2018/0178375	A1	*	6/2018	Yang	.....	B25J 19/00
2020/0030963	A1	*	1/2020	Youn	.....	B25J 11/0005
						D21/452
2020/0406448	A1	*	12/2020	Luo	.....	B25J 11/008
						D21/452

\* cited by examiner

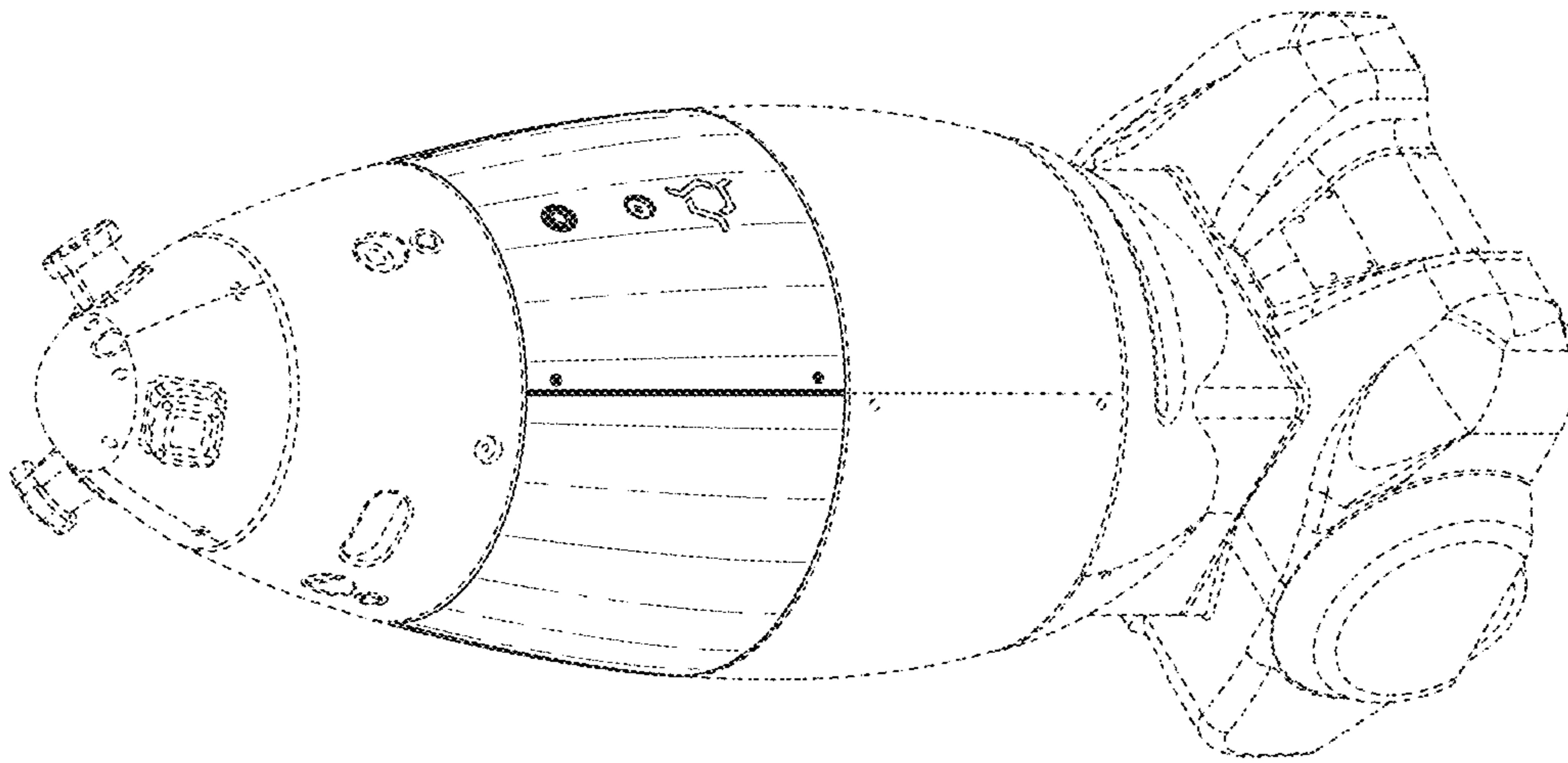

FIG.1

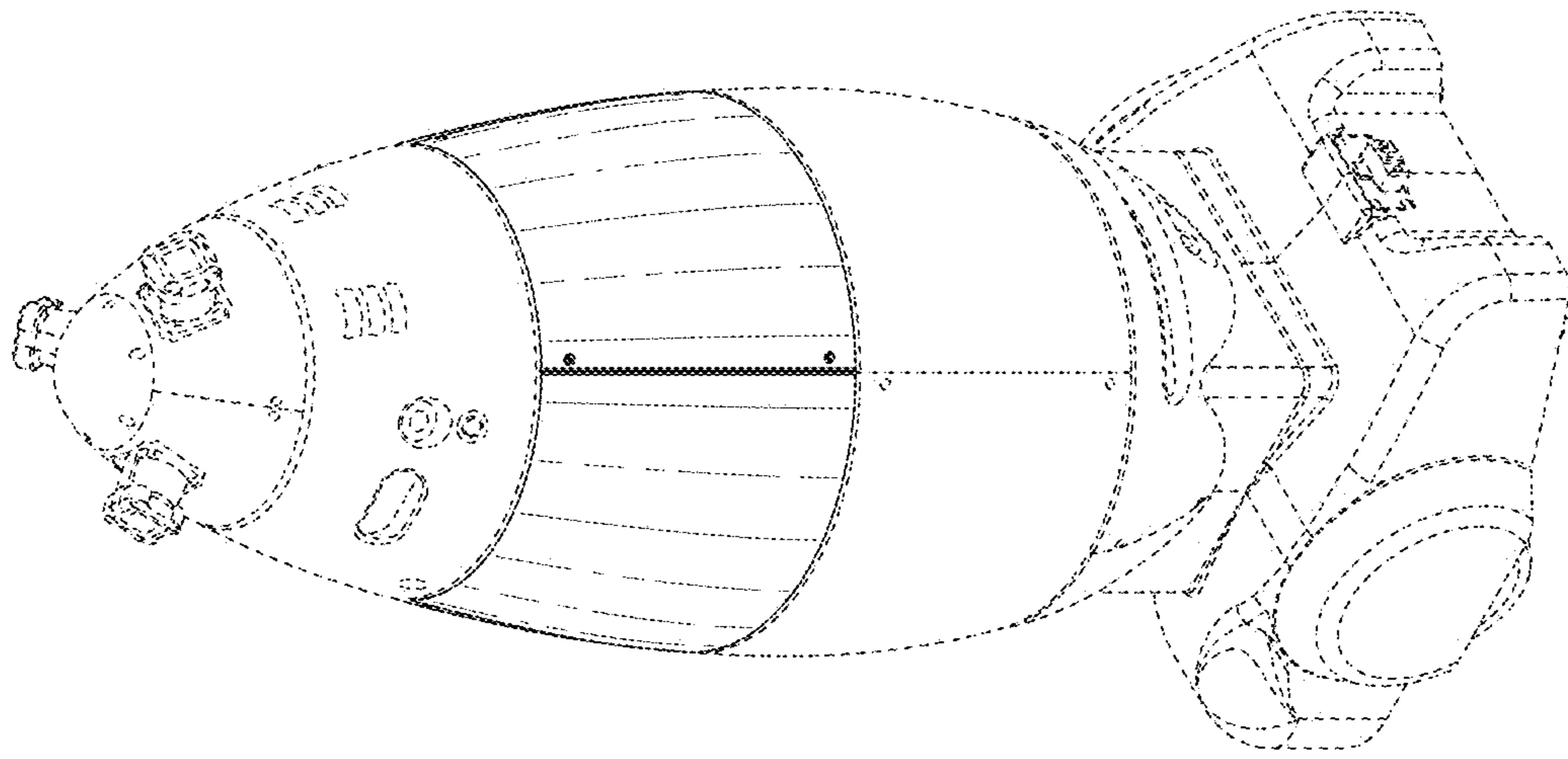

FIG.2

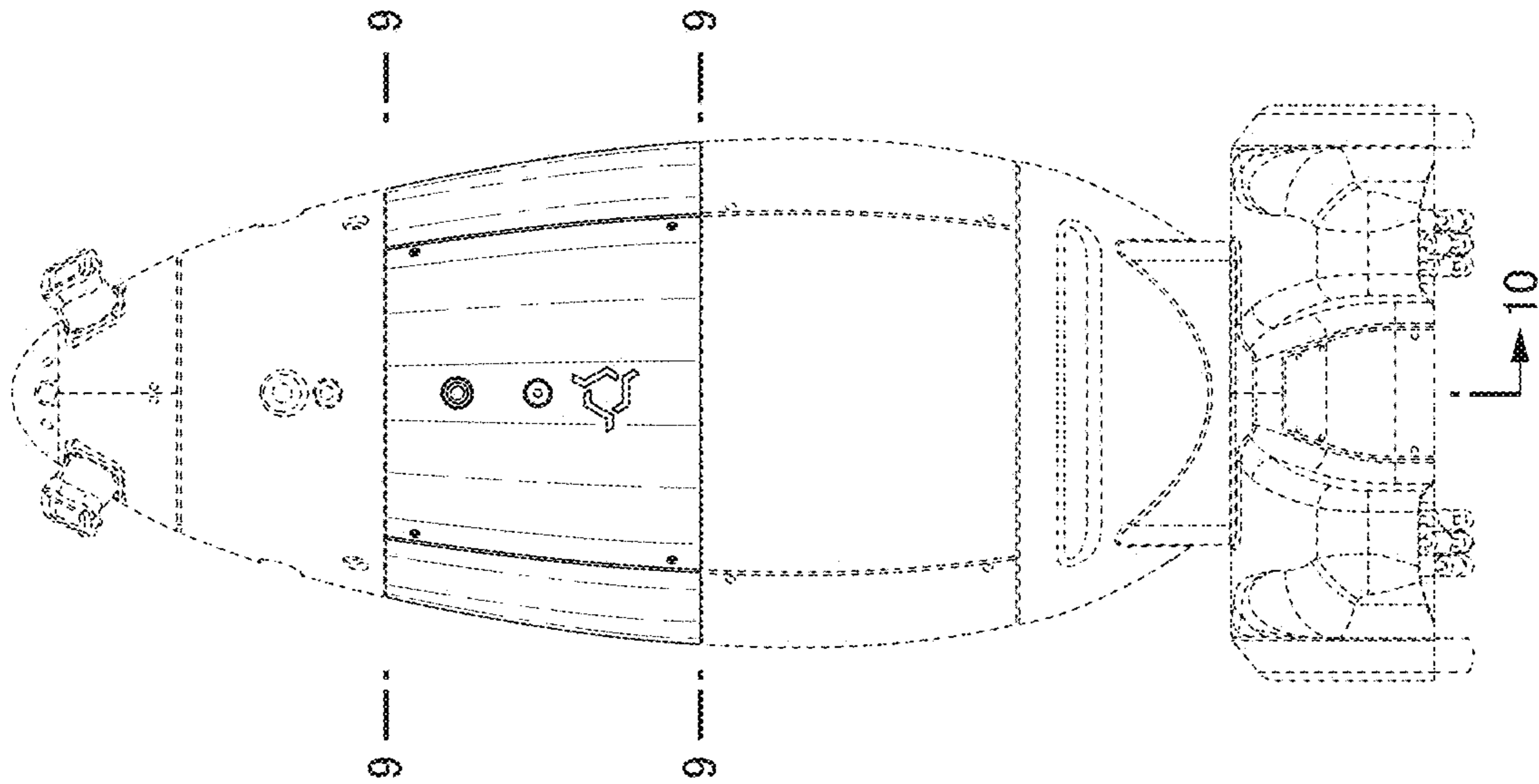

FIG.3

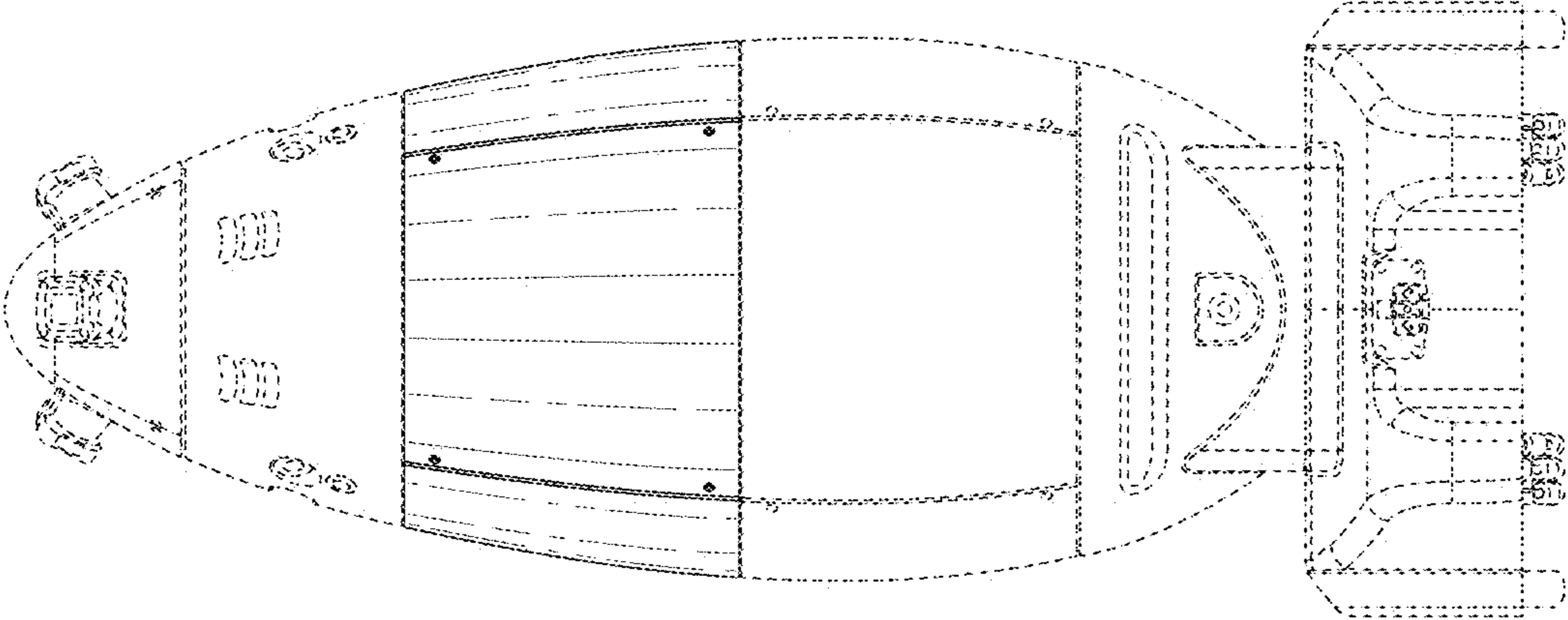

FIG.4



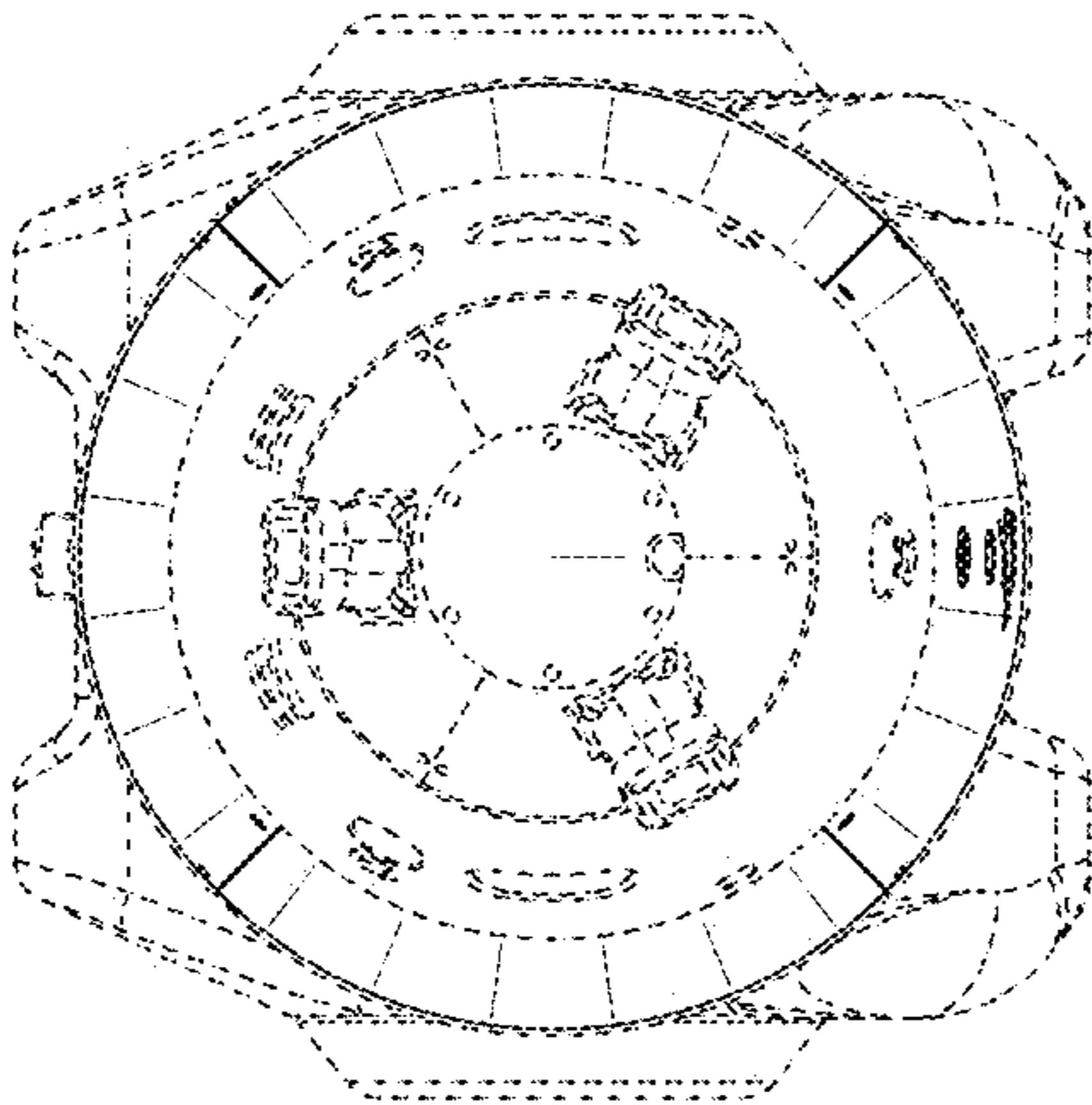

FIG.5

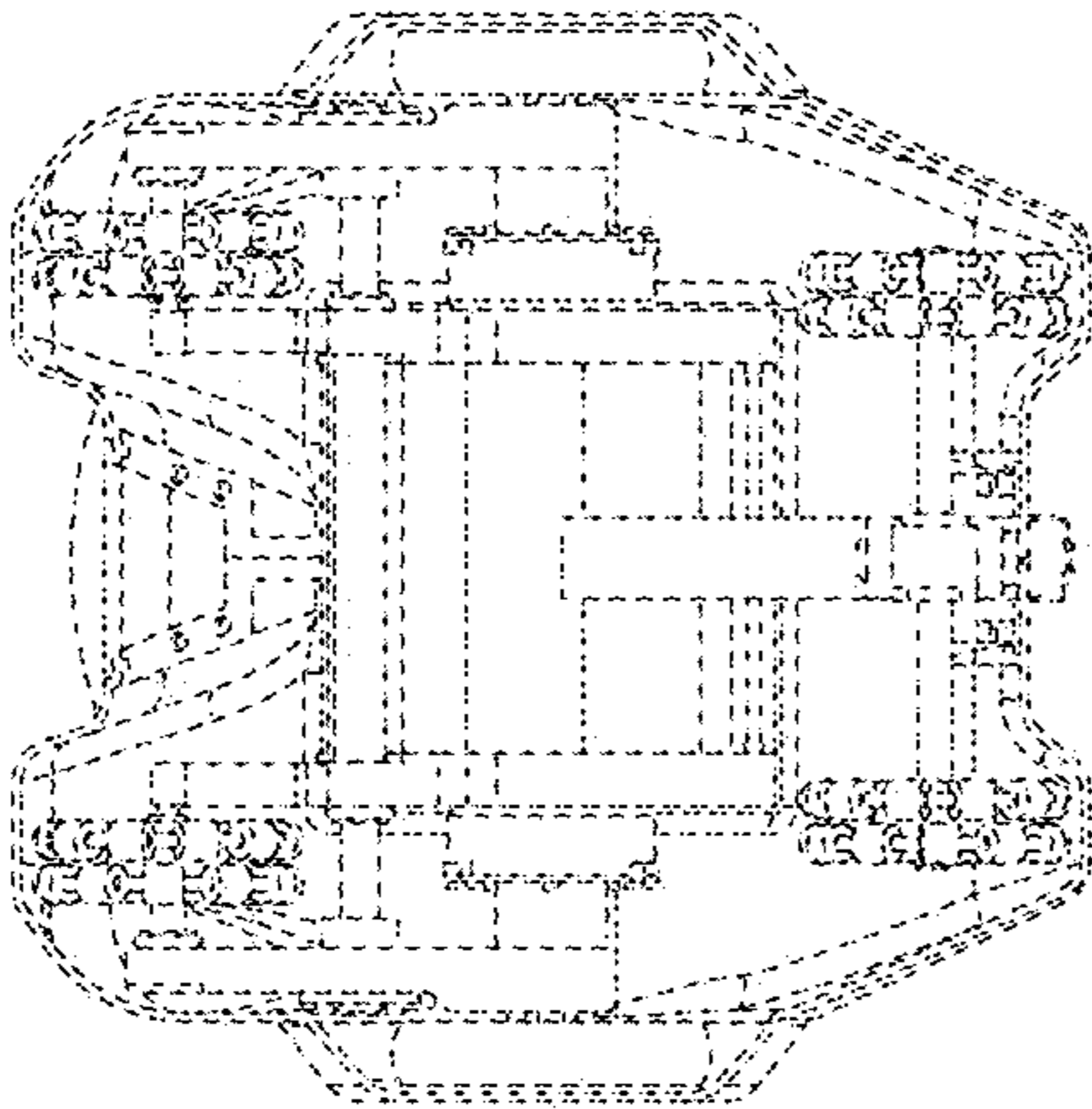

FIG.6



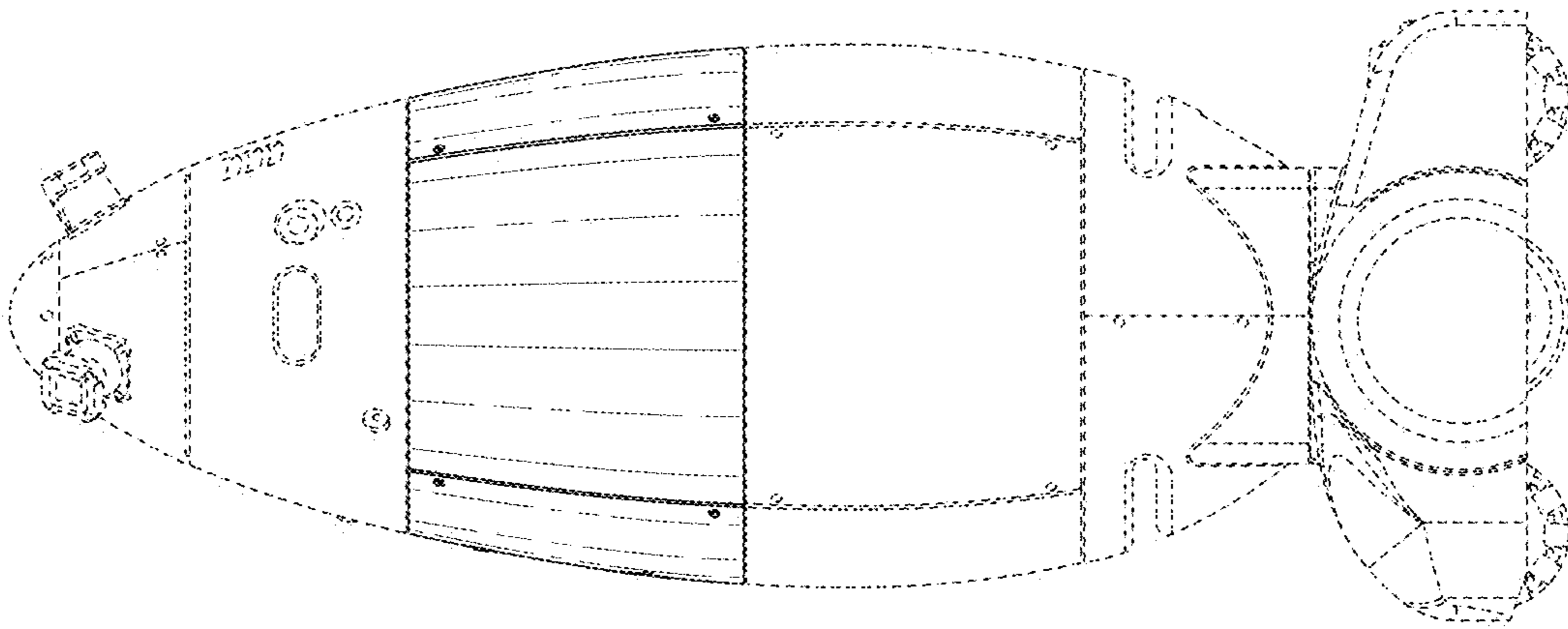

FIG.7

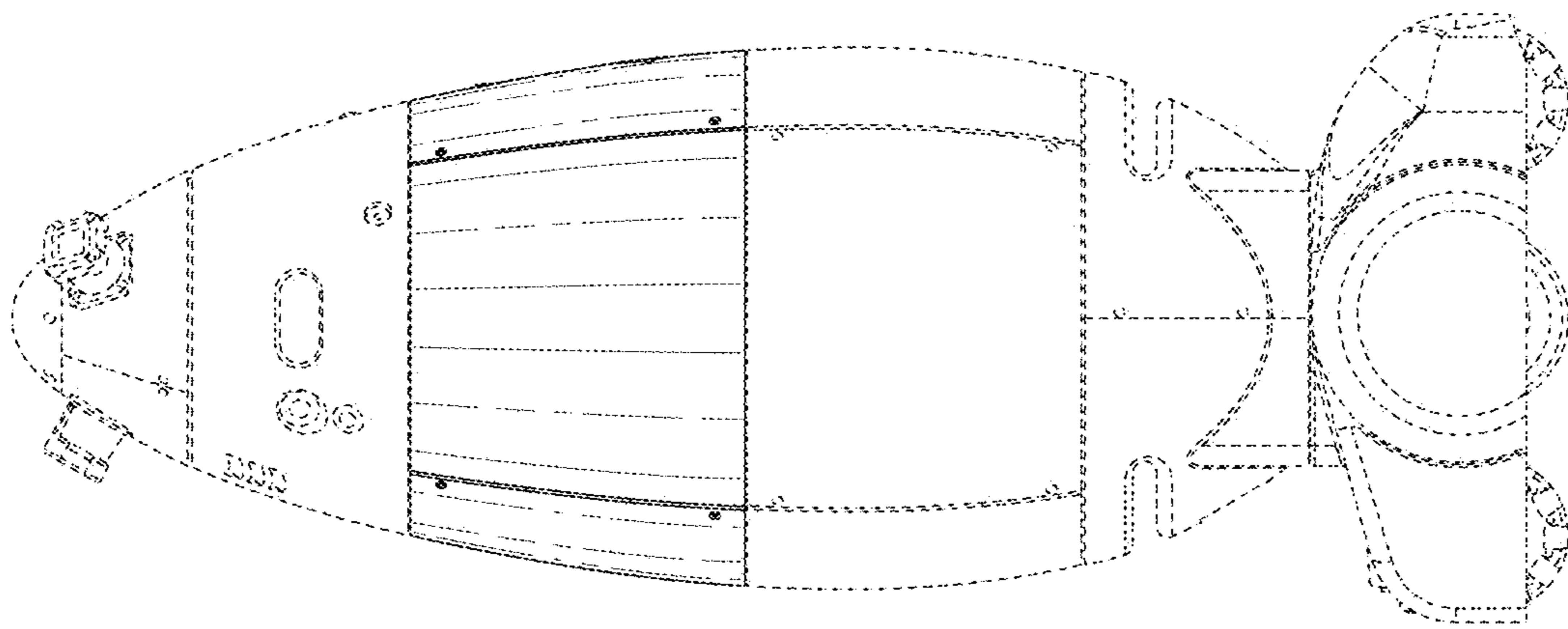

FIG.8

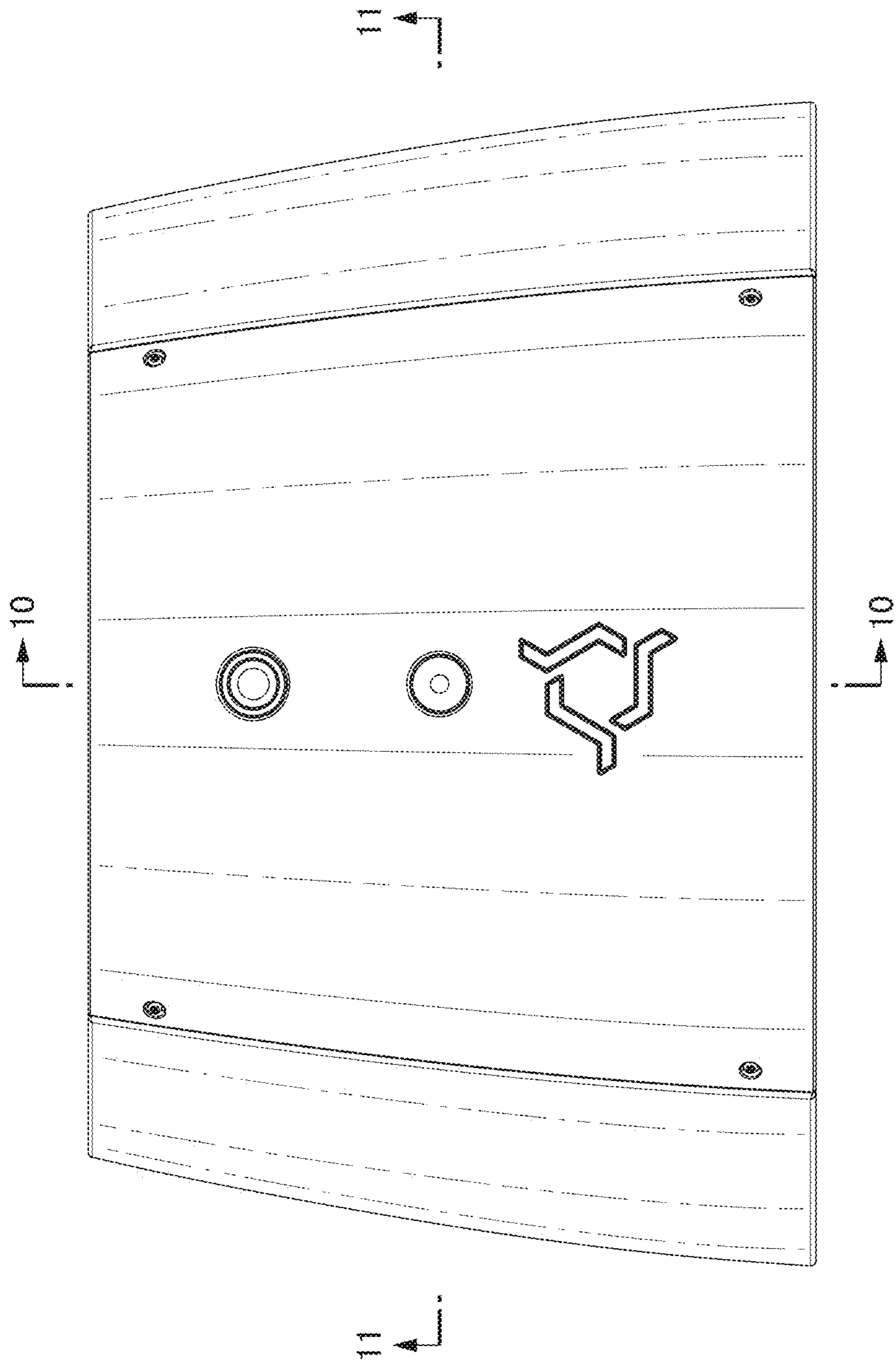

FIG.9

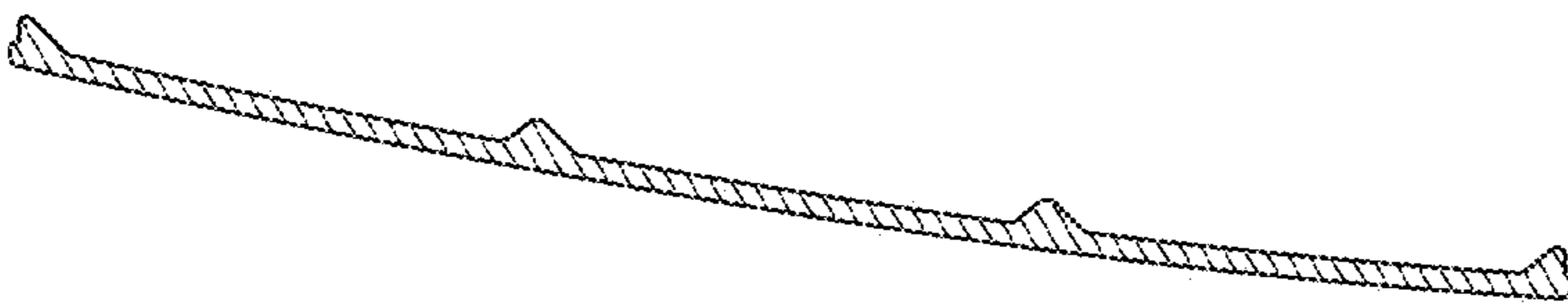
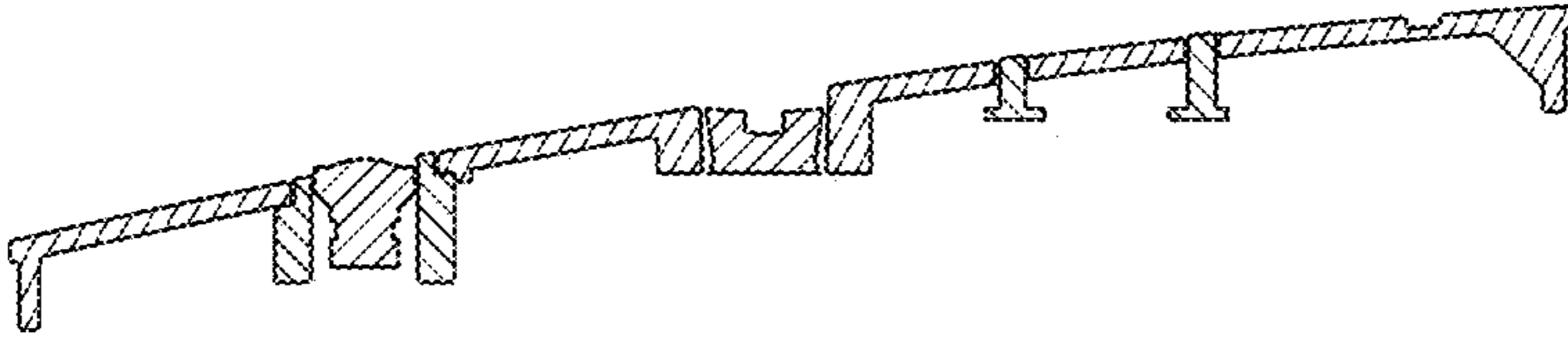

FIG.10

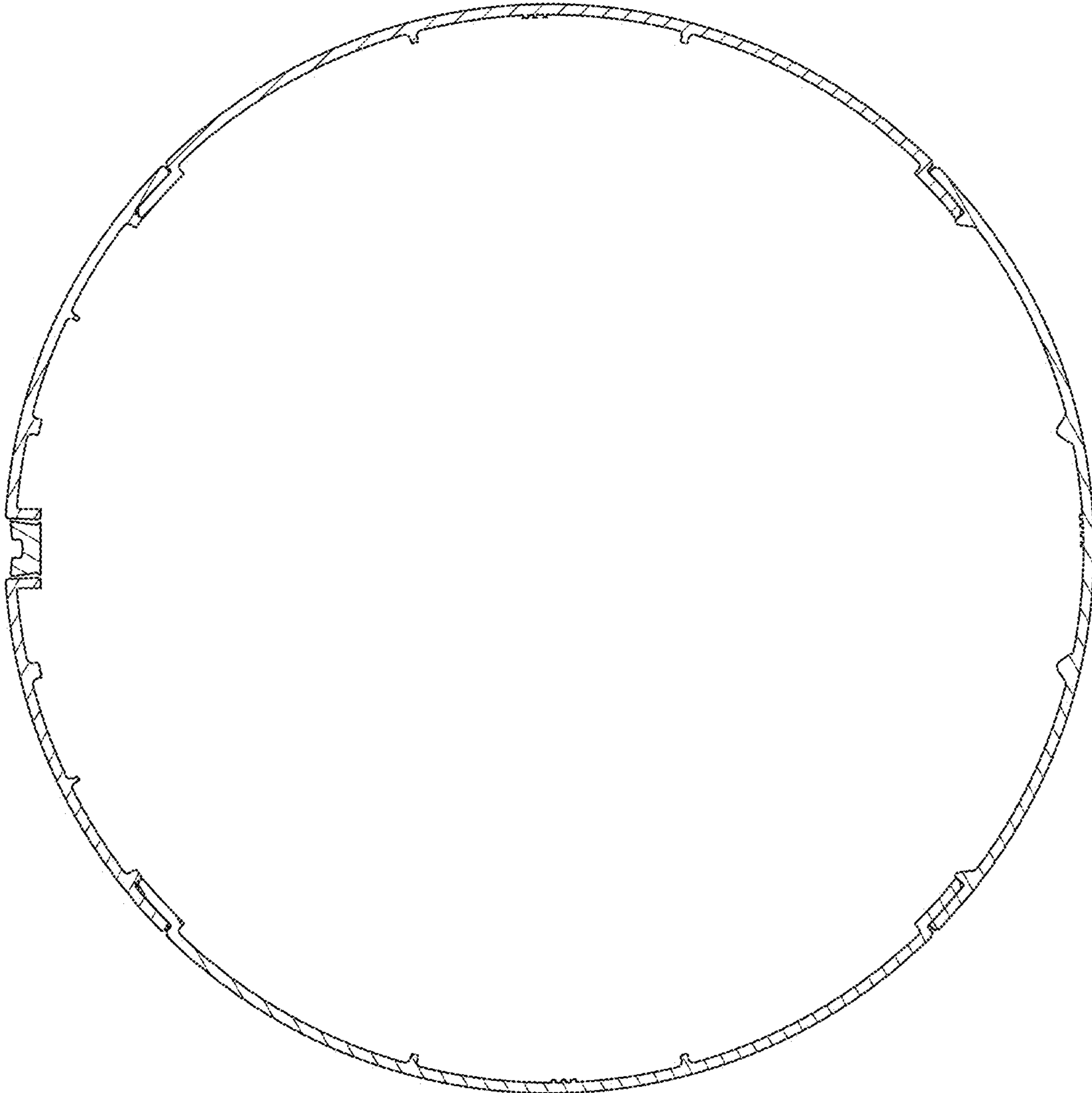

FIG.11