



US00D922524S

(12) **United States Design Patent**
Walters

(10) **Patent No.:** **US D922,524 S**
(45) **Date of Patent:** **** Jun. 15, 2021**

(54) **NOZZLE FOR SPRAYING FLUIDS**

(71) Applicant: **EXEL INDUSTRIES**, Epernay (FR)

(72) Inventor: **Georges Walters**, Birmingham (GB)

(**) Term: **15 Years**

(21) Appl. No.: **35/508,902**

(22) Filed: **Sep. 20, 2019**

(80) **Hague Agreement Data**

Int. Filing Date: **Sep. 20, 2019**

Int. Reg. No.: **DM/206607**

Int. Reg. Date: **Sep. 20, 2019**

Int. Reg. Pub. Date: **Mar. 27, 2020**

(51) **LOC (13) Cl.** **23-01**

(52) **U.S. Cl.**
USPC **D23/223**

(58) **Field of Classification Search**

USPC D23/211, 211.1, 211.2, 213, 223, 224,
D23/226, 231, 249, 255, 257, 260, 262,
D23/263, 266

CPC ... B67D 5/37; B67D 7/50; F16L 37/00; F16L
37/46; F17C 13/12; F17C 2205/0376

See application file for complete search history.

(56) **References Cited**

U.S. PATENT DOCUMENTS

D355,704 S * 2/1995 Simpson D23/223
D407,140 S * 3/1999 Heren D23/223

D417,483 S * 12/1999 Cornford D23/213
D447,539 S * 9/2001 Tse D23/226
D619,210 S * 7/2010 Jian D23/223
D684,664 S * 6/2013 Gevers D23/226
D694,360 S * 11/2013 Gaetano D23/223
D709,164 S * 7/2014 Abernethy D23/213
D726,872 S * 4/2015 Thurgood D23/223
D746,946 S * 1/2016 Naslund D23/223
D771,773 S * 11/2016 Chen D23/223
D792,945 S * 7/2017 Cheng D23/224
D824,492 S * 7/2018 Chen D23/223
D832,978 S * 11/2018 Miyawaki D23/226
D852,324 S * 6/2019 Willfort D23/226
D855,760 S * 8/2019 Lee D23/223

* cited by examiner

Primary Examiner — Natasha Vujcic

(57) **CLAIM**

The ornamental design for nozzle for spraying fluids, as shown and described.

DESCRIPTION

- 1. Nozzle for spraying fluids
- 1.1 is a bottom view.
- 1.2 is a right side view.
- 1.3 is a right side perspective view.
- 1.4 is a front view.
- 1.5 is a rear view.
- 1.6 is a top view.
- 1.7 is a left side view.
- 1.8 is a rear perspective view
- 1.9 is a top perspective view.

1 Claim, 9 Drawing Sheets

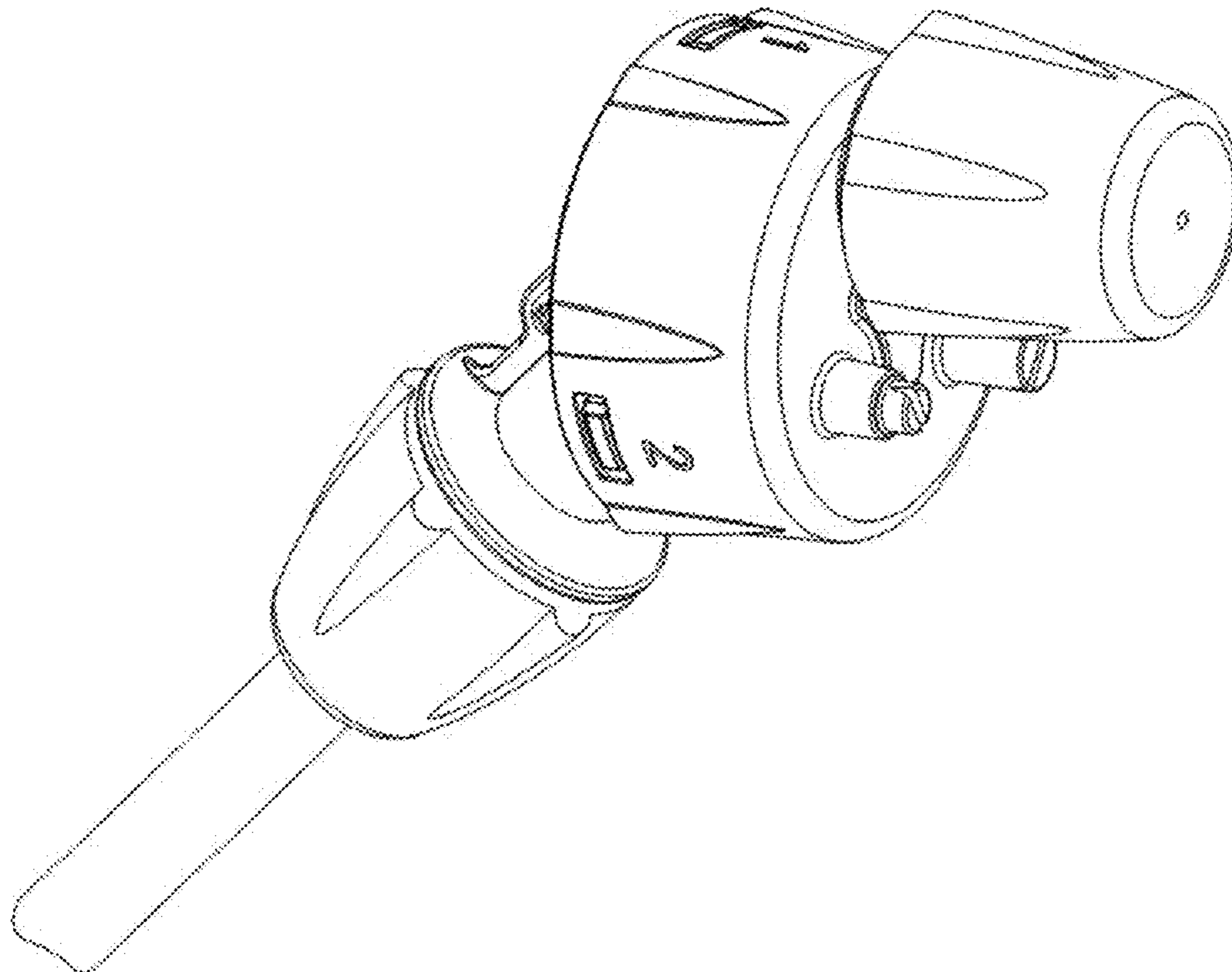

1.1

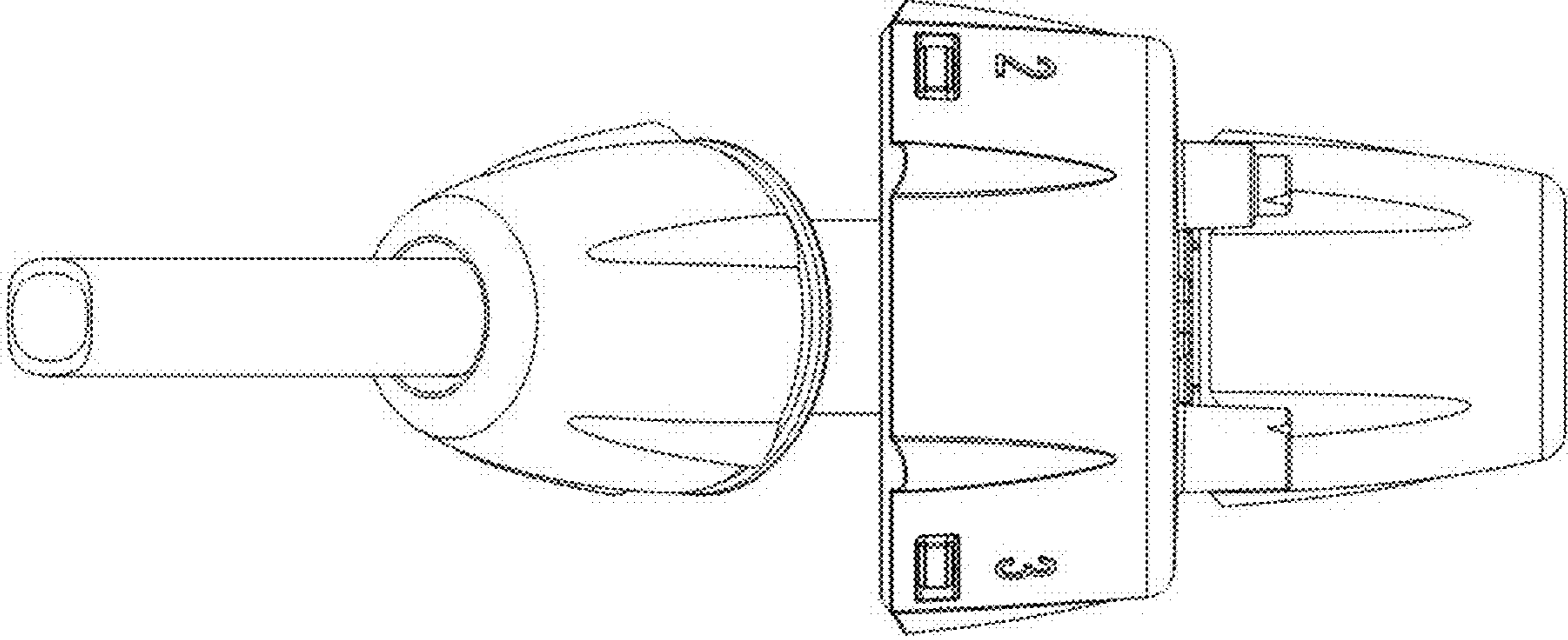

1.2

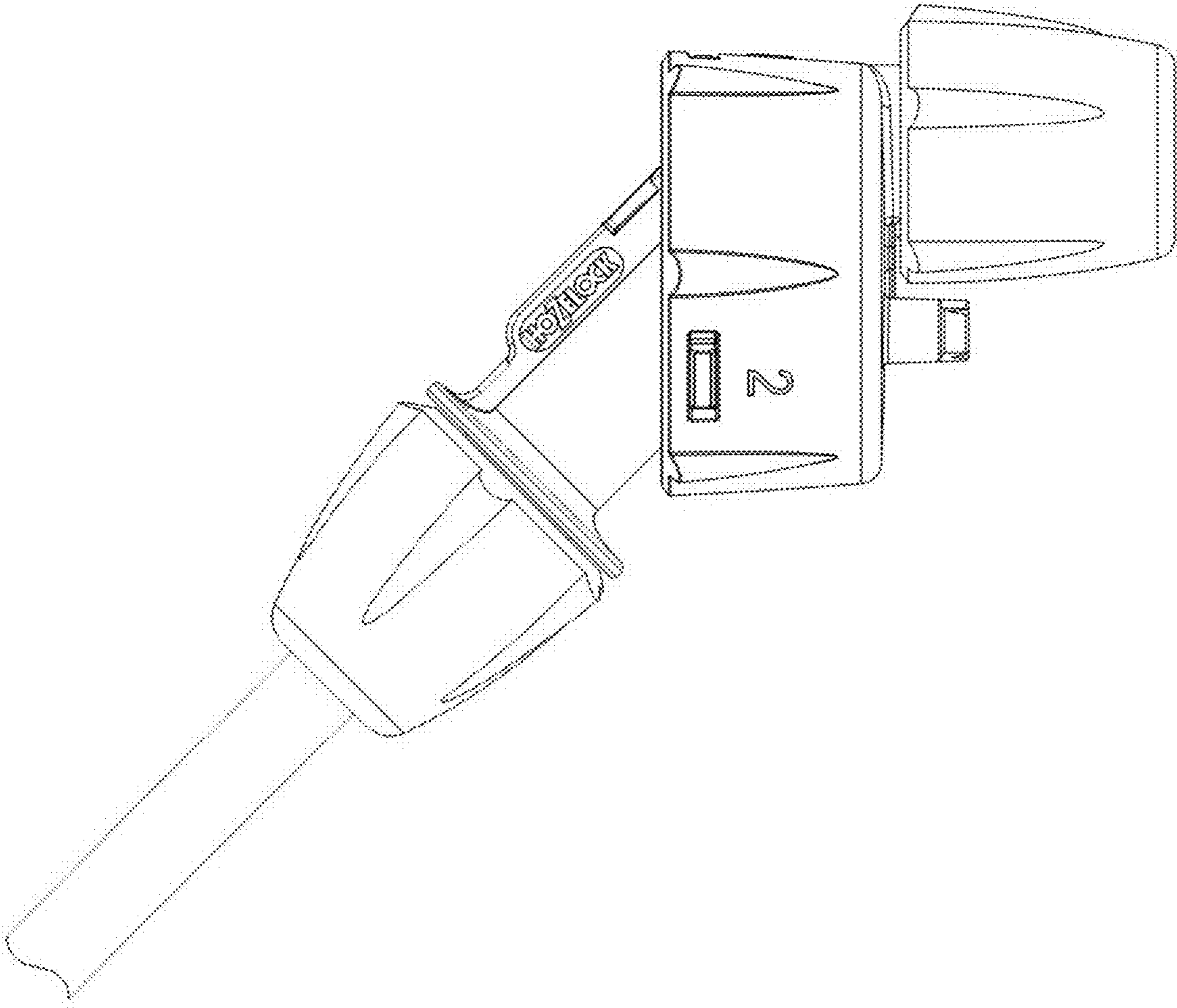

1.3

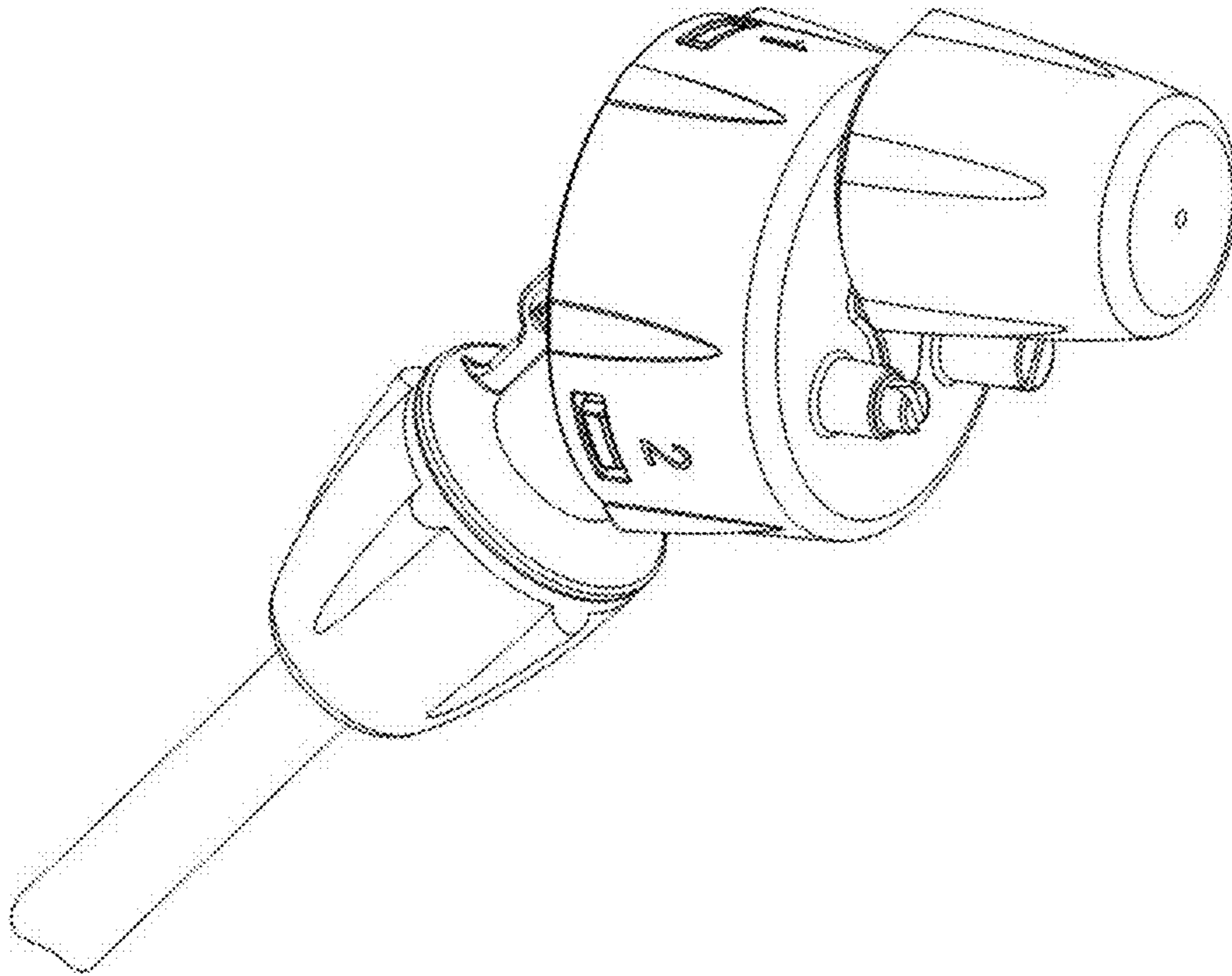

1.4

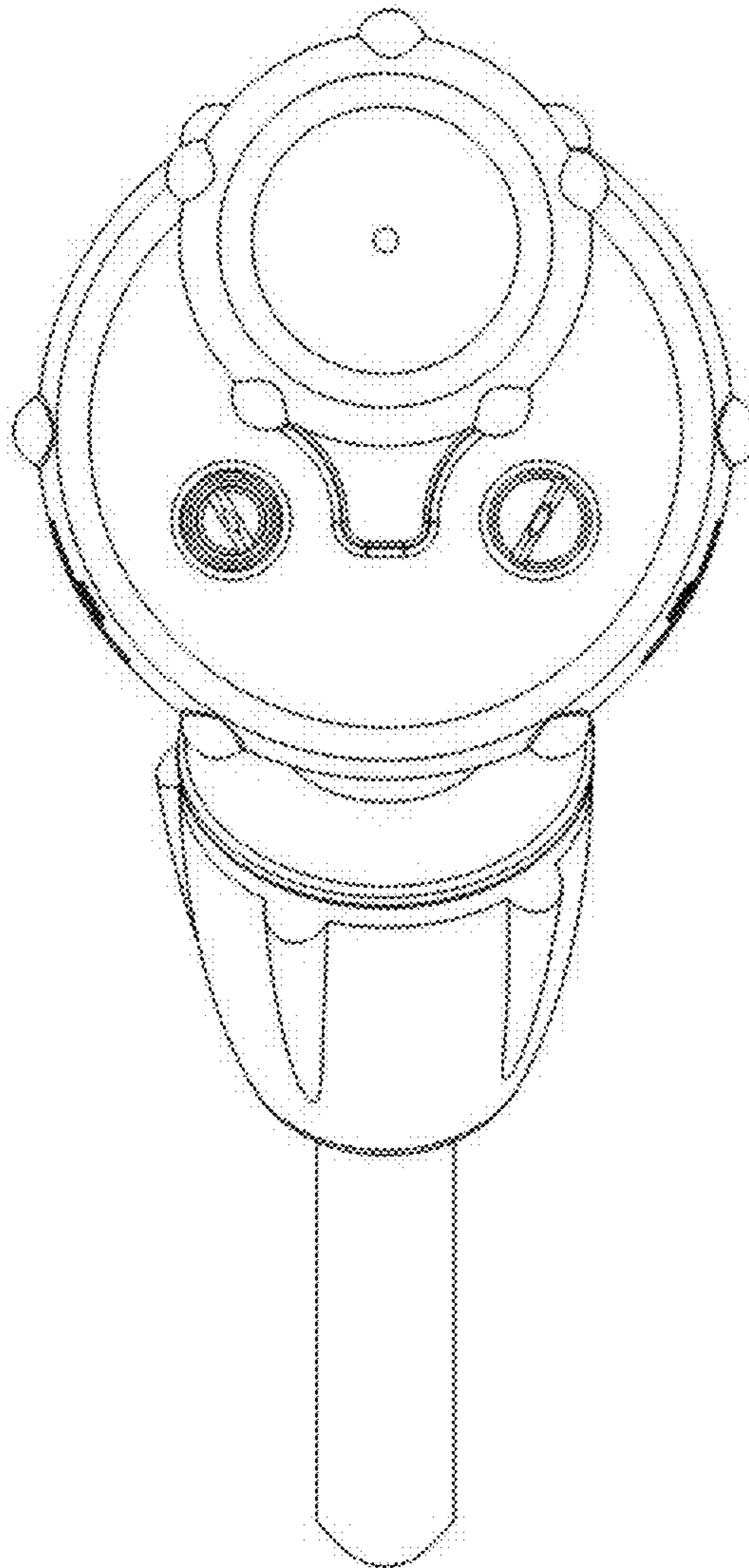

1.5

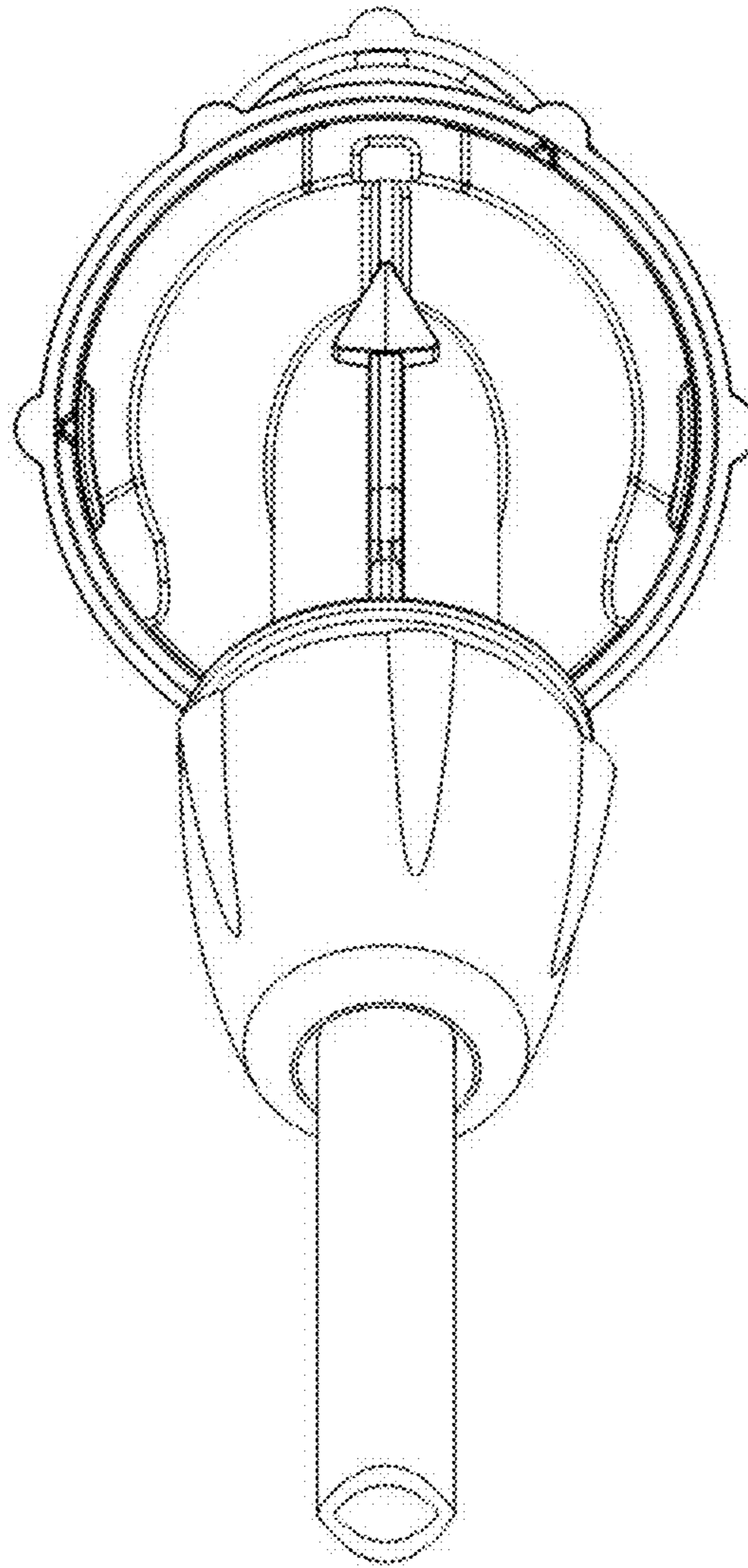

1.6

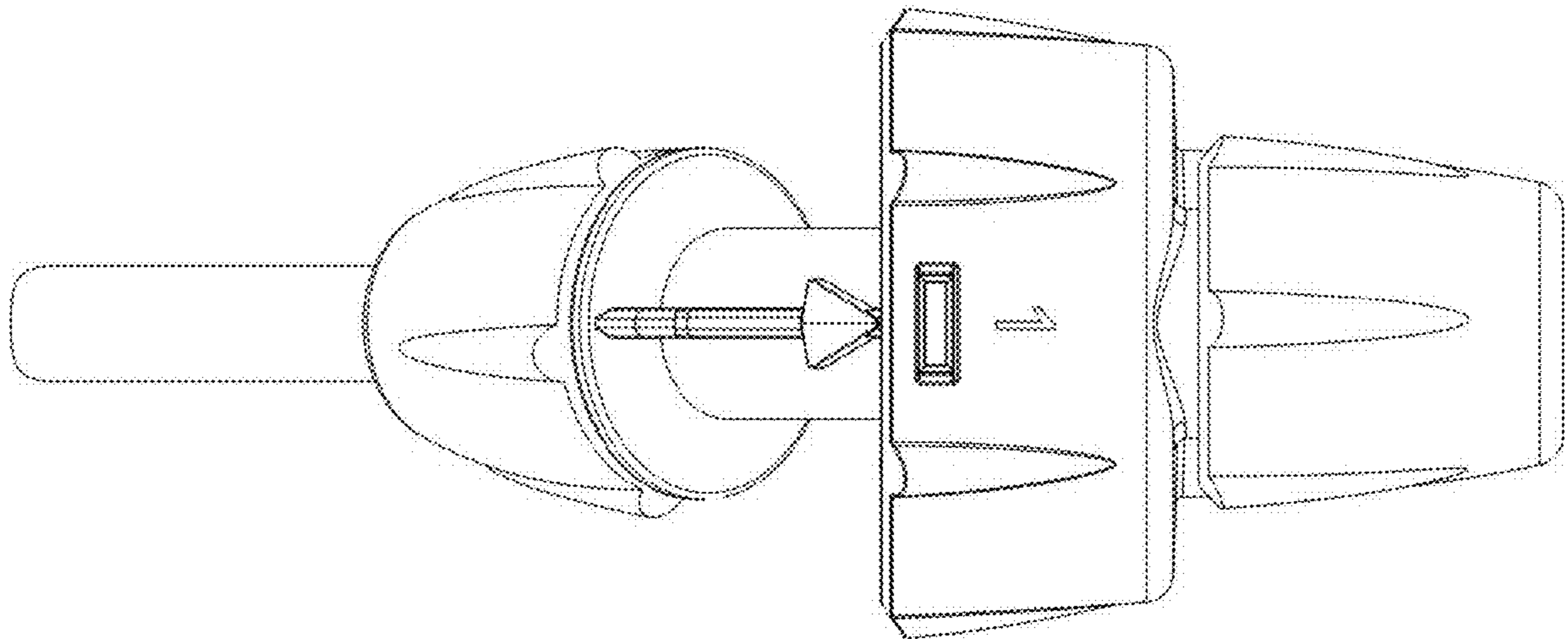

1.7

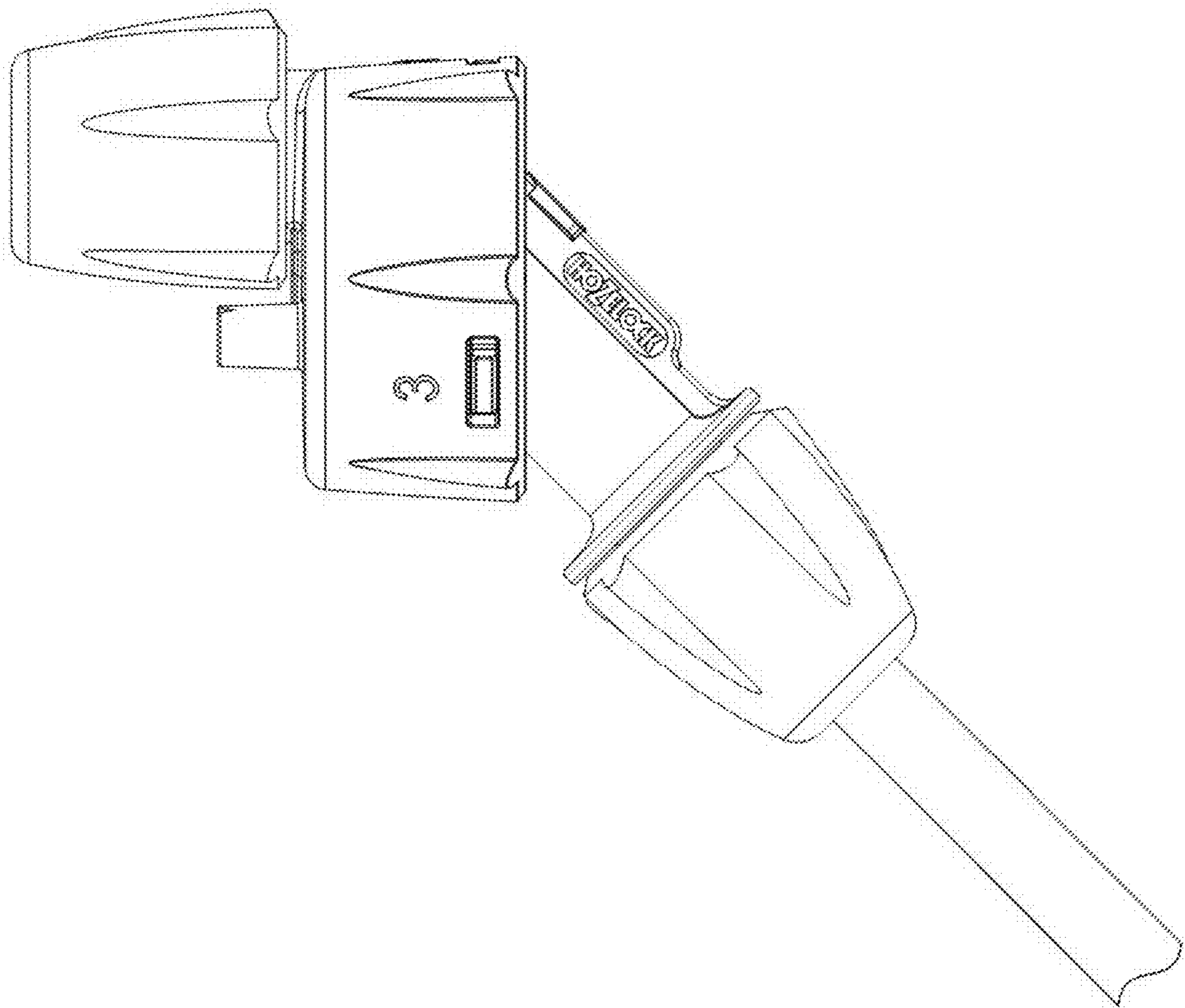

1.8

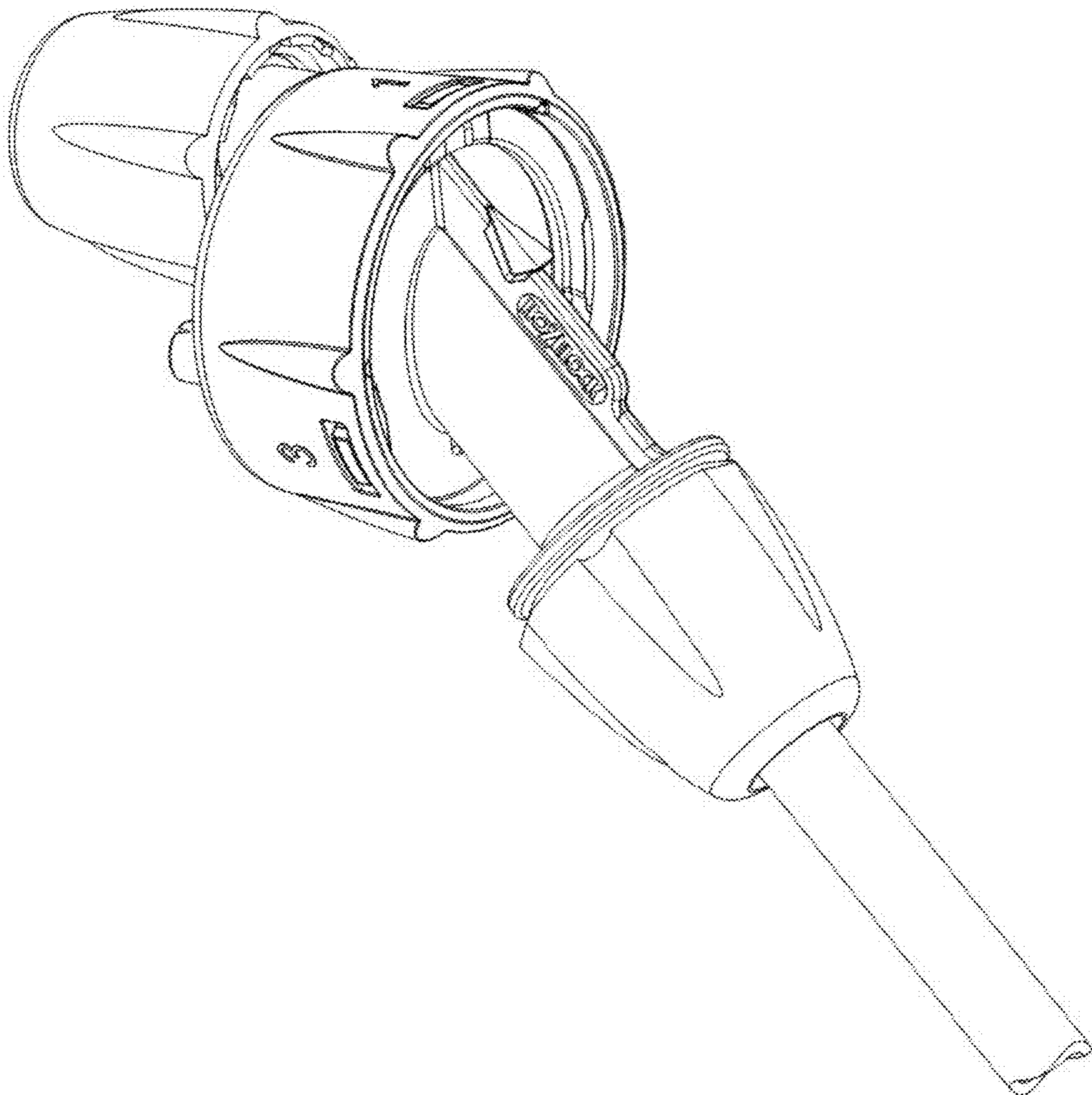

1.9

