



US00D922428S

(12) **United States Design Patent** (10) **Patent No.:** **US D922,428 S**
Hackwell et al. (45) **Date of Patent:** **** Jun. 15, 2021**

(54) **DISPLAY SCREEN OR PORTION THEREOF WITH GRAPHICAL USER INTERFACE**

(71) Applicants: **Samuel Hackwell**, Midway, UT (US);
Tina Hackwell, Midway, UT (US)

(72) Inventors: **Samuel Hackwell**, Midway, UT (US);
Tina Hackwell, Midway, UT (US)

(**) Term: **15 Years**

(21) Appl. No.: **29/699,661**

(22) Filed: **Jul. 26, 2019**

(51) **LOC (13) Cl.** **14-04**

(52) **U.S. Cl.**
USPC **D14/487**

(58) **Field of Classification Search**
USPC D14/485-495
CPC G05B 19/048; G06Q 50/08
See application file for complete search history.

D848,451 S * 5/2019 Baber D14/485
D865,782 S * 11/2019 Pitman D14/486
D896,241 S * 9/2020 Zhang D14/485
2011/0050888 A1* 3/2011 Shibukawa H04N 1/00411
348/135
2013/0226546 A1* 8/2013 Suyeyasu G06Q 10/067
703/6

* cited by examiner

Primary Examiner — Darlington Ly

Assistant Examiner — Katherine A Holbrow

(74) *Attorney, Agent, or Firm* — Sam IP Legal Solutions,
P.C.; Ryan D. Sam

(57) **CLAIM**

The ornamental design for a display screen or portion thereof with graphical user interface, as shown and described.

DESCRIPTION

(56) **References Cited**

U.S. PATENT DOCUMENTS

D427,574	S	*	7/2000	Sawada	D14/486
D525,982	S	*	8/2006	Suzuki	D14/486
D526,653	S	*	8/2006	McDougall	D14/485
D602,036	S	*	10/2009	Kasuya	D14/486
D617,335	S	*	6/2010	Ehrler	D14/486
D636,784	S	*	4/2011	Loken	D14/486
D701,236	S	*	3/2014	Hatta	D14/486
D708,633	S	*	7/2014	Capua	D14/488
D743,443	S	*	11/2015	Miura	D14/493
9,262,052	B2	*	2/2016	Roulliere	G06F 3/0488
D761,289	S	*	7/2016	Chen	D14/486
9,836,749	B1	*	12/2017	Bowman	G06Q 50/08
D828,382	S	*	9/2018	Leek	D14/488
D839,301	S	*	1/2019	Baber	D14/488

FIG. 1 is a front view of a first embodiment of a display screen or portion thereof with graphical user interface showing our new design;
FIG. 2 is a front view of a second embodiment thereof;
FIG. 3 is a front view of a third embodiment thereof; and,
FIG. 4 is a front view of a sixth embodiment thereof.
The outer short dash-dash broken lines in FIGS. 1 to 4 illustrate a display screen or portion thereof and form no part of the claimed design. The remaining short dash-dash broken lines and text in the figures illustrate portions of the graphical user interface that form no part of the claimed design.

1 Claim, 4 Drawing Sheets

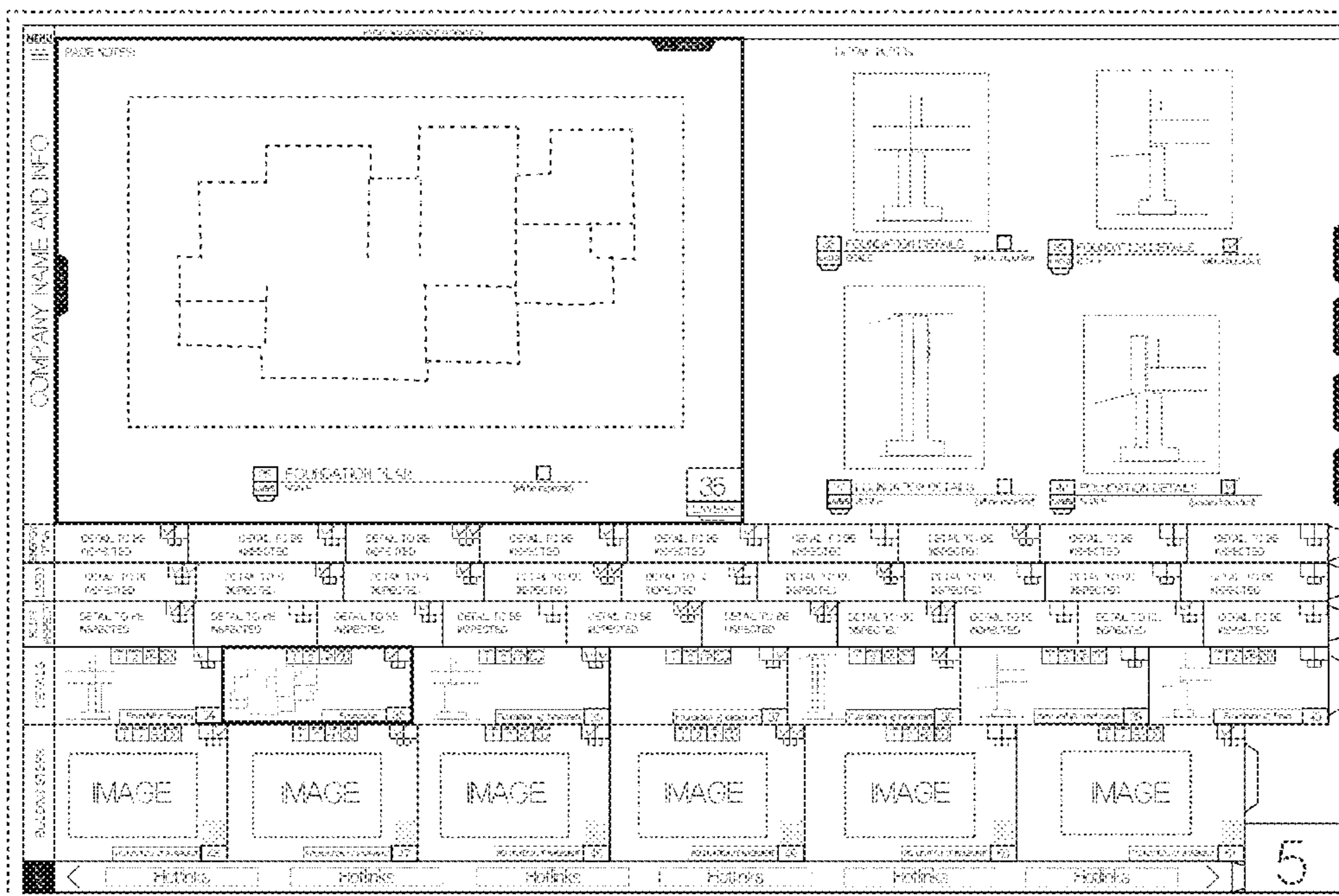

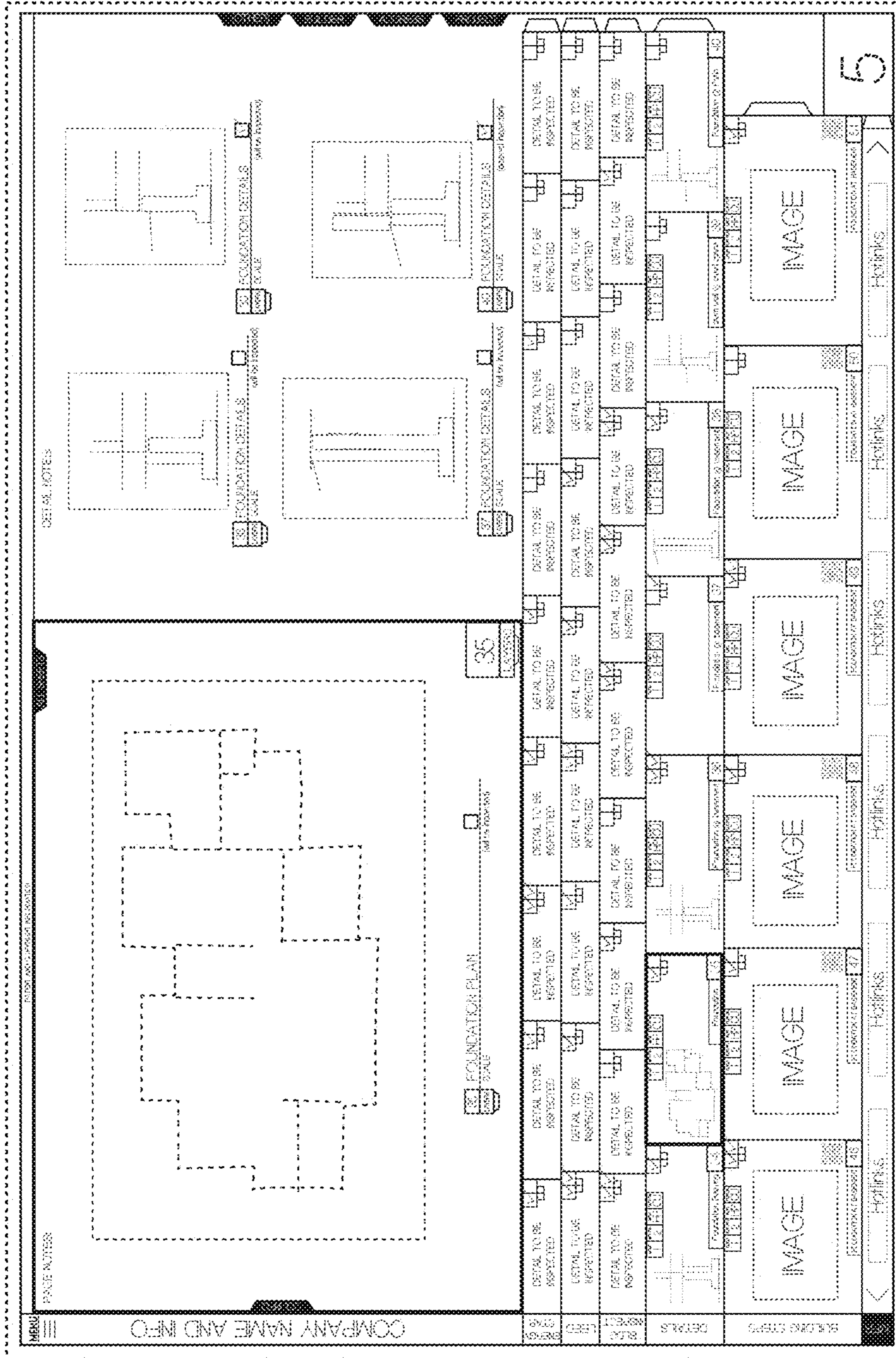

Fig. 1

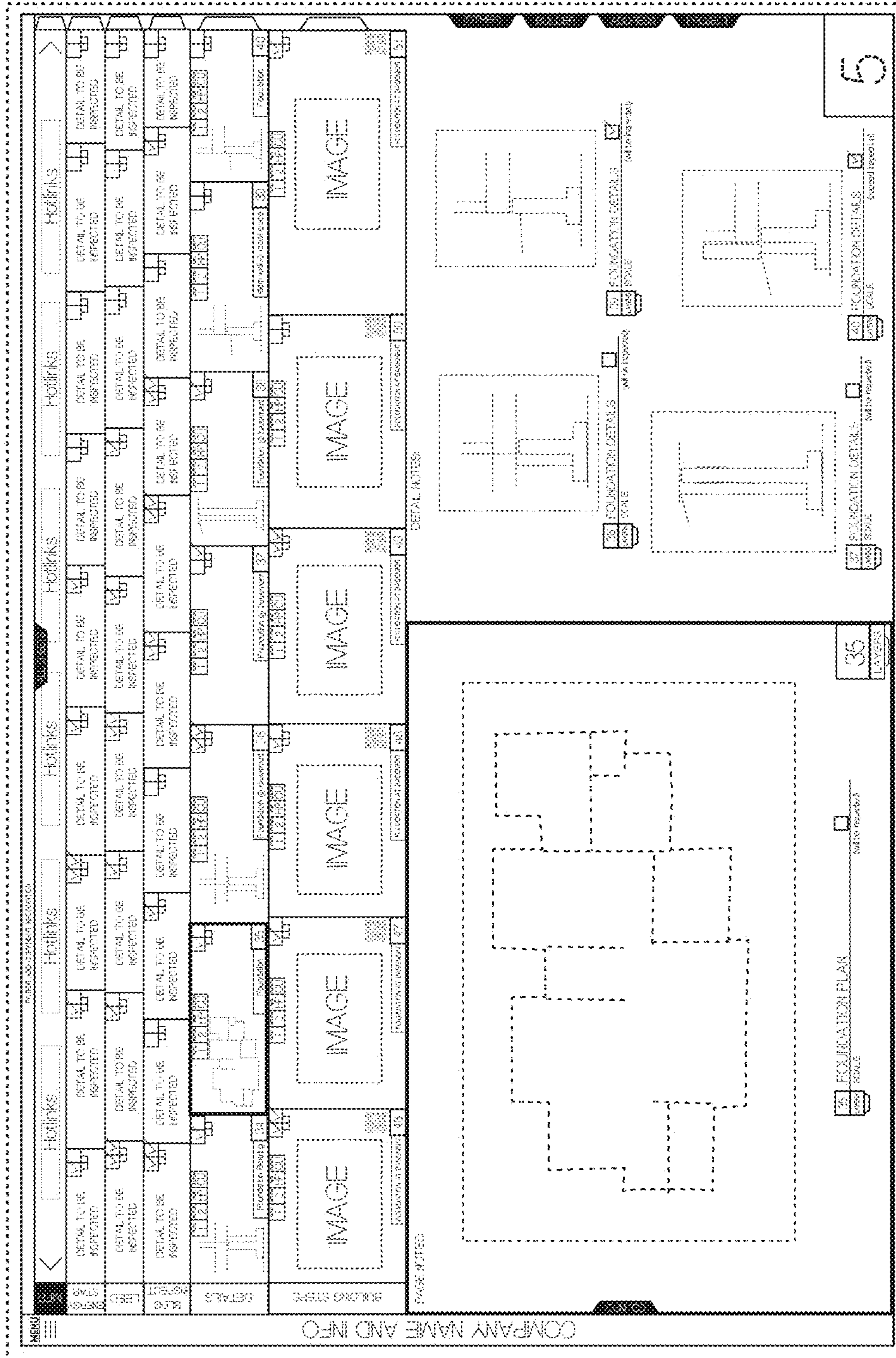

Fig. 2

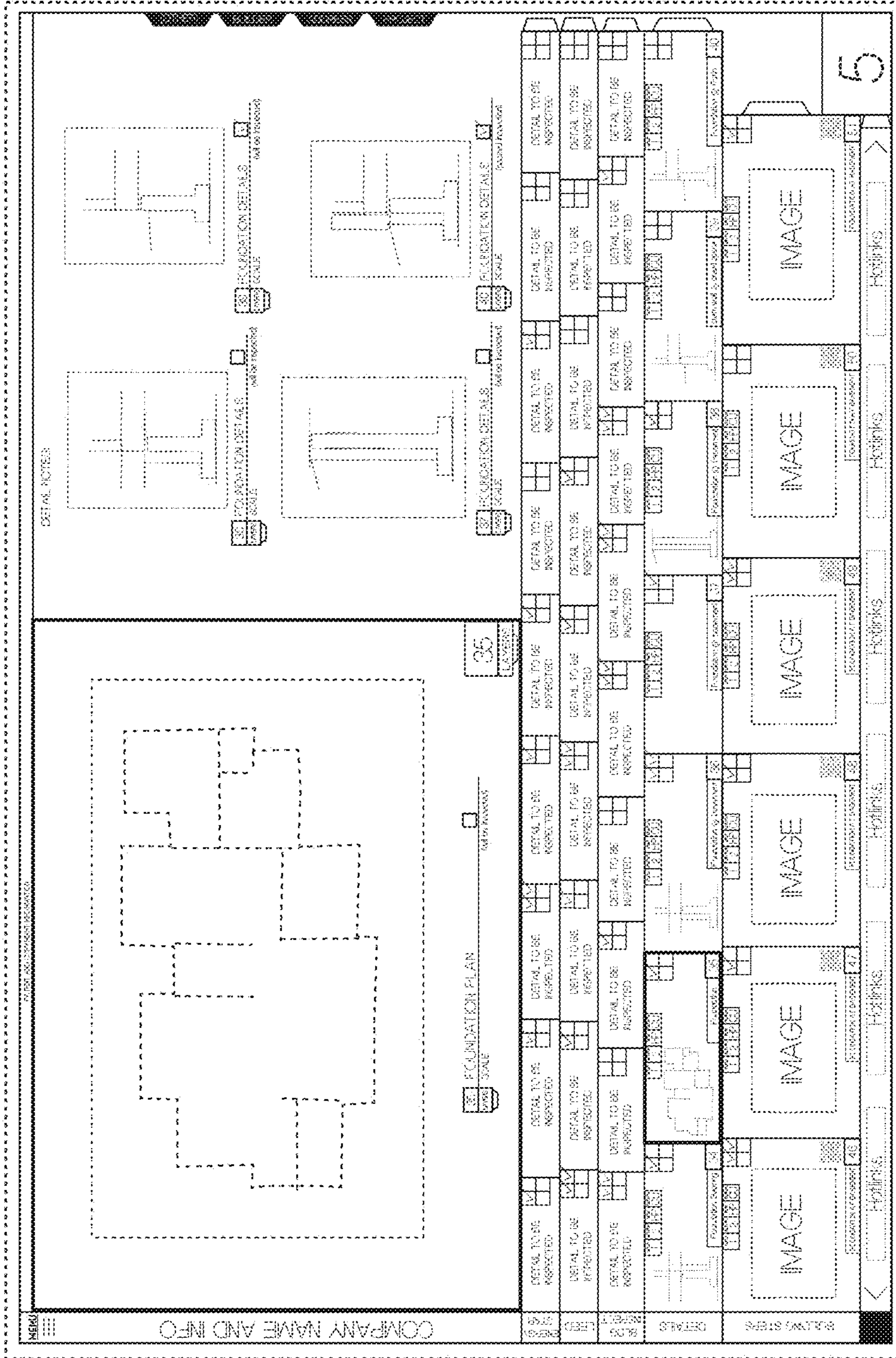

Fig. 3

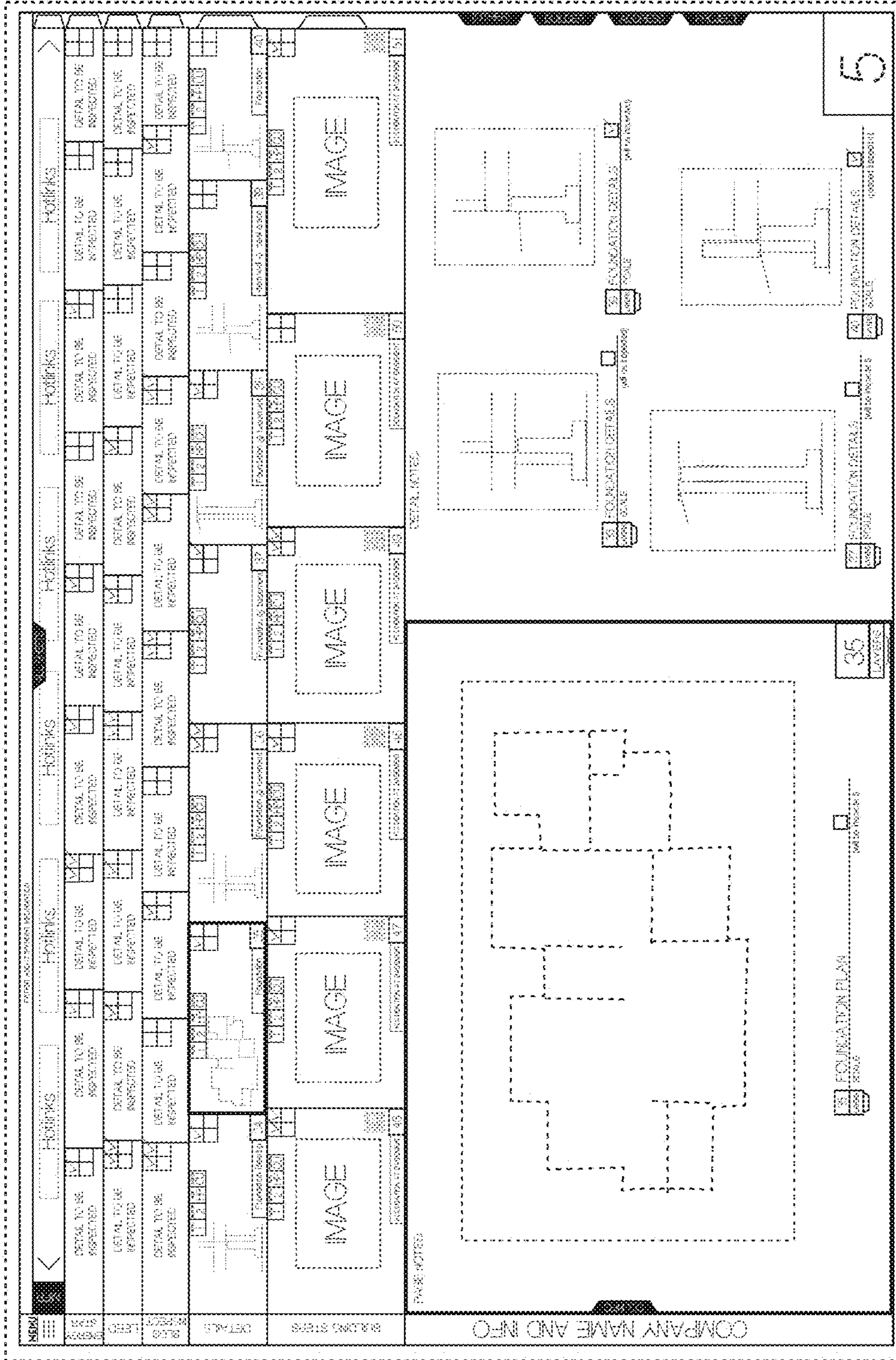

Fig. 4