



US00D922399S

(12) **United States Design Patent** (10) **Patent No.:** **US D922,399 S**
Desai et al. (45) **Date of Patent:** **** Jun. 15, 2021**

(54) **DISPLAY SCREEN OR PORTION THEREOF WITH GRAPHICAL USER INTERFACE**

(71) Applicant: **Wribbn, Inc.**, Aptos, CA (US)

(72) Inventors: **Sagar H. Desai**, Capitola, CA (US);
Jesse W. Street, Capitola, CA (US);
Jonas Welch, Santa Cruz, CA (US);
Ryan Houk, Roseville, CA (US)

(73) Assignee: **Wribbn, Inc.**, Aptos, CA (US)

(**) Term: **15 Years**

(21) Appl. No.: **29/688,262**

(22) Filed: **Apr. 19, 2019**

(51) **LOC (13) Cl.** **14-04**

(52) **U.S. Cl.**
USPC **D14/485**

(58) **Field of Classification Search**
USPC D14/485–495
CPC G06F 3/048; G06F 3/0481; G06F 3/04842;
G06Q 13/80
See application file for complete search history.

(56) **References Cited**

U.S. PATENT DOCUMENTS

D708,631 S	7/2014	Pai et al.	
D711,897 S *	8/2014	Chaudhri	D14/486
D726,744 S	4/2015	Park	
D730,926 S *	6/2015	Lee	D14/486
D733,183 S *	6/2015	Lee	D14/488
D736,247 S *	8/2015	Chen	D14/488
D745,022 S *	12/2015	McCleary	D14/486
D745,038 S *	12/2015	Abbas	D14/488
D745,550 S *	12/2015	Sanderson	D14/488
D746,866 S *	1/2016	Memoria	D14/494
D747,741 S *	1/2016	Paniaras	D14/494
D752,088 S *	3/2016	Hiramatsu	D14/488
D753,149 S *	4/2016	Kim	D14/485
D753,699 S *	4/2016	Tsukamoto	D14/487

D753,701 S *	4/2016	Hiramatsu	D14/488
D756,396 S *	5/2016	Anzures	D14/486
D757,041 S *	5/2016	Zankowski	D14/485
D757,064 S *	5/2016	Seo	D14/486
D759,670 S *	6/2016	Lee	D14/485
D761,825 S	7/2016	Kim et al.	
D763,296 S *	8/2016	Gomez	D14/486

(Continued)

Primary Examiner — Daniel J Domino

(74) *Attorney, Agent, or Firm* — Levine Bagade Han LLP

(57) **CLAIM**

The ornamental design for a display screen or portion thereof with graphical user interface, as shown and described.

DESCRIPTION

FIG. 1 is a front view of a first image in a sequence of a first embodiment of a display screen or portion thereof with a graphical user interface showing our new design;

FIG. 2 is a front view of a second image in the sequence of the first embodiment of the display screen or portion thereof shown in FIG. 1;

FIG. 3 is a front view of a first image in a sequence of a second embodiment of a display screen or portion thereof with a graphical user interface showing our new design; and, FIG. 4 is a front view of a second image in the sequence of the second embodiment of the display screen or portion thereof shown in FIG. 3.

The appearance of the graphical user interface transitions sequentially between the images shown in the figures. The process or period in which one image transitions to another forms no part of the claimed design.

The outermost broken lines in the figures show a display screen or portion thereof, and form no part of the claimed design. The other broken lines in the figures show portions of the graphical user interface that form no part of the claimed design.

1 Claim, 4 Drawing Sheets

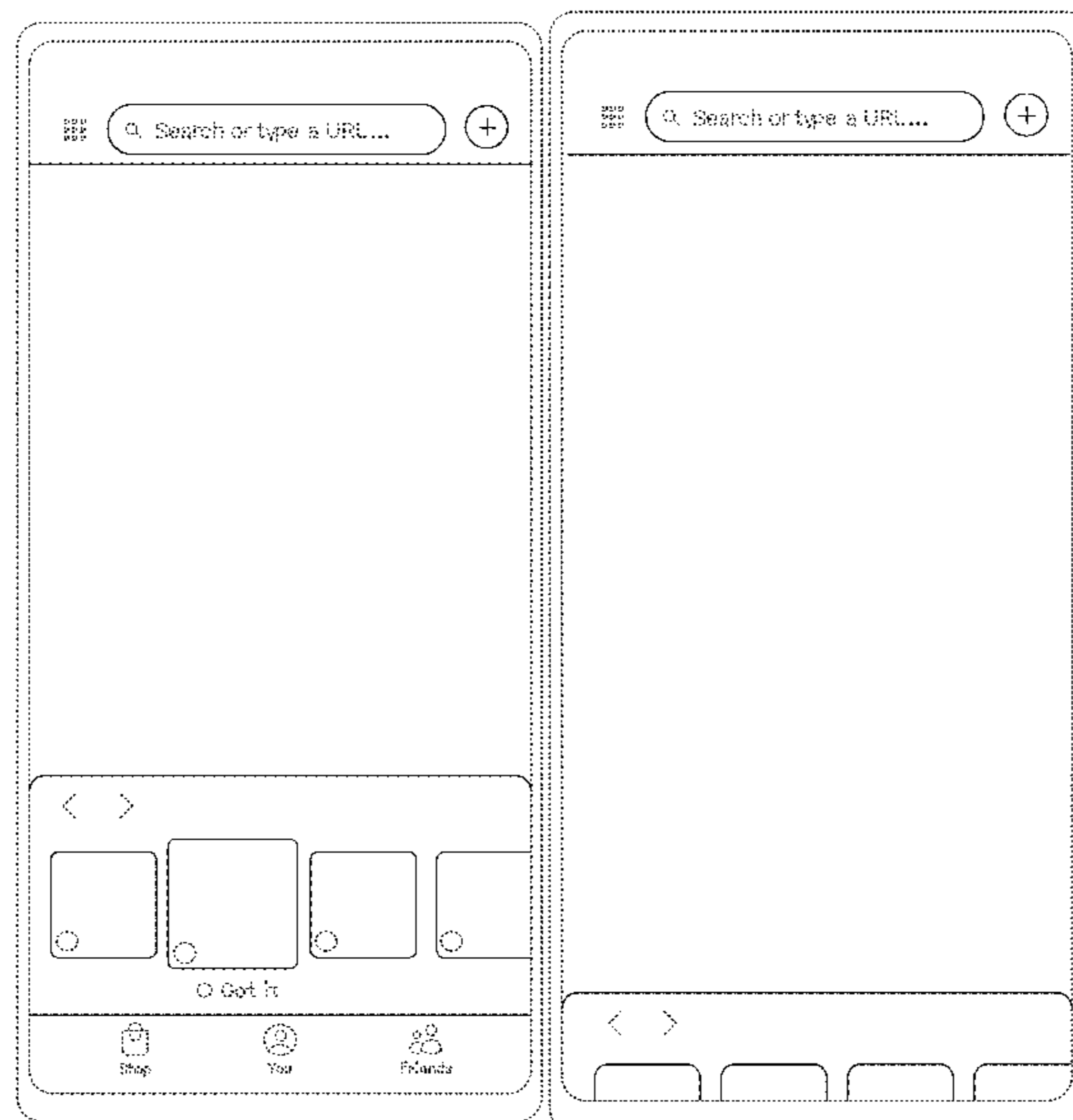

(56)

References Cited

U.S. PATENT DOCUMENTS

D766,308 S * 9/2016 Park D14/487
 D768,676 S * 10/2016 Edwards D14/486
 D769,295 S * 10/2016 Han D14/486
 D771,067 S * 11/2016 Righter D14/485
 D776,687 S 1/2017 Wick et al.
 D781,328 S * 3/2017 Fong D14/486
 D785,669 S * 5/2017 Nishizawa D14/488
 D790,569 S * 6/2017 Anzures D14/486
 D792,900 S 7/2017 Gaur et al.
 D792,901 S 7/2017 Gaur et al.
 D792,903 S * 7/2017 Park D14/486
 D793,424 S * 8/2017 Bao D14/488
 D798,321 S * 9/2017 Lieb D14/486
 D804,495 S * 12/2017 Kim D14/485
 D808,975 S * 1/2018 Park D14/485
 D823,889 S * 7/2018 Shelksohn D14/488
 D828,387 S * 9/2018 Nilsson D14/488
 D828,388 S * 9/2018 Bao D14/488
 D829,747 S 10/2018 Chaudhri
 D831,032 S * 10/2018 Lee D14/485

D832,876 S * 11/2018 Chung D14/486
 D835,149 S * 12/2018 Balcom D14/488
 D837,230 S * 1/2019 Johnston D14/485
 D845,324 S * 4/2019 Hemsley D14/486
 D845,331 S * 4/2019 Malahy D14/486
 D846,586 S * 4/2019 Kim D14/487
 D847,166 S * 4/2019 Jann D14/486
 D847,167 S * 4/2019 Jann D14/486
 D847,855 S * 5/2019 Majernik D14/488
 D848,451 S * 5/2019 Baber D14/485
 D850,478 S * 6/2019 Kim D14/486
 D871,421 S * 12/2019 Kim D14/485
 D872,750 S * 1/2020 Sakuma D14/485
 D875,762 S * 2/2020 Evans D14/486
 D885,410 S * 5/2020 Butler D14/485
 D888,733 S * 6/2020 Fong D14/486
 D891,461 S * 7/2020 Sowden D14/488
 D898,066 S * 10/2020 Kim D14/487
 D905,095 S * 12/2020 Park D14/488
 D907,053 S * 1/2021 Dascola D14/485
 D907,649 S * 1/2021 Uppala D14/485
 D908,731 S * 1/2021 Okumura D14/488
 D910,060 S * 2/2021 Kim D14/487

* cited by examiner

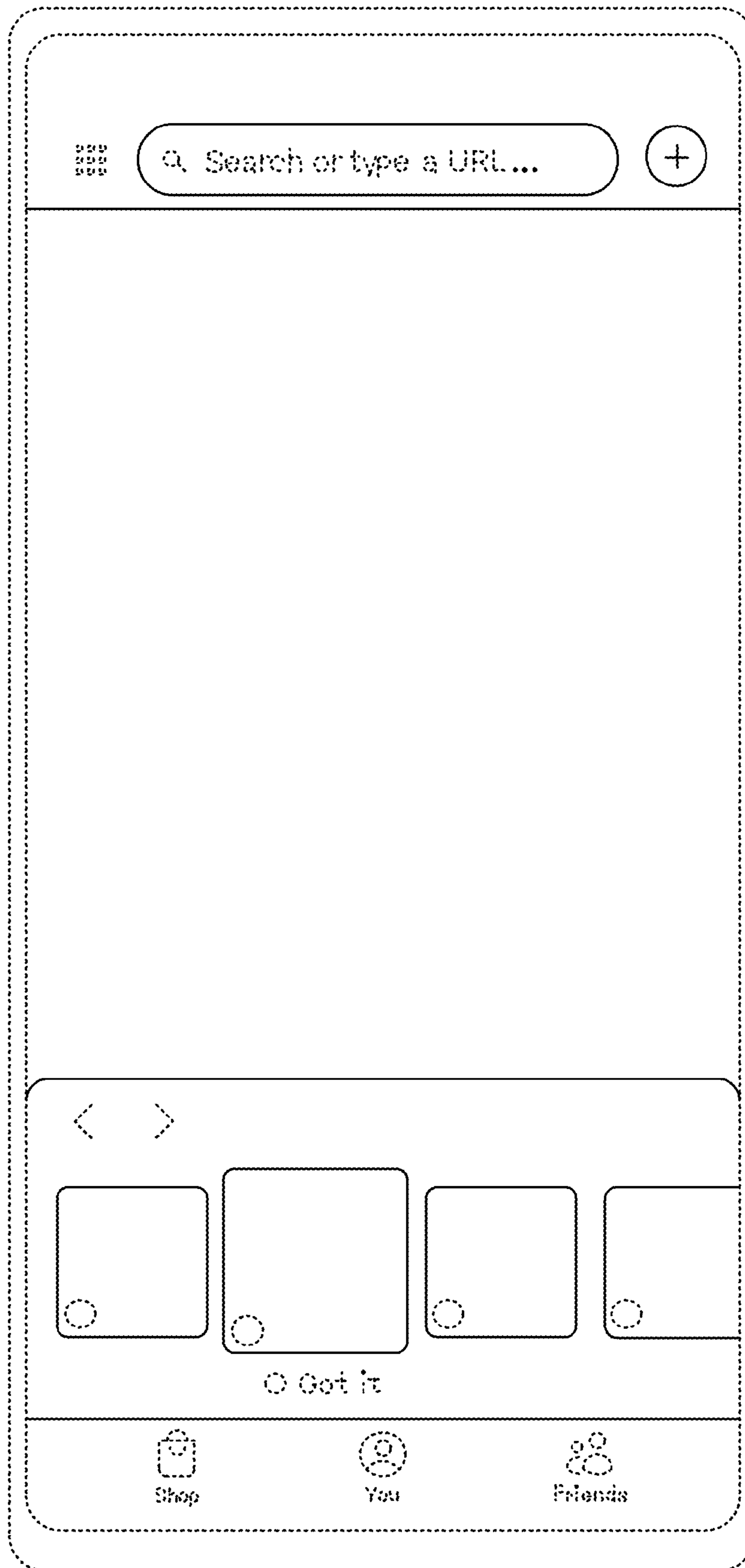

FIG. 1

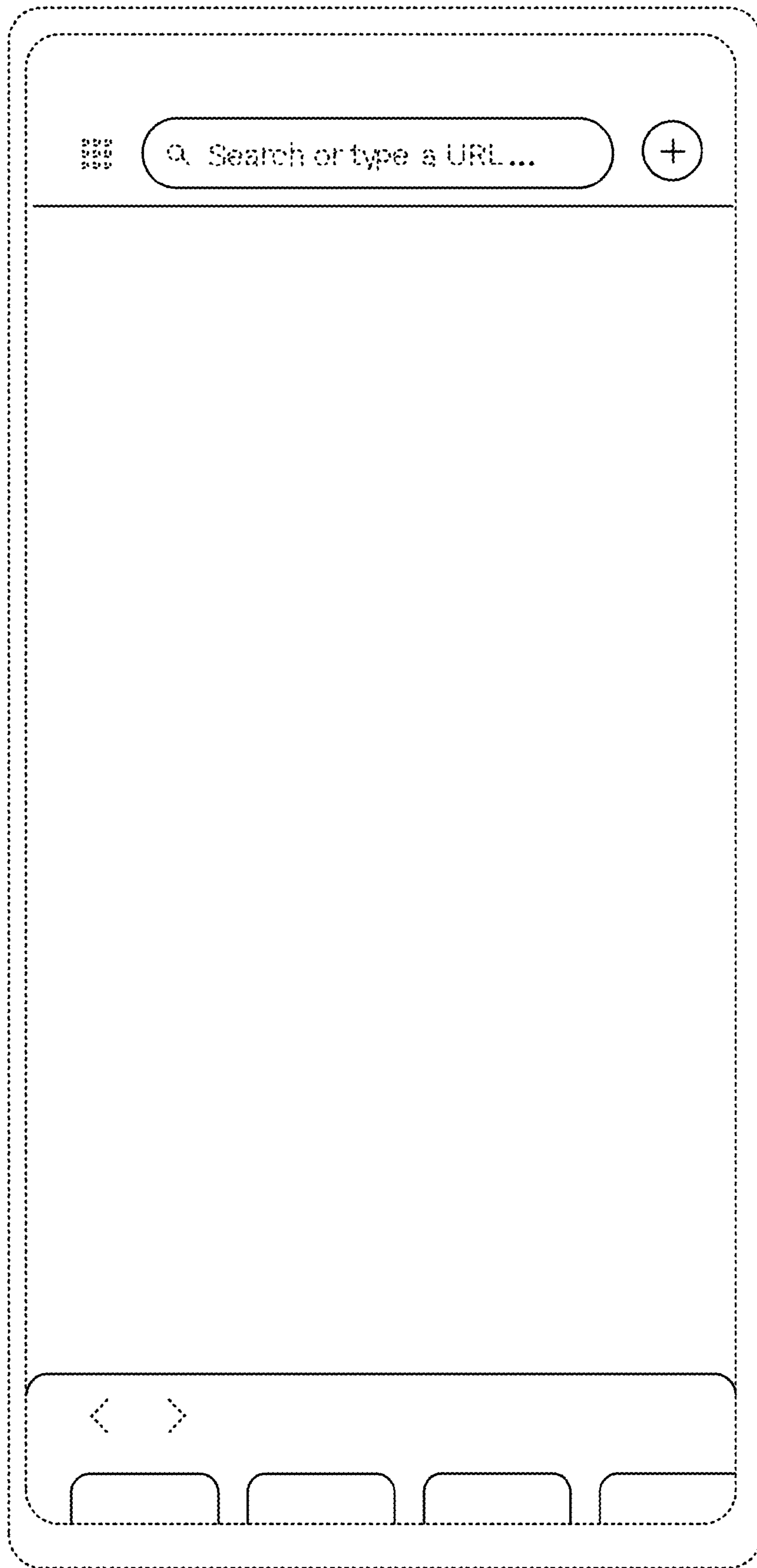

FIG. 2

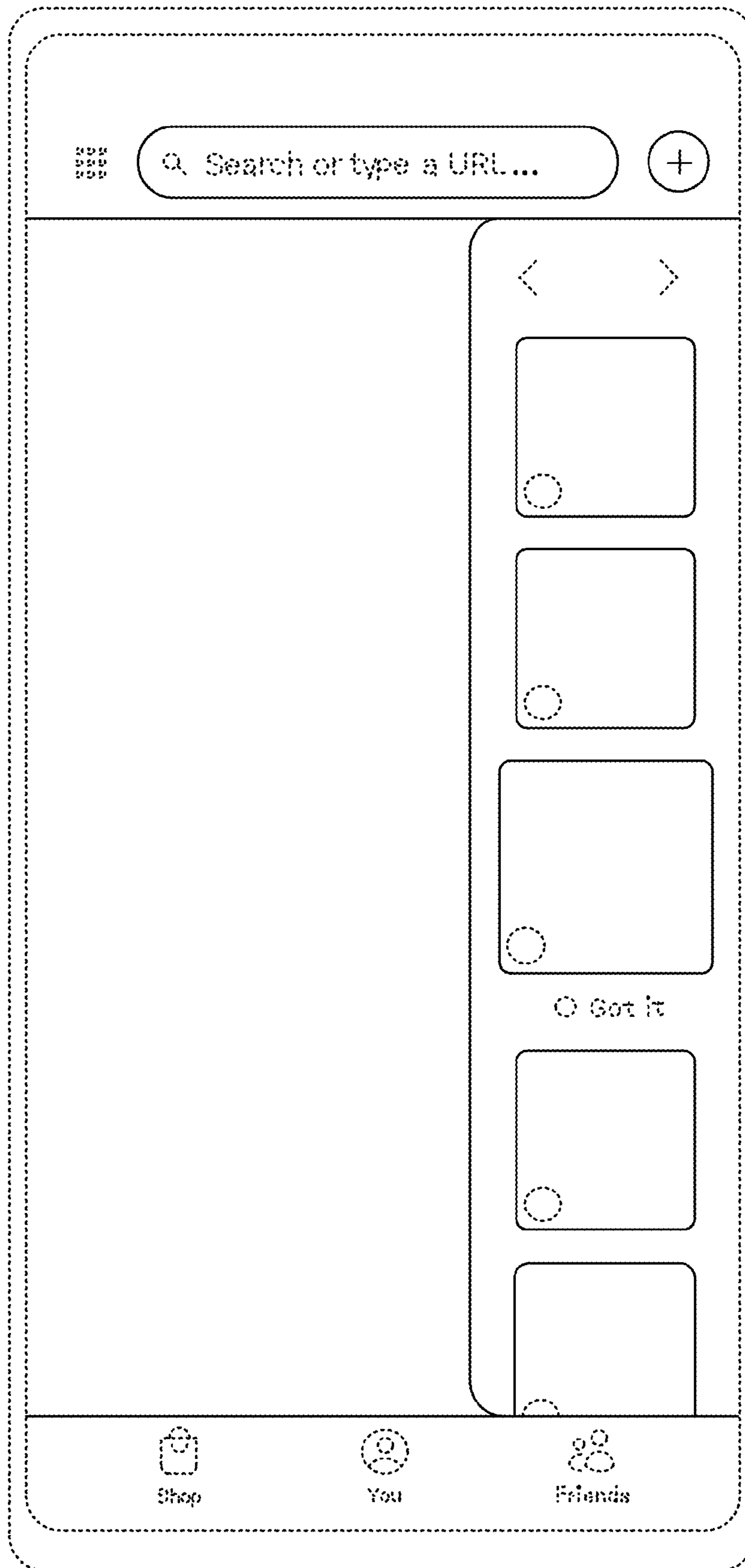

FIG. 3

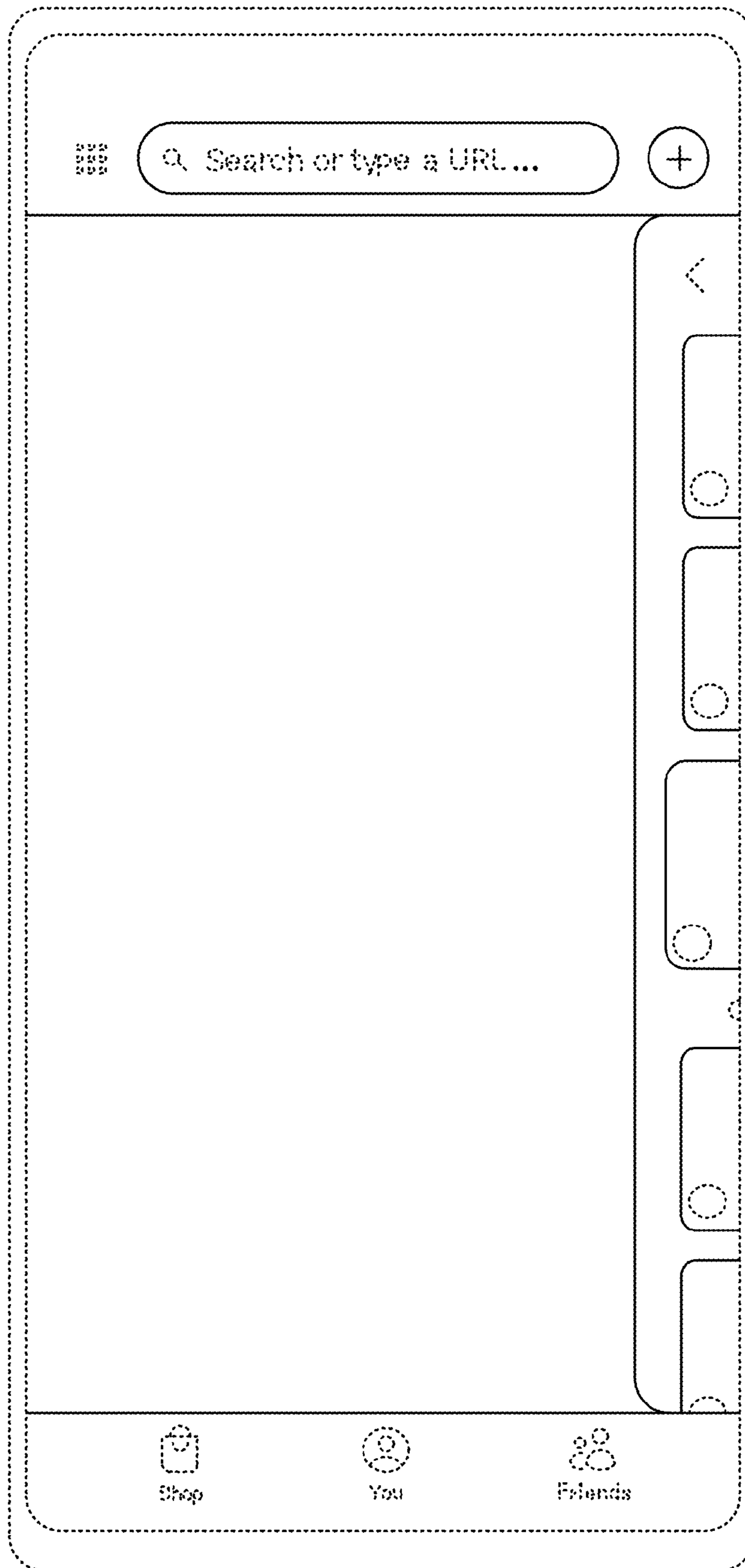

FIG. 4