



US00D919909S

(12) **United States Design Patent** (10) **Patent No.:** **US D919,909 S**
Tschopp (45) **Date of Patent:** **** May 18, 2021**

(54) **PRESSURE WASHER**
(71) Applicant: **BLACK & DECKER INC.**, New Britain, CT (US)
(72) Inventor: **Tylan A. Tschopp**, Baltimore, MD (US)
(73) Assignee: **BLACK & DECKER INC.**, New Britain, CT (US)
(**) Term: **15 Years**
(21) Appl. No.: **29/652,094**
(22) Filed: **May 12, 2020**
(51) **LOC (13) Cl.** **15-05**
(52) **U.S. Cl.**
USPC **D32/15**
(58) **Field of Classification Search**
USPC D32/15-16, 1, 20-21
CPC B05B 9/04; B05B 7/24
See application file for complete search history.

D804,750 S * 12/2017 Janik D32/16
D809,721 S * 2/2018 Venard D32/15
D834,269 S * 11/2018 Masters D32/15
D836,272 S * 12/2018 Janik D32/15
D839,512 S * 1/2019 Bearup D32/25
2007/0186813 A1* 8/2007 Smith B05D 1/02
106/281.1

FOREIGN PATENT DOCUMENTS

WO WO D100224-001 * 3/2020

* cited by examiner

Primary Examiner — John R Yeh

(74) *Attorney, Agent, or Firm* — Adan Ayala

(57) **CLAIM**

The ornamental design for a pressure washer, as shown and described.

DESCRIPTION

FIG. 1 is a front perspective view of a pressure washer according to the invention.
FIG. 2 is a front view thereof.
FIG. 3 is a rear view thereof.
FIG. 4 is a right side view thereof.
FIG. 5 is a left side view thereof.
FIG. 6 is a top plan view thereof; and,
FIG. 7 is a bottom plan view thereof.
The broken lines depict portions of the pressure washer that form no part of the claimed design.

1 Claim, 7 Drawing Sheets

(56) **References Cited**
U.S. PATENT DOCUMENTS
D375,591 S * 11/1996 Fryoux D32/15
D463,888 S * 10/2002 Rehkugler B08B 3/026
D32/1
D499,848 S * 12/2004 Leasure D32/15
D529,670 S * 10/2006 Hendy D32/15
D531,767 S * 11/2006 Hastie D32/15
D532,942 S * 11/2006 Busschaert D32/15
D778,011 S * 1/2017 Alexander D32/16
D779,744 S * 2/2017 Weinberg D32/16
D779,745 S * 2/2017 Weinberg D32/16
D779,746 S * 2/2017 Weinberg D32/16

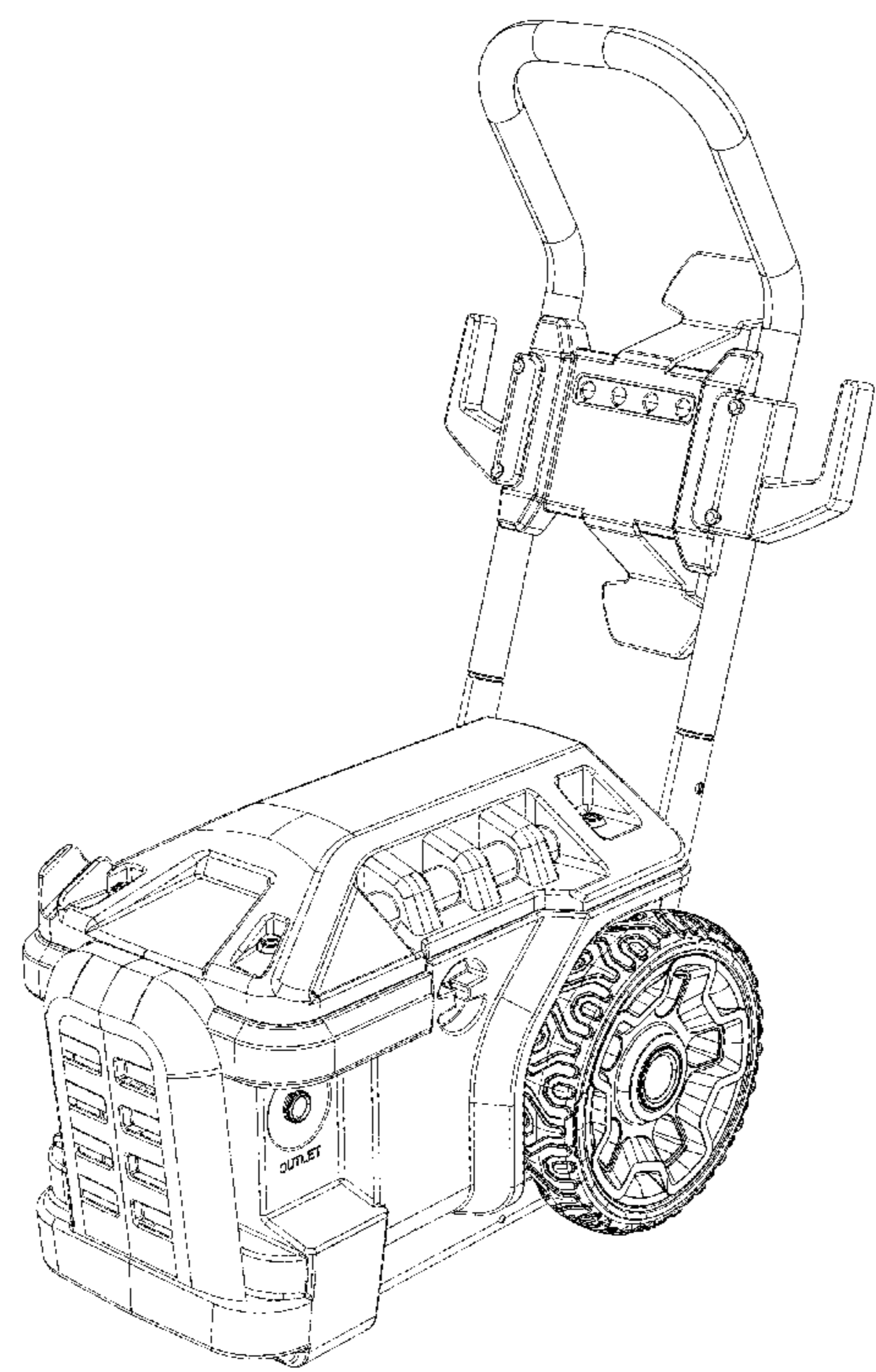

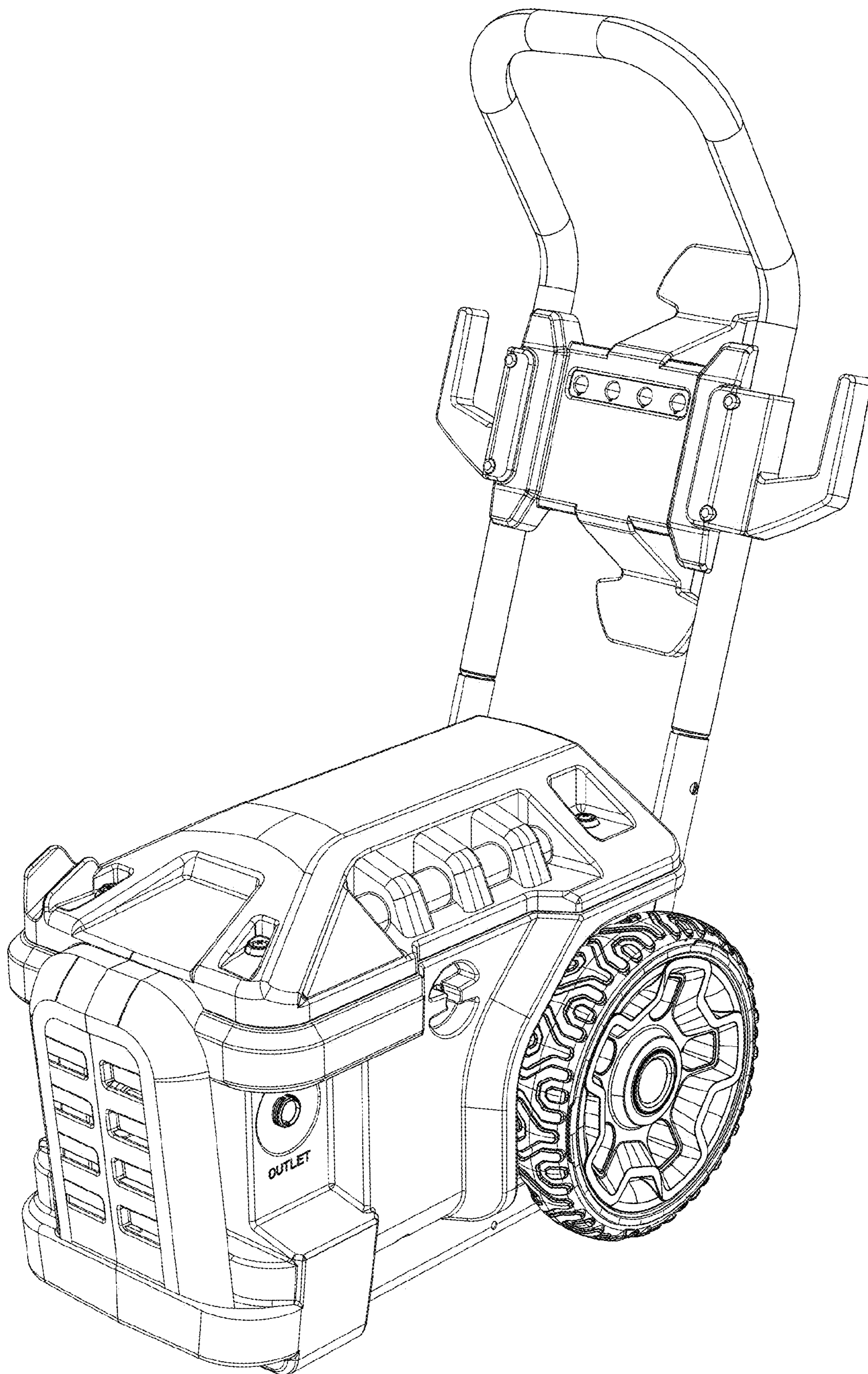

FIG. 1

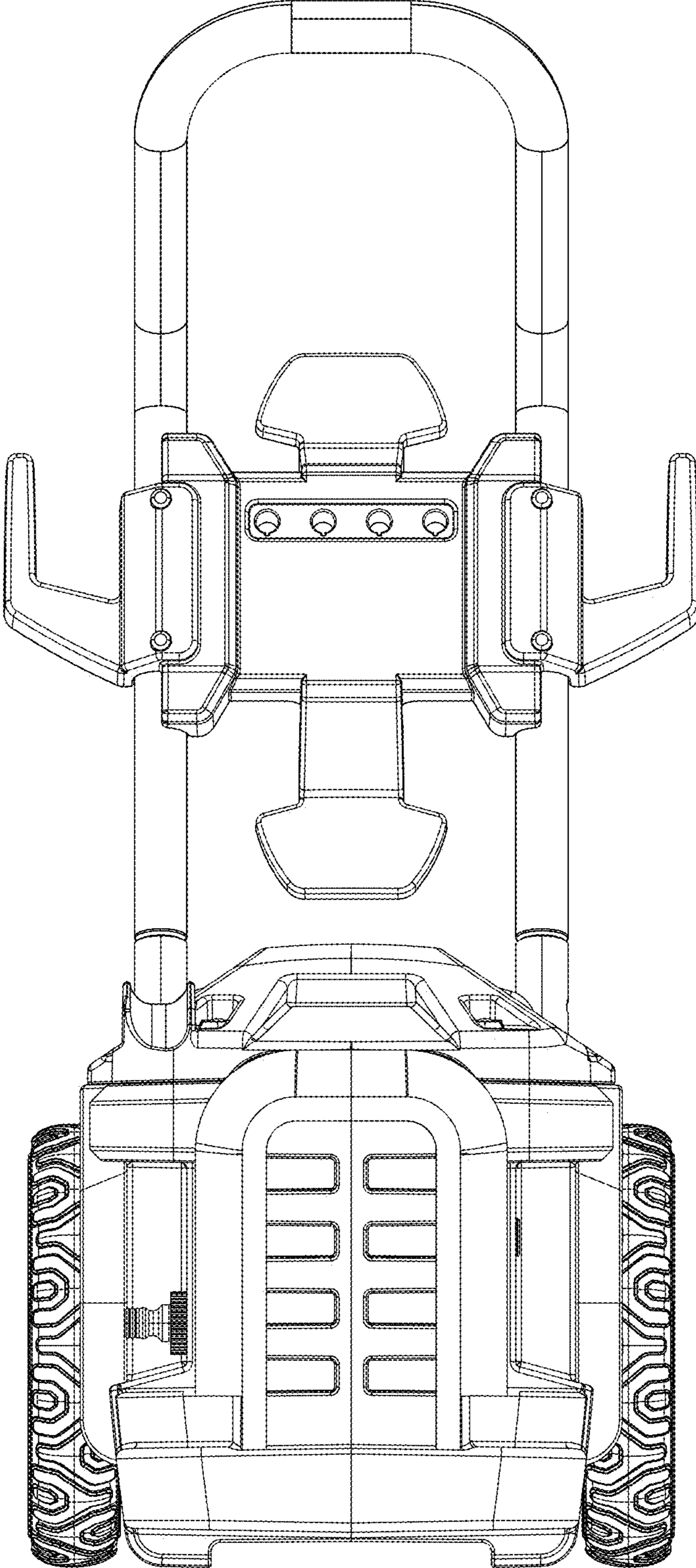

FIG. 2

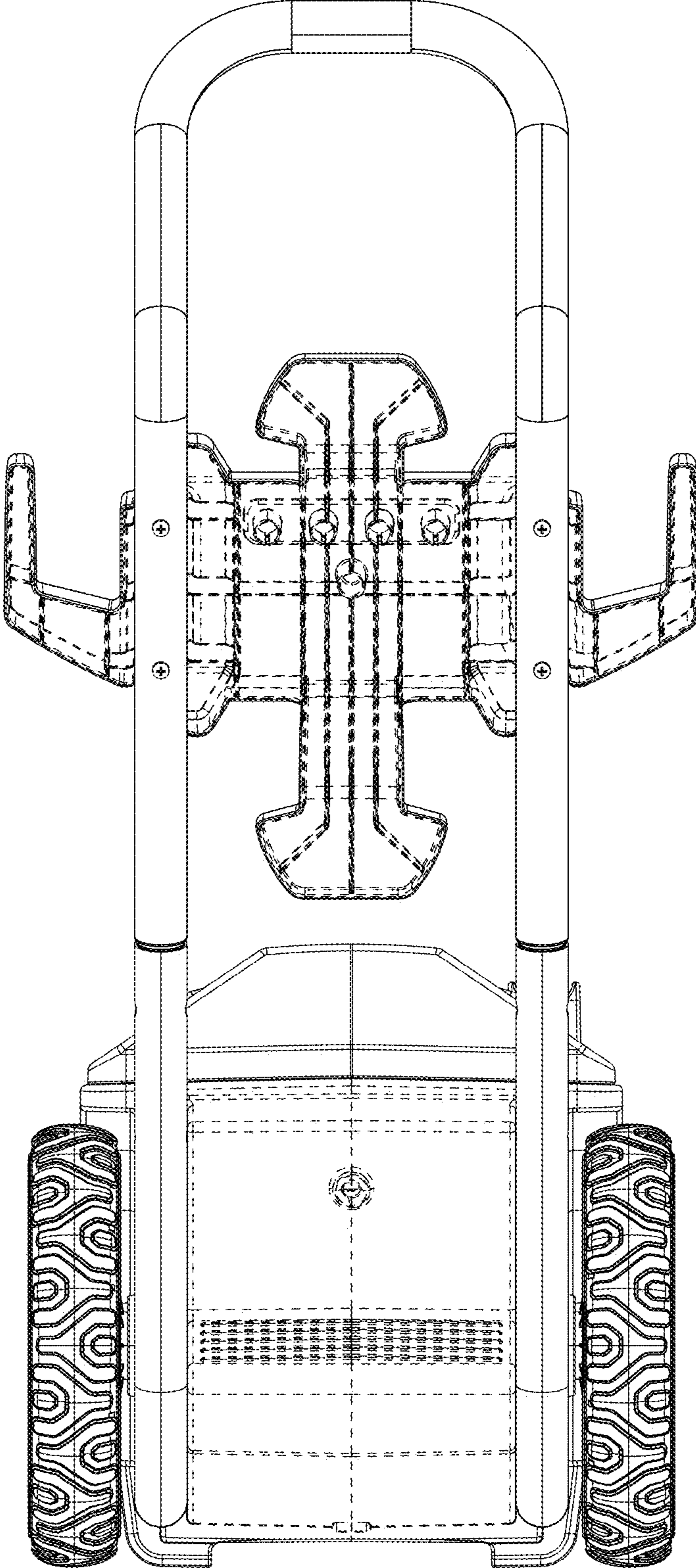

FIG. 3

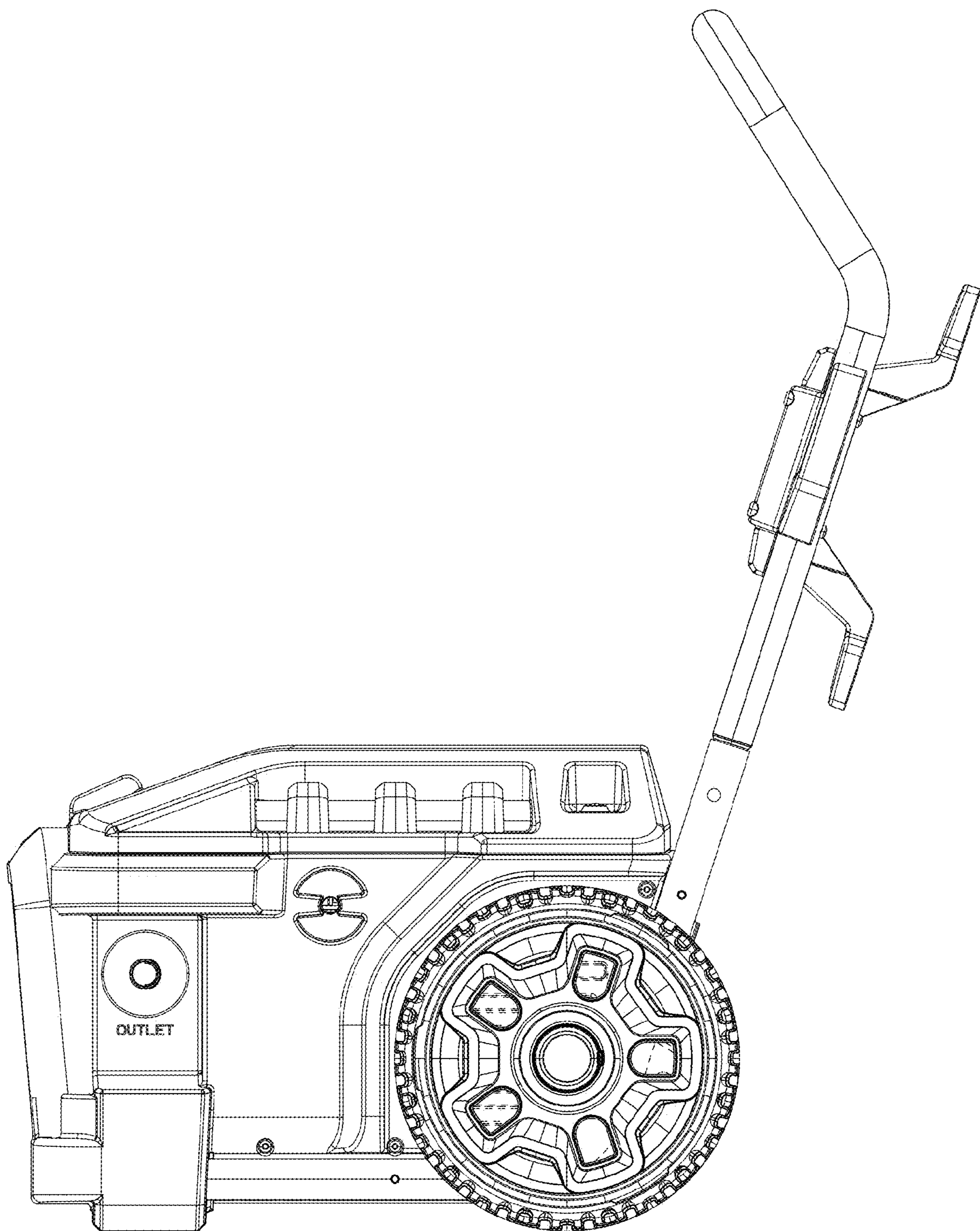

FIG. 4

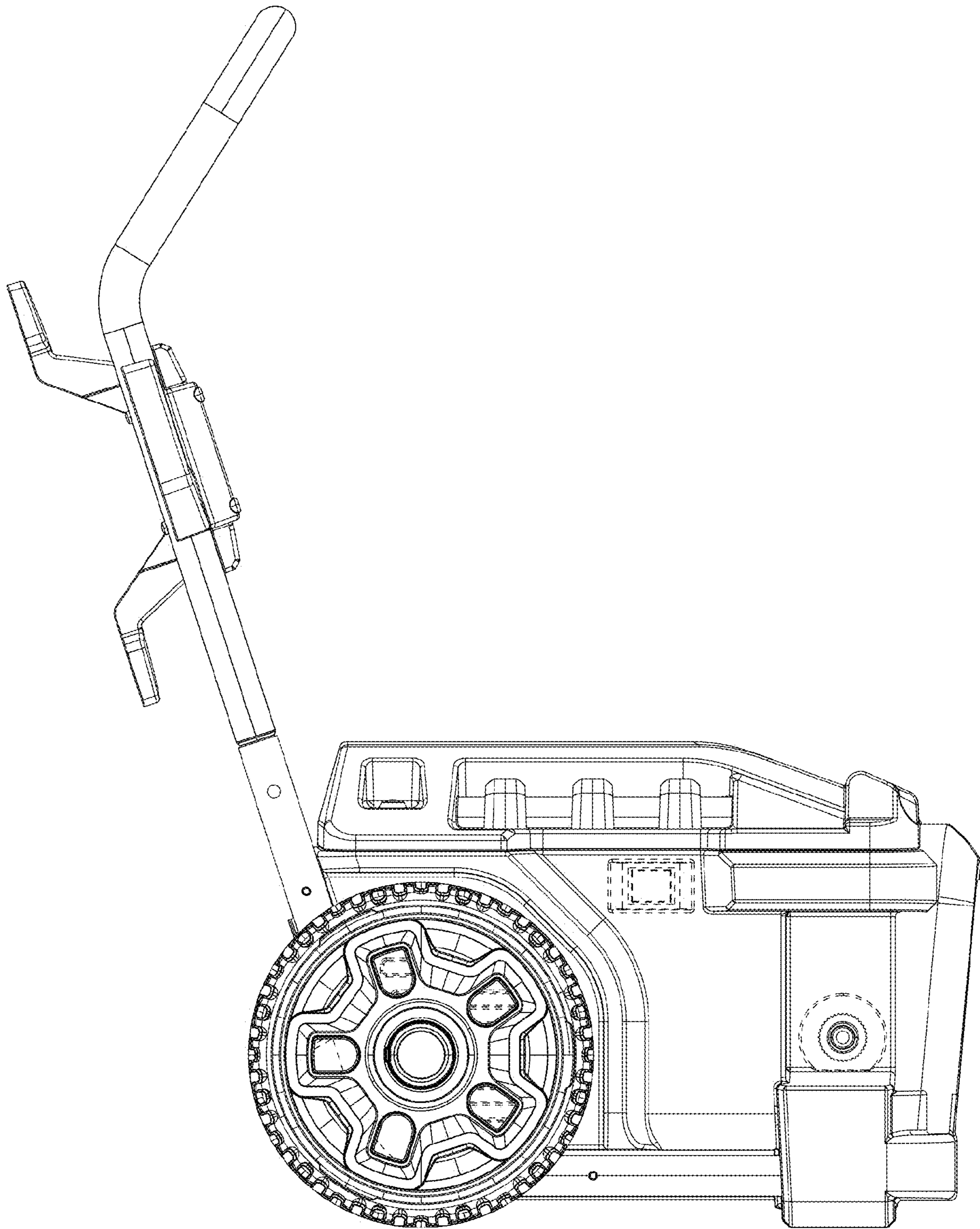

FIG. 5

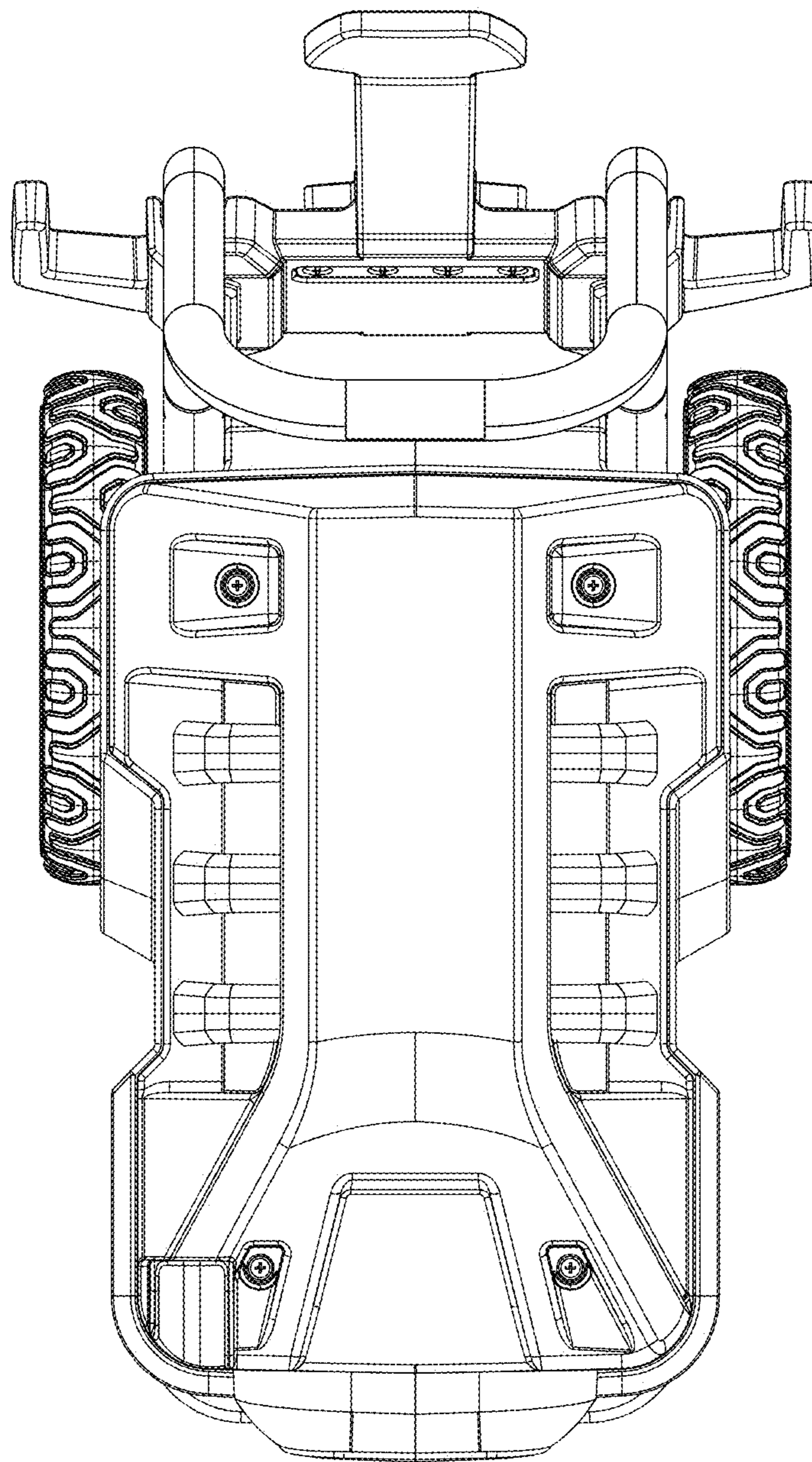

FIG. 6

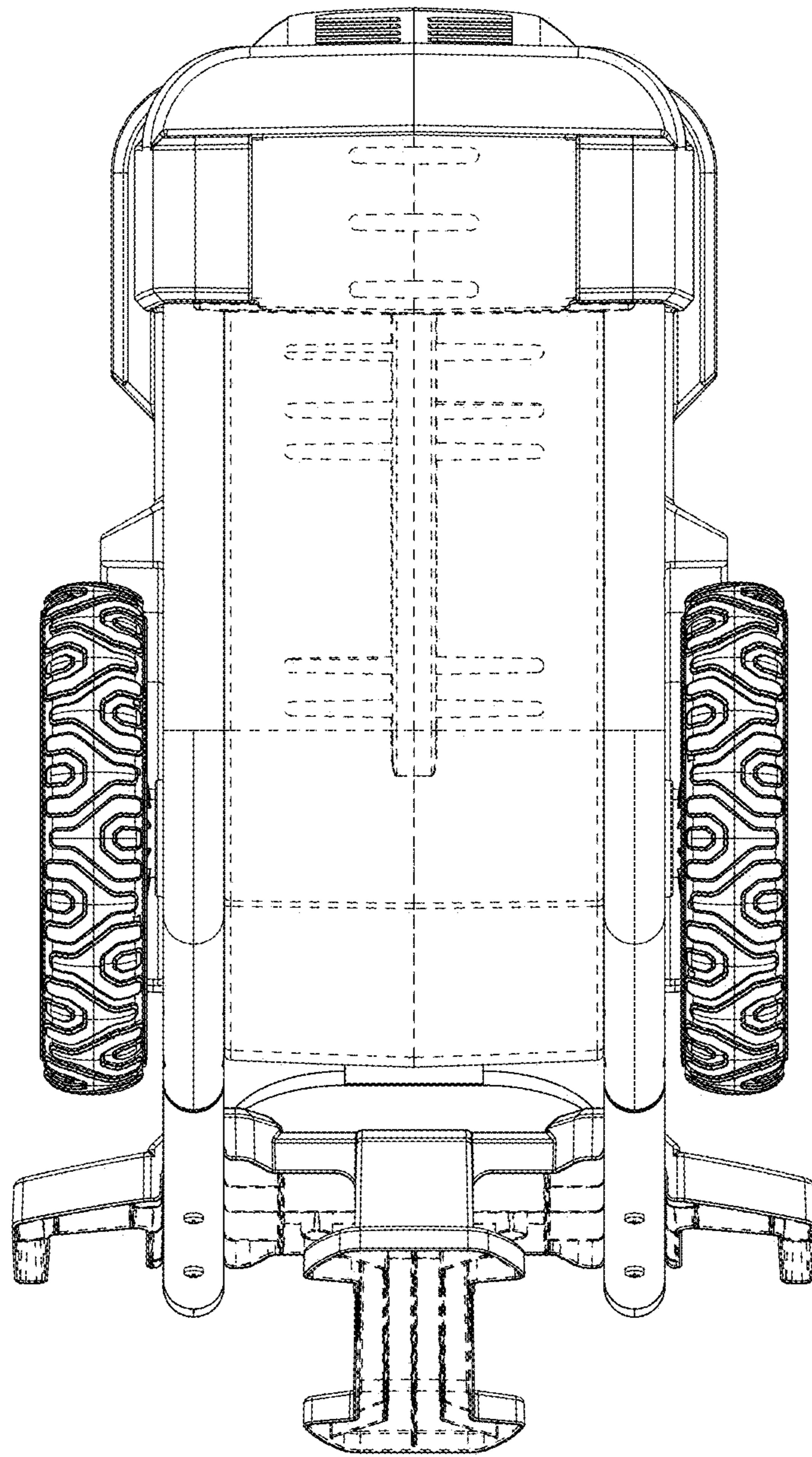

FIG. 7