



US00D919853S

(12) **United States Design Patent** (10) **Patent No.:** **US D919,853 S**  
**Kaoud et al.** (45) **Date of Patent:** **\*\* May 18, 2021**

- (54) **VEHICLE TAIL LAMP**
- (71) Applicant: **Ford Global Technologies, LLC**,  
Dearborn, MI (US)
- (72) Inventors: **Ehab N. Kaoud**, Livonia, MI (US);  
**William K. Moore**, West Bloomfield,  
MI (US); **Joshua Henry**, Detroit, MI  
(US); **Andrew Bazinski**, Ferndale, MI  
(US)
- (73) Assignee: **Ford Global Technologies, LLC**,  
Dearborn, MI (US)
- (\*\*) Term: **15 Years**
- (21) Appl. No.: **29/723,975**
- (22) Filed: **Feb. 12, 2020**
- (51) **LOC (13) Cl.** ..... **26-06**
- (52) **U.S. Cl.**  
USPC ..... **D26/28**
- (58) **Field of Classification Search**  
USPC ..... D26/28, 29, 30, 31, 32, 33, 34, 35, 36,  
D26/44  
CPC ..... F21S 48/00; F21S 48/10; F21S 48/115;  
F21S 48/225; F21S 48/1233; F21S  
48/1266; F21S 48/1388; F21S 48/2268;  
F21V 21/04; F21W 2103/35; F21W 3/40;  
F21W 2102/17; F21W 2102/30; F21W  
2103/00; F21W 2103/55; F21W 2104/00;  
F21W 2107/17; F21W 2107/13  
See application file for complete search history.

D750,291 S	2/2016	Platto	
D750,292 S	2/2016	Platto	
D771,852 S *	11/2016	Tsai	D26/28
D792,619 S *	7/2017	Wu	D26/28
D806,291 S	12/2017	Platto	
D806,292 S	12/2017	Platto	
D869,018 S *	12/2019	Dewitt	D26/28
D896,408 S *	9/2020	Gillam	D26/28
D898,959 S *	10/2020	Platto	D26/28
D902,451 S *	11/2020	Platto	D26/28
D902,453 S *	11/2020	Carbis	D26/28
D903,155 S *	11/2020	Platto	D26/28

(Continued)

**OTHER PUBLICATIONS**

Andrew Wendler, The 2021 Ford F-150, Spied Testing, Looks Pretty Evolutionary, May 8, 2019 <https://www.caranddriver.com/news/a27409108/2021-ford-f-150-pickup-spied/>.

*Primary Examiner* — Angela J Lee

(74) *Attorney, Agent, or Firm* — Michael Spenner

(57) **CLAIM**

The ornamental design for a vehicle tail lamp, as shown and described.

**DESCRIPTION**

FIG. 1 is a front elevational view of a vehicle tail lamp, showing our new design;  
FIG. 2 is a left side elevational view thereof;  
FIG. 3 is a right side elevational view thereof;  
FIG. 4 is a top plan view thereof;  
FIG. 5 is a bottom plan view thereof;  
FIG. 6 is a top, front and left side perspective view thereof; and,  
FIG. 7 is a bottom, front and left side perspective view thereof.

The claimed design is indicated by the relatively dark portions in the figures. The de-emphasized and relatively light portions form no part of the claimed design.

**1 Claim, 7 Drawing Sheets**

- (56) **References Cited**  
U.S. PATENT DOCUMENTS  
D550,382 S \* 9/2007 Ellis ..... D26/28  
D601,730 S 10/2009 Richards  
D611,175 S \* 3/2010 Elliott ..... D26/28  
D622,425 S 8/2010 Bucher  
D747,513 S \* 1/2016 Sato ..... D26/28

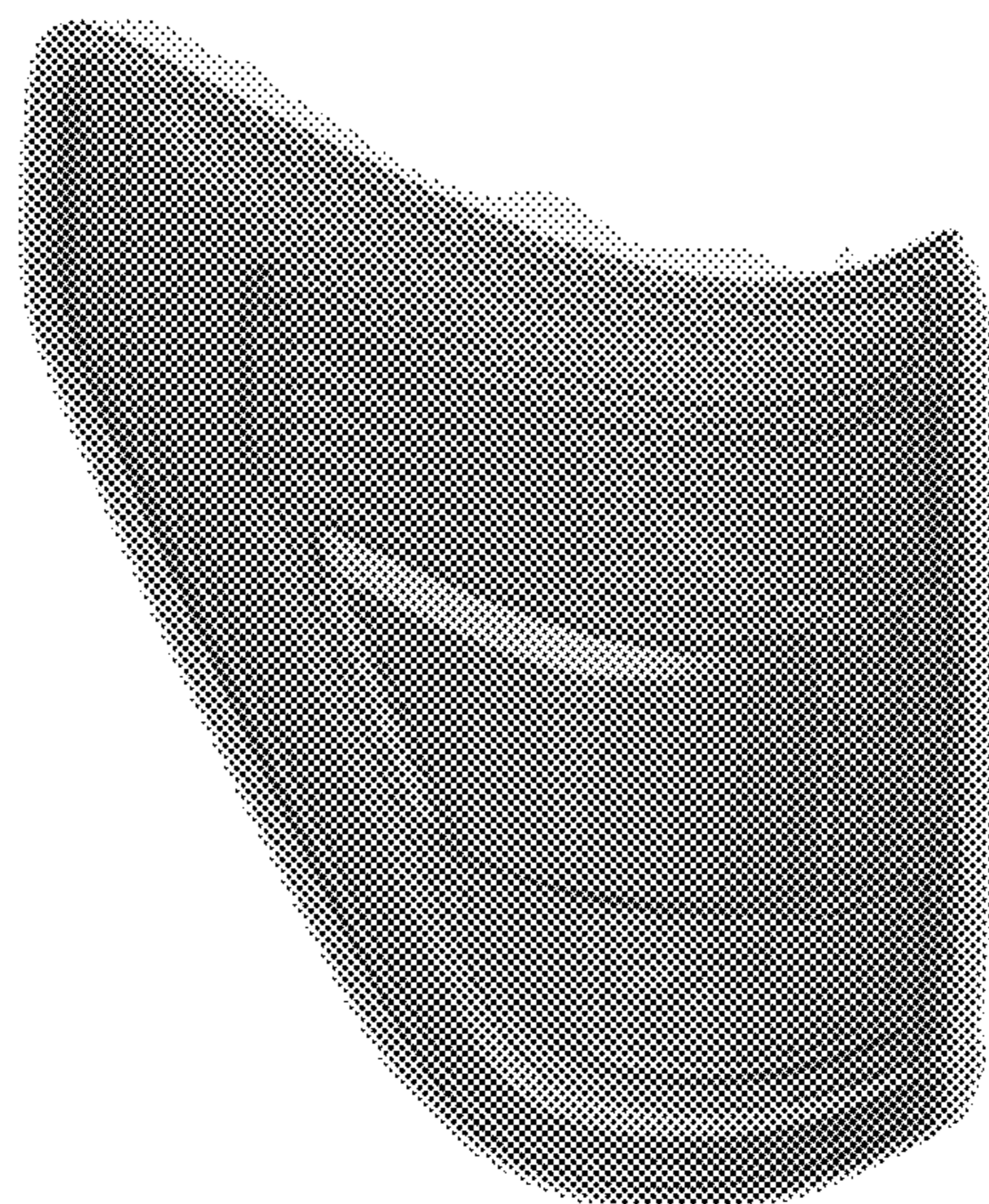

(56)

**References Cited**

U.S. PATENT DOCUMENTS

D905,301 S \* 12/2020 Wu ..... D26/28  
D907,263 S \* 1/2021 Lin ..... D26/28

\* cited by examiner

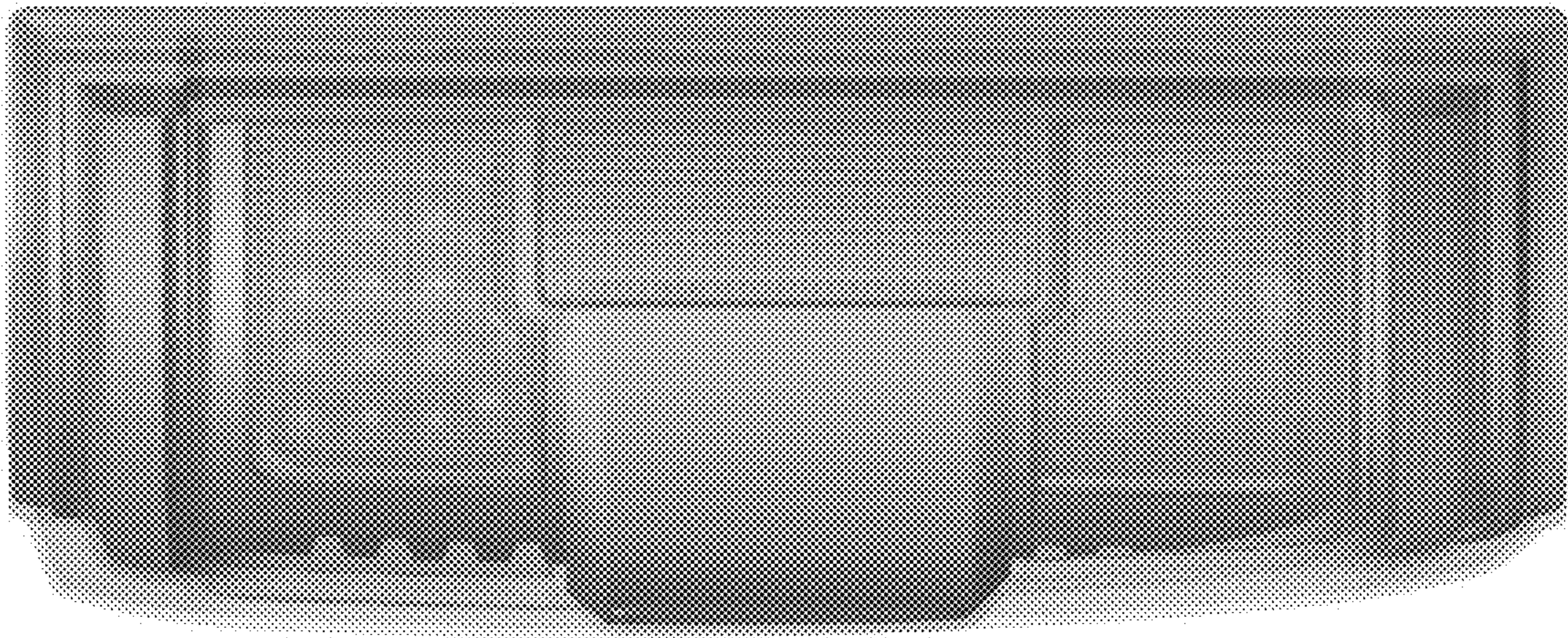
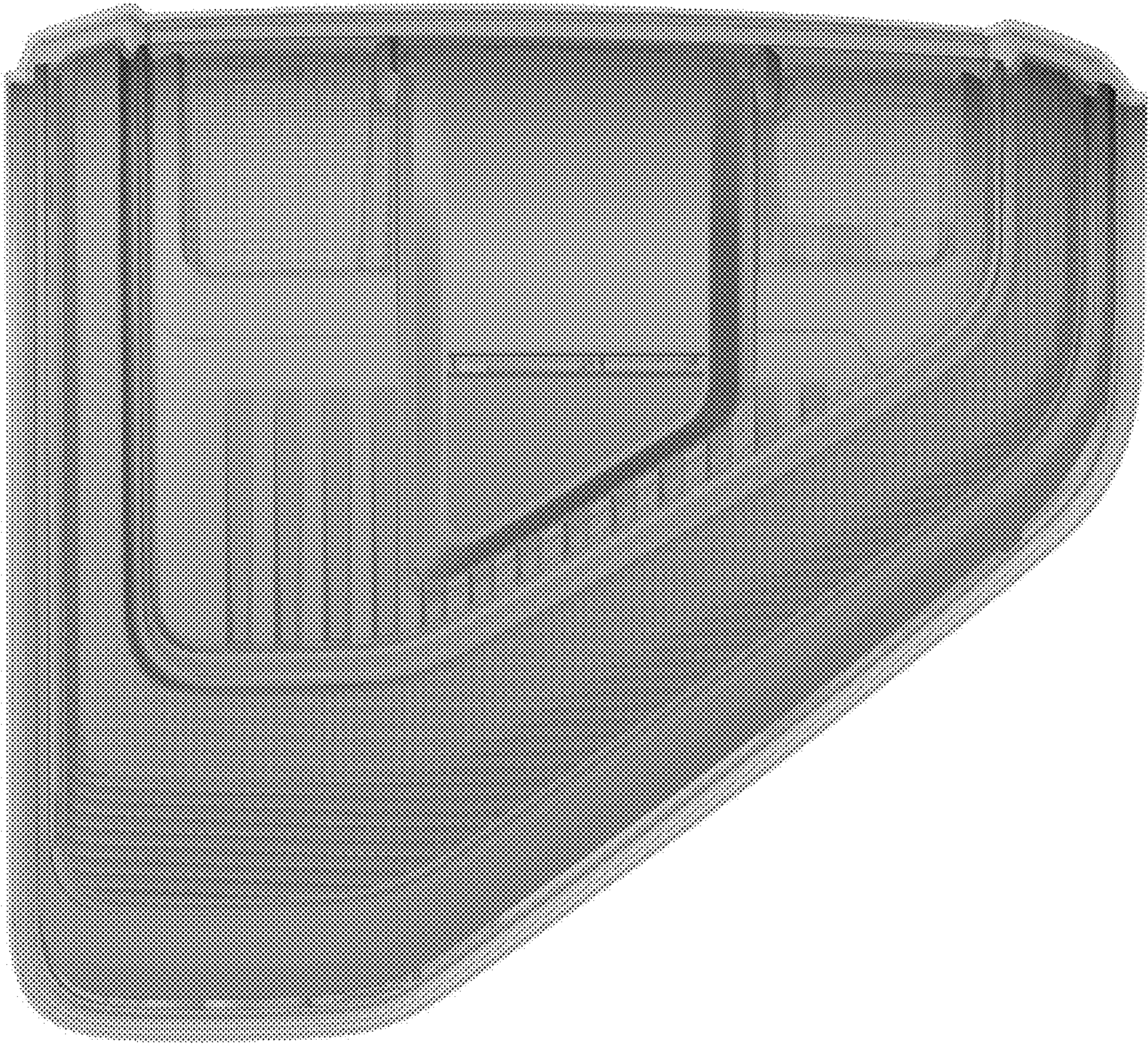

Fig. 1

Fig. 2



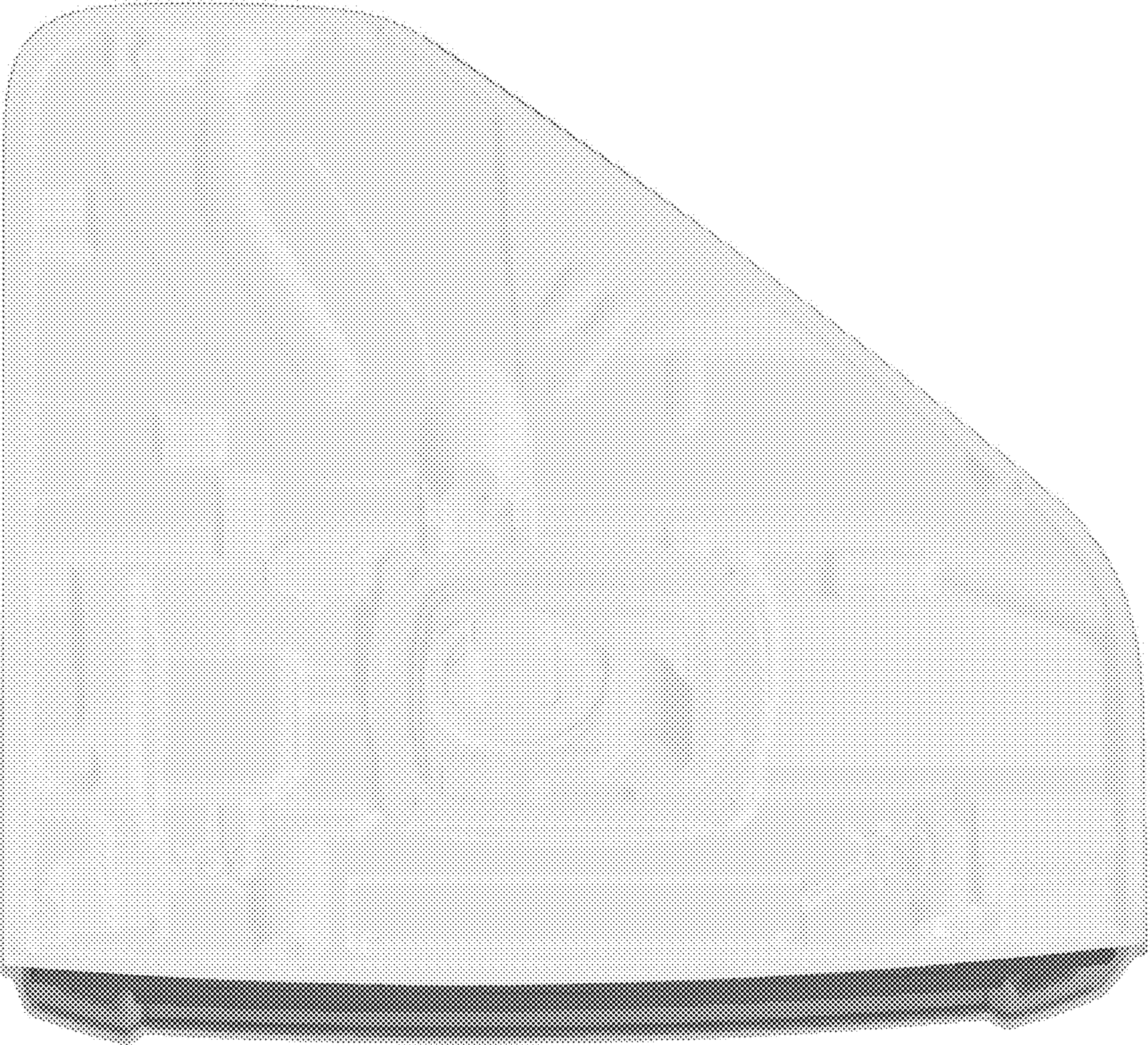

Fig. 3

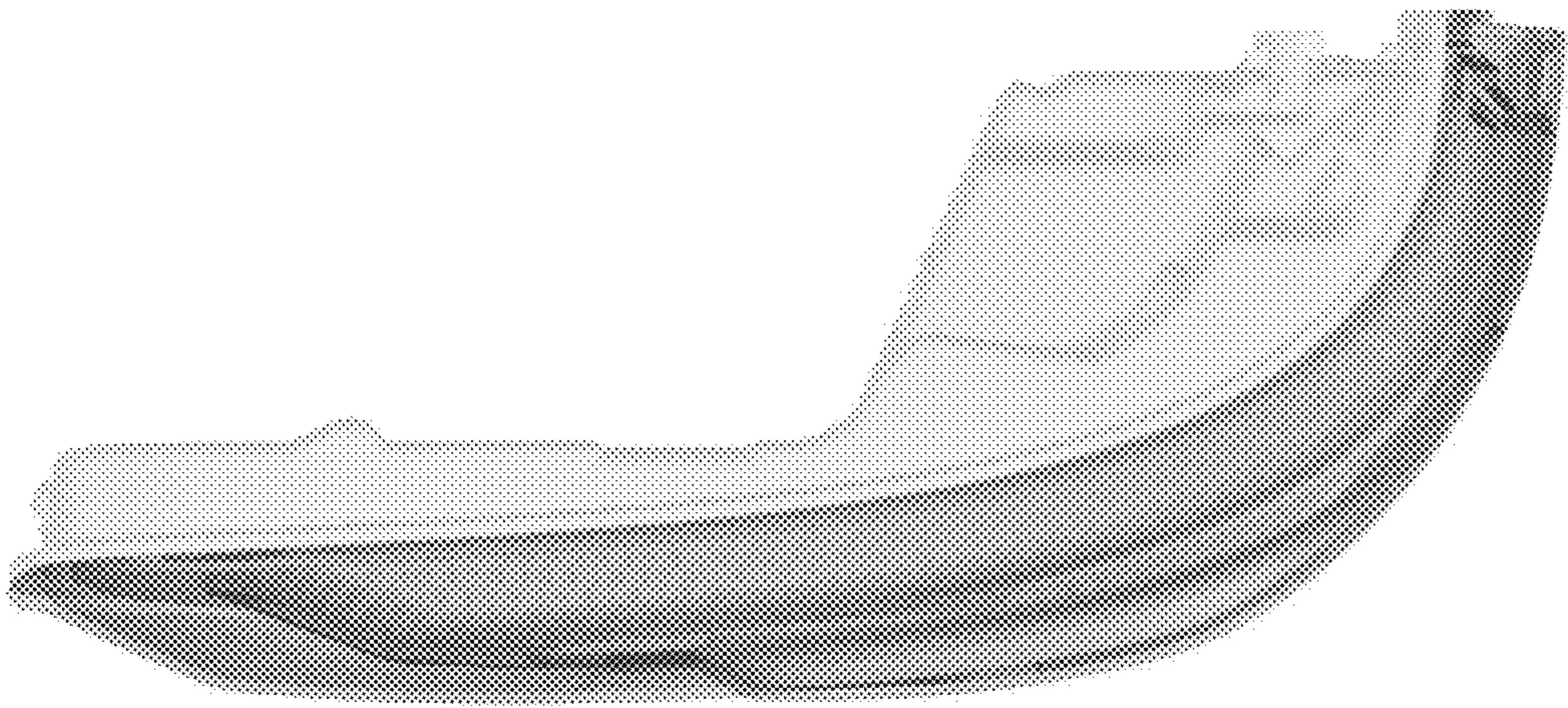

Fig. 4

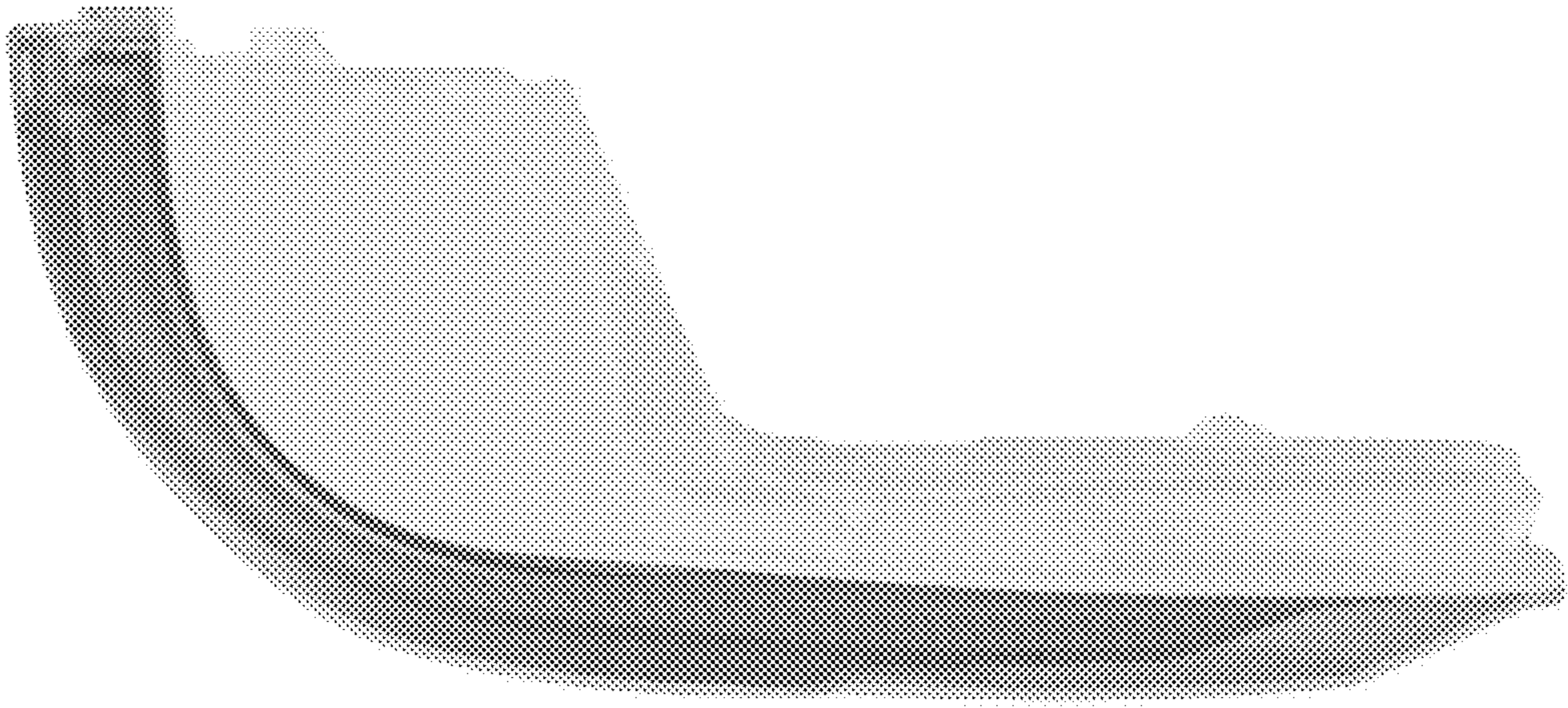

Fig. 5

Fig. 6

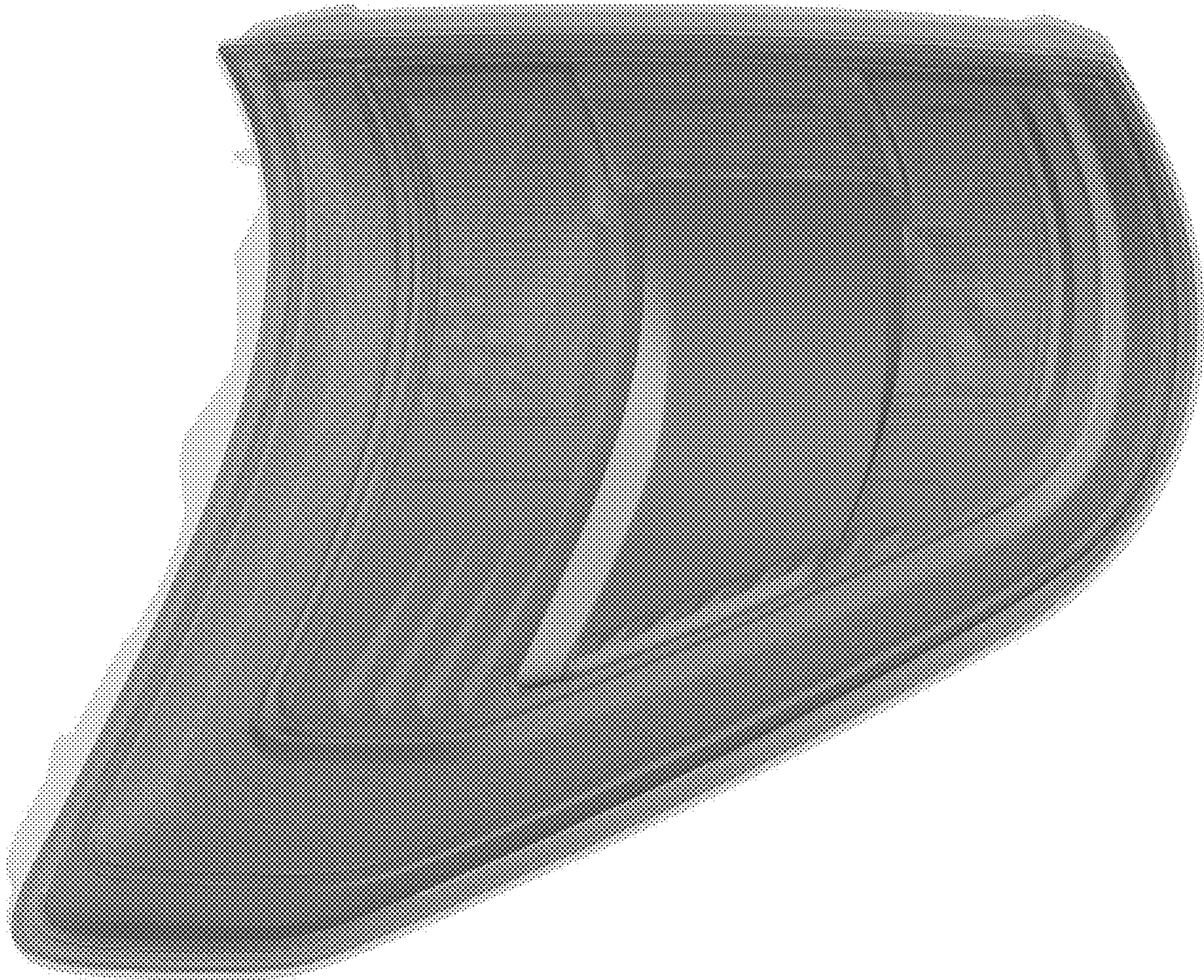



Fig. 7

