



US00D919665S

(12) **United States Design Patent** (10) **Patent No.:** **US D919,665 S**  
**Toda** (45) **Date of Patent:** **\*\* May 18, 2021**

(54) **NEEDLE VALVE FOR CARBURETORS**

(71) Applicant: **ZAMA JAPAN KABUSHIKI KAISHA**, Iwate (JP)

(72) Inventor: **Mamoru Toda**, Iwate (JP)

(73) Assignee: **ZAMA JAPAN KABUSHIKI KAISHA**, Iwate (JP)

(\*\*) Term: **15 Years**

(21) Appl. No.: **29/592,390**

(22) Filed: **Jan. 30, 2017**

(51) **LOC (13) Cl.** ..... **15-01**

(52) **U.S. Cl.**  
USPC ..... **D15/5**

(58) **Field of Classification Search**  
USPC ..... D15/5; D23/259–269, 235, 255;  
D8/382, 387  
CPC .... F02M 19/04; F02M 3/10; F02M 2003/105;  
F02M 3/14; F16K 27/0272; F16K  
27/0254  
See application file for complete search history.

(56) **References Cited**

**U.S. PATENT DOCUMENTS**

- D170,313 S \* 9/1953 Franck ..... 15/5
- 3,090,108 A \* 5/1963 Gifford ..... B29C 45/14  
29/890.127
- 4,116,417 A \* 9/1978 Larsen ..... A01C 23/042  
137/605
- 4,269,387 A \* 5/1981 Reynolds ..... A61B 5/0215  
251/122
- D263,711 S \* 4/1982 Dean ..... 239/533.3
- 5,984,281 A \* 11/1999 Hacker ..... F02B 63/02  
137/382
- D818,356 S \* 5/2018 Sears ..... D8/387

- D821,187 S \* 6/2018 Baiz ..... D8/387
- D848,486 S \* 5/2019 Tamura ..... D15/5
- 2003/0116734 A1 \* 6/2003 Casar ..... 251/69
- 2004/0007788 A1 \* 1/2004 Vimercati ..... F02M 3/10  
261/71
- 2012/0024411 A1 \* 2/2012 Hahn ..... G01N 30/6039  
138/109

\* cited by examiner

*Primary Examiner* — Ania Aman

(74) *Attorney, Agent, or Firm* — One LLP

(57) **CLAIM**

The ornamental design for a needle valve for carburetors, as shown and described.

**DESCRIPTION**

FIG. 1 is a top, plan view of the needle valve for carburetors, showing the new design;  
 FIG. 2 is a front, end elevation view of the needle valve for carburetors from FIG. 1;  
 FIG. 3 is a rear, end elevation view of the needle valve for carburetors from FIG. 1;  
 FIG. 4 is a right side, plan view of the needle valve for carburetors from FIG. 1;  
 FIG. 5 is a left side, plan view of the needle valve for carburetors from FIG. 1;  
 FIG. 6 is a perspective view of the needle valve for carburetors from FIG. 1; and,  
 FIG. 7 is an exploded assembly perspective view thereof, showing the new design in a state of use with a carburetor and a tool.  
 In the drawings, the broken lines depict environmental subject matter only and form no part of the claimed design.

**1 Claim, 6 Drawing Sheets**

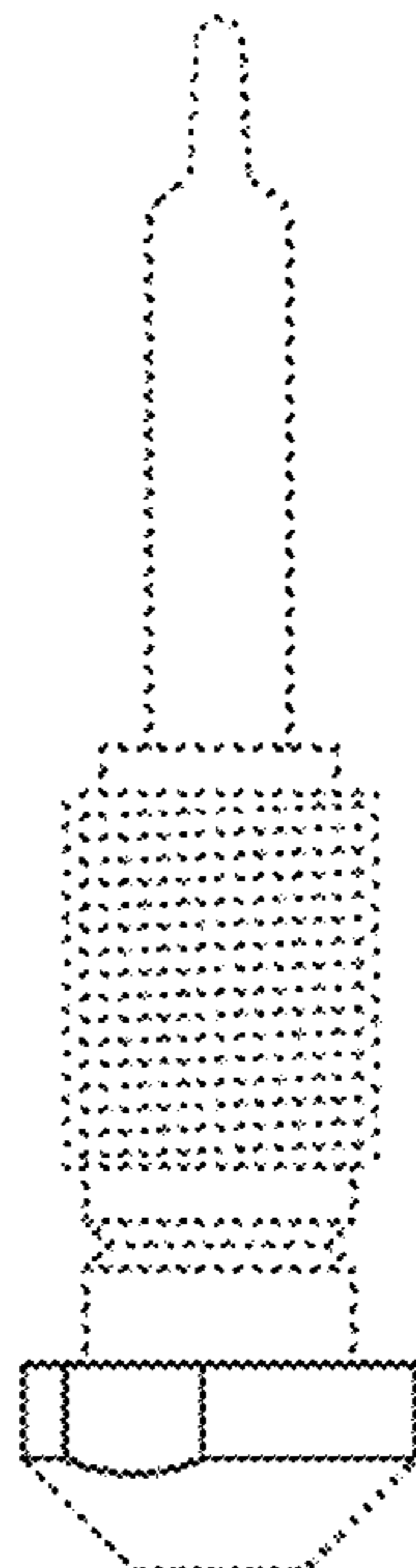

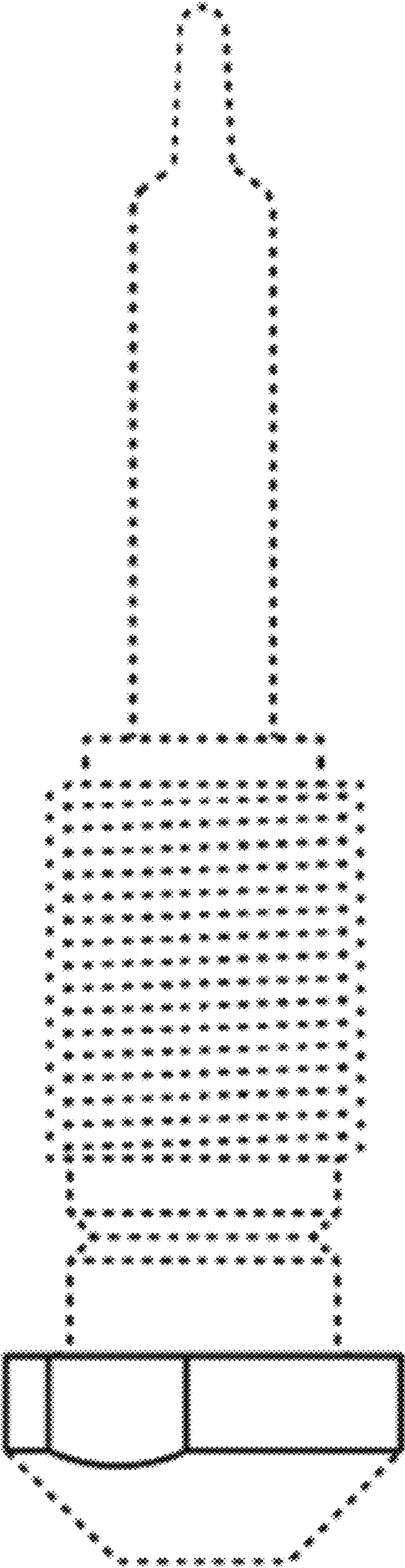

FIG. 1

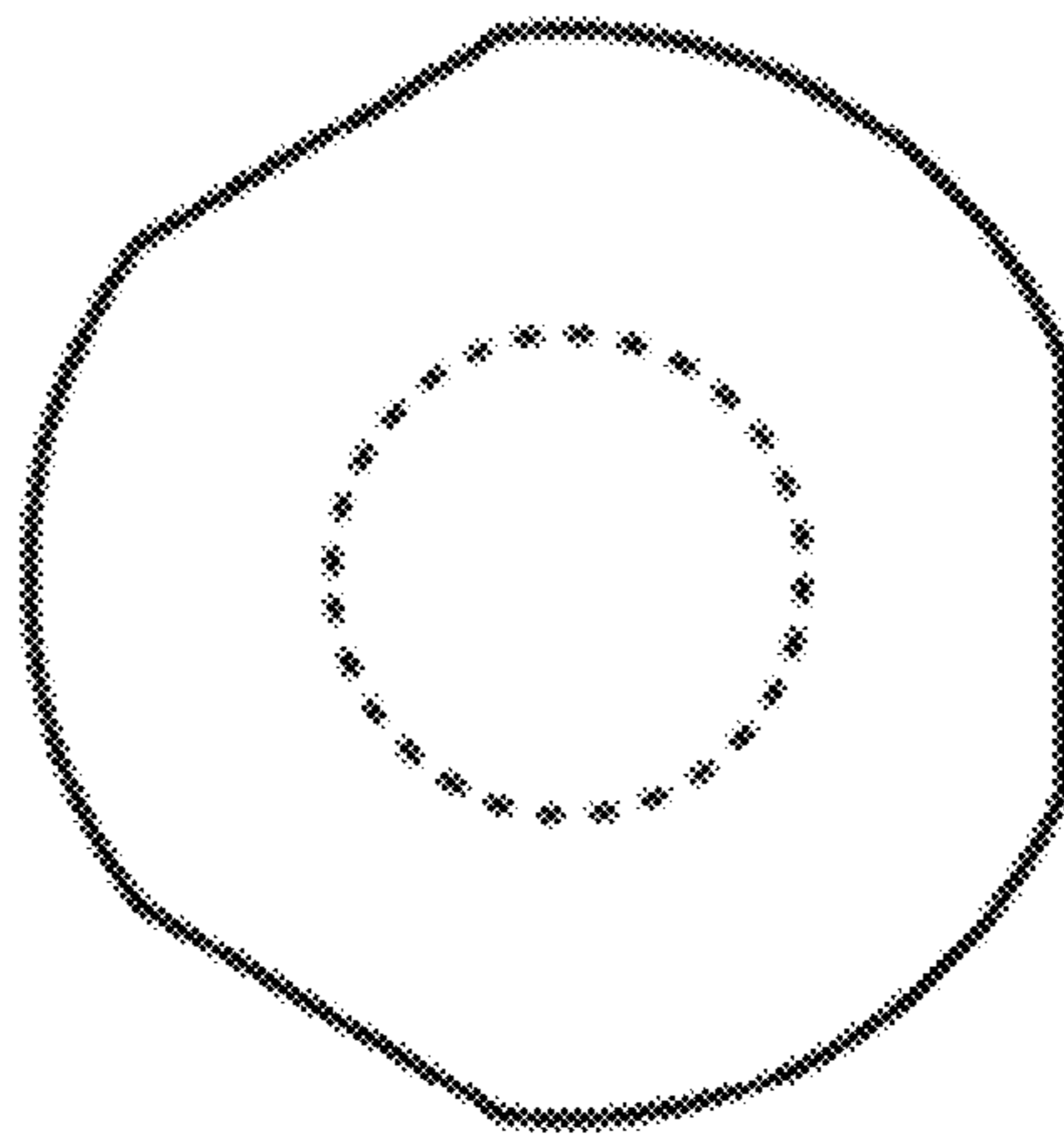
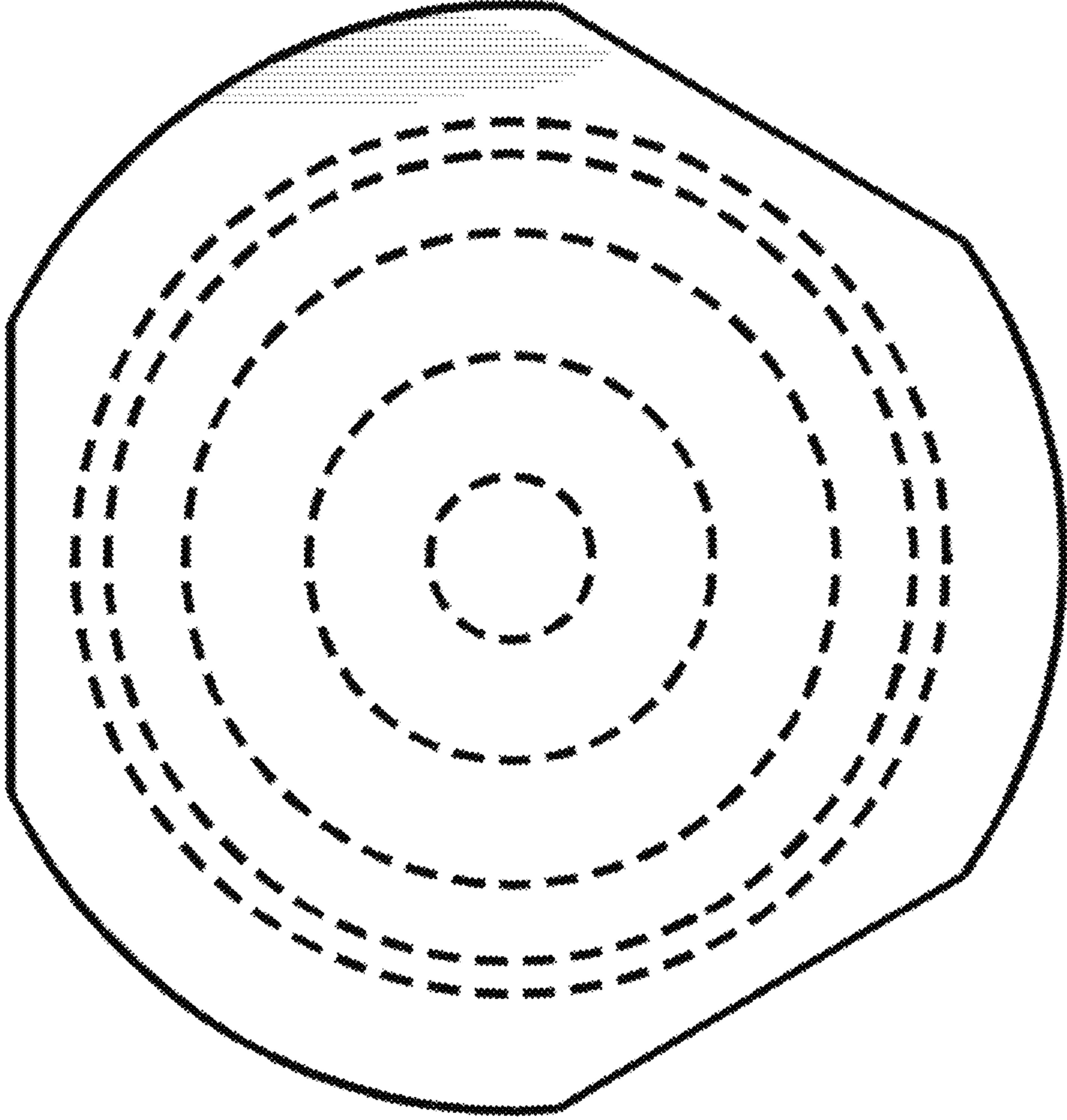

FIG. 2



*FIG. 3*

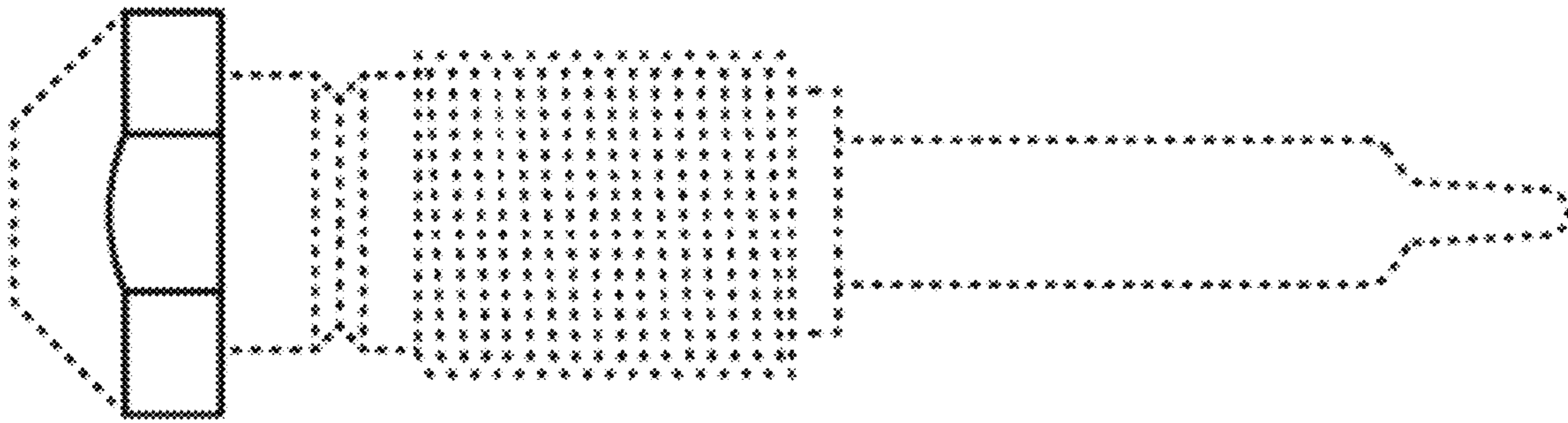

FIG. 4

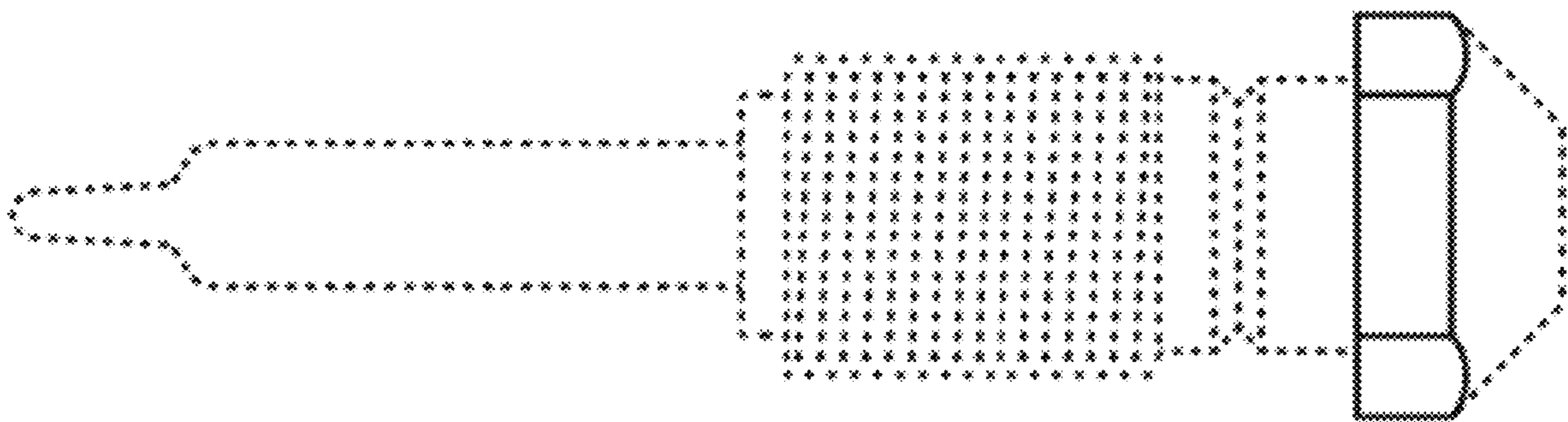

FIG. 5

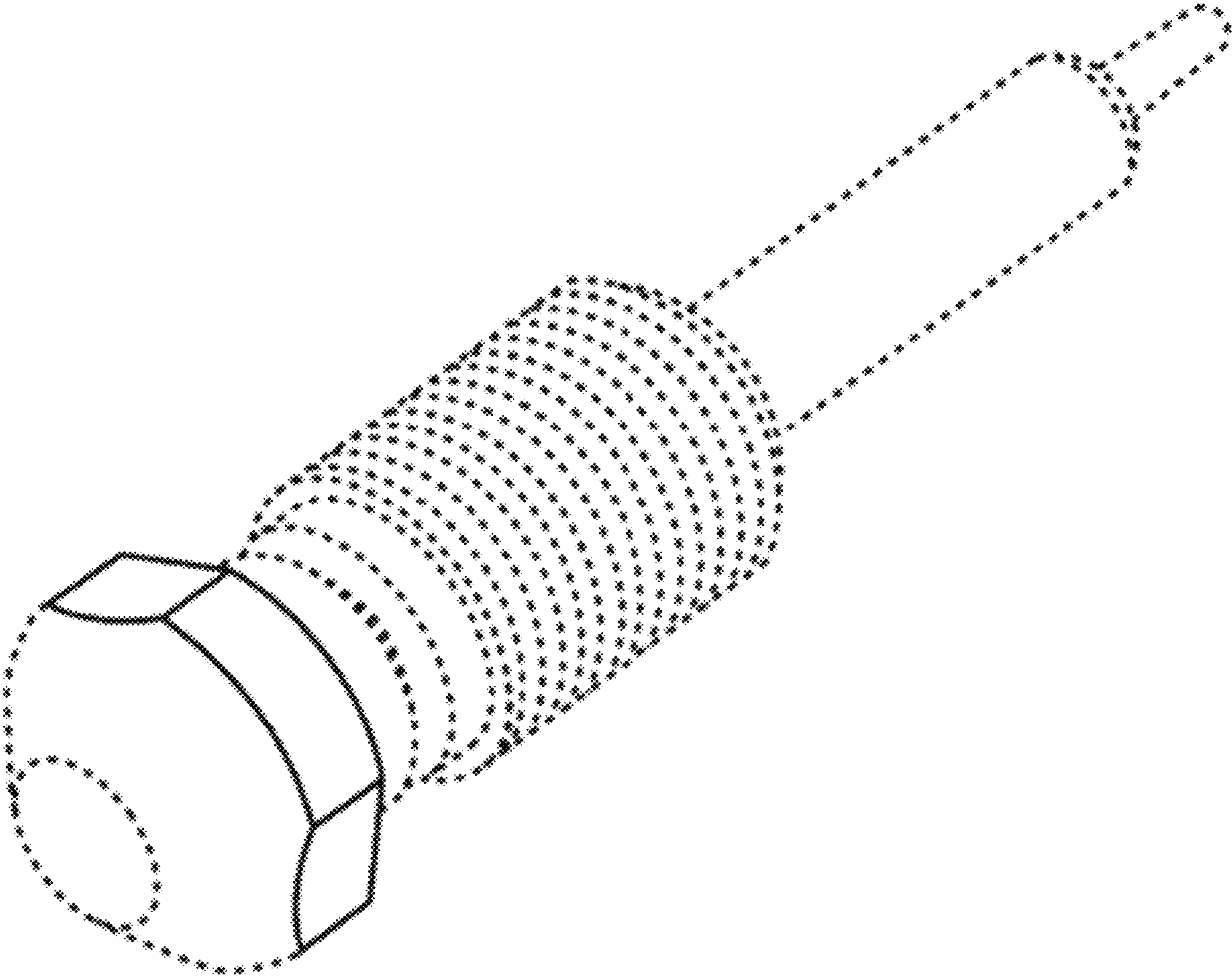

FIG. 6

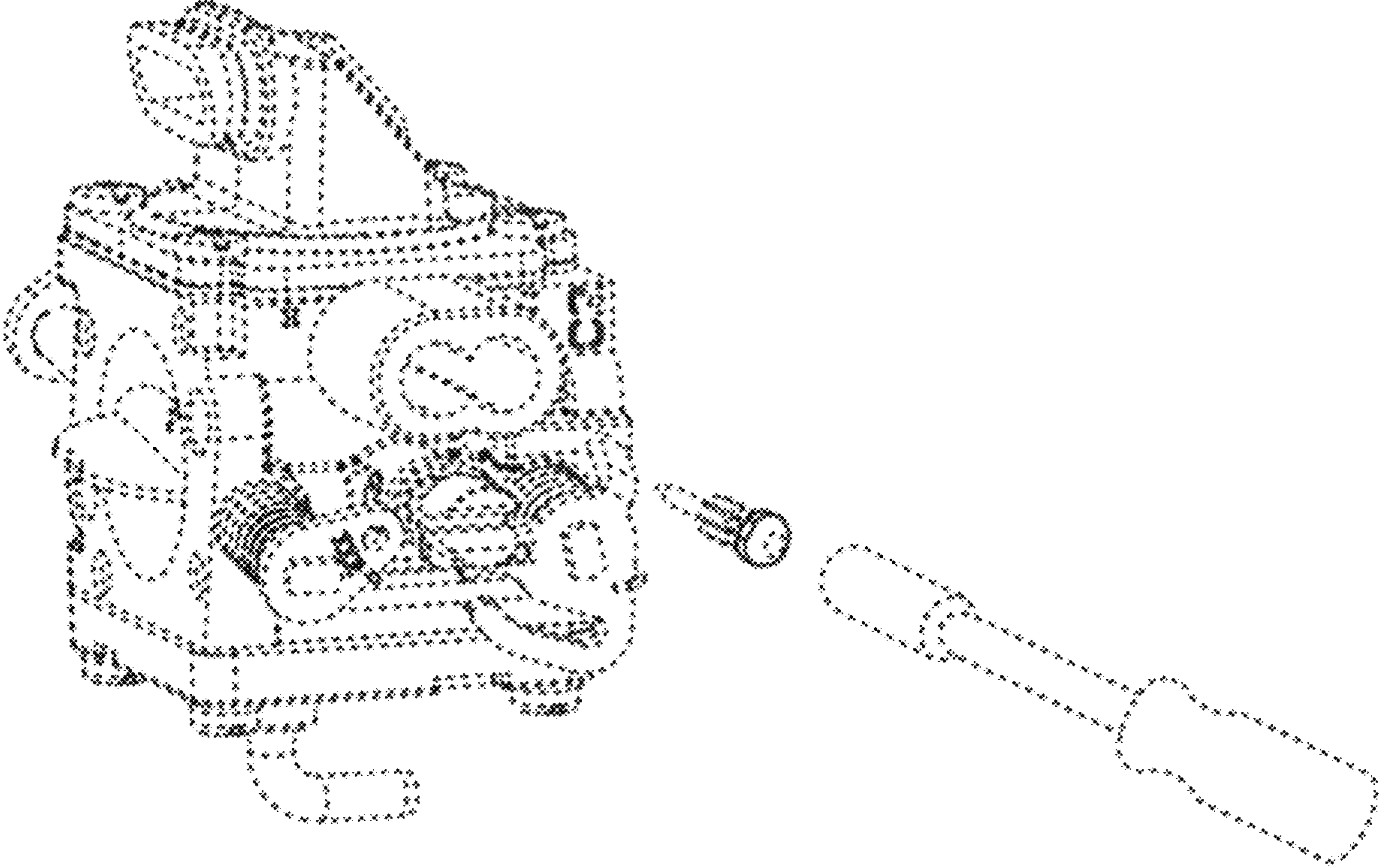

FIG. 7