



US00D918680S

(12) **United States Design Patent** (10) **Patent No.:** **US D918,680 S**  
**Crisp** (45) **Date of Patent:** **\*\* May 11, 2021**

(54) **LOCATION MARKER STAKE**

(71) Applicant: **Joe E Crisp**, Sevierville, TN (US)

(72) Inventor: **Joe E Crisp**, Sevierville, TN (US)

(\*\*) Term: **15 Years**

(21) Appl. No.: **29/685,384**

(22) Filed: **Mar. 28, 2019**

(51) **LOC (13) Cl.** ..... **08-01**

(52) **U.S. Cl.**  
USPC ..... **D8/1; D21/840**

(58) **Field of Classification Search**  
USPC ..... D8/1, 107, 154, 387, 391; D30/154;  
D21/840

CPC ..... E02D 27/00; G01C 15/04; A63C 19/06;  
A63C 19/062; E04H 15/62

See application file for complete search history.

(56) **References Cited**

**U.S. PATENT DOCUMENTS**

D331,526 S *	12/1992	Miller	.....	D8/1
5,687,910 A *	11/1997	King	.....	B05B 15/622
				239/276
D535,864 S *	1/2007	Suzuki	.....	D8/107
7,631,447 B2 *	12/2009	Morton	.....	G09F 15/00
				116/209
D655,584 S *	3/2012	Katzin	.....	F16B 25/0015
				D8/1
D734,998 S *	7/2015	Yang	.....	D8/1
D799,938 S *	10/2017	Lowitz	.....	G09F 15/00
				D8/354
D804,288 S *	12/2017	Keith	.....	F16B 25/0015
				D8/354
D884,466 S *	5/2020	Ryan	.....	D8/387

**OTHER PUBLICATIONS**

shopmtnmold.com, RebarLite Location Marking Stake, undated online product page, retrieved Dec. 2, 2020 from <URL: https://shop.mtnmold.com/products/rebarlite-location-marking-stake-1-slash-2-x-12-star-box-of-10-sta> (Year: 2020).\*

\* cited by examiner

*Primary Examiner* — Sheryl Lane

*Assistant Examiner* — Calvin E Vansant

(57) **CLAIM**

The ornamental design for a location marker stake, as shown and described.

**DESCRIPTION**

FIG. 1 is a prospective view of a location marker stake showing my new design;

FIG. 2 is a left side elevational view thereof;

FIG. 3 is a cross-section view thereof taken along the line 3-3 of FIG. 5;

FIG. 4 is a right side elevational view thereof;

FIG. 5 is a top plan view thereof;

FIG. 6 is a front plan thereof;

FIG. 7 is a enlarged view thereof taken within the circle 7 of FIG. 6;

FIG. 8 is a enlarged top plan view thereof; and,

FIG. 9 is a cross-section view thereof taken along the line 9-9 of FIG. 8.

The dot-dash broken lines in the figures represent the boundary of the claimed design or the boundary of an enlarged area and form no part of the claimed design.

The broken lines depict boundaries of the enlarged areas of the drawing and form no part of the claim.

**1 Claim, 3 Drawing Sheets**



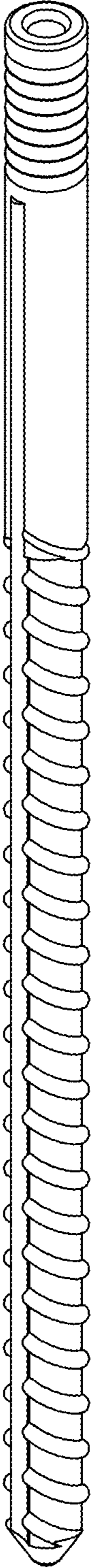

FIG. 1

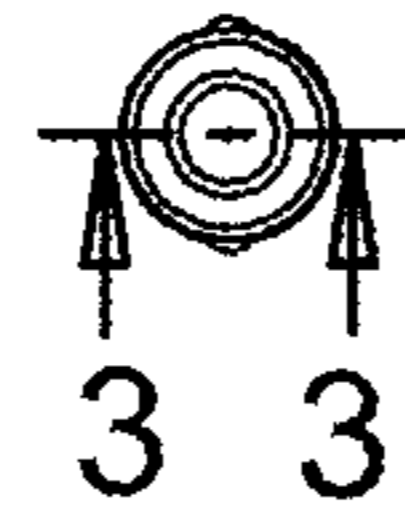

FIG. 5



FIG. 2



FIG. 3



FIG. 4

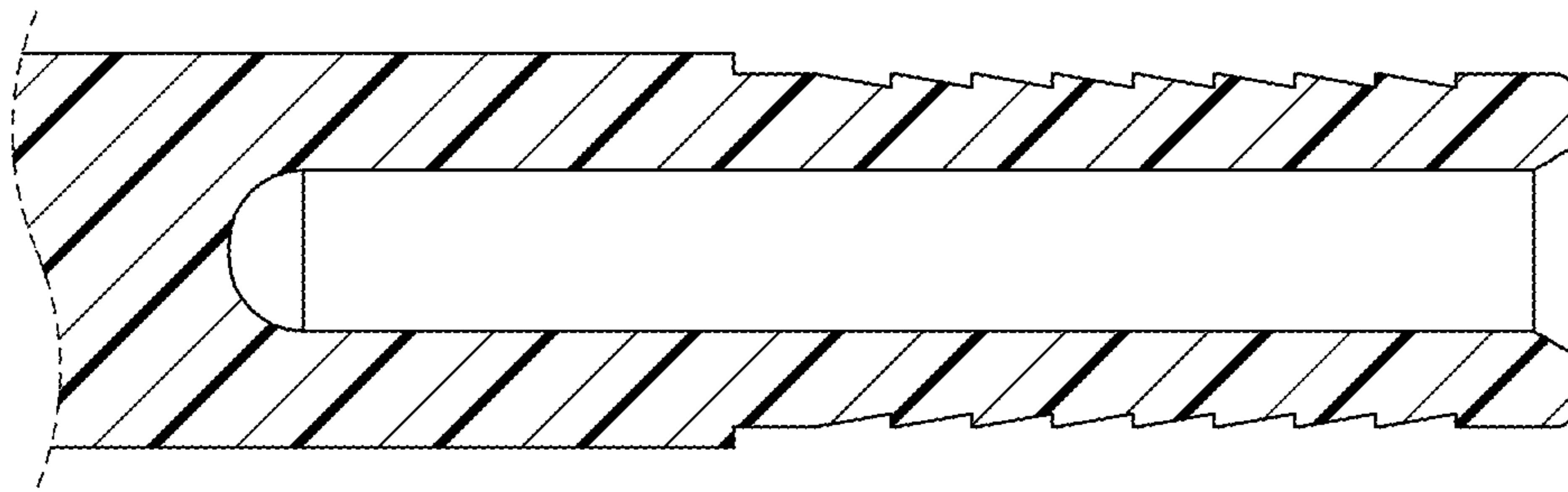

FIG. 9

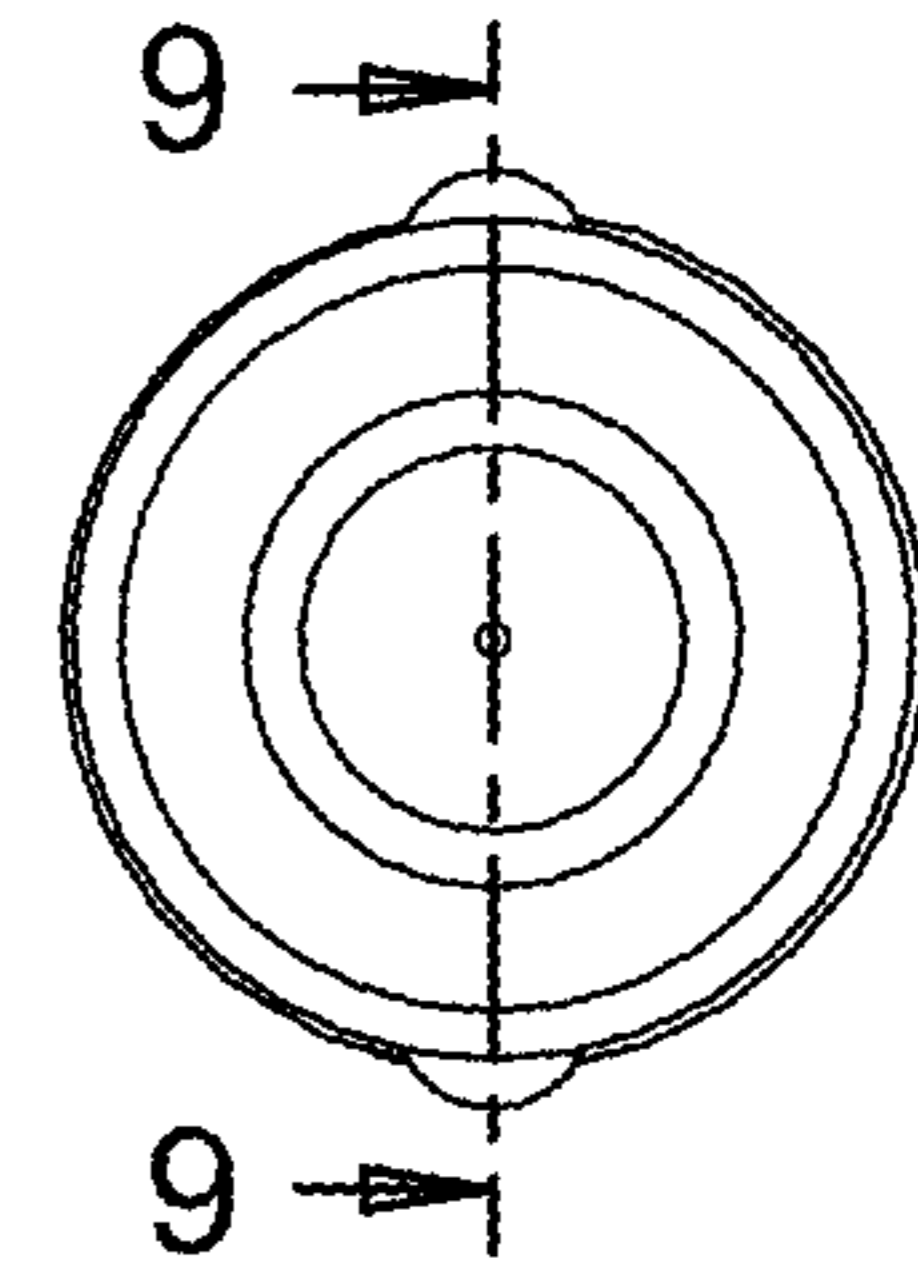

FIG. 8

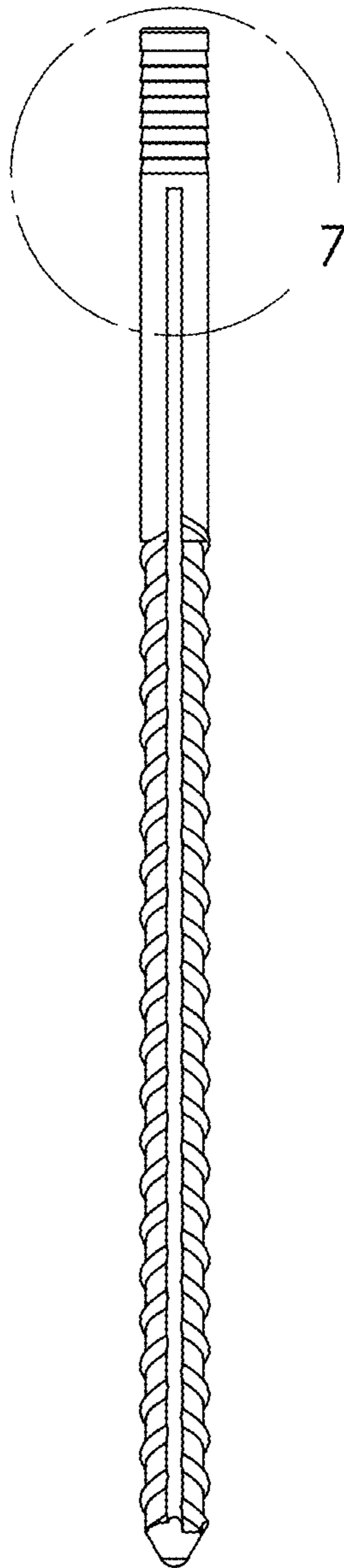

FIG. 6

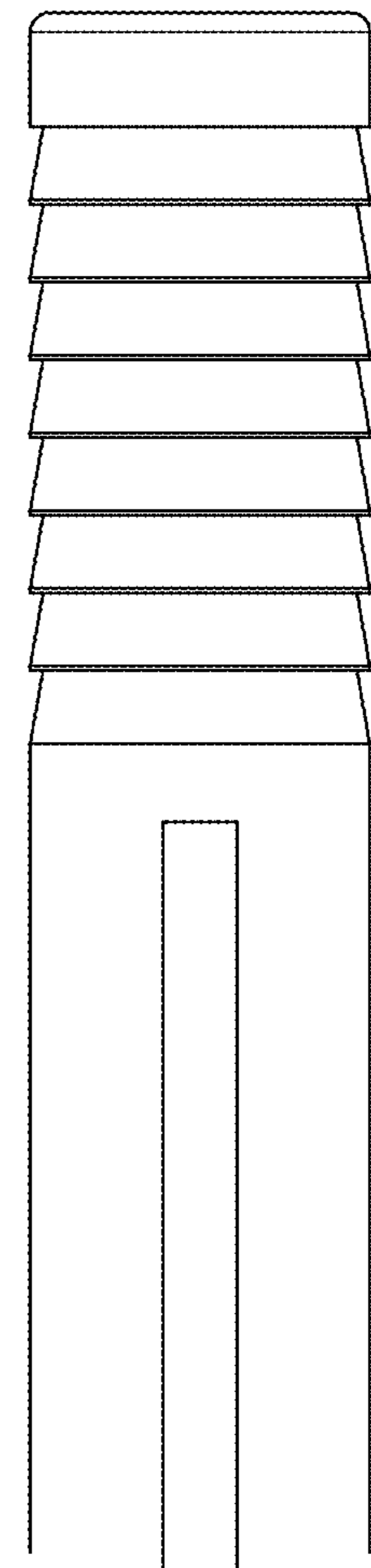

FIG. 7