



US00D916336S

(12) **United States Design Patent** (10) **Patent No.:** **US D916,336 S**  
**Wraith et al.** (45) **Date of Patent:** **\*\* Apr. 13, 2021**

(54) **VEHICLE TAIL LAMP**

(71) Applicant: **Ford Global Technologies, LLC**,  
Dearborn, MI (US)

(72) Inventors: **Paul Wraith**, West Bloomfield, MI  
(US); **Daniel J. Kangas**, Livonia, MI  
(US); **Anthony Meyer**, Royal Oak, MI  
(US); **Martin B. Coons**, Detroit, MI  
(US); **Dong Hoon Park**, Canton, MI  
(US); **Daniel C. Broaddus**, Novi, MI  
(US)

(73) Assignee: **Ford Global Technologies, LLC**,  
Dearborn, MI (US)

(\*\*) Term: **15 Years**

(21) Appl. No.: **29/711,436**

(22) Filed: **Oct. 31, 2019**

(51) **LOC (13) Cl.** ..... **26-06**

(52) **U.S. Cl.**  
USPC ..... **D26/28**

(58) **Field of Classification Search**  
USPC ..... D26/28-36, 139  
CPC ..... F21S 48/00; F21S 48/10; F21S 48/115;  
F21S 48/225; F21S 48/1233; F21S  
48/1266; F21S 48/1388; F21S 48/2268;  
F21V 5/00; B60Q 9/13; B60Q 9/135;  
B60Q 9/1375; F21K 9/00; F21K 13/00

See application file for complete search history.

(56) **References Cited**

U.S. PATENT DOCUMENTS

D498,013 S *	11/2004	Pfeiffer	.....	D26/28
D523,976 S *	6/2006	Pfeiffer	.....	D26/28
D539,450 S *	3/2007	Pfeiffer	.....	D26/28
D549,363 S *	8/2007	Pfeiffer	.....	D26/28
D686,764 S *	7/2013	Hamilton	.....	D26/28

\* cited by examiner

*Primary Examiner* — Marcus A Jackson

(74) *Attorney, Agent, or Firm* — Michael Spenner

(57) **CLAIM**

The ornamental design for a vehicle tail lamp, as shown and described.

**DESCRIPTION**

FIG. 1 is a front elevational view of a vehicle tail lamp, showing our new design;  
 FIG. 2 is a rear elevational view thereof;  
 FIG. 3 is a left side elevational view thereof;  
 FIG. 4 is a right side elevational view thereof;  
 FIG. 5 is a top plan view thereof;  
 FIG. 6 is a bottom plan view thereof;  
 FIG. 7 is a top, front and left side perspective view thereof;  
 and,  
 FIG. 8 is a bottom, front and left side perspective view thereof.

**1 Claim, 8 Drawing Sheets**

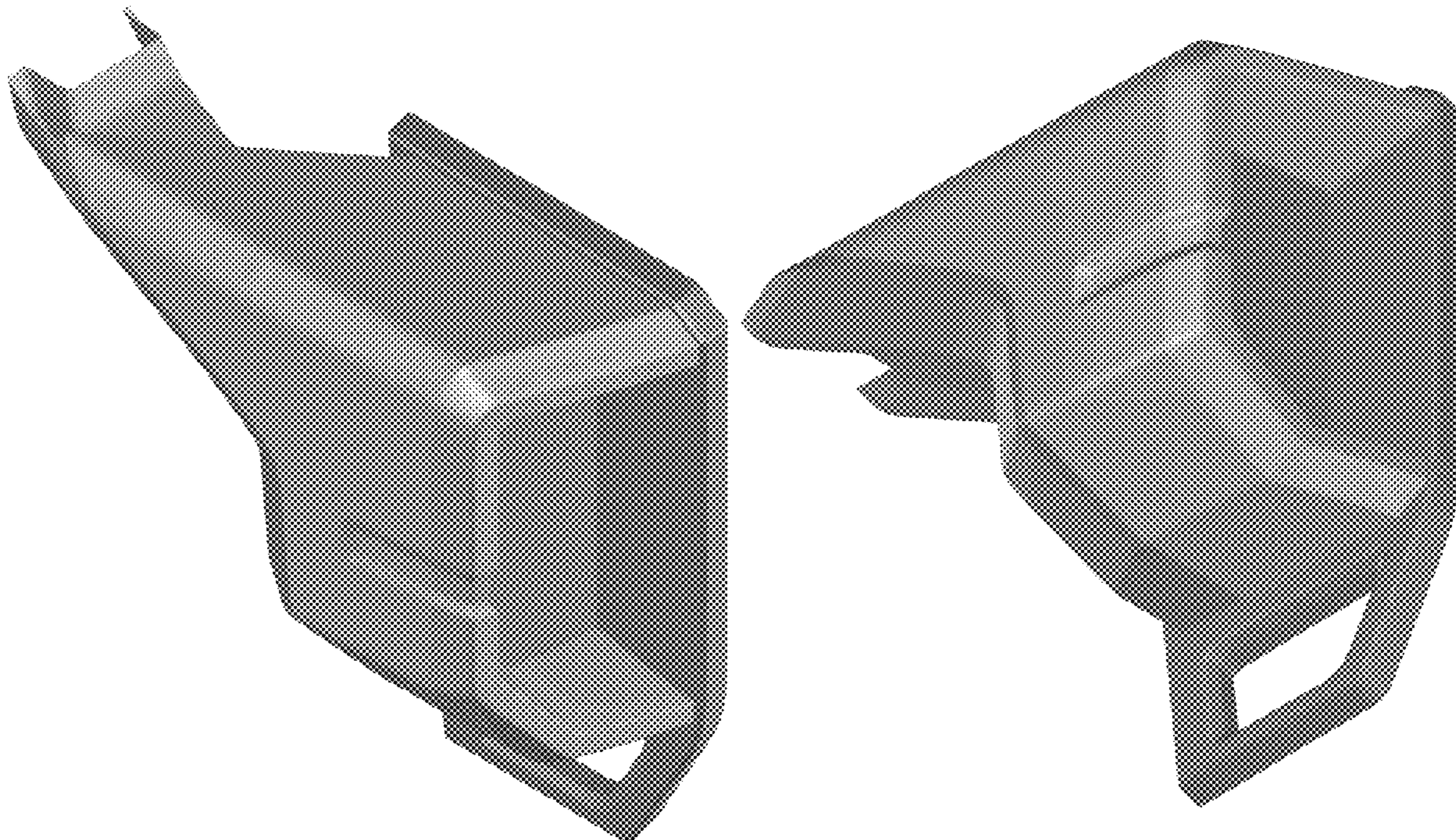

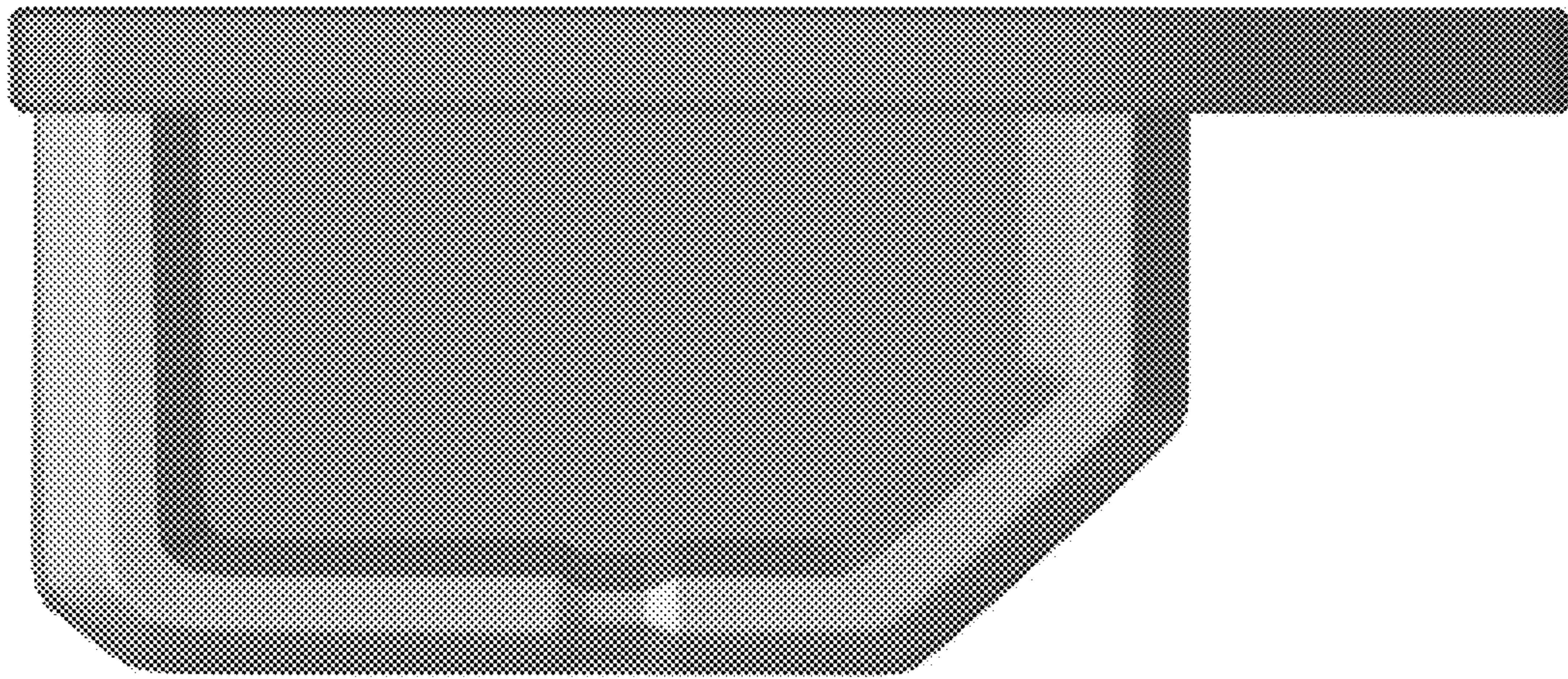

Fig. 1

Fig. 2

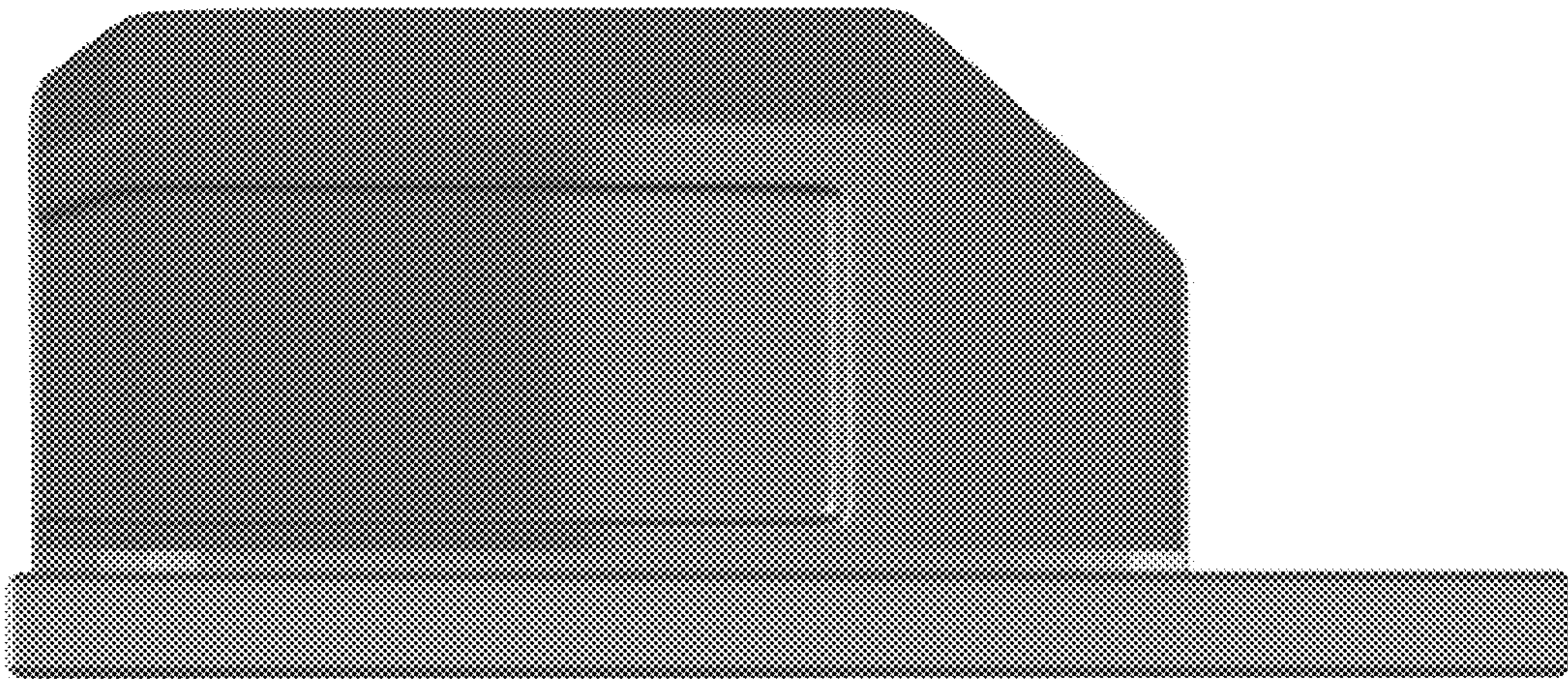
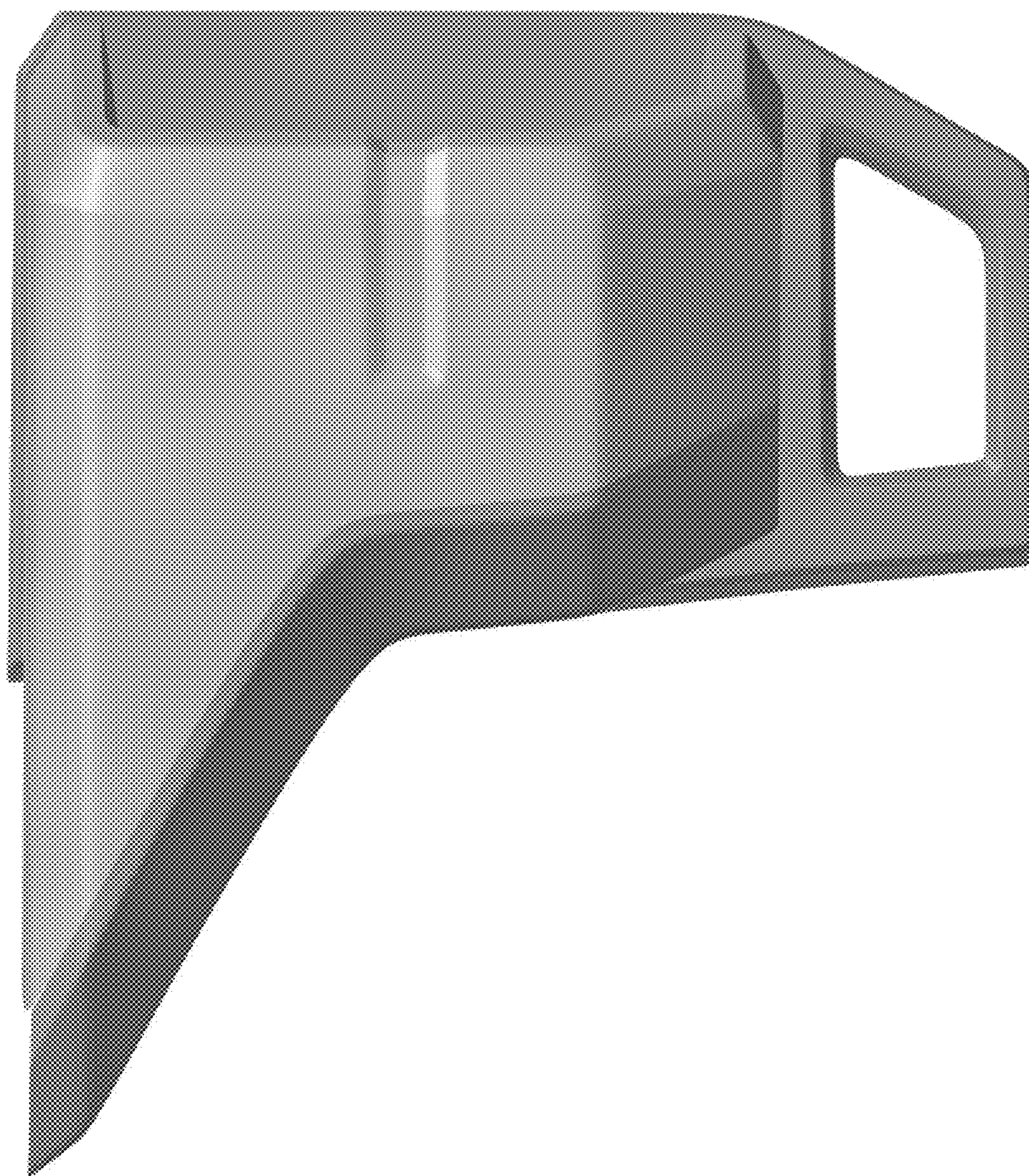

Fig. 3



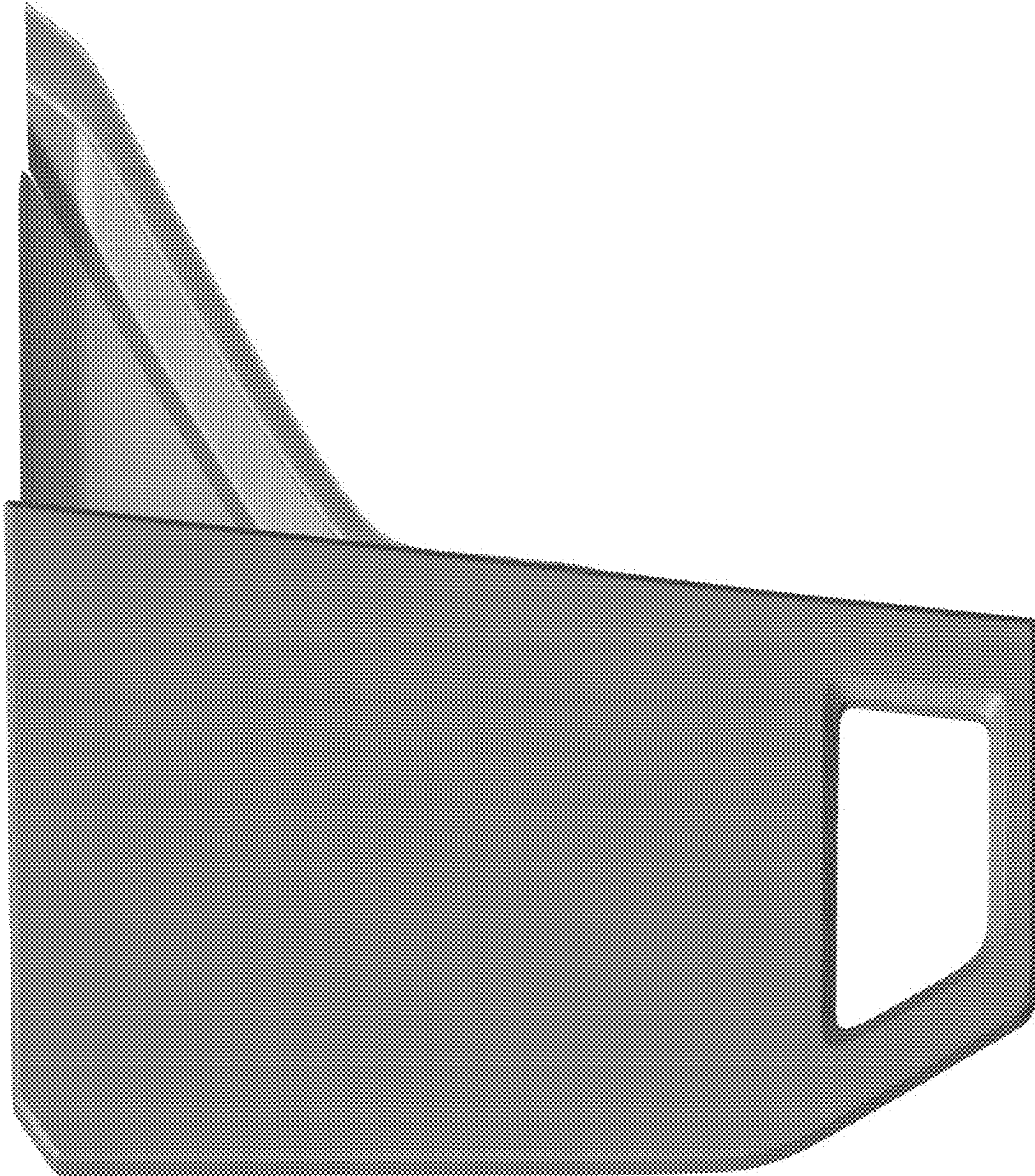

Fig.4

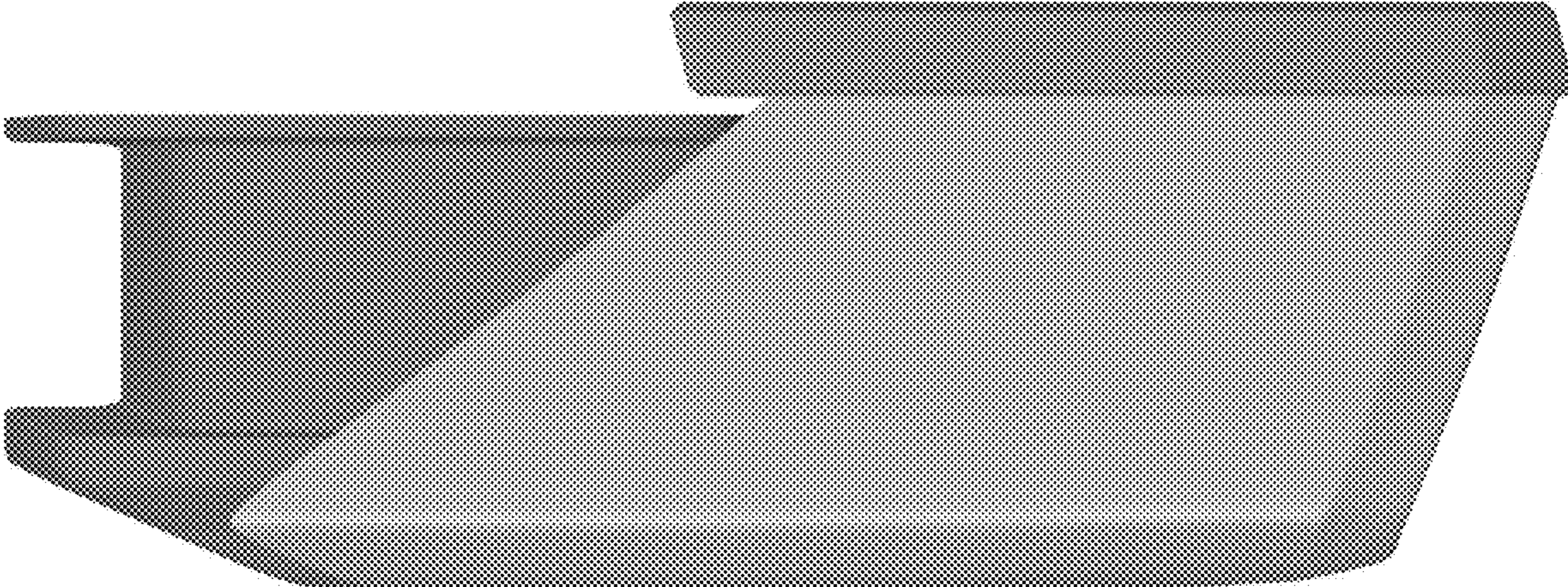

Fig. 5

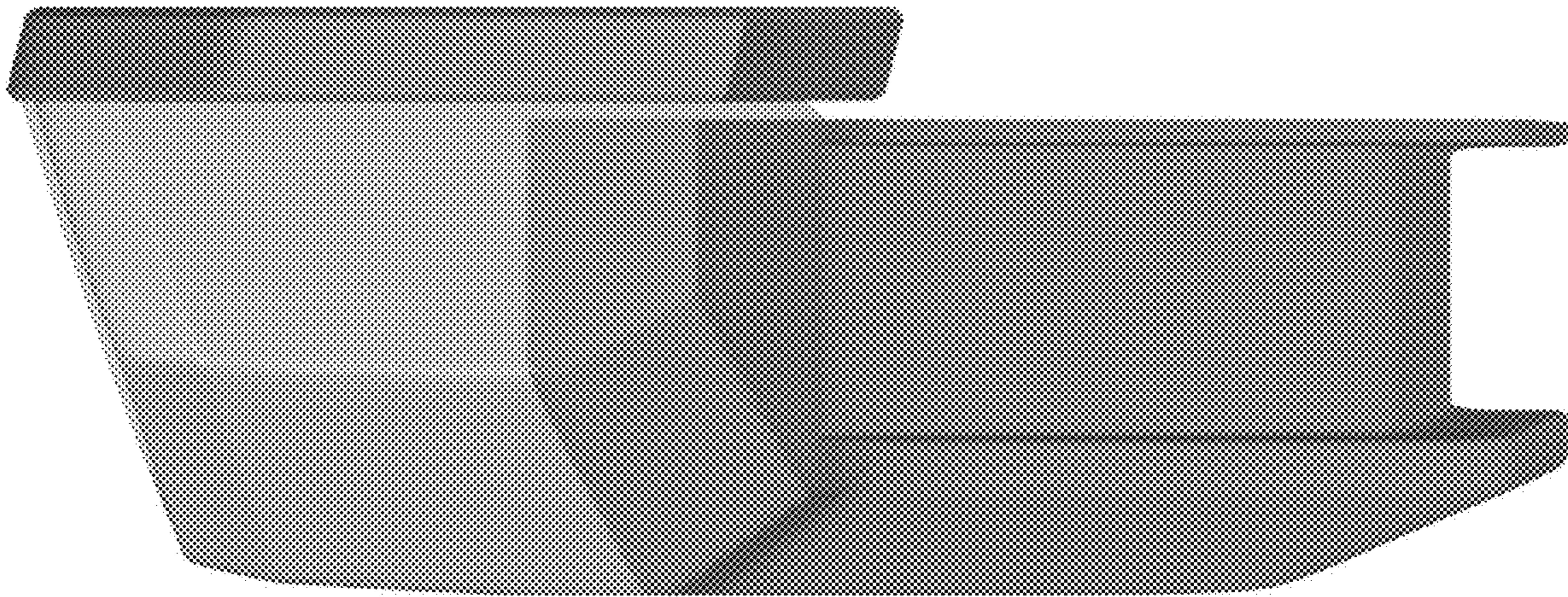

Fig. 6

Fig. 7

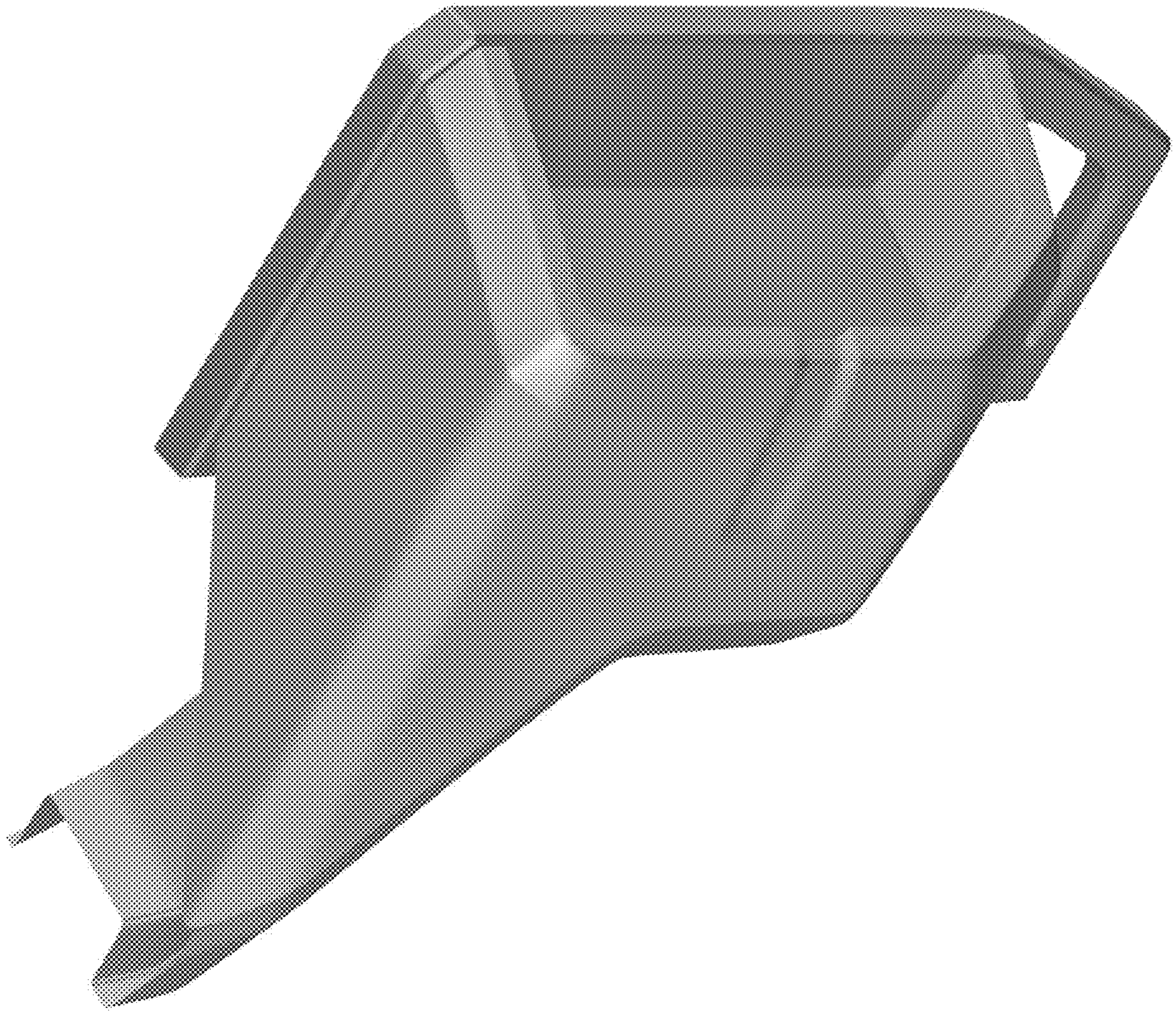



Fig. 8

