



US00D915492S

(12) **United States Design Patent** (10) **Patent No.:** **US D915,492 S**
Wang (45) **Date of Patent:** **** *Apr. 6, 2021**

(54) **GIMBAL**
(71) Applicant: **AUTEL ROBOTICS CO., LTD.**,
Shenzhen (CN)
(72) Inventor: **Yongshuai Wang**, Shenzhen (CN)
(73) Assignee: **AUTEL ROBOTICS CO., LTD.**,
Shenzhen (CN)
(*) Notice: This patent is subject to a terminal dis-
claimer.
(**) Term: **15 Years**

D754,242 S * 4/2016 Wang D16/242
D771,733 S * 11/2016 Wang D16/242
D785,698 S * 5/2017 Wang D16/242
D790,000 S * 6/2017 Wang D16/200
D791,216 S * 7/2017 Wang D16/242
D791,217 S * 7/2017 Wang D16/200
D799,581 S * 10/2017 Lin D16/242
9,835,934 B2 * 12/2017 Matt G03B 17/561
9,890,900 B2 * 2/2018 Zhao F16M 11/06
D813,924 S * 3/2018 Zheng D16/203
D816,150 S * 4/2018 Liao D16/242
9,983,461 B2 * 5/2018 Tang F16M 11/121
9,988,145 B2 * 6/2018 Yu B64C 27/001
10,047,905 B2 * 8/2018 Yang F16M 11/10

(Continued)

(21) Appl. No.: **29/630,811**
(22) Filed: **Dec. 22, 2017**
(30) **Foreign Application Priority Data**
Jun. 22, 2017 (CN) 201730261097.6
(51) **LOC (13) Cl.** **16-05**
(52) **U.S. Cl.**
USPC **D16/242**
(58) **Field of Classification Search**
USPC D16/219, 237-250; D12/101, 114, 129;
D14/224, 229, 238, 251, 253, 447, 451,
D14/457; D8/354, 355, 363, 373, 382,
D8/383, 394, 395, 396, 397, 398;
D34/12, 17, 18, 24, 26
CPC .. A45F 5/00; A45F 5/10; F16M 11/06; F16M
11/07; F16M 11/08; F16M 11/09; F16M
11/10; G02B 7/00-002; G03B 17/56;
G03B 17/561; G03B 17/563; G03B
17/565; G03B 17/566; G03B 17/568;
H04N 5/2253-2254
See application file for complete search history.

OTHER PUBLICATIONS

4K Camera & Gimbal Autel Robotics. [online] Published Nov. 4,
2017. Retrieved Oct. 19, 2018 from URL: <https://shop.autelrobotics.com/products/4k-camera-gimbal>.*

Primary Examiner — Vy N Koenig

(57) **CLAIM**

The ornamental design for a gimbal, as shown and
described.

DESCRIPTION

FIG. 1 is a front elevational view of the gimbal showing our
new design;
FIG. 2 is a rear elevational view thereof;
FIG. 3 is a left elevational view thereof;
FIG. 4 is a right side elevational view thereof;
FIG. 5 is a top plan elevational view thereof;
FIG. 6 is a bottom plan view thereof; and,
FIG. 7 is a perspective view thereof.
The broken lines in the drawings depict features of the
gimbal that form no part of the claimed design,

1 Claim, 7 Drawing Sheets

(56) **References Cited**
U.S. PATENT DOCUMENTS
D560,669 S * 1/2008 Muday D14/451
9,016,617 B2 * 4/2015 Wang B64C 39/024
244/17.17

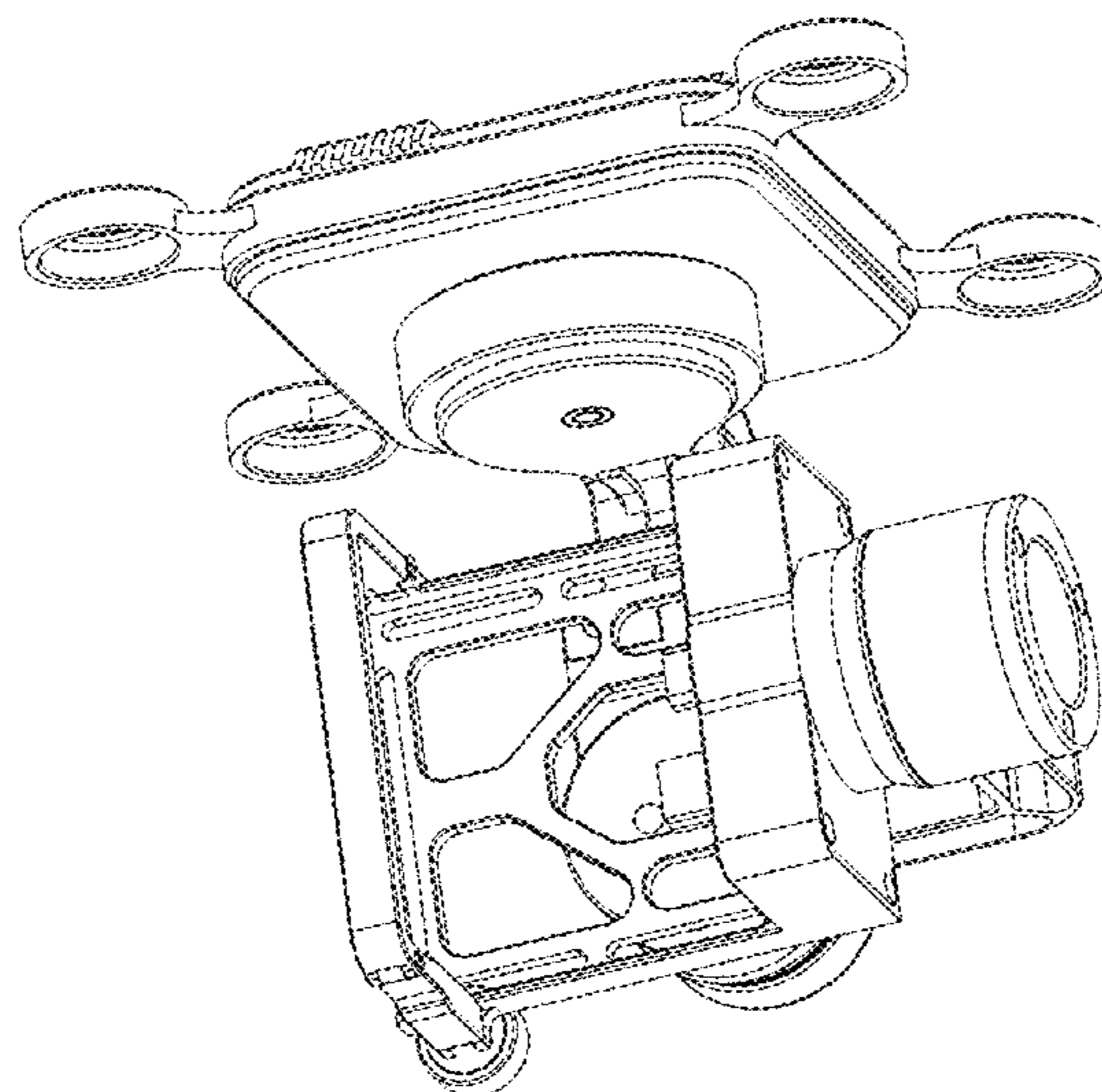

(56)

References Cited

U.S. PATENT DOCUMENTS

2008/0210025 A1* 9/2008 Goossen F16M 11/041
74/5.34
2015/0097950 A1* 4/2015 Wang H04N 5/23287
348/144
2016/0327847 A1* 11/2016 Yang B64D 47/08
2017/0174362 A1* 6/2017 Zhao F16M 11/041
2017/0307961 A1* 10/2017 Tian B64C 39/024

* cited by examiner

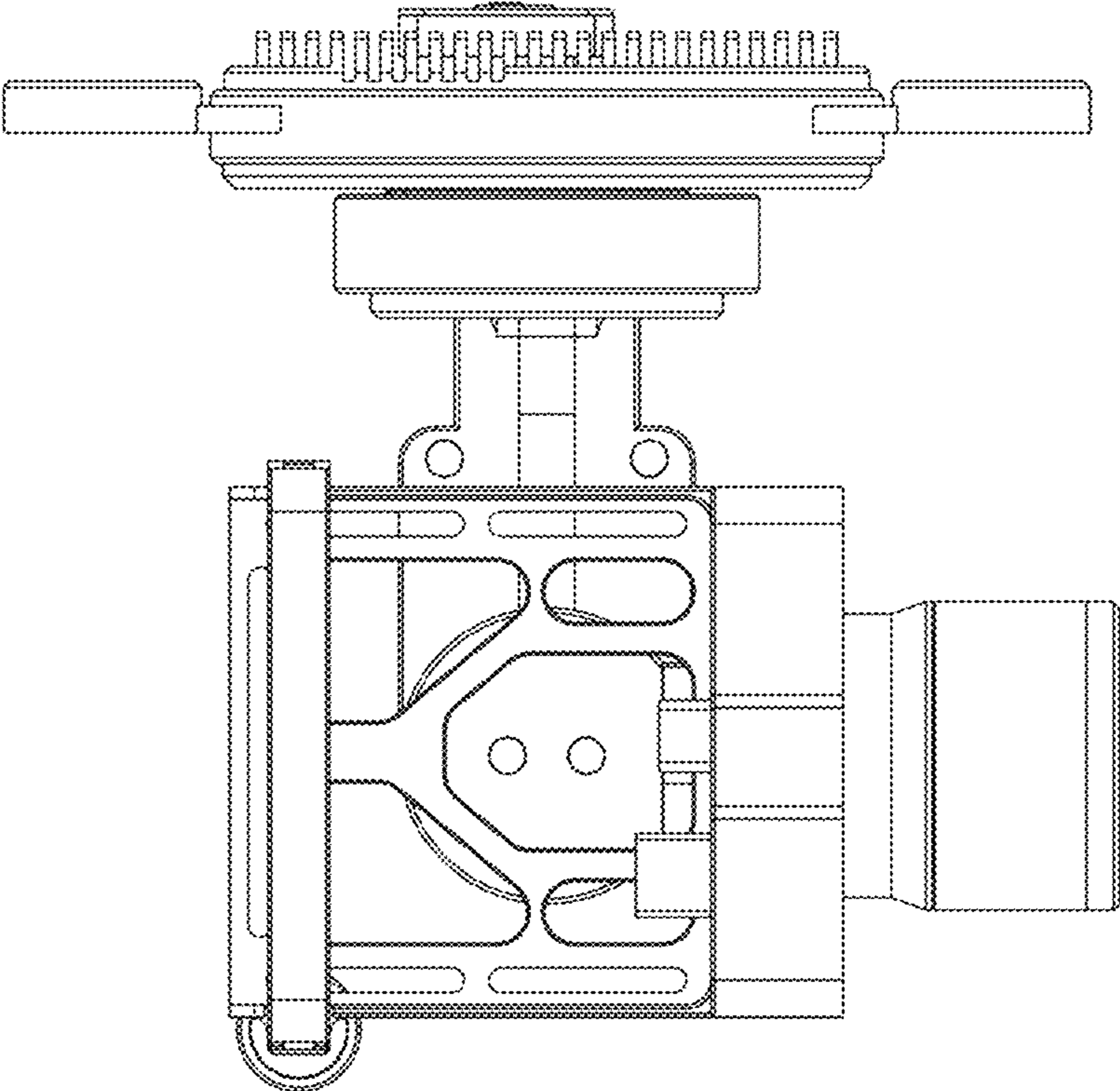

FIG. 1

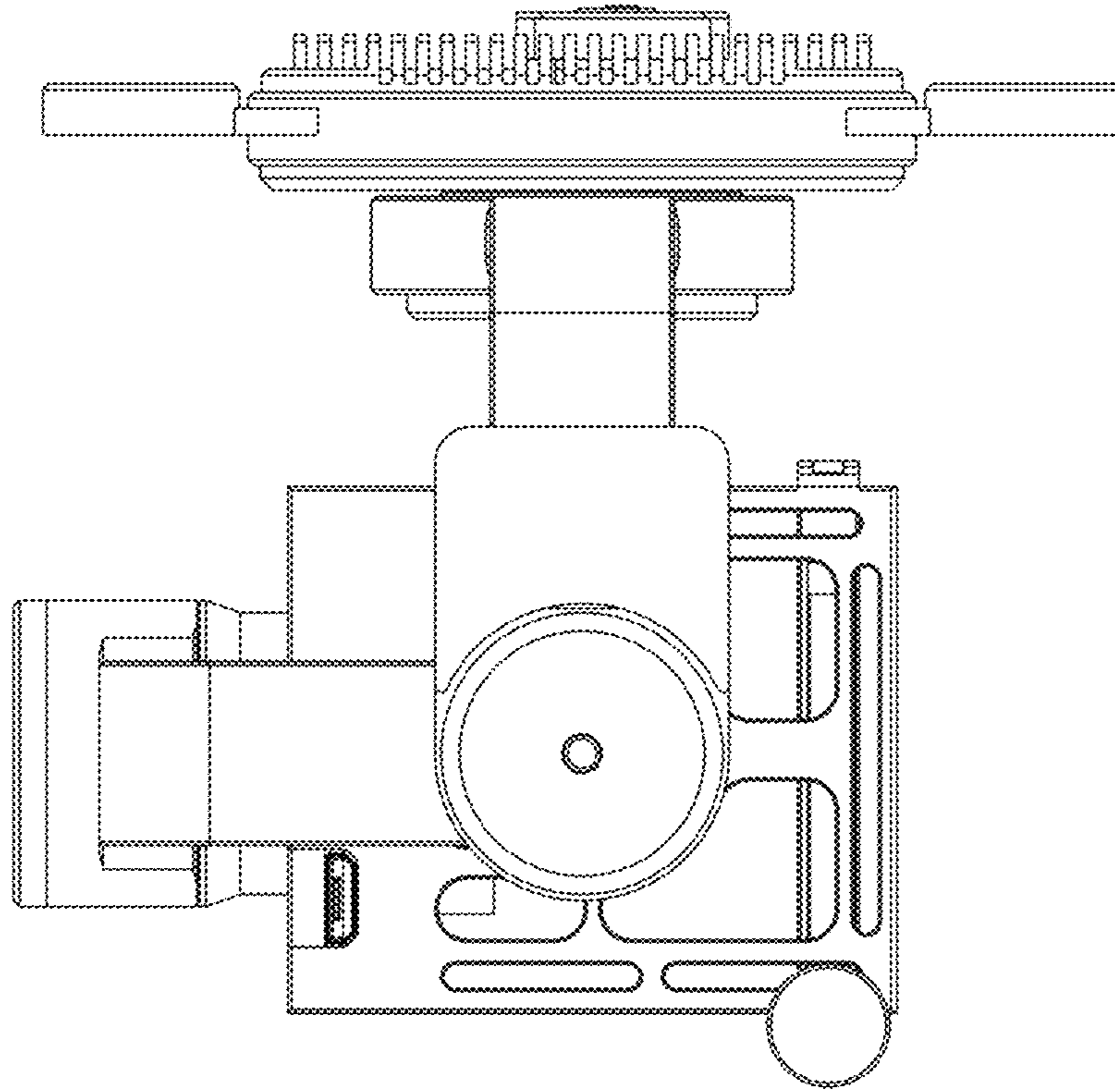

FIG.2

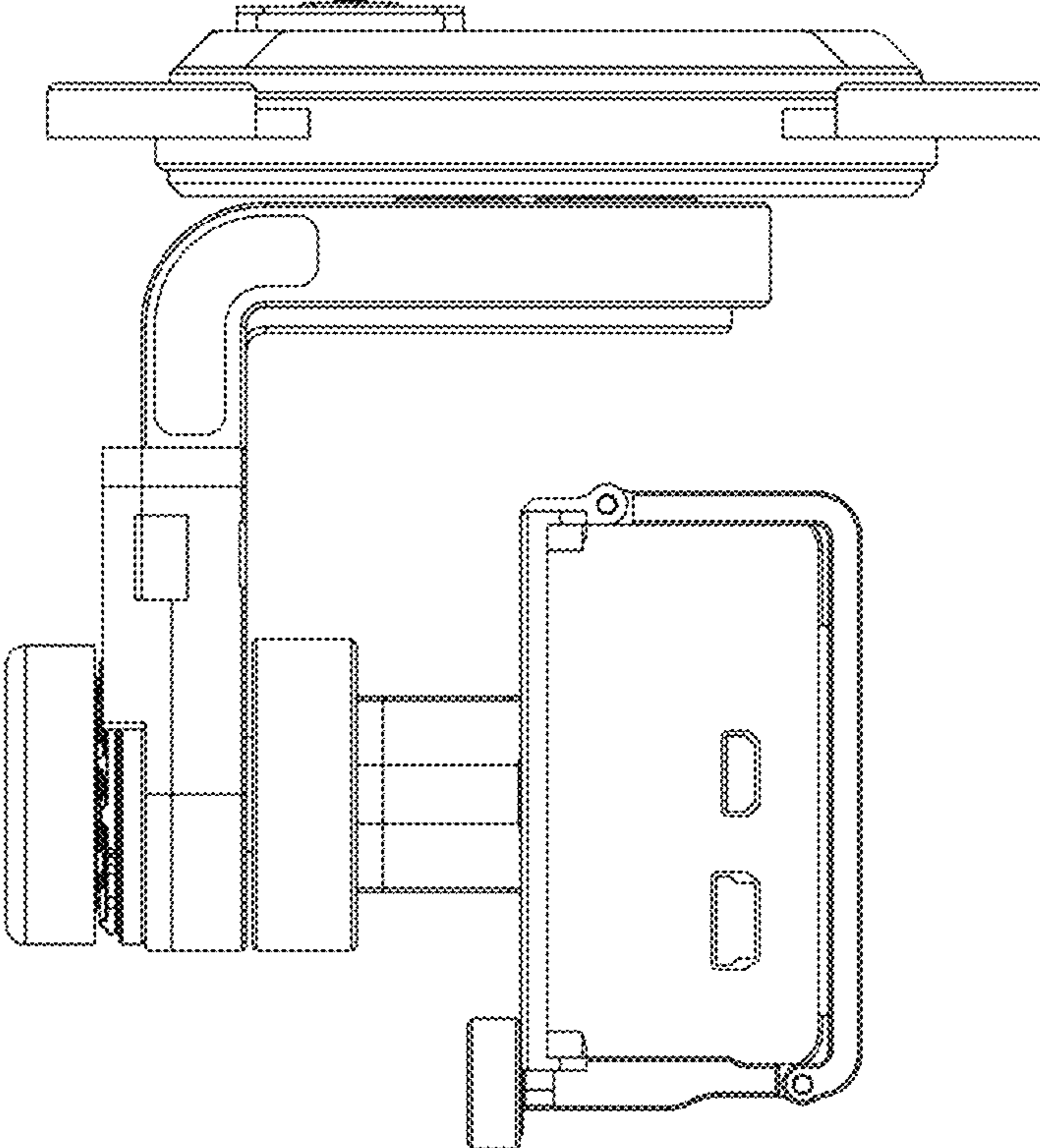

FIG.3

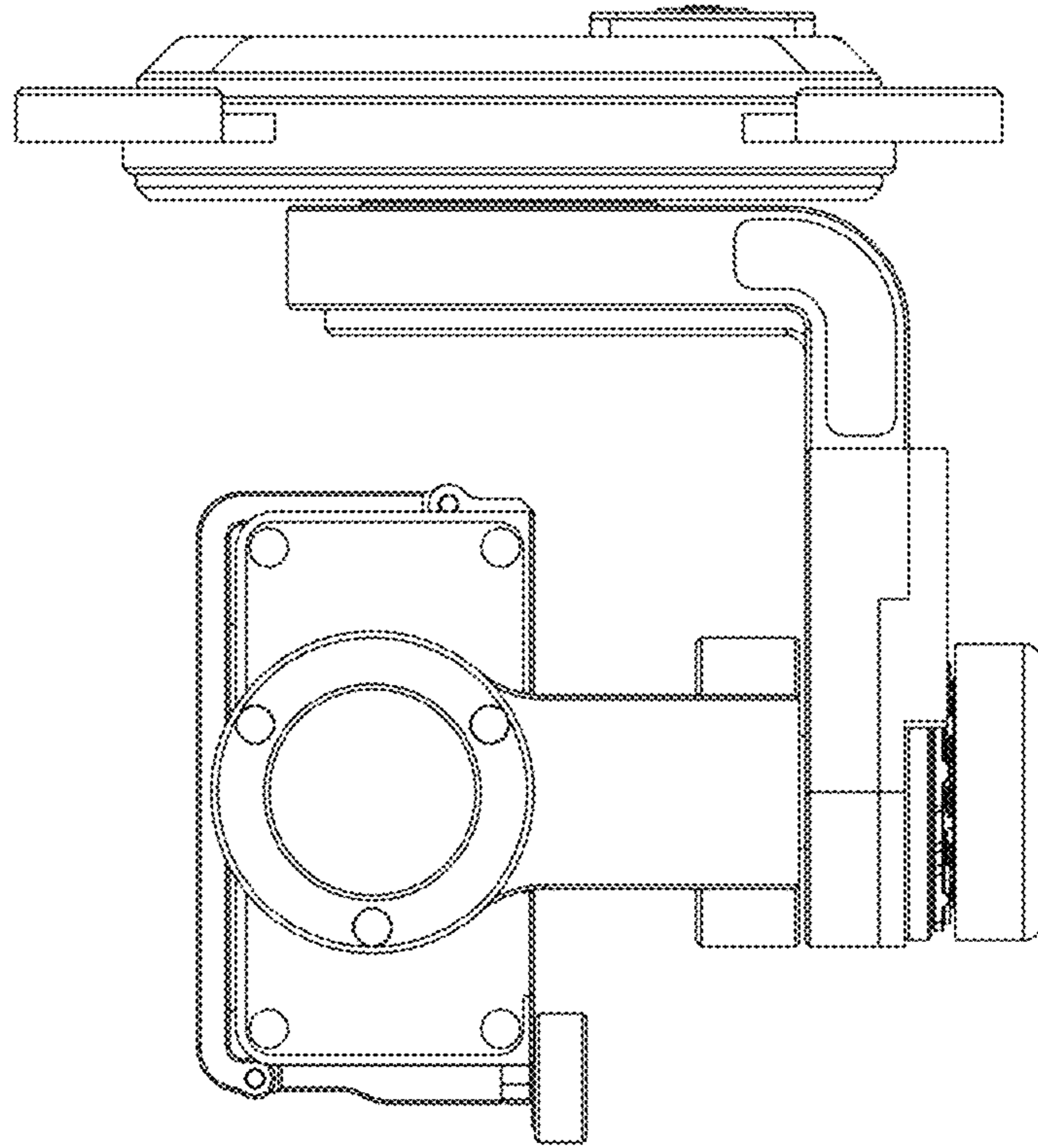

FIG.4

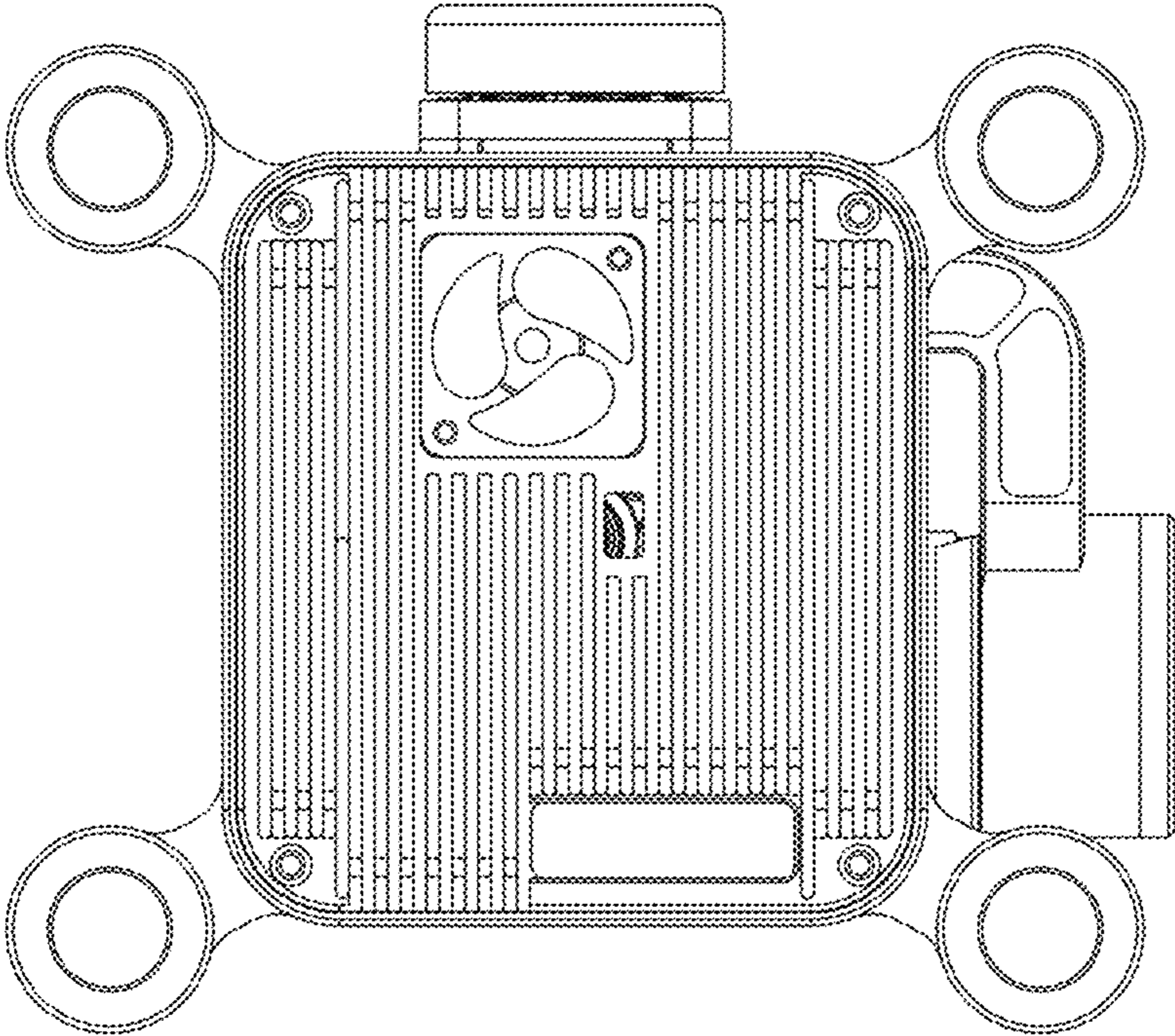

FIG.5

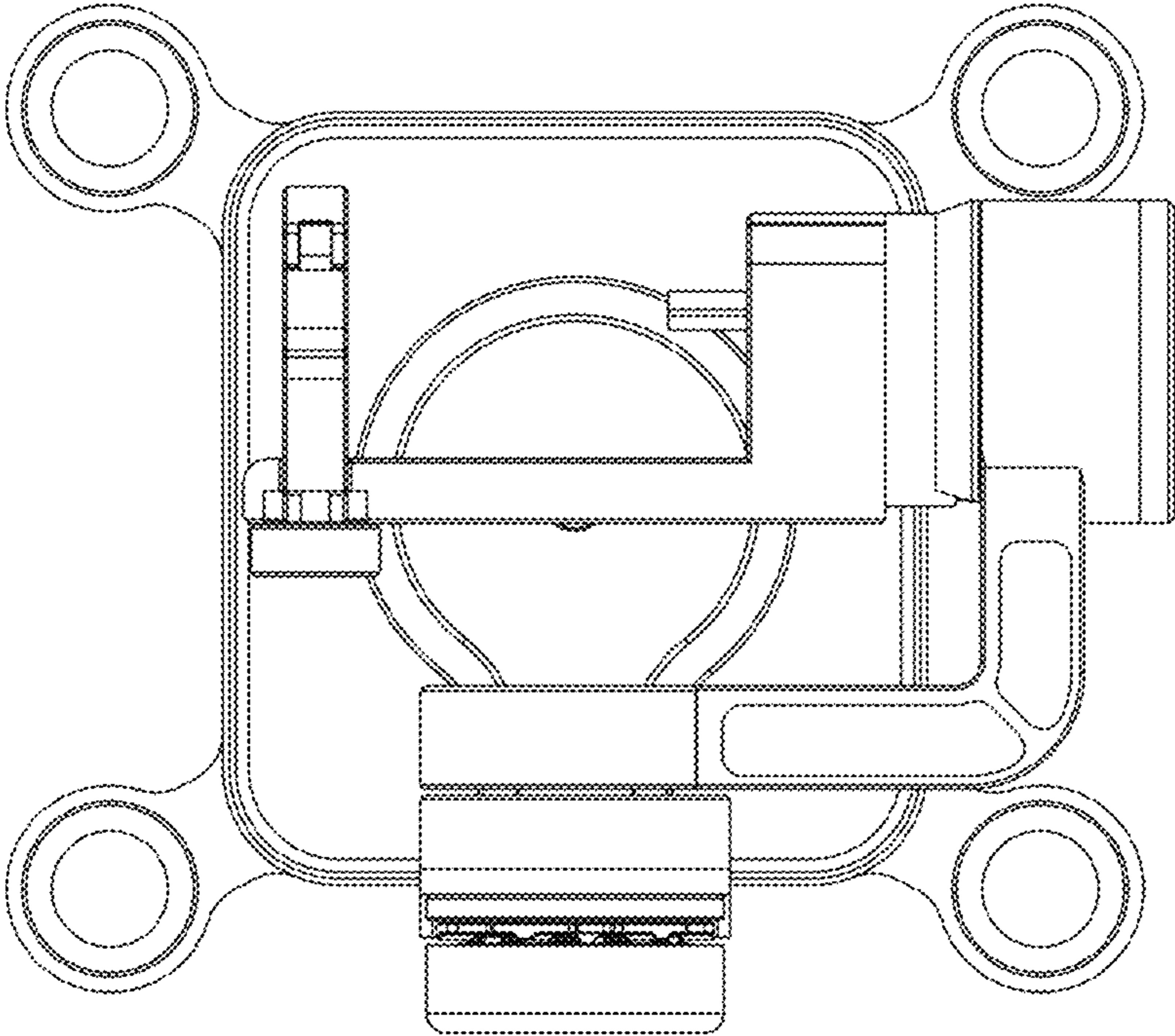

FIG.6

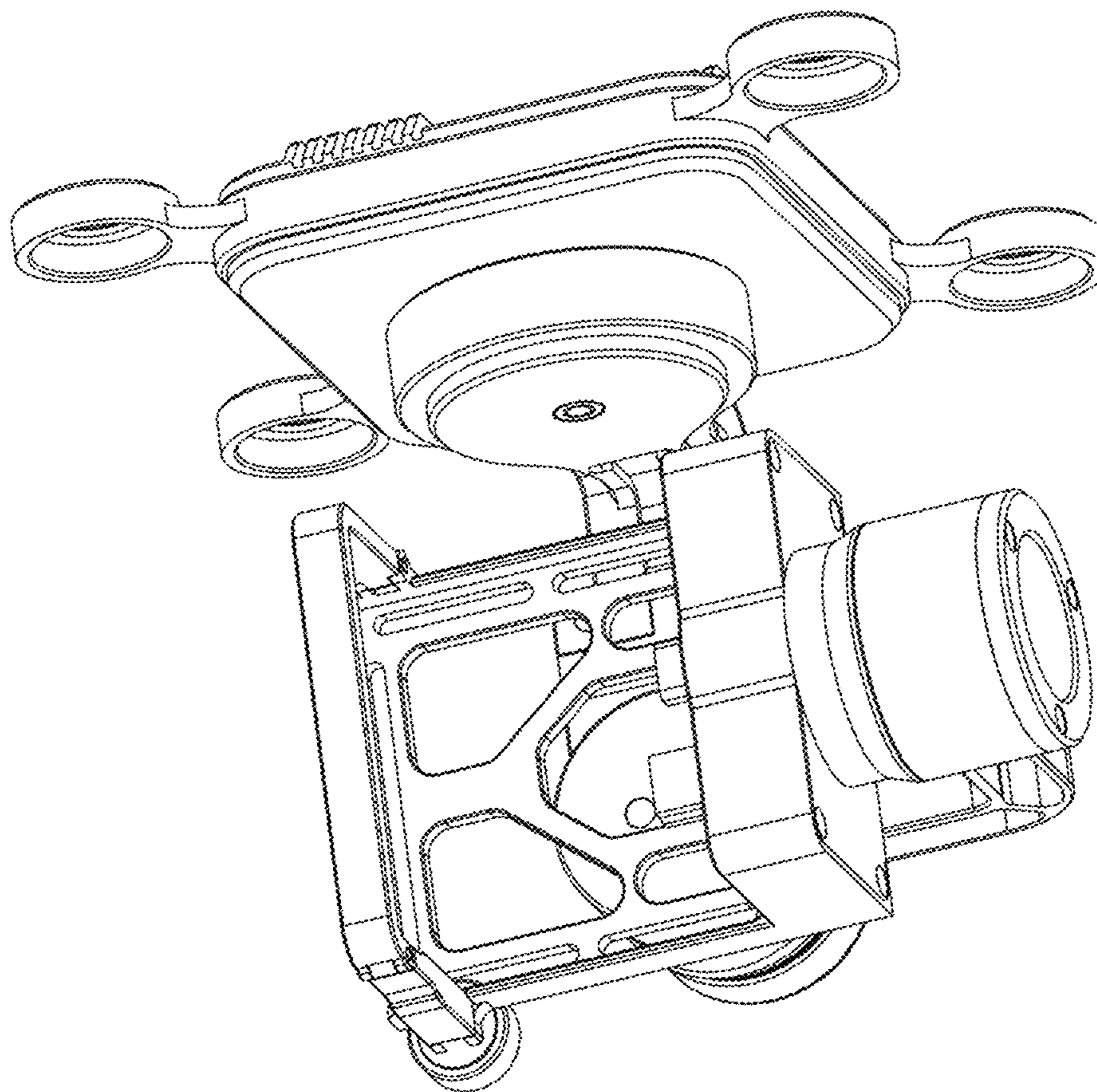

FIG.7