



US00D914627S

(12) **United States Design Patent**
Kim et al.

(10) **Patent No.: US D914,627 S**
(45) **Date of Patent: ** Mar. 30, 2021**

(54) **TELEVISION RECEIVER**

(71) Applicant: **LG Electronics Inc.**, Seoul (KR)
(72) Inventors: **Yongseok Kim**, Seoul (KR); **Yunui Chong**, Seoul (KR); **Misun Park**, Seoul (KR); **Yooseok Kim**, Seoul (KR); **Minji Seo**, Seoul (KR)

(73) Assignee: **LG ELECTRONICS INC.**, Seoul (KR)

(**) Term: **15 Years**
(21) Appl. No.: **35/507,478**

(22) Filed: **Mar. 8, 2019**

(80) **Hague Agreement Data**

Int. Filing Date: **Mar. 8, 2019**
Int. Reg. No.: **DM/202969**
Int. Reg. Date: **Mar. 8, 2019**
Int. Reg. Pub. Date: **Oct. 4, 2019**

(30) **Foreign Application Priority Data**

Sep. 10, 2018 (KR) 30-2018-0042134

(51) **LOC (13) Cl.** **14-03**

(52) **U.S. Cl.**
USPC **D14/126**

(58) **Field of Classification Search**

USPC D14/125, 126, 128, 133, 239, 336, 371,
D14/374-377, 448, 450; D20/10, 19, 39;
D21/329, 515; D16/241
CPC G06F 1/1601; G06F 1/1643; H04N 5/64;
H04N 5/66; H04N 5/655; H04N 7/00;
H04N 9/3141; H04N 13/0459; H04N
17/04;

(Continued)

(56) **References Cited**

U.S. PATENT DOCUMENTS

D646,336 S * 10/2011 Kelly D21/370
D697,862 S * 1/2014 Nemeth D12/345

(Continued)

OTHER PUBLICATIONS

Yaham LED; "Outdoor Fixed LED SC"; [online] 'https://yahamled.com/products/outdoor-fixed-led-sc/'; accessed Aug. 2, 2020; 4pgs. (Year: 2020).*

(Continued)

Primary Examiner — Keli L Hill

(74) *Attorney, Agent, or Firm* — Birch, Stewart, Kolasch & Birch, LLP

(57) **CLAIM**

The ornamental design for a television receiver, as shown and described.

DESCRIPTION

1. Television receiver
1.1 : Perspective
1.2 : Front
1.3 : Back
1.4 : Left
1.5 : Right
1.6 : Top
1.7 : Bottom
1.8 : Alternate Perspective view shown installed on a wall
1.9 : Alternate Top view showing display in an alternate position
The broken line showing of the wall in reproduction 1.8 is included for the purpose of illustrating environmental subject matter and forms no part of the claimed design. The fine lines on the drawings indicate the display part; reproductions 1.1 to 1.7 are front perspective, front, back, left, right, top and bottom views of the television receiver; reproduction 1.8 is an alternate perspective view showing an example of the use state in which the claimed design is installed on the wall; and reproduction 1.9 is an alternate top view showing a process in which the display moves along with the wall by the sliding structure formed at the top of the body.

1 Claim, 9 Drawing Sheets

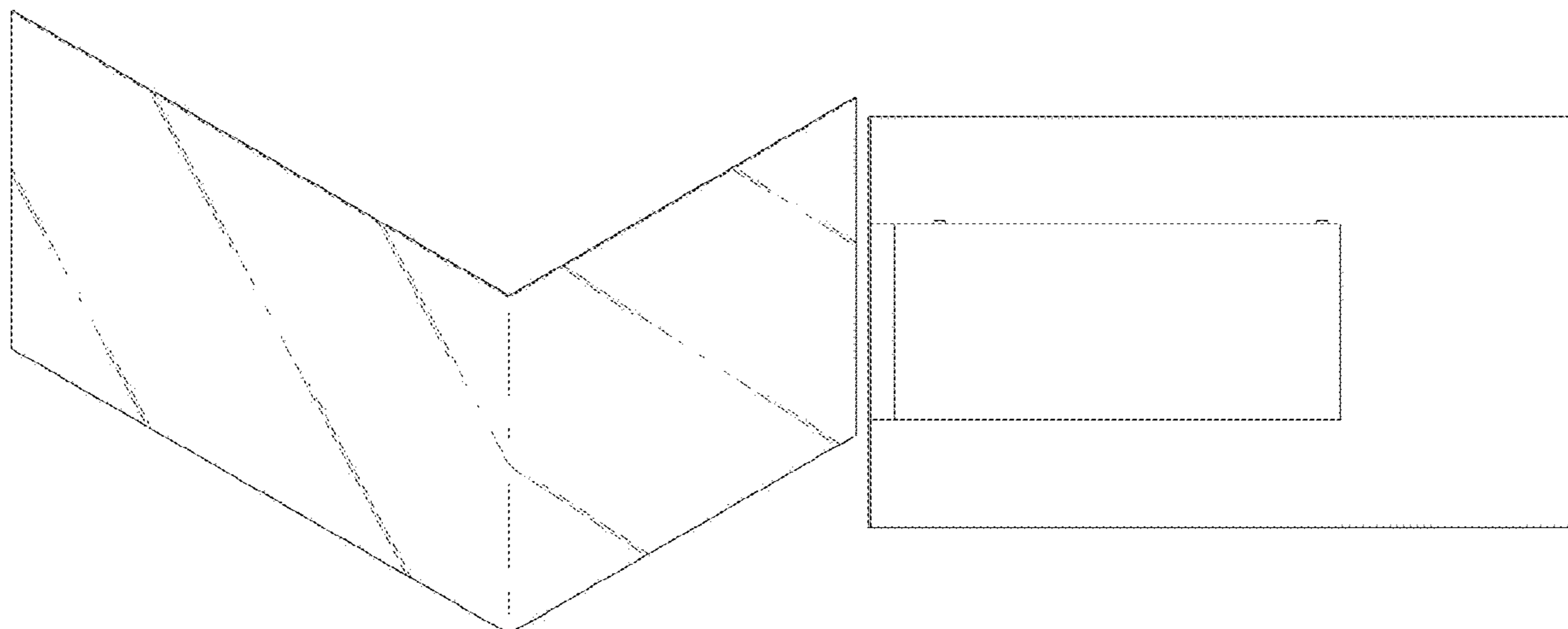

(58) **Field of Classification Search**

CPC H04N 17/004; H04N 21/43637; G02B
6/0068; H05K 5/02; H05K 5/0004; H05K
5/0017; H05K 5/0217

See application file for complete search history.

D858,638 S * 9/2019 Kwon D20/10
D862,297 S * 10/2019 Cha D12/126
D863,441 S * 10/2019 Hwang D20/39

OTHER PUBLICATIONS

(56)

References Cited

U.S. PATENT DOCUMENTS

D755,745 S * 5/2016 Williams D14/126
D765,659 S * 9/2016 Kim D14/375
D770,406 S * 11/2016 Fleming, Jr. D14/125
D771,628 S * 11/2016 Bae D14/374
D781,857 S * 3/2017 Drabant D14/371
D812,029 S * 3/2018 Kim D14/126
D823,856 S * 7/2018 Asamizu D14/374
D845,261 S * 4/2019 Won D14/126

MPLED: "MPLED P2.5 Seamless L shape corner LED Display for Singapor"; [online] 'http://www.mpled168.com/News/Company_News/20171025890.html'; dated Oct. 25, 2017; accessed Aug. 3, 2020; 2pgs. (Year: 2017).*

MPLED 2; "Outdoor & Indoor Bevel LED Display"; [online] 'www.mpled168.com/Products/Outdoor/20150613345.html'; accessed Aug. 3, 2020; 3pgs. (Year: 2020).*

Brill, Louis; Sign of the Times; "Building Lobbies and the Digital Domain"; [online] '<https://www.signsofthetimes.com/content/building-lobbies-and-digital-domain>'; dated Nov. 14, 2016; accessed Aug. 2, 2020; 7pgs. (Year: 2016).*

* cited by examiner

1.1

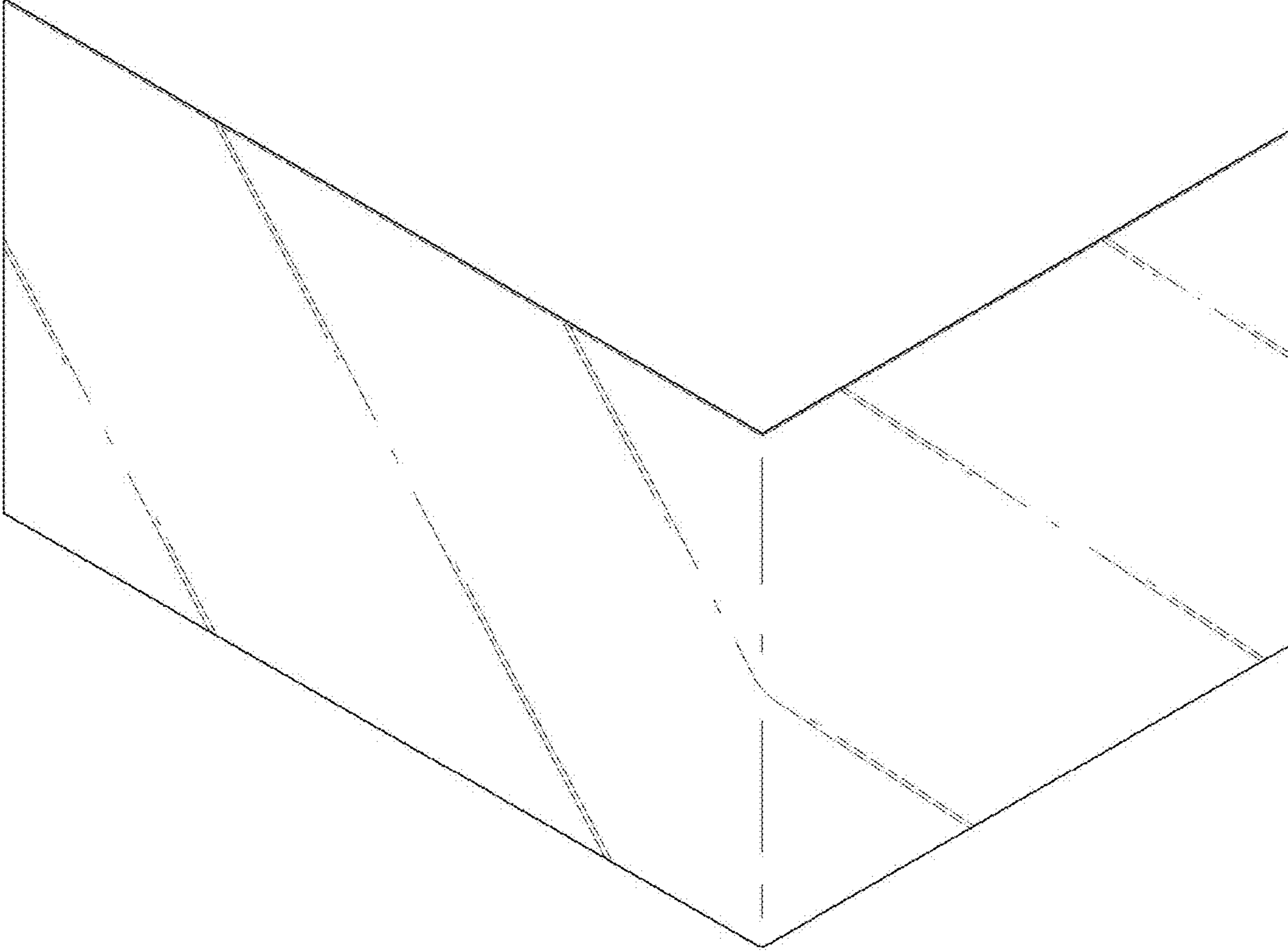

1.2

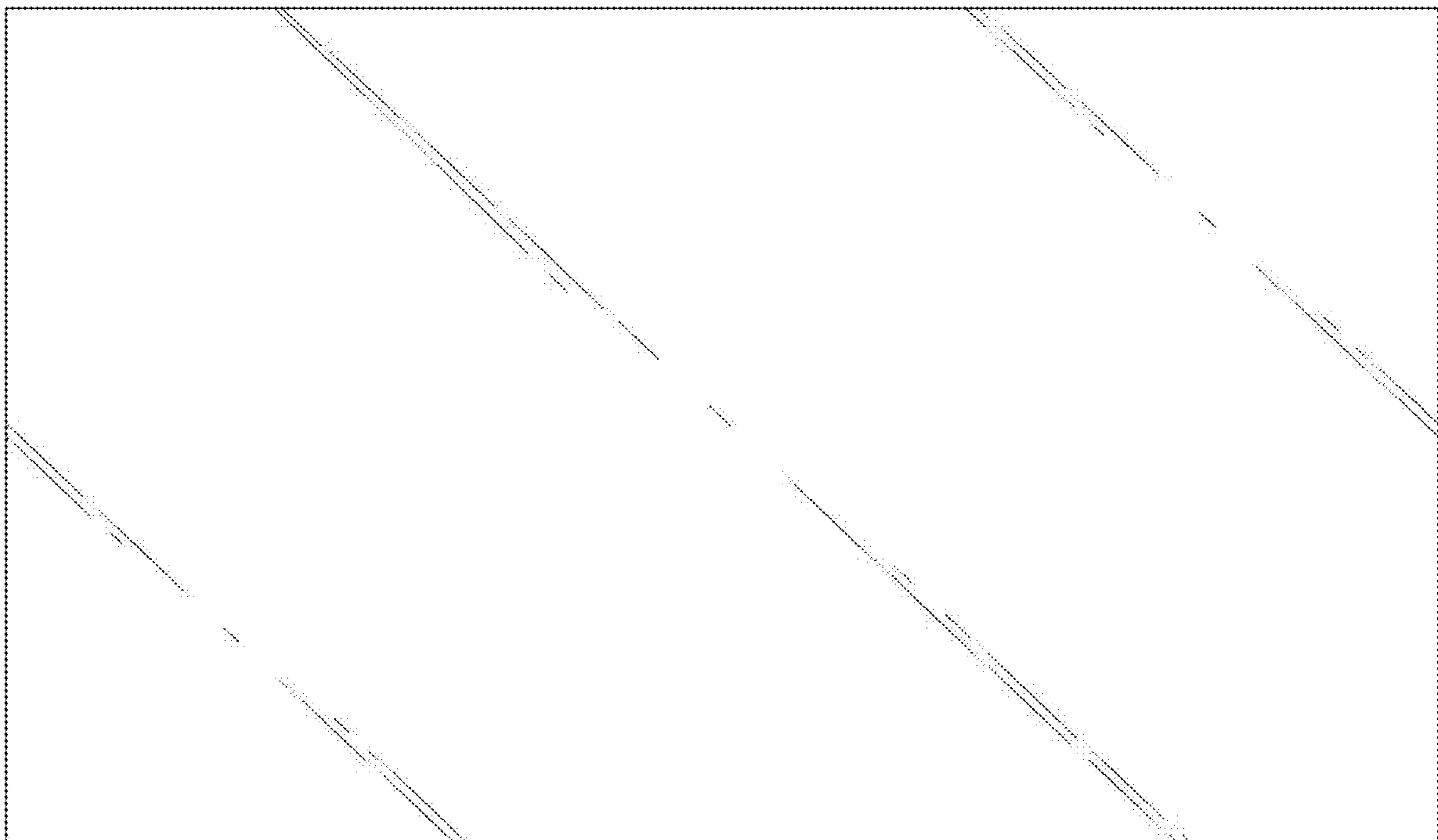

1.3

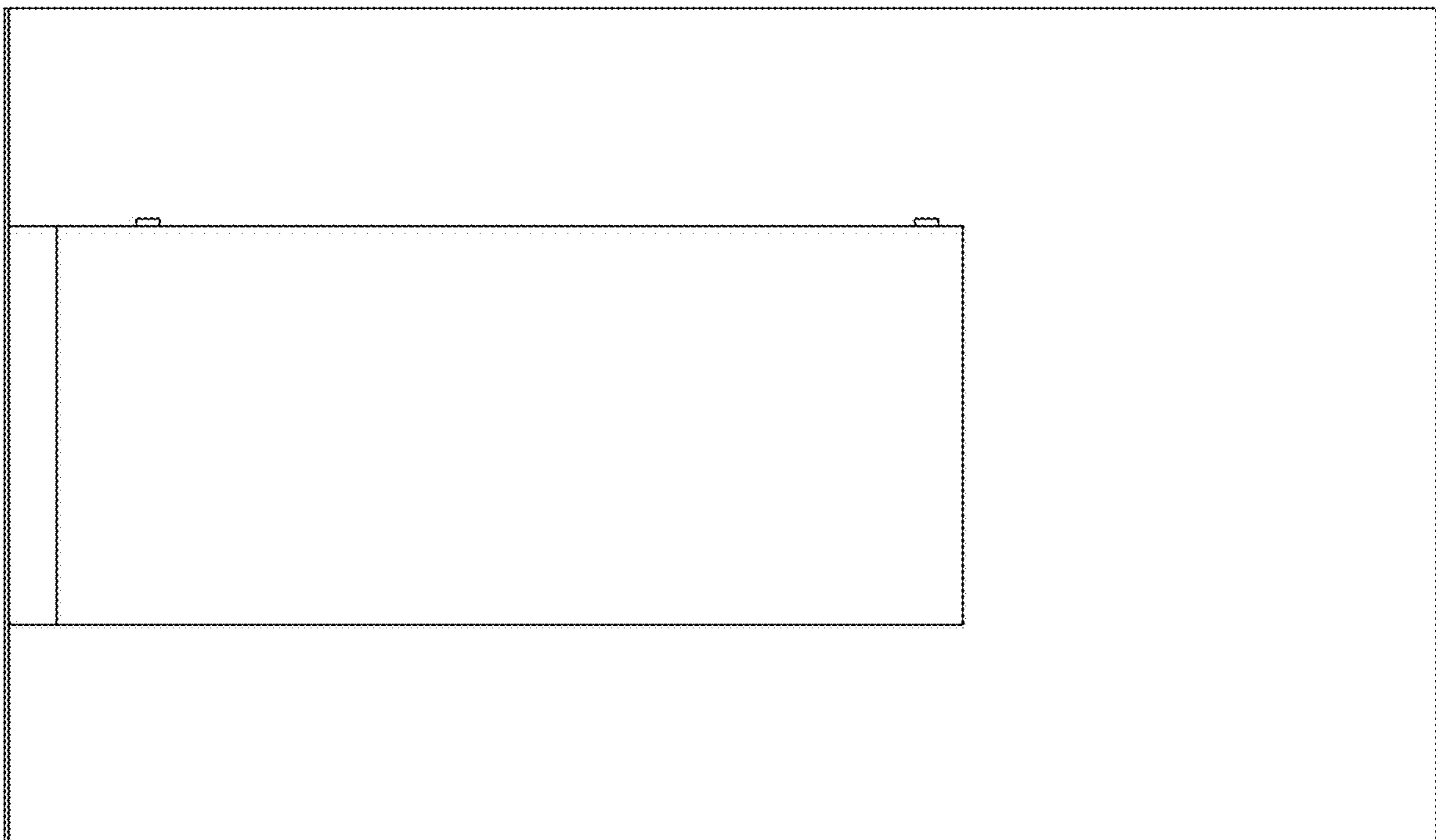

1.4



1.5

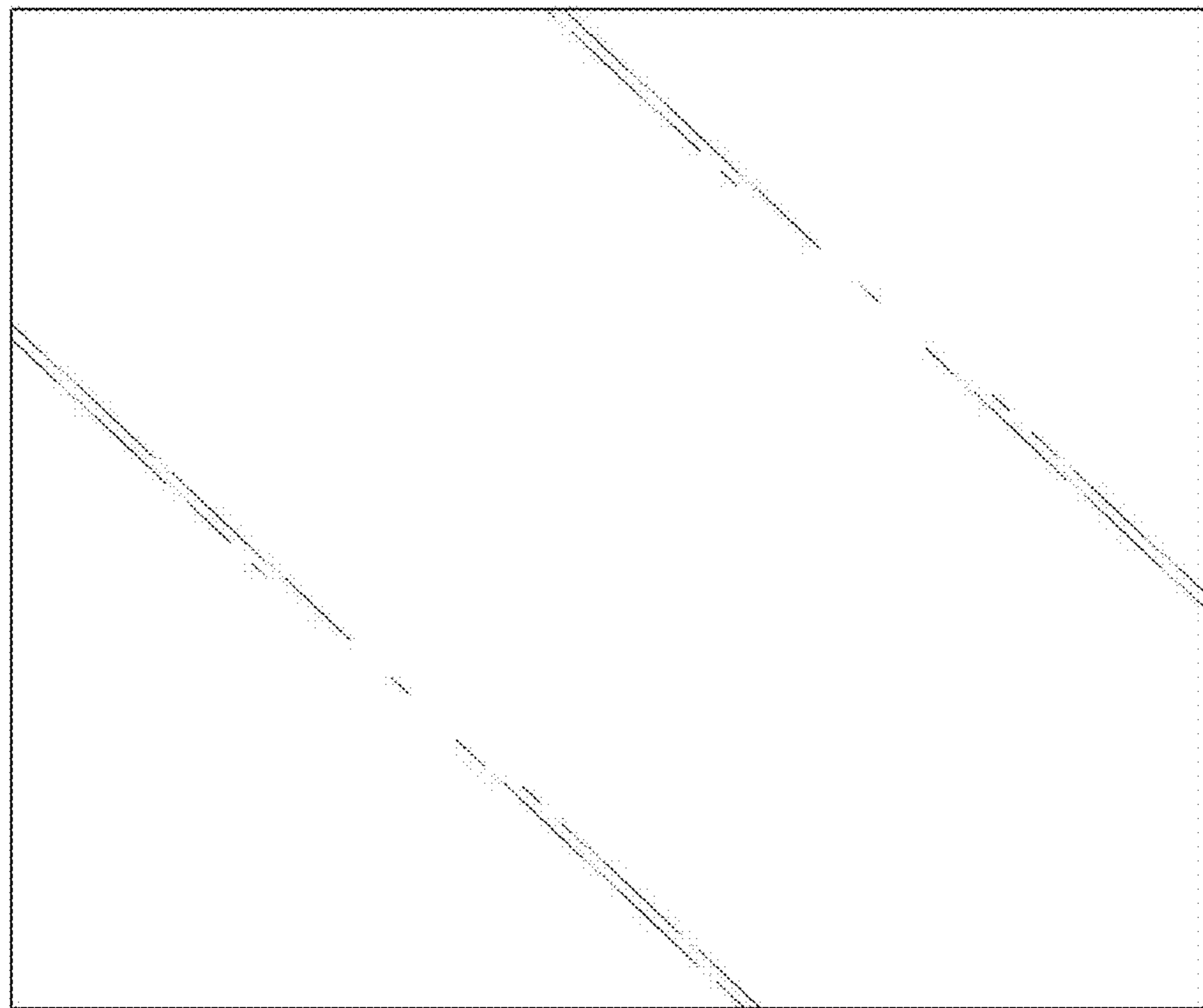

1.6



1.7

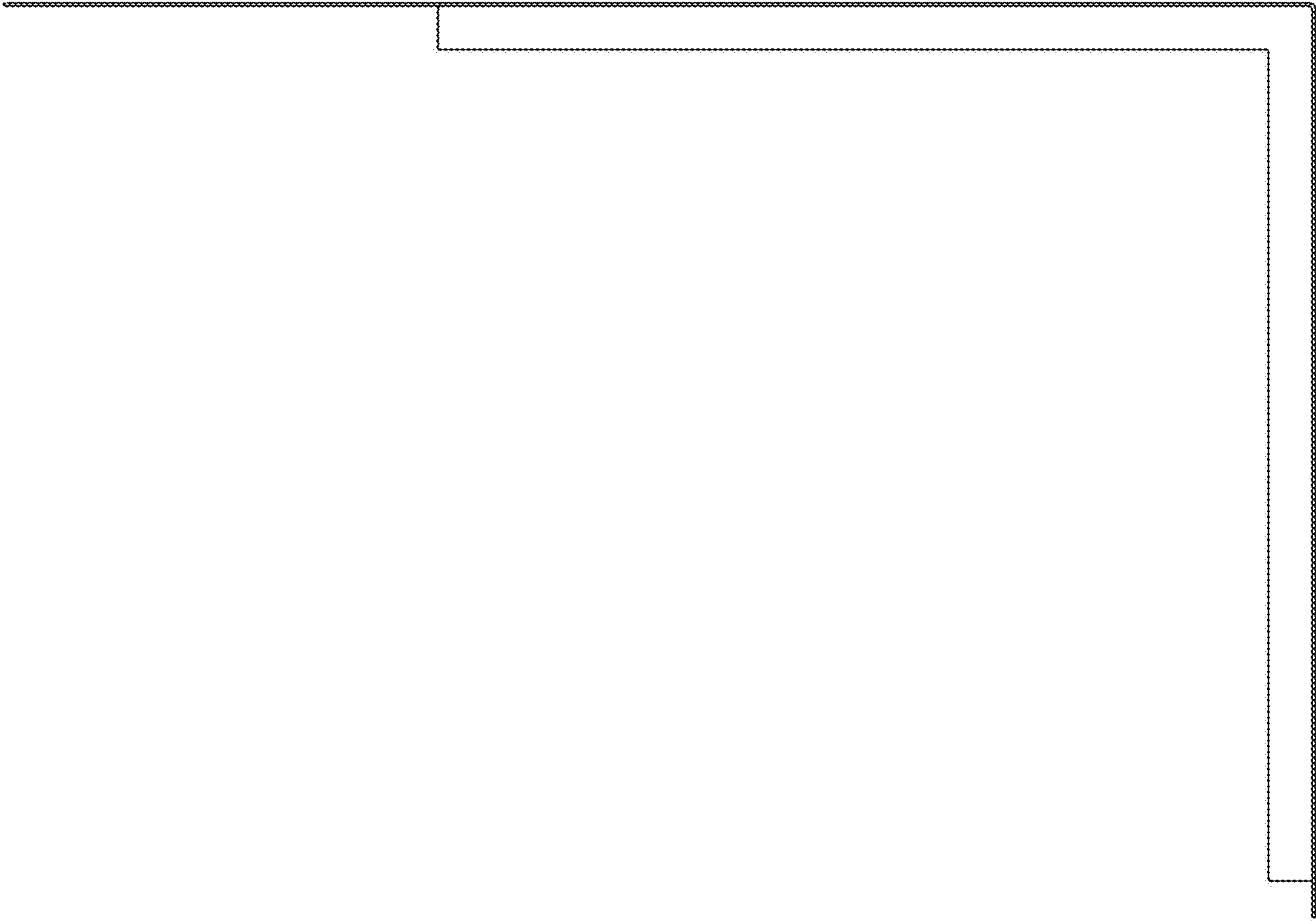

1.8

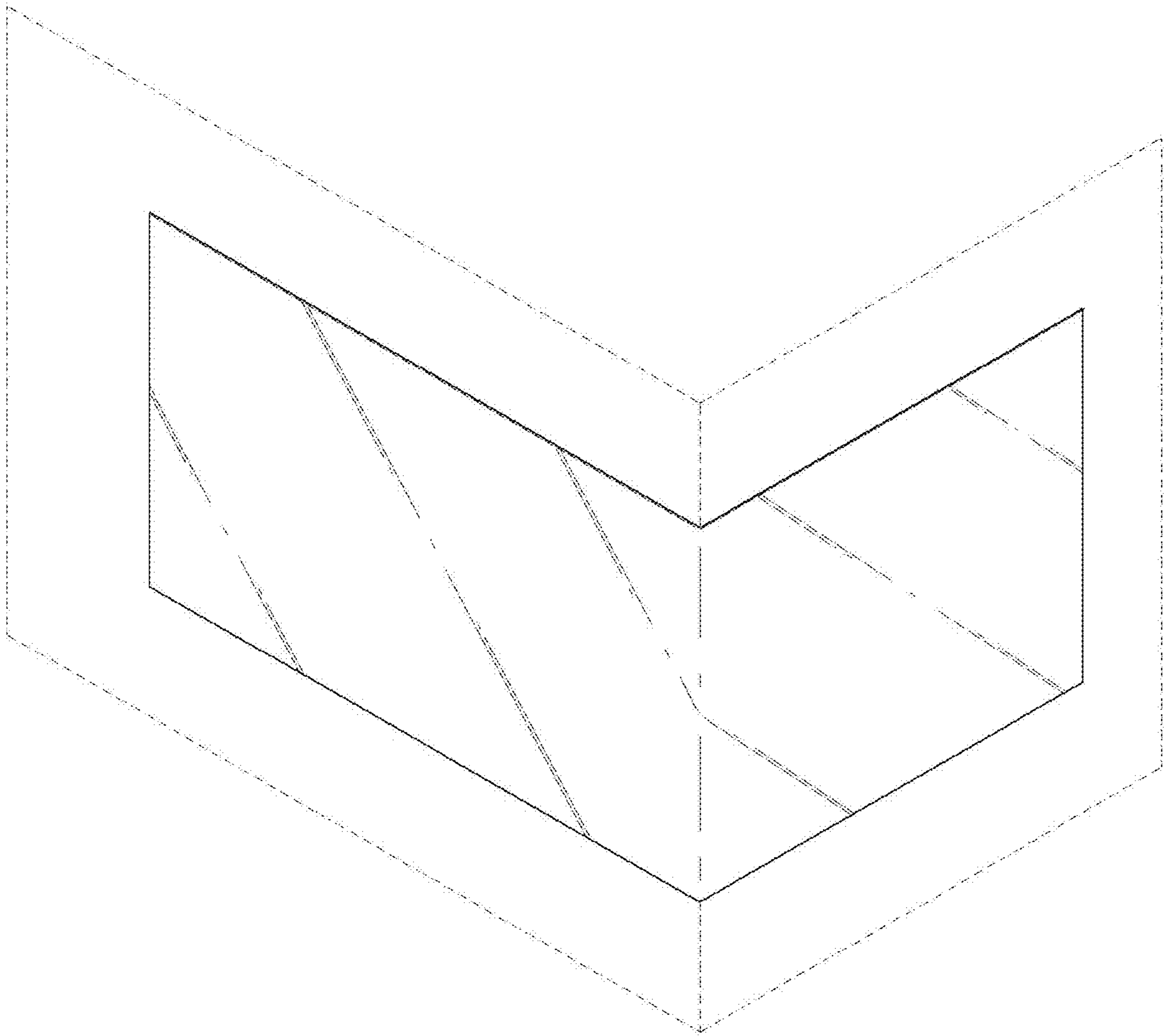

1.9

