



US00D914552S

(12) **United States Design Patent** (10) **Patent No.:** **US D914,552 S**
Babar et al. (45) **Date of Patent:** **** Mar. 30, 2021**

- (54) **RIGID SADDLE FOR MOTOR GRADER**
- (71) Applicant: **Deere & Company**, Moline, IL (US)
- (72) Inventors: **Onkar Babar**, Kolhapur (IN); **Michael J Ackerman**, Peosta, IA (US); **Anthony K Kraft**, Epworth, IA (US); **John Gundupalli**, Samalkot (IN); **Gregory K Werner**, Dubuque, IA (US)
- (73) Assignee: **DEERE & COMPANY**, Moline, IL (US)
- (**) Term: **15 Years**
- (21) Appl. No.: **29/717,583**
- (22) Filed: **Dec. 18, 2019**
- (51) **LOC (13) Cl.** **12-16**
- (52) **U.S. Cl.**
USPC **D12/162**
- (58) **Field of Classification Search**
USPC D12/159, 160, 161, 162
CPC . B60D 1/60; B60D 1/065; B60D 1/00; B60D 1/06; B60D 1/36
See application file for complete search history.

D862,308	S	*	10/2019	Siegel	D12/162
D887,910	S	*	6/2020	Noel	D12/162
D898,628	S	*	10/2020	Sagen	D12/162
2013/0013158	A1		1/2013	Weber et al.		
2017/0087947	A1*		3/2017	Moore	B60D 1/583
2019/0024340	A1		1/2019	Ono		
2020/0048865	A1		2/2020	Dauth et al.		

OTHER PUBLICATIONS

Case Motor Graders 8 Series and C Series. Product brochure [online]. CNH Industrial America LLC, 2019 [retrieved on Apr. 15, 2020]. Retrieved from the Internet: <URL:https://online.fliphtml5.com/kkbp/hnzu/#p=1>.

Case B-Series Motor Graders 845B, 865B, 885B. Product brochure [online]. CNH Industrial America LLC, 2018 [retrieved on Apr. 15, 2020]. Retrieved from the Internet: <URL:https://assets.cnhindustrial.com/casece/emea/assets/pdf/products/ame/en/brochures/graders/graders-brochure-en.pdf>.

(Continued)

Primary Examiner — Katrina A Betton

(57) **CLAIM**

The ornamental design for a rigid saddle for motor grader, as shown and described.

DESCRIPTION

FIG. 1 is a perspective view of a rigid saddle for motor grader showing our new design.
 FIG. 2 is a left side view thereof.
 FIG. 3 is a right side view thereof.
 FIG. 4 is a front view thereof.
 FIG. 5 is a rear view thereof.
 FIG. 6 is a top view thereof; and,
 FIG. 7 is a bottom view thereof.
 The broken line representations of environmental structure in FIGS. 1-7 is for illustrative purposes only and forms no part of the claimed design.

1 Claim, 7 Drawing Sheets

- (56) **References Cited**
U.S. PATENT DOCUMENTS
- 3,454,110 A 7/1969 Hanser
- 5,697,630 A * 12/1997 Thompson B60D 1/363
280/477
- D503,131 S * 3/2005 Underwood D12/162
- D563,838 S * 3/2008 McCowan D12/162
- D687,353 S * 8/2013 Dunn D12/162
- D729,703 S * 5/2015 Song D12/162
- D773,345 S * 12/2016 Borkholder D12/162
- 9,637,889 B2 5/2017 Elkins
- D841,526 S * 2/2019 Siegel D12/162
- D855,500 S * 8/2019 Metternich D12/162
- D858,368 S * 9/2019 Siegel D12/162

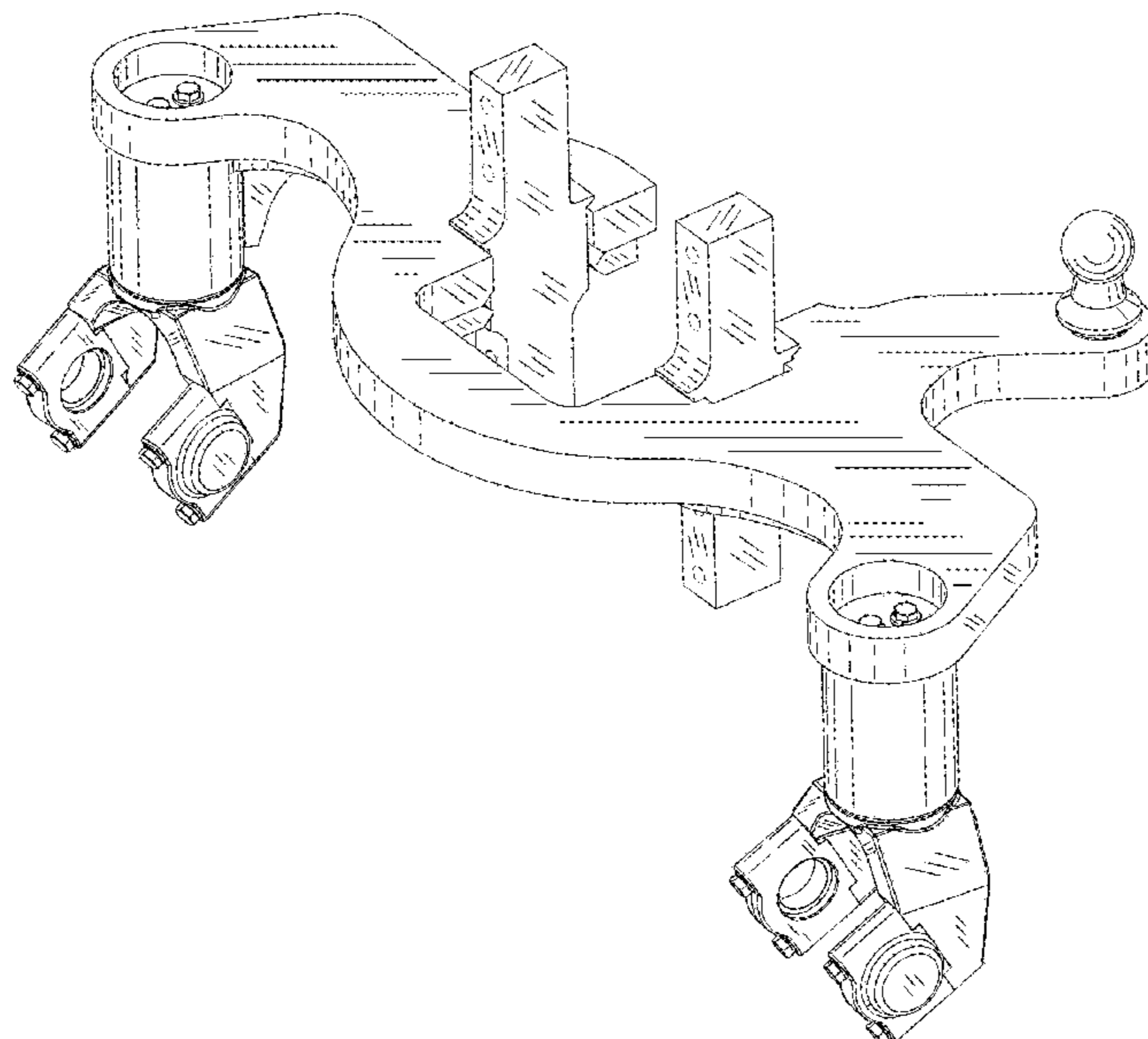

(56)

References Cited

OTHER PUBLICATIONS

Motor Grader GD655-7 [online]. Komatsu, 2020 [retrieved on Apr. 15, 2020]. Retrieved from the Internet: <URL: <https://www.komatsuamerica.com/equipment/motorgraders/ graders/gd655-7>>.

Image of full radial saddle. Case/CNH Industrial America LLC, known prior art as of Oct. 16, 2018.

Image of full radial saddle. Komatsu, known prior art as of Oct. 16, 2018.

Image of full radial saddle. Sany, known prior art as of Oct. 16, 2018.

Image of full radial saddle. Leeboy, known prior art as of Oct. 16, 2018.

Image of 4 bar saddle. John Deere, known prior art as of Oct. 16, 2018.

* cited by examiner

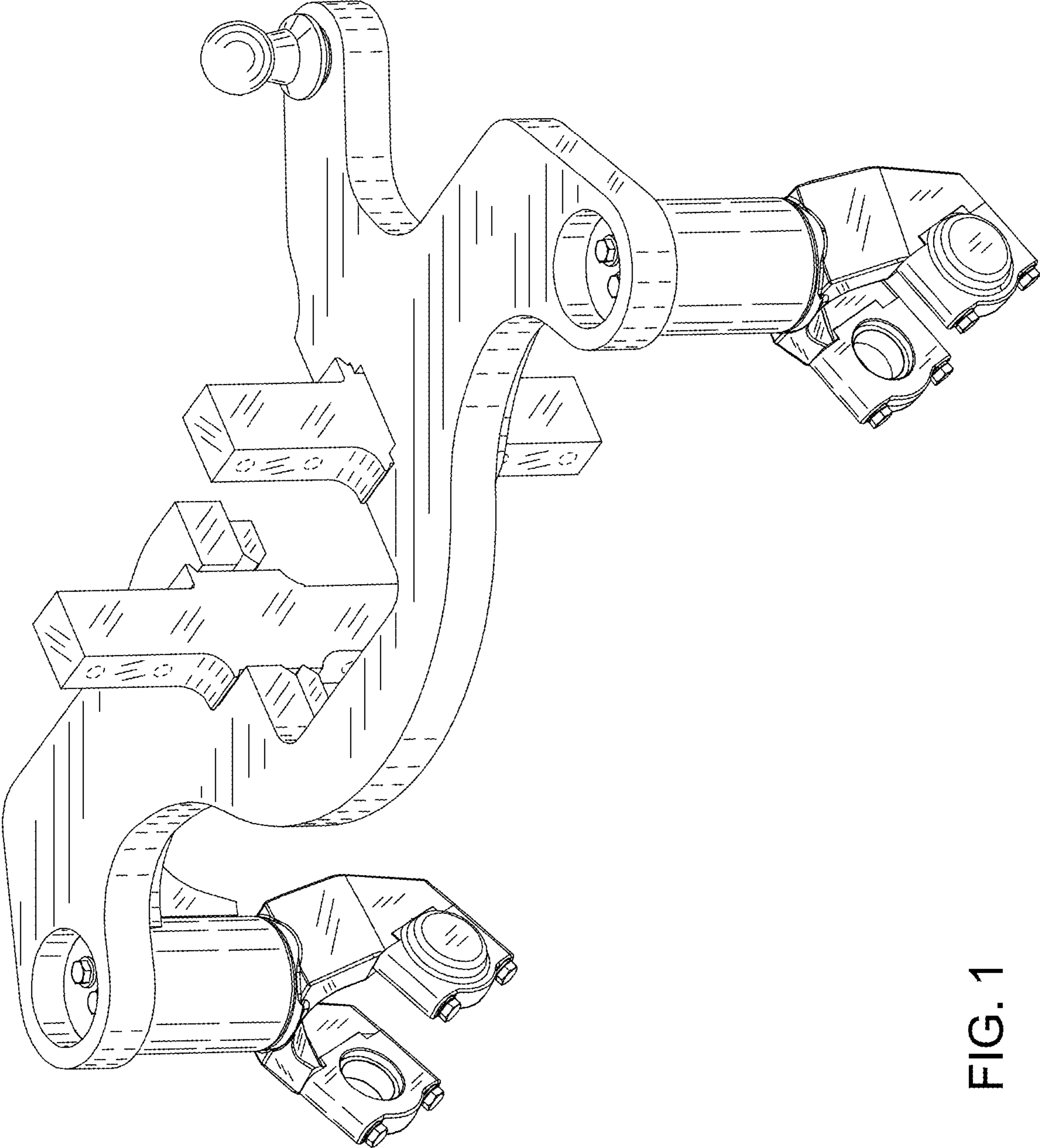

FIG. 1

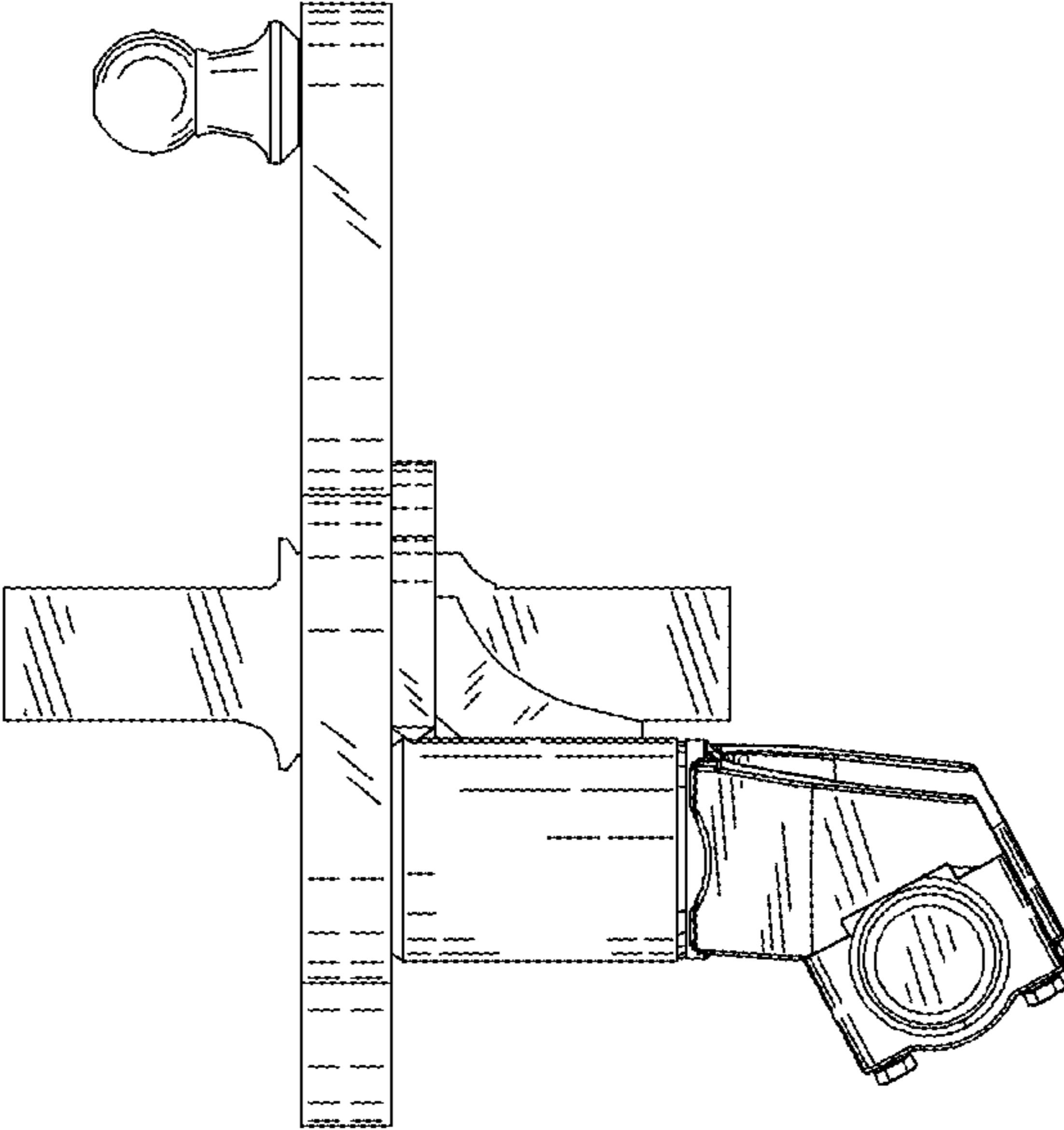

FIG. 2

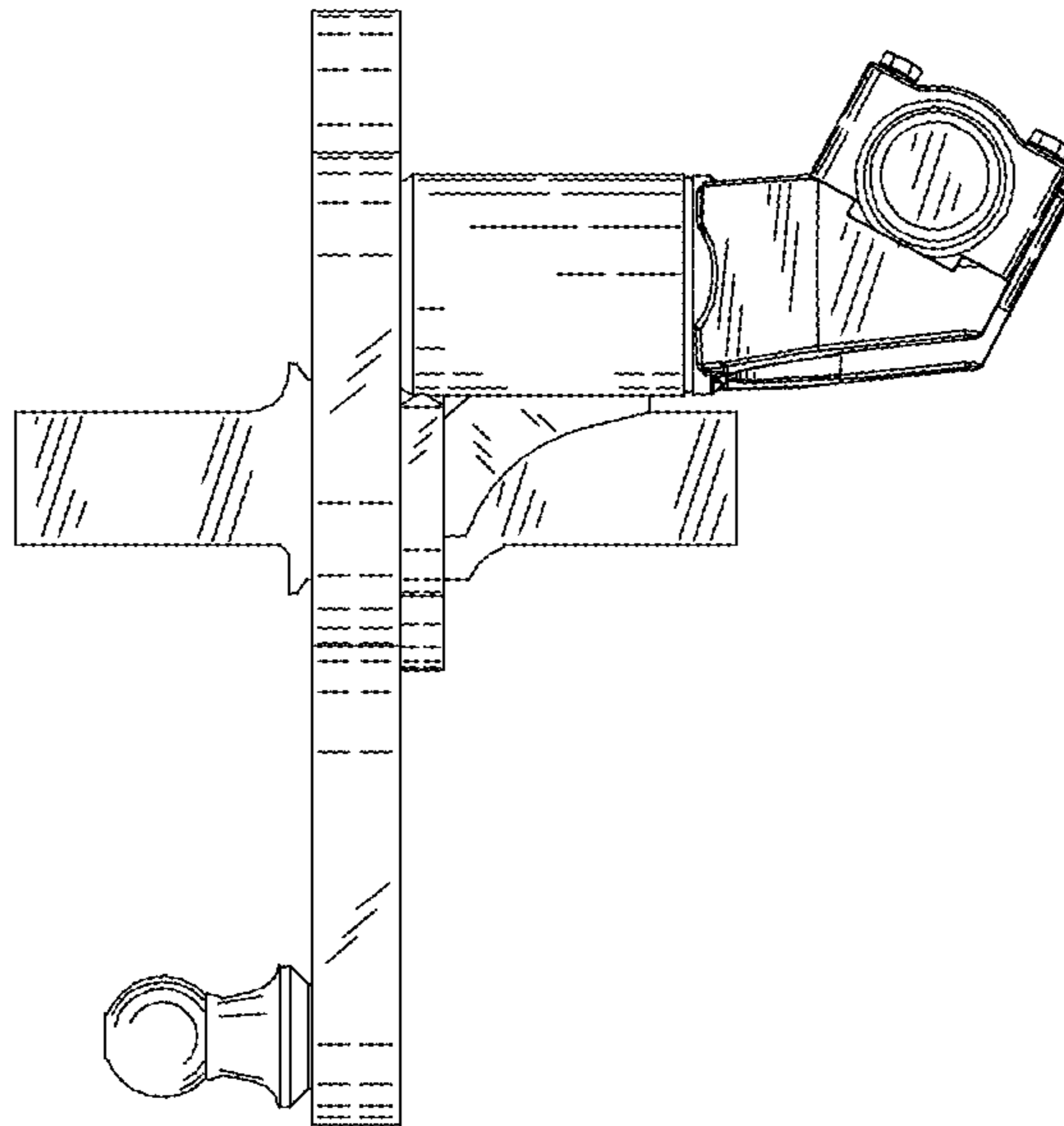

FIG. 3

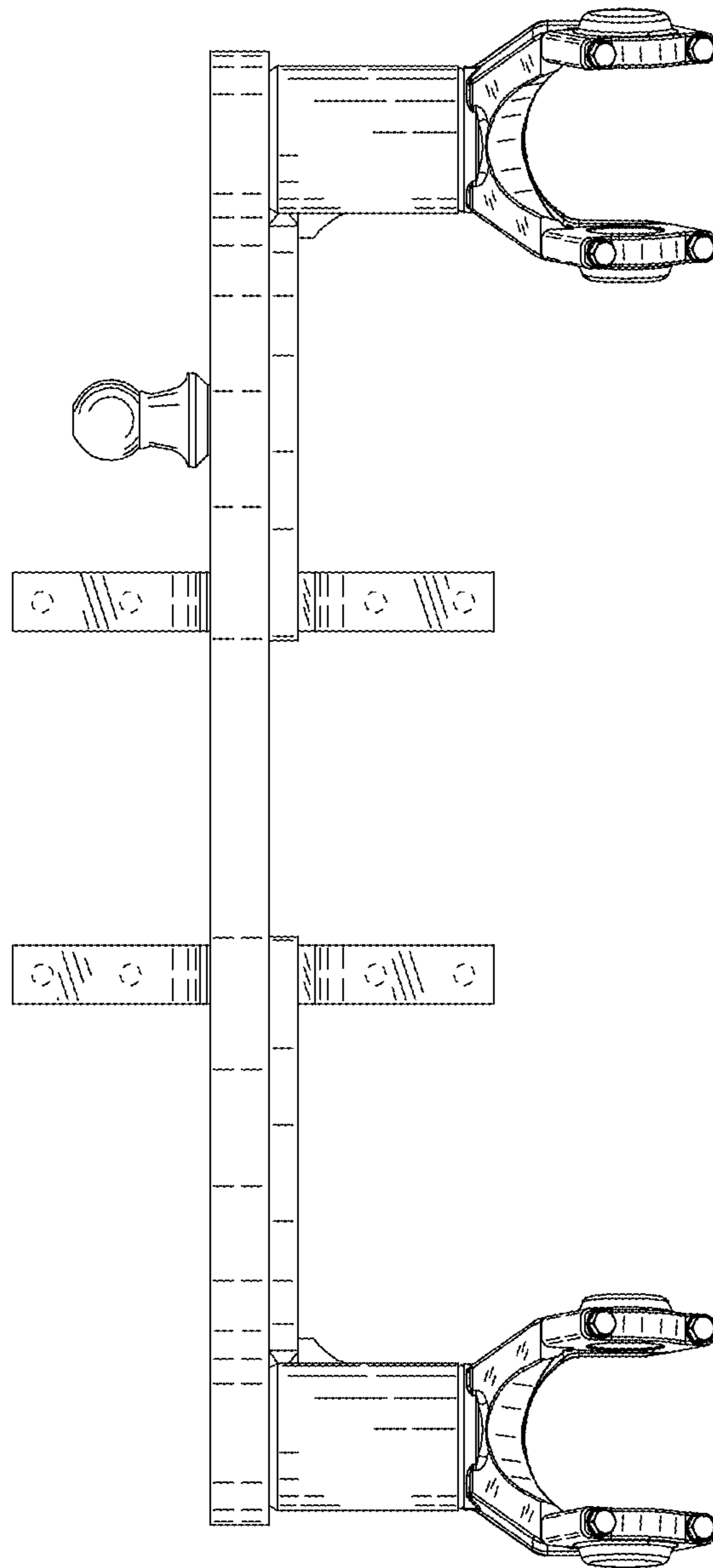

FIG. 4

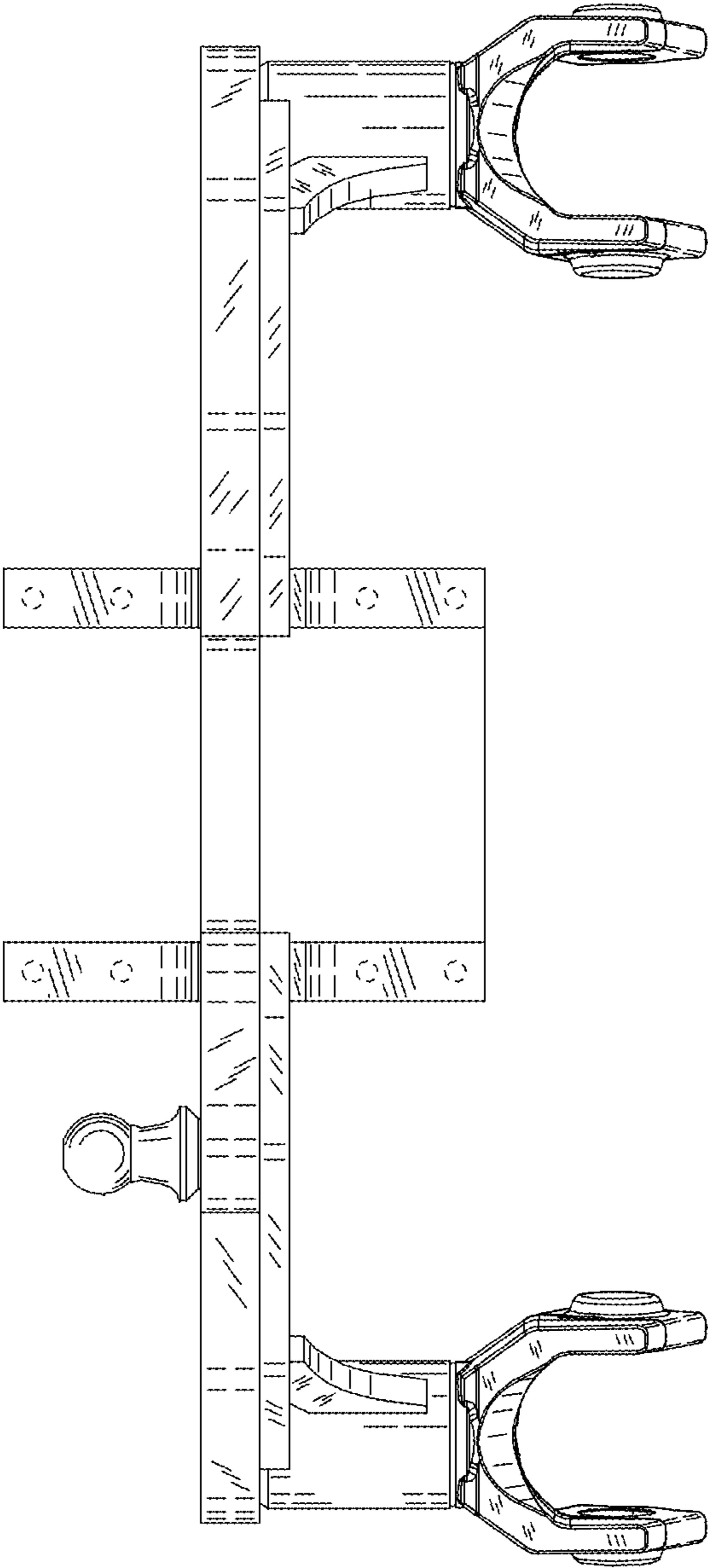

FIG. 5

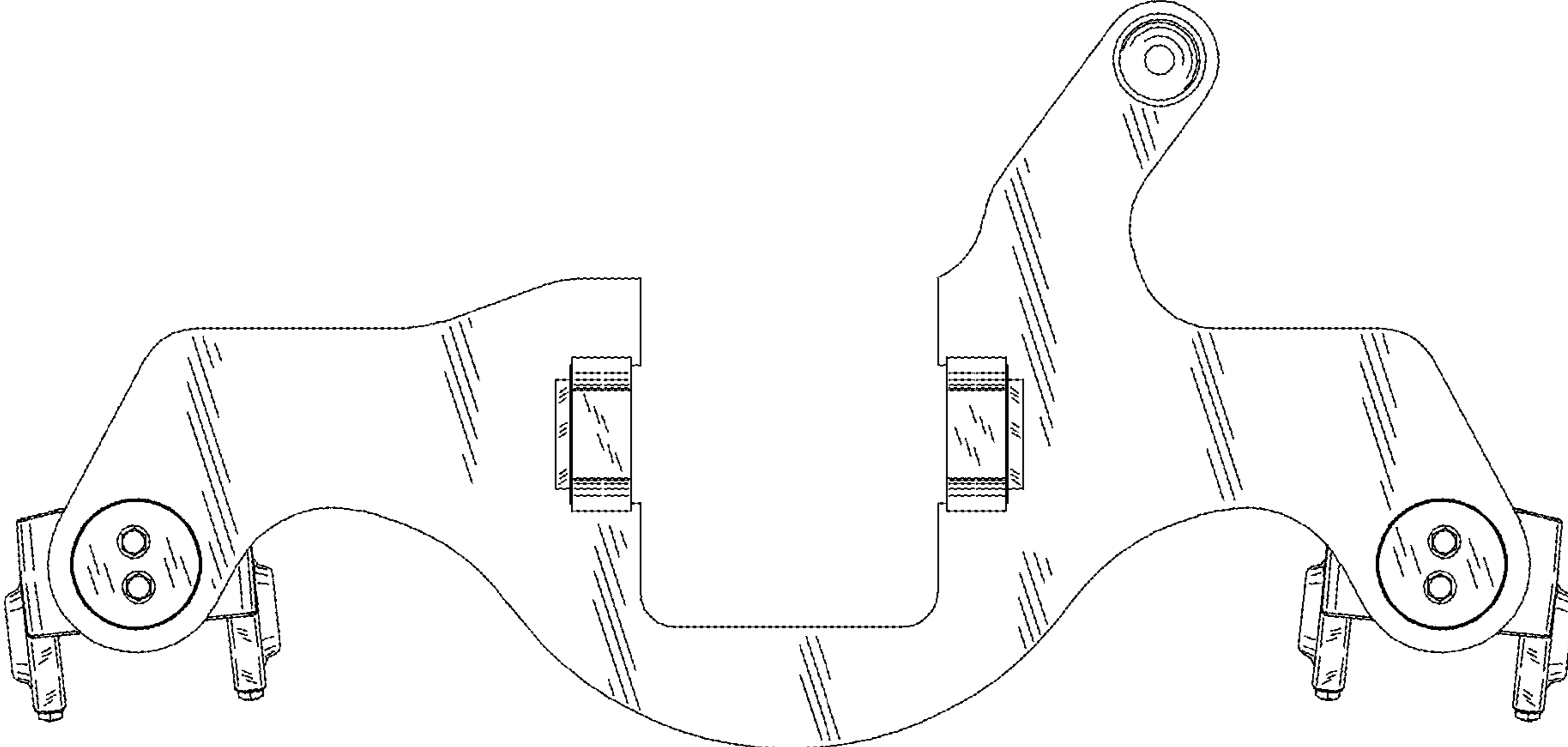

FIG. 6

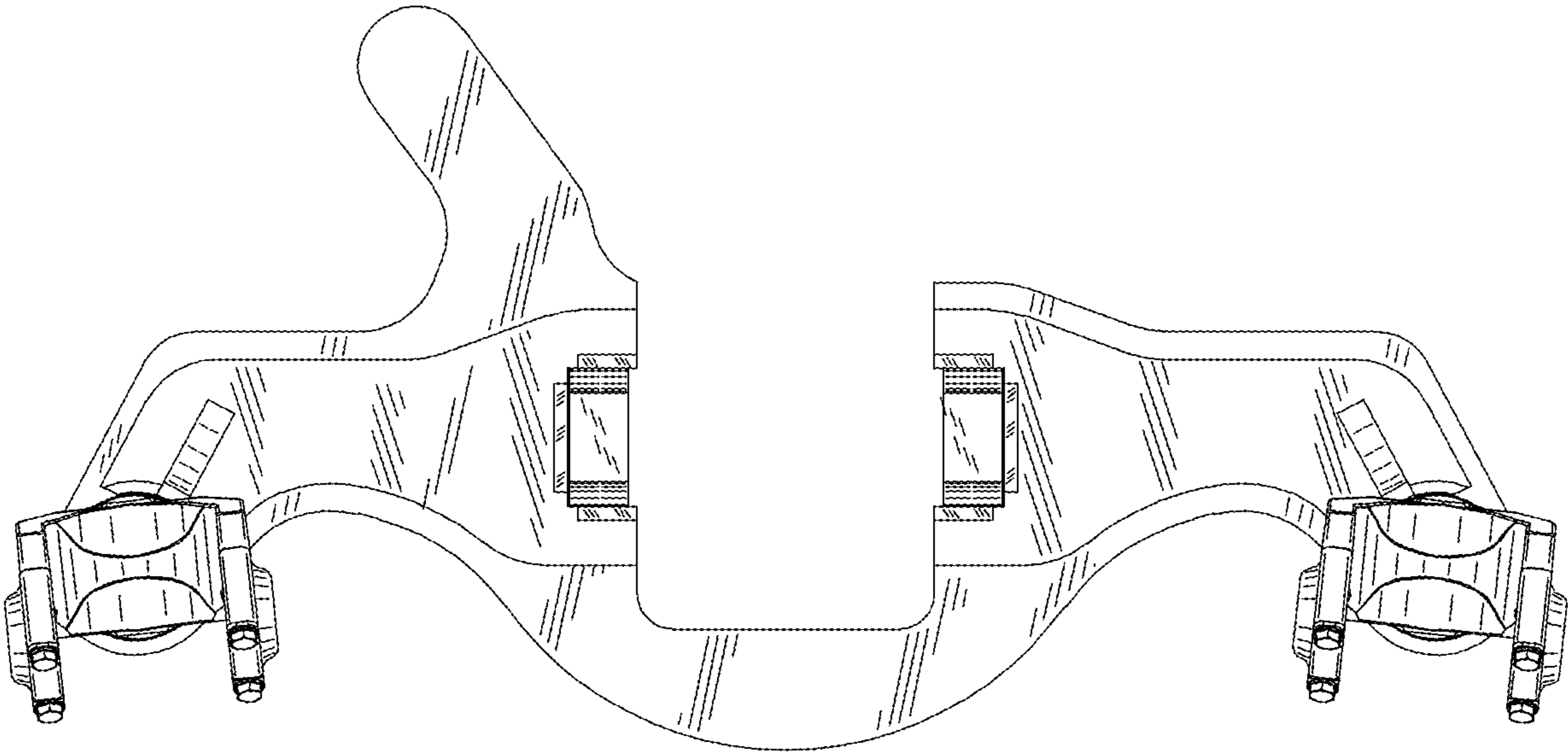

FIG. 7