



US00D913023S

(12) **United States Design Patent**  
**Chiang**

(10) **Patent No.:** **US D913,023 S**

(45) **Date of Patent:** **\*\* Mar. 16, 2021**

(54) **3 TIER RISER**  
(71) Applicant: **My Gift Enterprise, LLC**,  
Woodinville, WA (US)  
(72) Inventor: **Cliff Chiang**, Woodinville, WA (US)  
(\*\*) Term: **15 Years**  
(21) Appl. No.: **29/716,316**

4,760,800 A \* 8/1988 Hanson ..... A47B 81/002  
108/152  
D300,395 S \* 3/1989 Emery, Jr. .... D6/675.1  
D406,962 S \* 3/1999 Simpson, II ..... D6/678.1  
D603,187 S \* 11/2009 Conway ..... D6/677.1  
D774,597 S \* 12/2016 Lowery ..... D21/336  
D813,952 S \* 3/2018 Siepmann ..... D21/336  
D814,217 S \* 4/2018 Clayton ..... D6/678.1  
D830,746 S \* 10/2018 Johnson ..... D6/677.1  
D859,039 S \* 9/2019 Pedersen ..... D6/675.4  
D883,720 S \* 5/2020 Johnson ..... D6/677.1  
2010/0330240 A1\* 12/2010 Jeffery ..... A21C 15/00  
426/383

(22) Filed: **Dec. 9, 2019**  
(51) **LOC (13) Cl.** ..... **06-06**  
(52) **U.S. Cl.**  
USPC ..... **D6/678.2**  
(58) **Field of Classification Search**  
USPC ..... D6/672, 675, 675.1, 678, 678.1, 678.2,  
D6/705, 705.1, 707; D7/500, 501  
CPC ..... A47B 47/00; A47B 47/04; A47B 47/047;  
A47B 96/02; A47F 5/0018; A47F 5/0043;  
A47F 7/00  
See application file for complete search history.

\* cited by examiner

*Primary Examiner* — Kelley A Donnelly  
(74) *Attorney, Agent, or Firm* — Dean A. Craine, P.C.

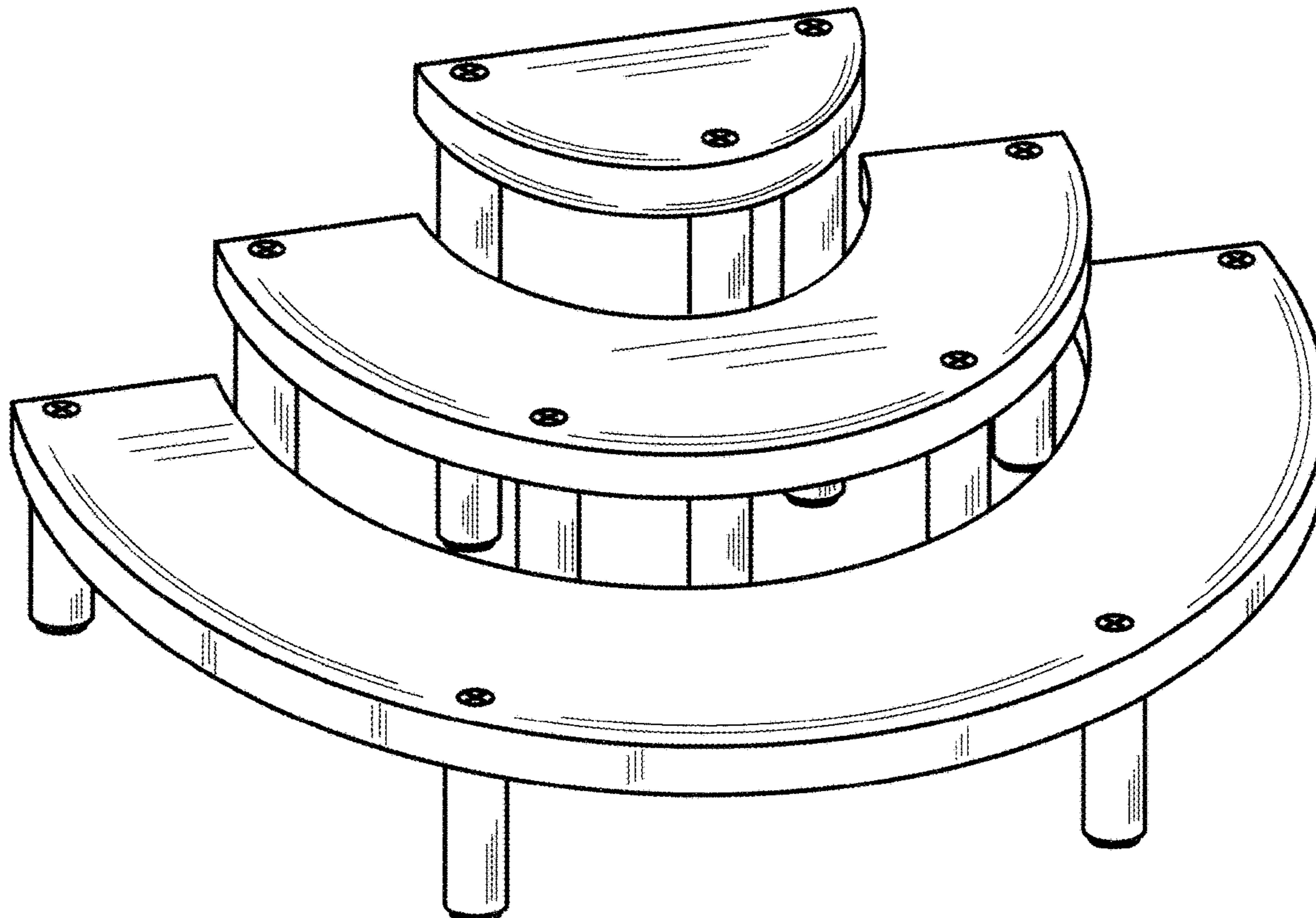
(57) **CLAIM**  
The ornamental design for the 3 tier riser, as shown and described.

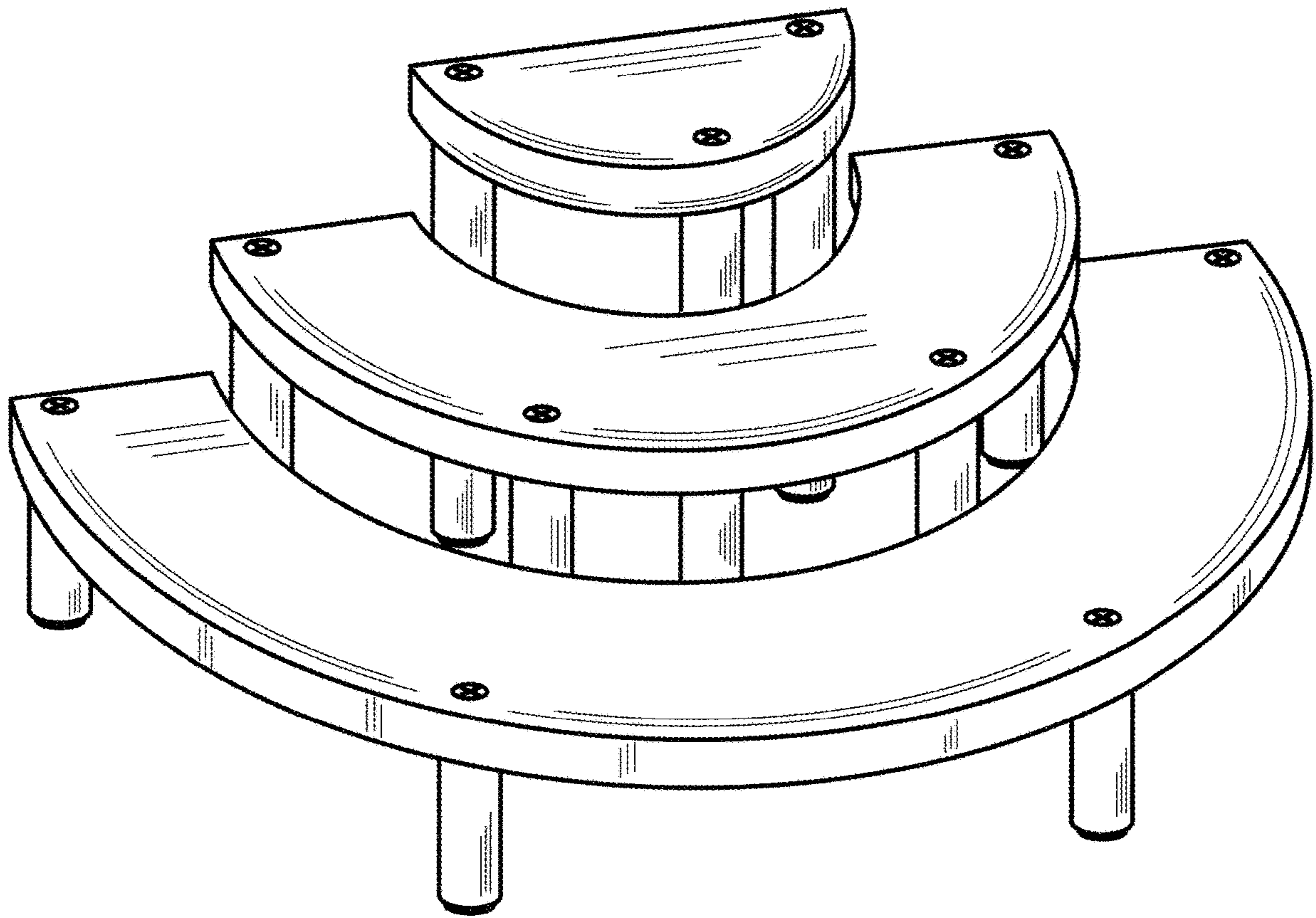
**DESCRIPTION**

FIG. 1 is a front perspective view of a 3 tier riser, showing my new design;  
FIG. 2 is a front elevational view thereof;  
FIG. 3 is a rear elevational view thereof;  
FIG. 4 is a top plan view thereof;  
FIG. 5 is a bottom plan view thereof; and,  
FIG. 6 is a left-side elevational view of the invention, the right-side elevational view being a mirror image thereof.

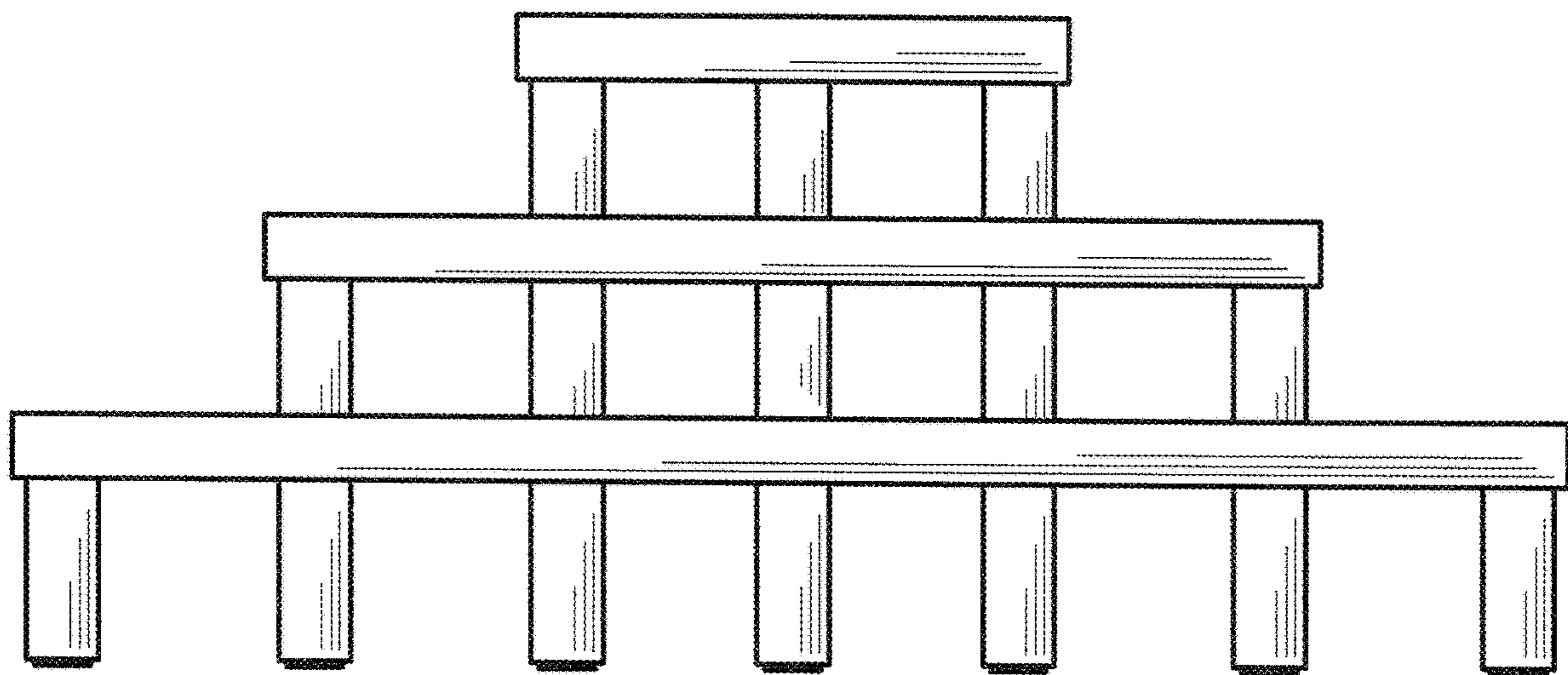
(56) **References Cited**  
U.S. PATENT DOCUMENTS  
D149,046 S \* 3/1948 Blumenthal et al. .... D7/501  
D239,901 S \* 5/1976 Goulder ..... D6/678.1  
D244,323 S \* 5/1977 Stone ..... D3/25  
D254,941 S \* 5/1980 Simmons ..... D6/349  
D263,534 S \* 3/1982 Markus ..... D6/678.1

**1 Claim, 6 Drawing Sheets**

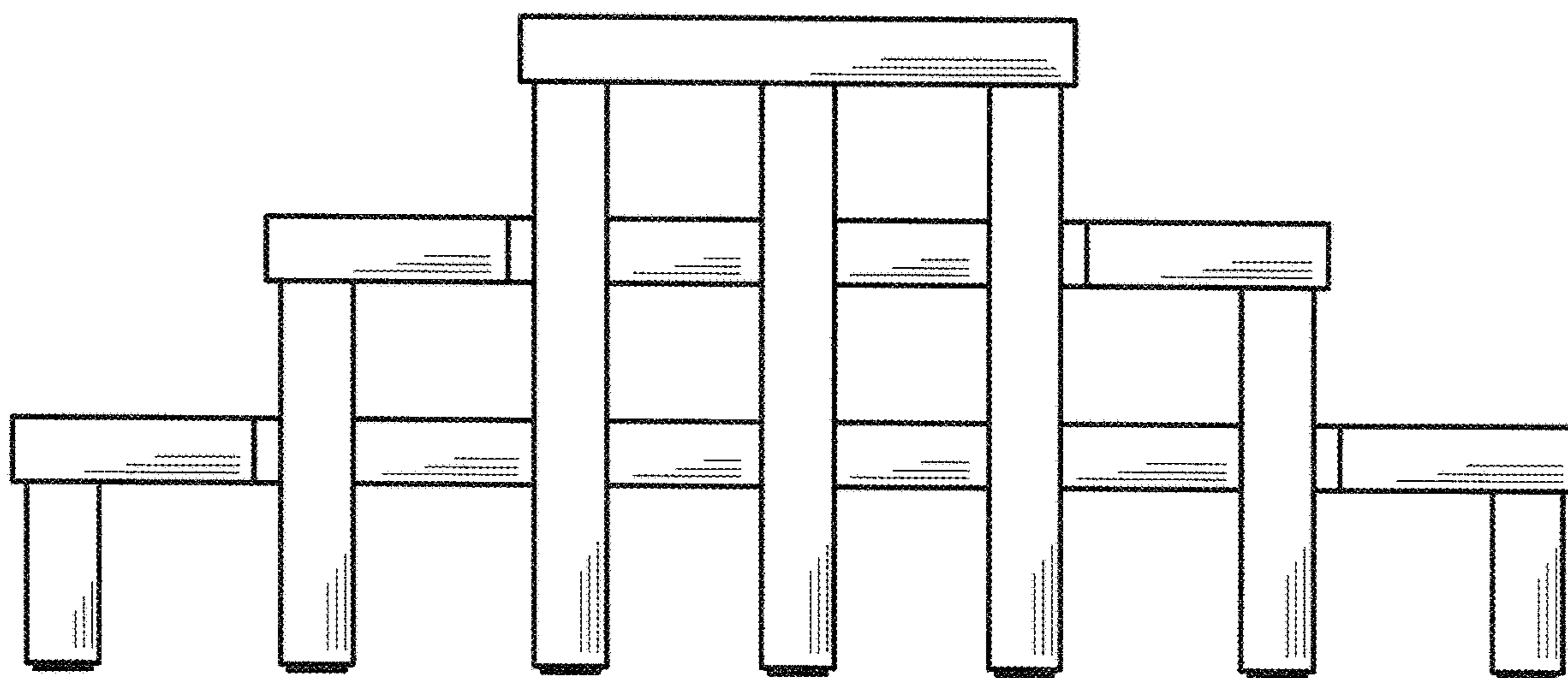




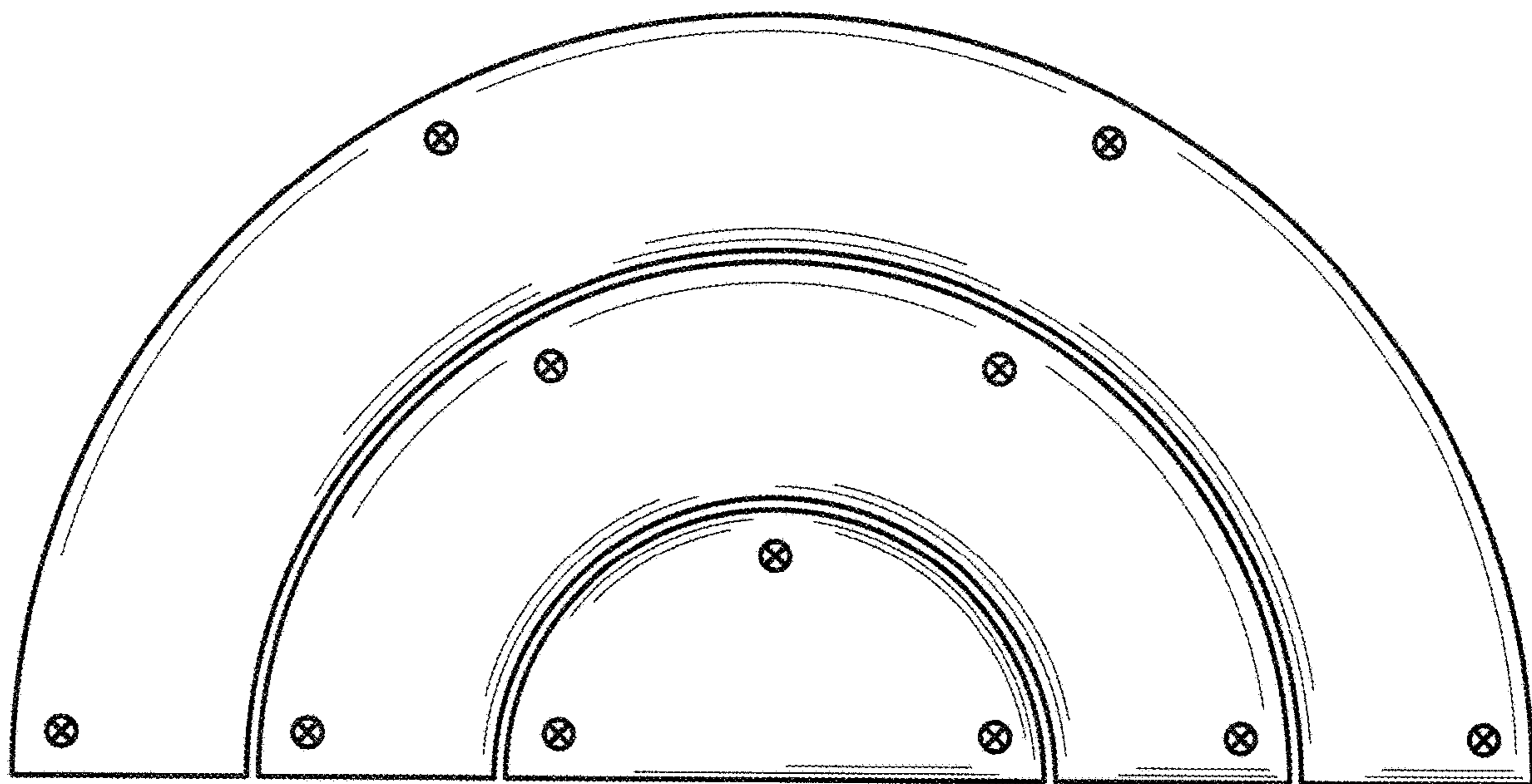
**FIG. 1**



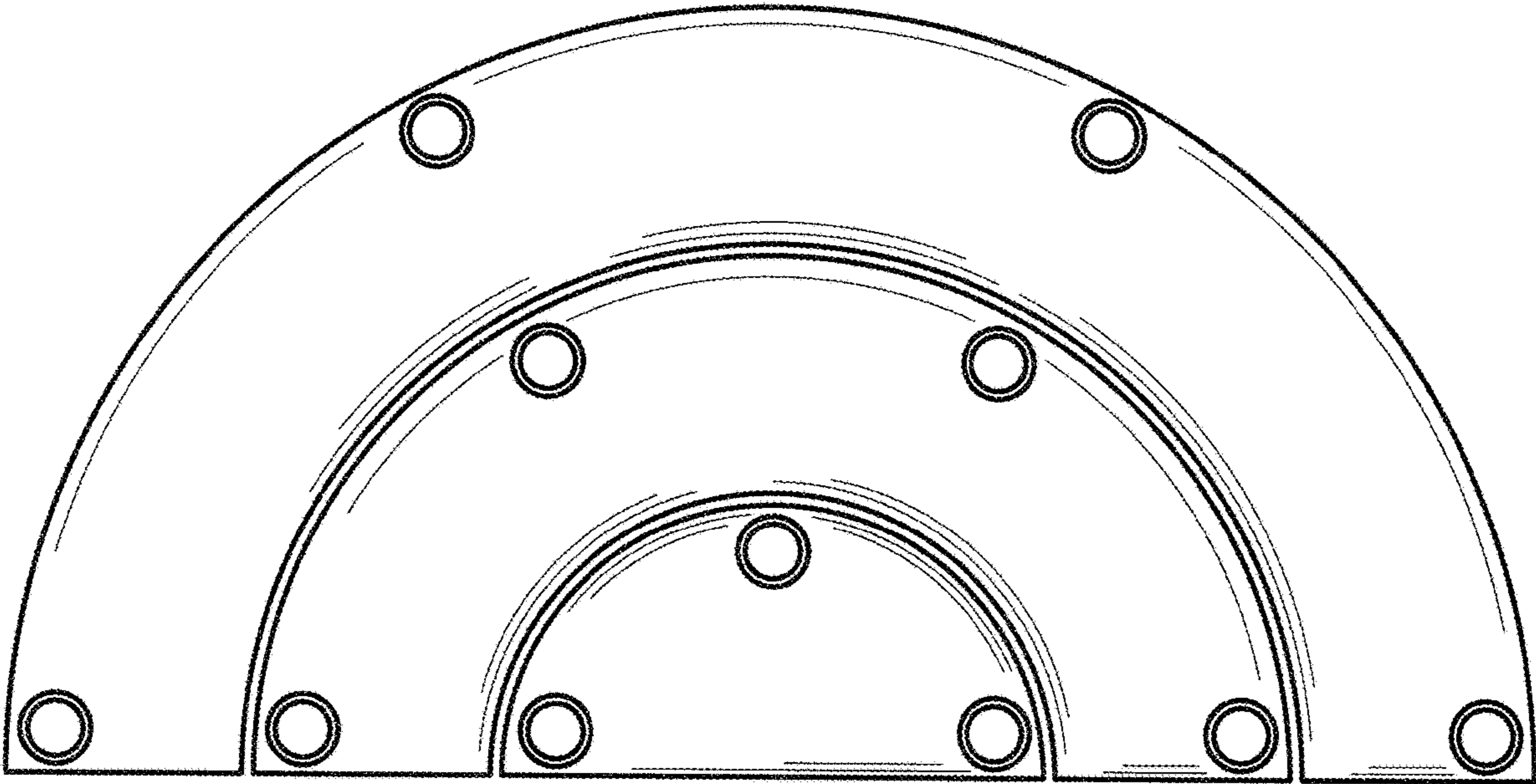
**FIG. 2**



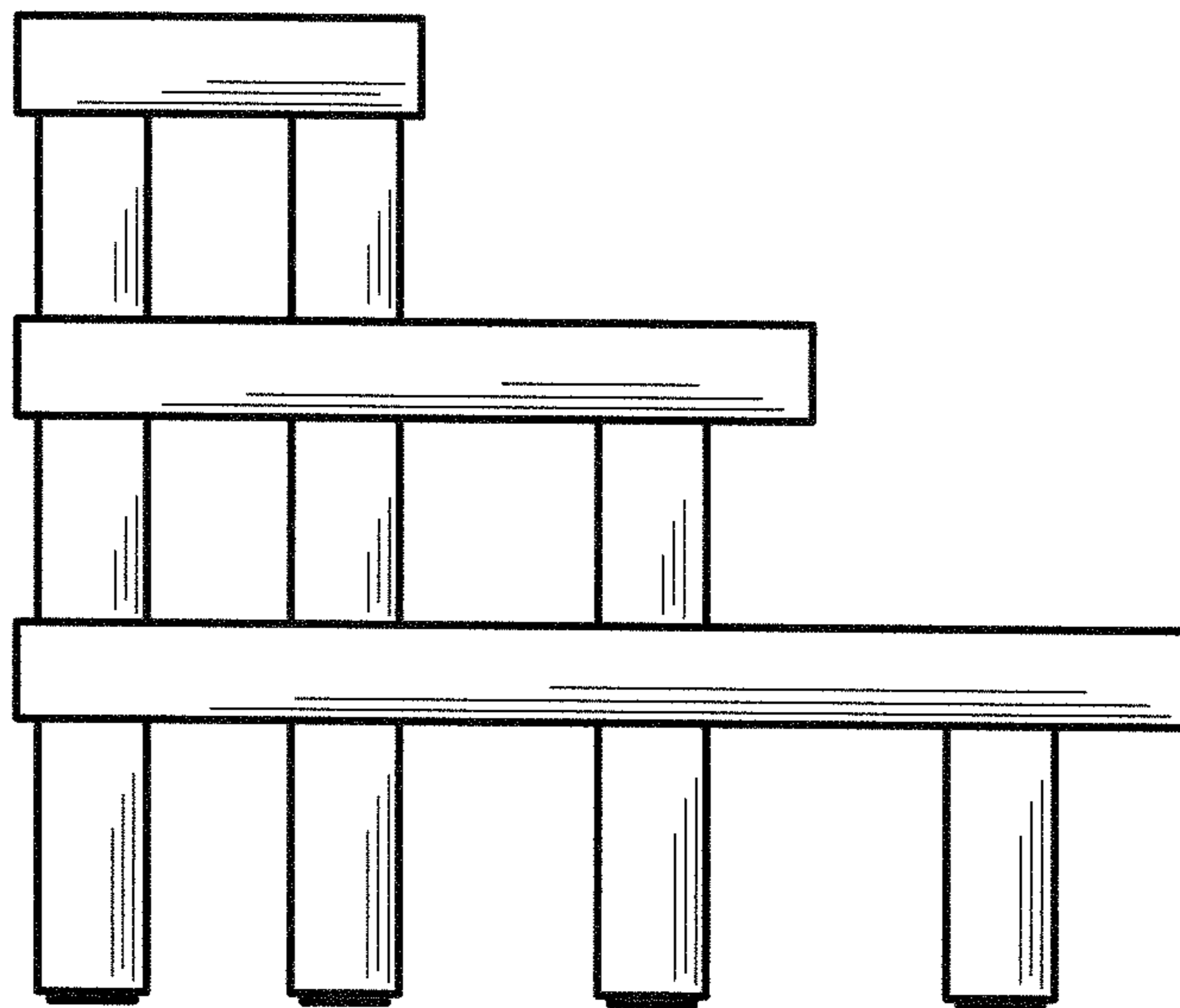
**FIG. 3**



**FIG. 4**



**FIG. 5**



**FIG. 6**