



US00D912687S

(12) **United States Design Patent** (10) **Patent No.:** **US D912,687 S**
Zhang (45) **Date of Patent:** **** Mar. 9, 2021**

(54) **DISPLAY SCREEN OR PORTION THEREOF WITH GRAPHICAL USER INTERFACE**

(71) Applicant: **Ke.com (Beijing)Technology Co., Ltd.**, Beijing (CN)

(72) Inventor: **Ruina Zhang**, Beijing (CN)

(73) Assignee: **Ke.com (Beijing)Technology Co., Ltd.**, Beijing (CN)

(**) Term: **15 Years**

(21) Appl. No.: **29/709,010**

(22) Filed: **Oct. 10, 2019**

(30) **Foreign Application Priority Data**

Apr. 15, 2019 (CN) 201930171952.3

(51) **LOC (13) Cl.** **14-04**

(52) **U.S. Cl.**
USPC **D14/485**

(58) **Field of Classification Search**

USPC D14/485-495
CPC G06F 3/048; G06F 3/0481; G06F 3/04812;
G06F 3/04817; G06F 3/0482; G06F
3/0483; G06F 3/0484; G06F 3/04847;
G06F 3/0485; G06F 3/04855; G06F
3/04886; G06Q 30/00; H03J 1/00; H03J
1/0008; H03J 1/0016; H03J 1/0025;
H04N 5/00; H04N 5/08; H04N 5/14;
H04N 5/222; H04N 5/225; H04N 5/232;
H04N 5/445; H04N 5/44543; H04N 5/45;
H04N

(Continued)

(56) **References Cited**

U.S. PATENT DOCUMENTS

D772,244 S * 11/2016 Jon D14/485
D775,649 S * 1/2017 Anzures D14/486

(Continued)

OTHER PUBLICATIONS

“Adding a Floor Plan.” support.cupix.com. Jun. 19, 2019. Accessed Dec. 11, 2020. Available online at URL: <https://support.cupix.com/support/solutions/articles/27000048806-adding-a-floor-plan> (Year: 2019).*

(Continued)

Primary Examiner — Christian P. McLean

(74) *Attorney, Agent, or Firm* — Sterne, Kessler, Goldstein & Fox P.L.L.C.

(57) **CLAIM**

The ornamental design for a display screen or portion thereof with graphical user interface, as shown and described.

DESCRIPTION

The file of this patent contains at least one drawing/photograph executed in color. Copies of this patent with color drawing(s)/photograph(s) will be provided by the Office upon request and payment of the necessary fee.

FIG. 1 is a front view of a display screen or portion thereof with graphical user interface showing the claimed design; and,

FIG. 2 is a front view of a display screen or portion thereof with graphical user interface showing the claimed design.

The outermost dashed broken lines in the figures show a display screen or portion thereof, and form no part of the claimed design.

The other dashed broken lines and the dot-dash broken lines in the figures show boundaries that form no part of the claimed design.

The areas between the dashed broken lines and the dot-dash broken lines in the figures show portions of the graphical user interface that form no part of the claimed design.

1 Claim, 2 Drawing Sheets
(1 of 2 Drawing Sheet(s) Filed in Color)

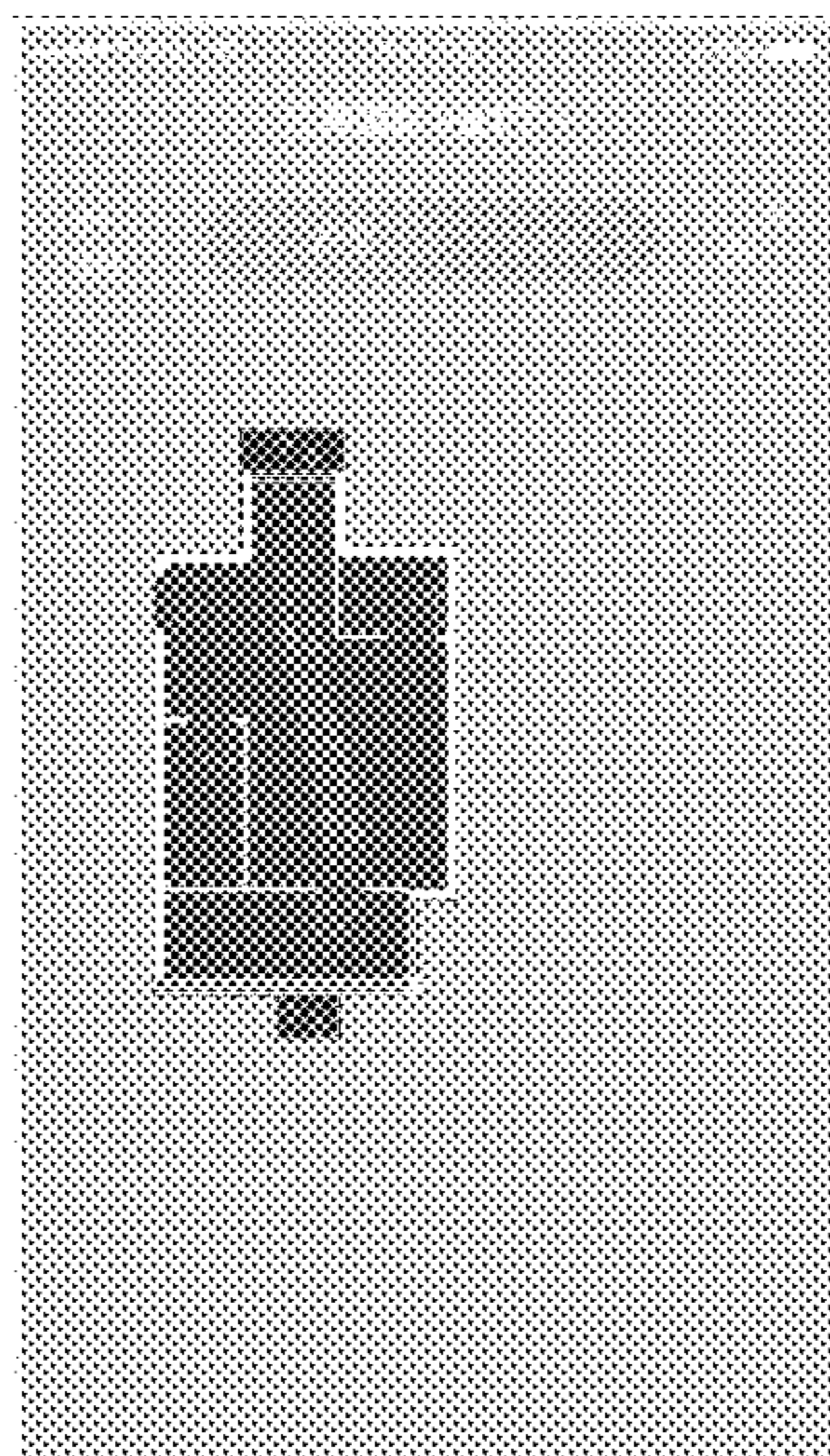

(58) **Field of Classification Search**

CPC 2005/44517; H04N 2005/44521; H04N
 2005/44526; H04N 2005/4453; H04N
 2005/44534; H04N 2005/44539; H04N
 2005/44547; H04N 2005/44556; H04N
 2005/4456; H04N 2005/44565; H04N
 2005/44569; H04N 2005/44573; H04N
 21/00; H04N 21/234; H04N 21/431;
 H04N 21/4312; H04N 21/4314; H04N
 21/4316

See application file for complete search history.

D903,692 S * 12/2020 Kang D14/485
 D904,431 S * 12/2020 Park D14/485
 10,853,992 B1 * 12/2020 Zhu G06T 15/40
 2014/0336824 A1 * 11/2014 Sasaki G05B 15/02
 700/276
 2016/0117086 A1 * 4/2016 Huang G06F 9/451
 715/736
 2017/0185277 A1 * 6/2017 Sundermeyer G06F 3/04817
 2018/0067593 A1 * 3/2018 Tiwari G08B 13/04
 2018/0205567 A1 * 7/2018 Piaskowski G05B 15/02

OTHER PUBLICATIONS

(56)

References Cited

U.S. PATENT DOCUMENTS

D777,760 S * 1/2017 Zhao D14/486
 9,651,928 B2 * 5/2017 Sasaki H04L 12/2803
 D790,567 S * 6/2017 Su D14/486
 D801,983 S * 11/2017 Sonneville D14/485
 D836,652 S * 12/2018 Fowler D14/486
 D842,330 S * 3/2019 Yao D14/488
 D842,877 S * 3/2019 Karunamuni D14/486
 D859,447 S * 9/2019 Anzures D14/486
 D869,480 S * 12/2019 Barnett D14/485
 D875,779 S * 2/2020 Sakuma D14/488
 D877,753 S * 3/2020 Chitalia D14/485

“Avantgarde Properties #5—WIP.” dribbble.com. Sep. 8, 2019. Accessed Dec. 11, 2020. Available online at URL: <https://dribbble.com/shots/7090263-Avantgarde-Properties-5-WIP> (Year: 2019).*

“The easiest way to control a building.” innea.de. Available Apr. 9, 2013. Accessed Dec. 11, 2020. Retrieved online via Internet Archive Wayback Machine at URL: <https://web.archive.org/web/20130409084908/http://www.innea.de/en/products/guis-floorplans/gui/> (Year: 2013).*

Vink, Luke. “Hass.io Floorplan UI with color synced lights.” youtube.com. Feb. 6, 2020. Accessed Dec. 11, 2020. Available online at URL: https://www.youtube.com/watch?v=KcfZc1MXP_A&feature=youtu.be (Year: 2020).*

* cited by examiner

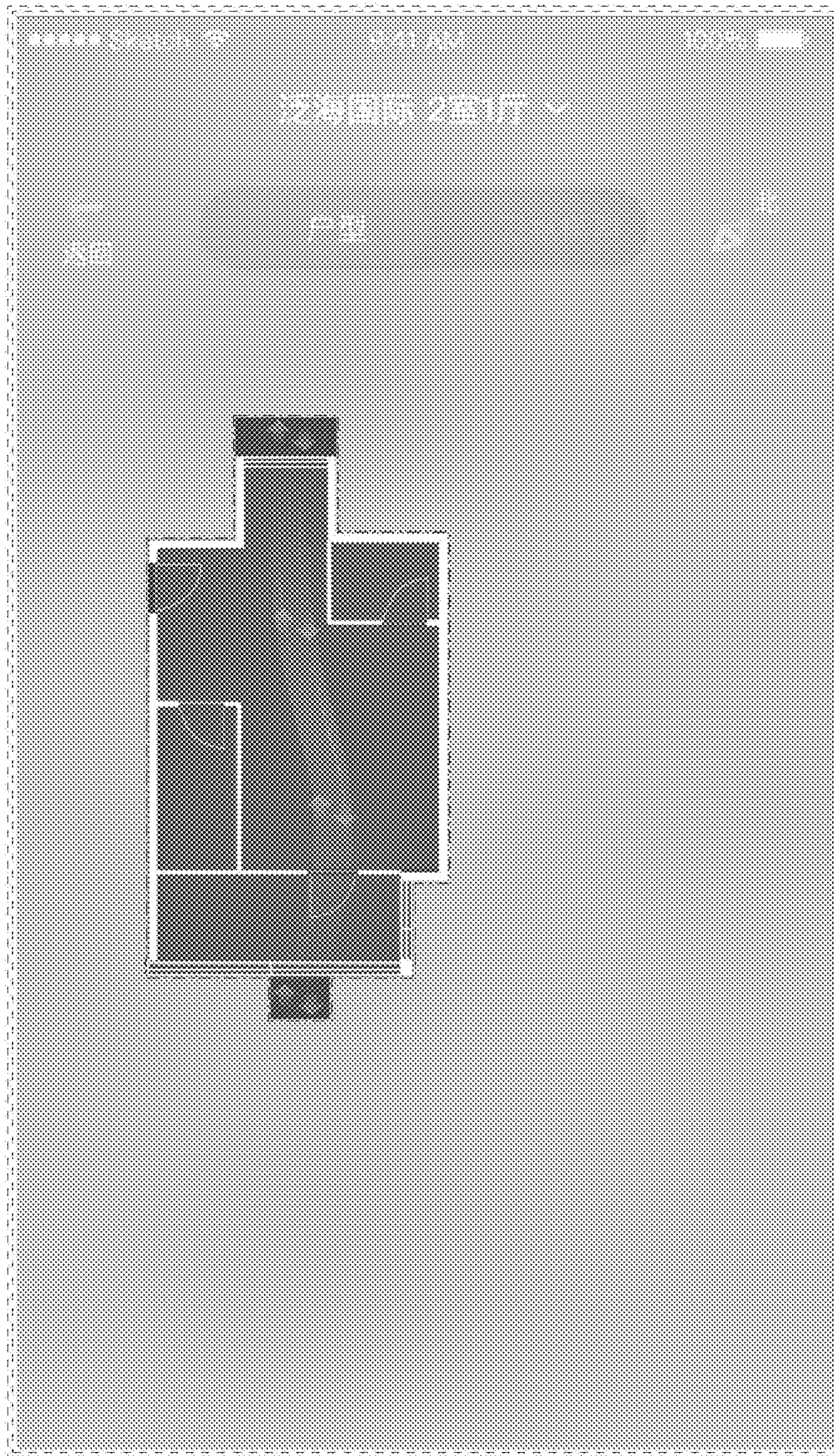

FIG. 1

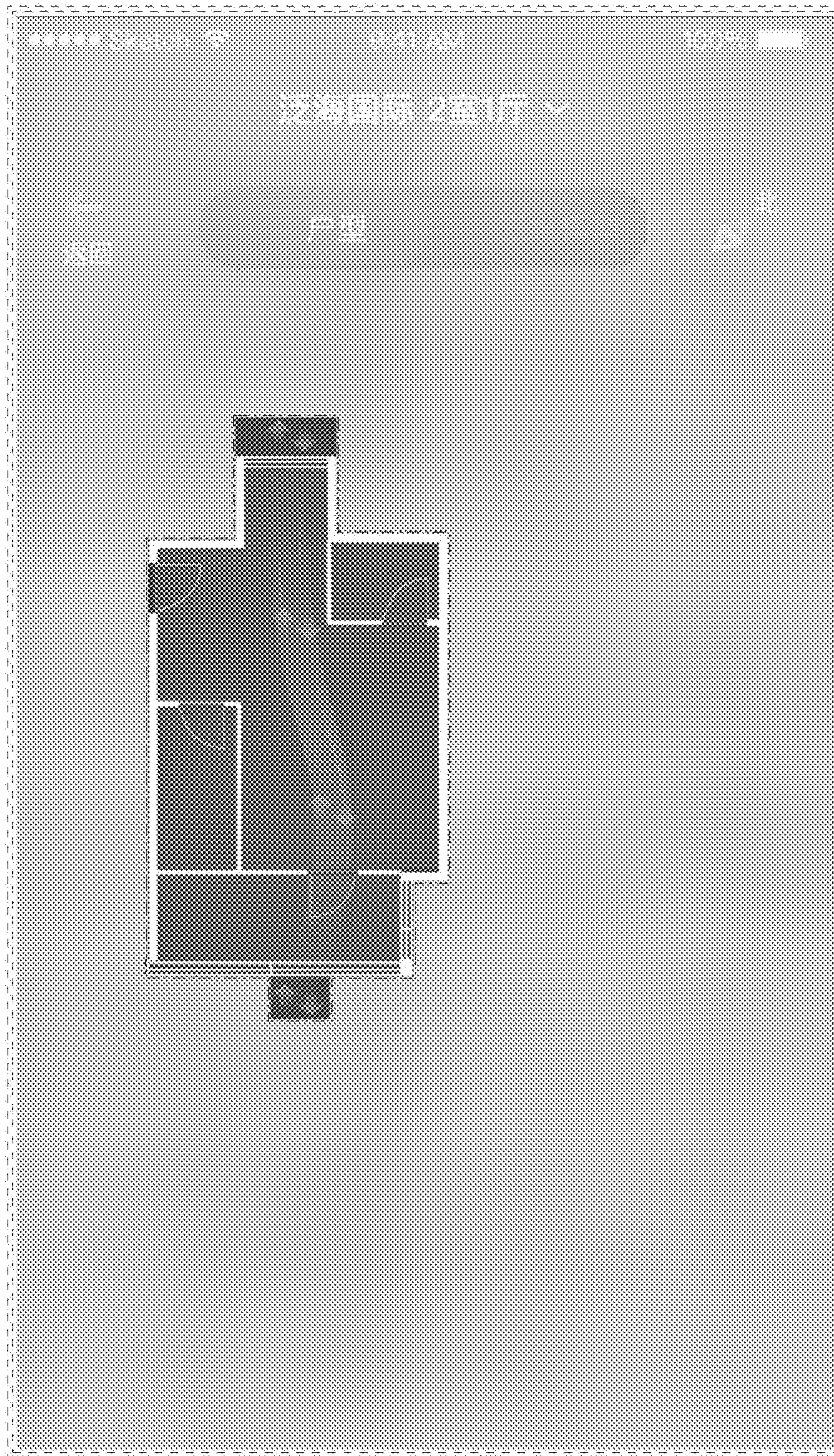

FIG. 2

UNITED STATES PATENT AND TRADEMARK OFFICE
CERTIFICATE OF CORRECTION

PATENT NO. : D912,687 S
APPLICATION NO. : 29/709010
DATED : March 9, 2021
INVENTOR(S) : Ruina Zhang

Page 1 of 3

It is certified that error appears in the above-identified patent and that said Letters Patent is hereby corrected as shown below:

On the Title Page

Delete the title page and substitute therefore with the attached title page consisting of the corrected illustrative figure.

In the Drawings

Please replace Figure 1 with replacement Figure 1 on the attached Replacement Sheet.

Signed and Sealed this
Twenty-first Day of June, 2022
Katherine Kelly Vidal

Katherine Kelly Vidal
Director of the United States Patent and Trademark Office

(12) **United States Design Patent** (10) **Patent No.:** **US D912,687 S**
Zhang (45) **Date of Patent:** **** Mar. 9, 2021**

(54) **DISPLAY SCREEN OR PORTION THEREOF WITH GRAPHICAL USER INTERFACE**

(71) Applicant: **Ke.com (Beijing)Technology Co., Ltd.**, Beijing (CN)

(72) Inventor: **Ruina Zhang**, Beijing (CN)

(73) Assignee: **Ke.com (Beijing)Technology Co., Ltd.**, Beijing (CN)

(**) Term: **15 Years**

(21) Appl. No.: **29/709,010**

(22) Filed: **Oct. 10, 2019**

(30) **Foreign Application Priority Data**

Apr. 15, 2019 (CN) 201930171952.3

(51) **LOC (13) Cl.** **14-04**

(52) **U.S. Cl.**
 USPC **D14/485**

(58) **Field of Classification Search**

USPC D14/485-495

CPC G06F 3/048; G06F 3/0481; G06F 3/04812;

G06F 3/04817; G06F 3/0482; G06F

3/0483; G06F 3/0484; G06F 3/04847;

G06F 3/0485; G06F 3/04855; G06F

3/04886; G06Q 30/00; H03J 1/00; H03J

1/0008; H03J 1/0016; H03J 1/0025;

H04N 5/00; H04N 5/08; H04N 5/14;

H04N 5/222; H04N 5/225; H04N 5/232;

H04N 5/445; H04N 5/44543; H04N 5/45;

H04N

(Continued)

(56) **References Cited**

U.S. PATENT DOCUMENTS

D772,244 S * 11/2016 Jon D14/485

D775,649 S * 1/2017 Anzures D14/486

(Continued)

OTHER PUBLICATIONS

“Adding a Floor Plan.” support.cupix.com. Jun. 19, 2019. Accessed Dec. 11, 2020. Available online at URL: <https://support.cupix.com/support/solutions/articles/27000048806-adding-a-floor-plan> (Year: 2019).*

(Continued)

Primary Examiner — Christian P. McLean

(74) *Attorney, Agent, or Firm* — Sterne, Kessler, Goldstein & Fox P.L.L.C.

(57) **CLAIM**

The ornamental design for a display screen or portion thereof with graphical user interface, as shown and described.

DESCRIPTION

The file of this patent contains at least one drawing/photograph executed in color. Copies of this patent with color drawing(s)/photograph(s) will be provided by the Office upon request and payment of the necessary fee.

FIG. 1 is a front view of a display screen or portion thereof with graphical user interface showing the claimed design; and,

FIG. 2 is a front view of a display screen or portion thereof with graphical user interface showing the claimed design.

The outermost dashed broken lines in the figures show a display screen or portion thereof, and form no part of the claimed design.

The other dashed broken lines and the dot-dash broken lines in the figures show boundaries that form no part of the claimed design.

The areas between the dashed broken lines and the dot-dash broken lines in the figures show portions of the graphical user interface that form no part of the claimed design.

1 Claim, 2 Drawing Sheets
(1 of 2 Drawing Sheet(s) Filed in Color)

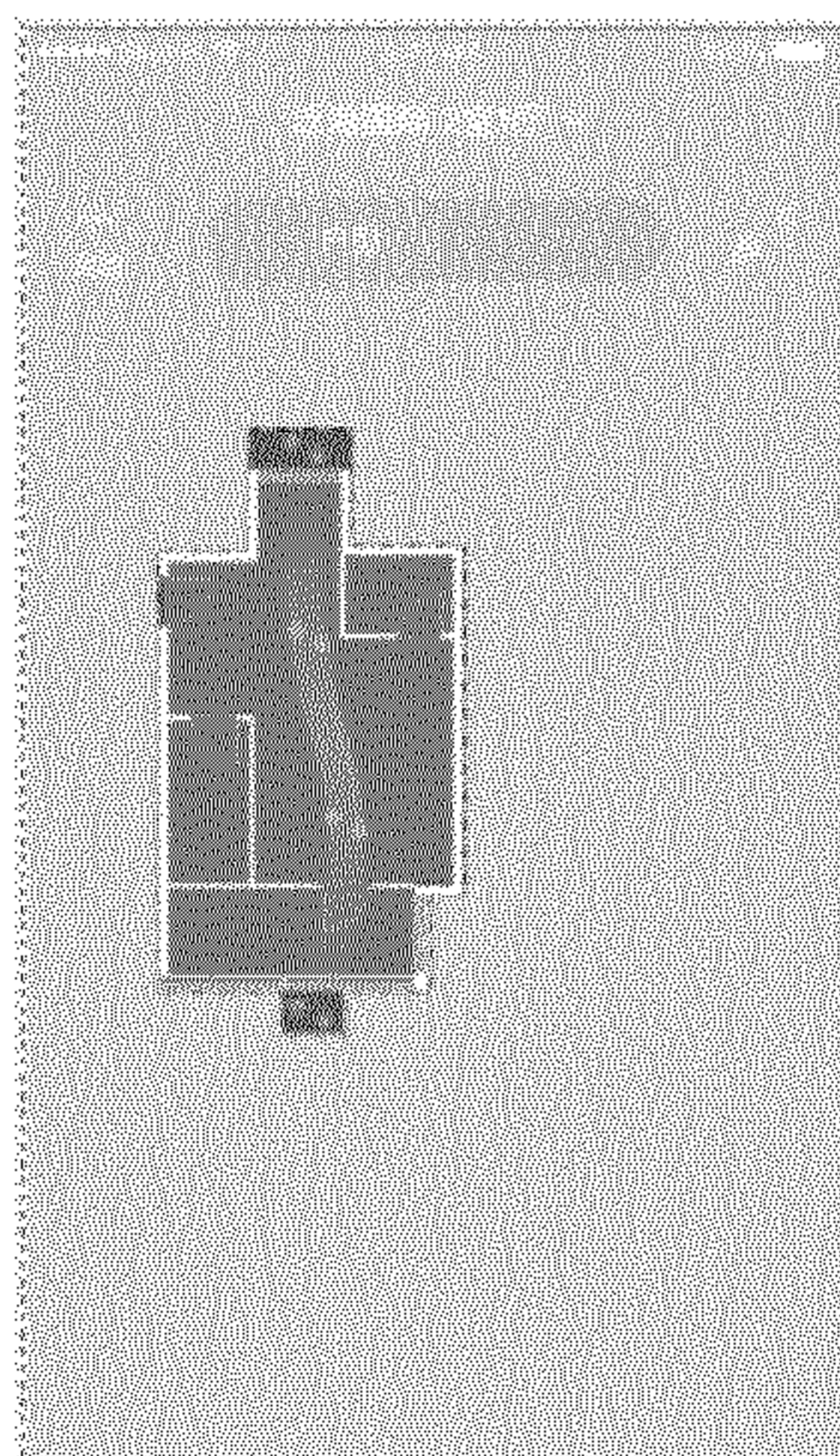

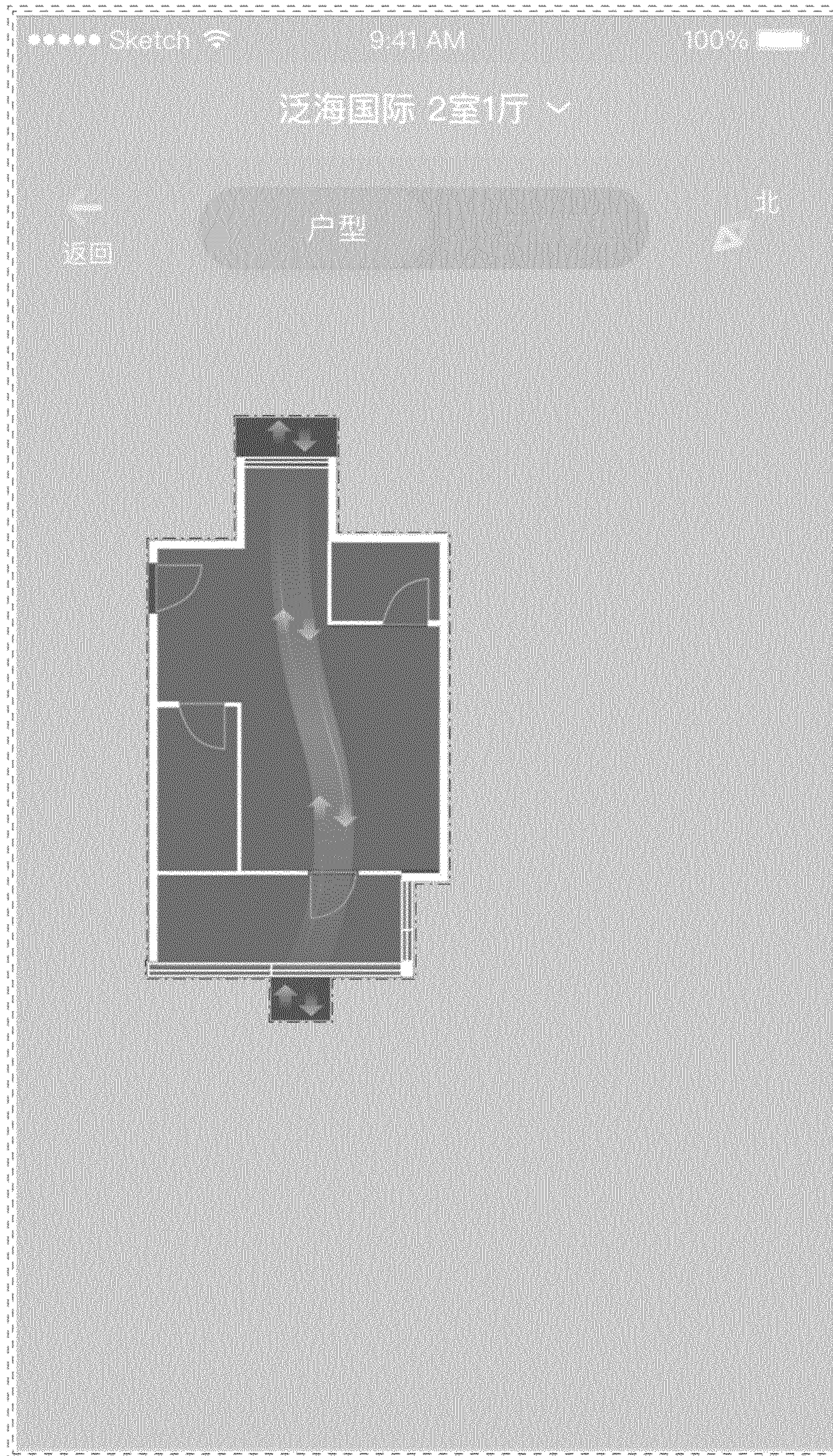

FIG. 1