



US00D912499S

(12) **United States Design Patent** (10) **Patent No.:** **US D912,499 S**
Zech (45) **Date of Patent:** **** Mar. 9, 2021**

(54) **HANDLE HANGER**

DESCRIPTION

(71) Applicant: **CAPACIOUS CLOSETS, LLC**,
Chicago, IL (US)

(72) Inventor: **Ellen Zech**, Chicago, IL (US)

(73) Assignee: **CAPACIOUS CLOSETS, LLC**,
Chicago, IL (US)

(**) Term: **15 Years**

(21) Appl. No.: **29/637,636**

(22) Filed: **Feb. 20, 2018**

Related U.S. Application Data

(63) Continuation-in-part of application No. 29/554,974,
filed on Feb. 17, 2016, now Pat. No. Des. 810,551.

(51) **LOC (13) Cl.** **08-05**

(52) **U.S. Cl.**
USPC **D8/373**

(58) **Field of Classification Search**

USPC D8/355, 363, 366, 367, 371, 372, 373,
D8/365; D3/328; D6/323, 324, 327,
D6/328, 534, 526, 531, 538, 553, 524
CPC A45C 11/00; A45C 13/26; A45C 15/00;
A45C 9/00; A47F 9/042; A47F 13/085
See application file for complete search history.

(56) **References Cited**

U.S. PATENT DOCUMENTS

2,726,004 A * 12/1955 McLeod B65D 21/0201
220/23.2
3,042,742 A * 7/1962 Foster F21V 21/16
174/69

(Continued)

Primary Examiner — Eliza Z Bennett-Hattan
(74) *Attorney, Agent, or Firm* — Flener IP & Business
Law; Zareefa B. Flener

(57) **CLAIM**

The ornamental design for a handle hanger, as shown and
described.

FIG. 1 is a top front isometric view of a handle hanger showing a first embodiment of my new design; FIG. 2 is a front elevation view of the design of FIG. 1, and the rear view is a mirror image of the front view; FIG. 3 is a right side elevational view thereof, and the left side elevational view is a mirror image of the right view; FIG. 4 is a top plan view thereof; FIG. 5 is a bottom plan view thereof; FIG. 6 is a top front isometric view of a handle hanger showing a second embodiment of my new design; FIG. 7 is a front elevation view of the design of FIG. 6, and the rear view is a mirror image of the front view; FIG. 8 is a left side elevational view thereof; FIG. 9 is a top plan view thereof; FIG. 10 is a right side elevational view thereof; FIG. 11 is a bottom plan view thereof; FIG. 12 is a top front isometric view of a handle hanger showing a third embodiment of my new design; FIG. 13 is a front elevation view of the design of FIG. 12, and the rear view is a mirror image of the front view; FIG. 14 is a right side elevational view thereof, and the left side elevational view is a mirror image of the right view; FIG. 15 is a top plan view thereof; FIG. 16 is a bottom plan view thereof; FIG. 17 is a top front isometric view of a handle hanger showing a fourth embodiment of my new design; FIG. 18 is a front elevation view of the design of FIG. 17, and the rear view is a mirror image of the front view; FIG. 19 is a right side elevational view thereof, and the left side elevational view is a mirror image of the right view; FIG. 20 is a top plan view thereof; FIG. 21 is a bottom plan view thereof; FIG. 22 is a top front isometric view of a handle hanger showing a fifth embodiment of my new design; FIG. 23 is a front elevation view of the design of FIG. 22, and the rear view is a mirror image of the front view; FIG. 24 is a right side elevational view thereof, and the left side elevational view is a mirror image of the right view; FIG. 25 is a top plan view thereof; FIG. 26 is a bottom plan view thereof; FIG. 27 is a top front isometric view of a handle hanger showing a sixth embodiment of my new design;

(Continued)

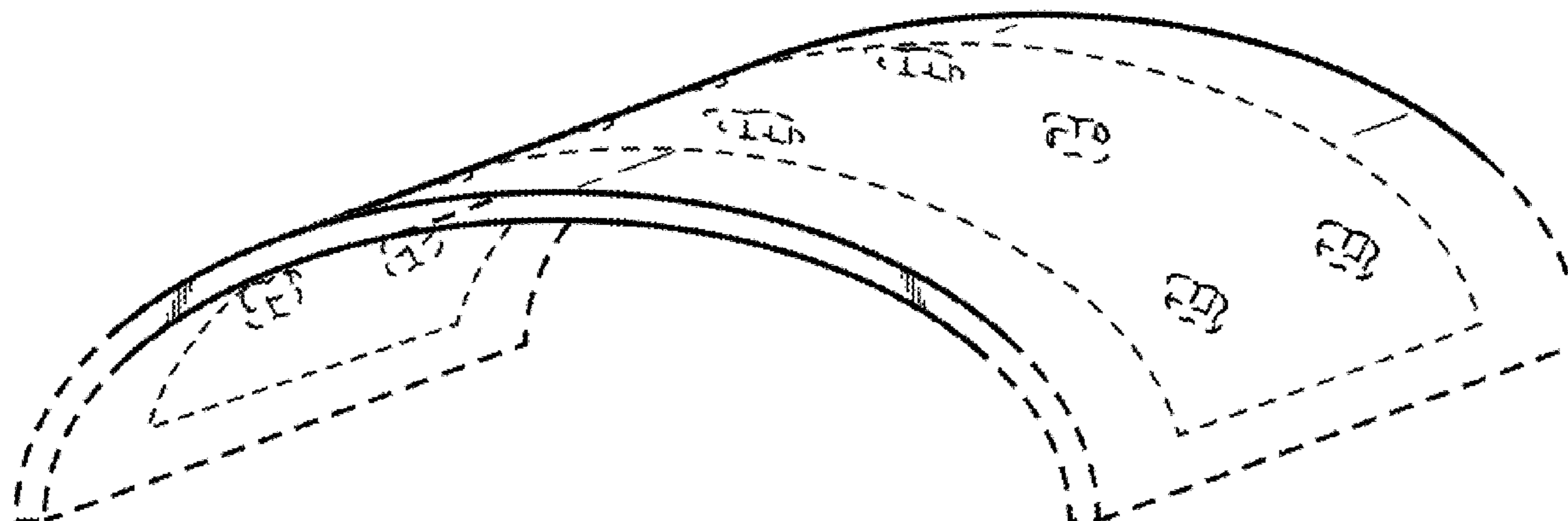

FIG. 28 is a front elevation view of the design of FIG. 27, and the rear view is a mirror image of the front view; FIG. 29 is a right side elevational view thereof, and the left side elevational view is a mirror image of the right view; FIG. 30 is a top plan view thereof; FIG. 31 is a bottom plan view thereof; FIG. 32 is a top front isometric view of a handle hanger showing a seventh embodiment of my new design; FIG. 33 is a front elevation view of the design of FIG. 32, and the rear view is a mirror image of the front view; FIG. 34 is a right side elevational view thereof, and the left side elevational view is a mirror image of the right view; FIG. 35 is a top plan view thereof; and, FIG. 36 is a bottom plan view thereof.

1 Claim, 7 Drawing Sheets

(56)

References Cited

U.S. PATENT DOCUMENTS

3,638,890 A * 2/1972 Burrell A47G 25/28
 248/215
 D377,866 S * 2/1997 Samples D3/328

5,744,218 A * 4/1998 Barnes B32B 27/00
 428/192
 5,845,804 A * 12/1998 Prescott B65D 81/3879
 220/739
 D404,526 S * 1/1999 Motta D28/46
 6,053,378 A * 4/2000 Doyel A47G 25/60
 211/113
 7,828,254 B2 * 11/2010 Stephens-De Alanis
 A45D 44/00
 248/158
 D650,082 S * 12/2011 Roggenkamp D24/184
 D684,034 S * 6/2013 Vaughan D8/354
 D707,535 S * 6/2014 Burr D8/363
 D712,663 S * 9/2014 Gasparino D3/328
 D715,627 S * 10/2014 Pan D8/371
 D723,905 S * 3/2015 Fugett D8/380
 D748,458 S * 2/2016 Zech D8/373
 D764,594 S * 8/2016 Aragon D20/43
 D765,997 S * 9/2016 Sandgrund D6/327
 D799,308 S * 10/2017 Zech D8/373
 D810,551 S * 2/2018 Zech D8/373
 D832,583 S * 11/2018 Tripaldi D3/328
 D887,718 S * 6/2020 Tripaldi D3/328
 2016/0095404 A1 * 4/2016 Zech A45C 13/002
 383/15

* cited by examiner

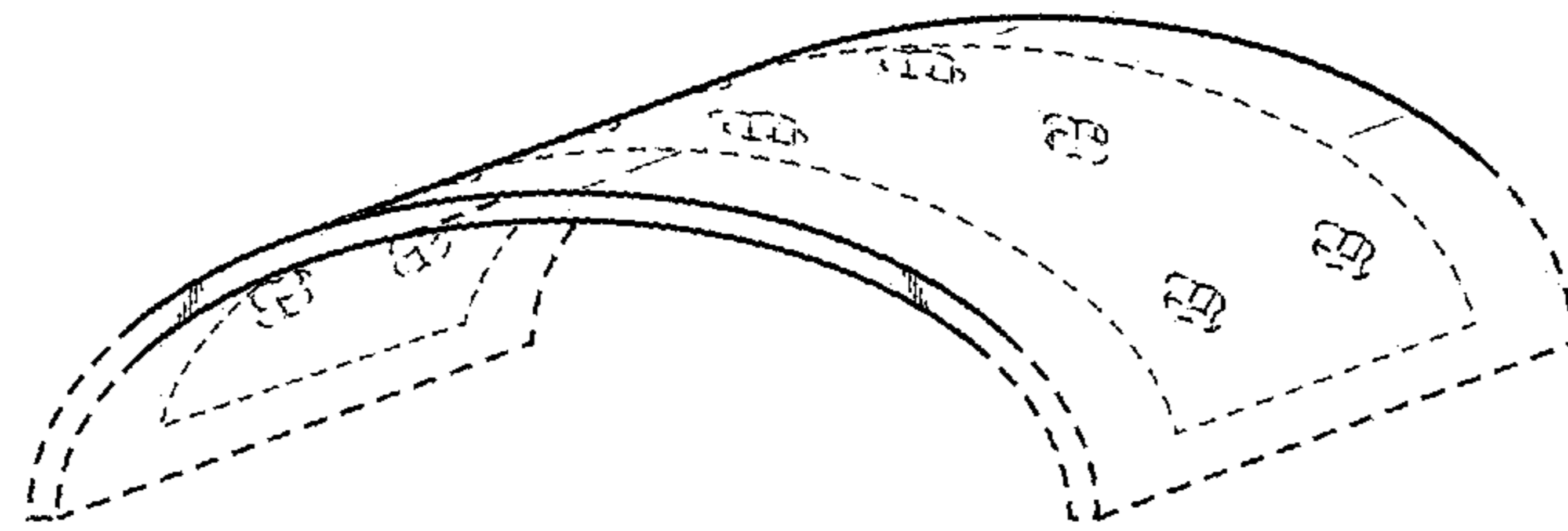

FIG. 1



FIG. 2

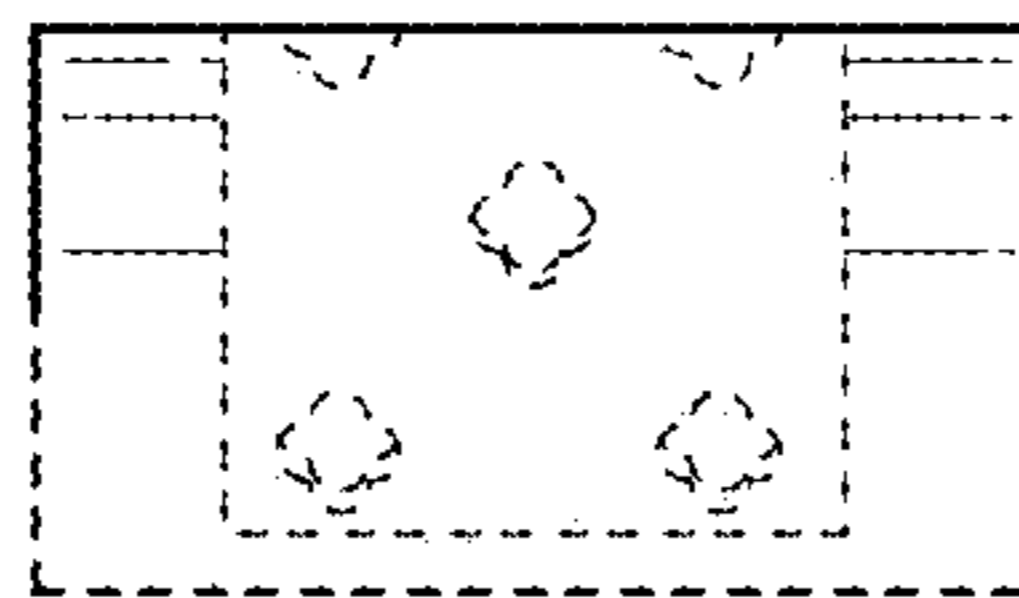

FIG. 3

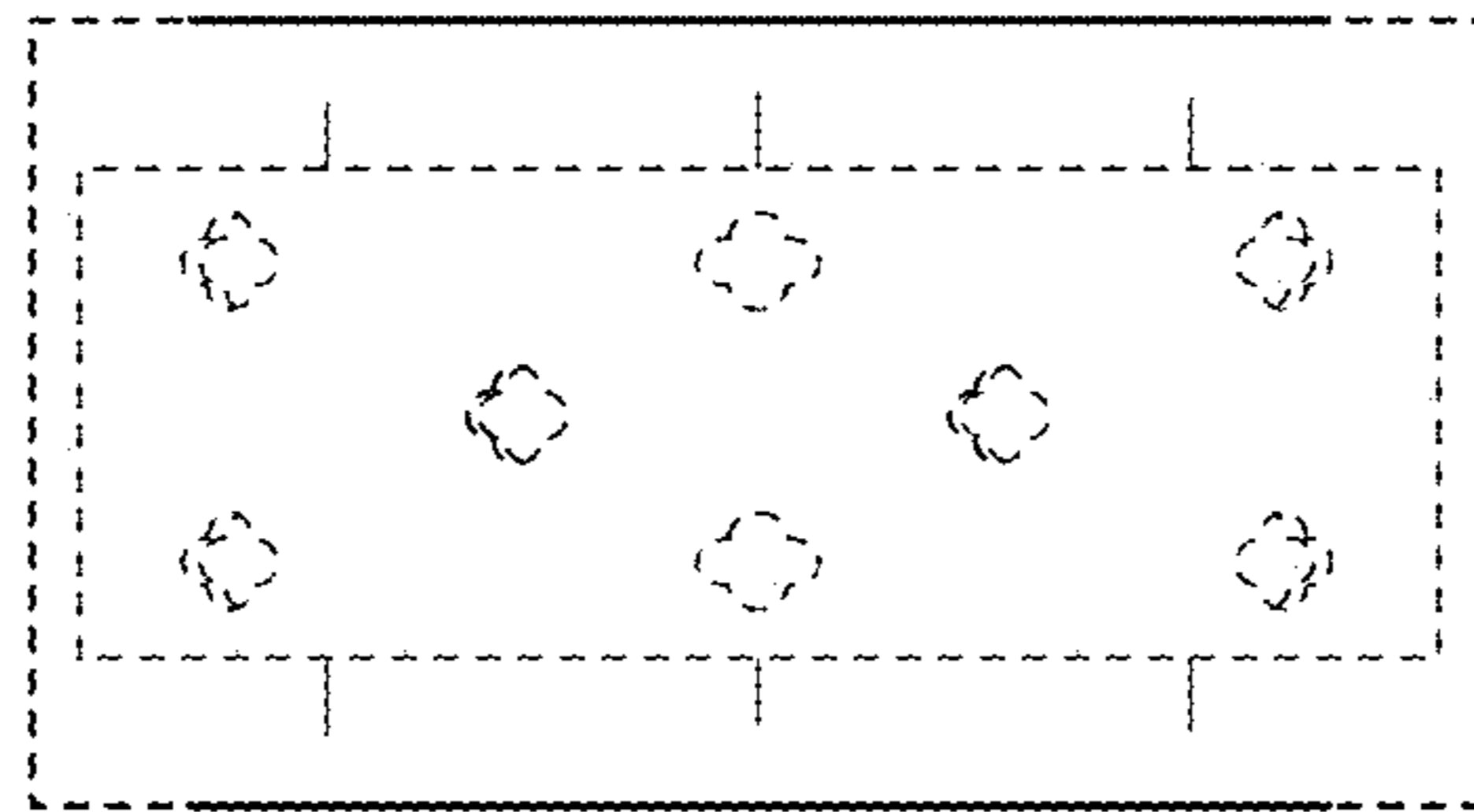

FIG. 4

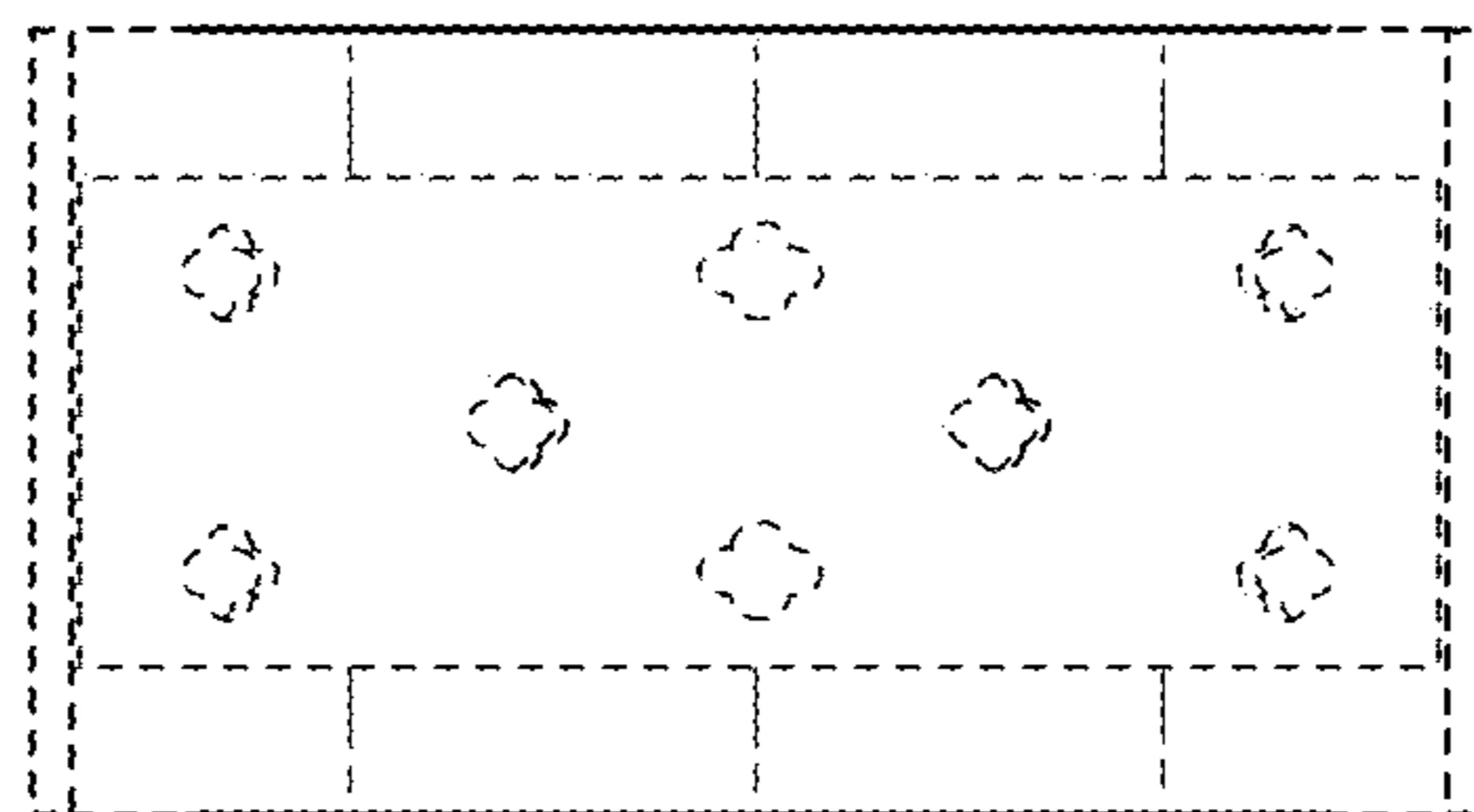

FIG. 5

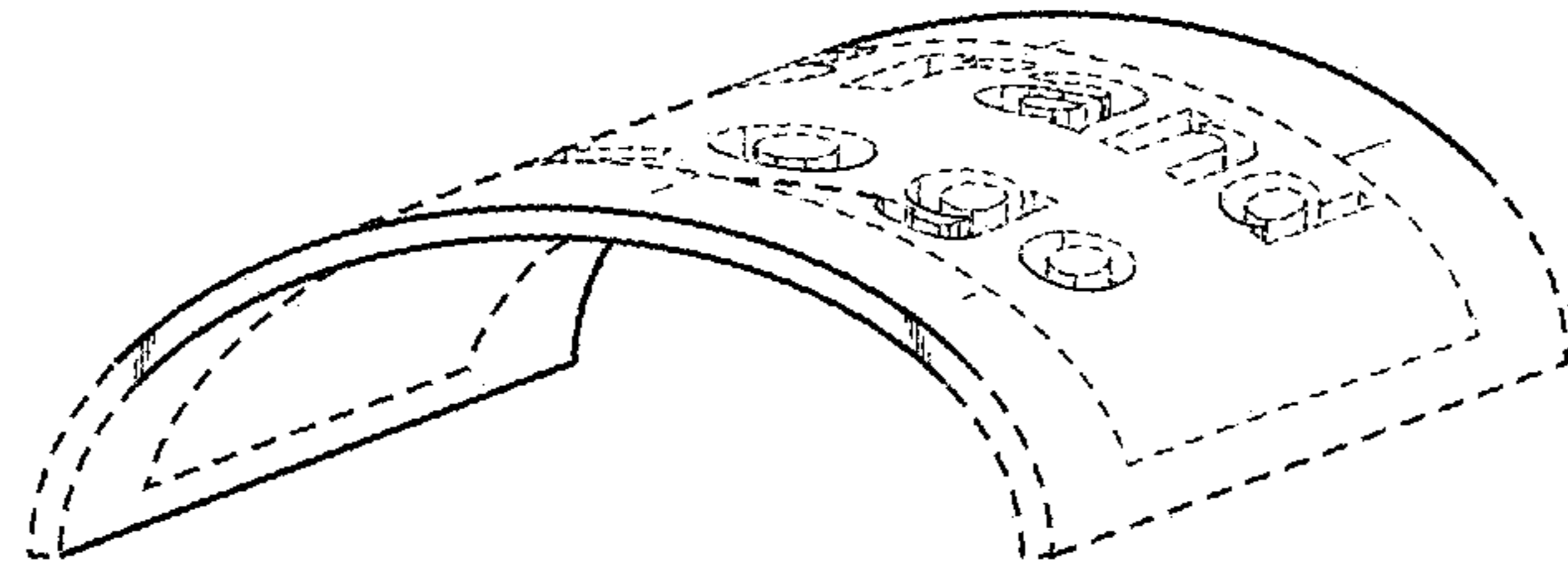

FIG. 6



FIG. 7

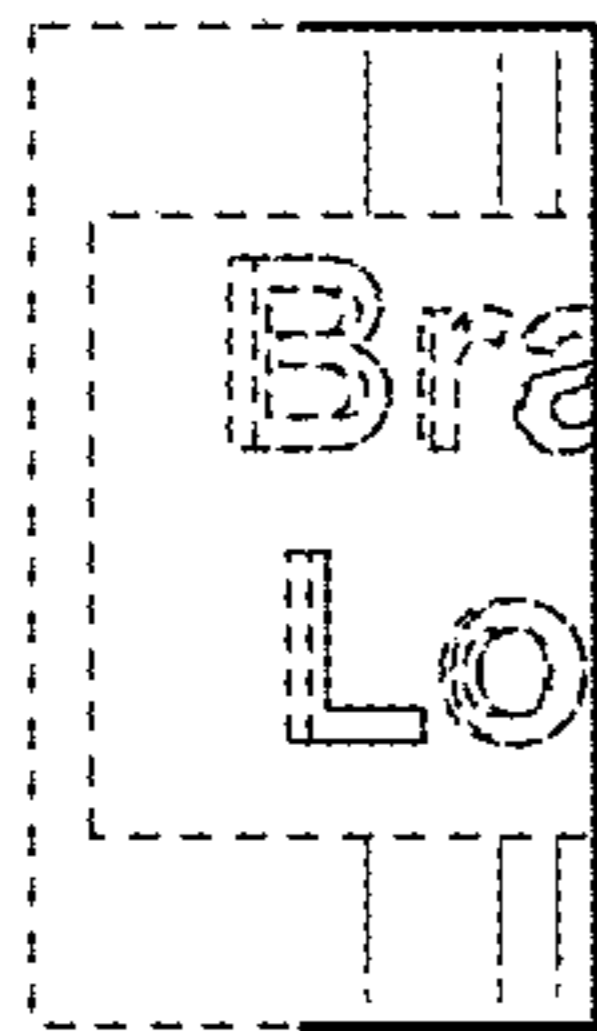

FIG. 8

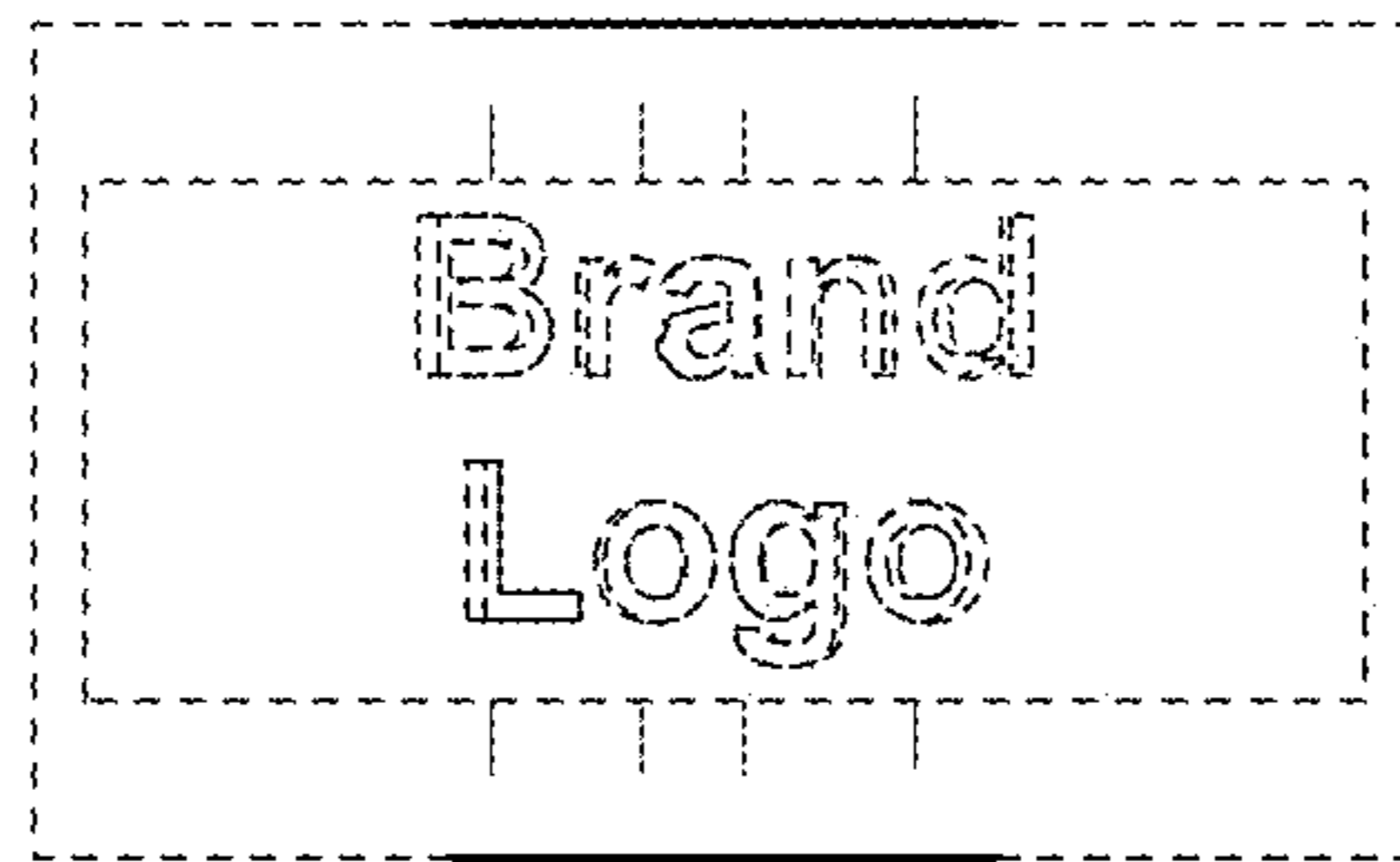

FIG. 9

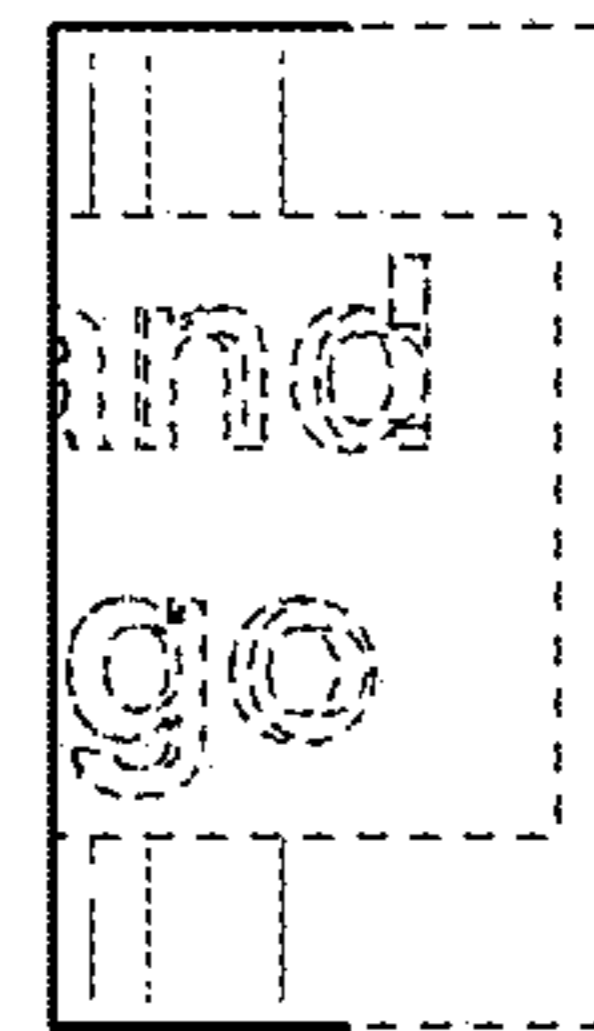

FIG. 10

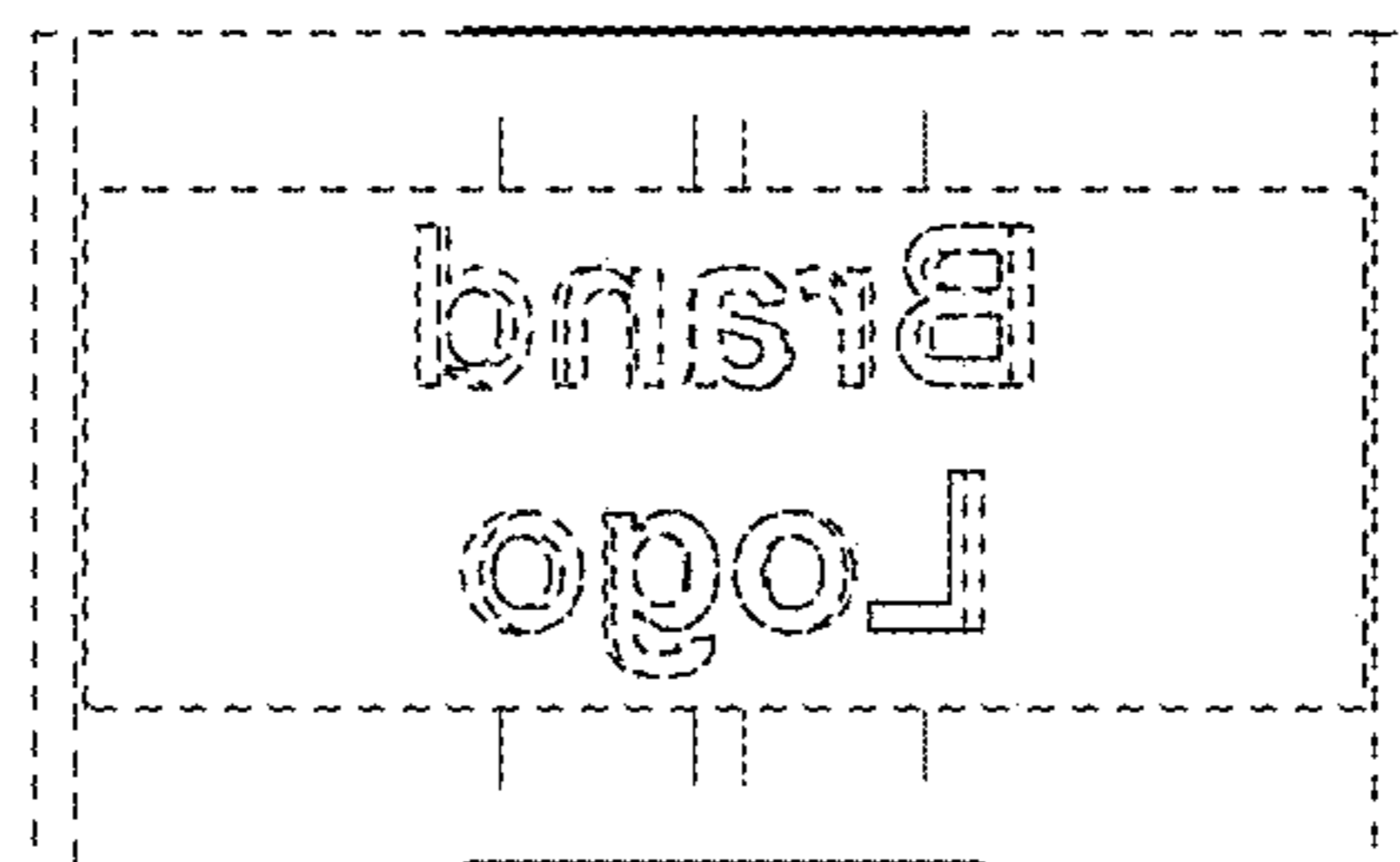

FIG. 11

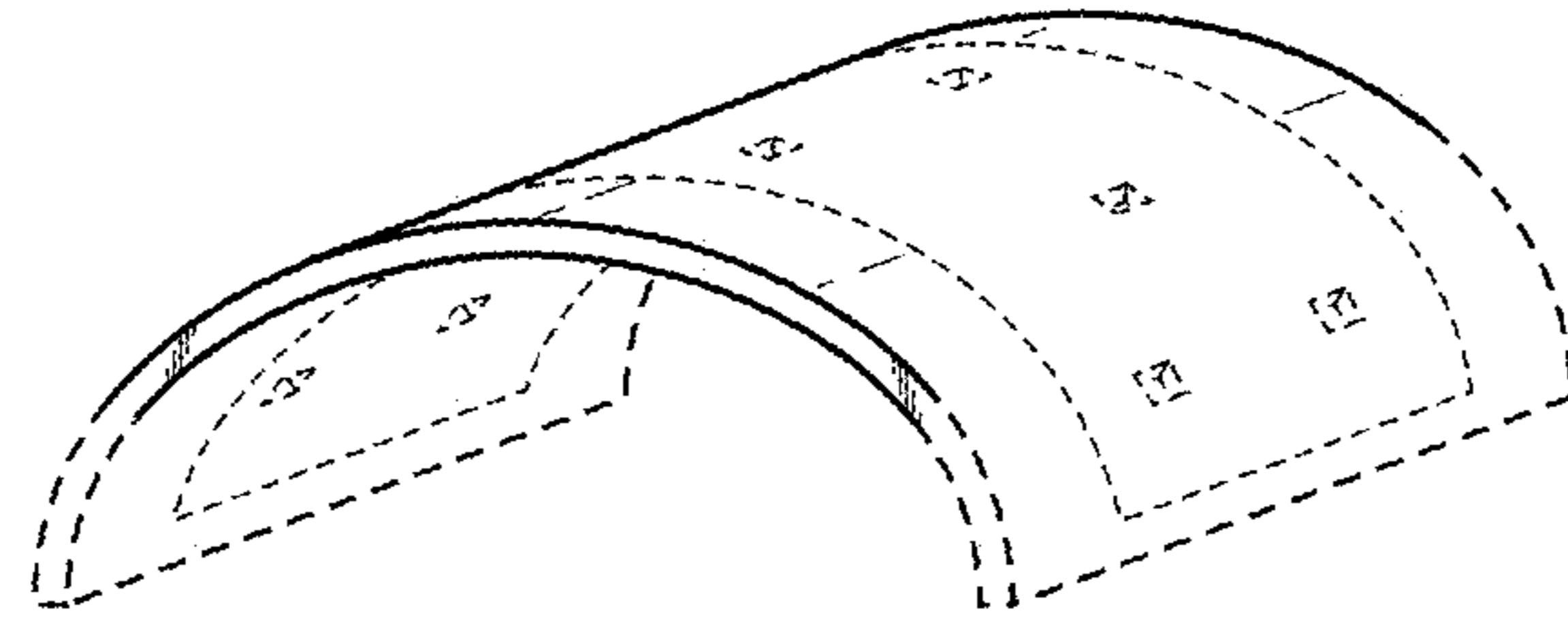

FIG. 12



FIG. 13

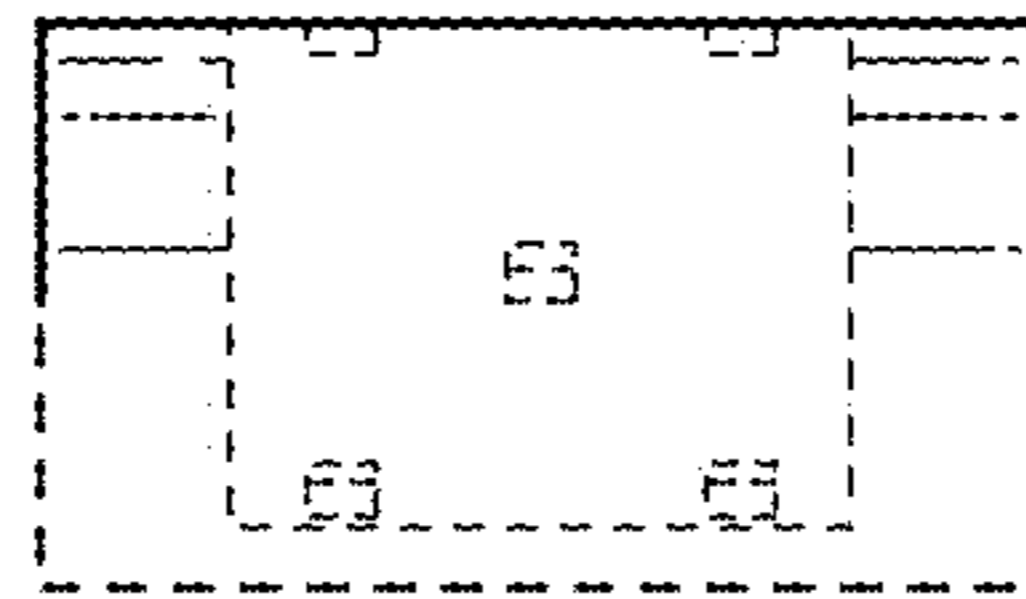

FIG. 14

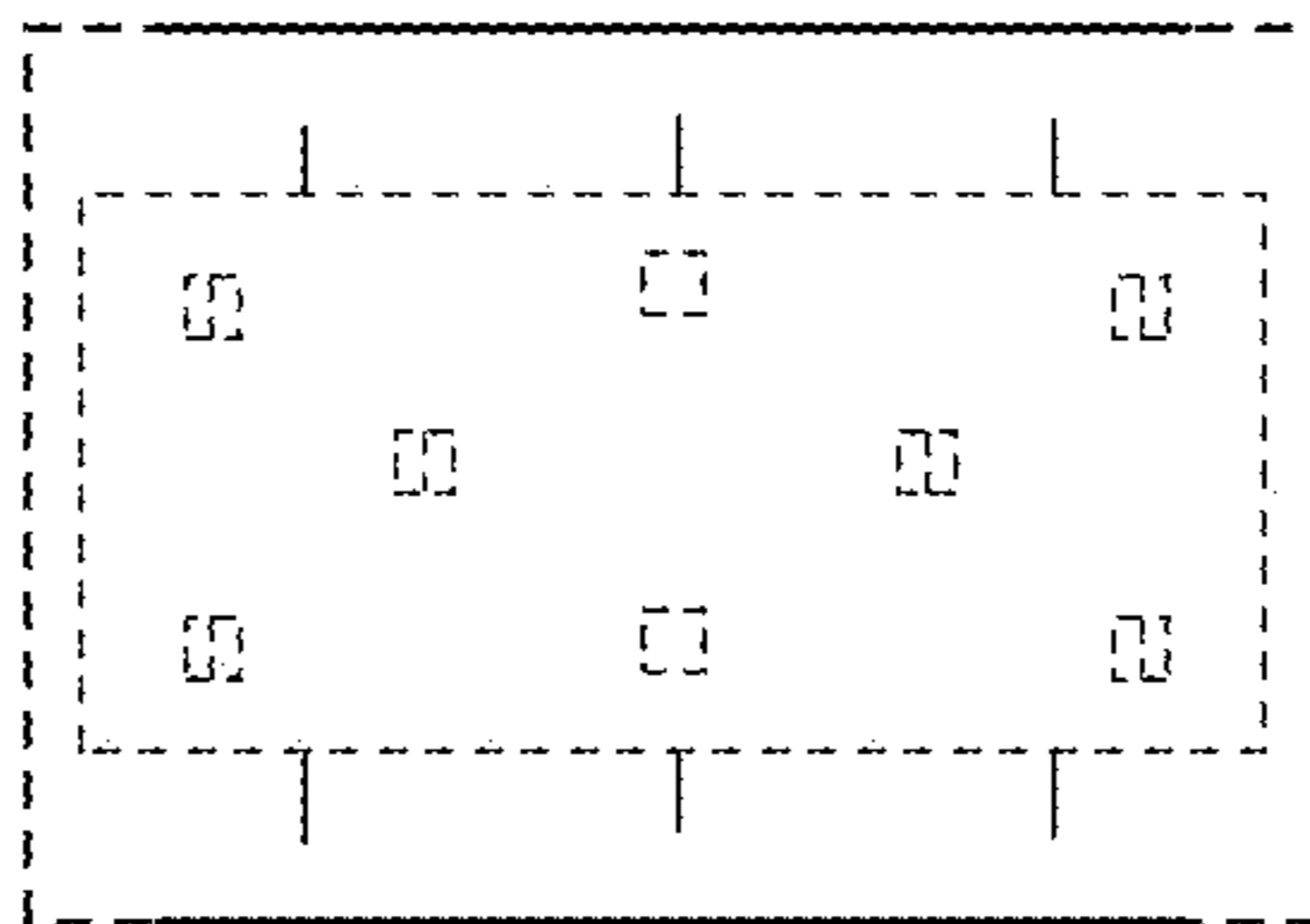

FIG. 15

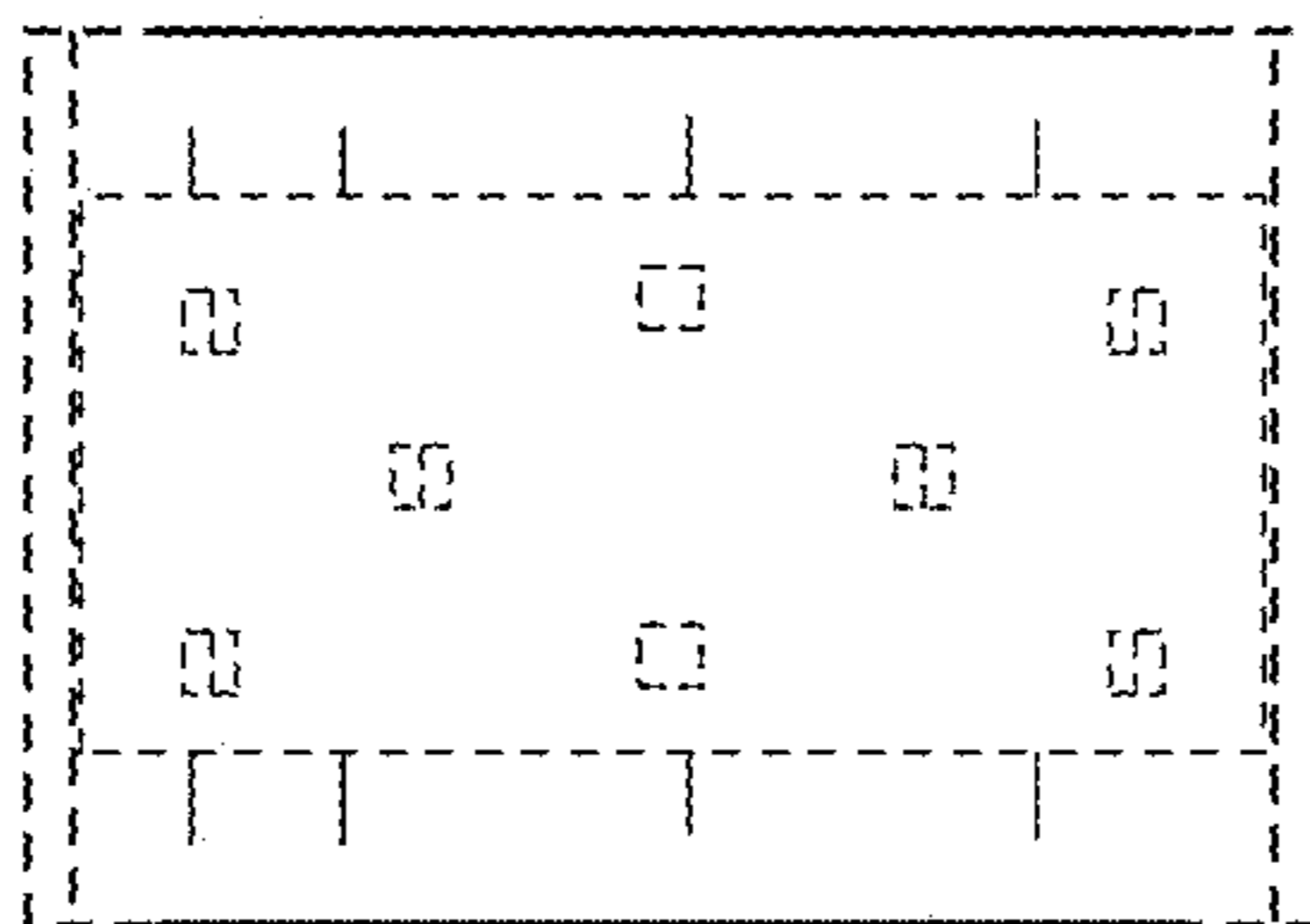

FIG. 16

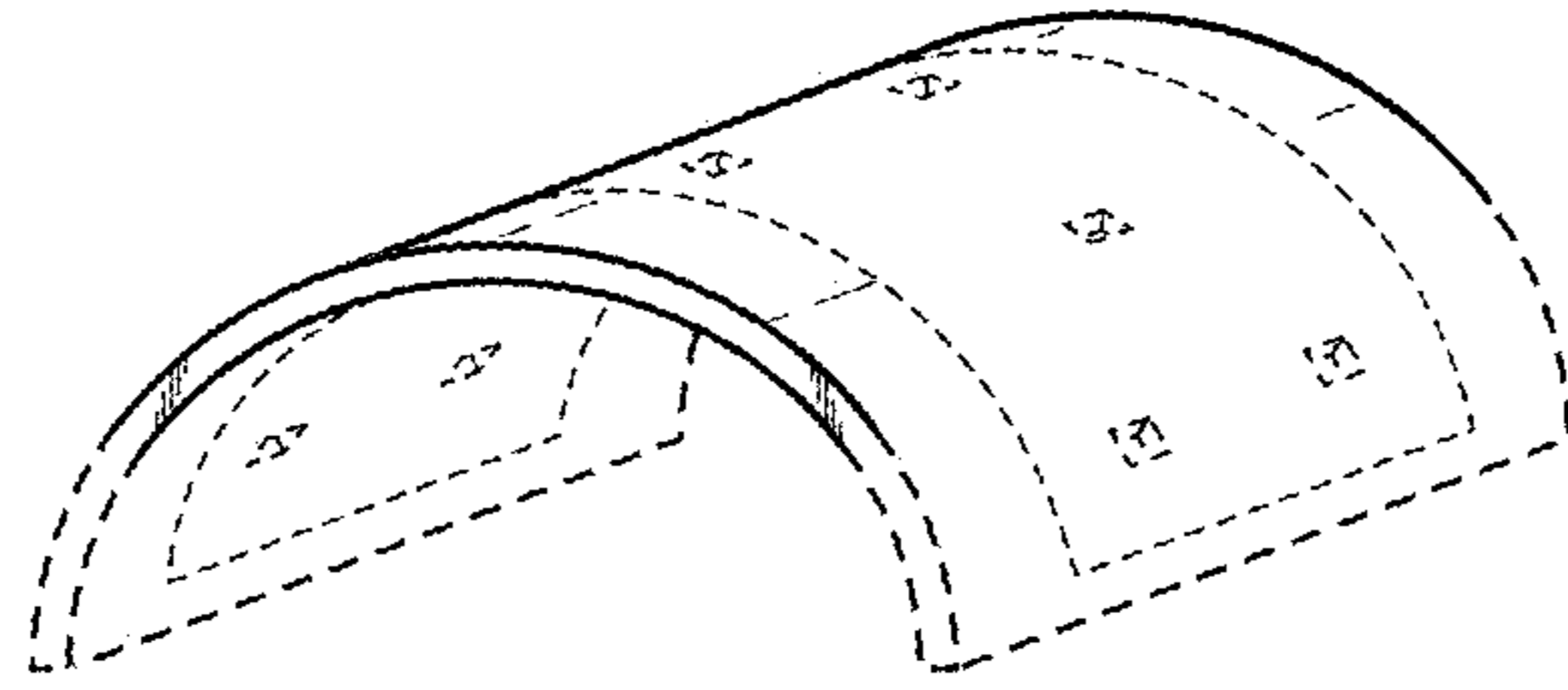

FIG. 17



FIG. 18

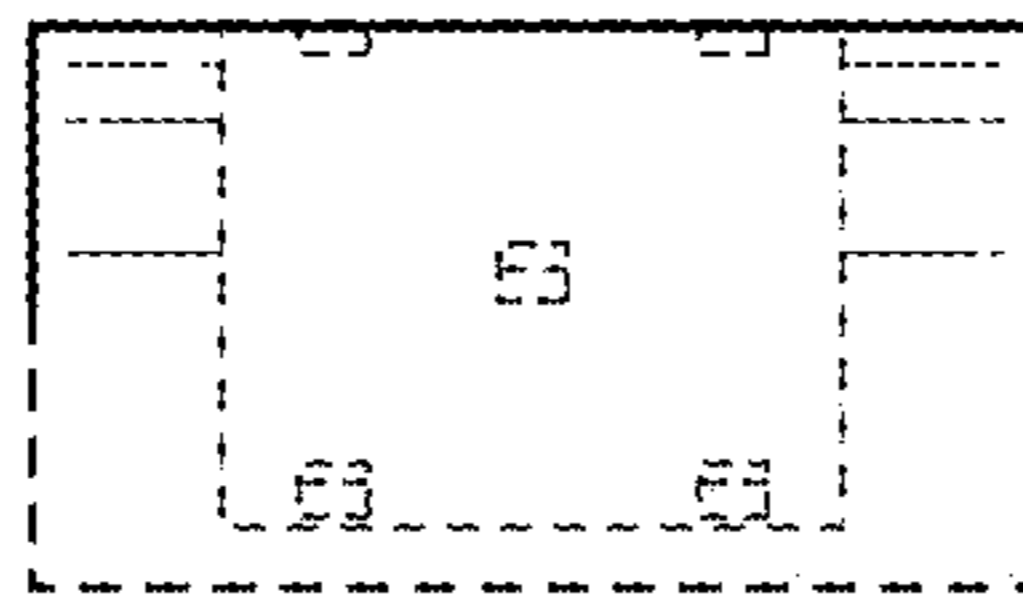

FIG. 19

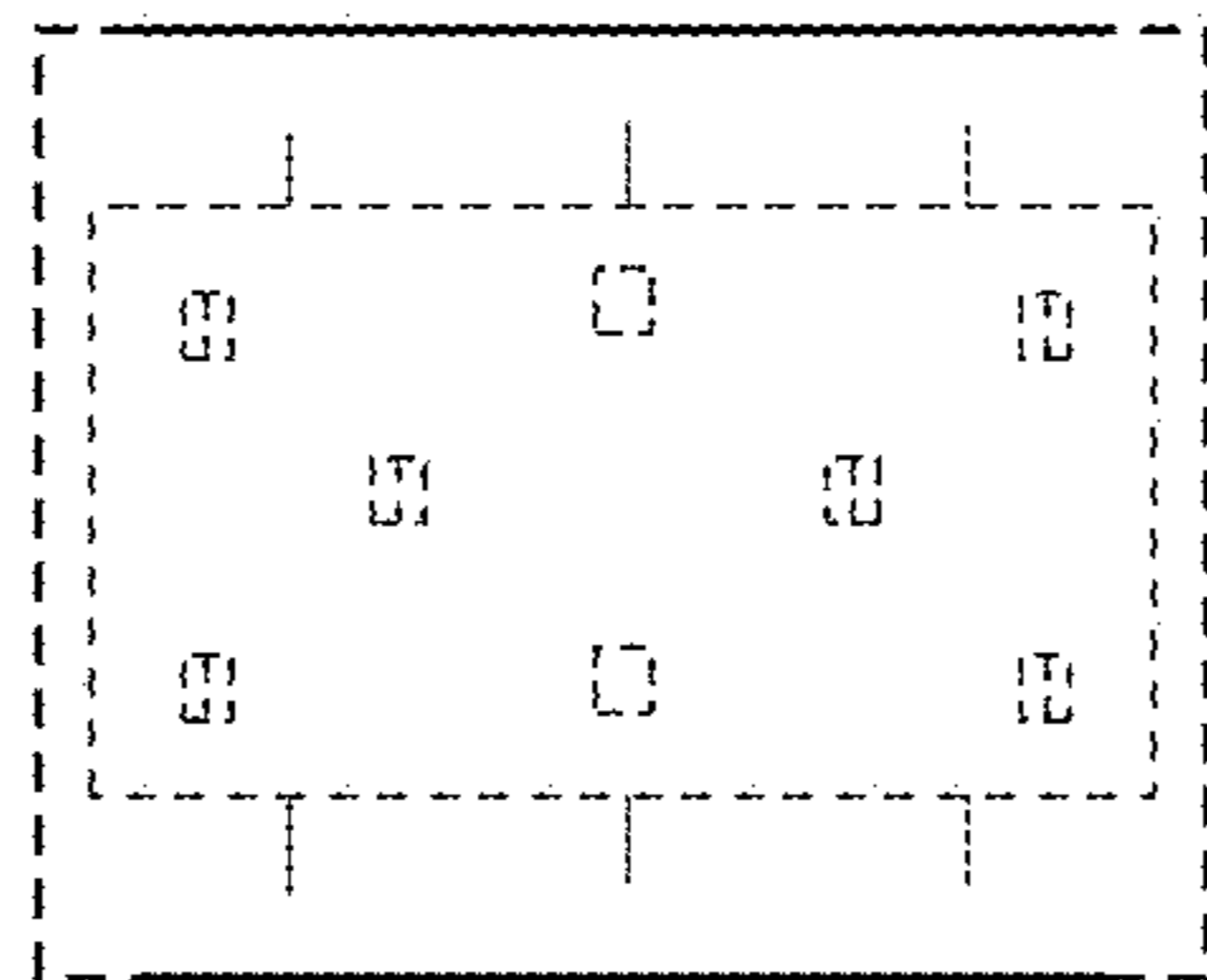

FIG. 20

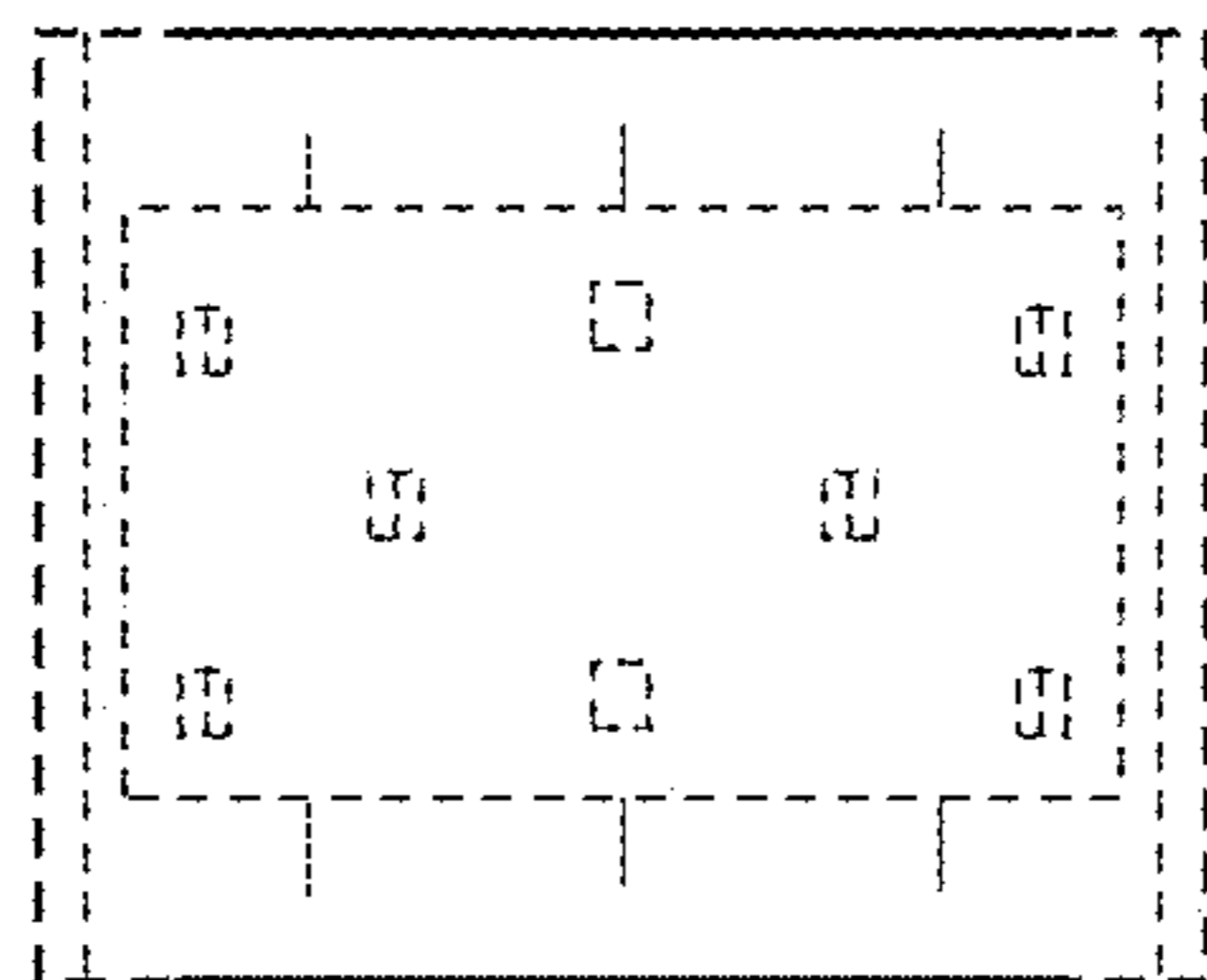

FIG. 21

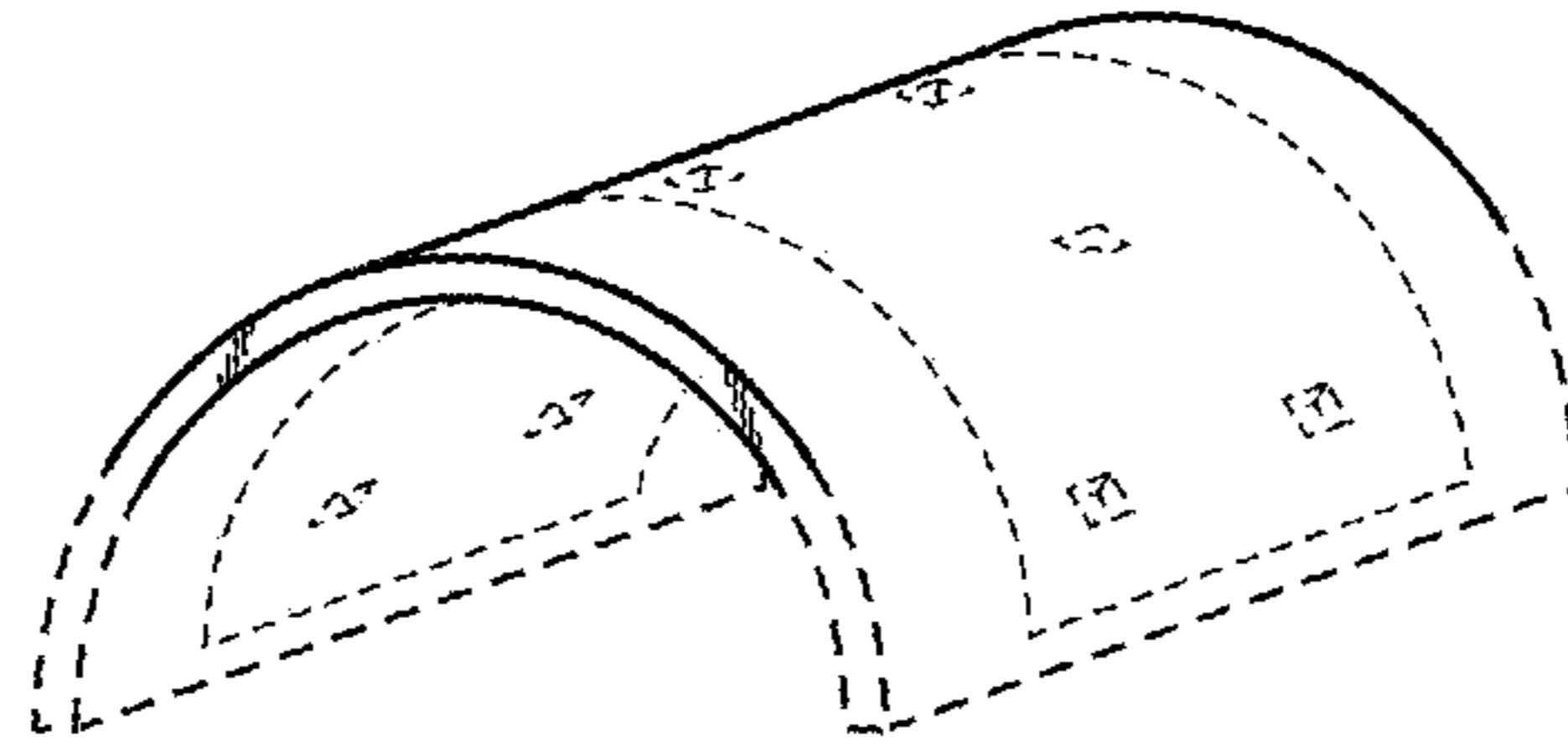

FIG. 22



FIG. 23

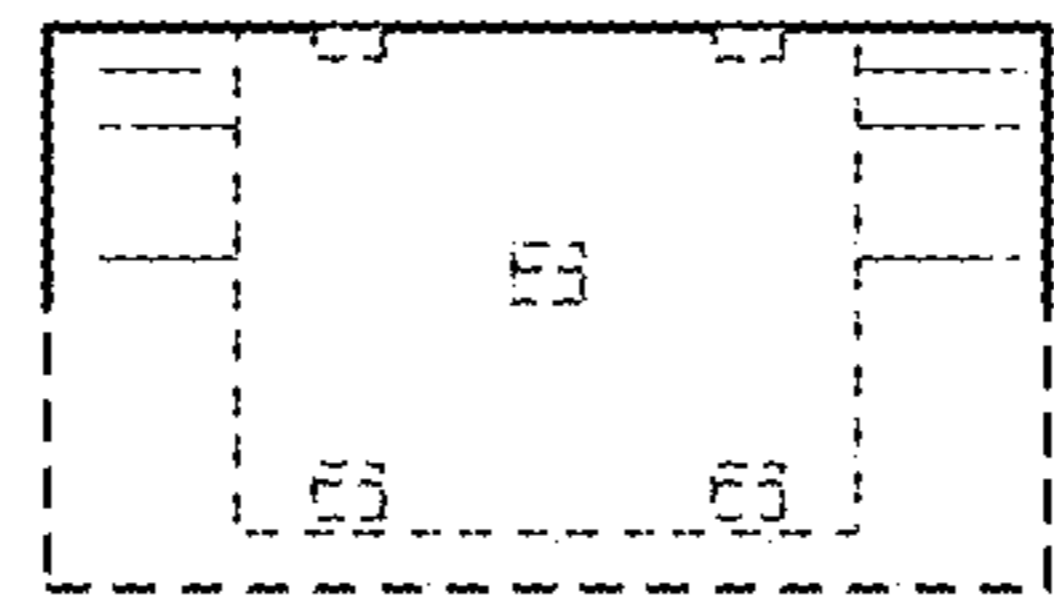

FIG. 24

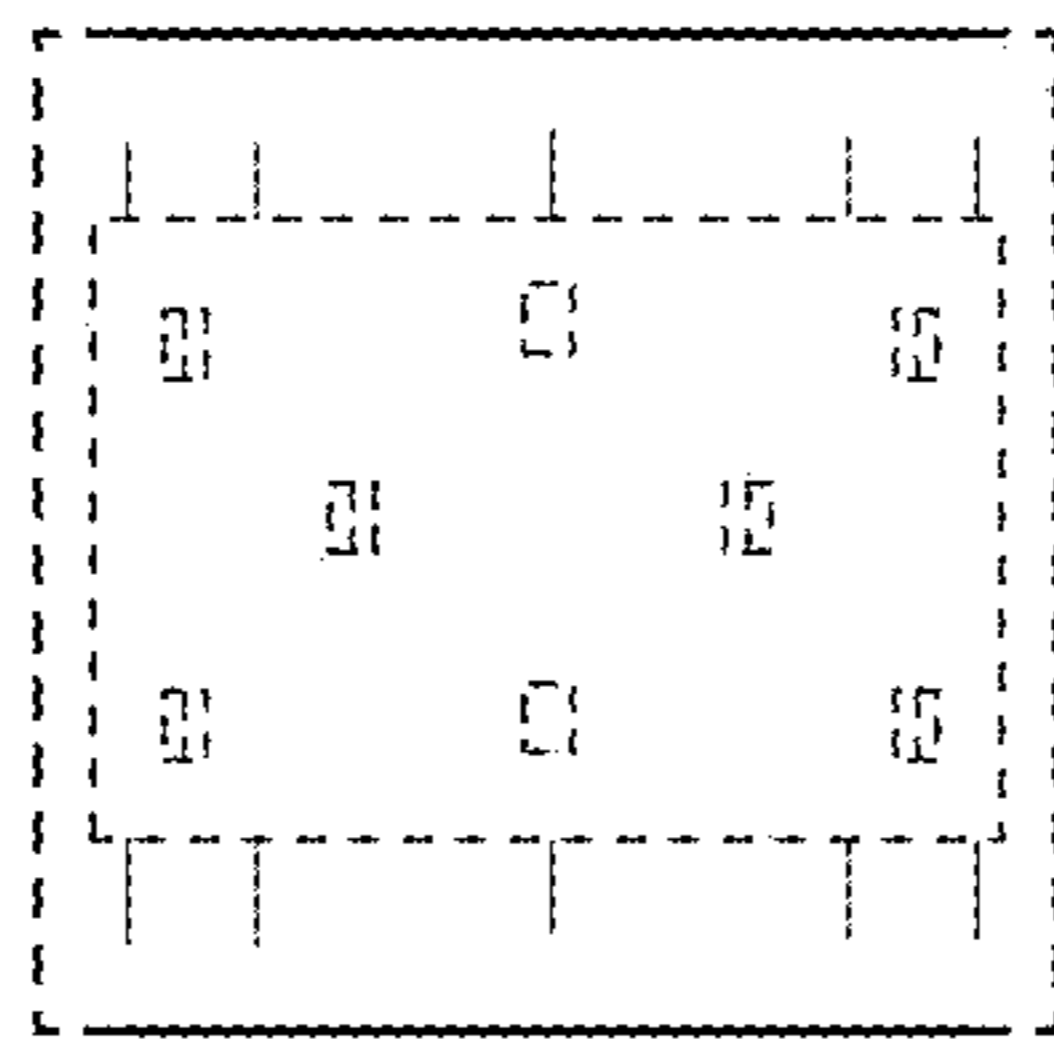

FIG. 25

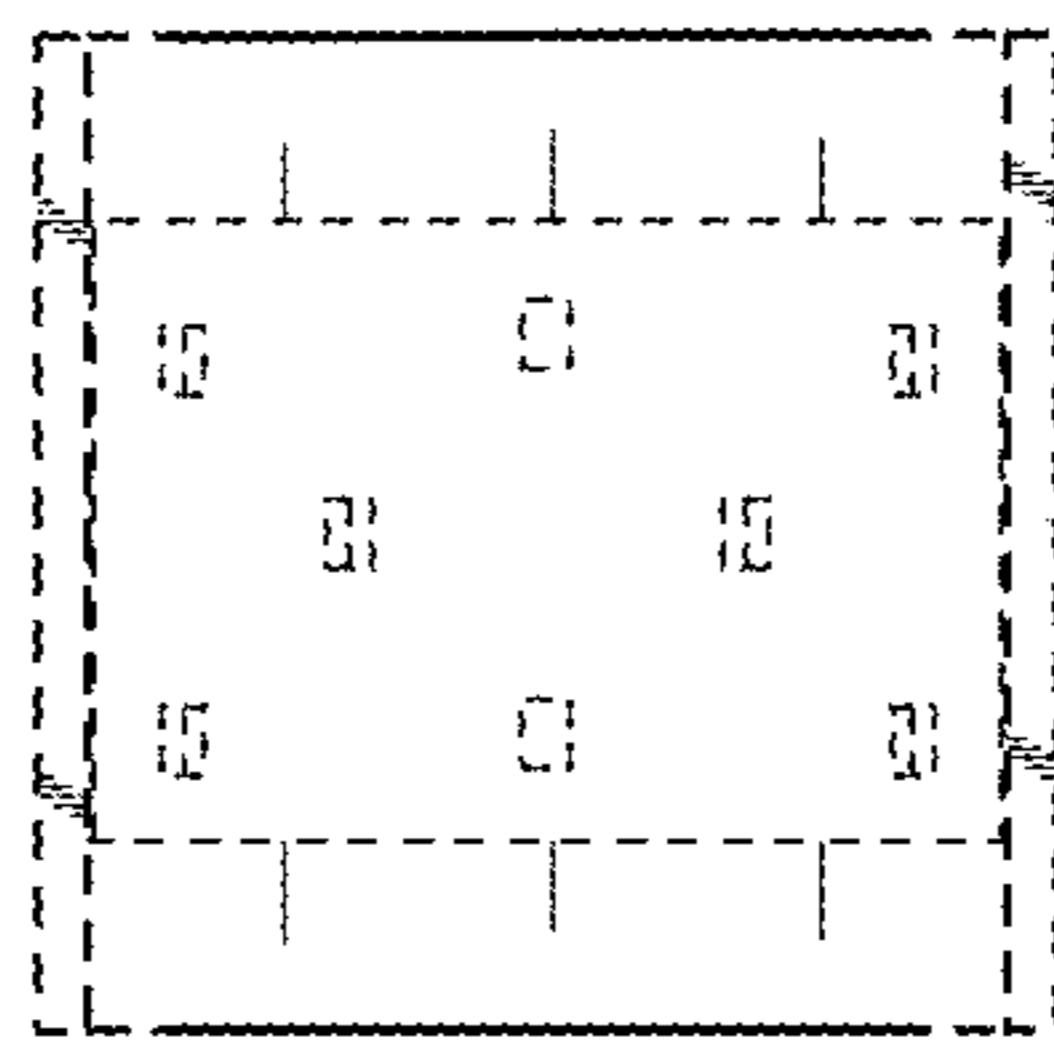

FIG. 26

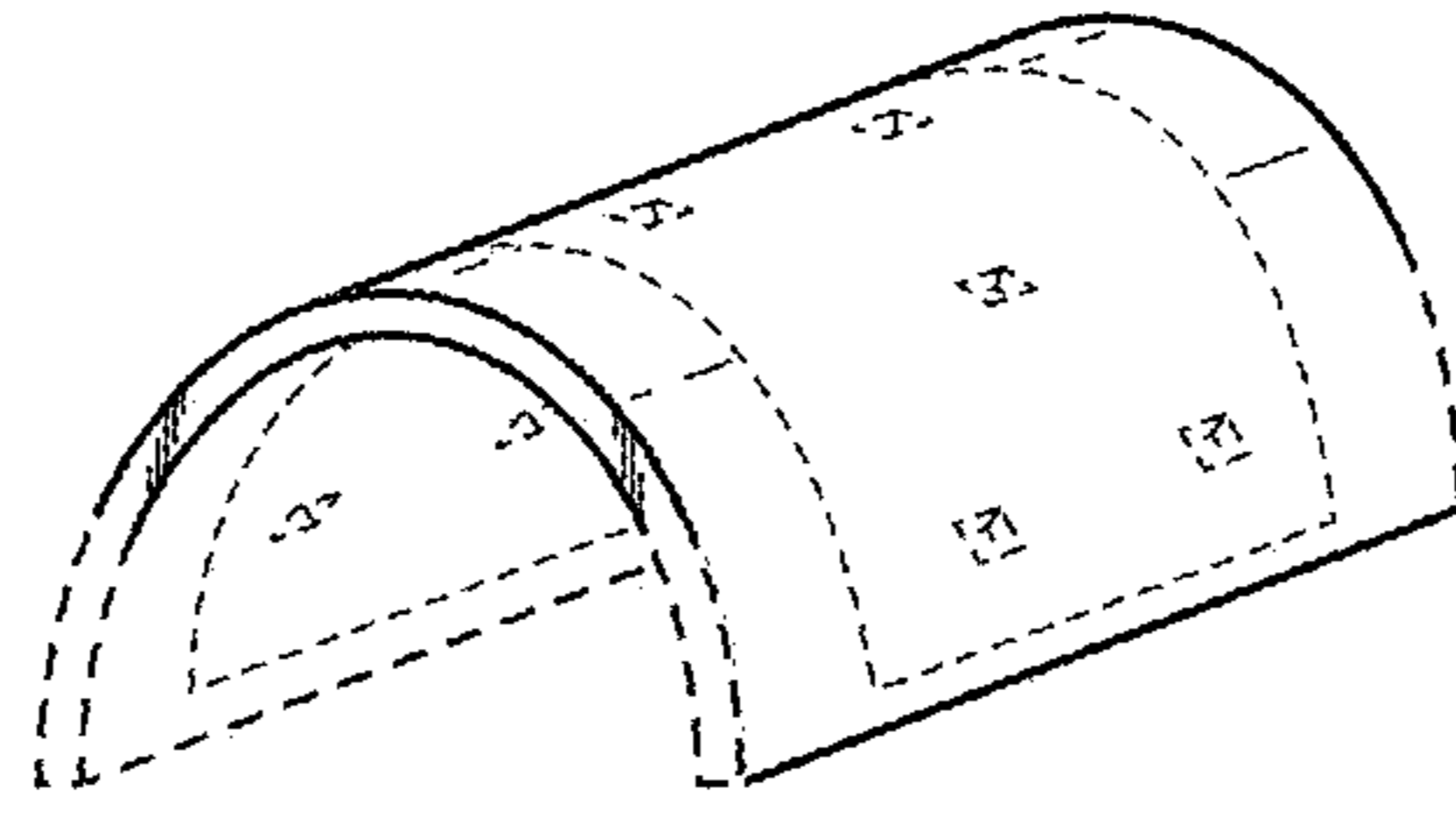

FIG. 27



FIG. 28

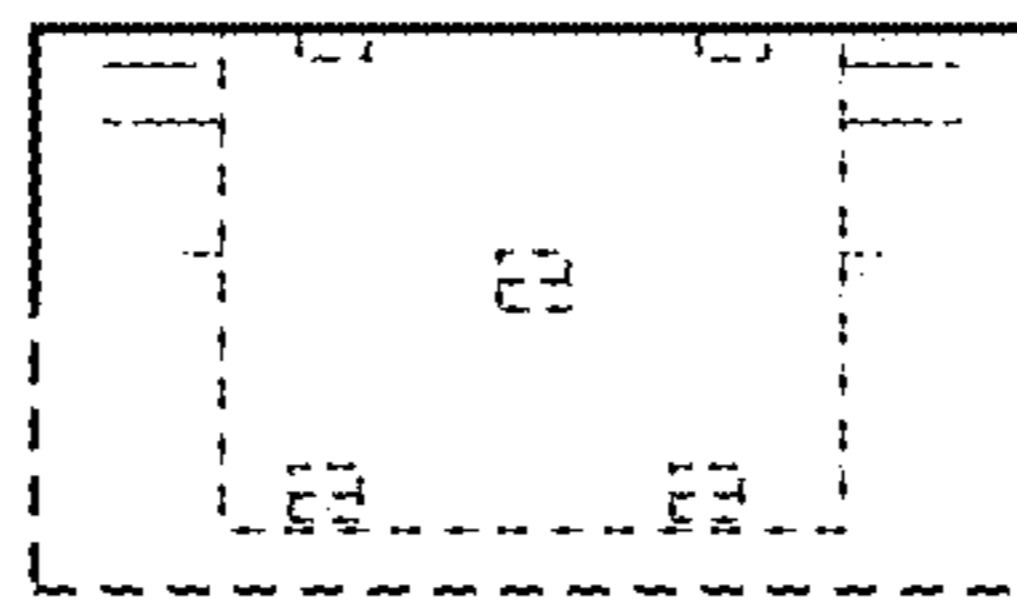

FIG. 29

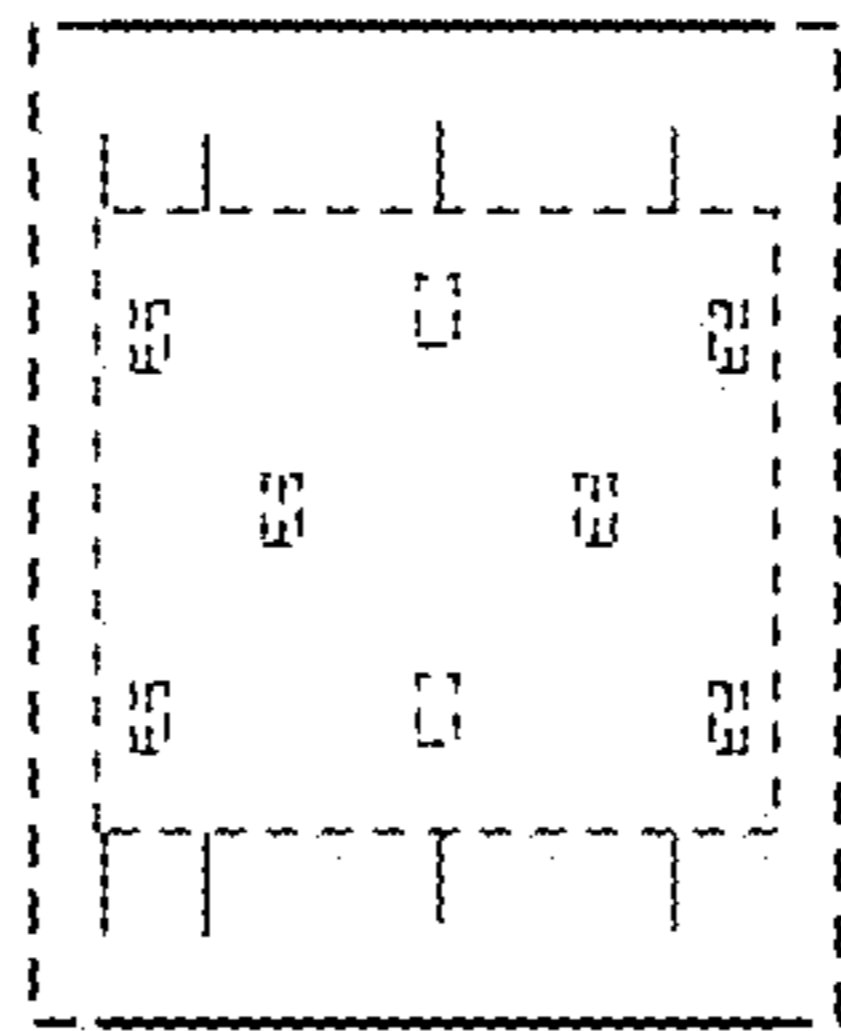

FIG. 30

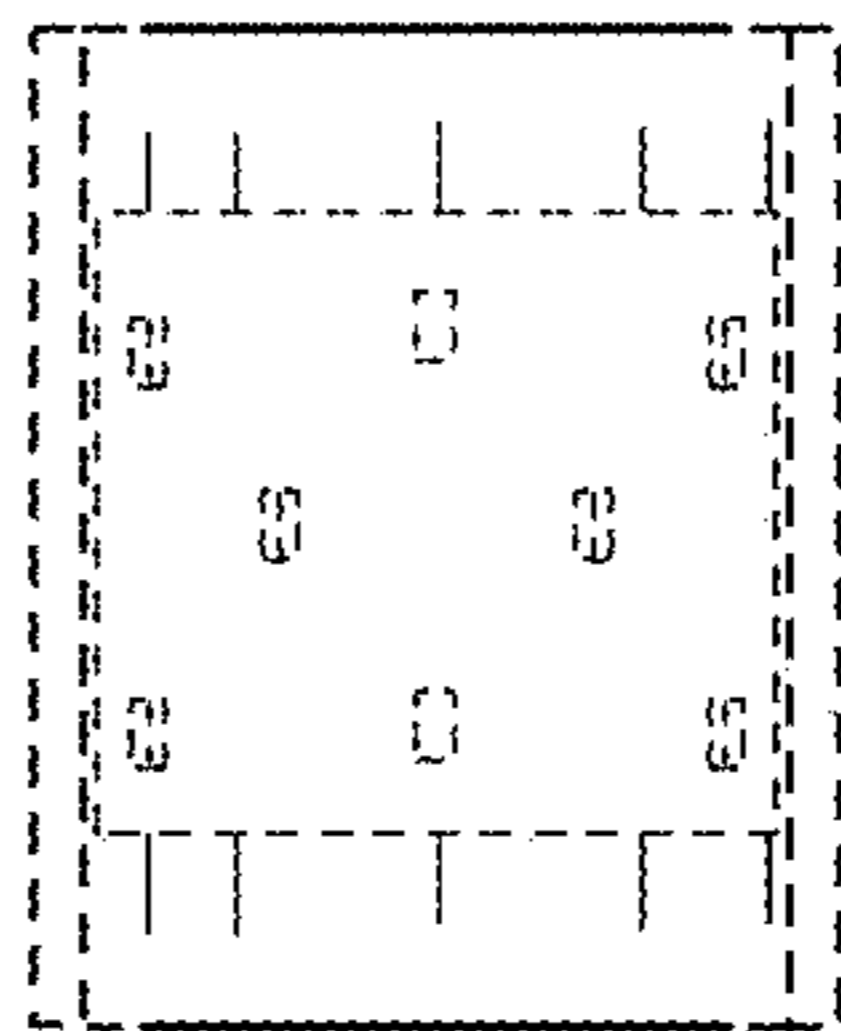

FIG. 31

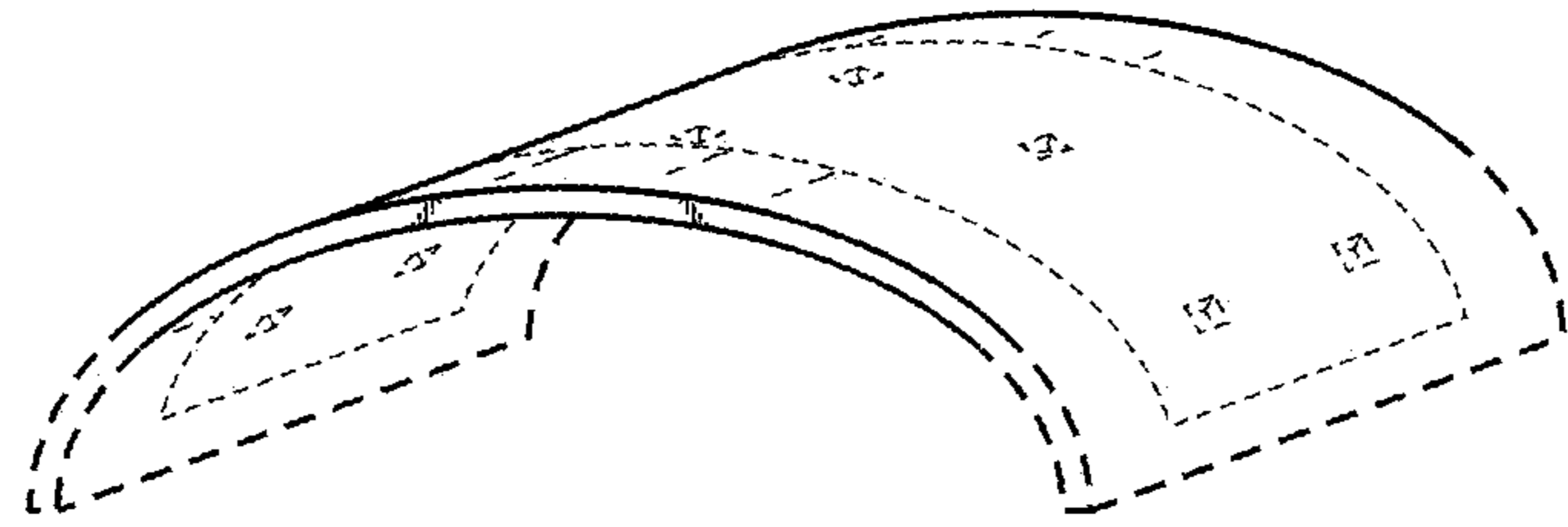

FIG. 32



FIG. 33

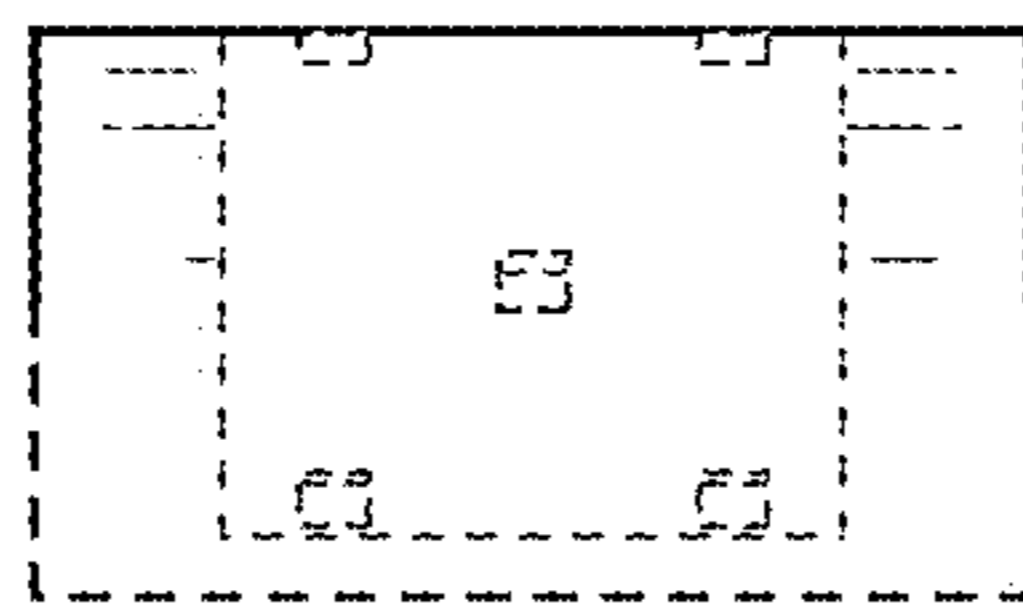

FIG. 34

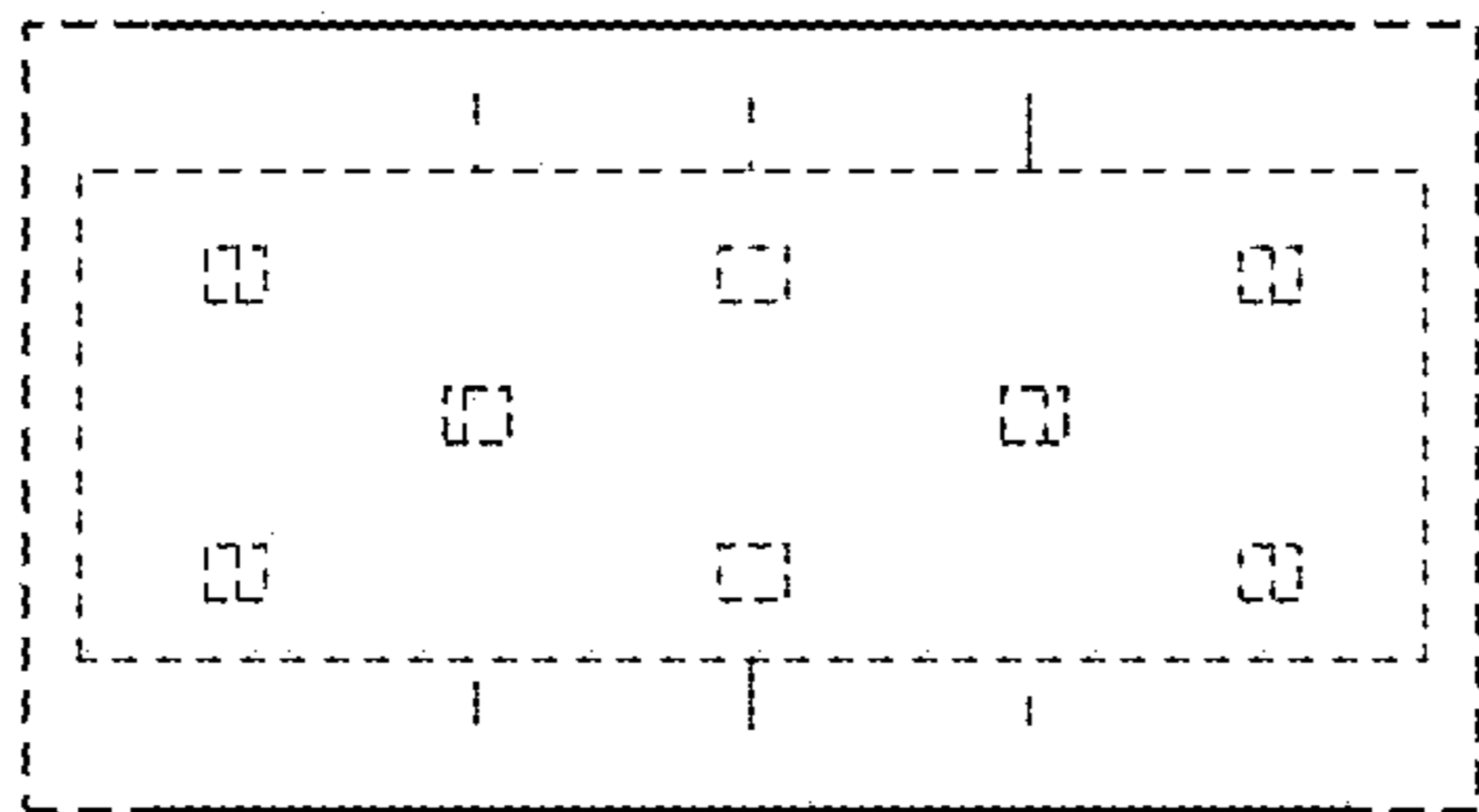

FIG. 35

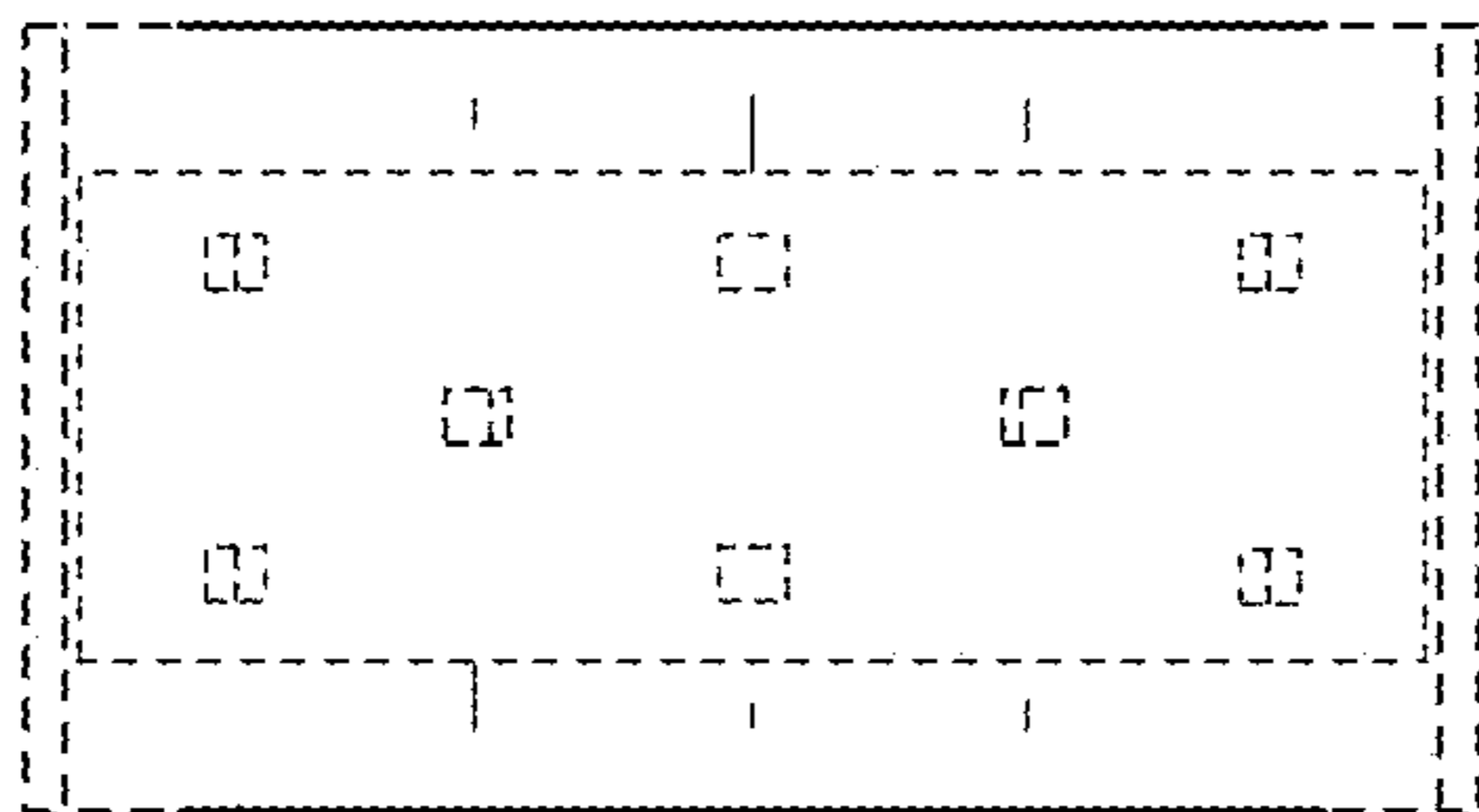

FIG. 36