



US00D911077S

(12) **United States Design Patent**
Kim et al.

(10) **Patent No.:** **US D911,077 S**

(45) **Date of Patent:** **** Feb. 23, 2021**

(54) **KITCHEN ISLAND WITH WINE COOLER**

(71) Applicant: **LG ELECTRONICS INC.**, Seoul (KR)

(72) Inventors: **Hyungki Kim**, Seoul (KR); **Wonsang Choi**, Seoul (KR); **Kyukwan Choi**, Seoul (KR); **Hyun Choi**, Seoul (KR)

(73) Assignee: **LG ELECTRONICS INC.**, Seoul (KR)

(**) Term: **15 Years**

(21) Appl. No.: **35/508,077**

(22) Filed: **Apr. 3, 2019**

(80) **Hague Agreement Data**

Int. Filing Date: **Apr. 3, 2019**

Int. Reg. No.: **DM/204556**

Int. Reg. Date: **Apr. 3, 2019**

Int. Reg. Pub. Date: **Dec. 13, 2019**

(51) **LOC (13) Cl.** **06-04**

(52) **U.S. Cl.**

USPC **D6/660**; D15/79

CPC **A47B 77/04** (2013.01)

(58) **Field of Classification Search**

USPC D6/657, 660, 661, 662, 662.1, 663, 664, D6/664.1, 671, 671.1, 671.2, 702, 703, D6/705; D15/79-91

CPC . A47F 3/00; A47F 3/005; A47F 3/063; A47B 17/04; A47B 47/00; A47B 47/04; A47B 67/00; A47B 67/04; A47B 88/00; A47B 88/40; A47B 69/00; A47B 73/00; A47B 77/00; A47B 81/007; A47B 77/04

See application file for complete search history.

(56) **References Cited**

U.S. PATENT DOCUMENTS

4,700,849 A * 10/1987 Wagner A47B 73/00
211/113
D787,246 S * 5/2017 Price D6/699.2

D787,247 S * 5/2017 Price D6/699.2
D793,772 S * 8/2017 Nicoll D6/666
D801,728 S * 11/2017 Reyes D6/660
D803,602 S * 11/2017 Hightower D6/663
D814,215 S * 4/2018 Yan D6/660
D837,539 S * 1/2019 Nicoll D6/336
D837,540 S * 1/2019 Nicoll D6/336

(Continued)

Primary Examiner — Richard E Chilcot

(74) *Attorney, Agent, or Firm* — Birch, Stewart, Kolasch & Birch, LLP

(57) **CLAIM**

The ornamental design for kitchen island with wine cooler, as shown and described.

DESCRIPTION

1. Kitchen island with wine cooler

1.1 : Perspective

1.2 : Front

1.3 : Back

1.4 : Left

1.5 : Right

1.6 : Top

1.7 : Bottom

1.8 : Reference

1.9 : Perspective

1.10 : Front

1.11 : Back

1.12 : Left

1.13 : Right

1.14 : Top

1.15 : Bottom

1.16 : Perspective

1.17 : Front

1.18 : Back

1.19 : Left

1.20 : Right

1.21 : Top

1.22 : Bottom

(Continued)

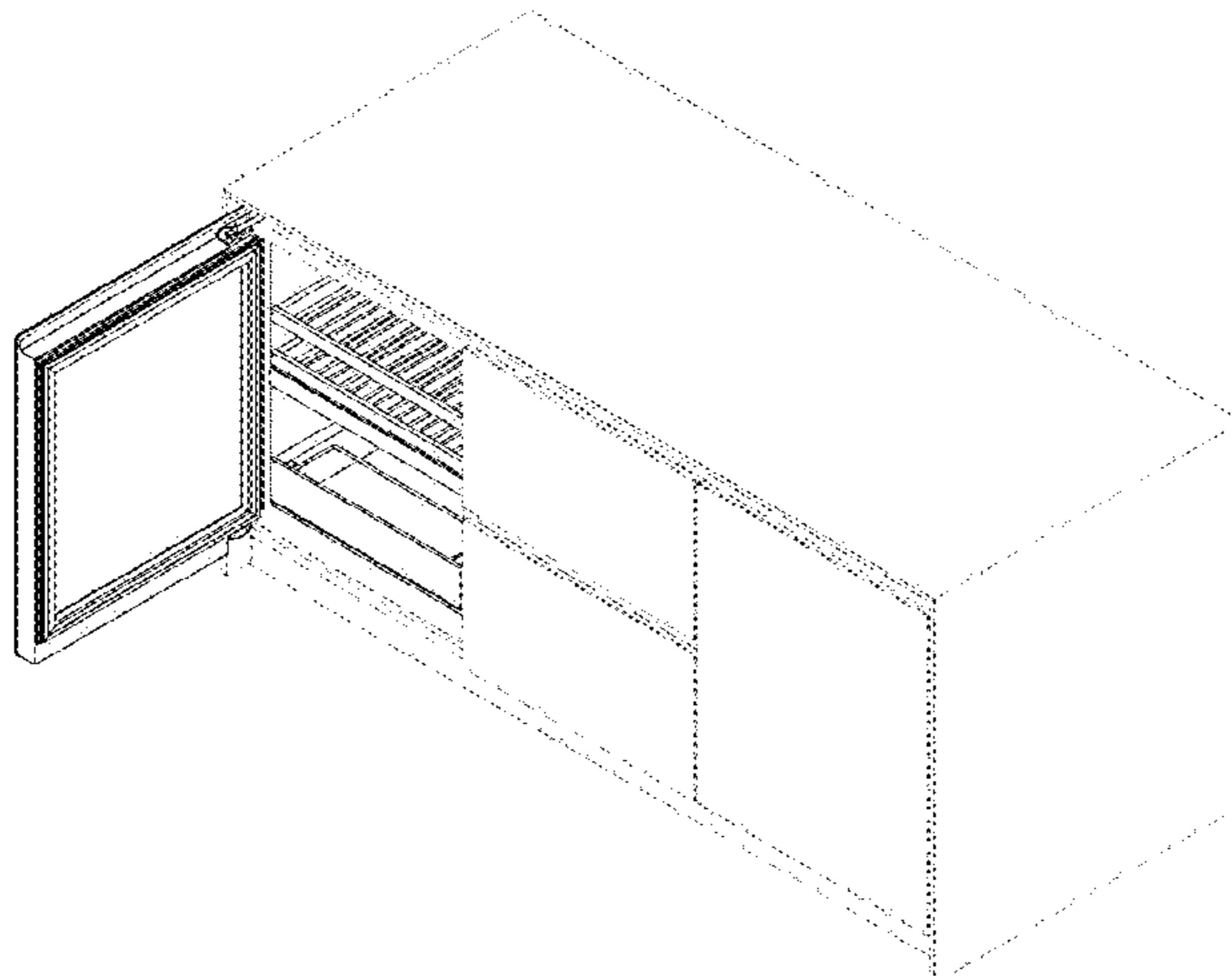

The broken lines indicate portions of the article that form no part of the claimed design.

1 Claim, 22 Drawing Sheets

(56)

References Cited

U.S. PATENT DOCUMENTS

D837,541	S	*	1/2019	Nicoll	D6/336
D837,542	S	*	1/2019	Nicoll	D6/336
D838,114	S	*	1/2019	Nicoll	D6/336
D838,504	S	*	1/2019	Nicoll	D6/336
D878,828	S	*	3/2020	Kasza	D6/675
2003/0227240	A1	*	12/2003	Khosropour	A47B 87/008 312/319.5
2004/0237955	A1	*	12/2004	Muldoon	A47J 37/0704 126/8
2009/0134751	A1	*	5/2009	Ingjaldsdottir	A47B 77/04 312/237
2015/0027350	A1	*	1/2015	Castillo	A47B 37/04 108/50.11
2018/0014636	A1	*	1/2018	Bertani	A47B 33/00

* cited by examiner

1.1

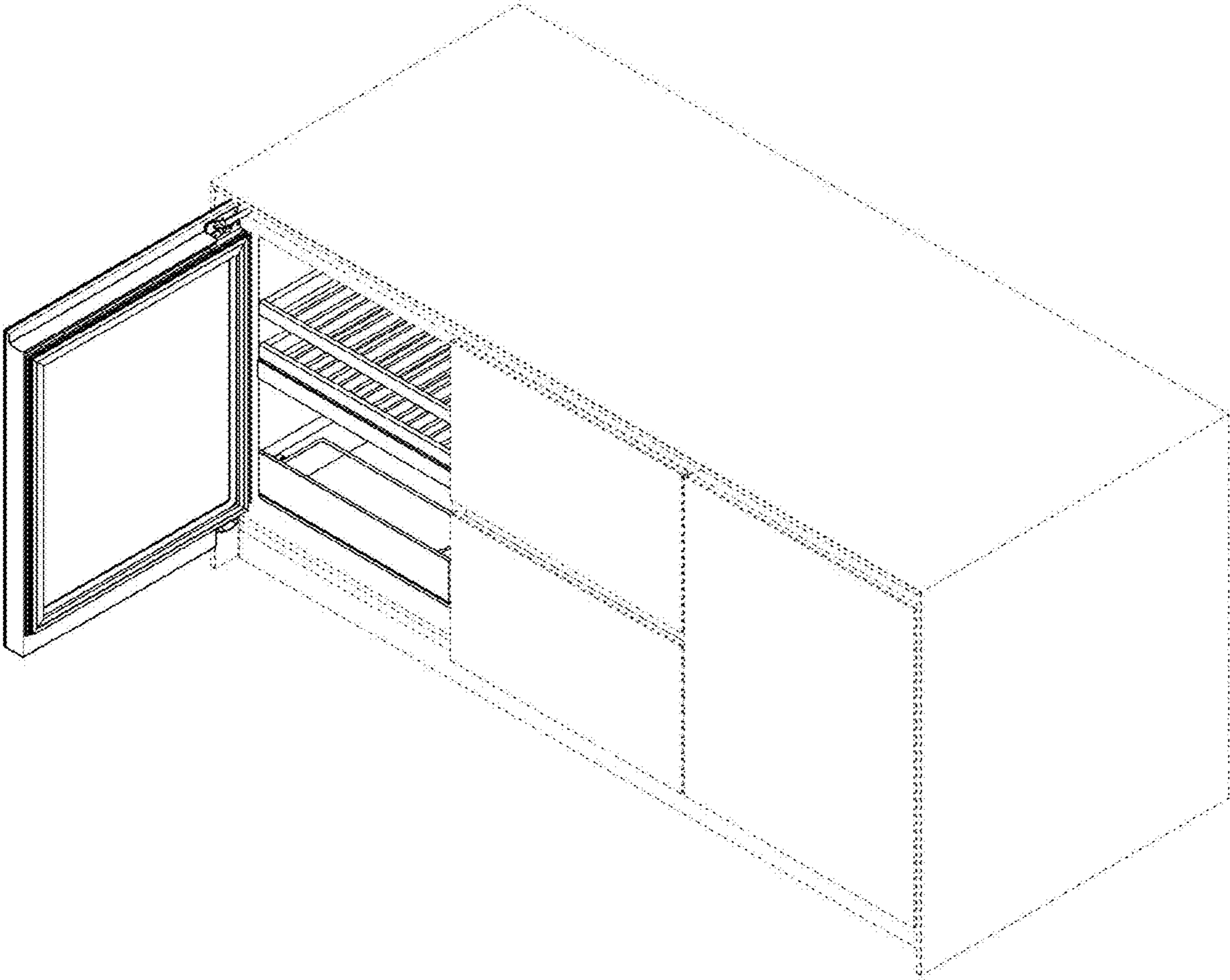

1.2

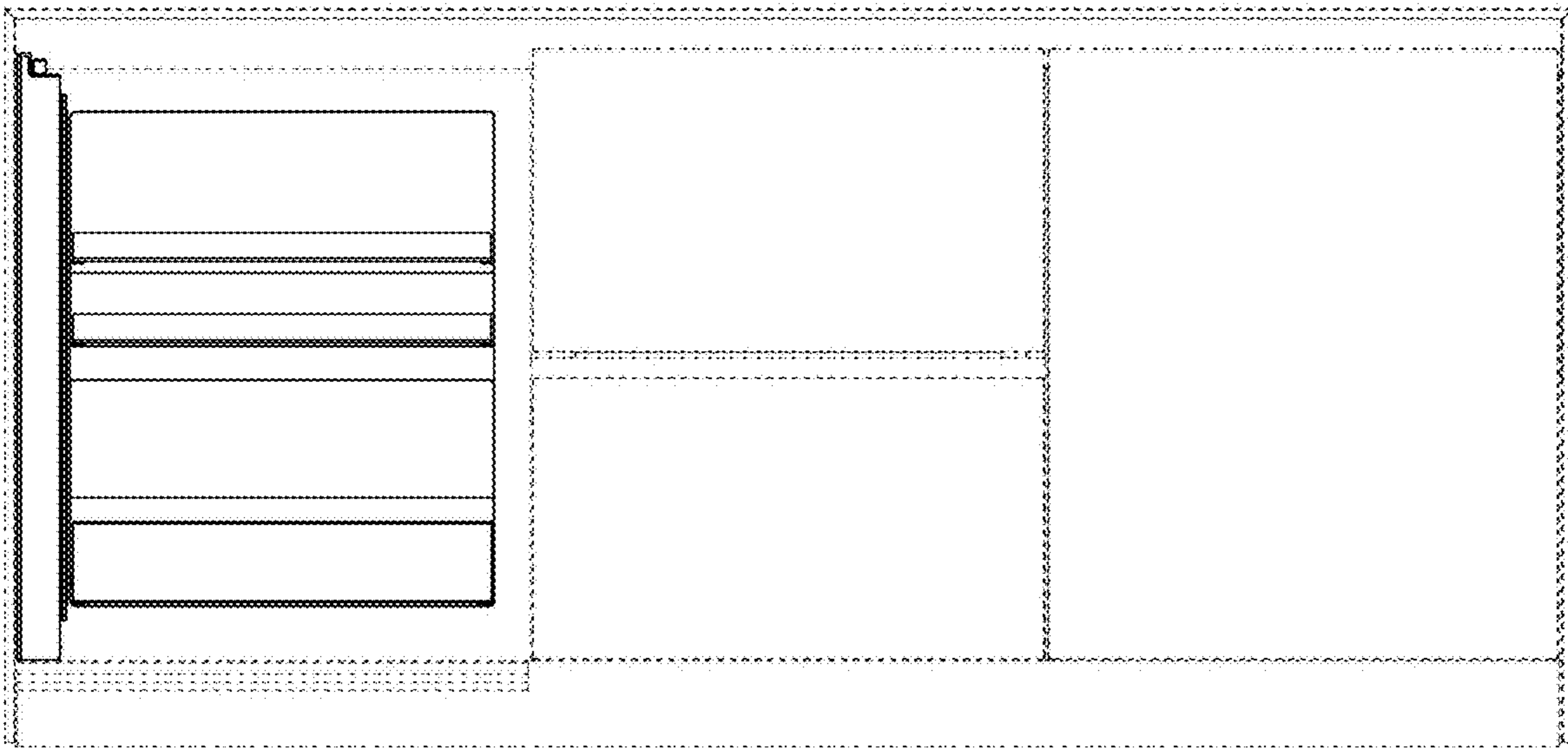

1.3

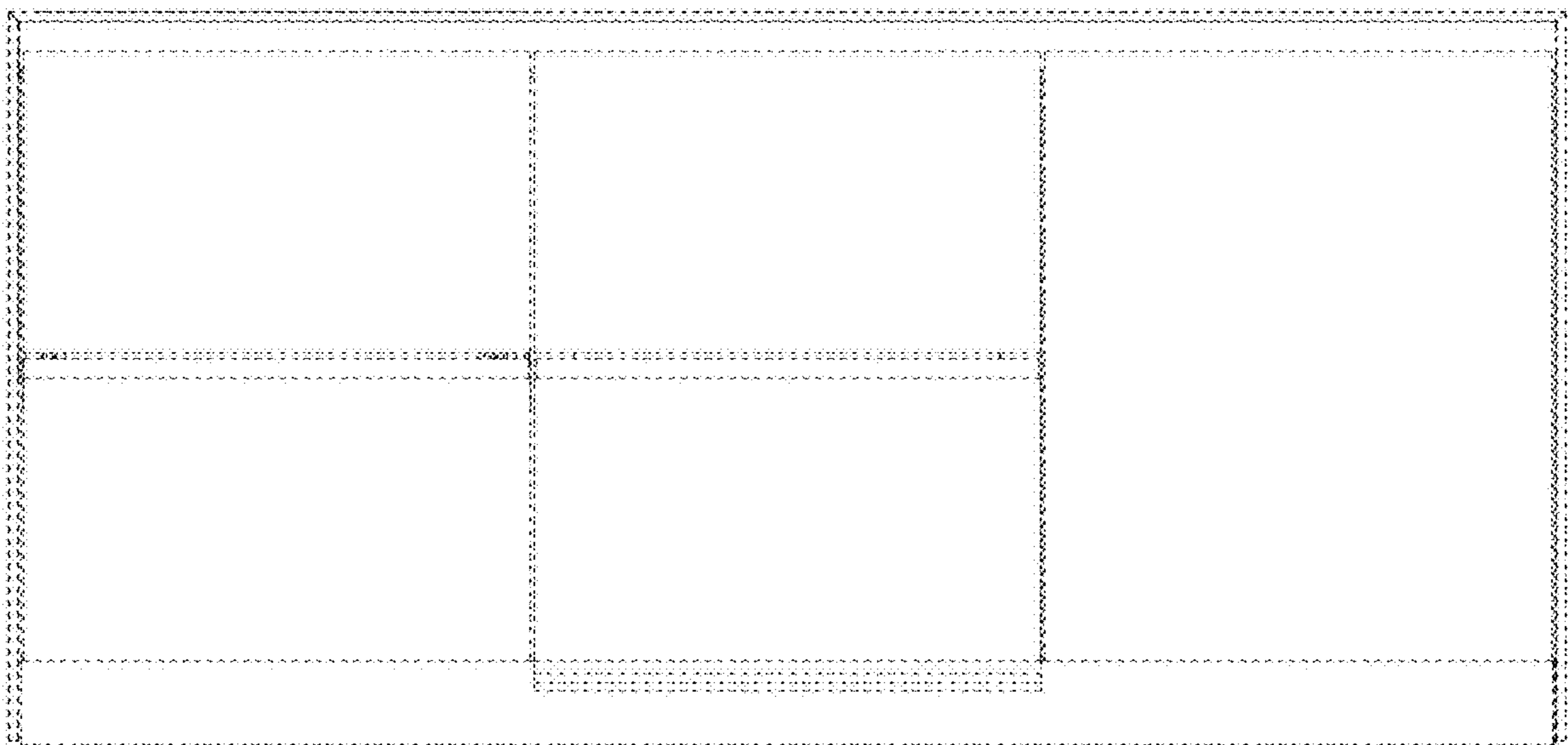

1.4

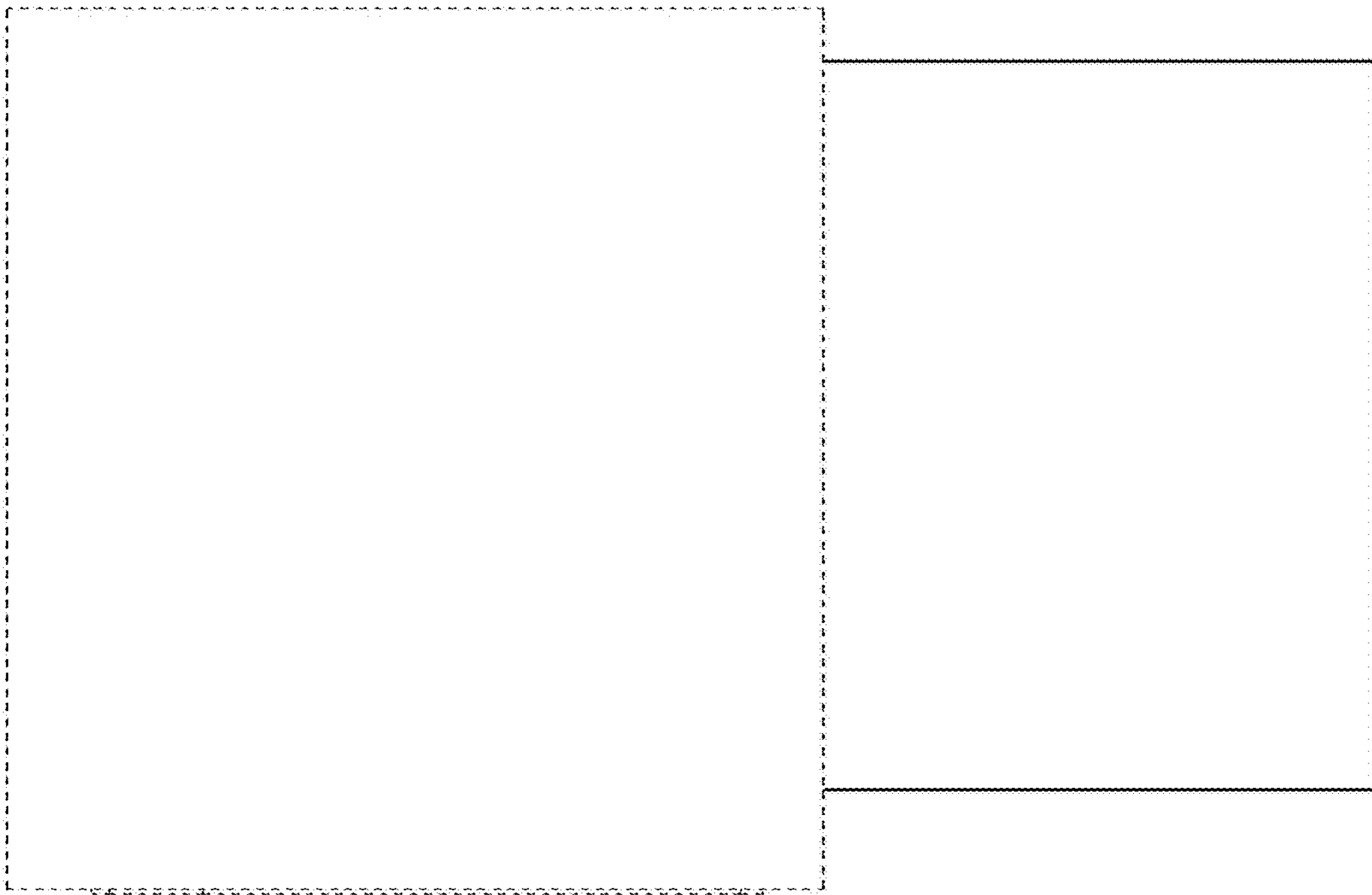

1.5

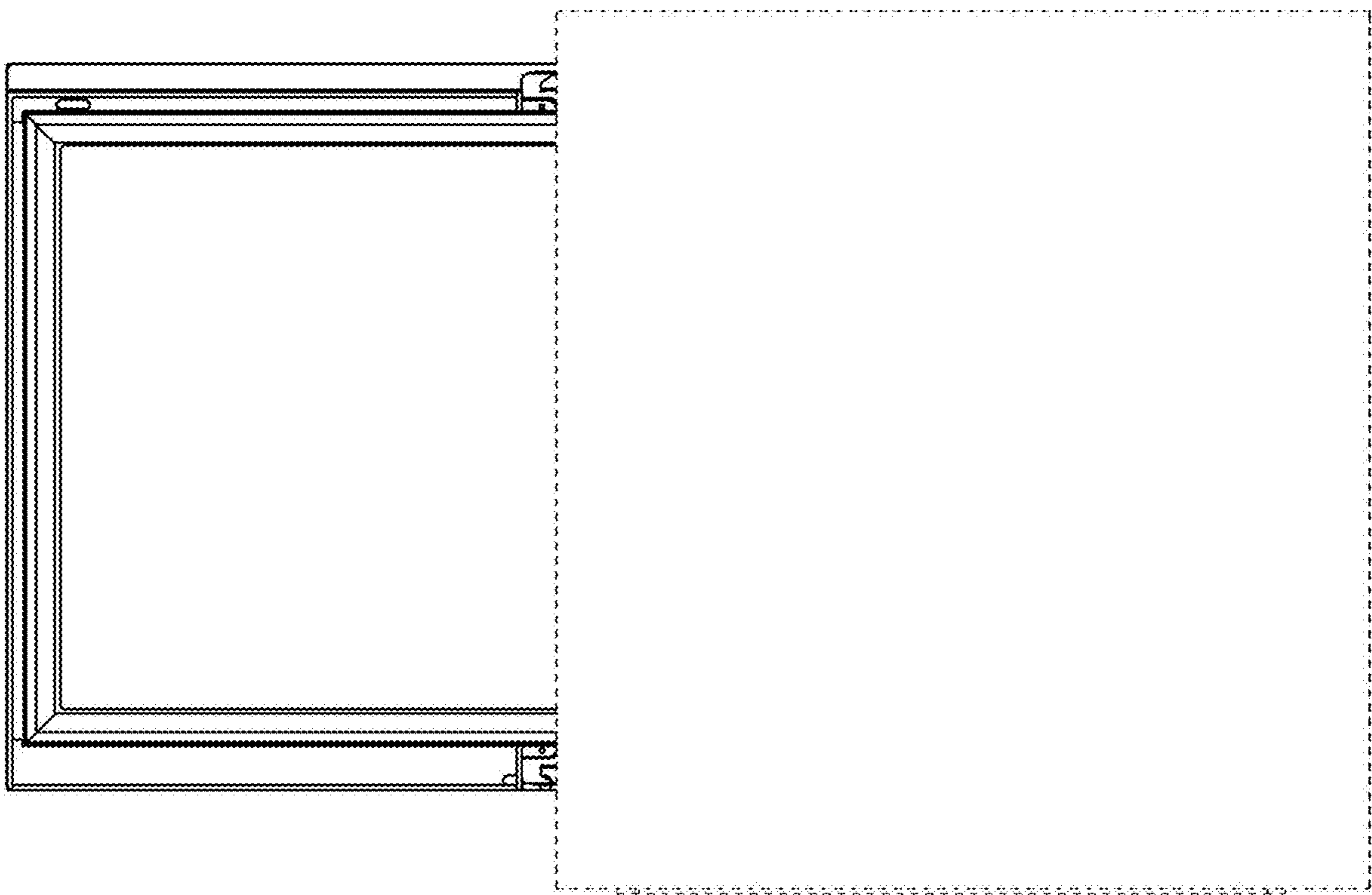

1.6



1.7

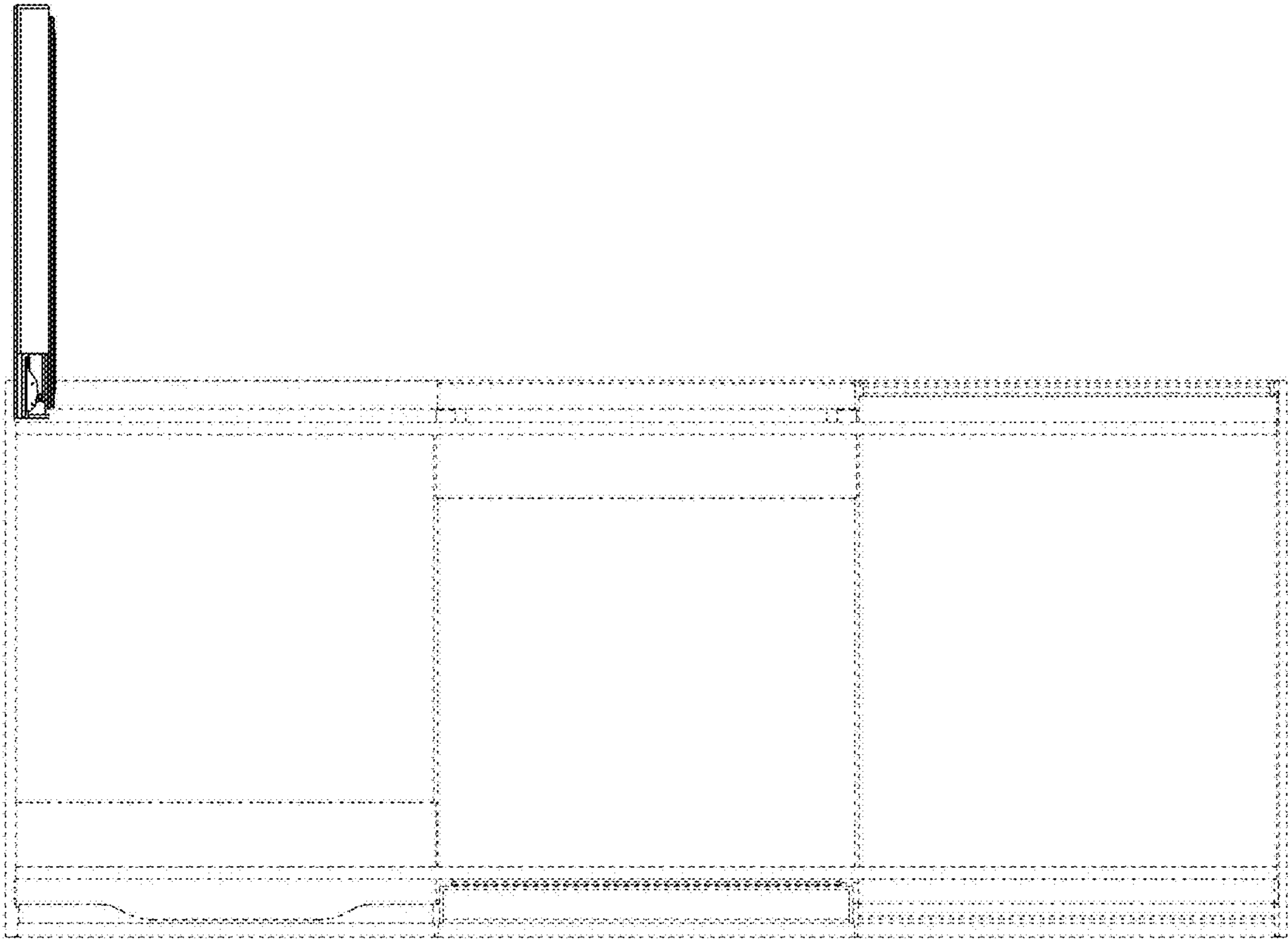

1.8

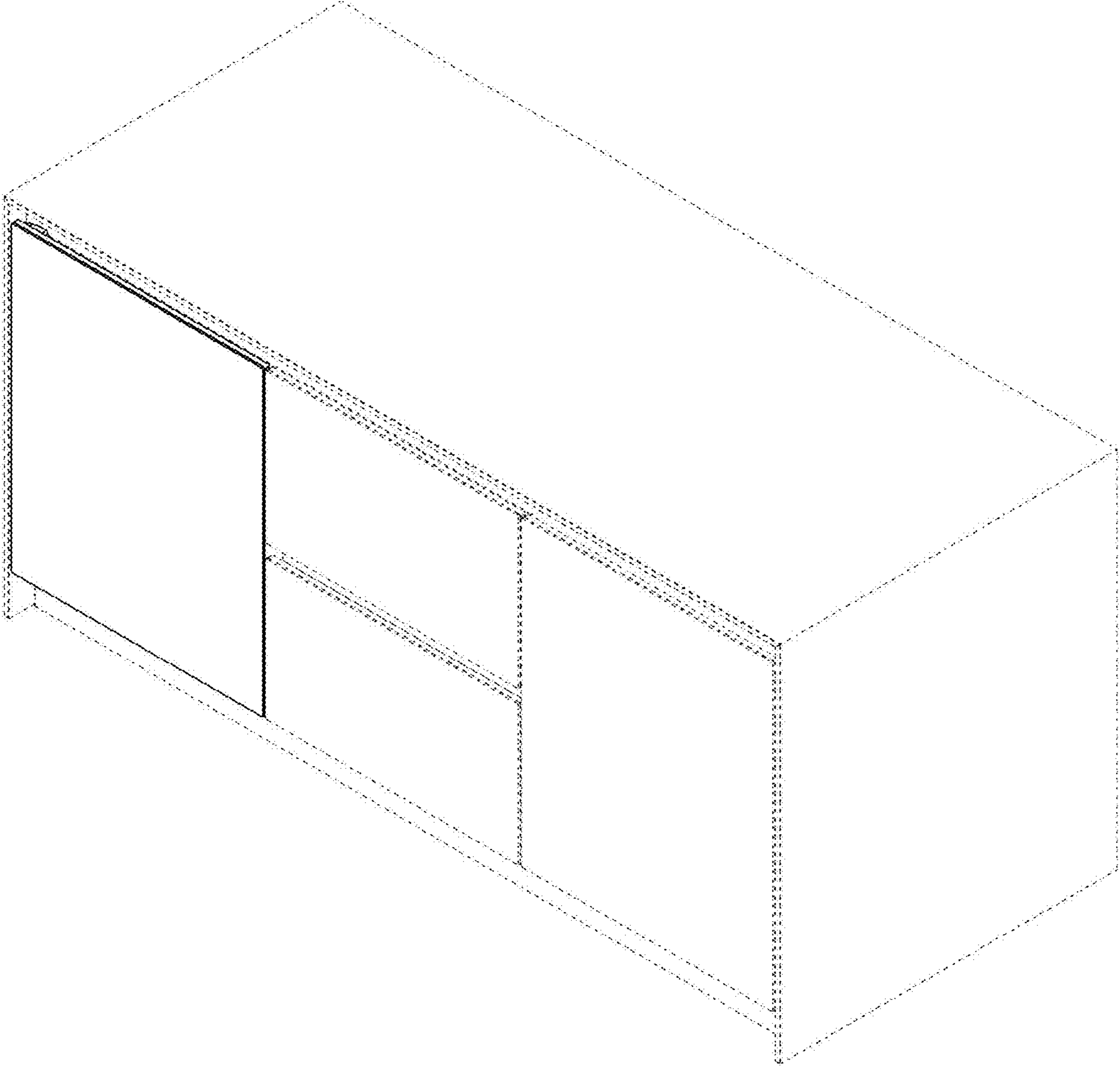

1.9

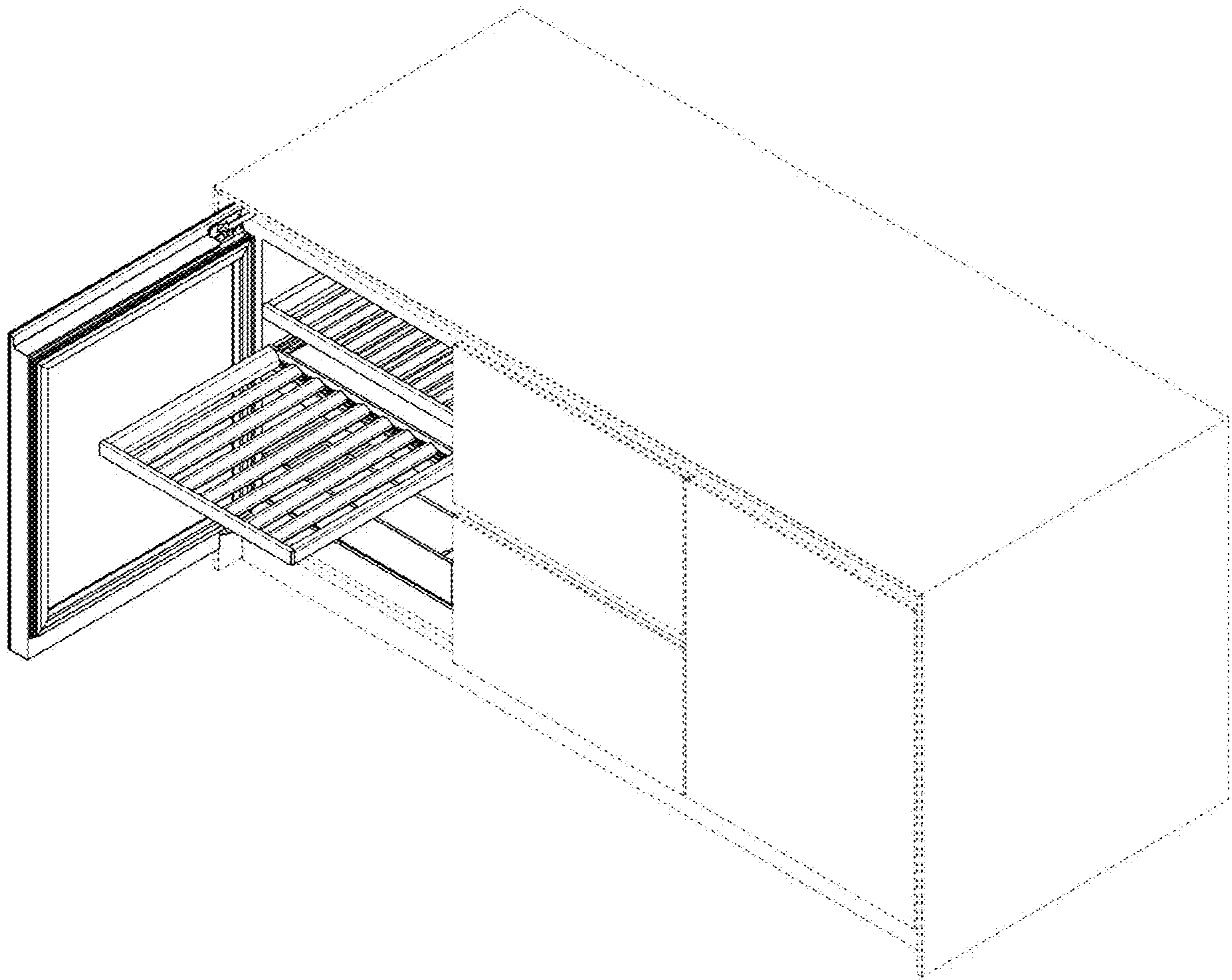

1.10

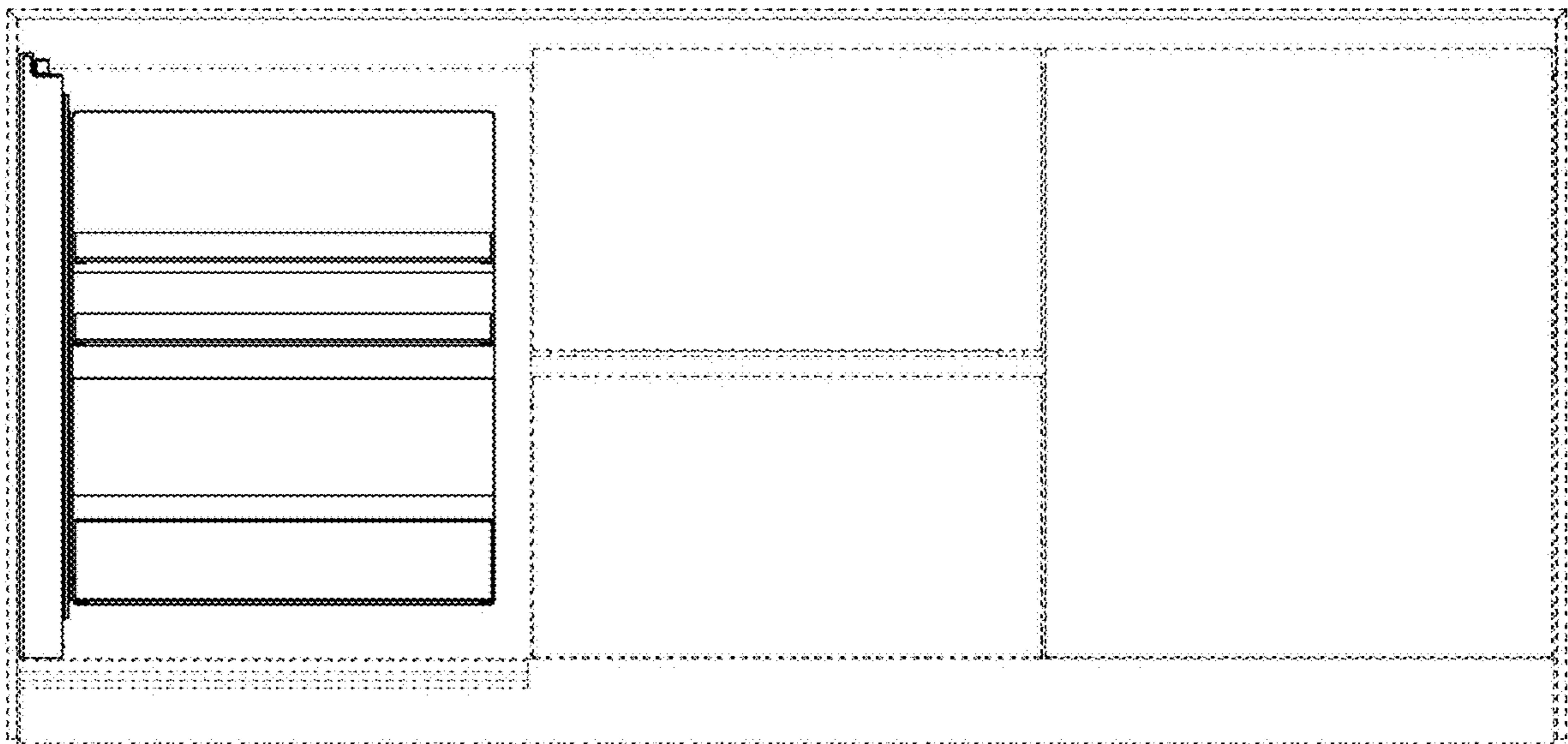

1.11

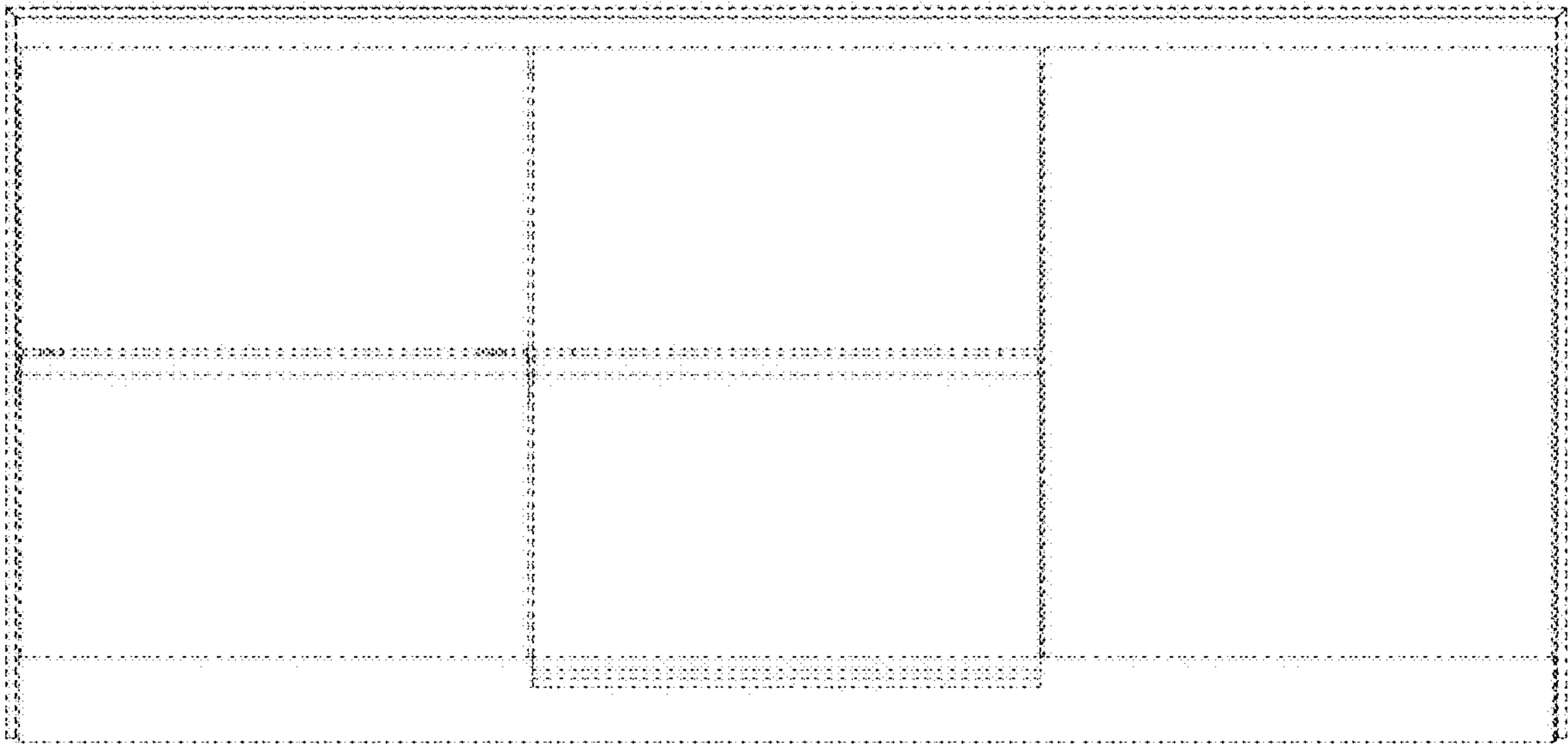

1.12

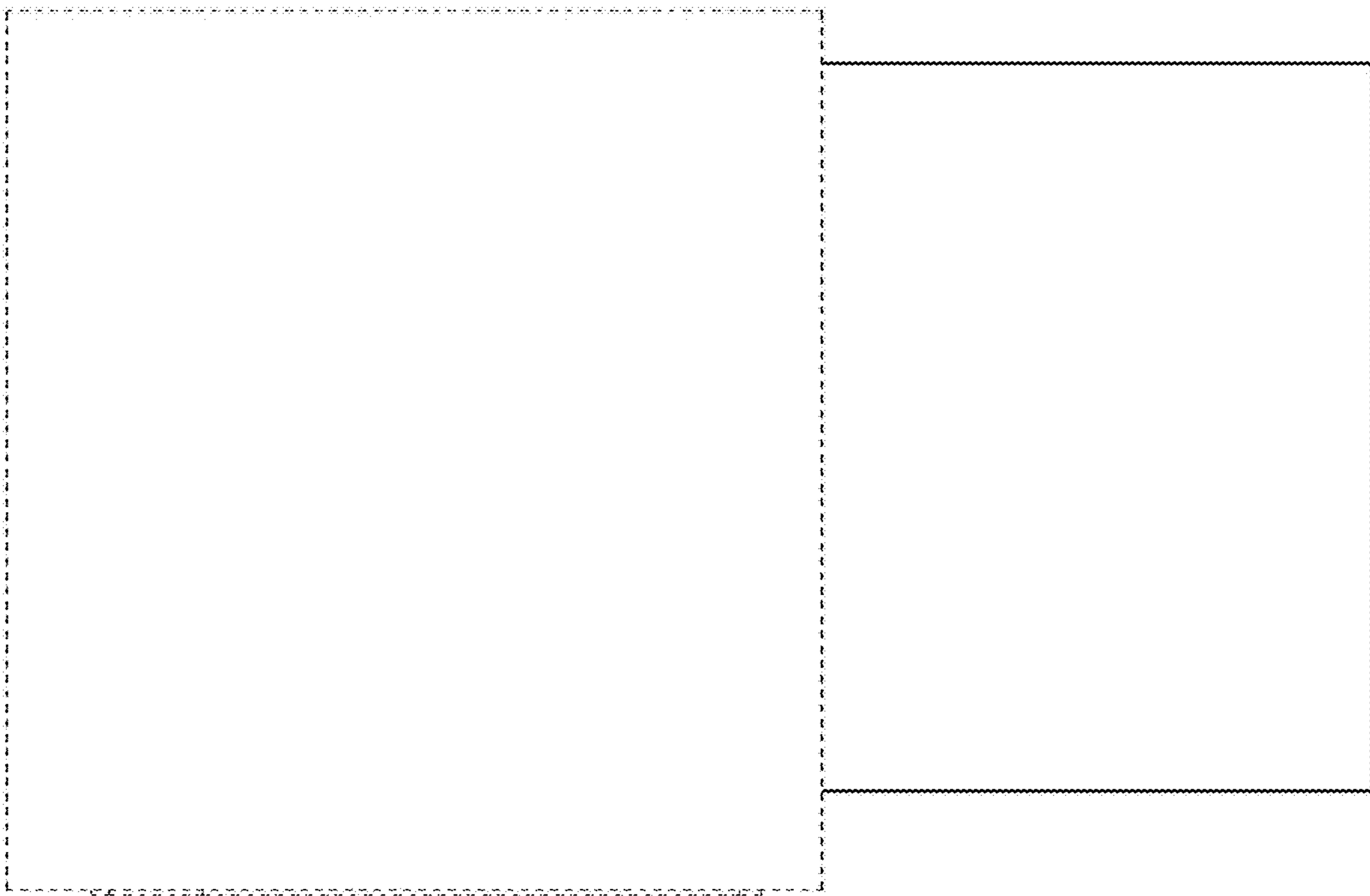

1.13

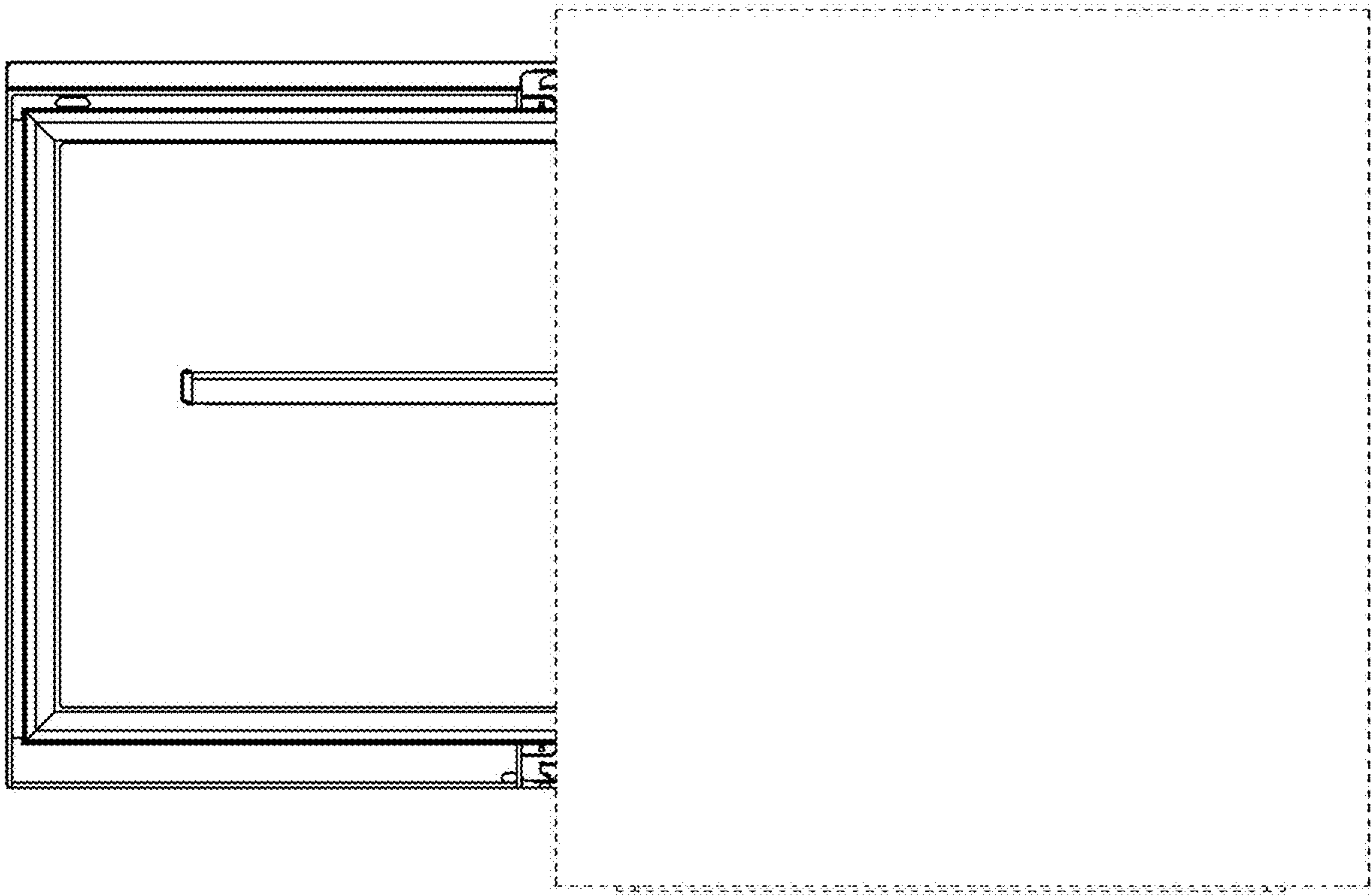

1.14

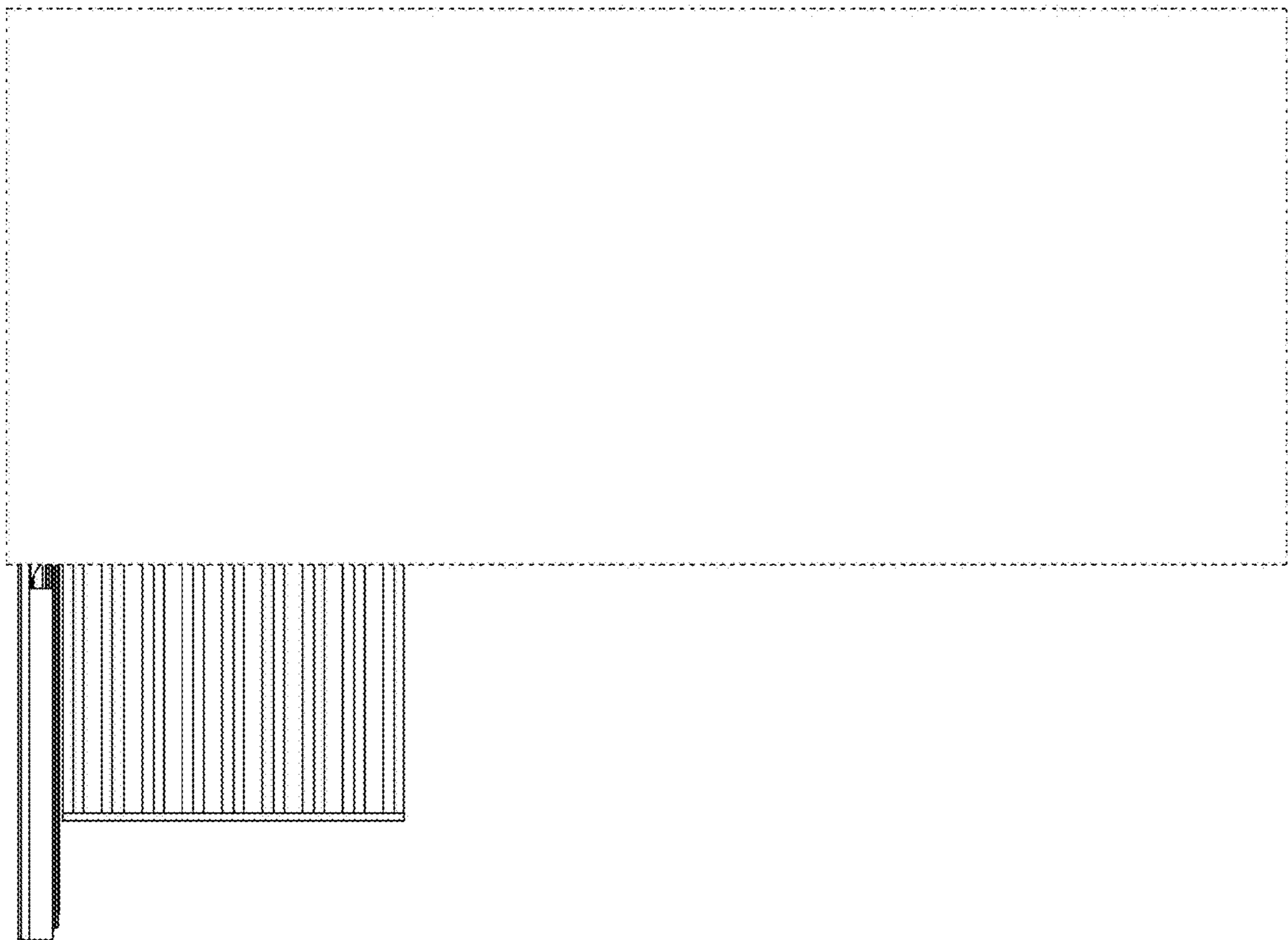

1.15

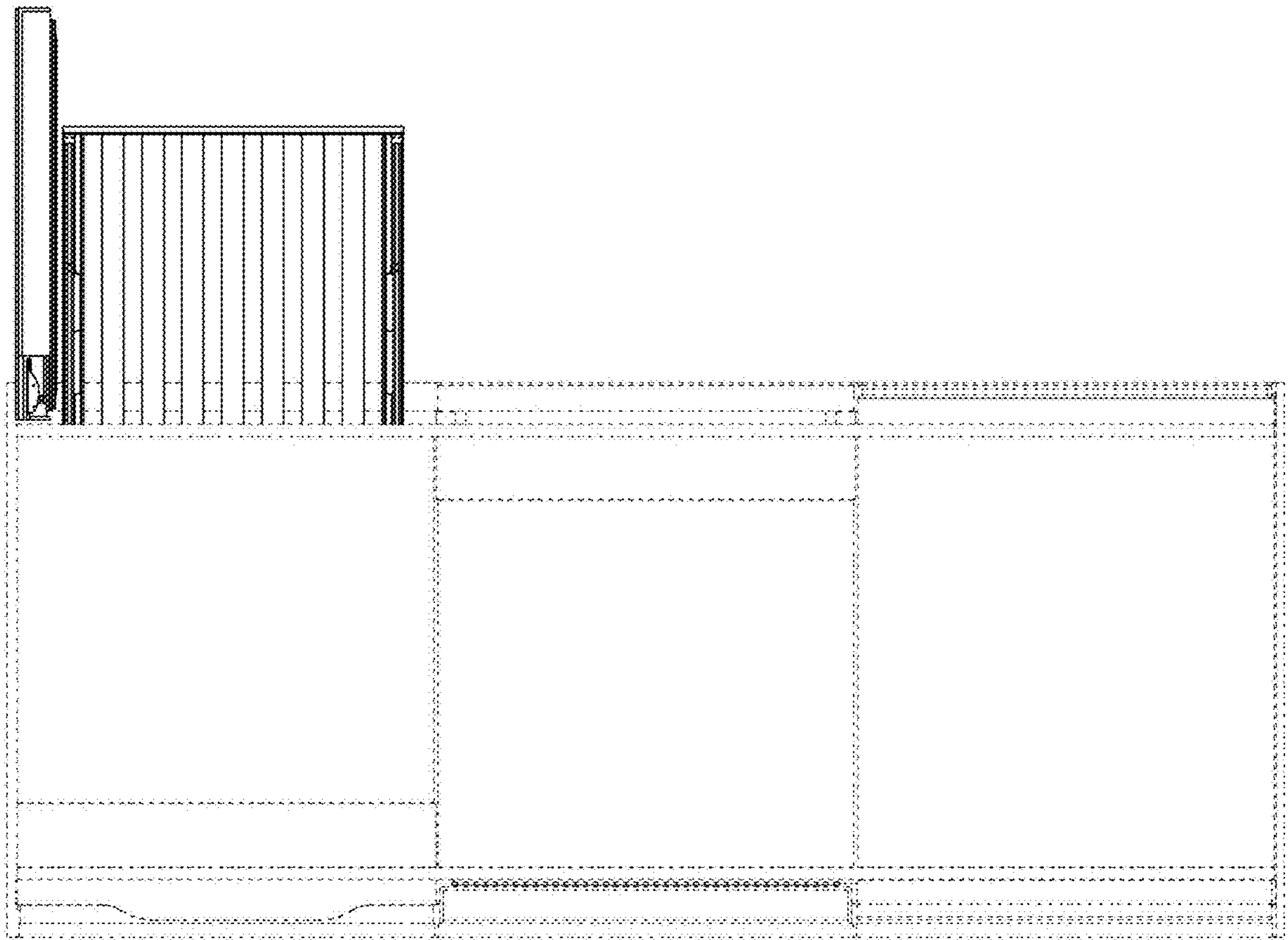

1.16

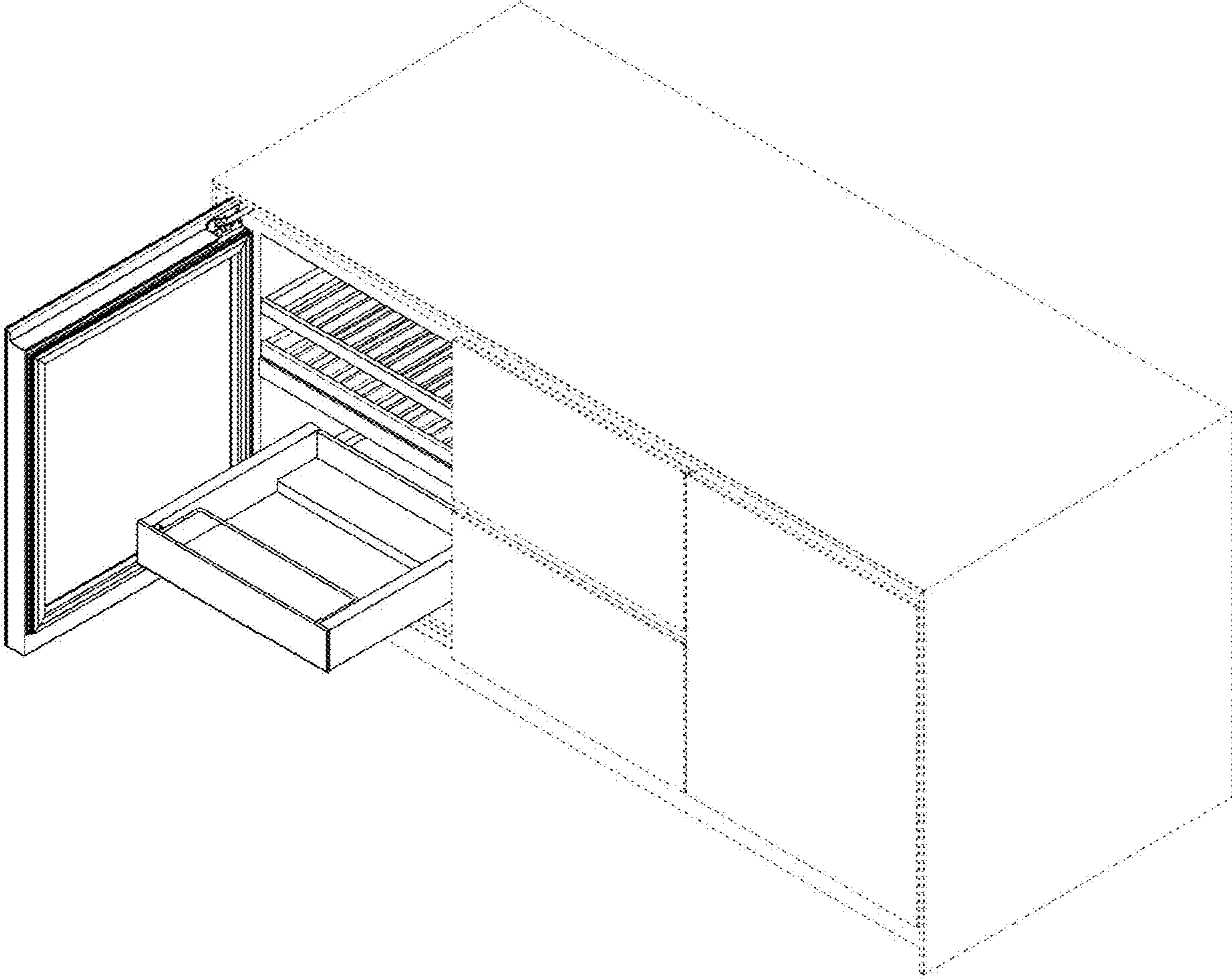

1.17

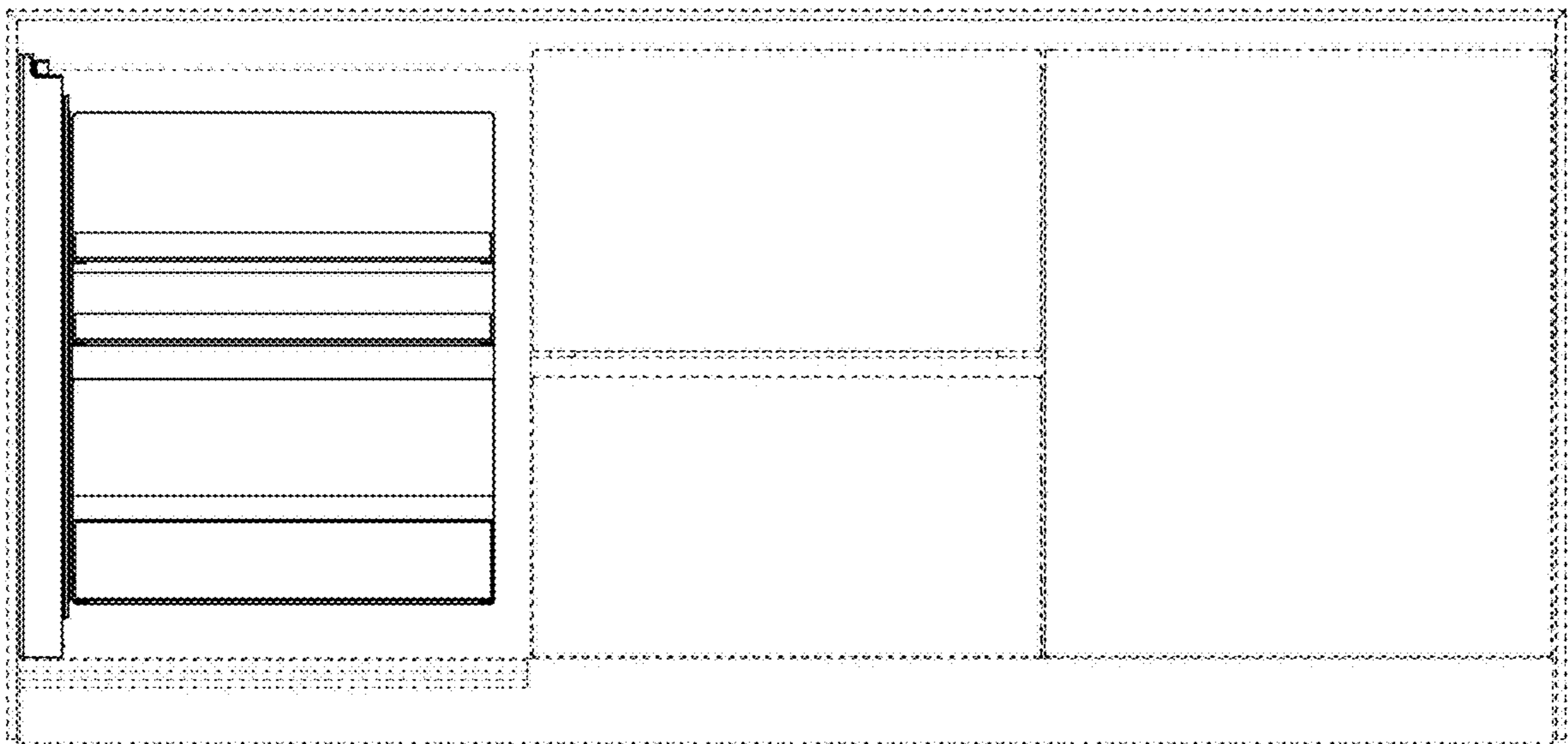

1.18

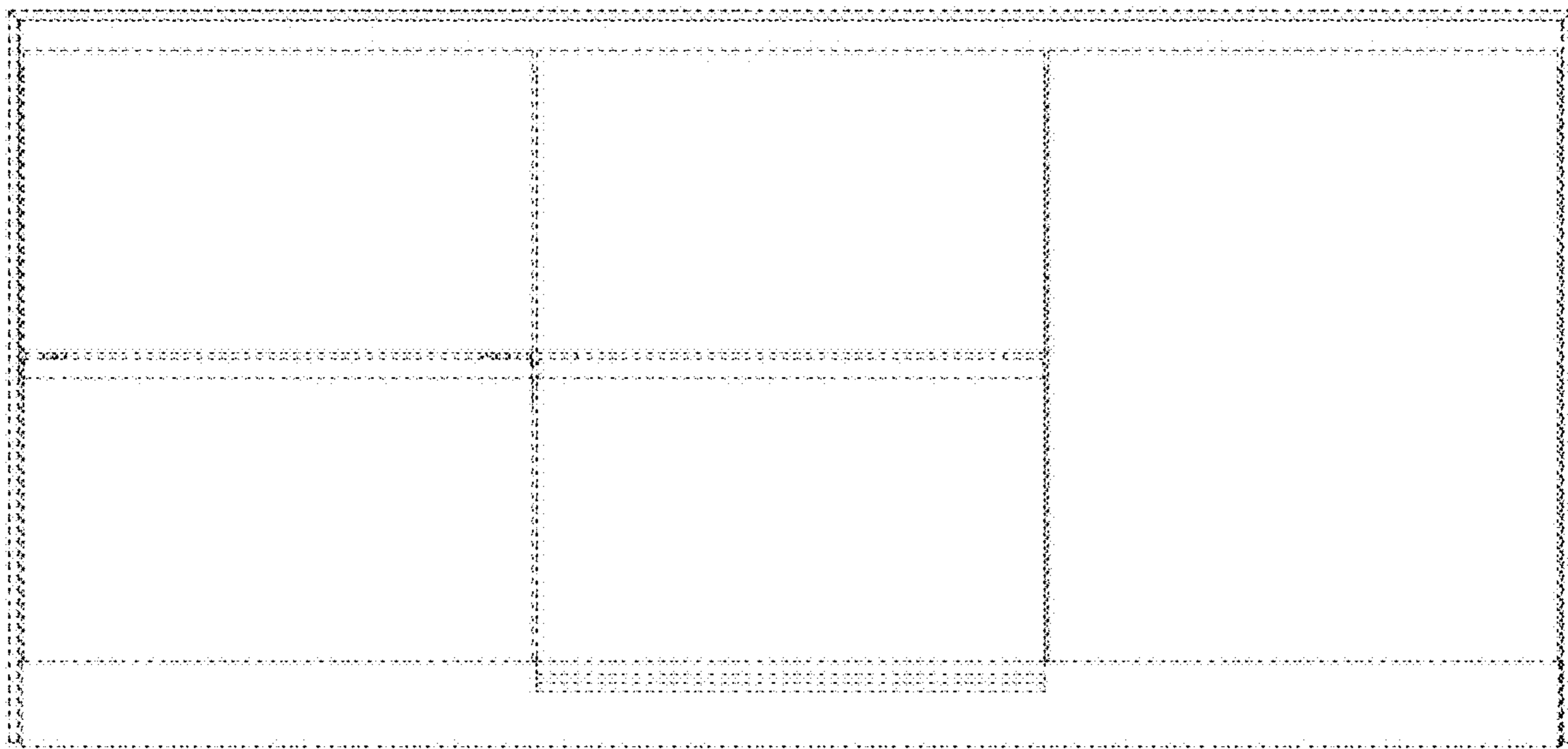

1.19

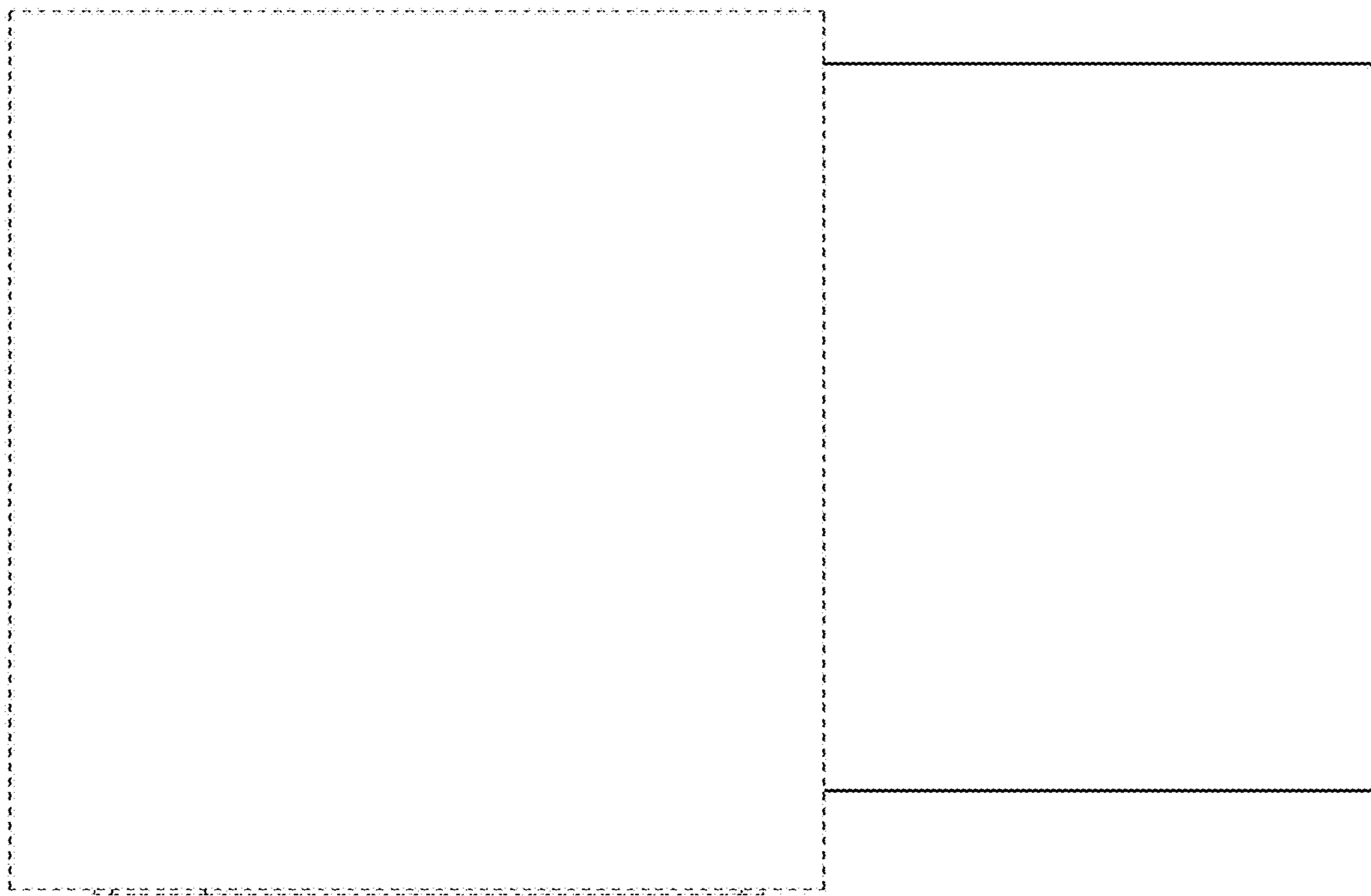

1.20



1.21

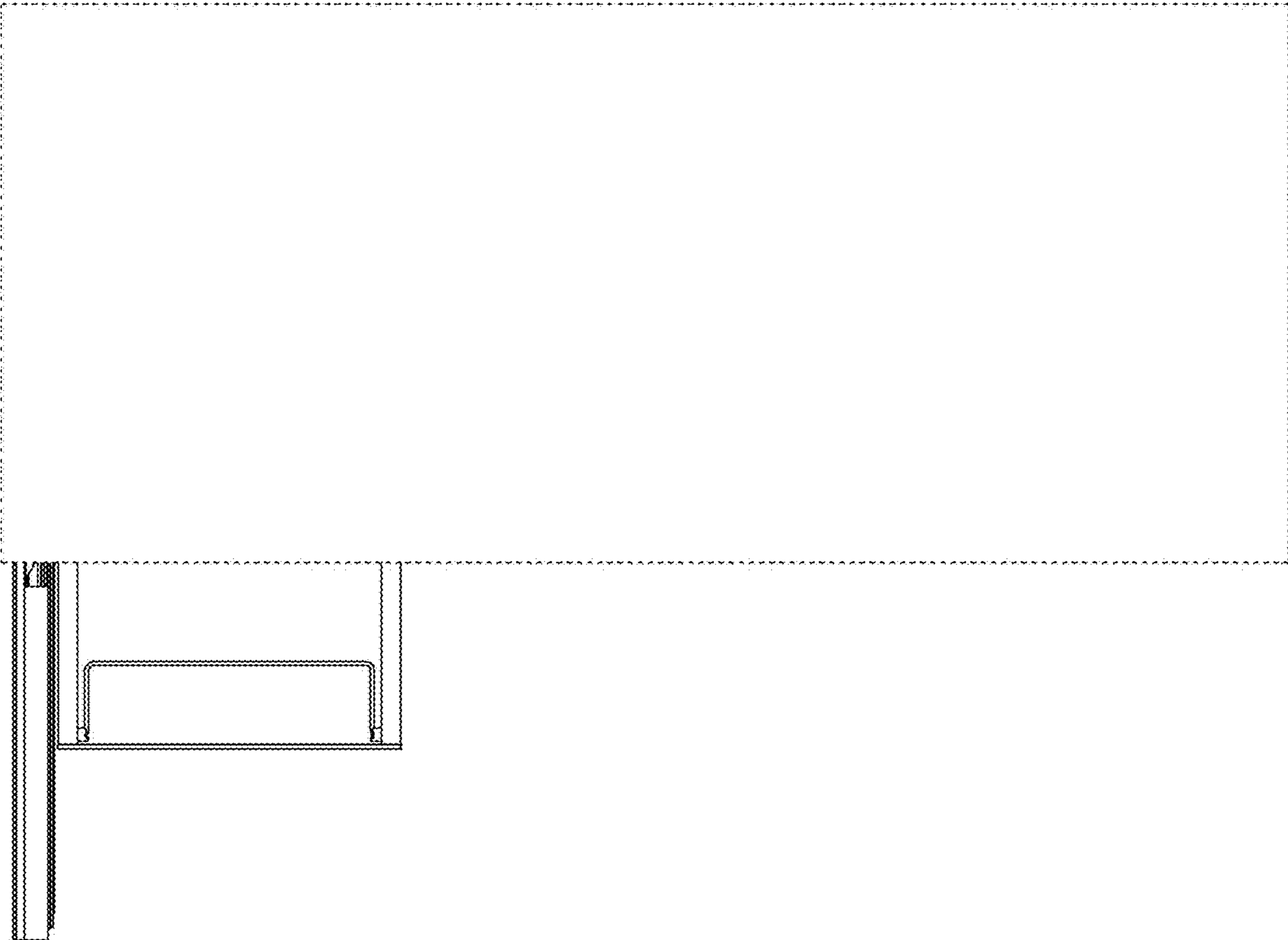

1.22

