



US00D910807S

(12) **United States Design Patent** (10) **Patent No.:** **US D910,807 S**
Brown et al. (45) **Date of Patent:** **** Feb. 16, 2021**

(54) **FUEL TANK FLOAT**

(71) Applicants: **Christopher J. Brown**, Oregon City, OR (US); **Daniel Ray Enyeart**, Gladstone, OR (US)

(72) Inventors: **Christopher J. Brown**, Oregon City, OR (US); **Daniel Ray Enyeart**, Gladstone, OR (US)

(**) Term: **15 Years**

(21) Appl. No.: **29/687,063**

(22) Filed: **Apr. 10, 2019**

(51) **LOC (13) Cl.** **23-01**

(52) **U.S. Cl.**
USPC **D23/200**

(58) **Field of Classification Search**
USPC D23/200, 202, 258; D7/675, 676
CPC G01F 23/38; B60K 15/03
See application file for complete search history.

(56) **References Cited**

U.S. PATENT DOCUMENTS

D256,608 S *	8/1980	Makhobey	D23/258
D282,893 S *	3/1986	Daenen	D7/676
4,836,396 A *	6/1989	Ancona	A21C 11/106 206/457
D675,888 S *	2/2013	Cline	D7/675
D799,911 S *	10/2017	Mockler	D7/675
2002/0083597 A1 *	7/2002	Garner	B26D 5/10 30/316
2008/0076651 A1 *	3/2008	Curtin	A21C 11/106 492/14
2017/0055564 A1 *	3/2017	Yoshida	A23P 30/10

2017/0099846 A1 *	4/2017	Mueller	A21D 13/24
2019/0248230 A1 *	8/2019	Enyeart	B60K 15/077
2020/0300687 A1 *	9/2020	Brown	G01F 23/38

FOREIGN PATENT DOCUMENTS

KR 300351899 * 2/2003

OTHER PUBLICATIONS

Carburetor float, announced Dec. 29, 2008[online], [site visited Nov. 16, 2020]. Available from internet, URL:<<https://www.amazon.com/Stens-056-098-Carburetor-Tecumseh-632019A/dp/B0014C4UYA>> (Year: 2008).*

* cited by examiner

Primary Examiner — Barbara Fox

Assistant Examiner — Jamaal Rasheed

(74) *Attorney, Agent, or Firm* — Ingrid McTaggart

(57) **CLAIM**

The ornamental design for a fuel tank float, as shown and described.

DESCRIPTION

FIG. 1 is an isometric view of the fuel tank float. FIG. 2 is a front elevational view of the fuel tank float, the rear elevational view, left side elevational view, and right side elevational view each being identical thereto; and, FIG. 3 is a top plan view thereof, the bottom plan view being identical thereto.

1 Claim, 1 Drawing Sheet

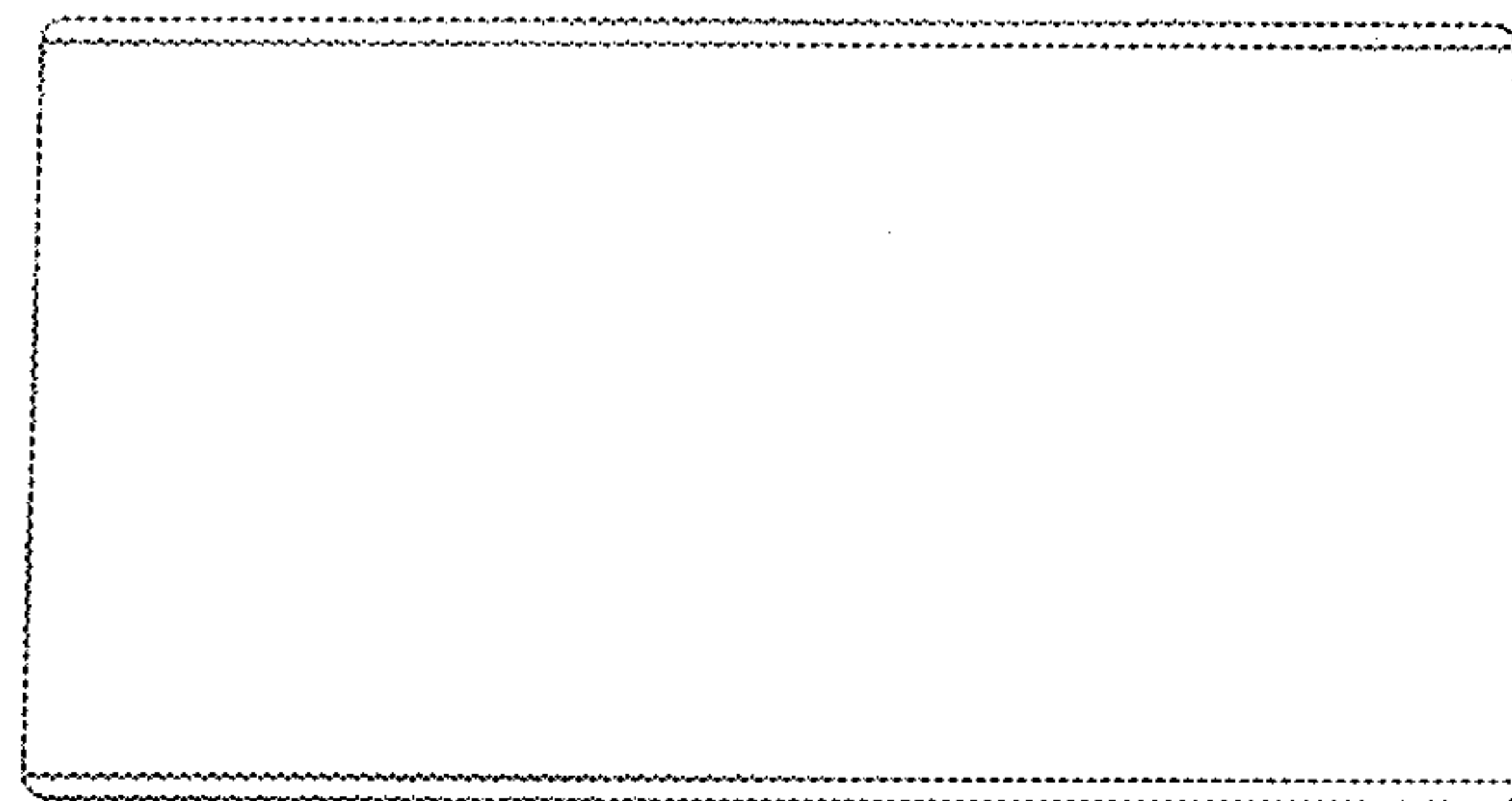
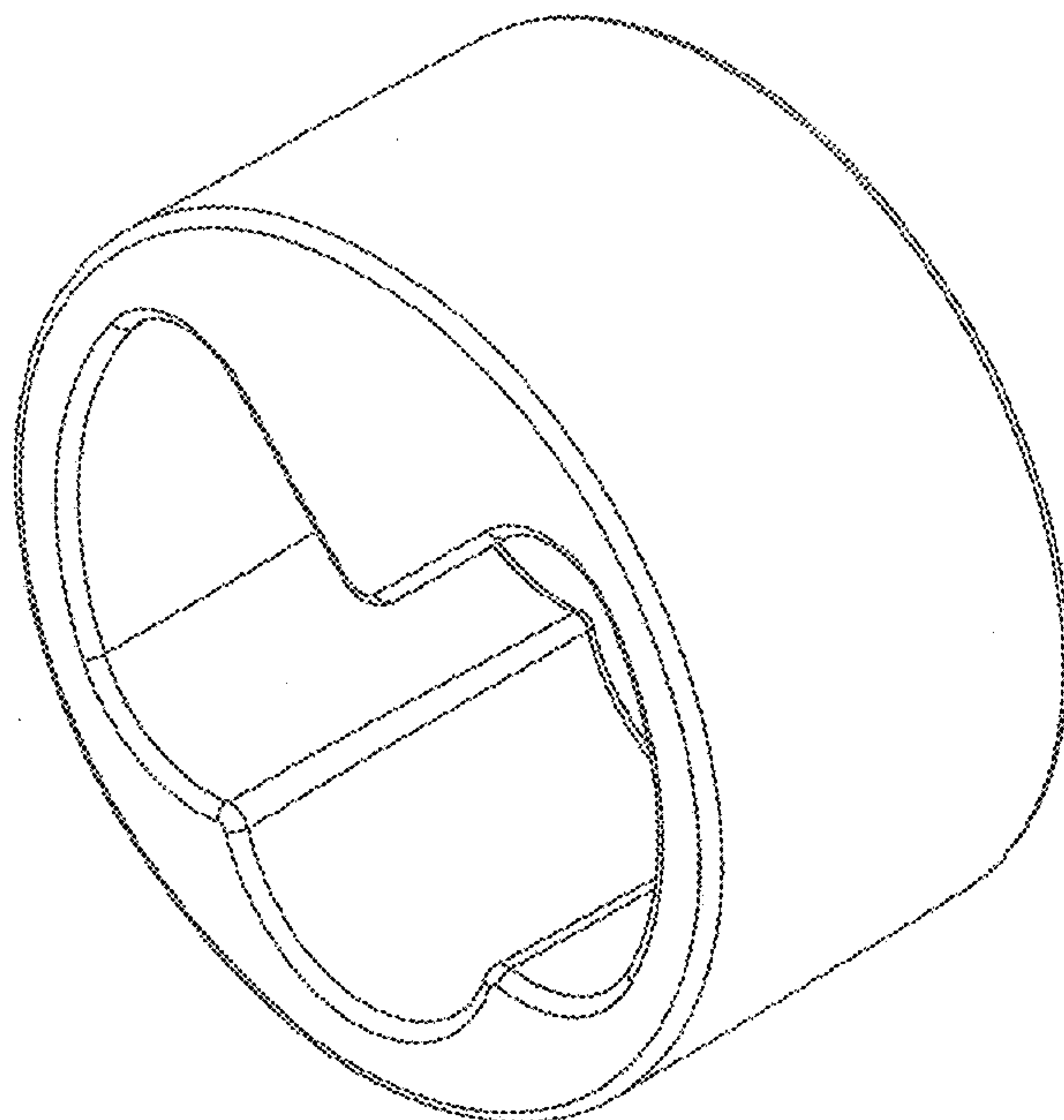

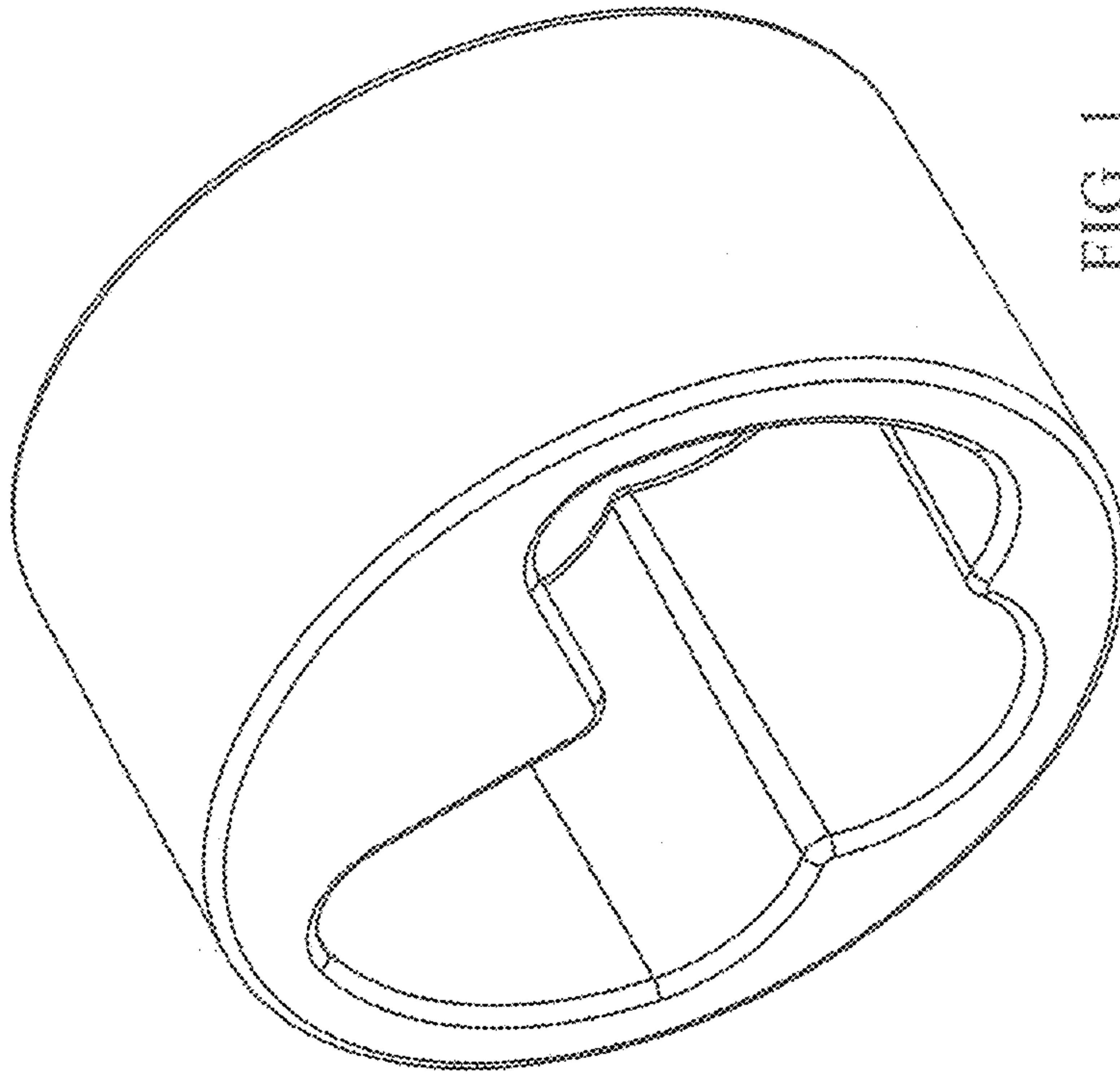

FIG. 1

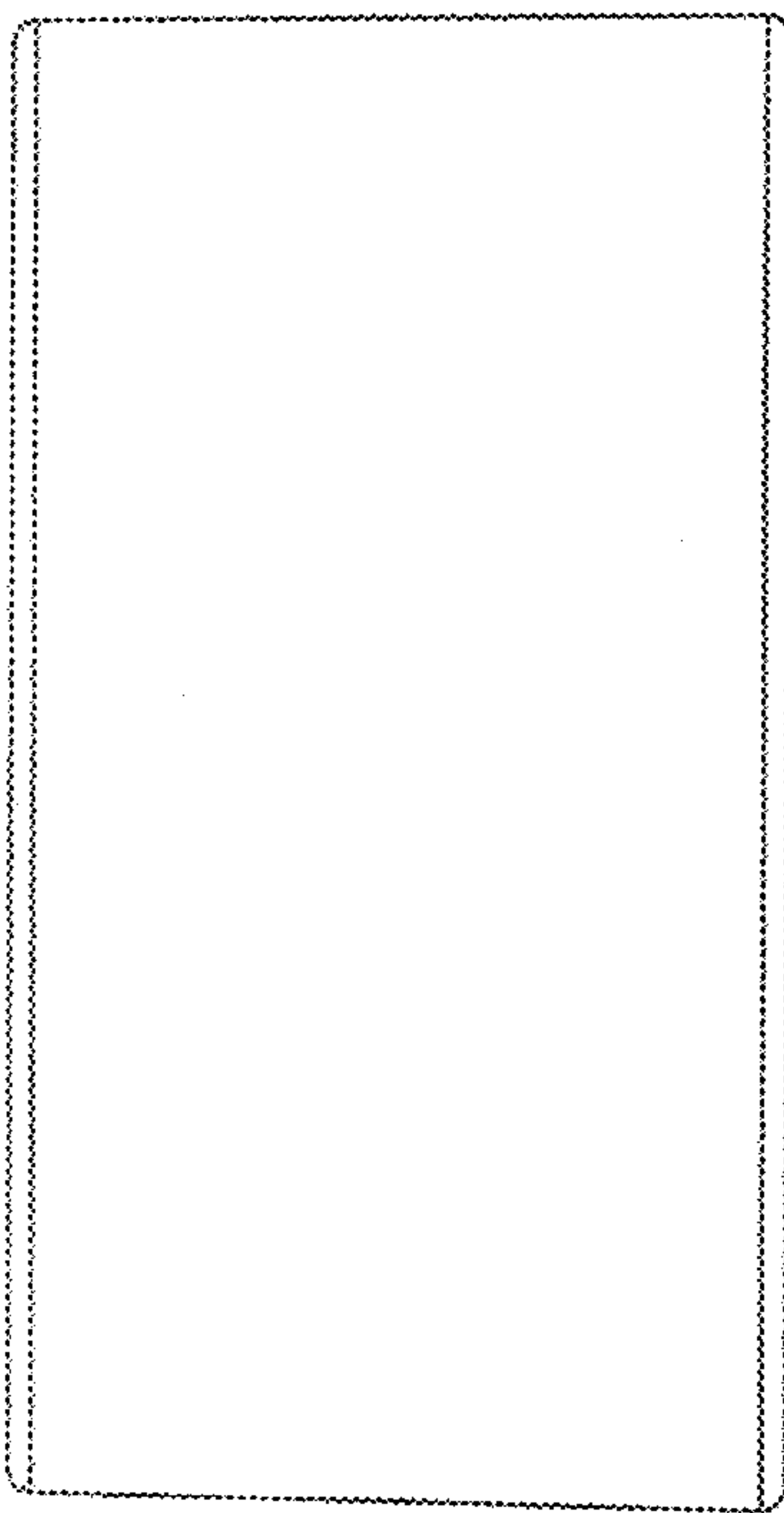

FIG. 2

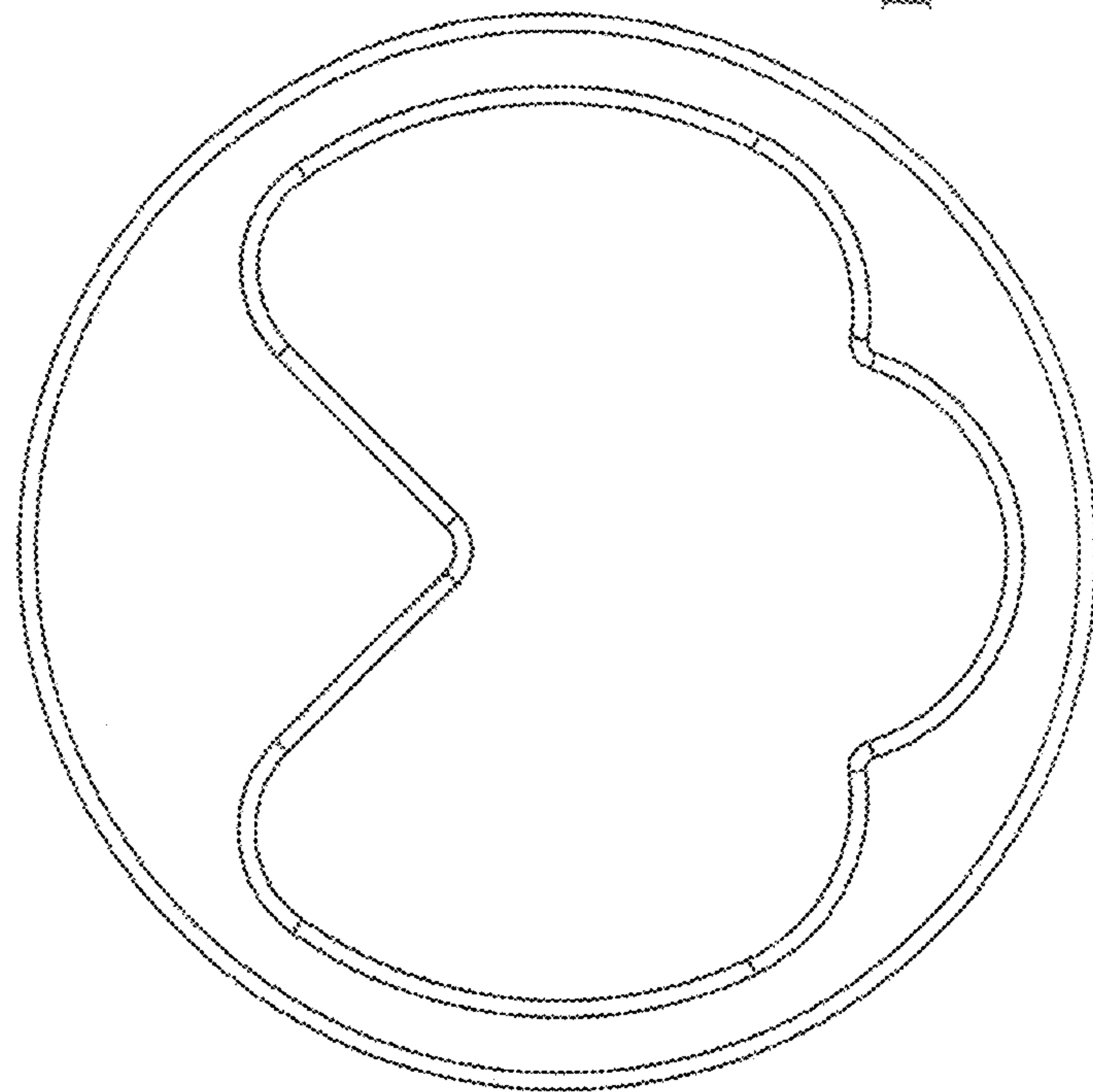

FIG. 3