

US00D910742S

(12) **United States Design Patent**  
**Fujii et al.**

(10) **Patent No.:** **US D910,742 S**

(45) **Date of Patent:** **\*\* Feb. 16, 2021**

(54) **IMAGE DRUM CARTRIDGE**

(71) Applicant: **OKI DATA CORPORATION**, Tokyo (JP)

(72) Inventors: **Masashi Fujii**, Tokyo (JP); **Tatsuhiko Shimomura**, Tokyo (JP); **Junichi Ushikubo**, Tokyo (JP); **Shun Hatanaka**, Tokyo (JP)

(73) Assignee: **OKI DATA CORPORATION**, Tokyo (JP)

(\*\*) Term: **15 Years**

(21) Appl. No.: **29/664,053**

(22) Filed: **Sep. 21, 2018**

(30) **Foreign Application Priority Data**

Mar. 30, 2018 (JP) ..... JP2018-007165

(51) **LOC (13) Cl.** ..... **16-03**

(52) **U.S. Cl.**  
USPC ..... **D18/43**

(58) **Field of Classification Search**  
USPC ..... D18/40, 43, 56, 58; D14/462, 471  
CPC . B41J 2/17503; G03G 21/16; G03G 21/1814;  
G03G 15/00; G03G 15/0142; G03G  
2221/1823

See application file for complete search history.

(56) **References Cited**

**U.S. PATENT DOCUMENTS**

D374,250 S \* 10/1996 Yabuki ..... D18/40  
D471,583 S \* 3/2003 Okabe ..... D18/40

D476,360 S \* 6/2003 Kawamura ..... 347/86  
D523,896 S \* 6/2006 Ishii ..... D18/43  
D579,970 S \* 11/2008 Kamimura ..... D18/40  
D728,012 S \* 4/2015 Yoshii ..... D18/43  
D845,384 S \* 4/2019 Oguma ..... D18/43  
2017/0329277 A1\* 11/2017 Ushikubo ..... G03G 15/0875  
2018/0203408 A1\* 7/2018 Itabashi ..... G03G 15/0865  
2019/0294078 A1\* 9/2019 Fujii ..... G03G 15/0886  
2019/0391529 A1\* 12/2019 Abe ..... G03G 21/1867  
2020/0089158 A1\* 3/2020 Shimizu ..... G03G 21/1814

\* cited by examiner

*Primary Examiner* — Kevin K Rudzinski

*Assistant Examiner* — J. Thorn, Sr.

(74) *Attorney, Agent, or Firm* — Ladas & Parry LLP

(57) **CLAIM**

We claim the ornamental design for an image drum cartridge, as shown and described.

**DESCRIPTION**

FIG. 1 is a front elevational view of an image drum cartridge showing our new design;

FIG. 2 is a rear elevational view thereof;

FIG. 3 is a right-side elevational view thereof;

FIG. 4 is a left-side elevational view thereof;

FIG. 5 is a top plan view thereof;

FIG. 6 is a bottom plan view thereof;

FIG. 7 is a front perspective view thereof; and,

FIG. 8 is a rear perspective view thereof.

The broken lines in the drawings depict portions of the image drum cartridge that form no part of the claimed design.

**1 Claim, 8 Drawing Sheets**

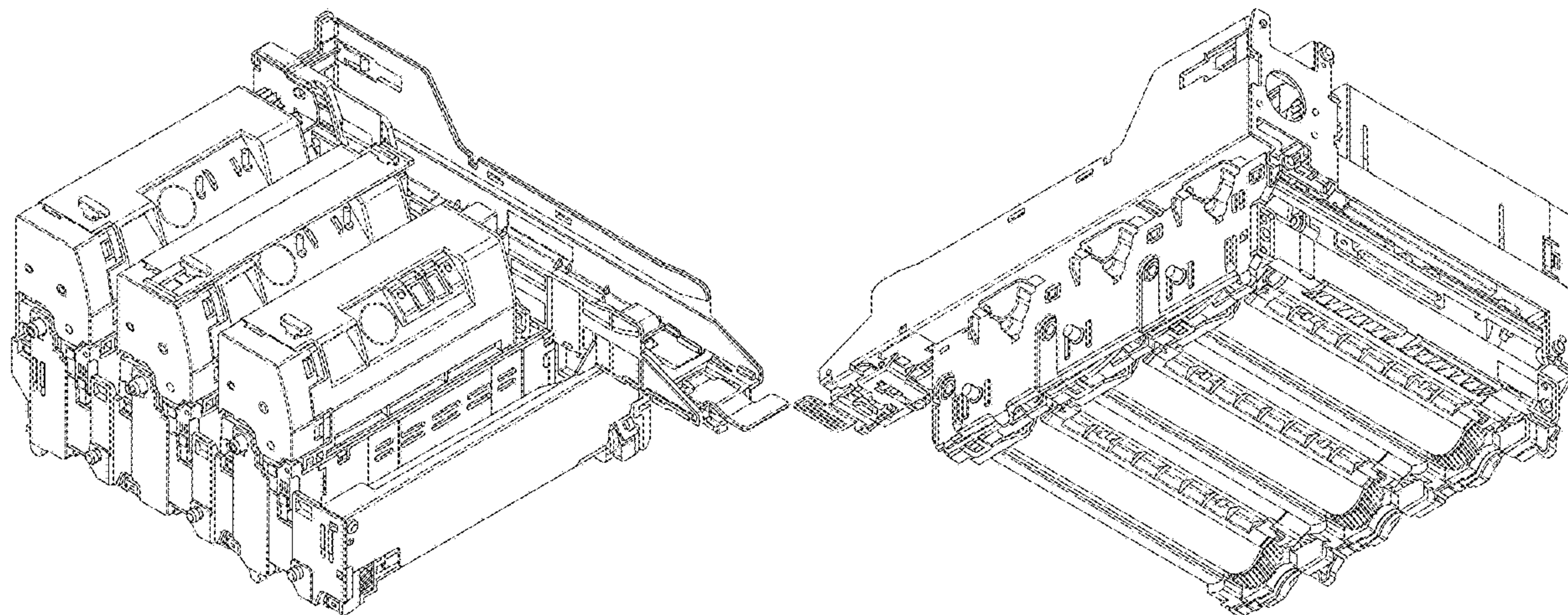

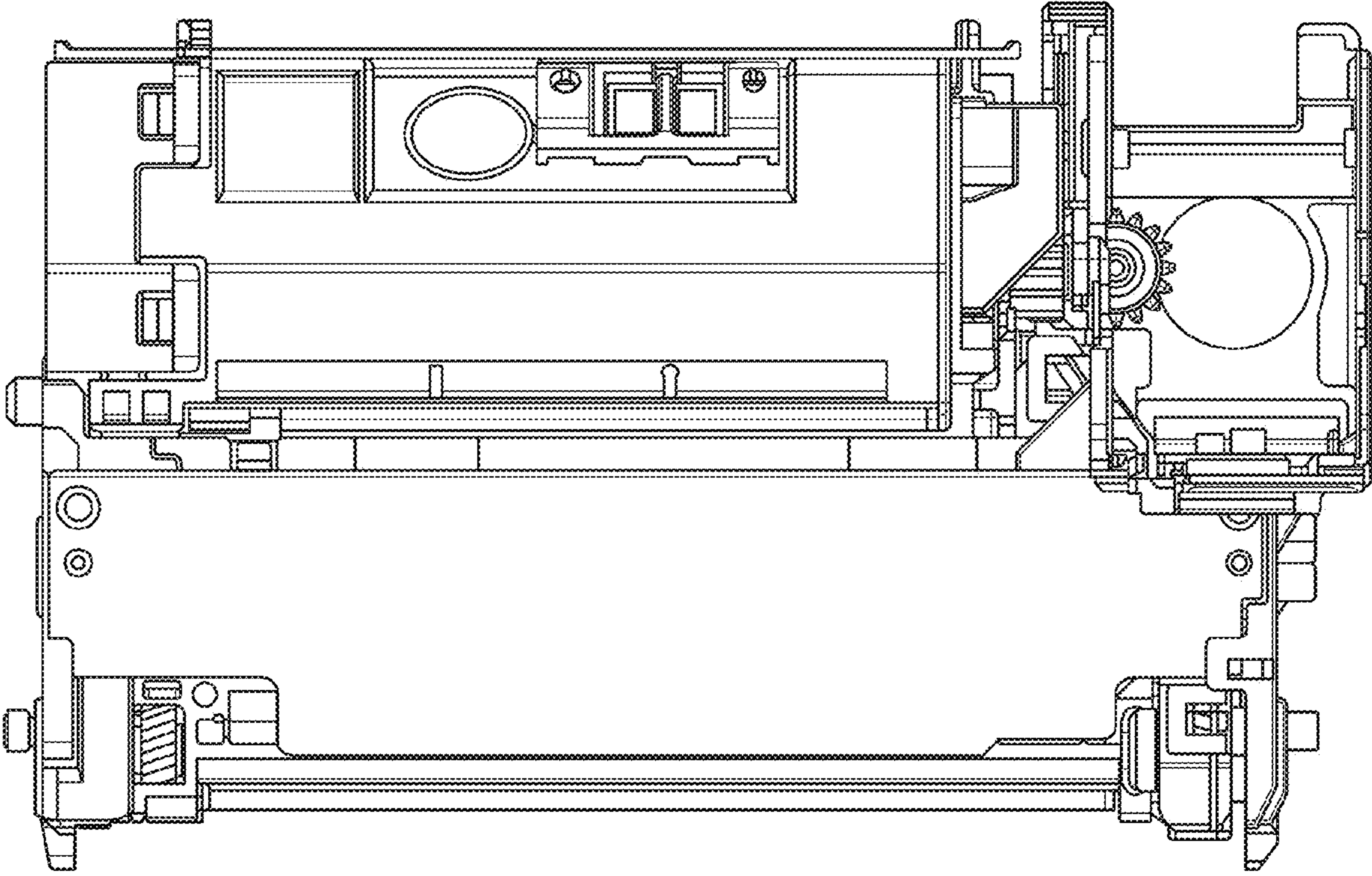

FIG. 1



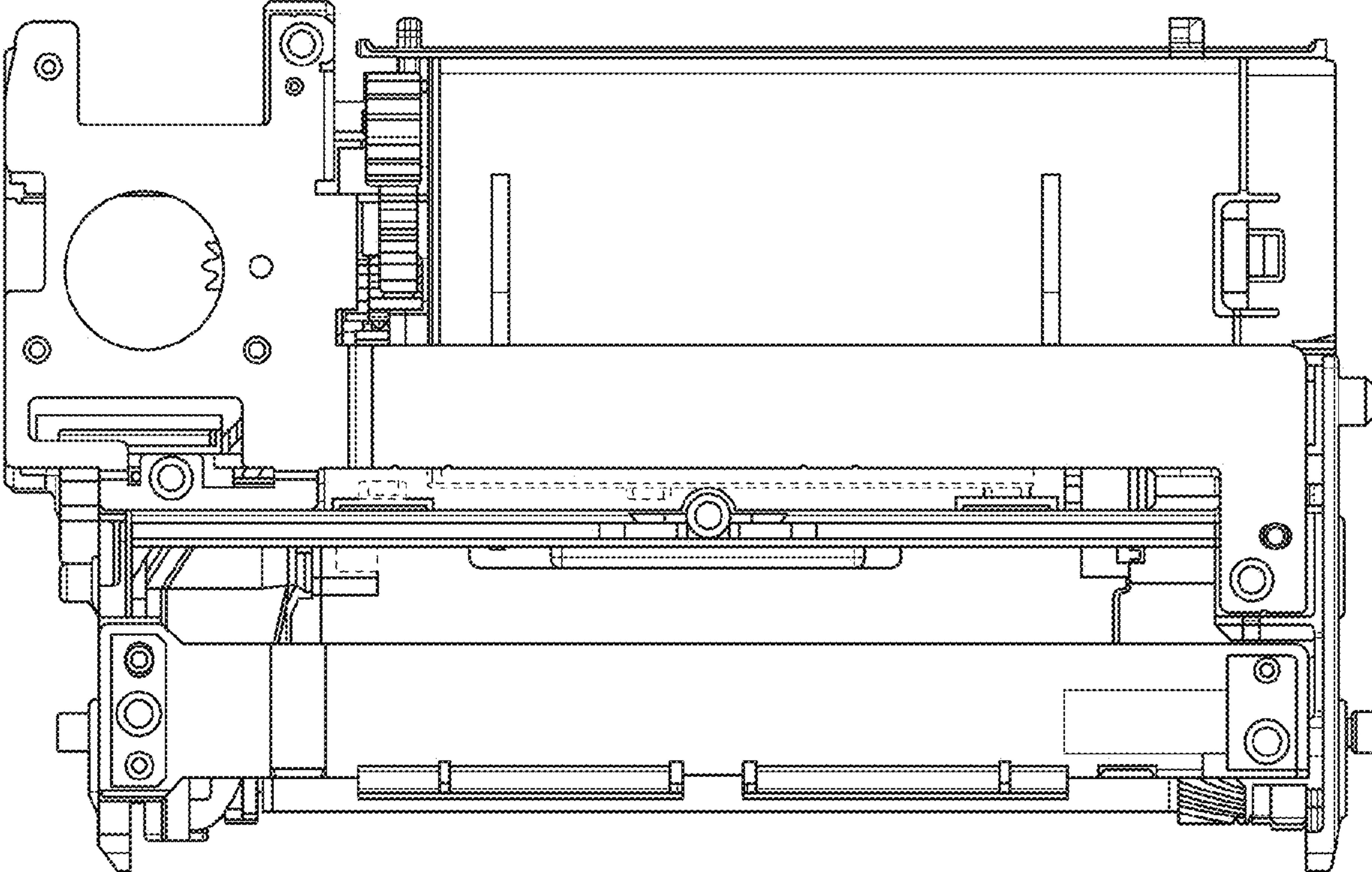

FIG. 2

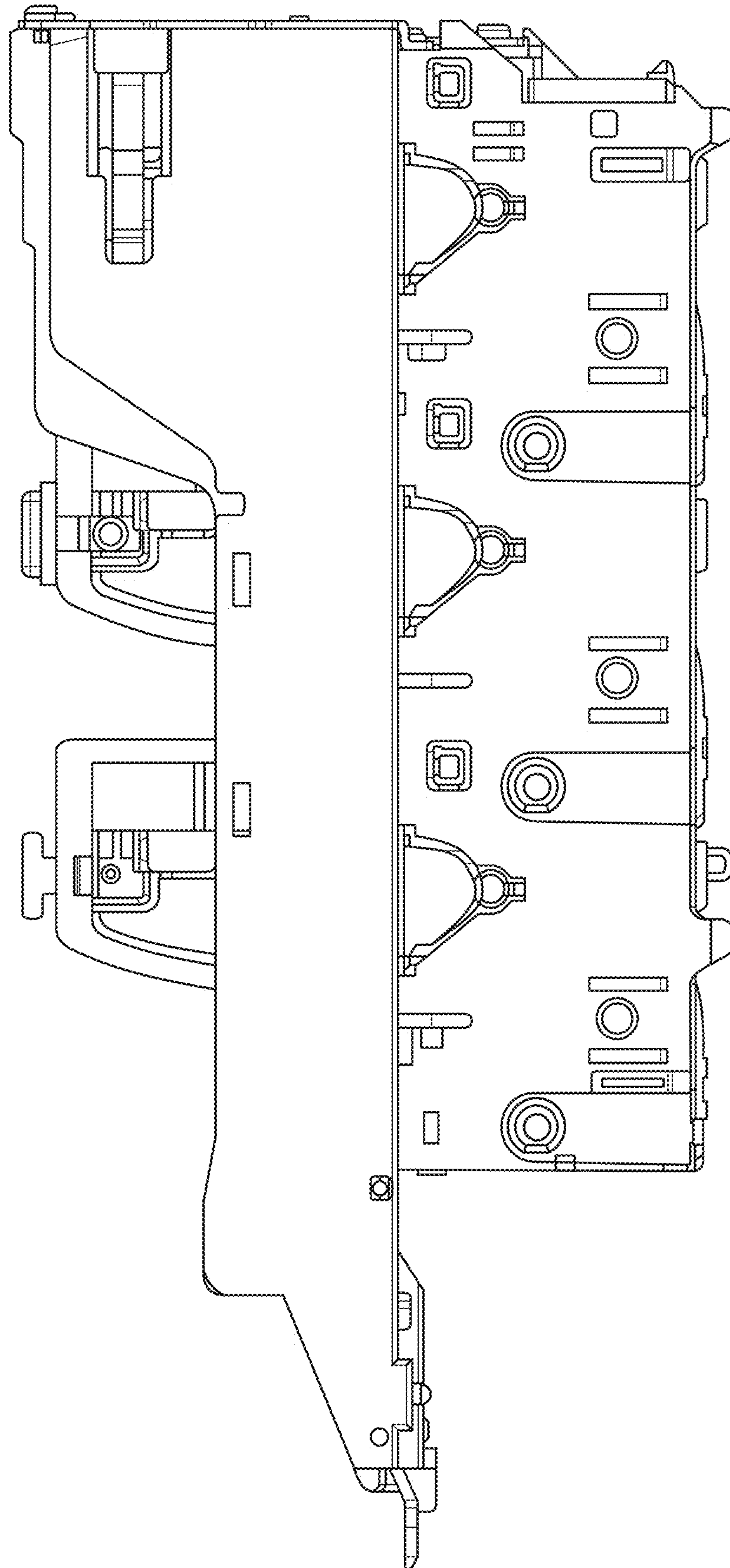

FIG. 3

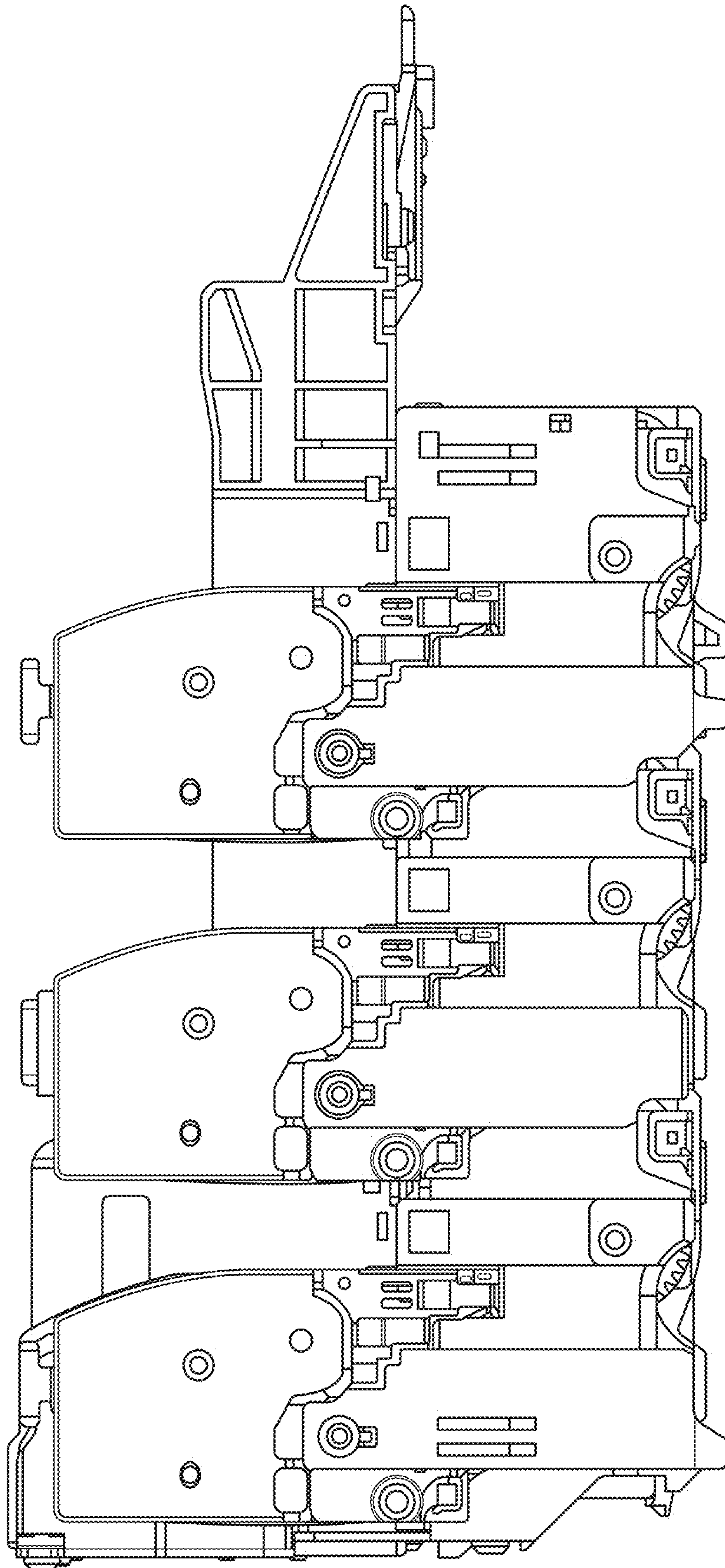

FIG. 4



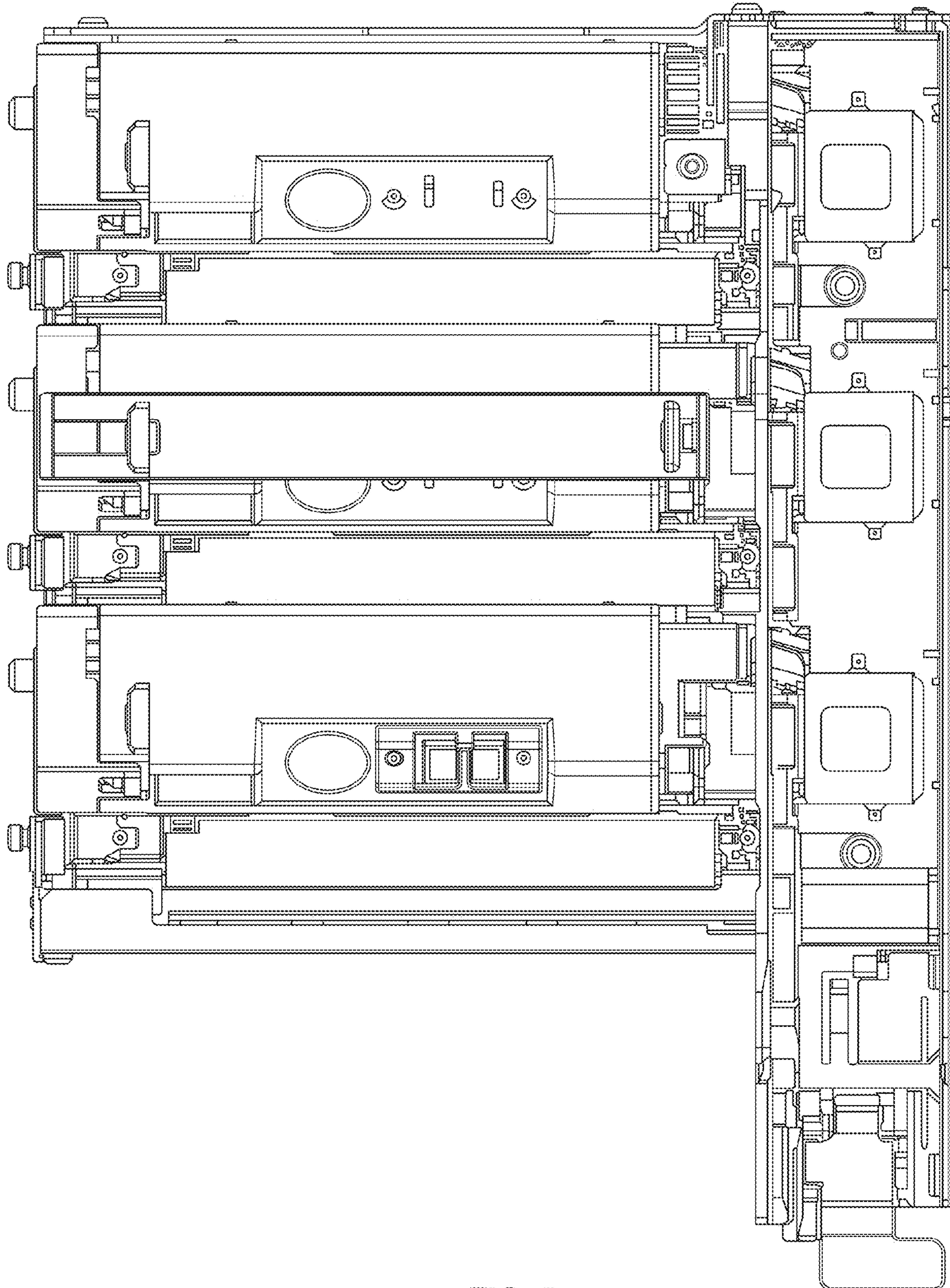

FIG. 5

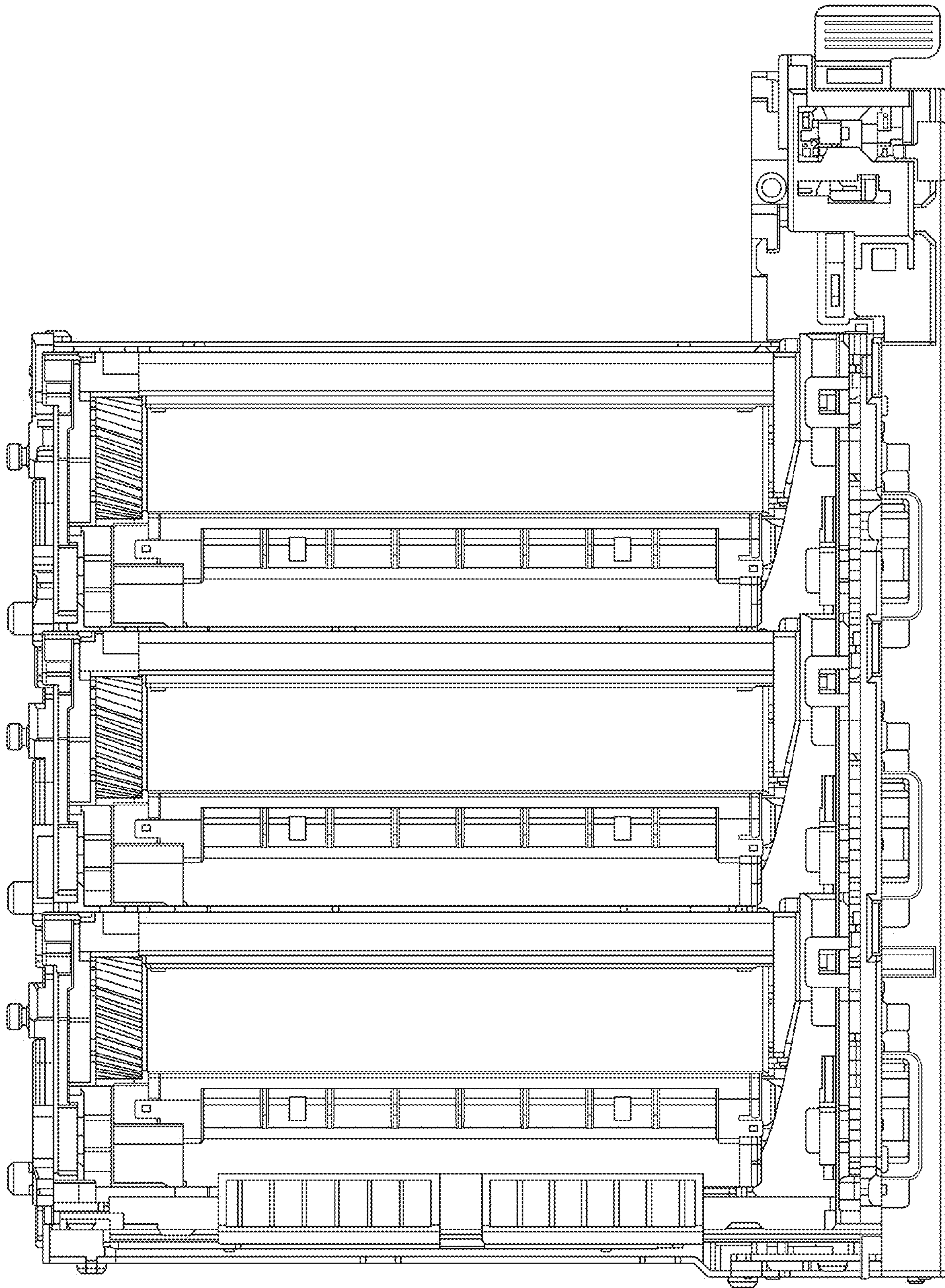

FIG. 6



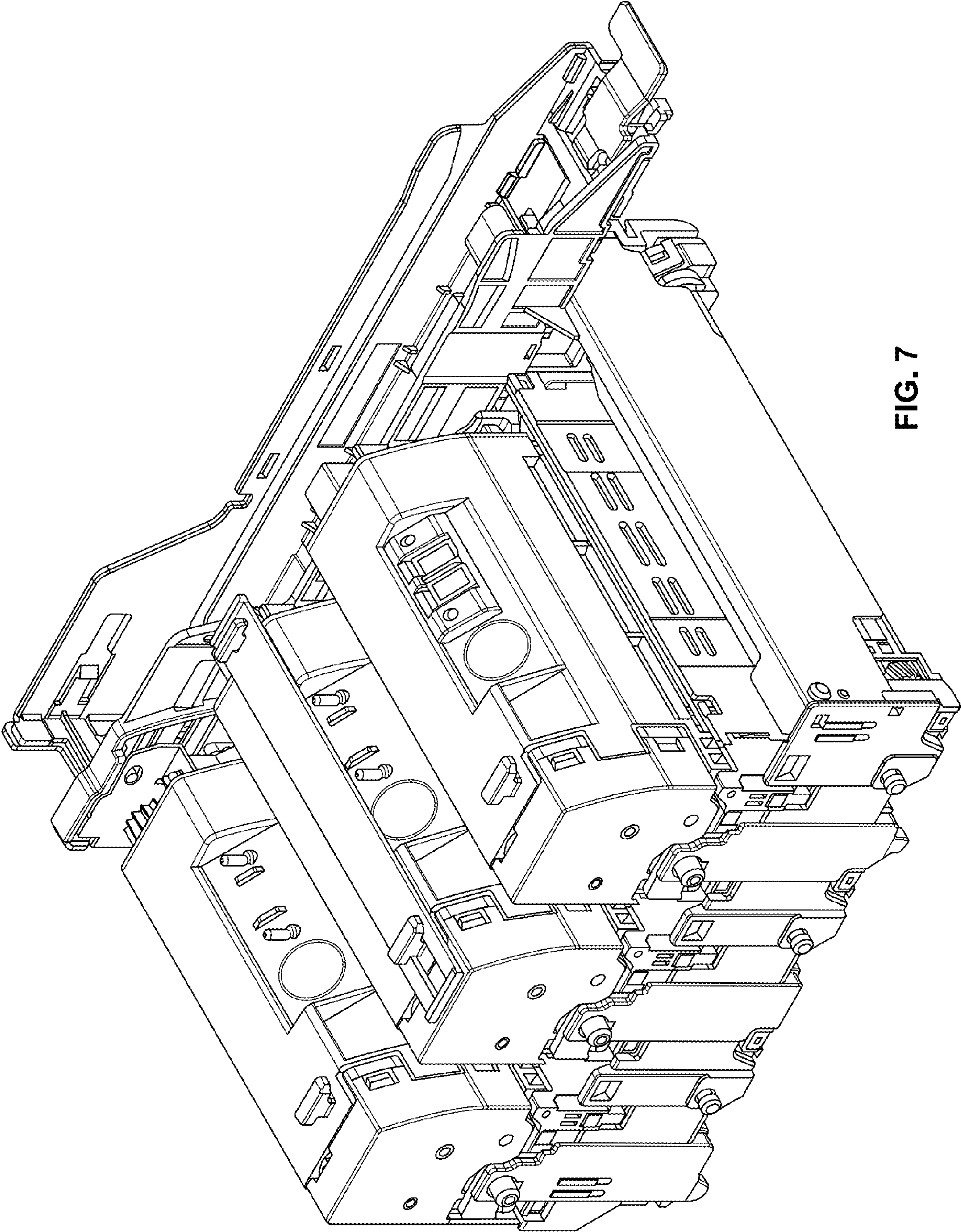

FIG. 7



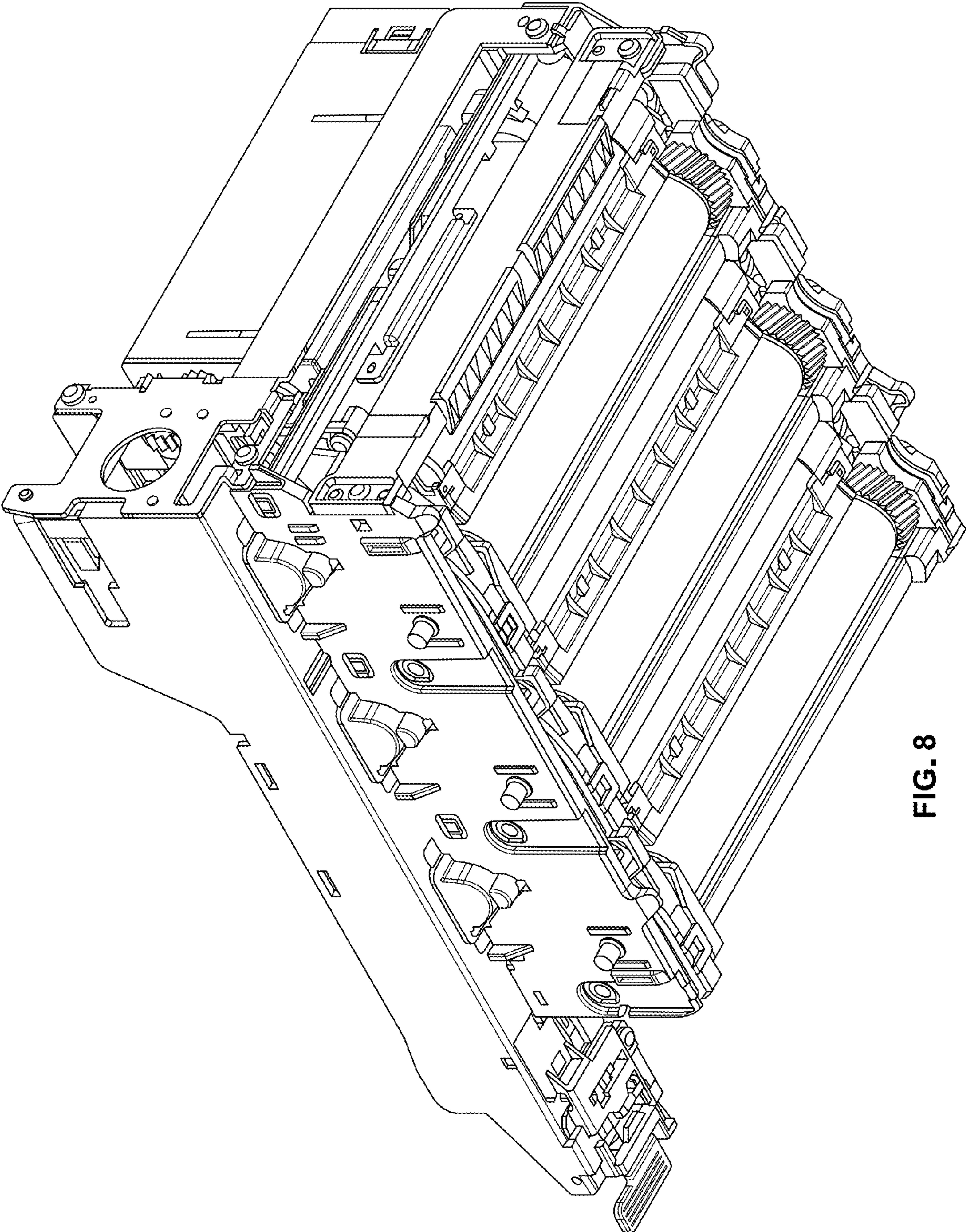

FIG. 8