



US00D910341S

(12) **United States Design Patent** (10) **Patent No.:** **US D910,341 S**
Ye (45) **Date of Patent:** **** Feb. 16, 2021**

(54) **COMPUTER DESK**
(71) Applicant: **XIAMEN PAI SHENG IMP. & EXP. CO., LTD**, Xiamen (CN)
(72) Inventor: **Junyi Ye**, Xiamen (CN)
(**) Term: **15 Years**
(21) Appl. No.: **29/737,209**
(22) Filed: **Jun. 7, 2020**
(51) **LOC (13) Cl.** **06-03**
(52) **U.S. Cl.**
USPC **D6/648**; D6/655.1
(58) **Field of Classification Search**
USPC D6/641, 642, 648, 648.1-648.4, 655, D6/655.1, 656, 656.13, 656.14, 656.16
CPC .. A47B 7/00; A47B 9/00; A47B 13/00; A47B 13/02; A47B 13/04; A47B 13/06; A47B 13/08; A47B 13/10; A47B 13/12; A47B 17/00; A47B 17/003; A47B 17/06; A47B 21/00; A47B 2200/0001; A47B 2200/0002; A47B 2200/001; A47B 2200/0011; A47B 2200/0012; A47B 2200/002; A47B 2200/0066
See application file for complete search history.

D526,812 S 8/2006 Chen
D783,316 S * 4/2017 Davis A47B 17/033 D6/655.1
D798,084 S * 9/2017 Acuff D6/641
D882,300 S 4/2020 Li
D891,823 S * 8/2020 Li D6/648.3

OTHER PUBLICATIONS

L-Shaped Home Office Desk with Open Shelving, Gerdanet Collection by Signature Design by Ashley—Value City Furniture <https://www.valuecitynj.com/item/gerdanet-l-shaped-desk/243276320> retrieved from the internet on Sep. 29, 2020.*
Left Hand Side Assembly of HSH L Shaped Computer Desk—Amazon.com, First available on Oct. 22, 2019 https://www.amazon.com/HSH-Computer-Industrial-Writing-Workstation/dp/B07ZF2GX8M/ref=sr_1_6?dchild=1&keywords=hsh+l+computer+desk&qid=1589439726&sr=8-6 retrieved from the internet on Sep. 29, 2020.*

(Continued)

Primary Examiner — Mary Ann Calabrese
(74) *Attorney, Agent, or Firm* — Rumit Ranjit Kanakia

(57) **CLAIM**

I claim the ornamental design for a computer desk, as shown and described.

DESCRIPTION

FIG. 1 is a Perspective view of a computer desk showing my new design;
FIG. 2 is a Front view thereof;
FIG. 3 is a Back view thereof;
FIG. 4 is a Right-side view thereof;
FIG. 5 is a Left-side view thereof;
FIG. 6 is a Top view thereof; and,
FIG. 7 is a Bottom view thereof.
The broken lines shown in the drawings illustrates portions of the computer desk that form no part of the claimed design.

(56) **References Cited**
U.S. PATENT DOCUMENTS

D169,375 S *	4/1953	Knoll	D6/648
D208,412 S *	8/1967	Bonk et al.	D6/642
D258,787 S *	4/1981	Verdesca	D6/652
D265,783 S *	8/1982	Fusselman	D6/648
D270,025 S *	8/1983	Koves	D6/652
D270,690 S *	9/1983	Daventry	D6/648
D275,349 S *	9/1984	Thompson	D6/648
4,555,150 A *	11/1985	Turnbull	A47B 17/033 312/195
D469,269 S	1/2003	Tzeng		
D495,525 S	9/2004	Chang		

1 Claim, 6 Drawing Sheets

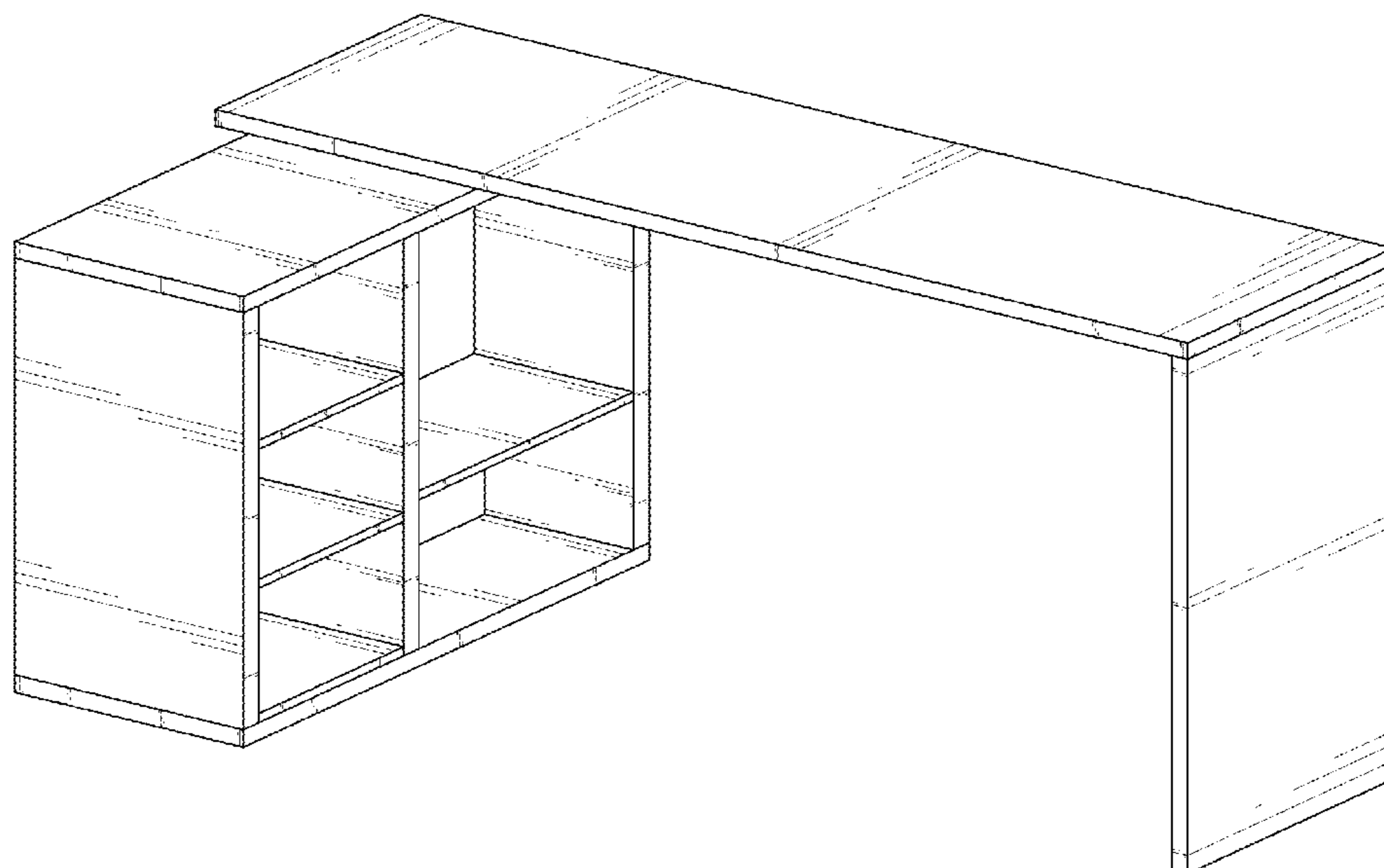

(56)

References Cited

OTHER PUBLICATIONS

HSH L Shaped Computer Desk, Rustic Wood Corner Desk, Industrial Writing Workstation Table with Cabinet Drawer Storage for Home Office Study, Grey 55 inch, https://www.amazon.com/HSH-Computer-Industrial-Writing-Workstation/dp/B07ZF2GX8M/ref=sr_1_6?dchild=1&keywords=hsh+l+computer+desk&qid=1589439726&sr=8-6, Dec. 16, 2019.

Reis Reversible Desk, <https://www.wayfair.com/furniture/pdp/gracie-oaks-reis-reversible-desk-w002805935.html>, Dec. 16, 2019.

* cited by examiner

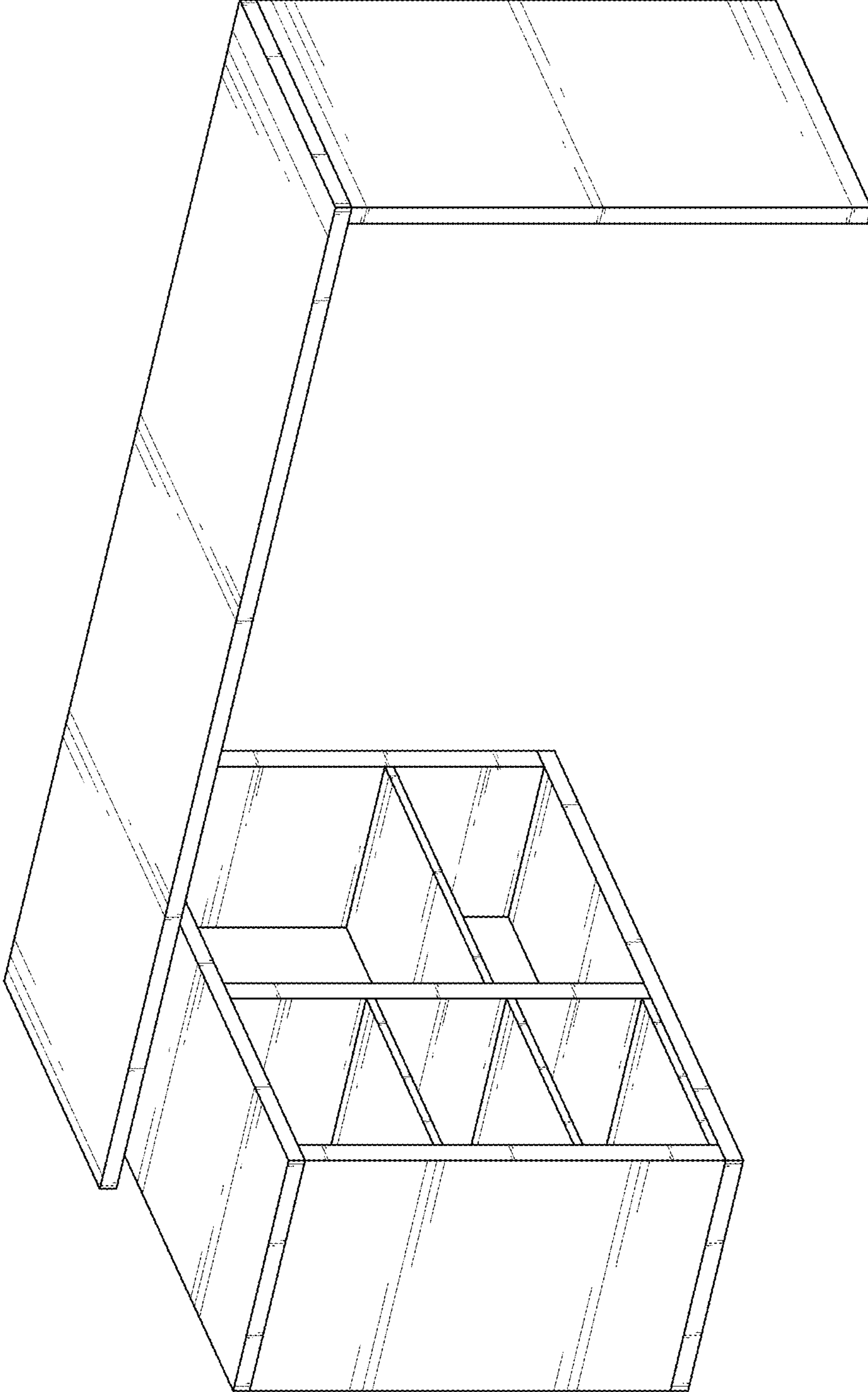

FIG. 1

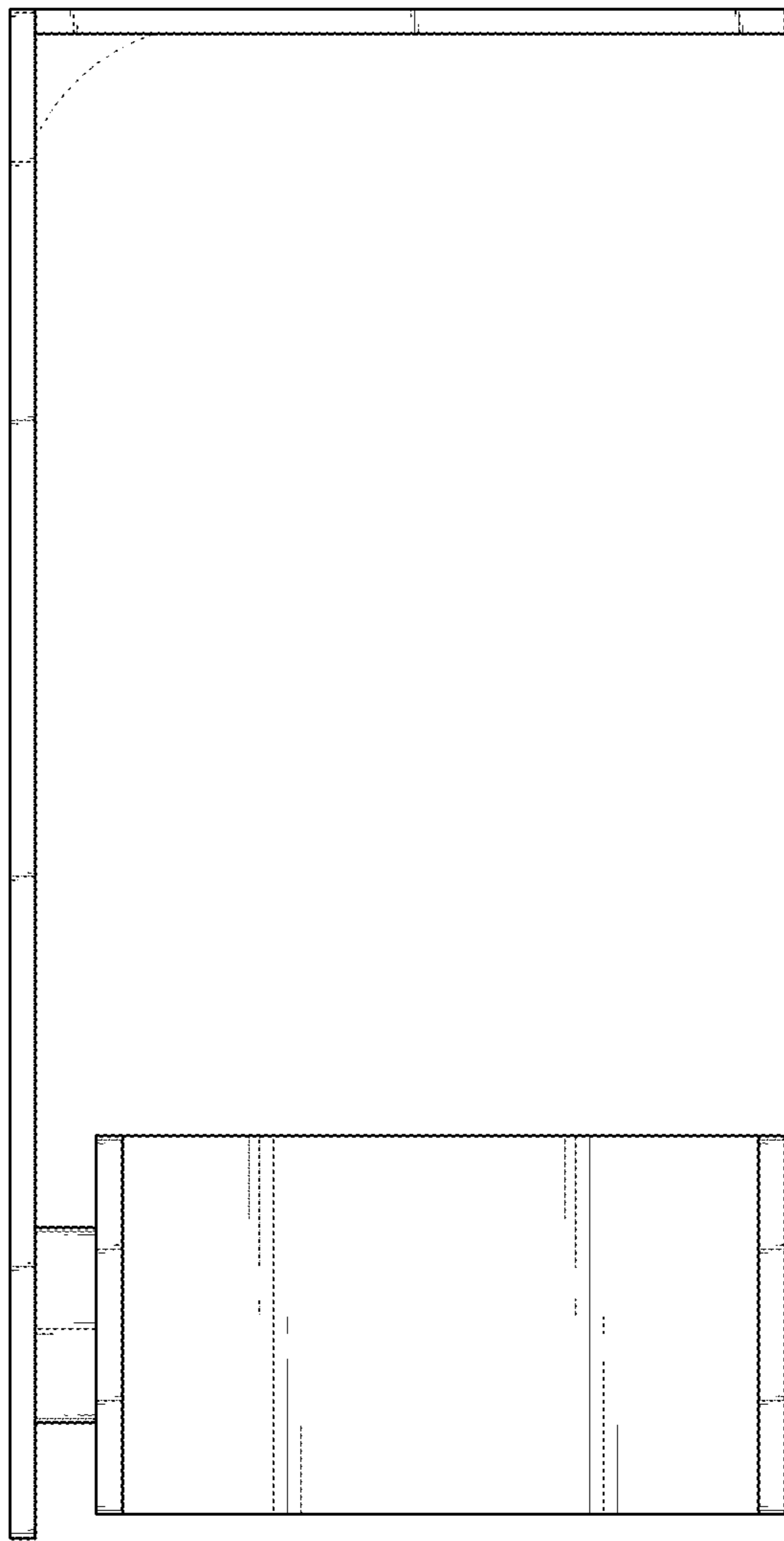

FIG. 2

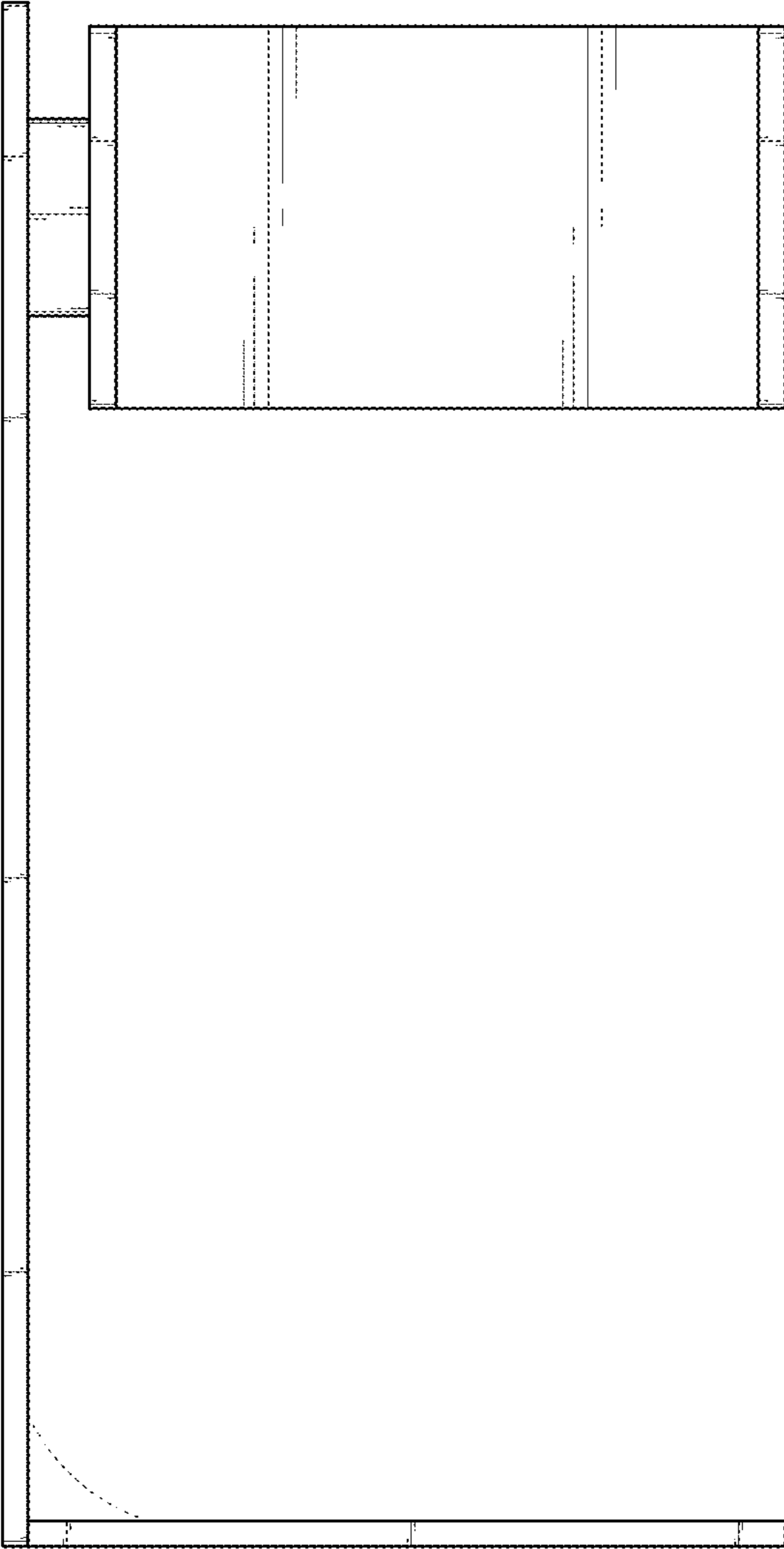

FIG. 3

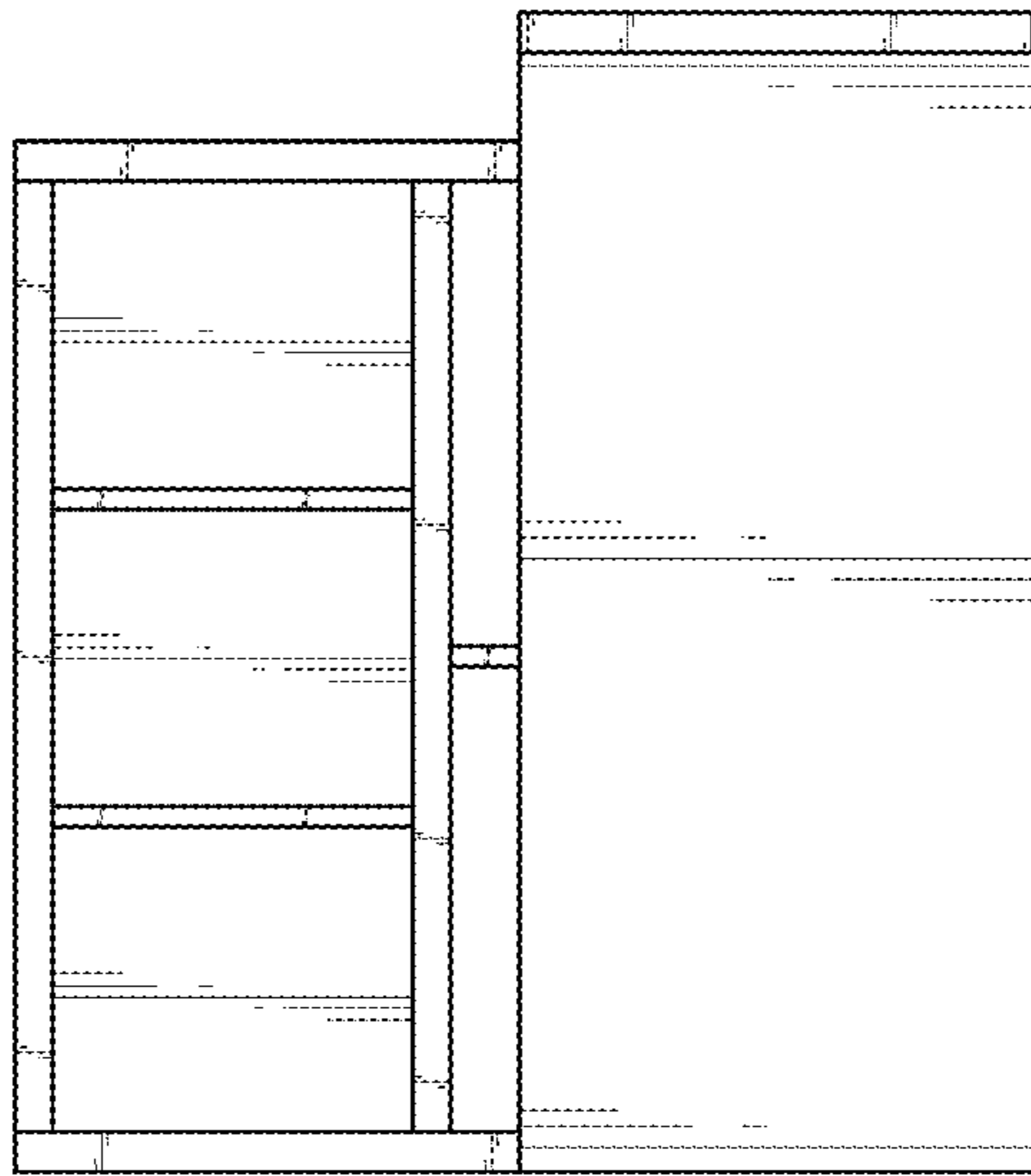

FIG. 4

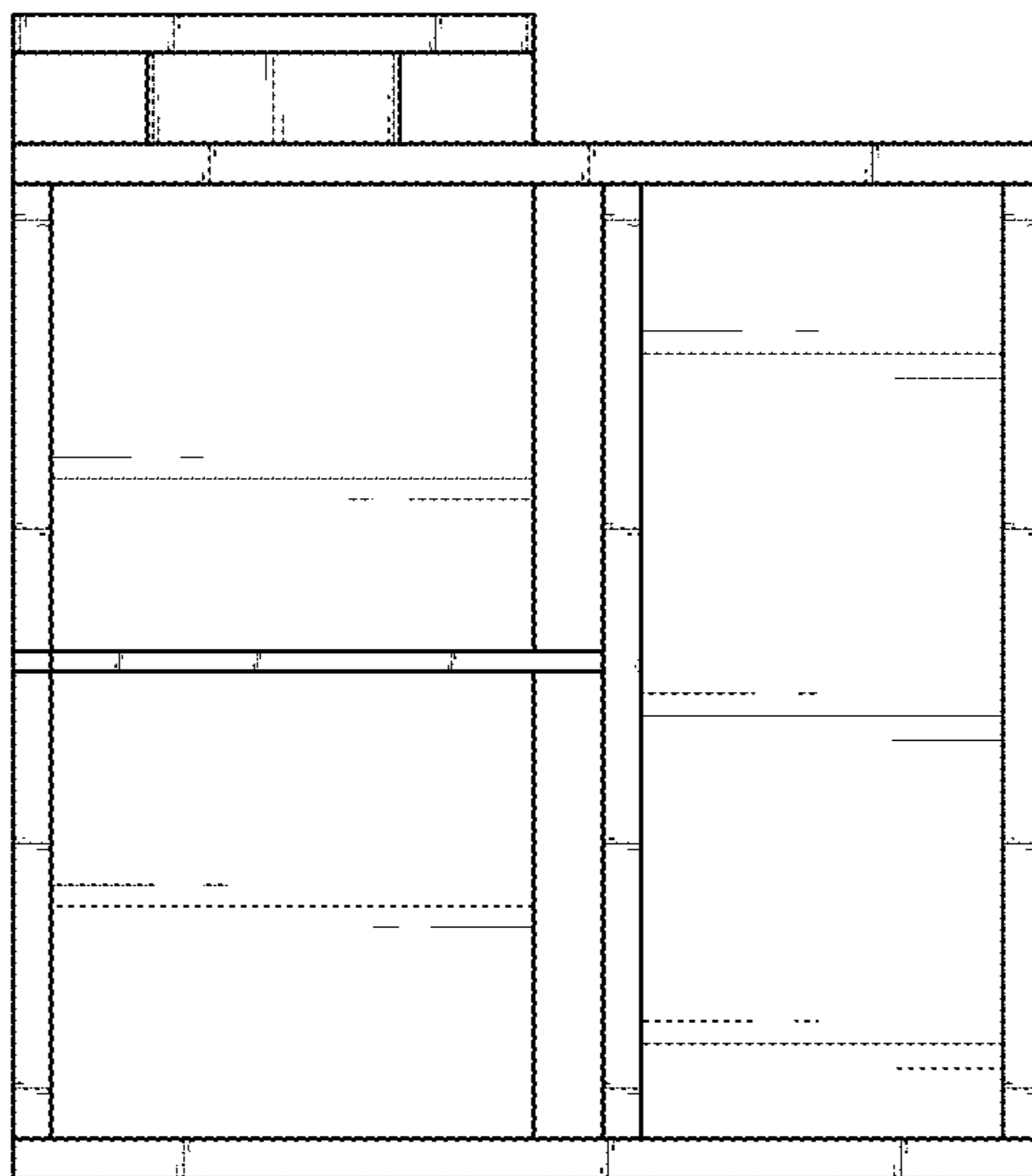

FIG. 5

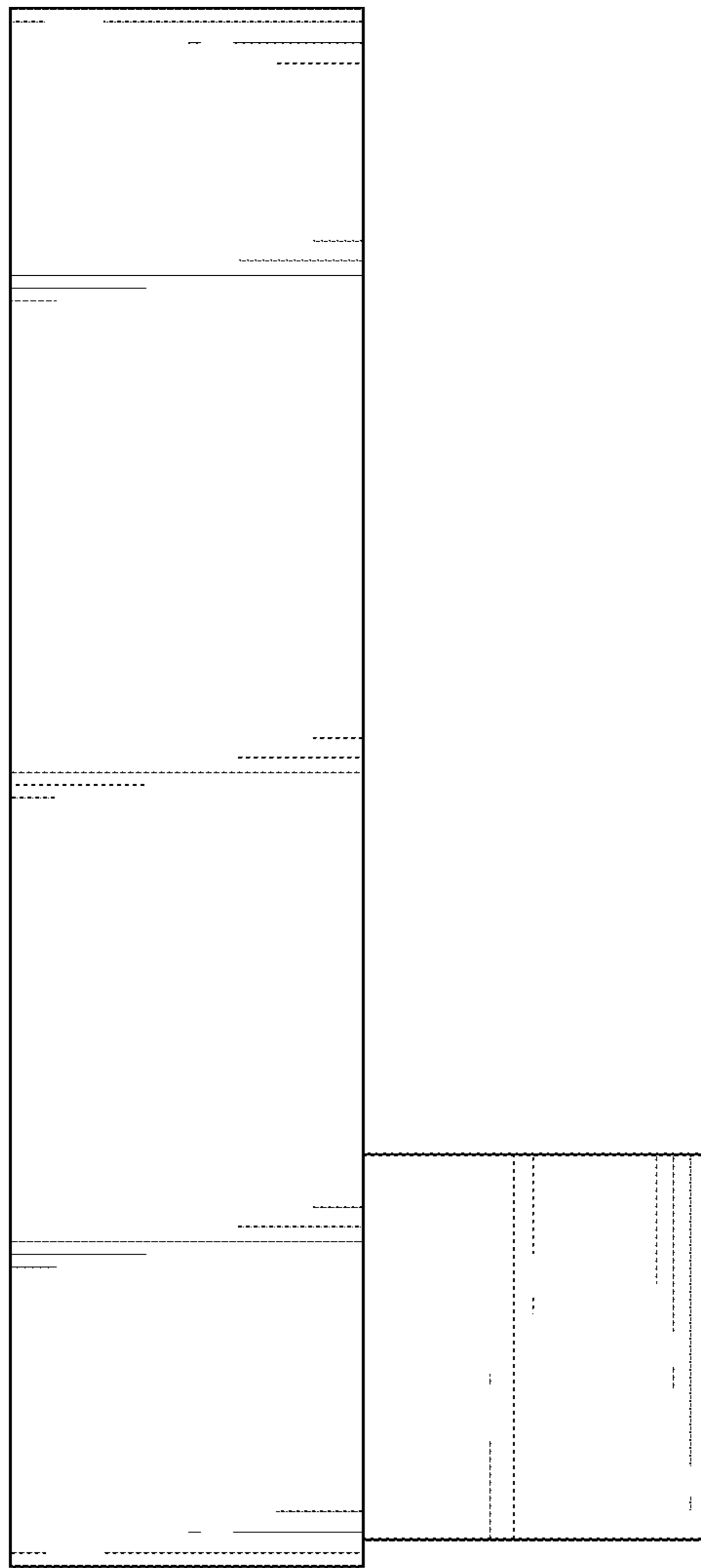

FIG. 6

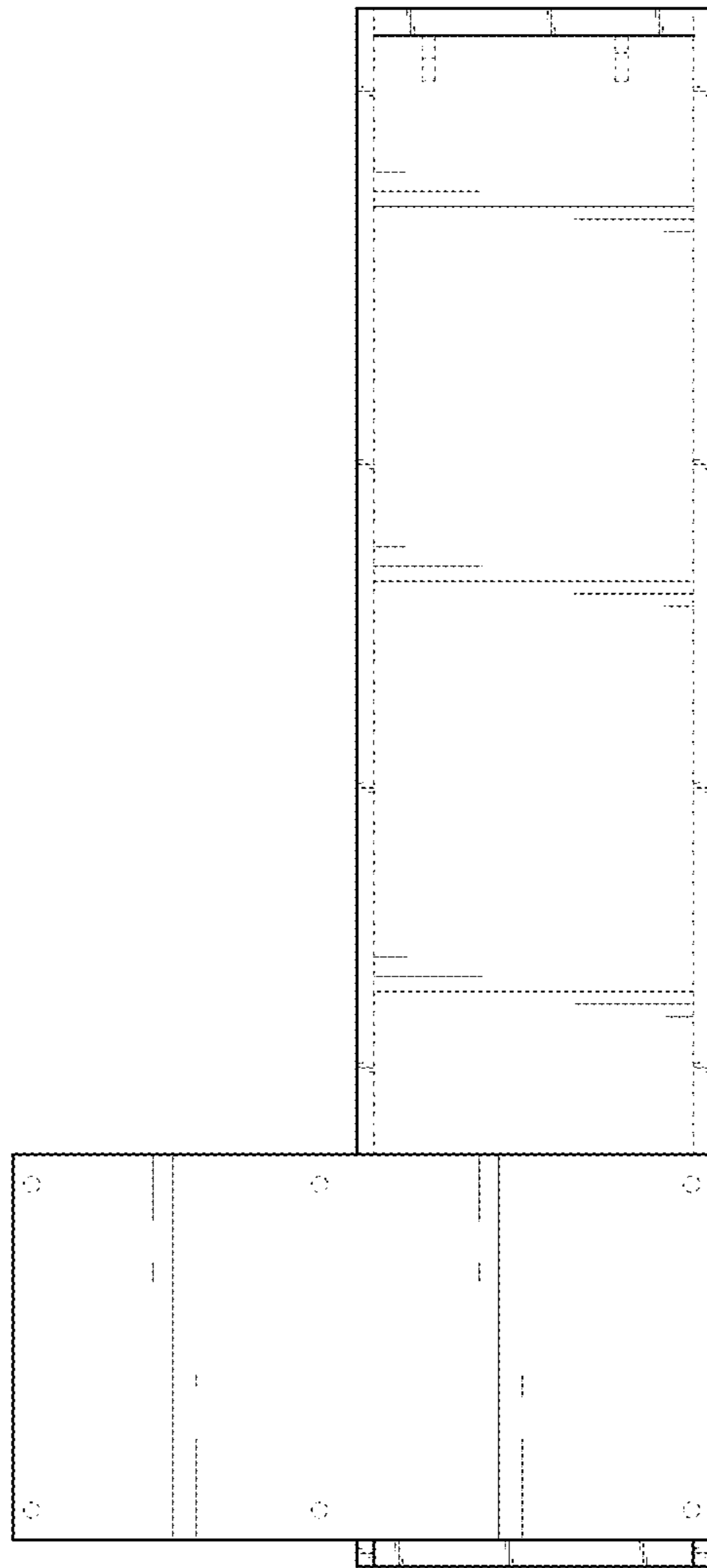

FIG. 7