



US00D909453S

(12) **United States Design Patent**  
**Yoshida**

(10) **Patent No.:** **US D909,453 S**

(45) **Date of Patent:** **\*\* Feb. 2, 2021**

(54) **PROJECTOR**

(71) Applicant: **FUJIFILM Corporation**, Tokyo (JP)

(72) Inventor: **Koji Yoshida**, Saitama (JP)

(73) Assignee: **FUJIFILM Corporation**, Tokyo (JP)

(\*\*) Term: **15 Years**

(21) Appl. No.: **29/697,312**

(22) Filed: **Jul. 8, 2019**

(30) **Foreign Application Priority Data**

Feb. 5, 2019 (JP) ..... 2019-002244

(51) **LOC (13) Cl.** ..... **16-02**

(52) **U.S. Cl.**  
USPC ..... **D16/235**

(58) **Field of Classification Search**  
USPC ..... D16/221, 222, 225, 235, 237, 242, 245,  
D16/136; D8/373, 349, 370, 380;  
248/126-127, 917, 919, 346.01; 396/420,  
396/422; D14/224  
CPC ..... F16M 11/00; F16M 11/04; F16M 11/041;  
F16M 11/10; F16M 11/18; G03B 21/54  
See application file for complete search history.

(56) **References Cited**

**U.S. PATENT DOCUMENTS**

D150,044 S \* 6/1948 Wolfe ..... D16/221  
D218,071 S \* 7/1970 Armbruster ..... D16/221  
D233,856 S \* 12/1974 Kira ..... D16/221  
D257,388 S \* 10/1980 Jordan ..... D16/221  
D276,165 S \* 10/1984 Spilman ..... D16/221  
D298,011 S \* 10/1988 Jans ..... D8/349  
D468,335 S \* 1/2003 Goto ..... D16/221

D543,229 S \* 5/2007 Hochendoner ..... D16/235  
D574,407 S \* 8/2008 Dittmer ..... D16/235  
2008/0179475 A1\* 7/2008 Whitley ..... F16M 11/18  
248/218.4  
2015/0286117 A1\* 10/2015 Sung ..... F16M 11/041  
224/191

\* cited by examiner

*Primary Examiner* — Wan Laymon

(74) *Attorney, Agent, or Firm* — Studebaker & Brackett  
PC

(57) **CLAIM**

The ornamental design for a projector, as shown and described.

**DESCRIPTION**

FIG. 1 is a top and left perspective view of a projector whose stand legs are closed, showing my new design;  
FIG. 2 is a front view thereof;  
FIG. 3 is a rear view thereof;  
FIG. 4 is a top plan view thereof;  
FIG. 5 is a bottom plan view thereof;  
FIG. 6 is a right side view thereof;  
FIG. 7 is a left side view thereof;  
FIG. 8 is a top and left perspective view of a projector whose stand legs are opened, showing my new design; and,  
FIG. 9 is an enlarged perspective view indicating condition that two stands are joined back to back.  
The broken lines illustrate portions of the projector and form no part of the claimed design. The design of the projector has legs which transition from the closed condition to the open condition and vice versa, wherein the transition forms no part of the claimed design.

**1 Claim, 8 Drawing Sheets**

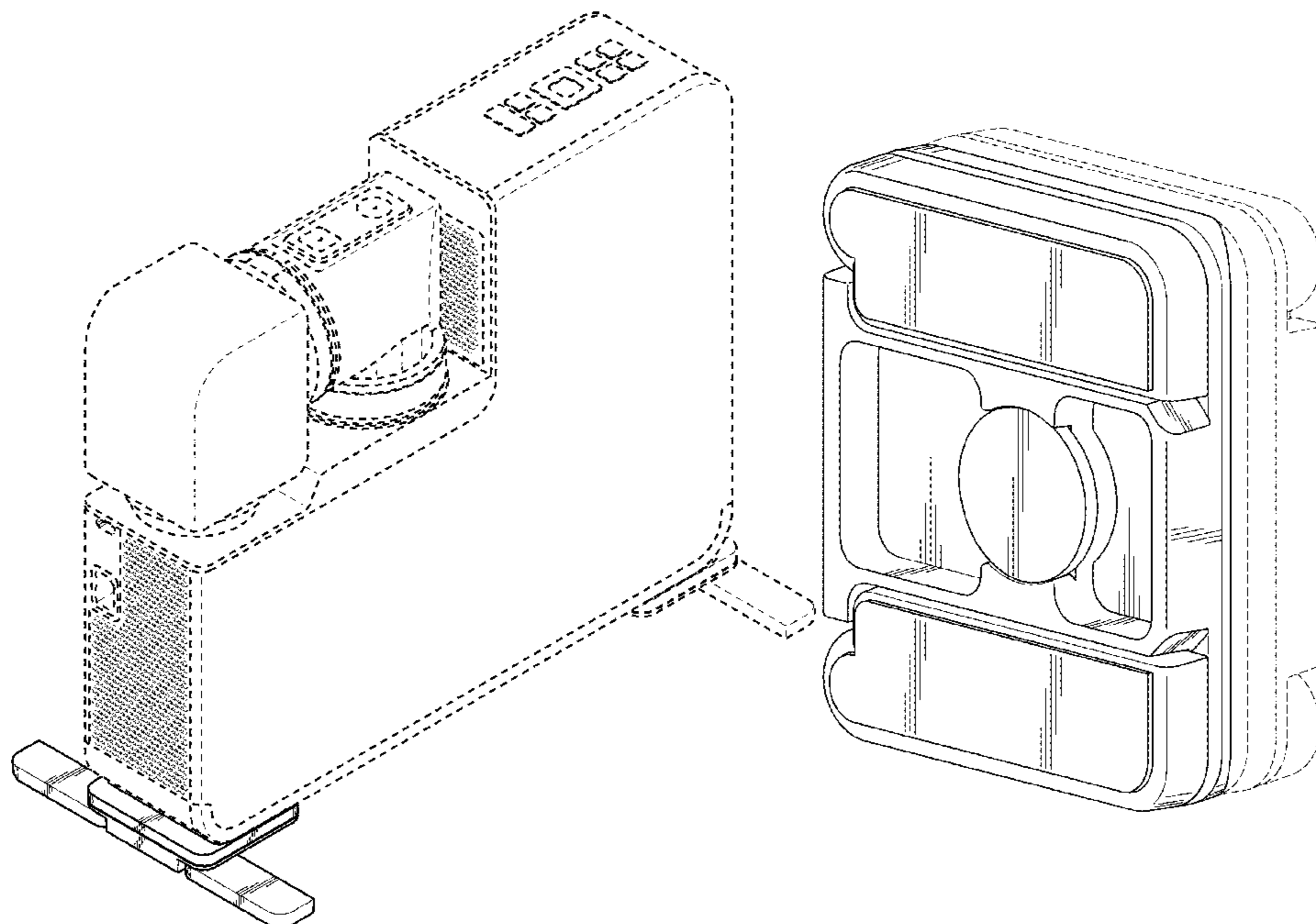

FIG. 1

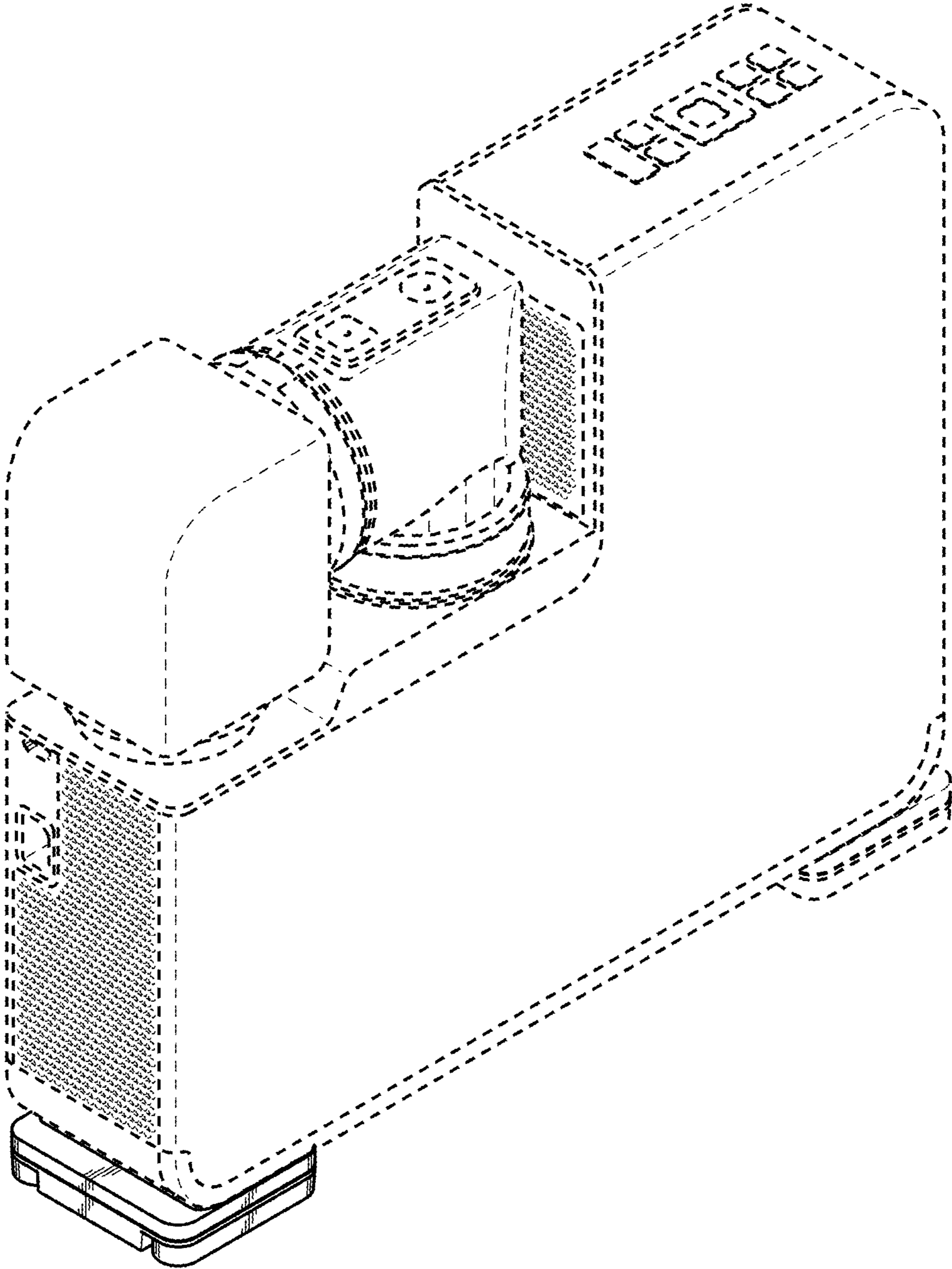

FIG. 2

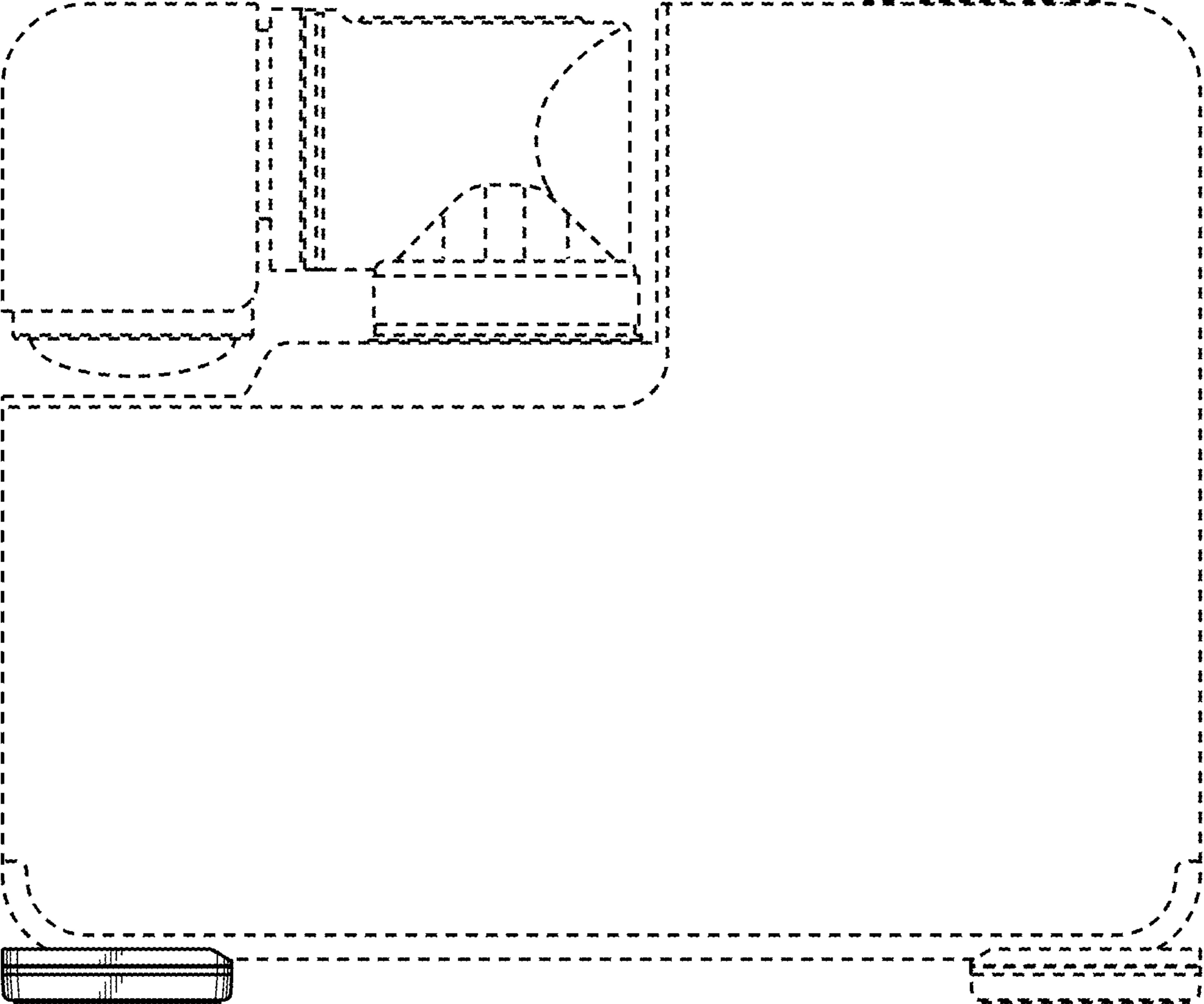
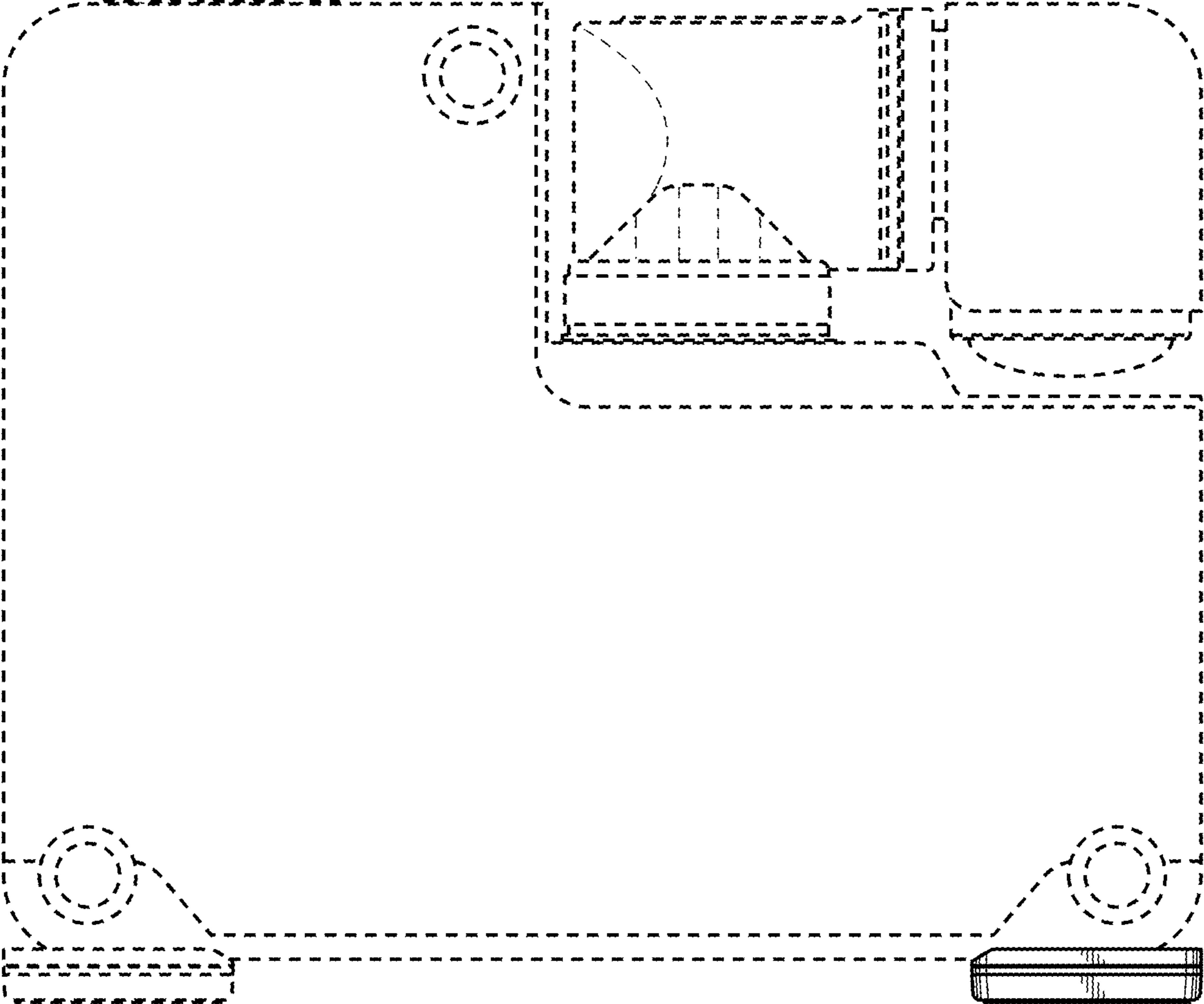
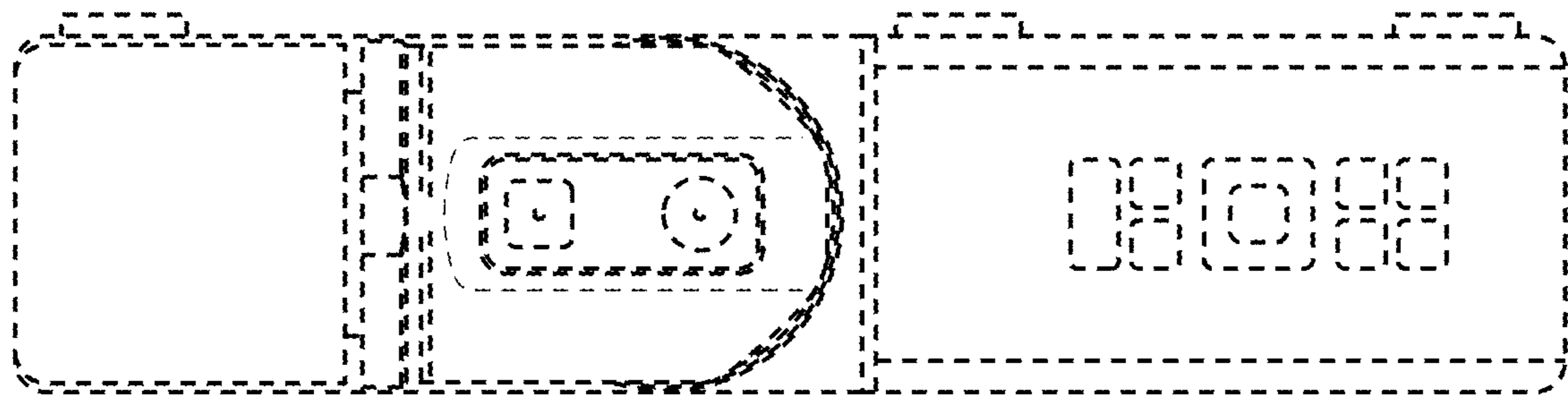

FIG. 3



**FIG. 4**



**FIG. 5**



**FIG. 6**

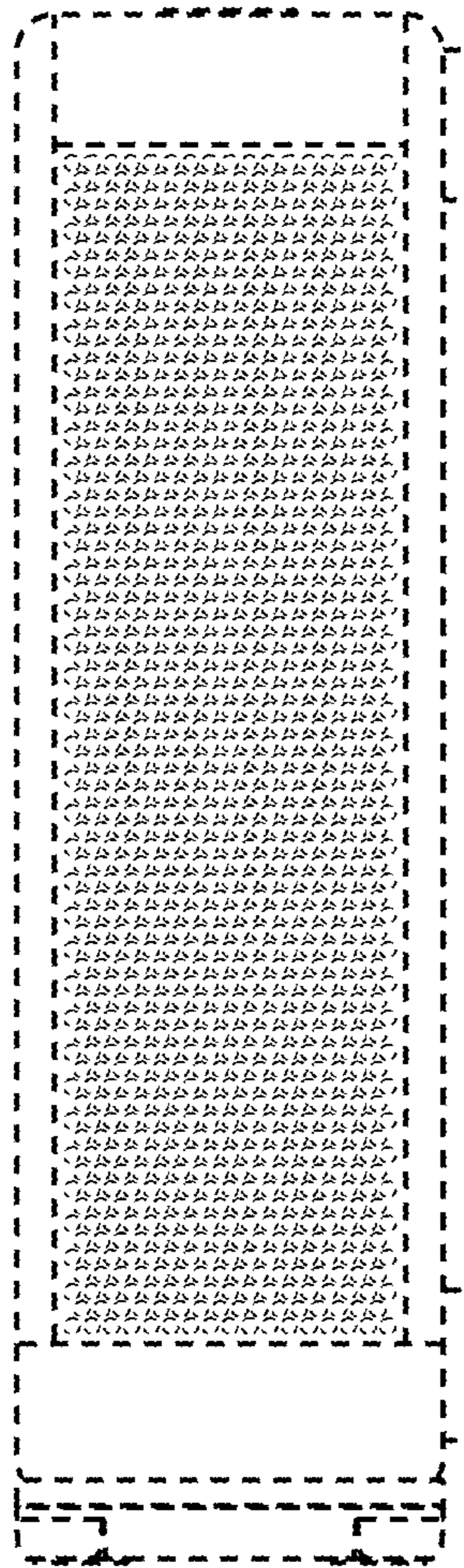

**FIG. 7**

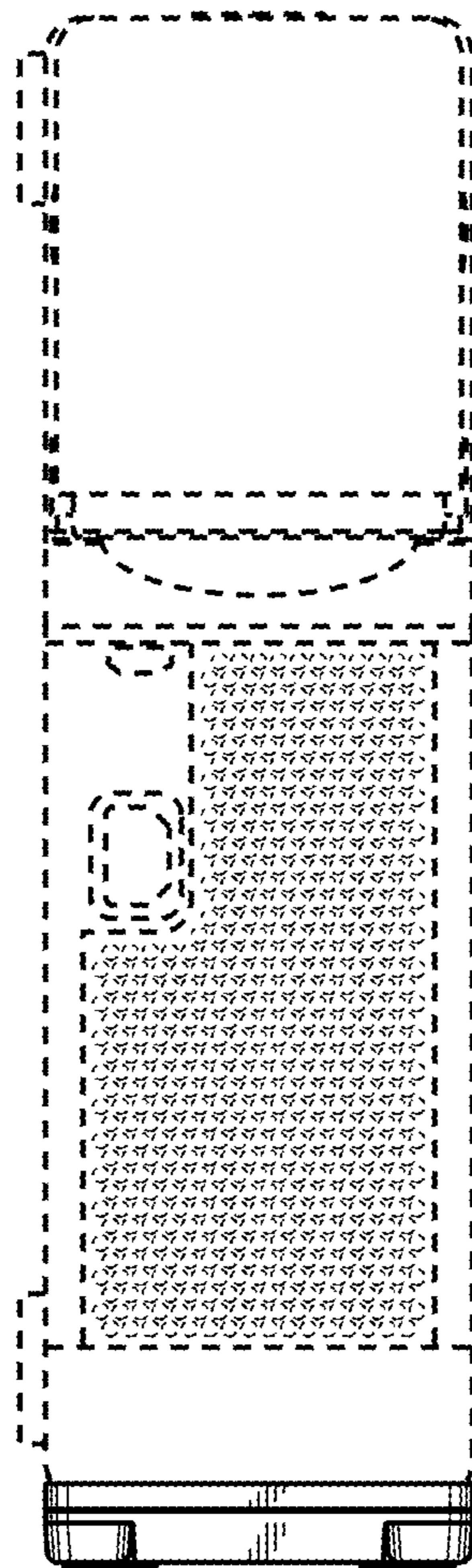
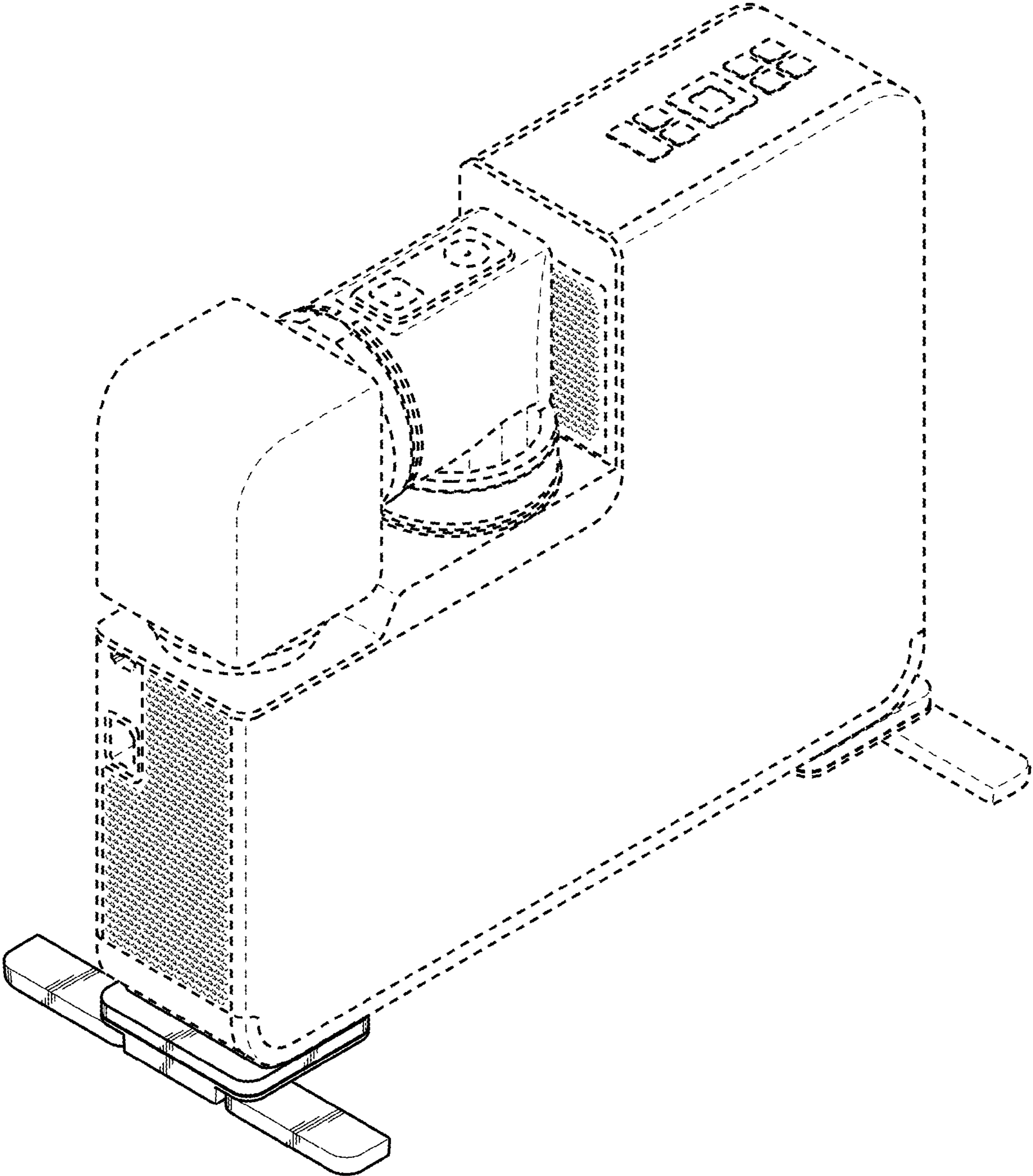

FIG. 8





**FIG. 9**

