

US00D909314S

(12) **United States Design Patent** (10) **Patent No.:** **US D909,314 S**  
**Ryan et al.** (45) **Date of Patent:** **\*\* \*Feb. 2, 2021**

(54) **REMOTE CONTROL HOUSING**  
(71) Applicant: **Universal Electronics Inc.**, Santa Ana, CA (US)  
(72) Inventors: **Brian Ryan**, Darlington (GB); **Richard Remmes**, Santa Ana, CA (US); **Alex Lai**, Ma On Shan (HK)  
(73) Assignee: **Universal Electronics Inc.**, Santa Ana, CA (US)  
(\* ) Notice: This patent is subject to a terminal disclaimer.  
(\*\*) Term: **15 Years**  
(21) Appl. No.: **29/659,972**  
(22) Filed: **Aug. 14, 2018**

9,155,210	B2	10/2015	Hwang	
D774,493	S	12/2016	Wong et al.	
D785,602	S	5/2017	Park et al.	
9,703,330	B2	7/2017	Johnson et al.	
D825,494	S *	8/2018	Ryan .....	D13/168
2010/0062323	A1	3/2010	Dong et al.	
2010/0102576	A1	4/2010	Zhang	
2013/0165190	A1	6/2013	Ko et al.	
2013/0328461	A1	12/2013	Chung et al.	
2014/0016996	A1	1/2014	Chung et al.	
2015/0061475	A1	3/2015	Fairchild	
2015/0156903	A1	6/2015	Heimerl	
2015/0228420	A1	8/2015	McDaniel et al.	
2015/0277487	A1	10/2015	Gerst et al.	
2015/0289398	A1	10/2015	Takase	
2016/0120047	A1	4/2016	Chang	
2017/0170446	A1	6/2017	Tompkins	
2017/0263114	A1	9/2017	Yoon	

\* cited by examiner

*Primary Examiner* — Selina Sikder  
(74) *Attorney, Agent, or Firm* — Greenberg Traurig, LLP

**Related U.S. Application Data**

(63) Continuation of application No. 29/582,446, filed on Oct. 27, 2016, now Pat. No. Des. 825,494.  
(51) **LOC (13) Cl.** ..... **14-03**  
(52) **U.S. Cl.**  
USPC ..... **D13/168; D14/218**  
(58) **Field of Classification Search**  
USPC ..... D13/168; D14/218  
CPC ..... H05K 5/0217; H05K 5/0221; H05K 5/03; H01H 9/0235; H01H 9/0242; H04B 1/202; G08C 17/00; G08C 17/02; G08C 19/28; G08C 23/04; H04N 21/4221; H04N 21/42204; H04N 5/44582  
See application file for complete search history.

(57) **CLAIM**

The ornamental design for a remote control housing, as shown and described.

**DESCRIPTION**

FIG. 1 is a top perspective view of a remote control housing showing my new design;  
FIG. 2 is a bottom perspective view thereof;  
FIG. 3 is a top plan view thereof;  
FIG. 4 is a bottom view thereof;  
FIG. 5 is a right side elevational view thereof;  
FIG. 6 is a left side elevational view thereof;  
FIG. 7 is front side elevational view thereof; and,  
FIG. 8 is a rear side elevational view thereof.  
The broken lines illustrate portions of the remote control housing that form no part of the claimed design.

(56) **References Cited**  
U.S. PATENT DOCUMENTS

D533,165 S 12/2006 Knight et al.  
D601,976 S 10/2009 Petrillo et al.

**1 Claim, 8 Drawing Sheets**

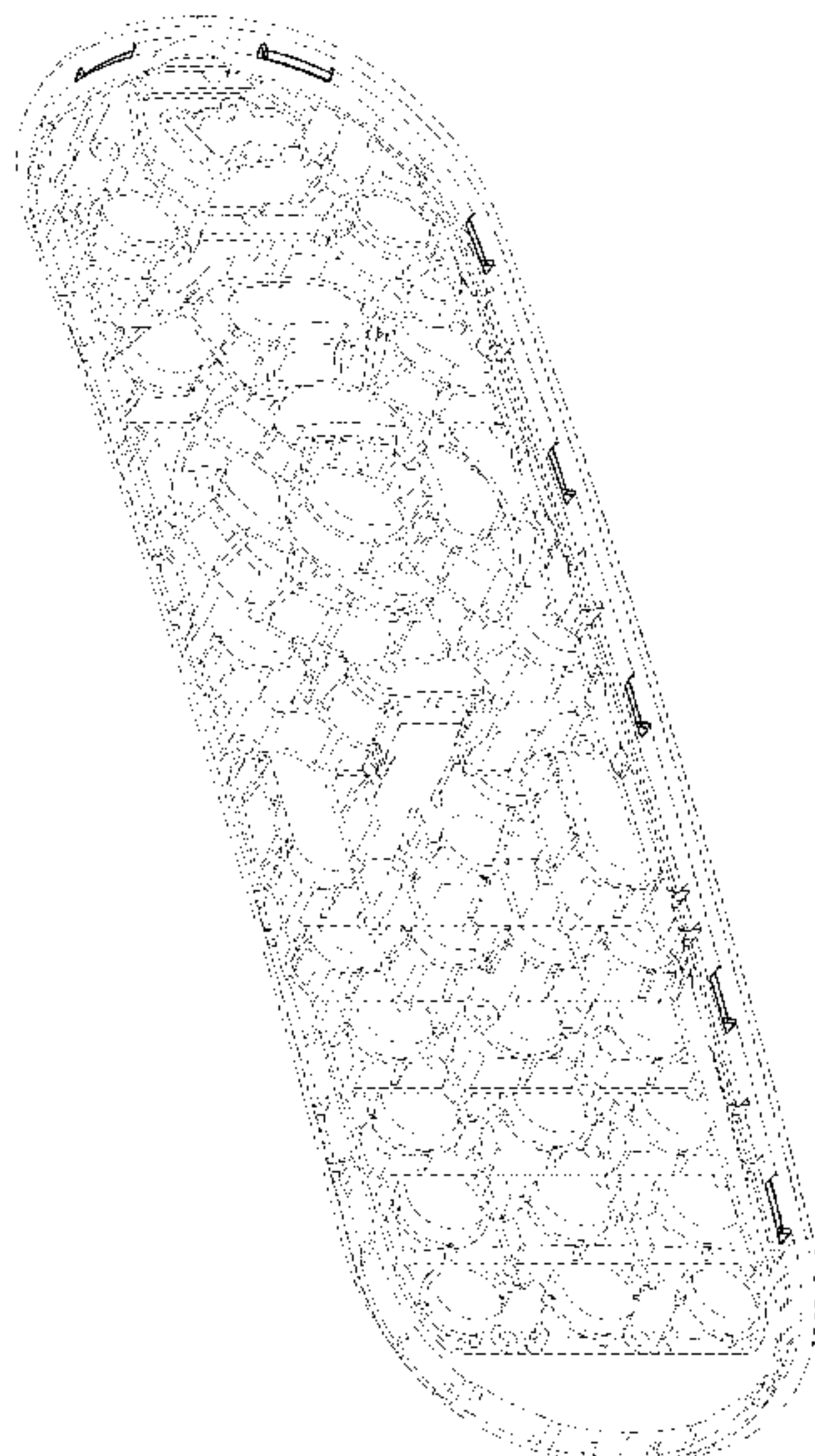

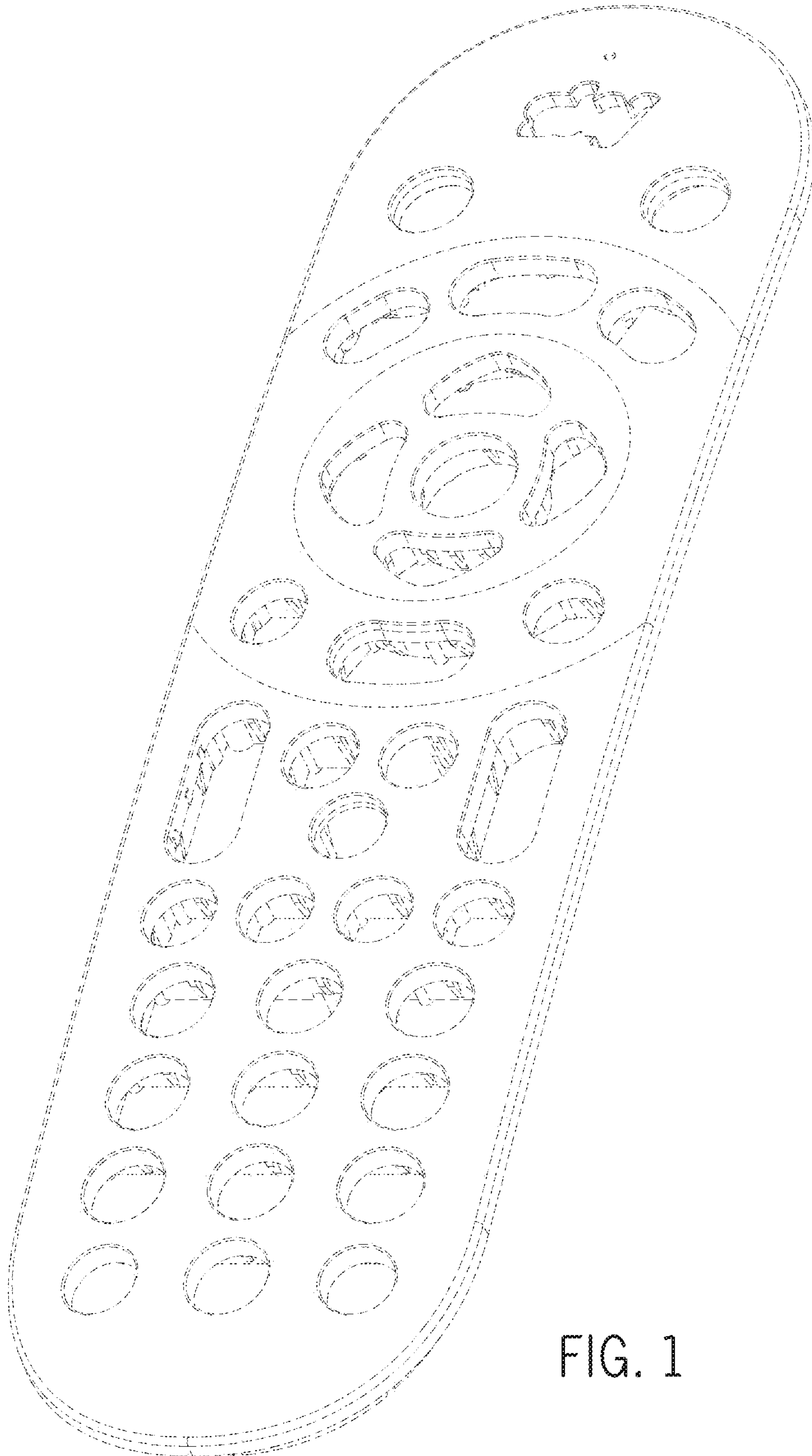

FIG. 1



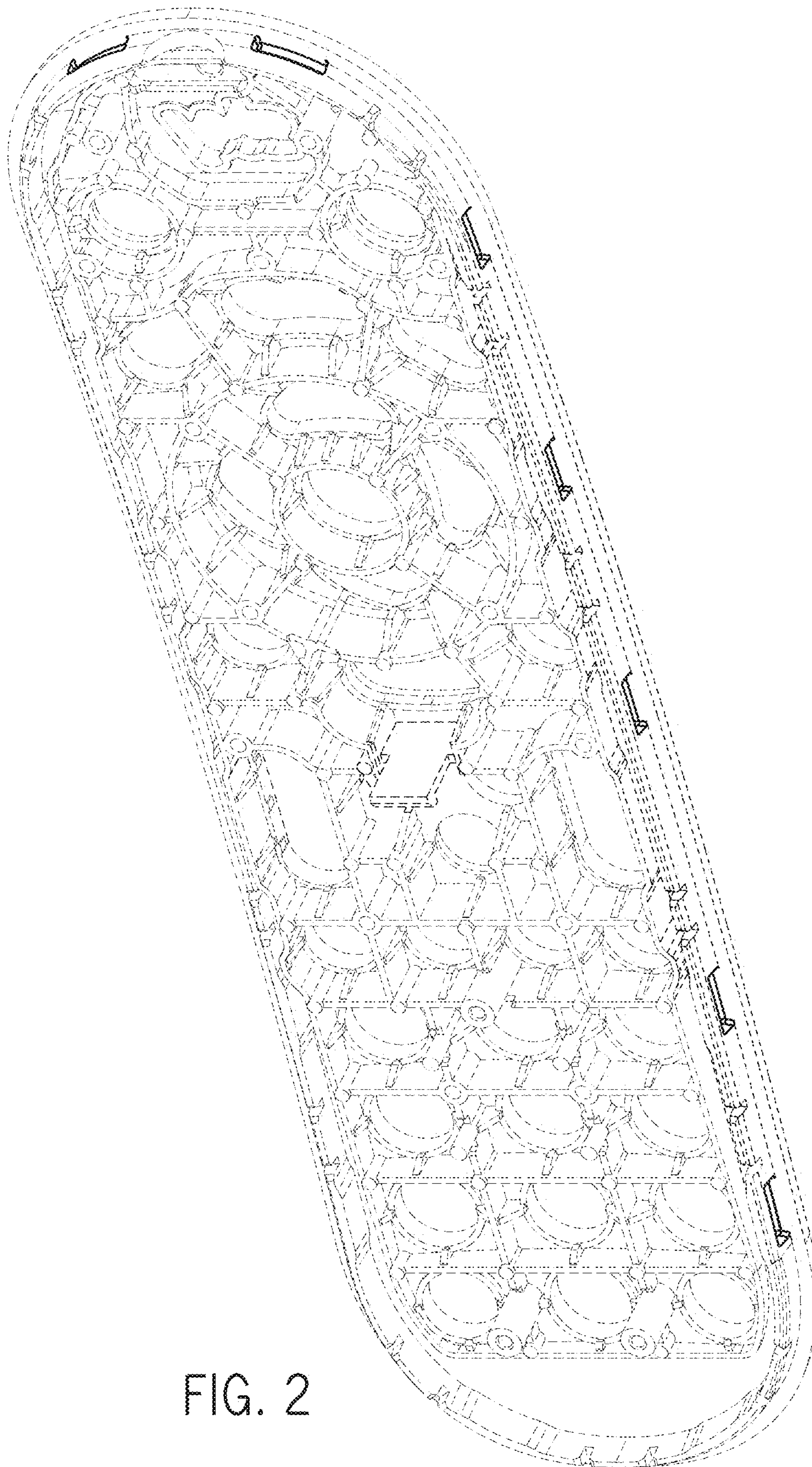

FIG. 2

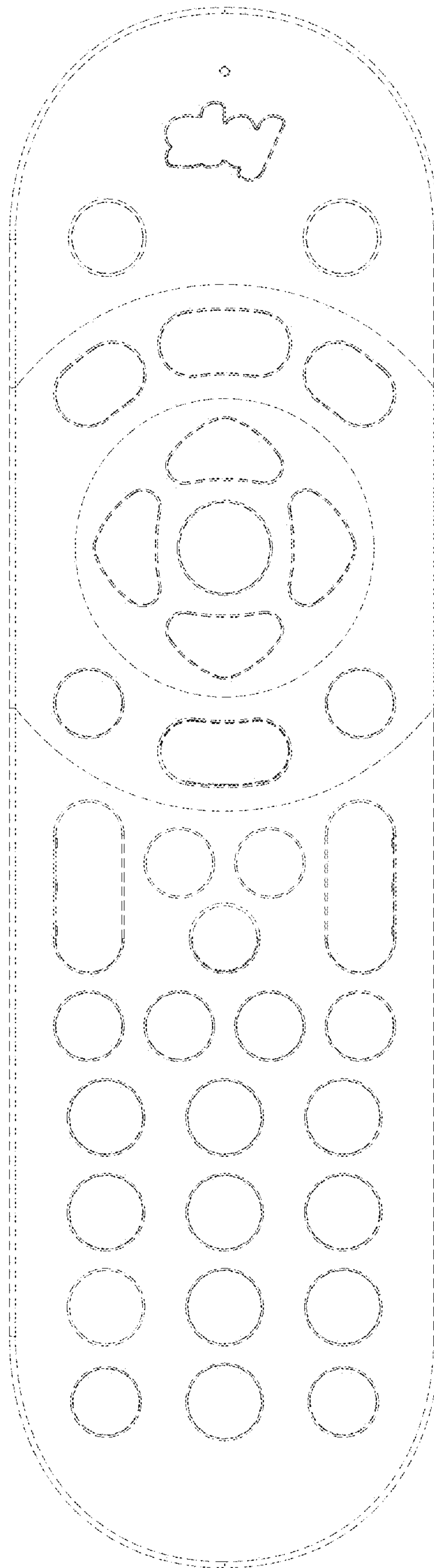

FIG. 3

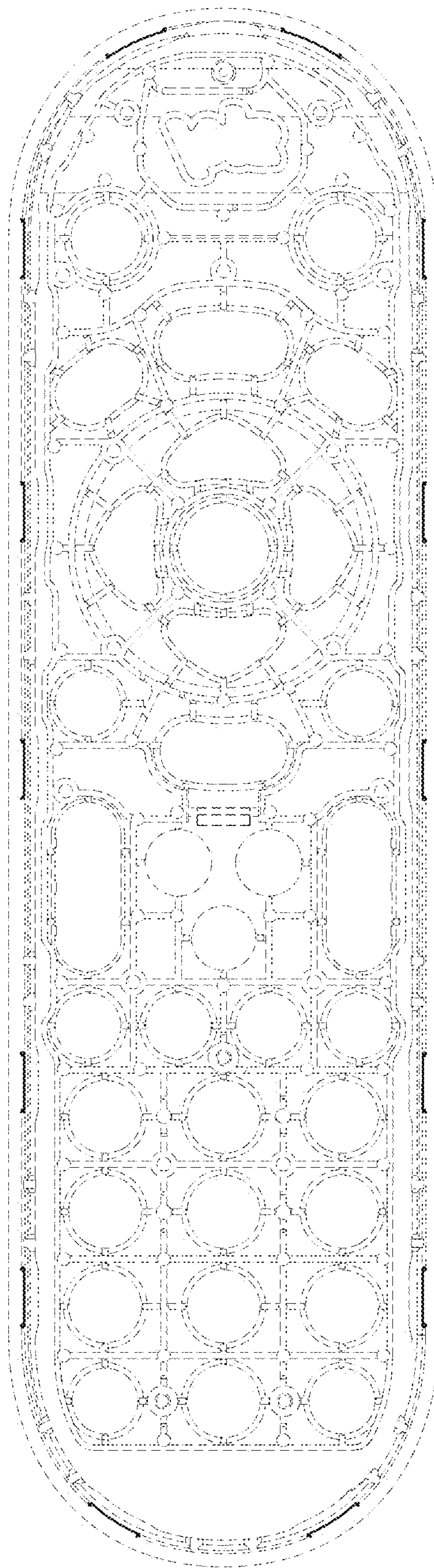

FIG. 4

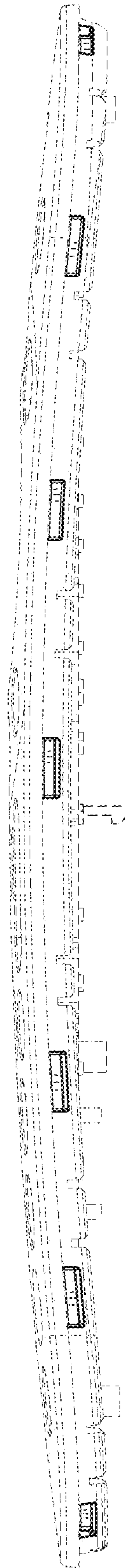

FIG. 5



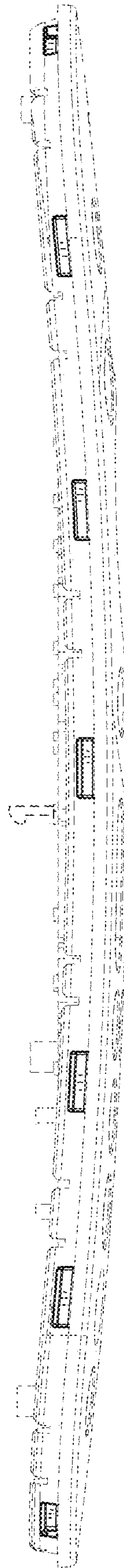

FIG. 6

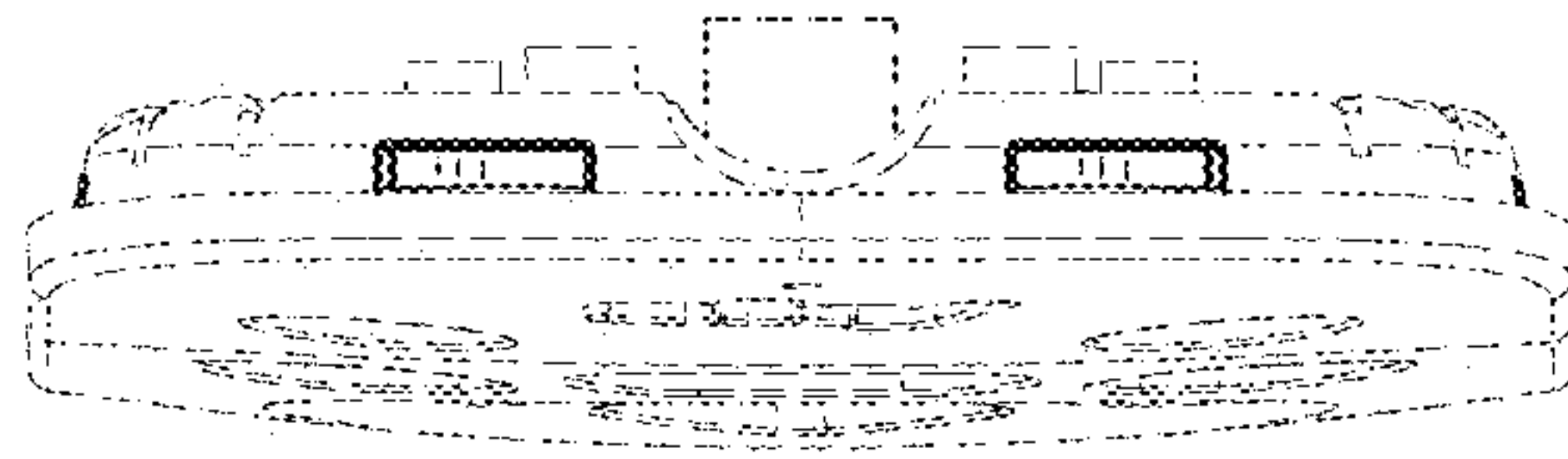

FIG. 7



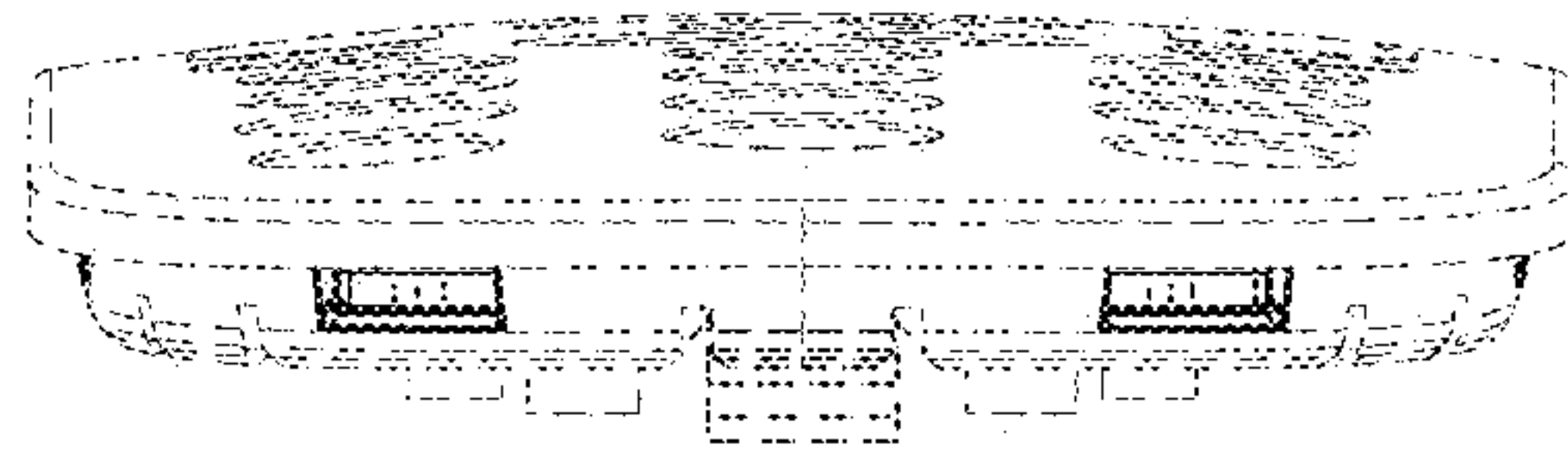

FIG. 8