



US00D907746S

(12) **United States Design Patent** (10) **Patent No.:** **US D907,746 S**
Park (45) **Date of Patent:** **** Jan. 12, 2021**

- (54) **FAUCET HANDLE**
- (71) Applicant: **DELTA FAUCET COMPANY,**
Indianapolis, IN (US)
- (72) Inventor: **Maris Park,** McCordsville, IN (US)
- (73) Assignee: **DELTA FAUCET COMPANY,**
Indianapolis, IN (US)
- (**) Term: **15 Years**
- (21) Appl. No.: **29/687,478**
- (22) Filed: **Apr. 12, 2019**
- (51) **LOC (13) Cl.** **23-01**
- (52) **U.S. Cl.**
USPC **D23/252**
- (58) **Field of Classification Search**
USPC D23/238-243, 249-250, 252, 254;
D8/307-308
See application file for complete search history.

| | | | | |
|--------------|---------|---------|-------|---------|
| D809,106 S * | 1/2018 | Wang | | D23/252 |
| D840,505 S * | 2/2019 | Zhang | | D23/238 |
| D845,439 S * | 4/2019 | Zhang | | D23/238 |
| D860,403 S * | 9/2019 | Park | | D23/252 |
| D868,211 S * | 11/2019 | Garland | | D23/238 |
| D877,296 S * | 3/2020 | Tentler | | D23/238 |

* cited by examiner

Primary Examiner — Robert A Delehanty

(74) *Attorney, Agent, or Firm* — Nirav D. Parikh; Edgar A. Zarins

(57) **CLAIM**

The ornamental design for a faucet handle, as shown and described.

DESCRIPTION

FIG. 1 is a first perspective view of a faucet handle showing my new design;
 FIG. 2 is a second perspective view thereof;
 FIG. 3 is a top plan view thereof;
 FIG. 4 is a first side view thereof;
 FIG. 5 is a second side view thereof; and,
 FIG. 6 is a third side view thereof.
 The broken-line disclosure in the view represents a portion of the faucet handle in which the claimed design is embodied, but which forms no part of the claimed design.

1 Claim, 1 Drawing Sheet

- (56) **References Cited**
U.S. PATENT DOCUMENTS
D746,413 S * 12/2015 Hanna D23/255
D769,421 S * 10/2016 Hanna D23/252
D787,019 S * 5/2017 Ziemann D23/238

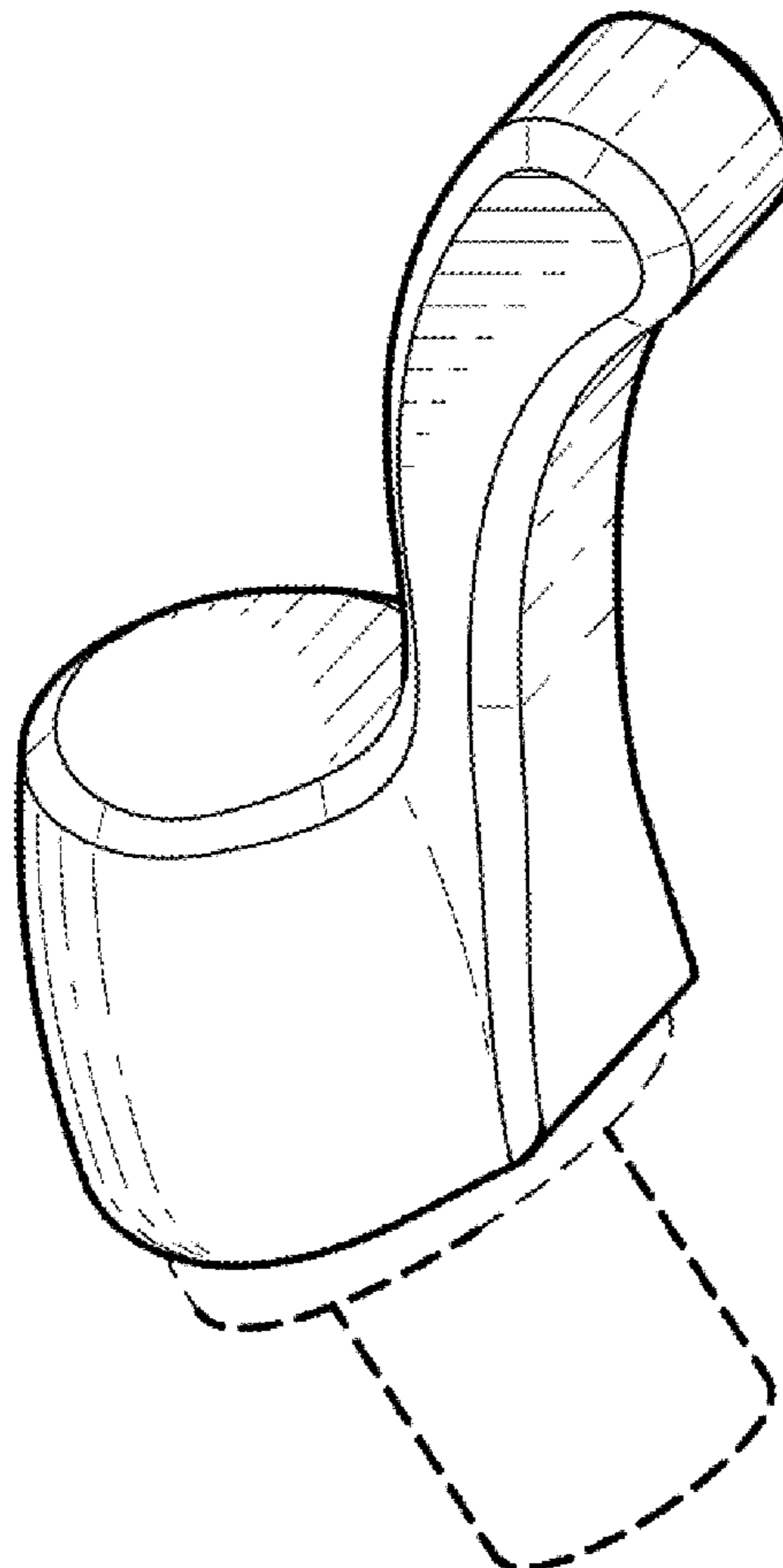

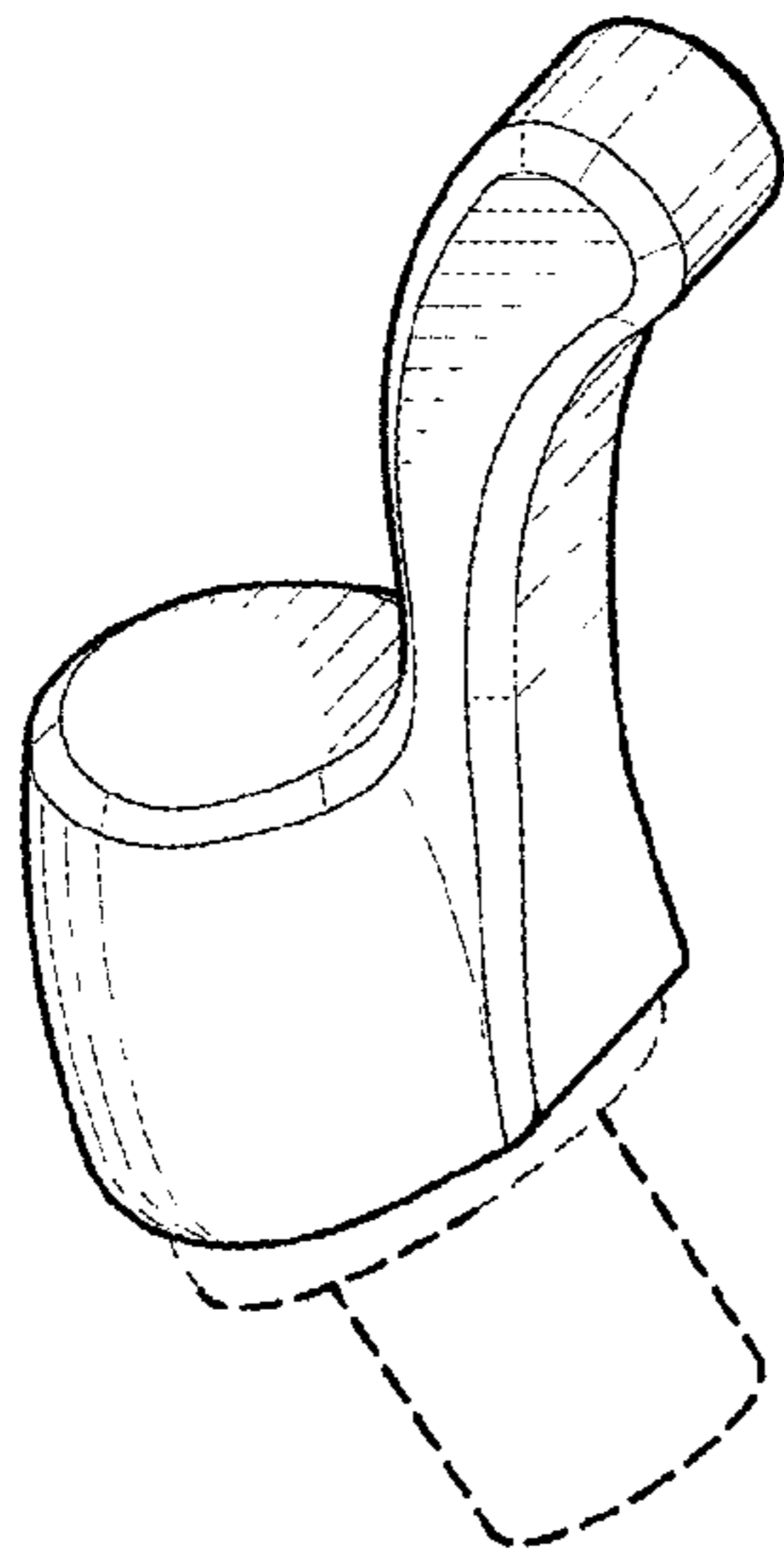

Fig-1

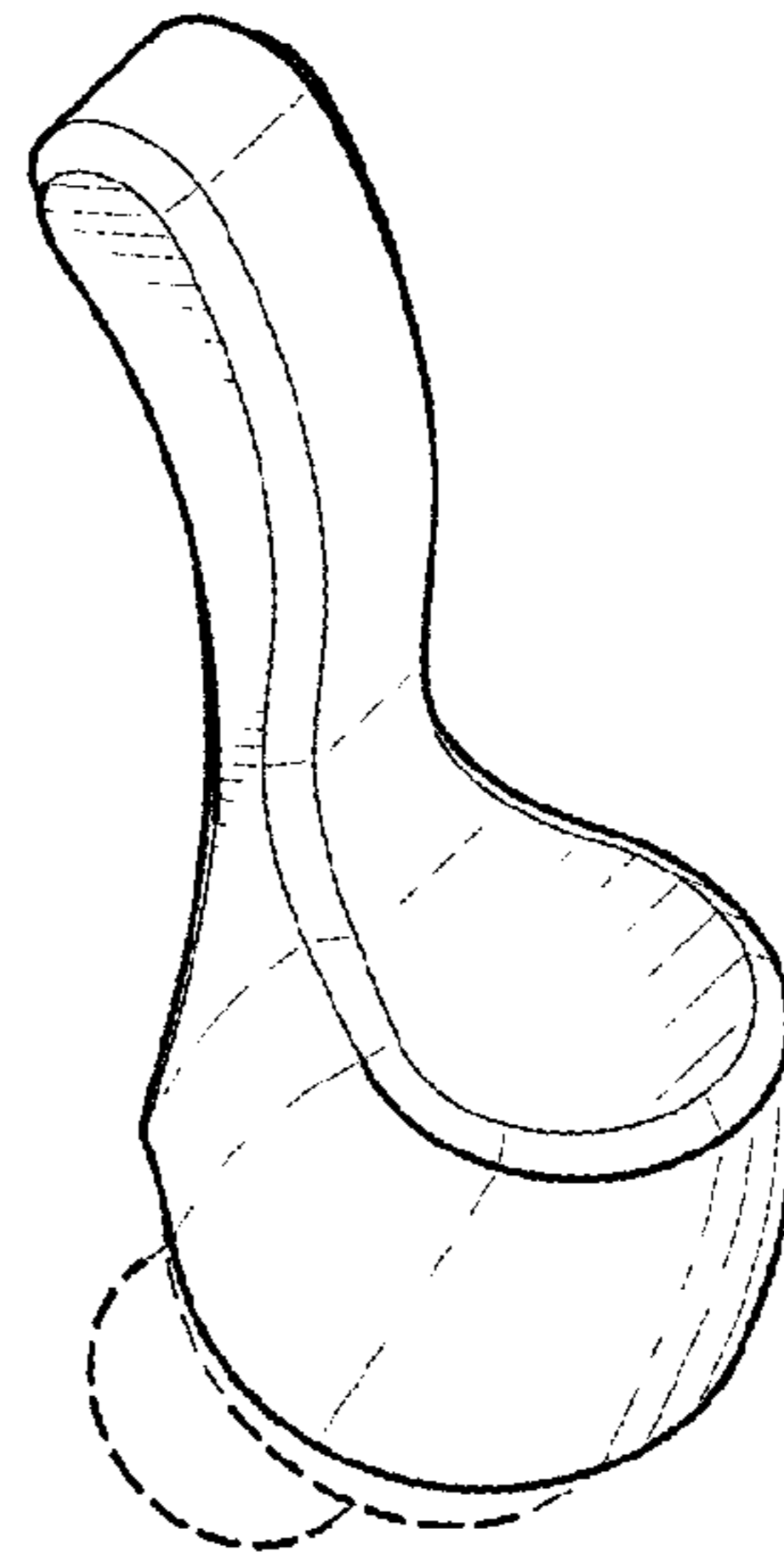

Fig-2

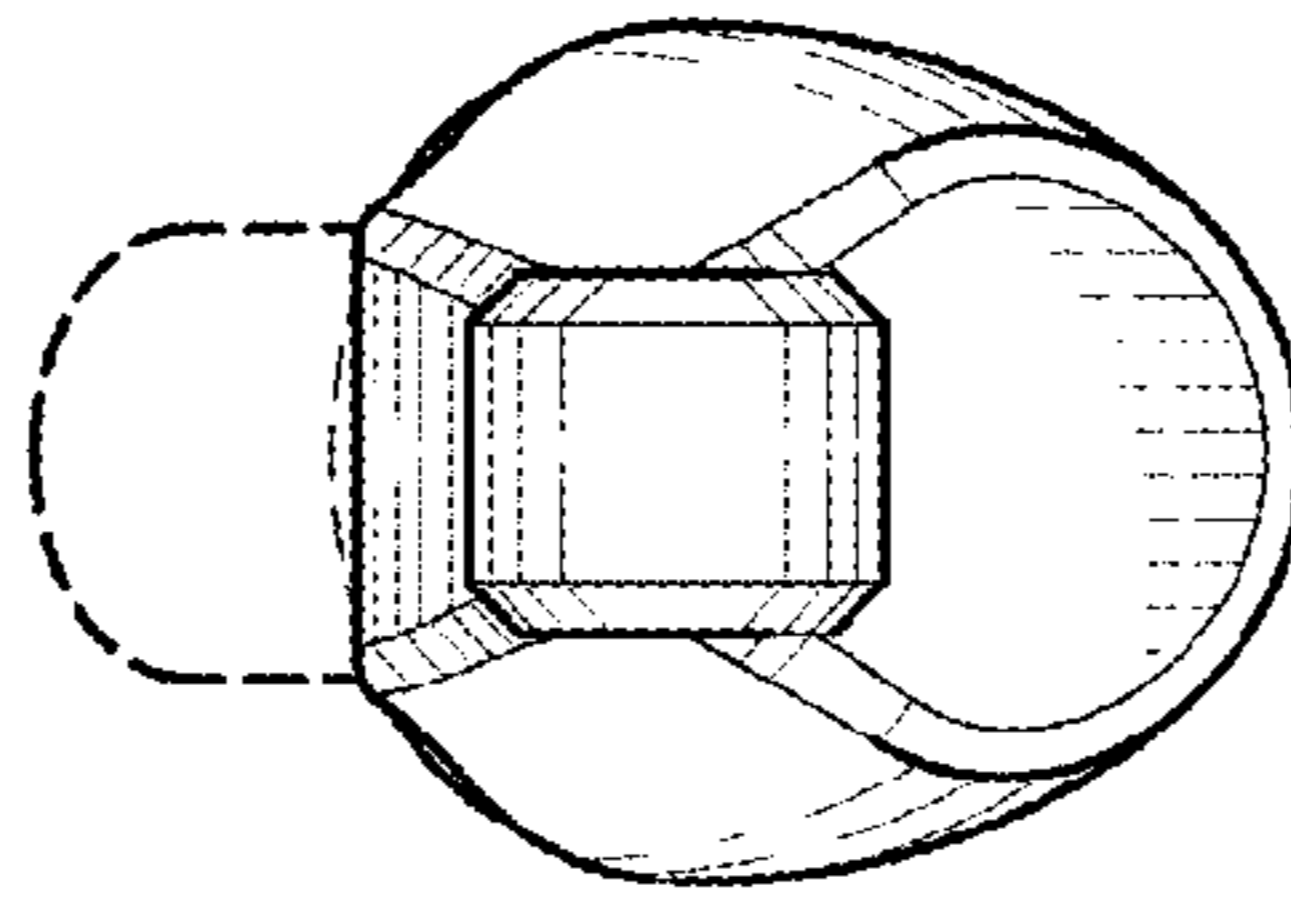

Fig-3

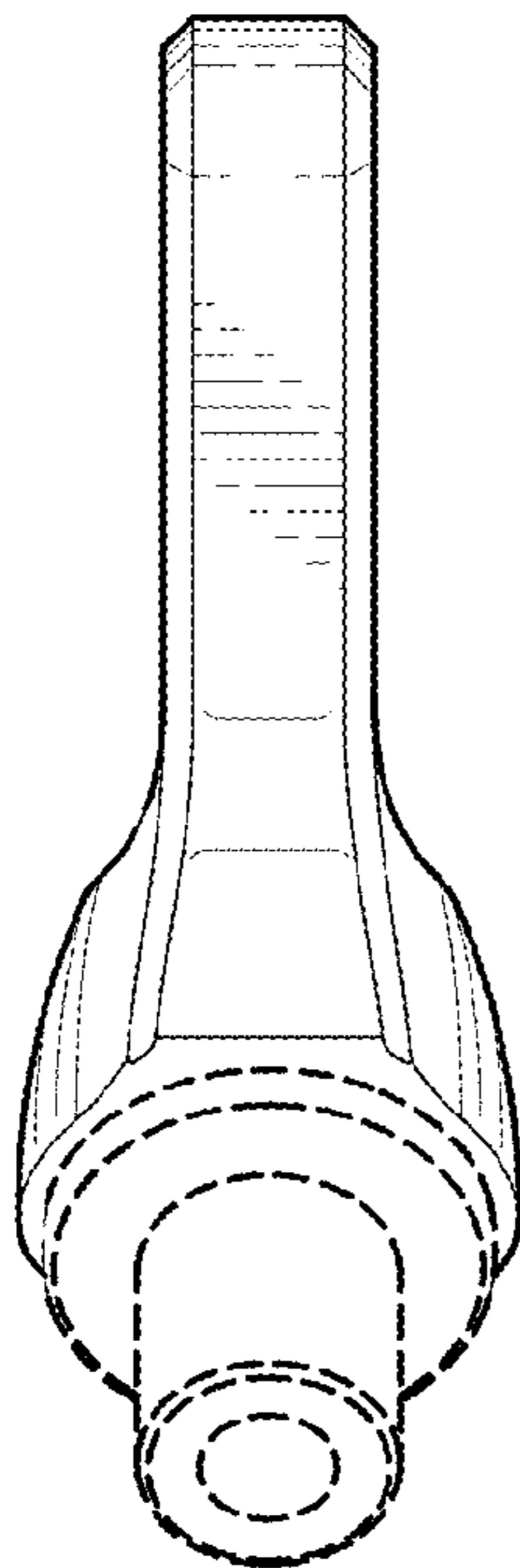

Fig-4

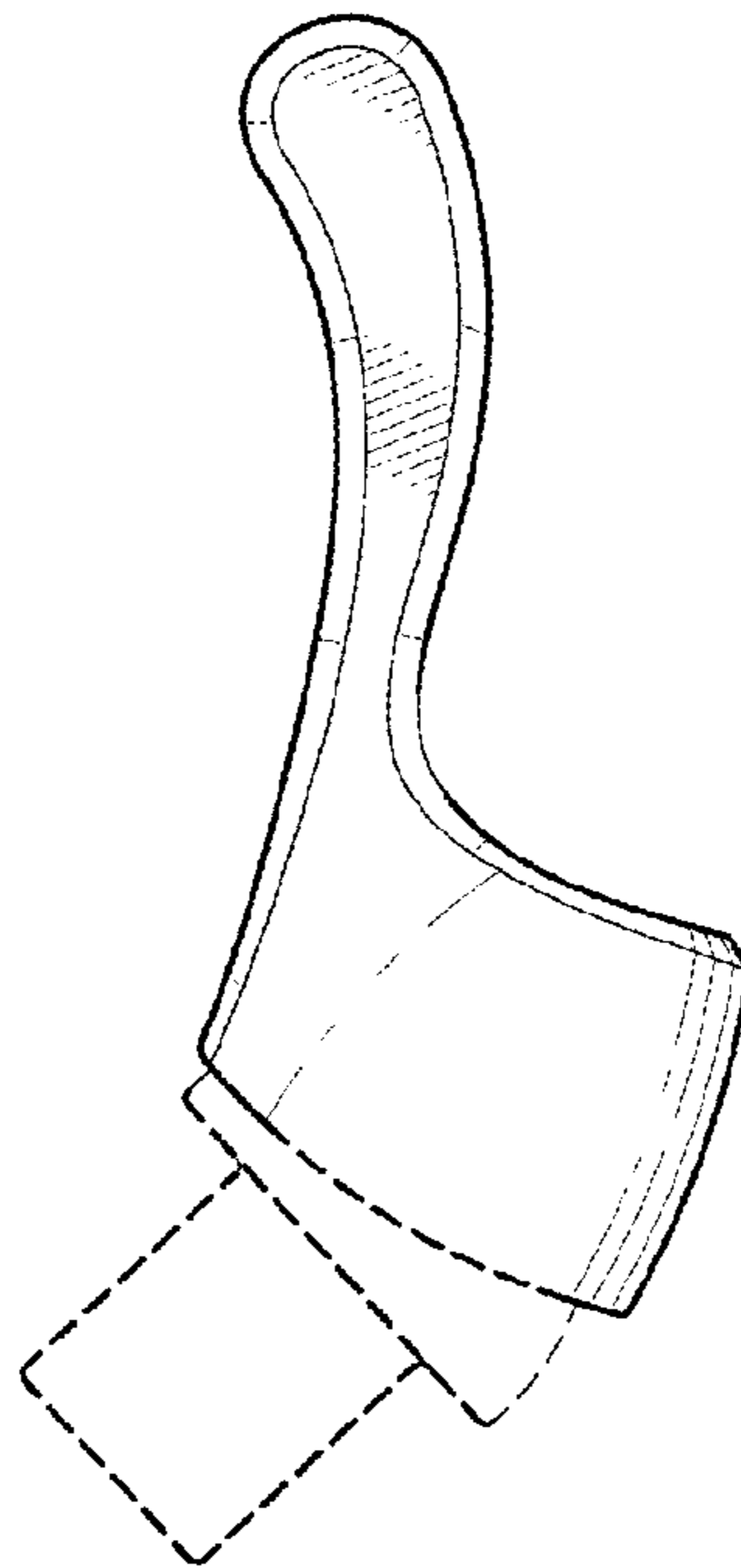

Fig-5

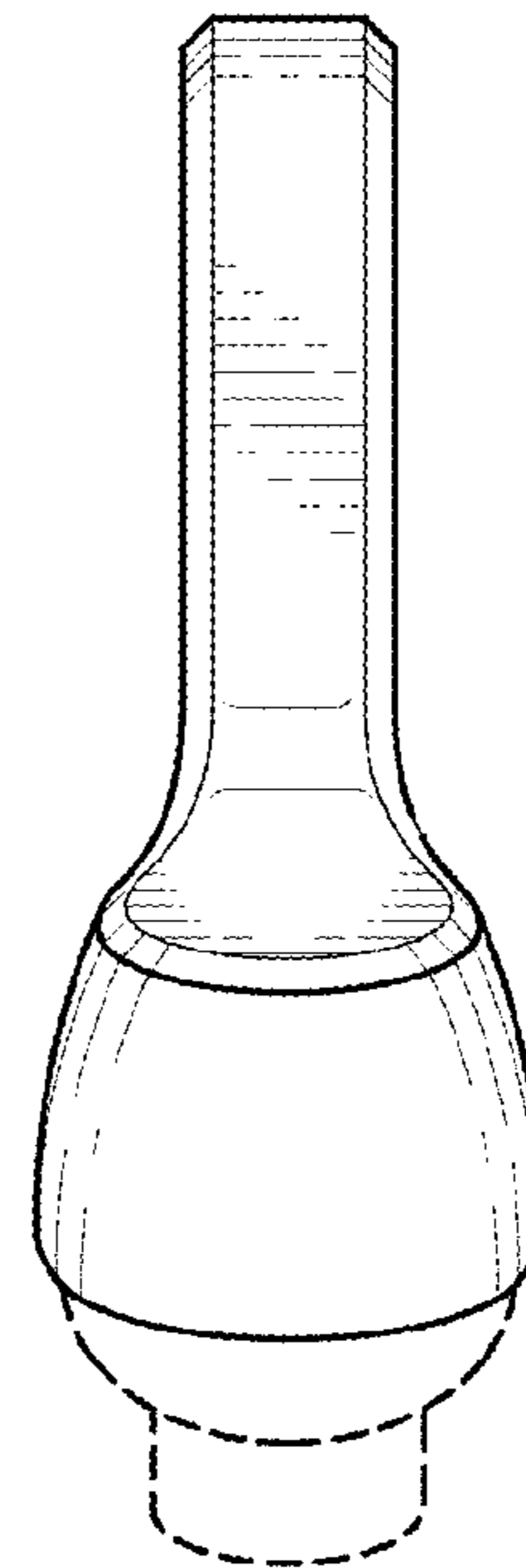

Fig-6