



US00D906270S

(12) **United States Design Patent**
Song

(10) **Patent No.:** **US D906,270 S**

(45) **Date of Patent:** **** Dec. 29, 2020**

(54) **LED COMPONENT**

(71) Applicant: **KINGBRIGHT ELECTRONIC CO., LTD.**, New Taipei (TW)

(72) Inventor: **Wen-Joe Song**, New Taipei (TW)

(73) Assignee: **KINGBRIGHT ELECTRONICS CO. LTD.**

(**) Term: **15 Years**

(21) Appl. No.: **29/669,449**

(22) Filed: **Nov. 8, 2018**

(30) **Foreign Application Priority Data**

Oct. 26, 2018 (TW) 107306348

(51) **LOC (12) Cl.** **13-03**

(52) **U.S. Cl.**
USPC **D13/180**

(58) **Field of Classification Search**

USPC D26/1; D13/180

CPC H01L 25/167; H01L 25/0753; H01L

27/0248; H01L 27/15; H01L 27/156;

H01L 31/02; H01L 33/00; H01L 33/04;

H01L 33/08; H01L 33/10; H01L 33/20;

H01L 33/38; H01L 33/42; H01L 33/48;

H01L 33/62; H01L 33/483; H01L 33/486;

F21K 9/00; F21K 9/30; F21K 9/54

See application file for complete search history.

(56) **References Cited**

U.S. PATENT DOCUMENTS

D719,535 S * 12/2014 Iino D13/180

D724,039 S * 3/2015 Iino D13/180

D744,965 S * 12/2015 Chen D13/180

D756,942 S * 5/2016 Shi D13/180

D761,215 S * 7/2016 Shi D13/180

D774,475 S * 12/2016 Song D13/180

D774,476 S * 12/2016 Song D13/180

D778,846 S * 2/2017 Song D13/180

D778,847 S * 2/2017 Song D13/180

D783,547 S * 4/2017 Bergmann D13/180

D823,269 S * 7/2018 Iino D13/180

D847,102 S * 4/2019 Chen D13/180

D856,946 S * 8/2019 Song D13/180

* cited by examiner

Primary Examiner — Zenia I Bennett

(57) **CLAIM**

The ornamental design for an LED component, as shown and described.

DESCRIPTION

FIG. 1 is a top, front and left side perspective view of an LED component showing my design;

FIG. 2 is a front elevation view thereof;

FIG. 3 is a rear elevation view thereof

FIG. 4 is a left side elevation view thereof

FIG. 5 is a right side elevation view thereof;

FIG. 6 is a top plan view thereof;

FIG. 7 is a bottom plan view thereof; and,

FIG. 8 is a bottom, front and right side perspective view thereof.

The broken lines showing in the embodiments of FIGS. 1-8 are for illustrative purposes only and form no part of the claimed design. The top layer can have been visually transparent or translucent as shown in the embodiments of FIGS. 1-8.

1 Claim, 6 Drawing Sheets

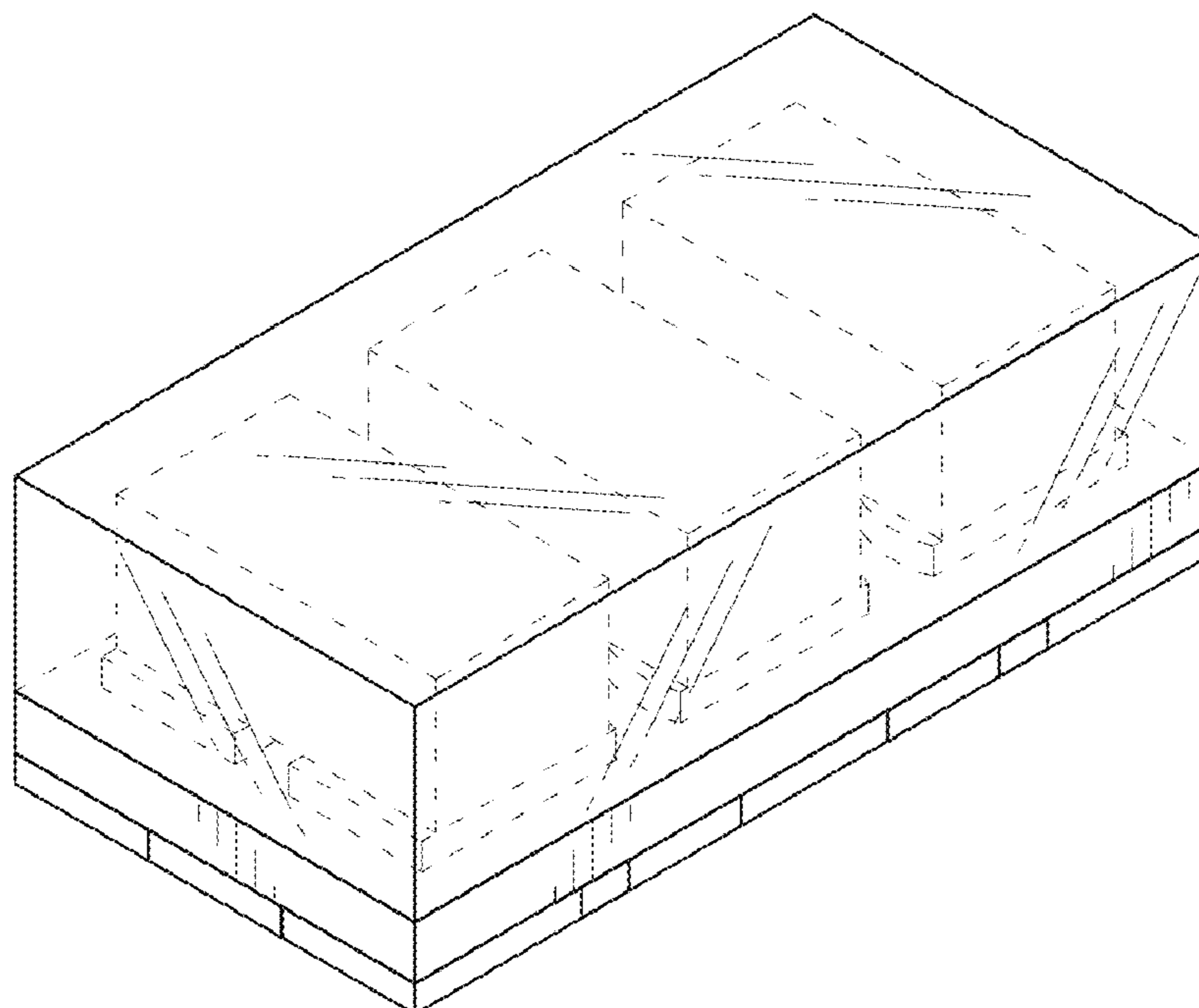

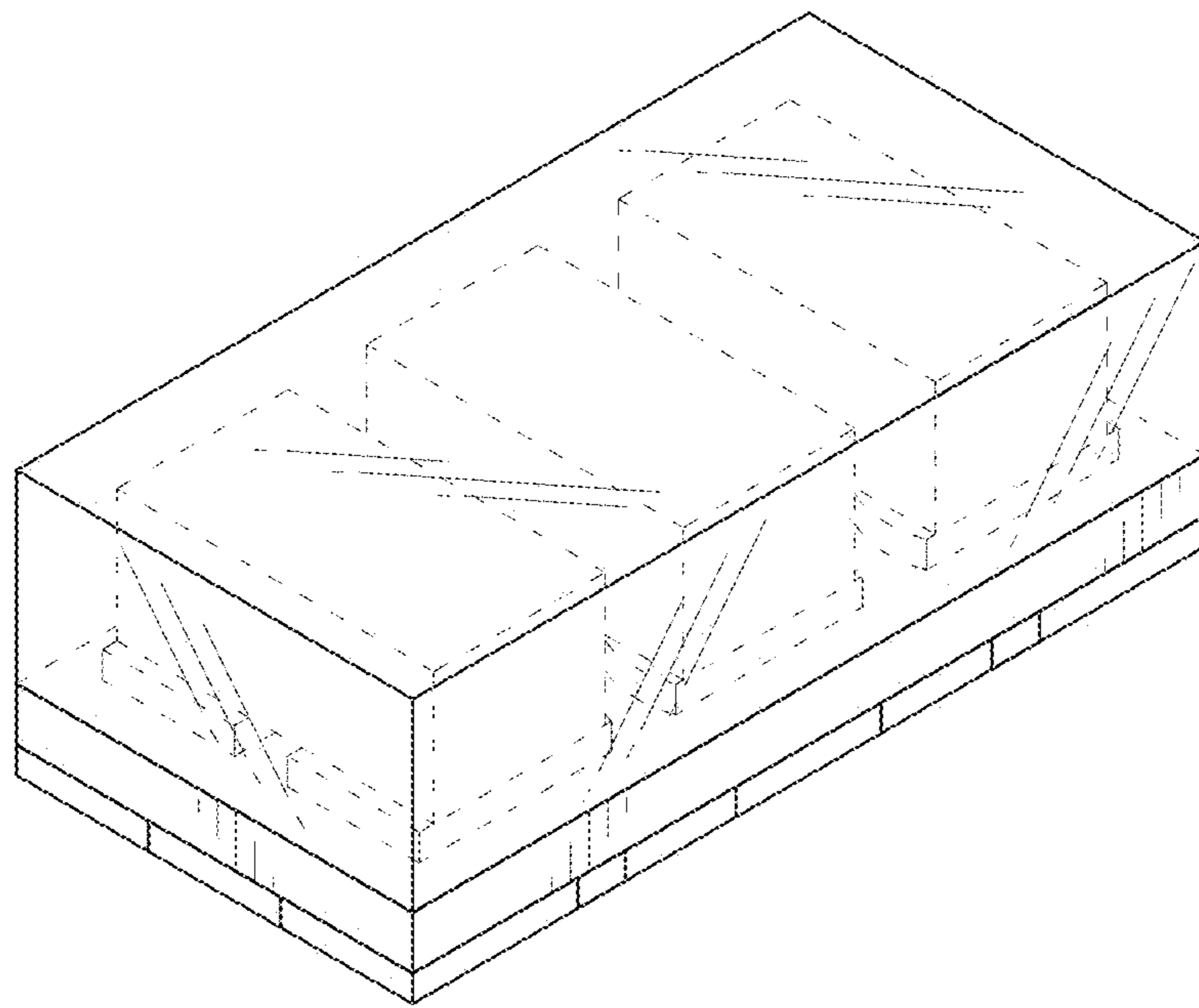

FIG. 1

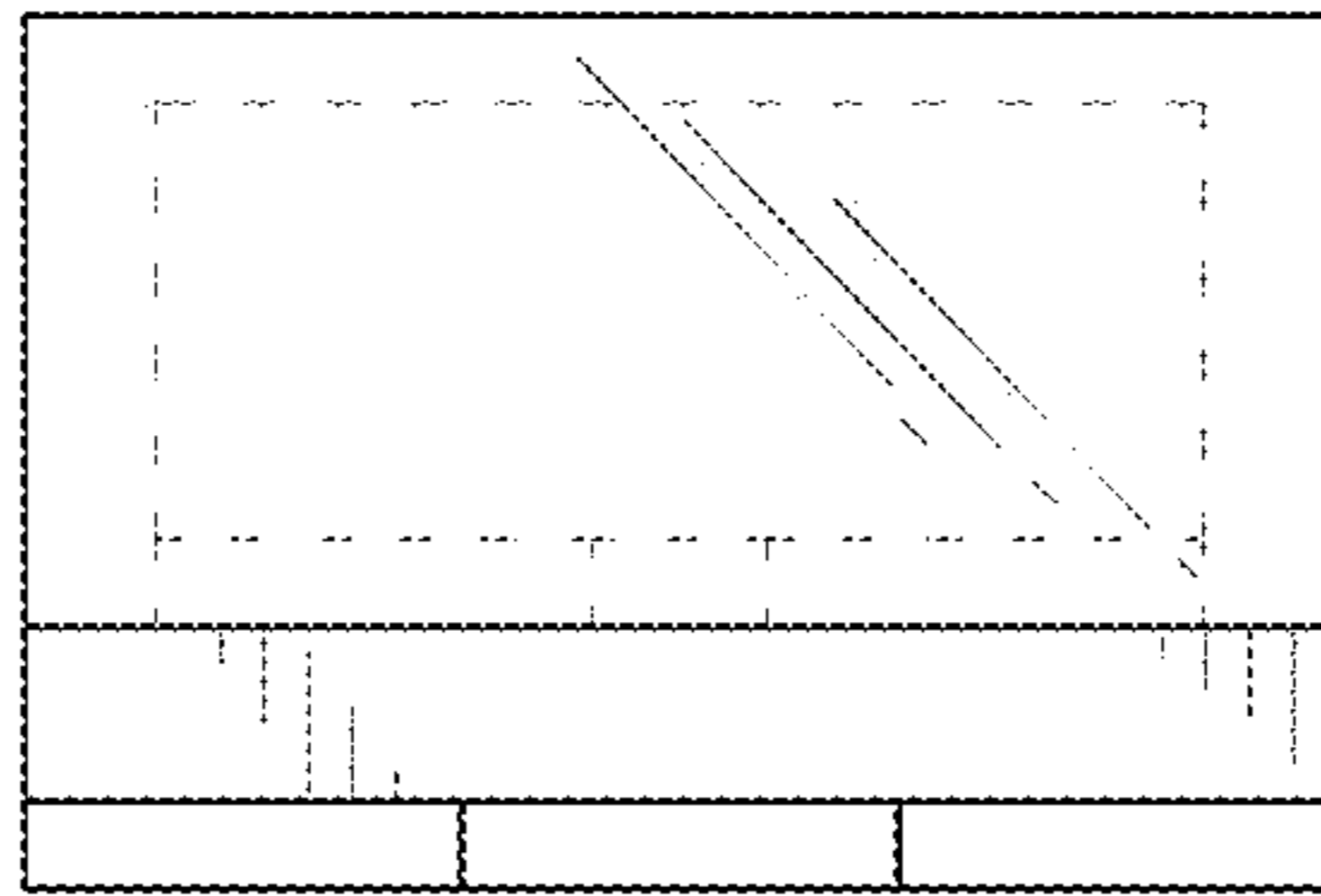

FIG. 2

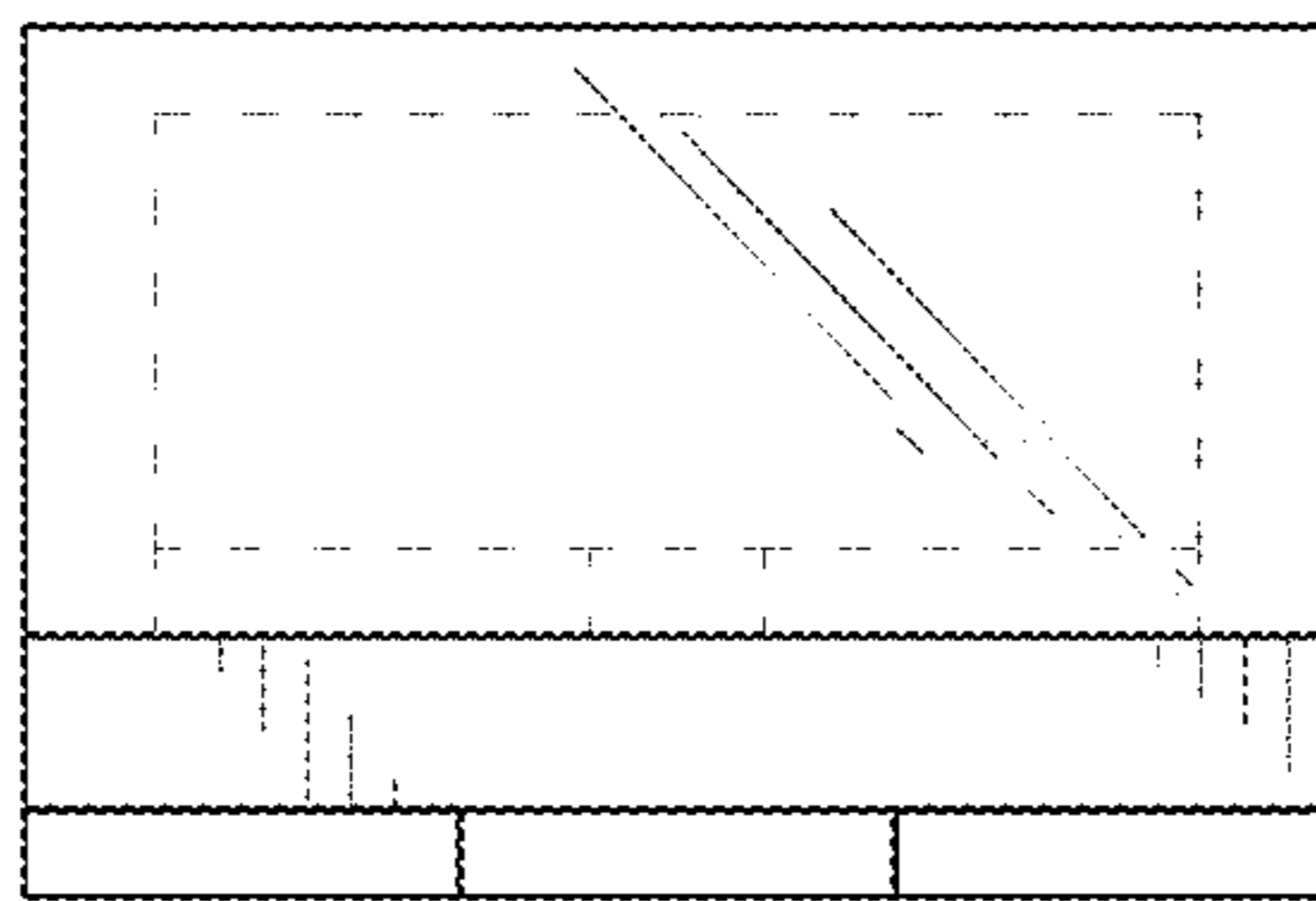

FIG. 3

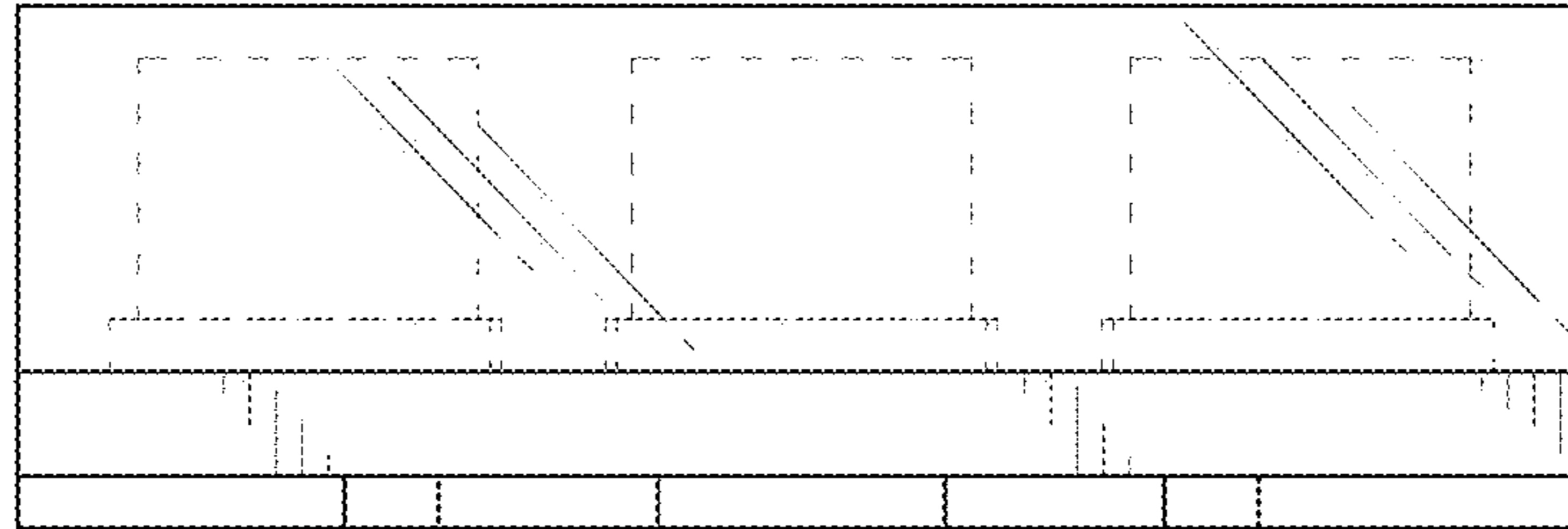

FIG. 4

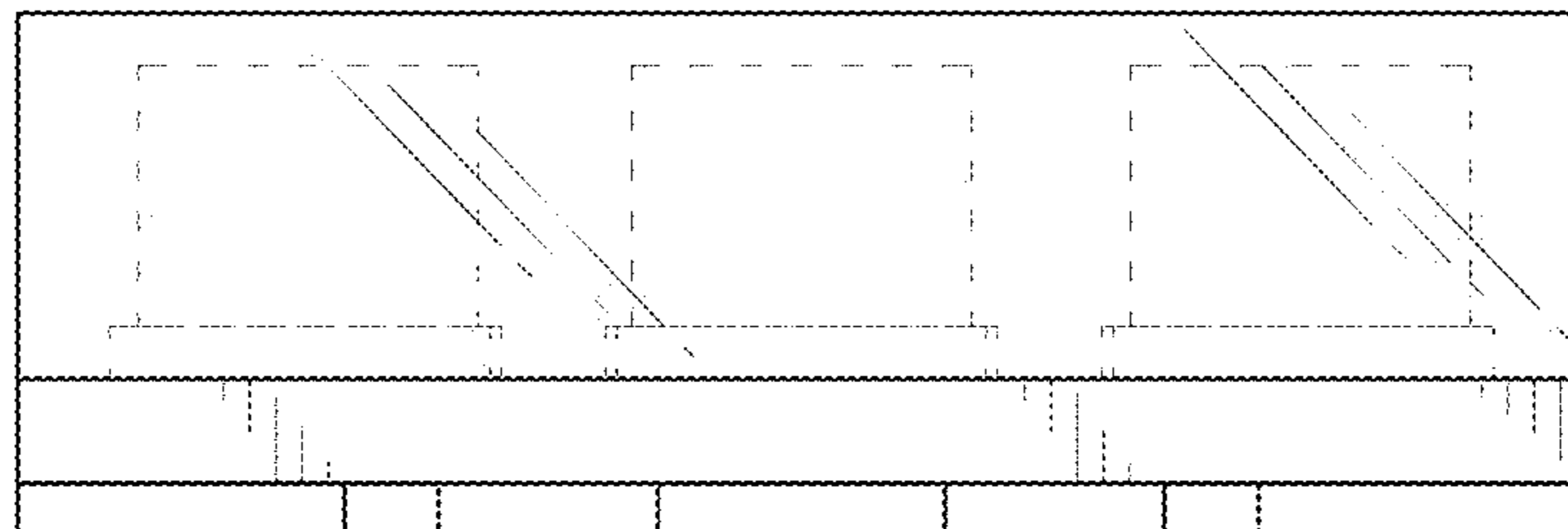

FIG. 5

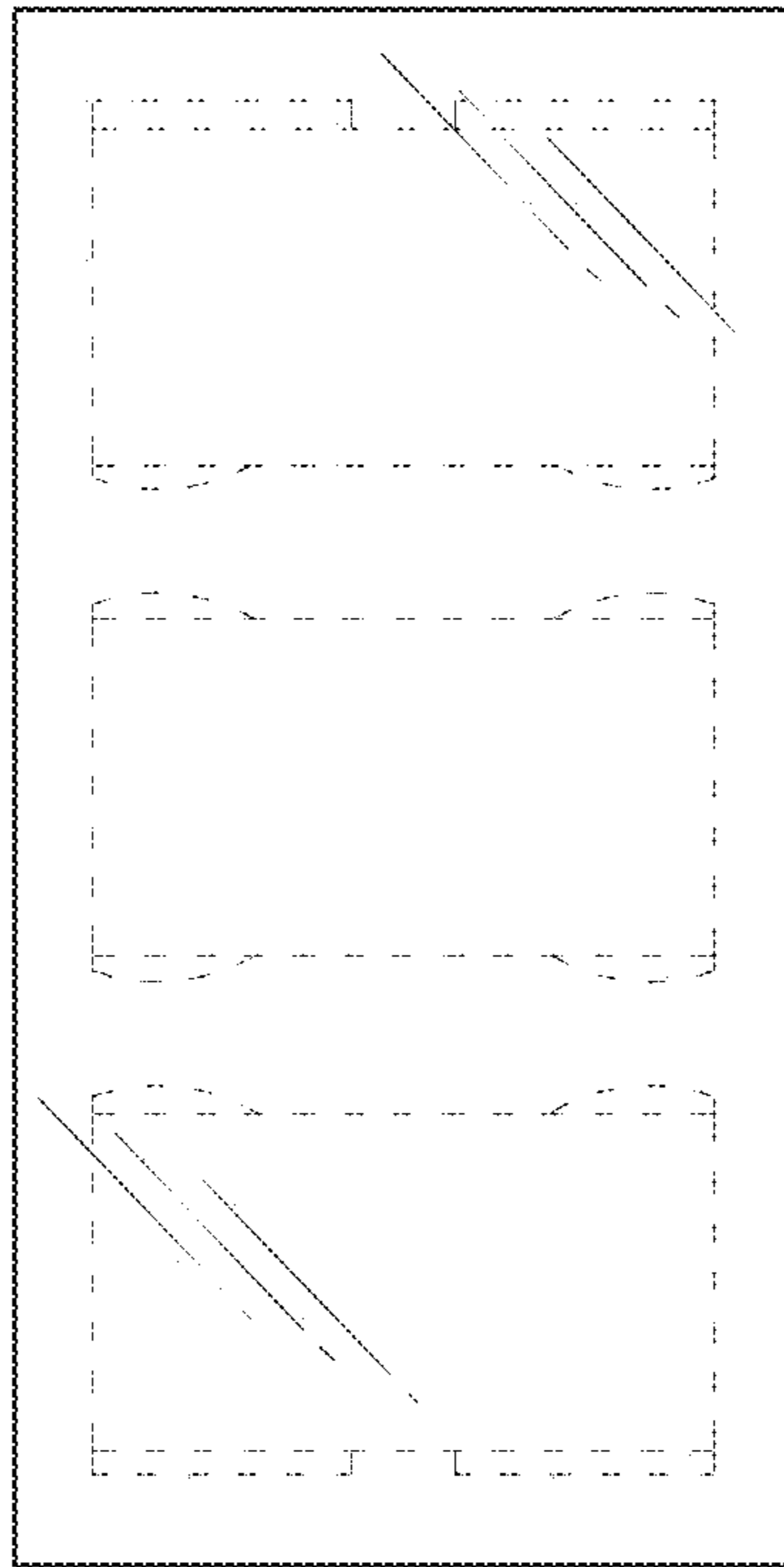

FIG. 6

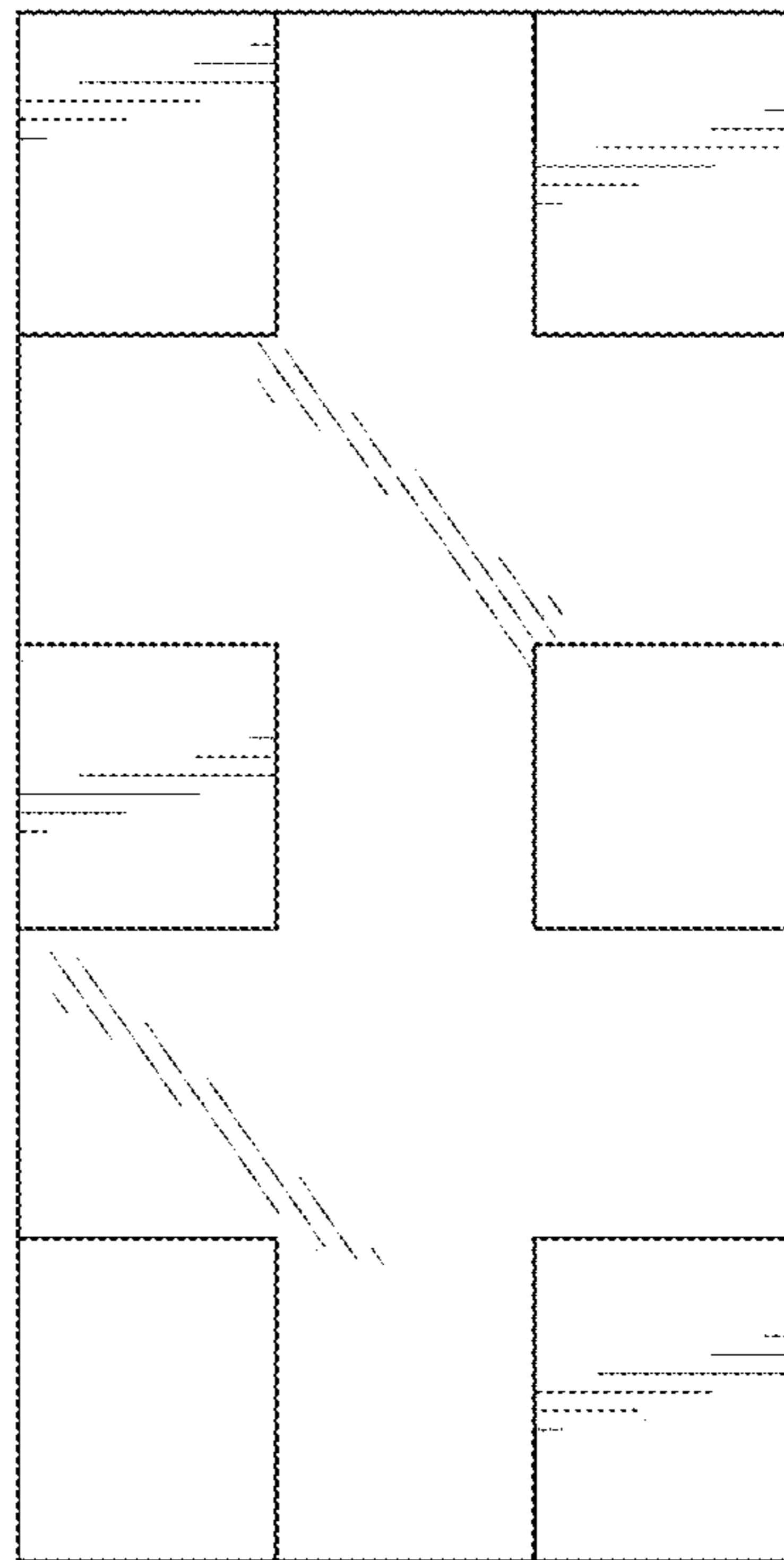

FIG. 7

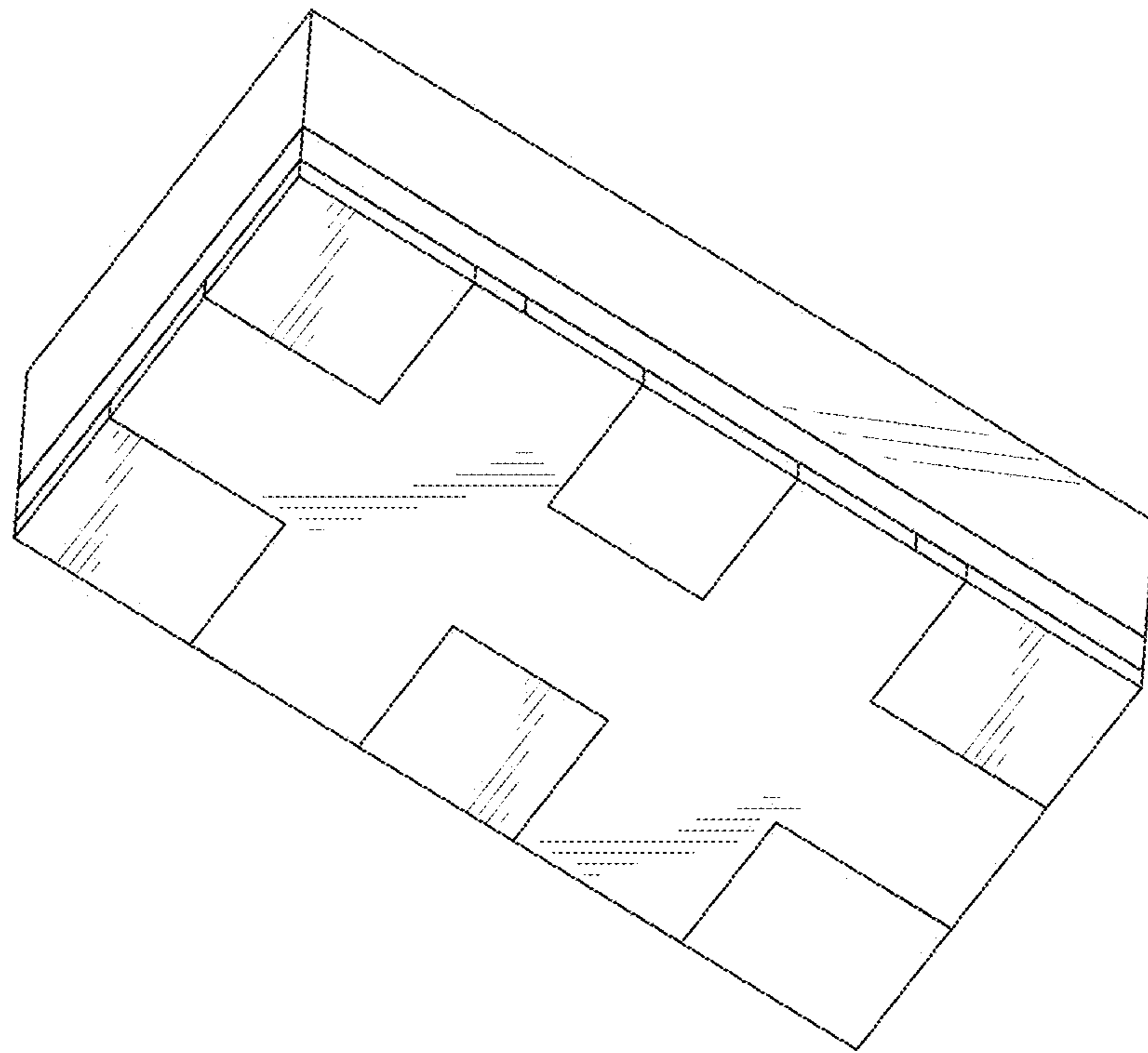

FIG. 8