



US00D904860S

(12) **United States Design Patent**
Hellsten

(10) **Patent No.:** **US D904,860 S**

(45) **Date of Patent:** **** Dec. 15, 2020**

(54) **SUPPORT FRAME FOR INFLATABLE
BLADDER**

(71) Applicant: **Picote Solutions Inc.**, Sammamish, WA
(US)

(72) Inventor: **Ilkka Hellsten**, Oulu (FI)

(73) Assignee: **Picote Solutions Inc.**, Sammamish, WA
(US)

(**) Term: **15 Years**

(21) Appl. No.: **29/703,219**

(22) Filed: **Aug. 26, 2019**

(30) **Foreign Application Priority Data**

Mar. 8, 2019 (EM) 006293635-0001

(51) **LOC (12) Cl.** **08-05**

(52) **U.S. Cl.**
USPC **D8/354; D8/376**

(58) **Field of Classification Search**
USPC D8/354, 355, 367, 373, 376, 380
CPC . A47H 1/022; A47H 1/12; E03F 9/002; E03F
9/005; E03F 9/007
See application file for complete search history.

(56) **References Cited**

U.S. PATENT DOCUMENTS

527,273 A * 10/1894 Fowler et al. A47H 1/022
211/105.6
670,585 A * 3/1901 Fowler A47H 1/022
211/105.4
3,983,593 A * 10/1976 Naeve E03F 9/005
15/104.33
4,312,679 A * 1/1982 Klein, Sr. E03C 1/304
134/167 C
D324,328 S * 3/1992 Pagan 248/200.1
D331,872 S * 12/1992 Maruko D8/376

5,330,061 A * 7/1994 Geltz A47K 3/38
211/105.4
D385,178 S * 10/1997 Poulin D8/376
D396,183 S * 7/1998 Poulin D8/376
D530,132 S * 10/2006 Ivankovic D8/376
9,999,313 B2 * 6/2018 Mullet E06B 9/68
D867,864 S * 11/2019 Haruta D8/376
10,731,685 B2 * 8/2020 Uchida F16B 21/082
2014/0158377 A1 * 6/2014 Hollier E21B 17/18
166/382
2017/0000280 A1 * 1/2017 Mullet E06B 9/68
2019/0275569 A1 * 9/2019 Jertrum E03C 1/302

* cited by examiner

Primary Examiner — Keli L Hill

Assistant Examiner — Harold E Blackwell, II

(74) *Attorney, Agent, or Firm* — Fasth Law Offices; Rolf
Fasth

(57) **CLAIM**

The ornamental design for a support frame for inflatable
bladder, as shown and described.

DESCRIPTION

FIG. 1 is a perspective back view of the support frame
for inflatable bladder of the present invention;
FIG. 2 is a perspective front view of the support frame for
inflatable bladder of the present invention;
FIG. 3 is an elevational top view of the support frame for
inflatable bladder of the present invention;
FIG. 4 is an elevational bottom view of the support frame for
inflatable bladder of the present invention;
FIG. 5 is an elevational back view of the support frame for
inflatable bladder of the present invention;
FIG. 6 is an elevational front view of the support frame for
inflatable bladder of the present invention;
FIG. 7 is an elevational left view of the support frame for
inflatable bladder of the present invention; and,
FIG. 8 is an elevational right view of the support frame for
inflatable bladder of the present invention.

1 Claim, 8 Drawing Sheets

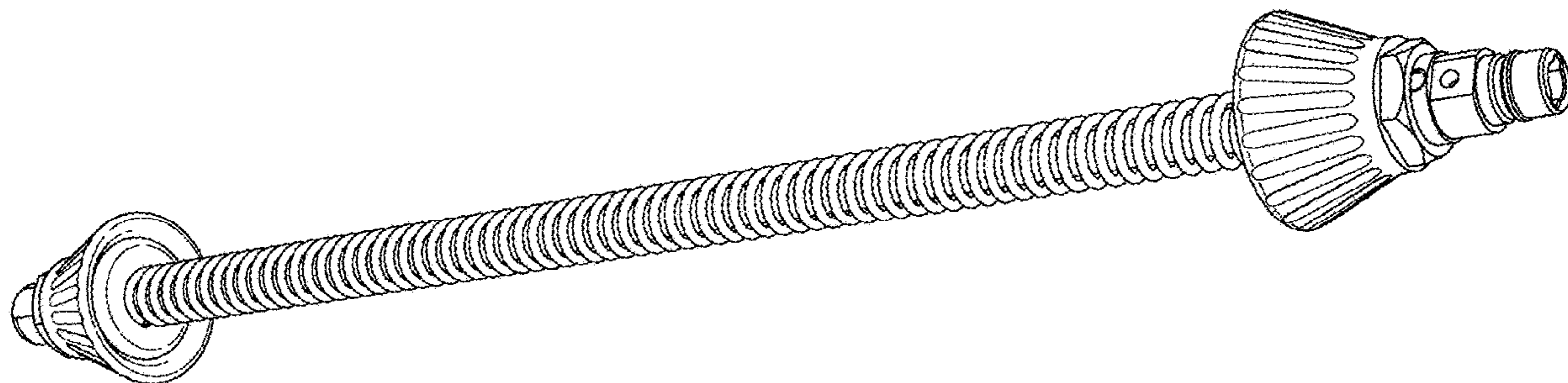

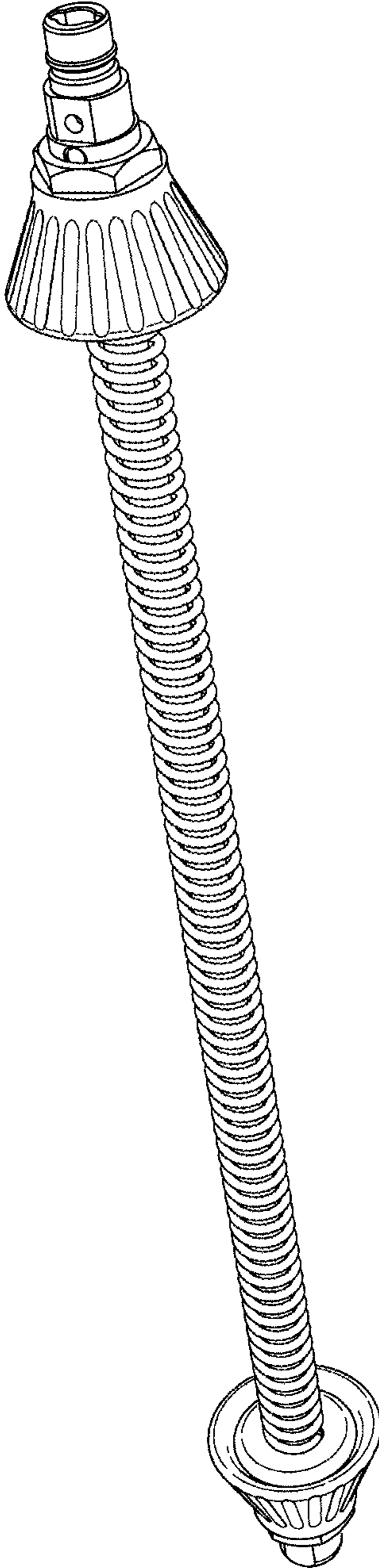

Fig. 1

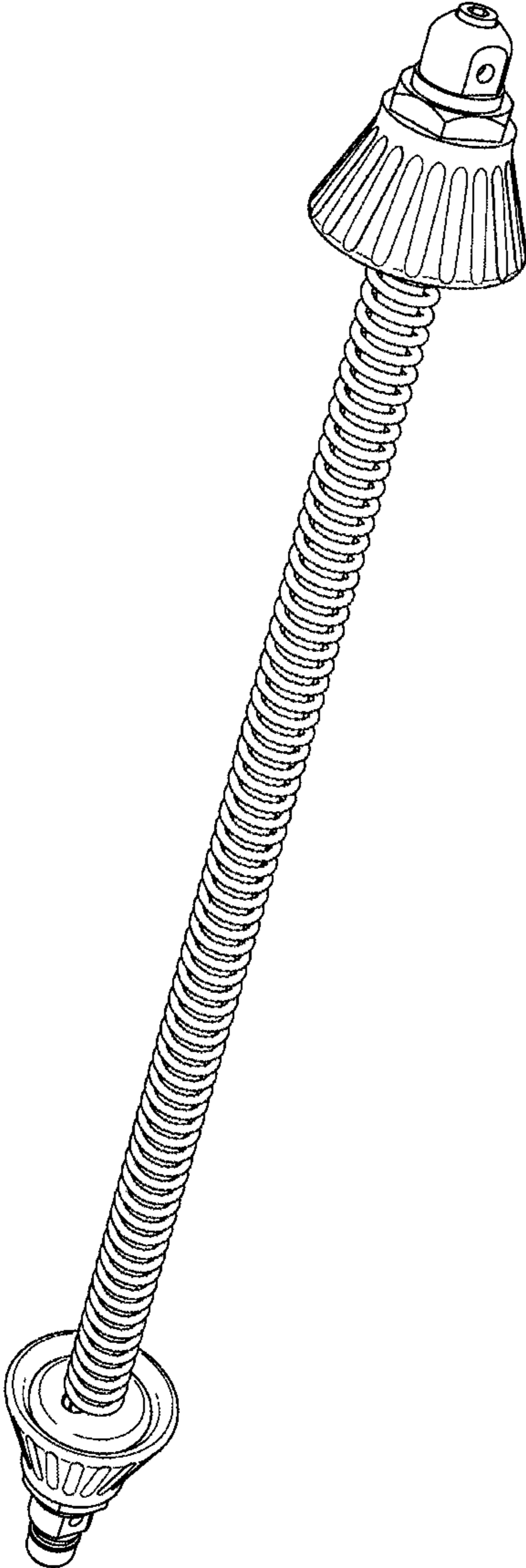

Fig. 2

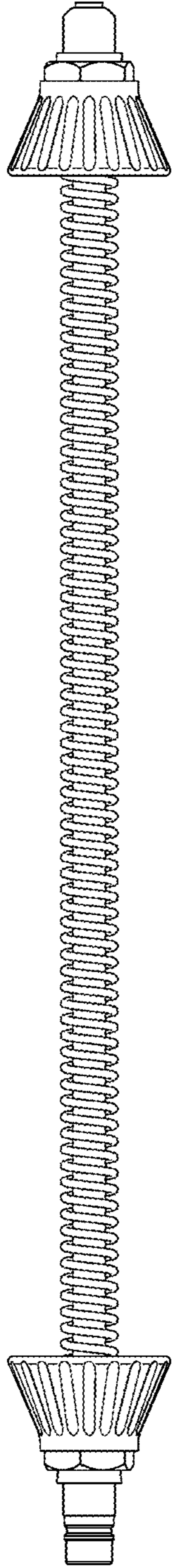

Fig. 3

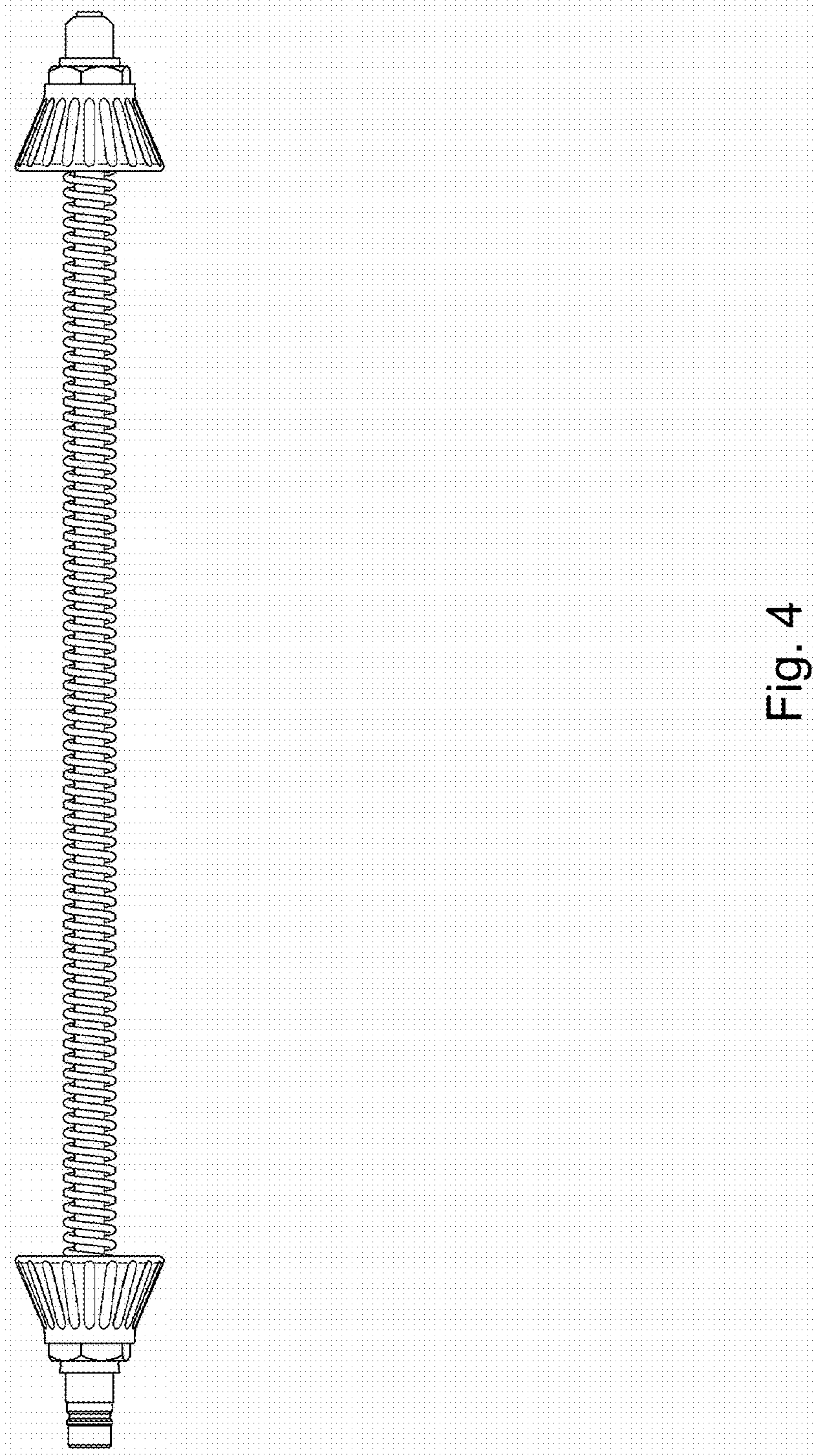

Fig. 4

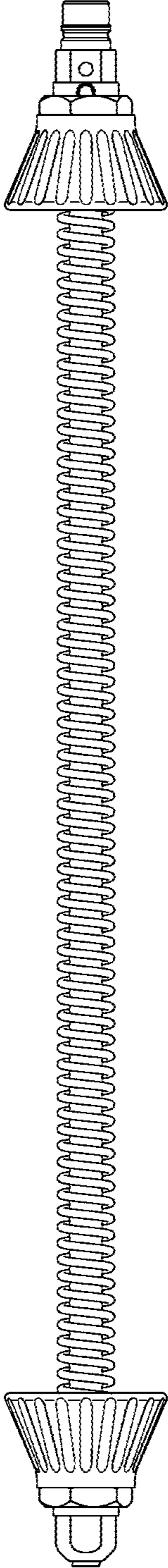

Fig. 5

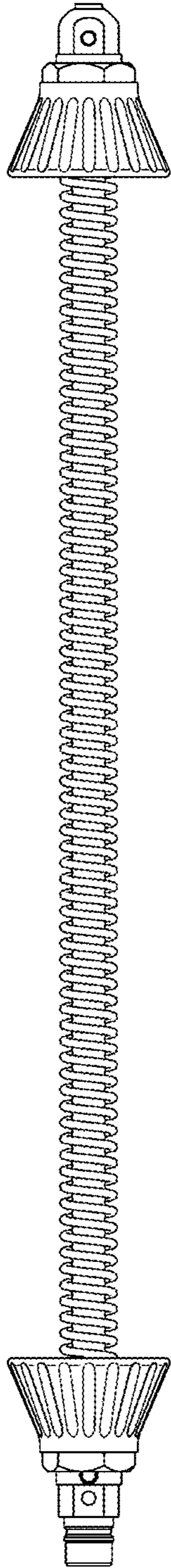

Fig. 6

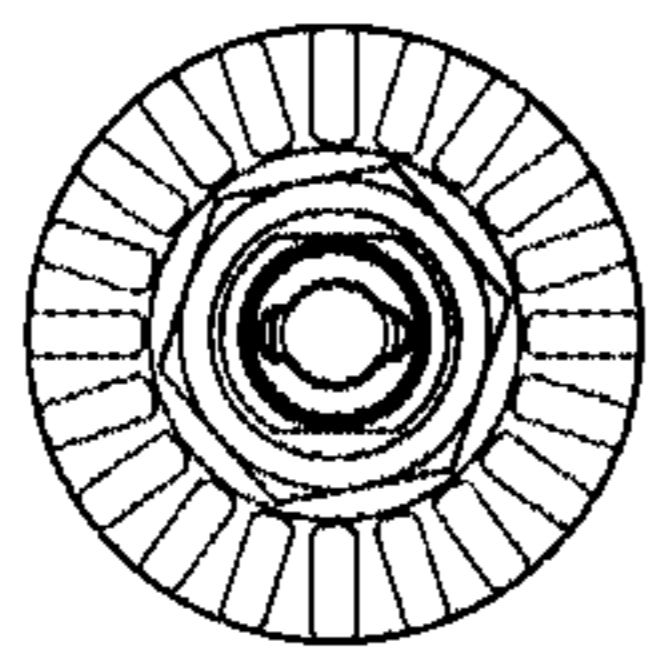

Fig. 7

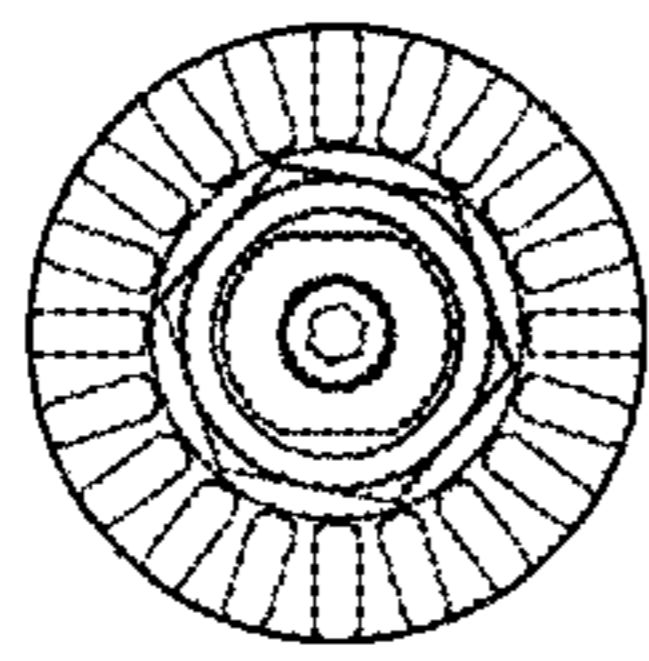

Fig. 8