



US00D904644S

(12) **United States Design Patent**  
**Celestino**

(10) **Patent No.:** **US D904,644 S**

(45) **Date of Patent:** **\*\* Dec. 8, 2020**

(54) **WALL COVERING**

(71) Applicant: **MISHA S.r.L.**, Milan (IT)

(72) Inventor: **Cristina Celestino**, Milan (IT)

(73) Assignee: **MISHA S.R.L.**, Milan (IT)

(\*\*) Term: **15 Years**

(21) Appl. No.: **29/696,098**

(22) Filed: **Jun. 25, 2019**

(51) **LOC (12) Cl.** ..... **25-01**

(52) **U.S. Cl.**

USPC ..... **D25/138**; D25/149; D5/32

(58) **Field of Classification Search**

USPC ..... D25/138, 149; D6/332; D5/32, 37, 38,  
D5/39, 66

CPC ..... B32B 2607/02; B32B 2451/00; E04F  
13/002; E04F 13/00; D06N 7/00; D06Q  
1/00; D06Q 1/02; Y10S 428/9133

See application file for complete search history.

(56) **References Cited**

**U.S. PATENT DOCUMENTS**

D257,598 S *	12/1980	Cyplik .....	D6/332
D257,600 S *	12/1980	Cyplik .....	D6/332
D338,108 S *	8/1993	Hurd .....	D5/32
D652,533 S *	1/2012	Apelo Cruz .....	D25/138
D728,244 S *	5/2015	Saavedra .....	D5/60
9,340,982 B2 *	5/2016	Rainey .....	E04F 13/0871

10,189,236 B2 *	1/2019	Lautzenhiser .....	B32B 27/22
10,328,677 B2 *	6/2019	Schwarz .....	B32B 27/12
10,480,120 B2 *	11/2019	Guyot .....	B32B 27/20

\* cited by examiner

*Primary Examiner* — Doris Clark

(74) *Attorney, Agent, or Firm* — Vorys, Sater, Seymour & Pease

(57) **CLAIM**

The ornamental design for a wall covering, as shown and described.

**DESCRIPTION**

FIG. 1 is a front view of a new design for a wall covering; FIG. 2 is a back view thereof;

FIG. 3 is a bottom view thereof; the top view being a mirror image of FIG. 3;

FIG. 4 is a right side view thereof; the left side view being a mirror image of FIG. 4; and,

FIG. 5 is a perspective view thereof, shown in a position of use.

The broken line perimeters surrounding the design in FIGS. 1-2 and 5 depict boundaries of the design and form no part thereof. The broken lines extending across the side and back surfaces in FIGS. 3 and 4 depict boundaries of the design and form no part thereof. The door and door frame drawn in broken line within a plane on the left hand side of the design are environmental subject matter that forms no part of the claimed design. All broken lines in the drawings are not claimed.

**1 Claim, 4 Drawing Sheets**

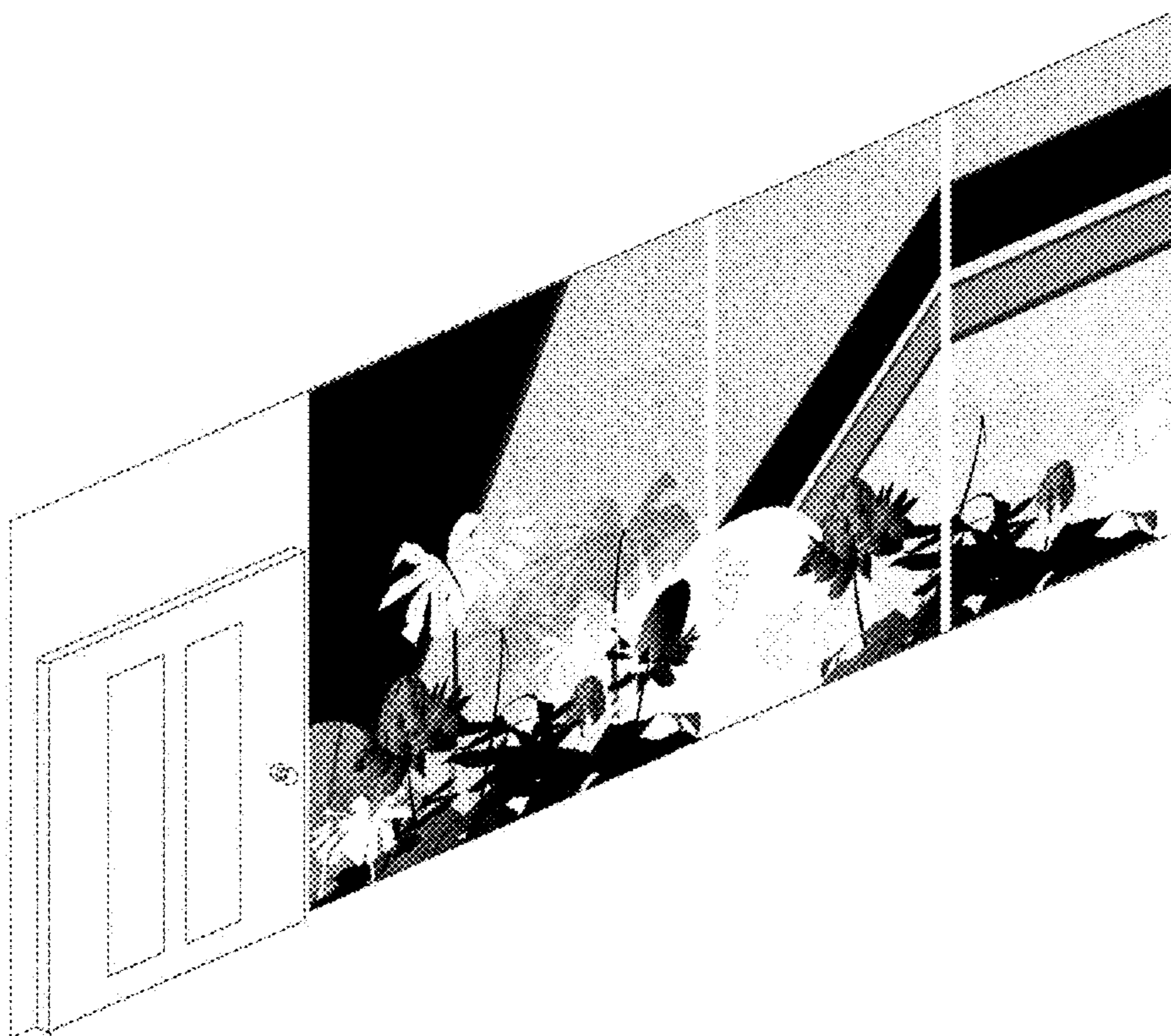

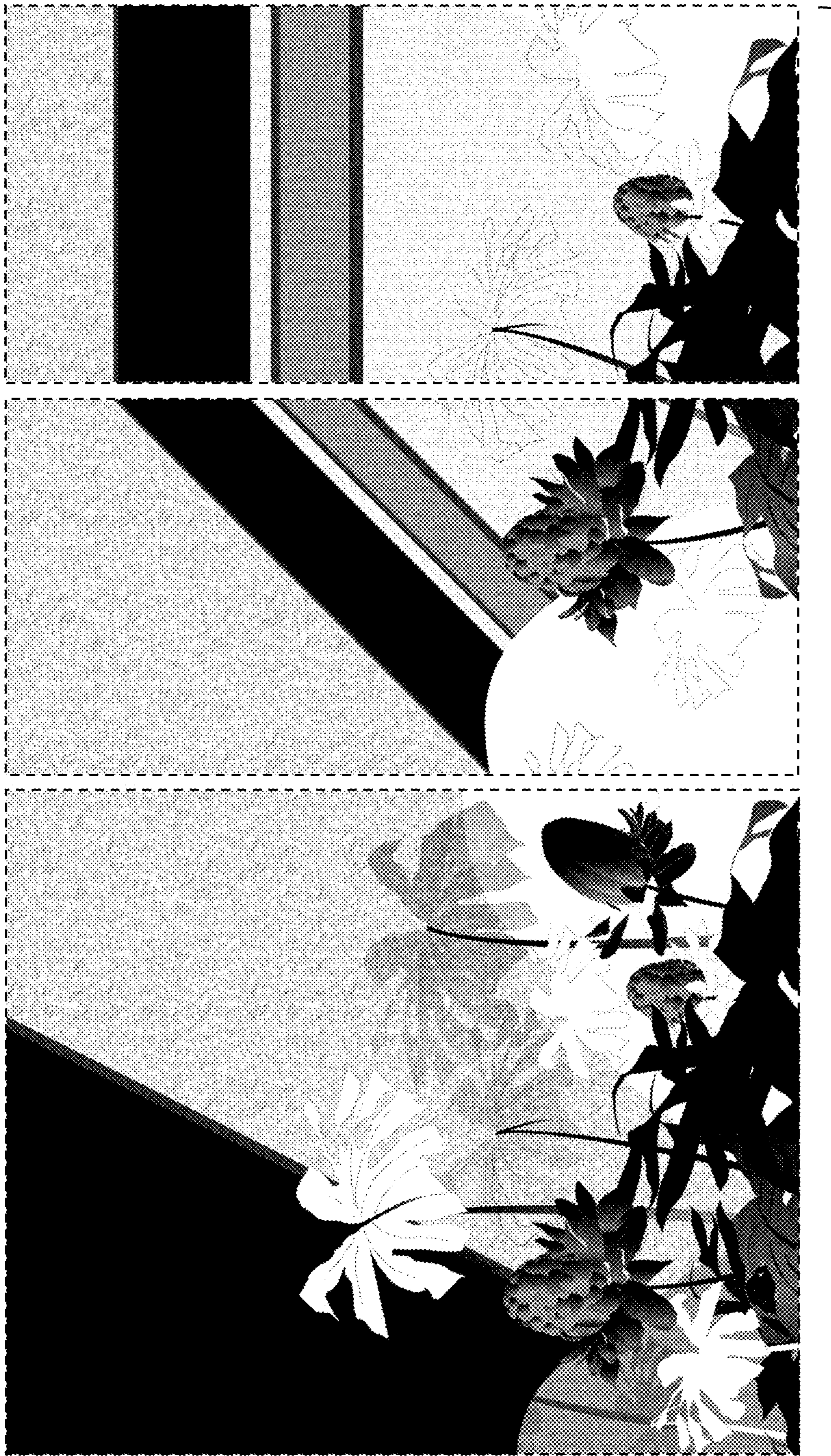

FIG.1

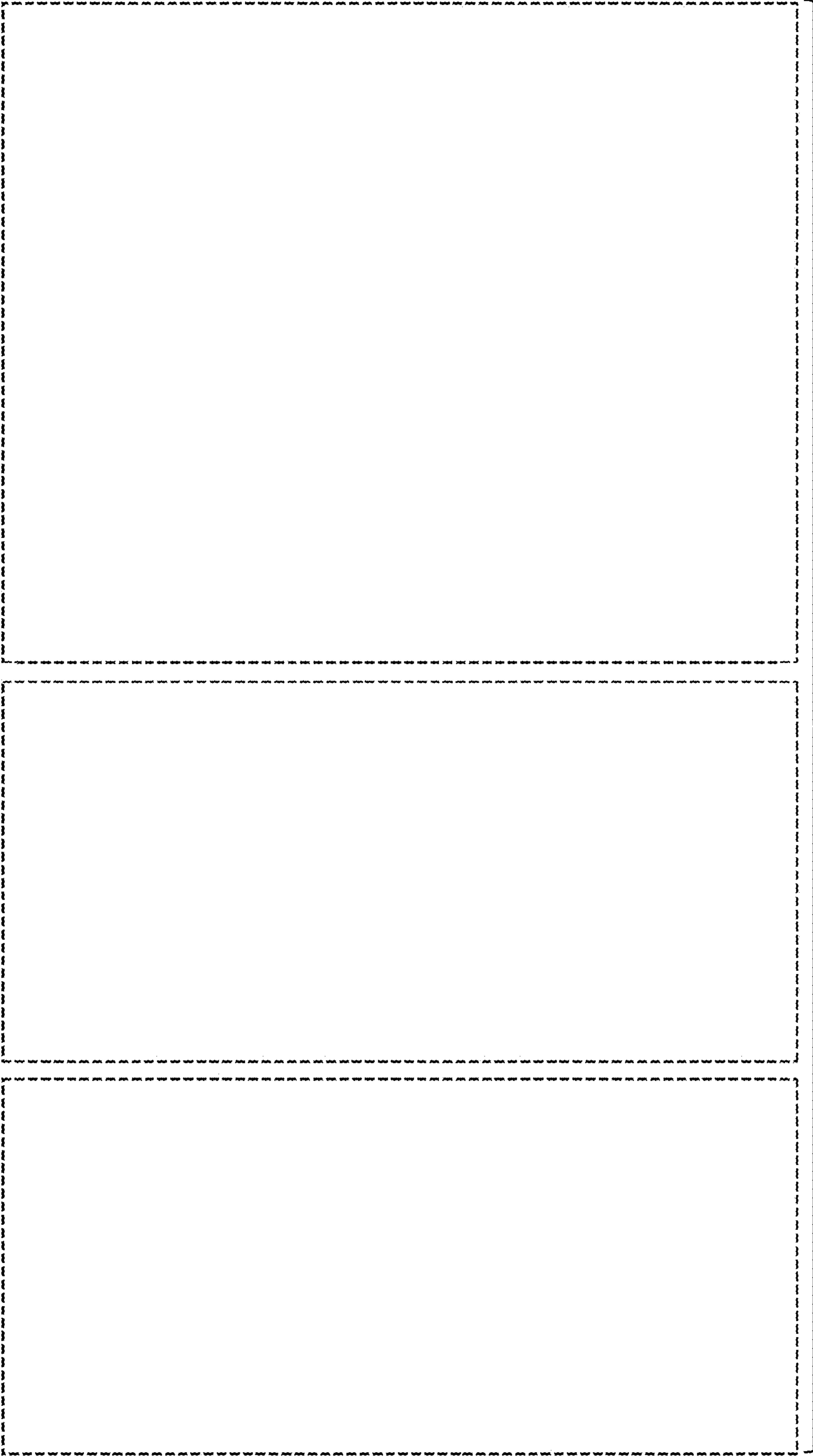

FIG. 2



FIG. 3



FIG. 4

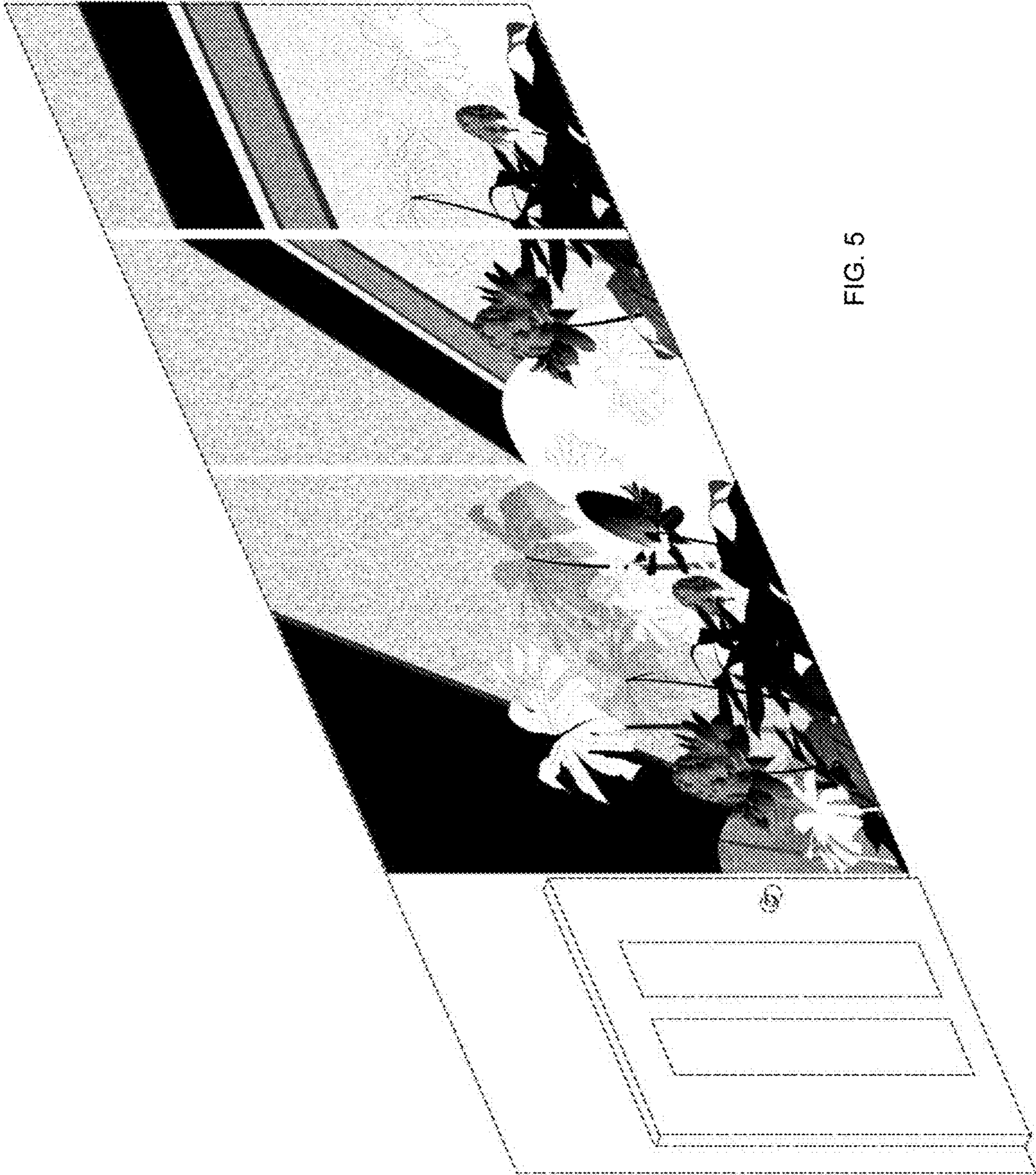

FIG. 5